

MINUTE ITEM

This Calendar Item No. ~~C38~~ was approved as
Minute Item No. 38 by the California State Lands
Commission by a vote of 2 to 0 at its
2/27/96 meeting.

**CALENDAR ITEM
C38**

A 2
S 4

02/27/96
W 25277
J. Ludlow
PRC 7880

GENERAL LEASE - PUBLIC AGENCY USE

APPLICANT:

County of Siskiyou, Department of Public Works
305 Butte Street
Yreka, California 96097

LOCATION:

Klamath River on State Highway 96 and Walker Road near the community of
Klamath River, Siskiyou County

EXHIBITS:

A. Site Map

AB 884:

08/15/96

RECOMMENDED

ACTION:

IT IS RECOMMENDED THAT THE COMMISSION:

CEQA

FINDING:

FIND THAT A NEGATIVE DECLARATION WAS PREPARED AND ADOPTED FOR
THIS PROJECT BY THE COUNTY OF SISKIYOU (STATE CLEARING HOUSE
SCH NO. 95033036) AND THAT THE COMMISSION HAS REVIEWED AND
CONSIDERED THE INFORMATION CONTAINED THEREIN.

CALENDAR PAGE	118
MINUTE PAGE	000267

CALENDAR ITEM NO. C38 (CONT'D)

**SIGNIFICANT LANDS
INVENTORY FINDING:**

FIND THAT THIS ACTIVITY IS CONSISTENT WITH THE USE CLASSIFICATION DESIGNATED FOR THE LAND PURSUANT TO PUBLIC RESOURCES CODE SECTIONS 6370, ET SEQ.

AUTHORIZATION:

AUTHORIZE ISSUANCE TO THE COUNTY OF SISKIYOU, PUBLIC WORKS DEPARTMENT, OF A FORTY-NINE (49) YEAR GENERAL LEASE- PUBLIC AGENCY USE, BEGINNING FEBRUARY 1, 1996; FOR THE RECONSTRUCTION OF THE WALKER ROAD BRIDGE ON STATE HIGHWAY 96 AND WALKER ROAD. IN CONSIDERATION OF THE PUBLIC USE AND BENEFIT, WITH THE STATE RESERVING THE RIGHT AT ANY TIME TO SET A MONETARY RENTAL IF THE COMMISSION FINDS SUCH ACTION TO BE IN THE STATE'S BEST INTEREST.

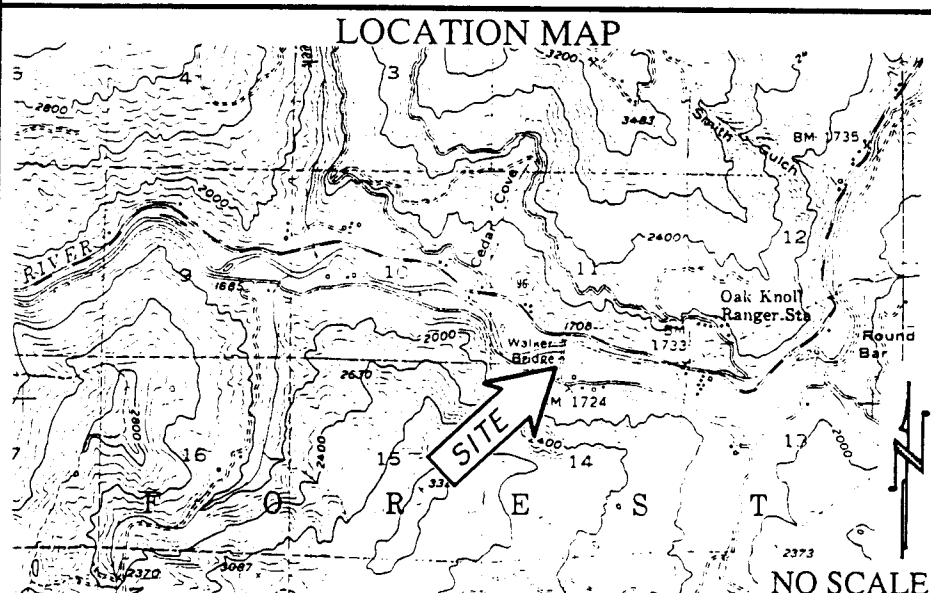
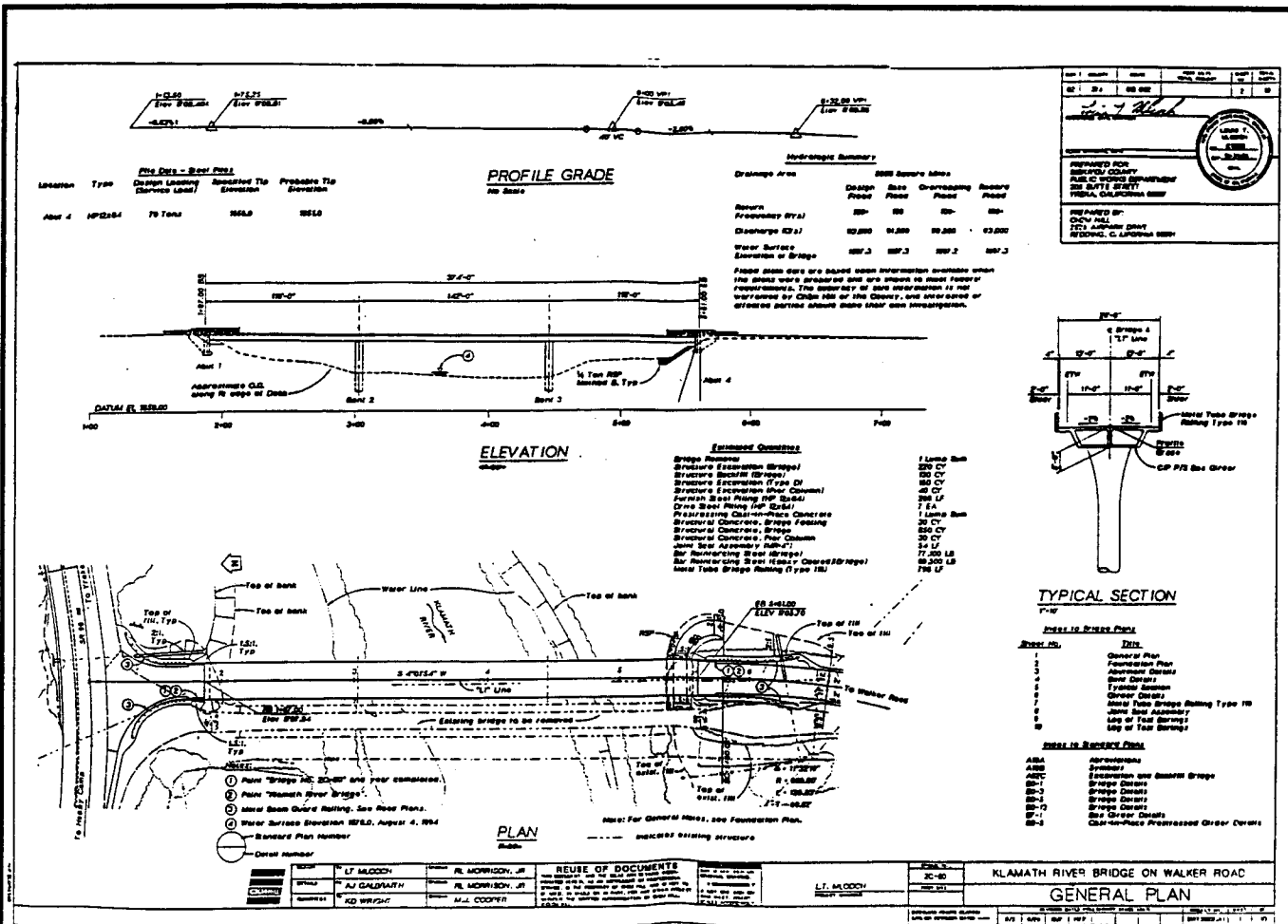

EXHIBIT "A"
 W 25277
 Siskiyou Co. Bridge Crossing
 Klamath River
 SISKIYOU COUNTY



This Exhibit is solely for purposes of generally defining the lease premises, and is not intended to be, nor shall it be construed as, a waiver or limitation of any State interest in the subject or any other property.