

MINUTE ITEM

This Calendar Item No. ~~C27~~ was approved as Minute Item No. 27 by the California State Lands Commission by a vote of 2 to ~~0~~ at its 2/27/96 meeting.

CALENDAR ITEM

C27

A 7

S 2

02/27/96
WP 6960.1
Lam
PRC 6960.1

GENERAL LEASE - RECREATIONAL AND RESIDENTIAL USE

APPLICANT:

Donna G. Cave
1436 Milton Road
Napa, California 94559

LOCATION:

A 0.015-acre parcel of tide and submerged land in Napa River, south of the City of Napa, Napa County.

EXHIBITS:

- A. Site Map
- B. Location Map

AB 884:

N/A

OTHER PERTINENT INFORMATION:

The existing improvements within the lease premises which are subject to annual rental include the deck and a portion of the residence. No rent is being charged for the existing walkway and floating dock pursuant to Public Resources Code Section 6503.5.

RECOMMENDED

ACTION:

IT IS RECOMMENDED THAT THE COMMISSION:

CALENDAR PAGE	82
MINUTE PAGE	000233

CALENDAR ITEM NO. C27 (CONT'D)

**CEQA
FINDING:**

FIND THAT THE ACTIVITY IS EXEMPT FROM THE REQUIREMENTS OF THE CEQA PURSUANT TO 14 CAL. CODE REGS. 15061 AS A CATEGORICALLY EXEMPT PROJECT, CLASS 1, EXISTING FACILITIES, 2 CAL. CODE REGS. 2905(a)(2).

**SIGNIFICANT LANDS
INVENTORY FINDING:**

FIND THAT THIS ACTIVITY IS CONSISTENT WITH THE USE CLASSIFICATION DESIGNATED FOR THE LAND PURSUANT TO PUBLIC RESOURCES CODE SECTIONS 6370, ET SEQ.

AUTHORIZATION:

AUTHORIZE ISSUANCE TO DONNA G. CAVE OF A 15-YEAR GENERAL LEASE - RECREATIONAL AND RESIDENTIAL USE, BEGINNING OCTOBER 8, 1995; IN CONSIDERATION OF ANNUAL RENT IN THE AMOUNT OF \$231 FOR THE DECK AND PORTION OF THE RESIDENCE, AND NO MONETARY RENT FOR THE EXISTING DOCK AND WALKWAY PURSUANT TO PUBLIC RESOURCES CODE SECTION 6503.5, WITH THE STATE RESERVING THE RIGHT TO FIX A DIFFERENT RENTAL ON EACH FIFTH ANNIVERSARY OF THE LEASE; PROVISION OF PUBLIC LIABILITY INSURANCE FOR COMBINED SINGLE LIMIT COVERAGE OF \$500,000; FOR THE CONTINUED USE AND MAINTENANCE OF A 4 FT. X 120 FT. WALKWAY, A 10 FT. X 30 FT. FLOATING DOCK, A 20 FT. X 22 FT. DECK AND A PORTION OF THE RESIDENCE ON THE LAND DESCRIBED ON EXHIBIT "A" ATTACHED AND BY REFERENCE MADE A PART HEREOF.

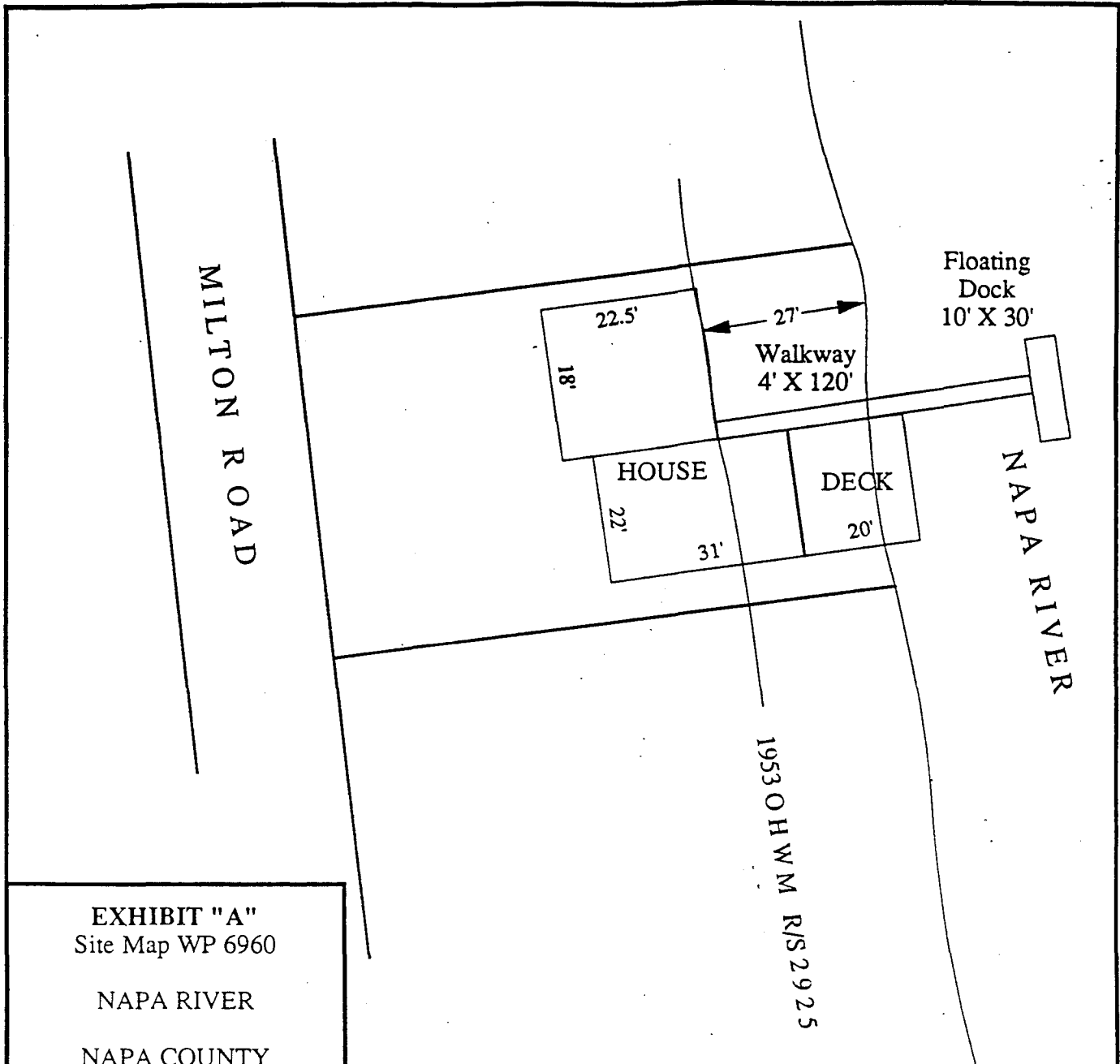

EXHIBIT "A"
 Site Map WP 6960
 NAPA RIVER
 NAPA COUNTY



DRAWING NOT TO SCALE

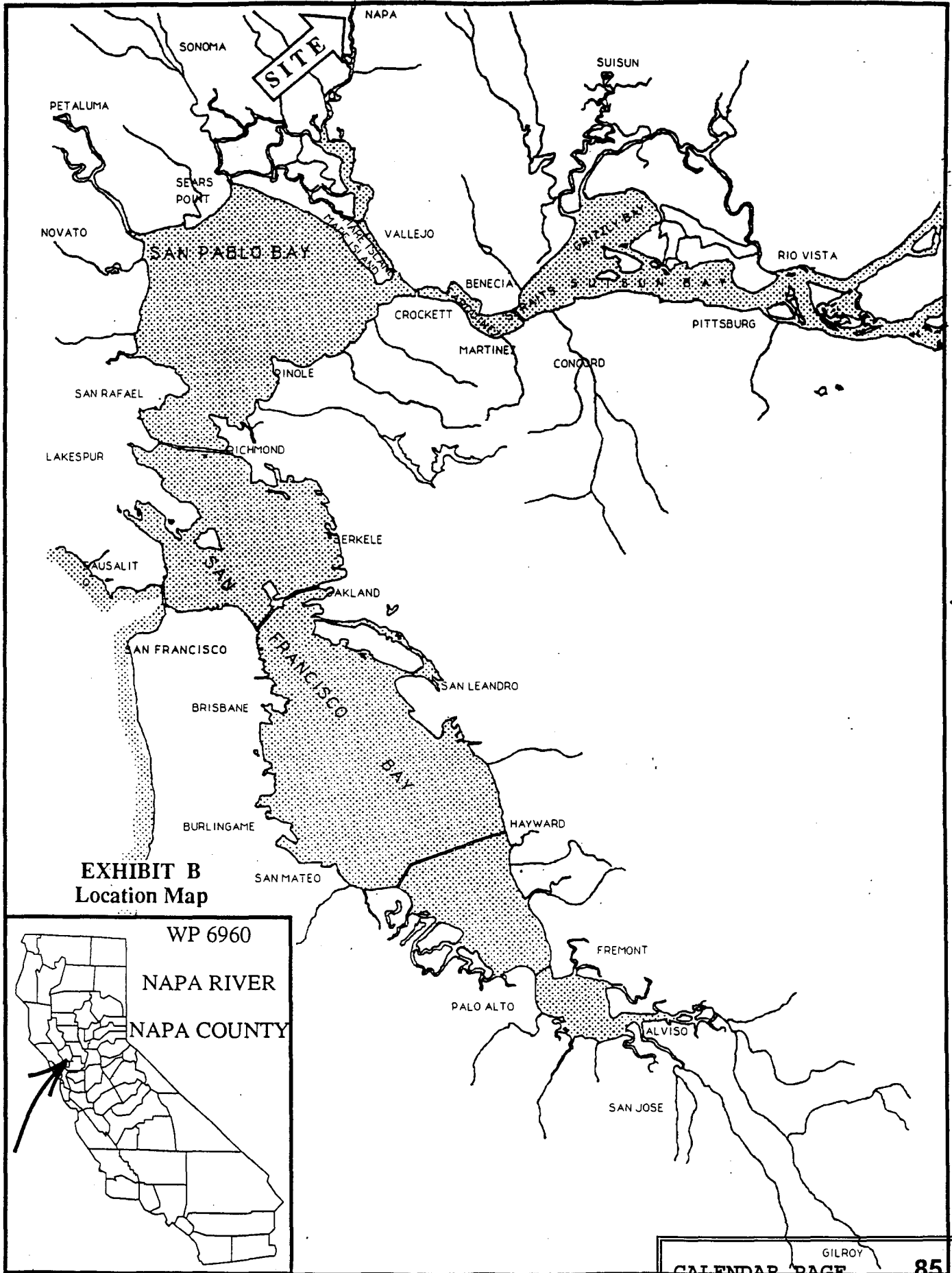

EXHIBIT B
Location Map

