

MINUTE ITEM

This Calendar Item No. C12 was approved as Minute Item No. 12 by the California State Lands Commission by a vote of 2 to 0 at its 2/27/96 meeting.

**CALENDAR ITEM
C12**

A 4
S 1

02/27/96
PRC 4469.9
Cooper

RECREATIONAL PIER LEASE

APPLICANT:

Karen Stone McCown, Trustee of the Karen Stone McCown Trust dated 5/11/90
George E. McCown, Trustee of the George E. McCown Revocable Trust
dated 11/29/93
250 Greer Road
Woodside, California 95062

LOCATION:

A parcel of submerged land located in the bed of Lake Tahoe, Tahoe City, El Dorado County.

EXHIBIT:

A. Site Map

AB 884:

N/A

RECOMMENDED

ACTION:

IT IS RECOMMENDED THAT THE COMMISSION:

CEQA

FINDING:

FIND THAT THE ACTIVITY IS EXEMPT FROM THE REQUIREMENTS OF THE CEQA PURSUANT TO 14 CAL. CODE REGS. 15061 AS A CATEGORICALLY EXEMPT PROJECT, CLASS 1, EXISTING FACILITIES; 2 CAL. CODE REGS. 2905 (a) (2).

CALENDAR PAGE	33
MINUTE PAGE	000110

CALENDAR ITEM NO. **C12** (CONT'D)

SIGNIFICANT LANDS

INVENTORY FINDING:

FIND THAT THIS ACTIVITY IS CONSISTENT WITH THE USE CLASSIFICATION DESIGNATED FOR THE LAND PURSUANT TO PUBLIC RESOURCES CODE SECTIONS 6370, ET SEQ.

AUTHORIZATION:

AUTHORIZE ISSUANCE TO KAREN STONE McCOWN, TRUSTEE OF THE KAREN STONE McCOWN TRUST, DATED 5/11/90, AND GEORGE E. McCOWN, TRUSTEE OF THE GEORGE E. McCOWN REVOCABLE TRUST, DATED 11/29/93, OF A TEN-YEAR RECREATIONAL PIER LEASE, BEGINNING JUNE 25, 1995, ON FILE IN THE COMMISSION'S OFFICES FOR ALL OF THE STATE'S SOVEREIGN LANDS BELOW THE ELEVATION OF 6223 FEET LAKE TAHOE DATUM UNDER APPLICANT'S PIER AND BOATHOUSE AS DEPICTED ON EXHIBIT "A" ATTACHED AND BY REFERENCE MADE A PART HEREOF; NO MONETARY CONSIDERATION PURSUANT TO PUBLIC RESOURCES CODE SECTION 6503.5.

CALENDAR ITEM NO. C12 (CONT'D)

**SIGNIFICANT LANDS
INVENTORY FINDING:**

FIND THAT THIS ACTIVITY IS CONSISTENT WITH THE USE
CLASSIFICATION DESIGNATED FOR THE LAND PURSUANT TO PUBLIC
RESOURCES CODE SECTIONS 6370, ET SEQ.

AUTHORIZATION:

AUTHORIZE ISSUANCE TO KAREN STONE McCOWN, TRUSTEE OF THE
KAREN STONE McCOWN TRUST, DATED 5/11/90, AND GEORGE E.
McCOWN, TRUSTEE OF THE GEORGE E. McCOWN REVOCABLE TRUST,
DATED 11/29/93, OF A TEN-YEAR RECREATIONAL PIER LEASE,
BEGINNING JUNE 25, 1995, ON FILE IN THE COMMISSION'S OFFICES FOR
ALL OF THE STATE'S SOVEREIGN LANDS BELOW THE ELEVATION OF
6223 FEET LAKE TAHOE DATUM UNDER APPLICANT'S PIER AND
BOATHOUSE AS DEPICTED ON EXHIBIT "A" ATTACHED AND BY
REFERENCE MADE A PART HEREOF; NO MONETARY CONSIDERATION
PURSUANT TO PUBLIC RESOURCES CODE SECTION 6503.5.

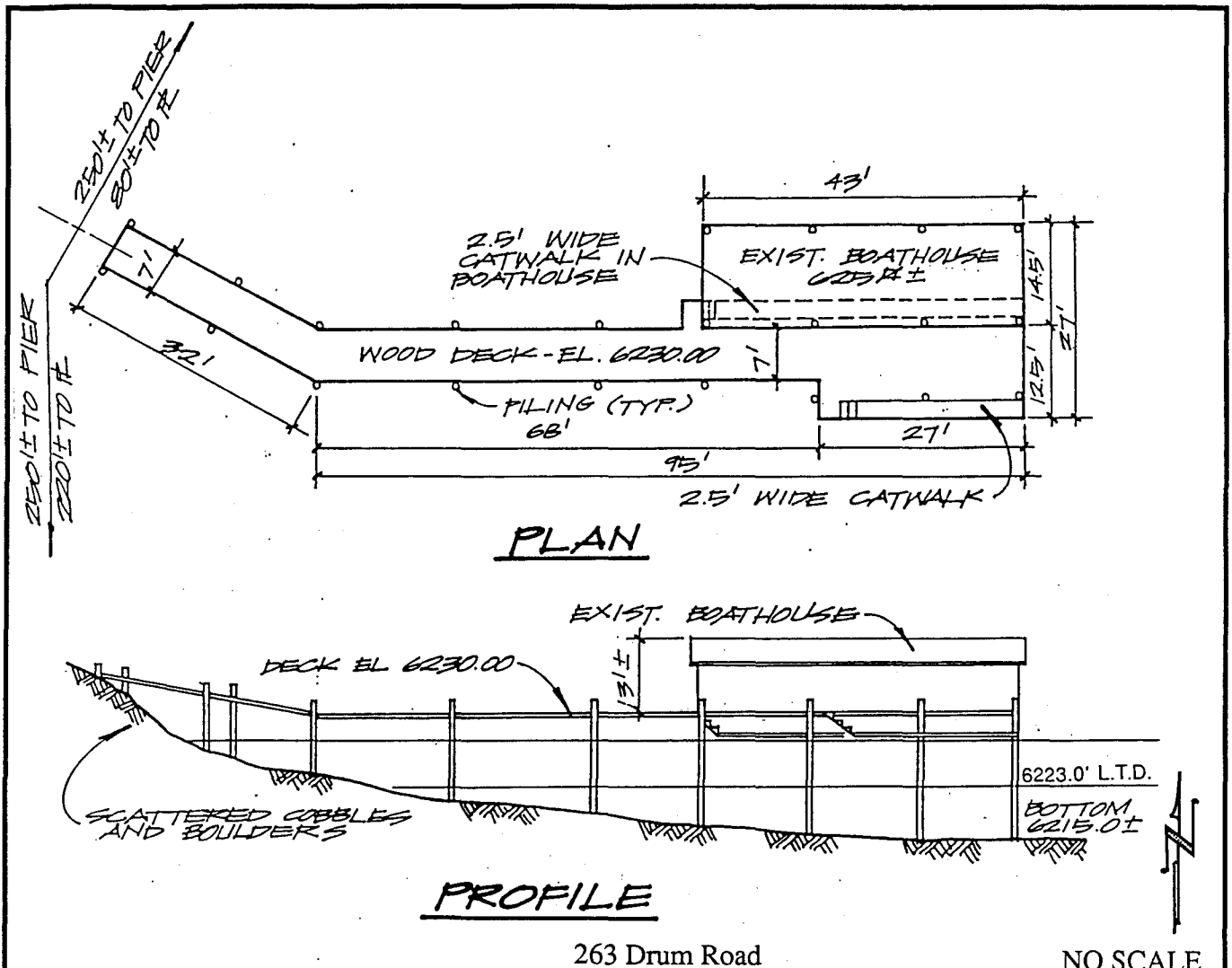

263 Drum Road NO SCALE

LOCATION MAP

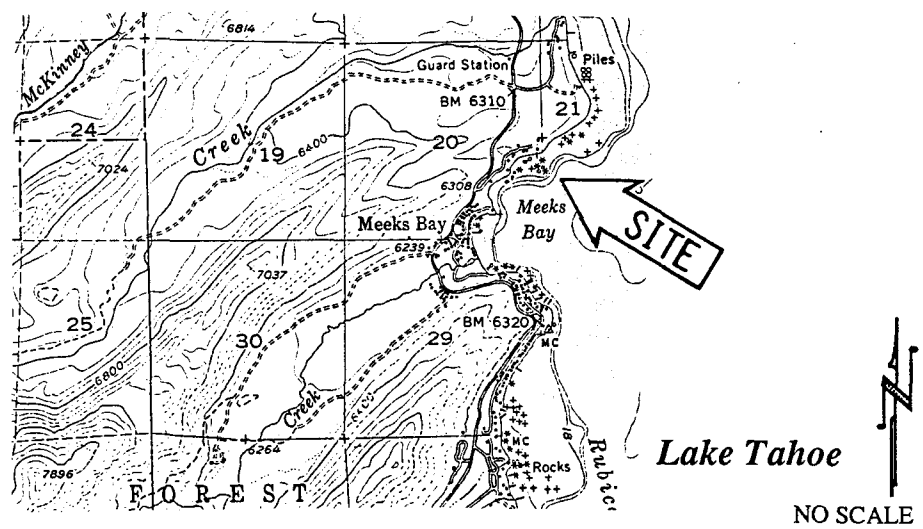
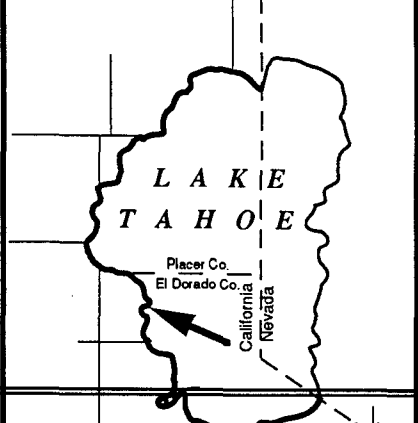
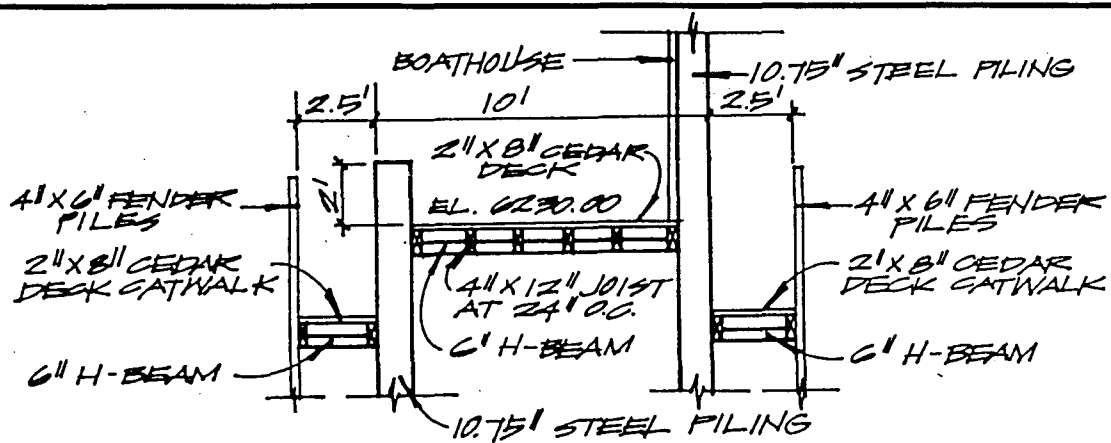

EXHIBIT "A"
 PRC 4469.9
 APN 016 - 300 - 211
 Lake Tahoe
 EL DORADO COUNTY
 Sheet 1 of 2 Sheets



This Exhibit is solely for purposes of generally defining the lease premises, and is not intended to be, nor shall it be construed as, a waiver or limitation of any State interest in the subject or any other property.

CALENDAR PAGE 36
 MINUTE PAGE 000413
 CG 5/25/13



PIERHEAD SECTION

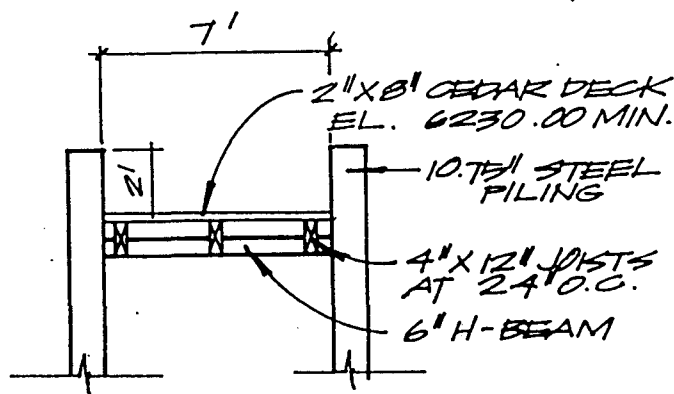

PIER SECTION

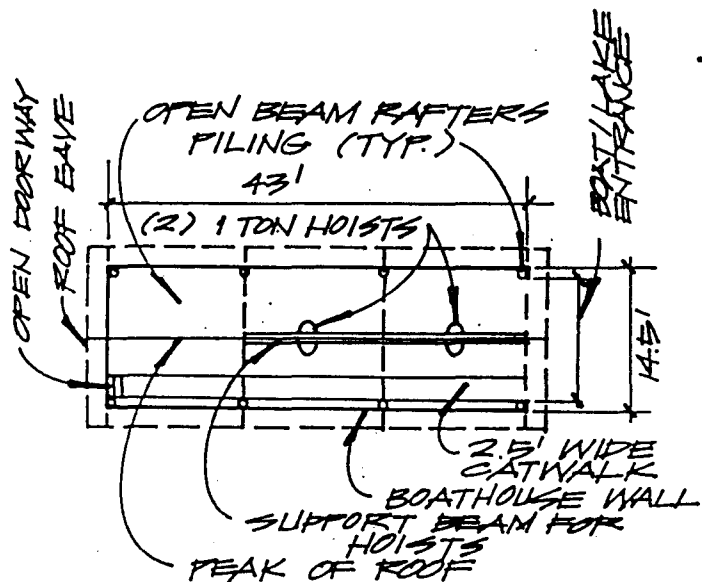

EXISTING BOATHOUSE

NO SCALE

This Exhibit is solely for purposes of generally defining the lease premises, and is not intended to be, nor shall it be construed as, a waiver or limitation of any State interest in the subject or any other property.

EXHIBIT "A"
 PRC 4469.9
 APN 016 - 300 - 211
 Lake Tahoe
 EL DORADO COUNTY
 Sheet 2 of 2 Sheets