

This Calendar Item No. C46
was approved as Minute Item
No. 46 by the State Lands
Commission by a vote of 3
to 0 at its 10-17-95
meeting.

10/17/95

PRC 4357.9

J. Ludlow

CALENDAR ITEM

C46

A 4

S 1

RECREATIONAL PIER LEASE

APPLICANT:

Delbert E. Loewen and Faye D. Heldorn
1615 Amber Leaf Way
Lodi, California 95242

LOCATION:

A arcel of submerged land located in the bed of Lake Tahoe,
Placer County.

EXHIBIT:

A. Site Map

AB 884:

N/A

RECOMMENDED ACTION:

IT IS RECOMMENDED THAT THE COMMISSION:

CEQA FINDING:

FIND THAT THE ACTIVITY IS EXEMPT FROM THE REQUIREMENTS OF THE
CEQA PURSUANT TO 14 CAL. CODE REGS. 15061 AS A CATEGORICALLY
EXEMPT PROJECT, CLASS 1, 2 CAL. CODE REGS. 2905 (a) (2).

SIGNIFICANT LANDS

INVENTORY FINDING:

FIND THAT THIS ACTIVITY IS CONSISTENT WITH THE USE
CLASSIFICATION DESIGNATED FOR THE LAND PURSUANT TO PUBLIC
RESOURCES CODE SECTION 6370, ET SEQ.

AUTHORIZATION:

AUTHORIZE ISSUANCE TO DELBERT E. LOEWEN AND FAYE D. HELDORN OF
A TEN-YEAR RECREATIONAL PIER LEASE ON FILE IN THE COMMISSION'S
OFFICES FOR ALL OF THE STATE'S SOVEREIGN LANDS BELOW THE
ELEVATION OF 6223 FEET LTD UNDER APPLICANT'S PIER AS DEPICTED
ON EXHIBIT "A" ATTACHED AND BY REFERENCE MADE A PART HEREOF,
BEGINNING NOVEMBER 14, 1994; NO CONSIDERATION PURSUANT TO
PUBLIC RESOURCES CODE SECTION 6503.5.

CALENDAR PAGE

144

MINUTE PAGE

1985

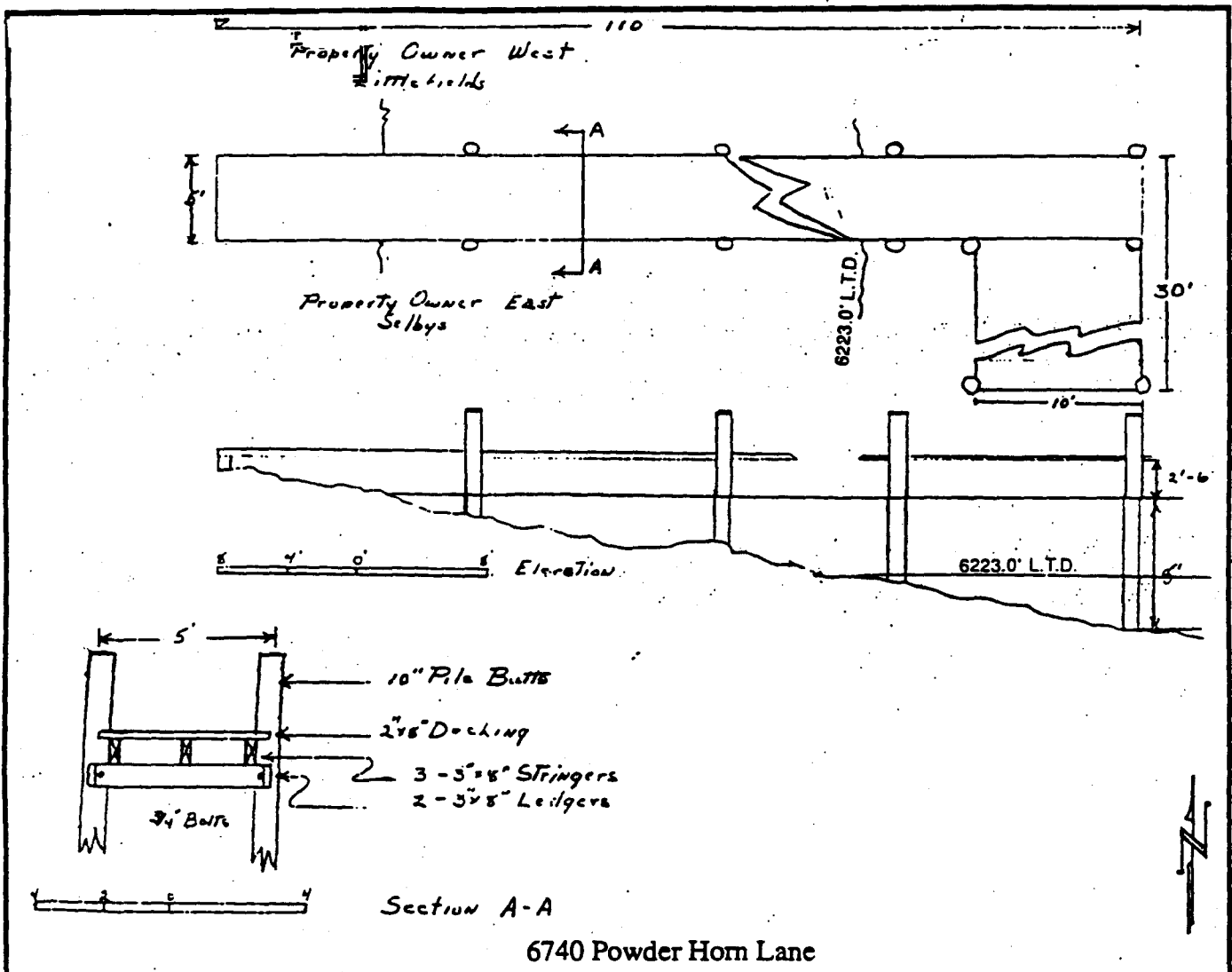

LOCATION MAP

NO SCALE

Lake Tahoe

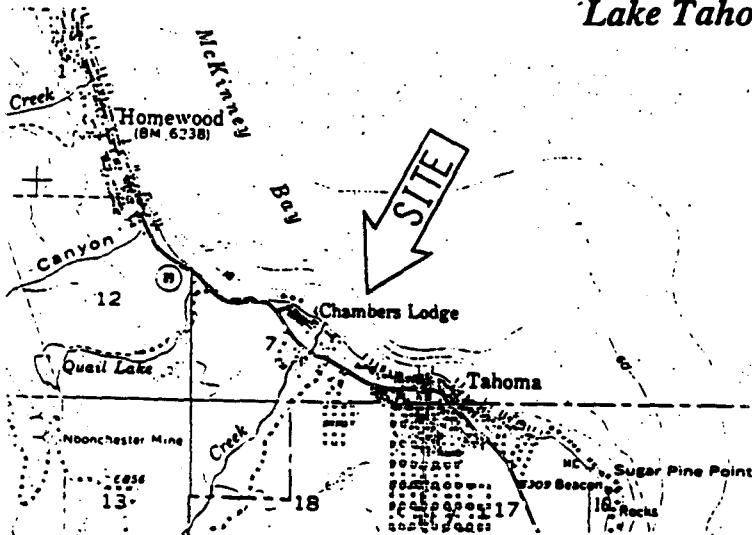

This Exhibit is solely for purposes of generally defining the lease premises, and is not intended to be, nor shall it be construed as, a waiver or limitation of any State interest in the subject or any other property.

EXHIBIT "A"

PRC 4357.9

APN 98 - 180 - 025

Lake Tahoe

PLACER COUNTY

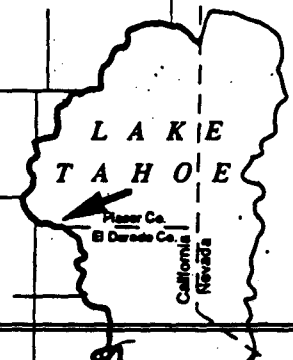

CALENDAR PAGE 144.1

MINUTE PAGE 1986

CG 605