

**MINUTE ITEM**

This Calendar Item No. C13  
was approved as Minute Item  
No. 13 by the State Lands  
Commission by a vote of 3  
to 0 at its 8-3-94  
meeting.

**CALENDAR ITEM  
C13**

A 20, 21

S 10, 11

08/03/94  
W 24856  
Jones  
PRC7776

**GENERAL LEASE - RIGHT OF WAY USE**

**APPLICANT:**

Southern Pacific Transportation Company  
One Market Plaza  
San Francisco, California 94105

**LOCATION:**

Tide and submerged land in San Francisco Bay, San Mateo and Alameda Counties.

**EXHIBITS:**

A. Site Map

B. Location Map

**AB 884:**

09/25/94

**RECOMMENDED**

**ACTION:**

IT IS RECOMMENDED THAT THE COMMISSION:

**CEQA**

**FINDING:**

FIND THAT THE ACTIVITY IS EXEMPT FROM THE REQUIREMENTS OF THE CEQA PURSUANT TO 14 CAL. CODE REGS. 15061 AS A CATEGORICALLY EXEMPT PROJECT, CLASS 2, 14 CAL. CODE REGS. 15302.

**SIGNIFICANT LANDS**

**INVENTORY FINDING:**

FIND THAT THIS ACTIVITY IS CONSISTENT WITH THE USE CLASSIFICATION DESIGNATED FOR THE LAND PURSUANT TO P.R.C. 6370, ET SEQ.

**AUTHORIZATION:**

AUTHORIZE ISSUANCE TO SOUTHERN PACIFIC TRANSPORTATION COMPANY OF A 49-YEAR GENERAL LEASE - RIGHT OF WAY USE, BEGINNING JULY 1, 1994; IN CONSIDERATION OF THE PUBLIC USE AND BENEFIT; WITH THE STATE RESERVING THE RIGHT AT ANY TIME TO SET A MONETARY RENTAL IF THE COMMISSION FINDS SUCH ACTION TO BE IN THE STATE'S BEST INTEREST; PROVISION OF PUBLIC LIABILITY INSURANCE FOR COMBINED SINGLE LIMIT COVERAGE OF \$1,000,000; FOR THE OPERATION, MAINTENANCE AND REPAIR OF THE DUMBARTON RAILROAD BRIDGE ON THE LAND DESCRIBED ON EXHIBIT "A" ATTACHED AND BY REFERENCE MADE A PART HEREOF.

CALENDAR PAGE	63
MINUTE PAGE	2728

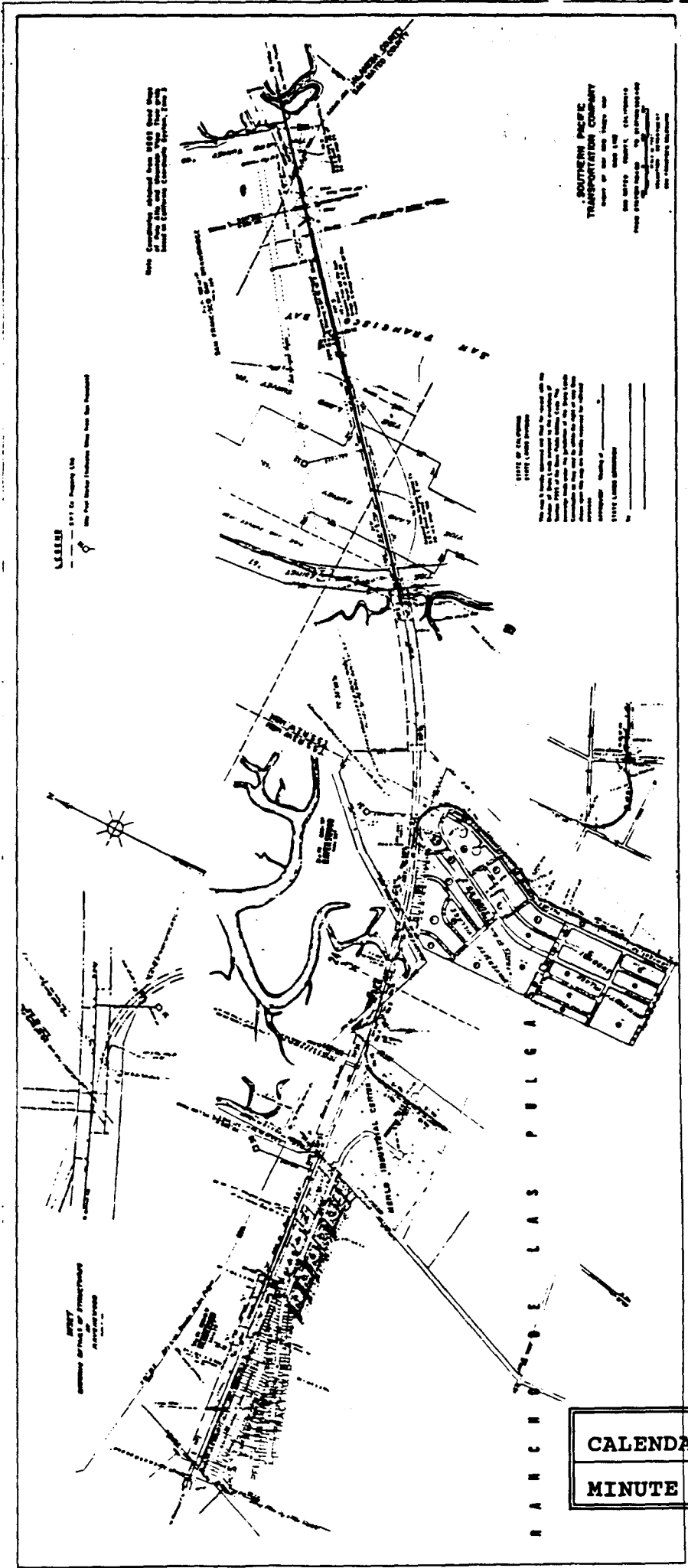

1917 G. Property Line  
 1917 G. Property Line  
 1917 G. Property Line

1917 G. Property Line  
 1917 G. Property Line  
 1917 G. Property Line

1917 G. Property Line  
 1917 G. Property Line  
 1917 G. Property Line

SOUTHERN PACIFIC  
 TRANSPORTATION COMPANY  
 1917 G. Property Line  
 1917 G. Property Line  
 1917 G. Property Line

**EXHIBIT A**  
**Site Map**  
**W 24856**

Southern Pacific  
 Transportation

CALENDAR PAGE Comp 94  
 MINUTE PAGE shipping channel

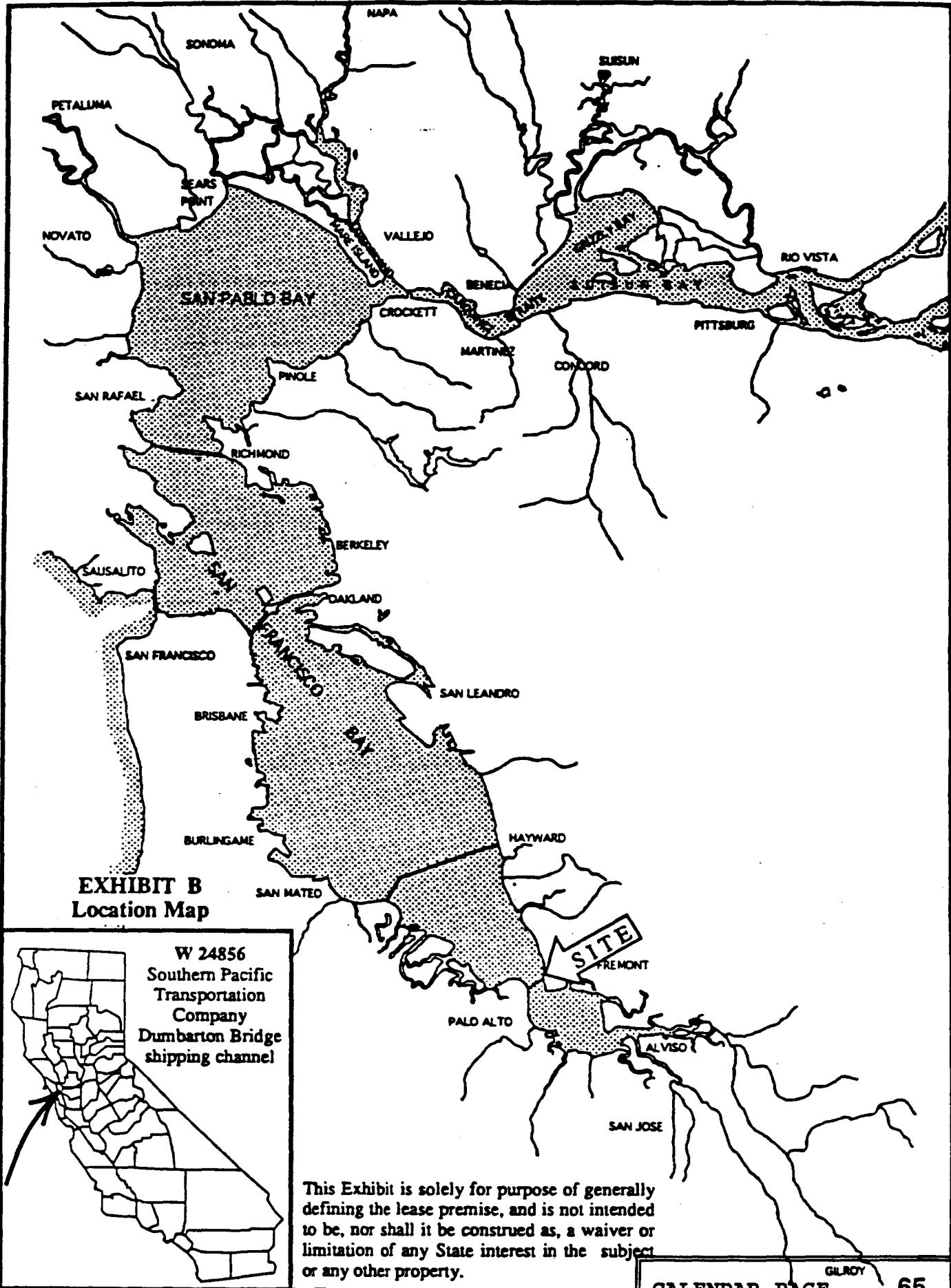

**EXHIBIT B**  
**Location Map**

W 24856  
Southern Pacific  
Transportation  
Company  
Dumbarton Bridge  
shipping channel

This Exhibit is solely for purpose of generally defining the lease premise, and is not intended to be, nor shall it be construed as, a waiver or limitation of any State interest in the subject or any other property.

NO TEXT THIS PAGE

CALENDAR PAGE _____
MINUTE PAGE <u>2731</u>