

MINUTE ITEM
This Calendar Item No. C04
was approved as Minute Item
No. 04 by the State Lands
Commission by a vote of 3
to 0 at its 8-3-94
meeting.

CALENDAR ITEM
C04

A 5

S 6

08/03/94

WP 6042

Burks

PRC6042

GENERAL LEASE - PROTECTIVE STRUCTURE AND RECREATIONAL USE

APPLICANT:

Paul Thayer and Martha Lennihan
6645 Garden Highway
Sacramento, California 95837

LOCATION:

Tide and submerged land located in Sacramento River, portion
of Lots 77 and 78, Natomas Elkhorn Subdivision (APN 201-
0270-034), adjacent to Garden Highway, Sacramento County.

EXHIBITS:

A. Site Map

B. Location Map

AB 884:

N/A

RECOMMENDED

ACTION:

IT IS RECOMMENDED THAT THE COMMISSION:

CEQA

FINDING: (Bank Protection)

FIND THAT THE ACTIVITY IS EXEMPT FROM THE REQUIREMENTS OF
THE CEQA PURSUANT TO 14 CAL. CODE REGS. 15061 AS A
CATEGORICALLY EXEMPT PROJECT, CLASS 4, 14 CAL. CODE REGS.
15304.

(Recreational Pier)

FIND THAT THE ACTIVITY IS EXEMPT FROM THE REQUIREMENTS OF
THE CEQA PURSUANT TO 14 CAL. CODE REGS. 15061 AS A
CATEGORICALLY EXEMPT PROJECT, CLASS 1, 2 CAL. CODE REGS.
21905(a)(2).

SIGNIFICANT LANDS

INVENTORY FINDING:

FIND THAT THIS ACTIVITY IS CONSISTENT WITH THE USE
CLASSIFICATION DESIGNATED FOR THE LAND PURSUANT TO P.R.C.
6370, ET SEQ.

AUTHORIZATION:

AUTHORIZE ISSUANCE TO PAUL THAYER AND MARTHA LENNIHAN OF A TEN-YEAR GENERAL LEASE - PROTECTIVE STRUCTURE AND RECREATIONAL USE, BEGINNING AUGUST 27, 1993; BANK PROTECTION - PUBLIC USE AND BENEFIT, WITH THE STATE RESERVING THE RIGHT AT ANY TIME TO SET A MONETARY RENTAL IF THE COMMISSION FINDS SUCH ACTION TO BE IN THE STATE'S BEST INTEREST; RECREATIONAL DOCK - NO MONETARY CONSIDERATION PURSUANT TO SECTION 6503.5 OF THE P.R.C.; FOR CONTINUED USE AND MAINTENANCE OF AN EXISTING 8 FT. X 32 FT. FLOATING DOCK WITH TWO PILINGS, AND 4 FT. X 62 FT. RAMP; FOR MINOR MODIFICATIONS DURING PREVIOUS REPAIR AND MAINTENANCE; AND FOR RETENTION OF APPROXIMATELY 900 CUBIC YARDS OF EXISTING BANK PROTECTION; ON THE LAND DESCRIBED ON EXHIBIT "A" ATTACHED AND BY REFERENCE MADE A PART HEREOF.

Area to be leased lies directly beneath dock and walkway, plus a necessary use area 10 feet in width around the entire dock and walkway. Excepting therefrom any portion lying above the ordinary high water mark.

PROPOSED FLOAT
 LOCATION ASSESSOR'S PARCEL NO.
 201-270-340
 PARCEL "D" A PORTION OF
 LOTS 77-78
 NATOMAS - ELKHORN SL.
 6645 GARDEN HWY
 SACRAMENTO, CALIF. 95833
 DATE MAY 1 1981

NO. 7610

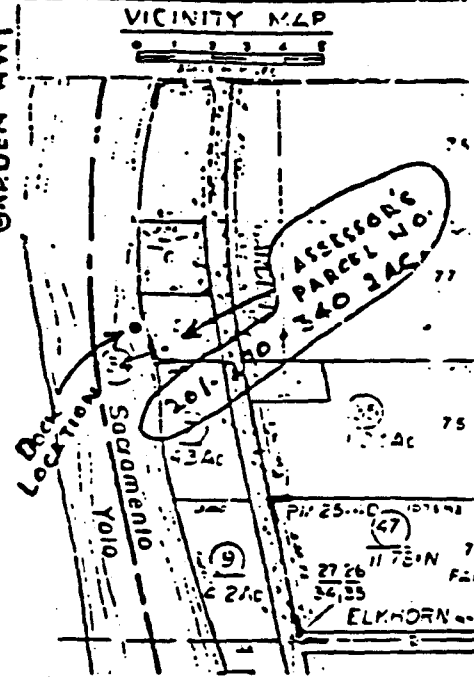
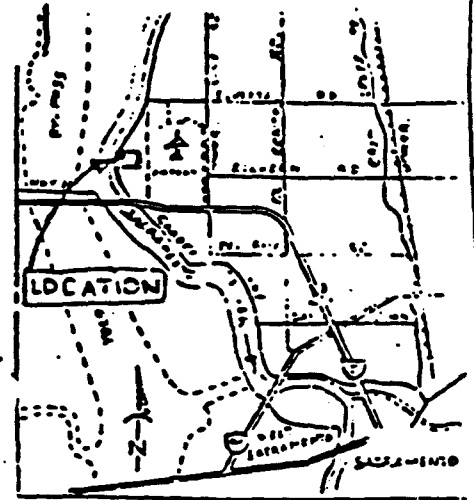
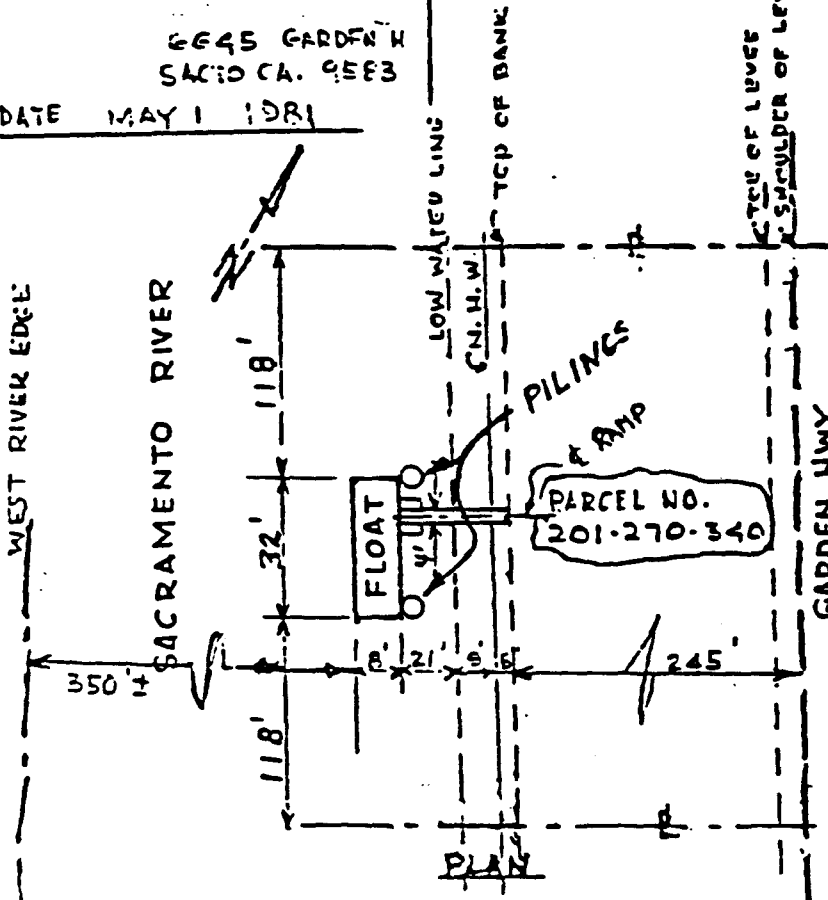

This exhibit is solely for purposes of generally defining the lease premises, and is not intended to be, nor shall it be construed as, a waiver or limitation of any State interest in the subject or any other property.

CALENDAR EXHIBIT "A"
 MINUTE PAGE WP-6042
 2674

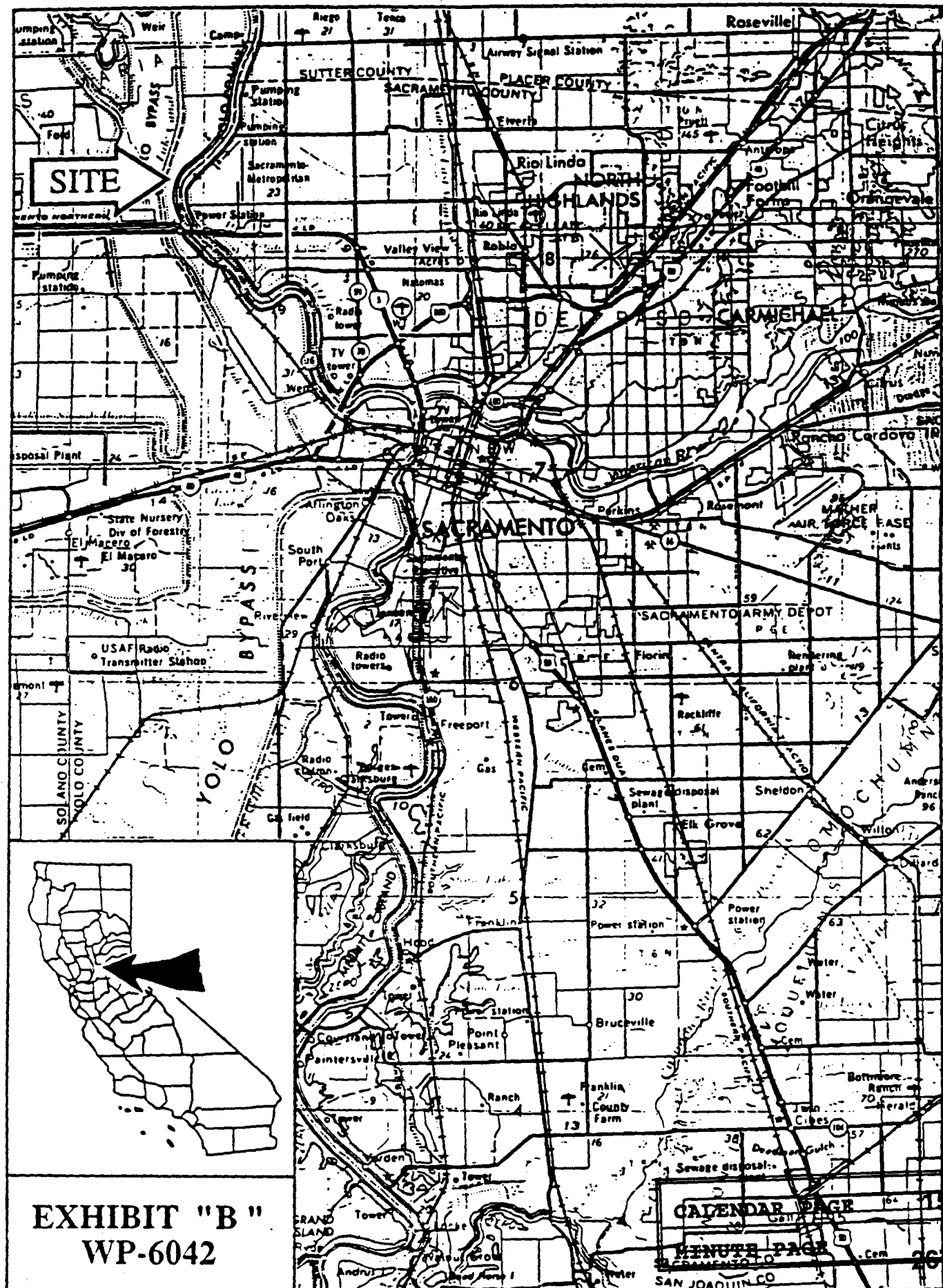

EXHIBIT "B"
WP-6042

CALENDAR PAGE 104 115
MINUTE PAGE 2675
 SAN JOAQUIN CO