



CALENDAR ITEM NO. C02 (CONT'D)

**AUTHORIZATION:**

AUTHORIZE ISSUANCE TO DONALD R. AND ALBERTA M. KENNY OF A TEN (10) YEAR GENERAL LEASE - PROTECTIVE STRUCTURE AND RECREATIONAL USE BEGINNING JULY 1, 1994; IN CONSIDERATION OF THE PUBLIC BENEFIT, WITH THE STATE RESERVING THE RIGHT AT ANY TIME TO SET A MONETARY RENTAL IF THE COMMISSION FINDS SUCH ACTION TO BE IN THE STATE'S BEST INTEREST FOR THE BANK PROTECTION, AND PURSUANT TO SECTION 6503.5 OF THE PUBLIC RESOURCES CODE FOR THE RECREATIONAL BOAT DOCK; PROVISION OF PUBLIC LIABILITY INSURANCE FOR A COMBINED SINGLE LIMIT COVERAGE OF \$500,000; FOR CONTINUED USE AND MAINTENANCE OF AN EXISTING SINGLE-BERTH COVERED FLOATING BOAT DOCK, GANGWAY AND WALKWAY, AND PREVIOUSLY UNAUTHORIZED BANK PROTECTION; ON THE LAND DESCRIBED ON EXHIBIT "A" ATTACHED AND BY REFERENCE MADE A PART HEREOF.

# NOT A PERMIT

NO. 9542

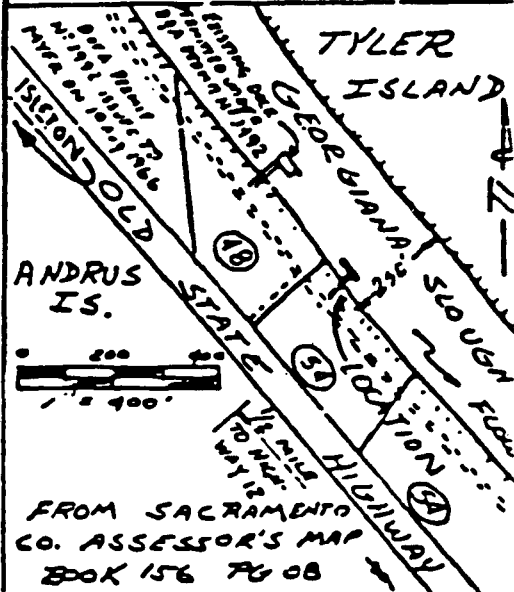
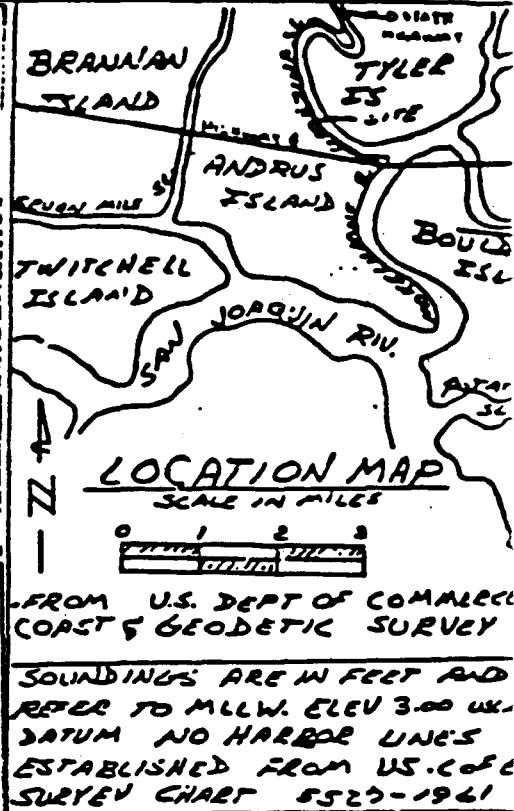
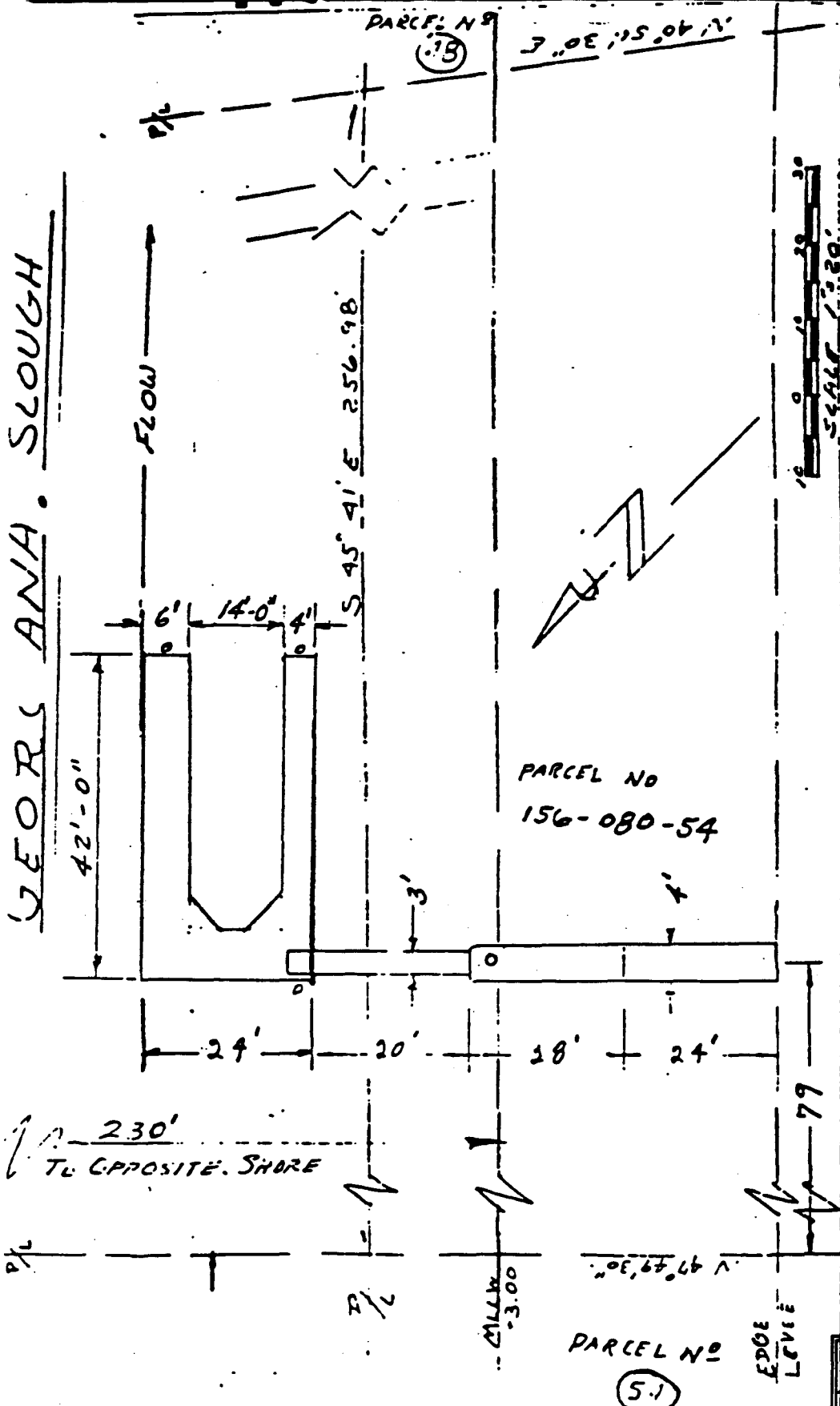

OWNER: Donald and Alberta Kenn  
 17161 Terminous Road  
 Calendar Page 95691  
 MINUTE PAGE 95691

This Land description is solely for purposes of generally defining the lease premises, and is not intended to be, nor shall it be construed as, a waiver or limitation of any State interest in the subject or any other property.

EXHIBIT A  
 WP 7089

DATE: FEB 4, 1987/2666  
 REV: FEB 12, 1987

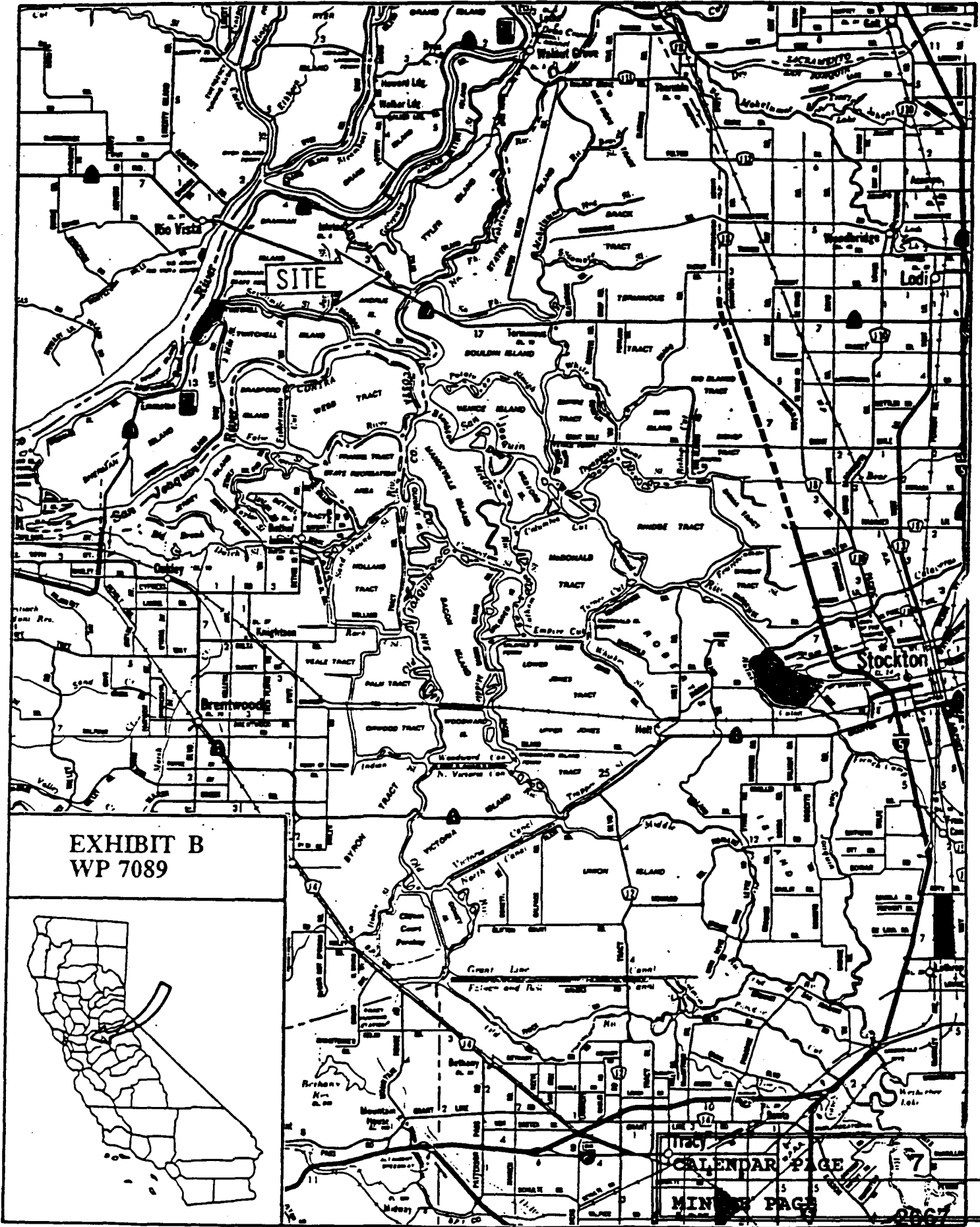

EXHIBIT B  
WP 7089

CALENDAR PAGE	7
MINUTE PAGE	2867