

MINUTE ITEM
This Calendar Item No. 006
was approved as Minute Item
No. 06 by the State Lands
Commission by a vote of 3
to 0 at its 7-9-94
meeting.

CALENDAR ITEM
C06

A 17

S 5

07/05/94

WP 6413

Jones

PRC 6413

RECREATIONAL PIER PERMIT

APPLICANT:

William Martin Schendel
1967 De Lima Road
Lathrop, California 95330

LOCATION:

Tide and submerged land in the San Joaquin River, San Joaquin
County.

EXHIBITS:

A. Site Map

B. Location Map

AB 884:

N/A.

RECOMMENDED

ACTION:

IT IS RECOMMENDED THAT THE COMMISSION:

CEQA

FINDING:

FIND THAT THE ACTIVITY IS EXEMPT FROM THE REQUIREMENTS OF THE
CEQA PURSUANT TO 14 CAL. CODE REGS. 15061 AS A CATEGORICALLY
EXEMPT PROJECT, CLASS 1, EXISTING FACILITIES, 2 CAL. CODE
REGS. 2905(A)(2).

SIGNIFICANT LANDS

INVENTORY FINDING:

FIND THAT THIS ACTIVITY IS CONSISTENT WITH THE USE
CLASSIFICATION DESIGNATED FOR THE LAND PURSUANT TO
P.R.C. 6370, ET SEQ.

AUTHORIZATION:

AUTHORIZE ISSUANCE TO WILLIAM MARTIN SCHENDEL OF A TEN-YEAR
RECREATIONAL PIER PERMIT, BEGINNING APRIL 28, 1993; WITH NO
MONETARY CONSIDERATION PURSUANT TO SECTION 6503.5 OF THE
P.R.C.; FOR AN 8 FOOT X 4 FOOT RAMP AND A 26 FOOT X 12 FOOT
FLOATING DOCK; ON THE LAND DESCRIBED ON EXHIBIT "A" ATTACHED
AND BY REFERENCE MADE A PART HEREOF.

Area to be leased lies directly beneath dock and walkway, plus a necessary use area 10 feet in width around the entire dock and walkway. Excepting therefrom any portion lying above the ordinary high water mark.

NOT A PERMIT

No. 8212

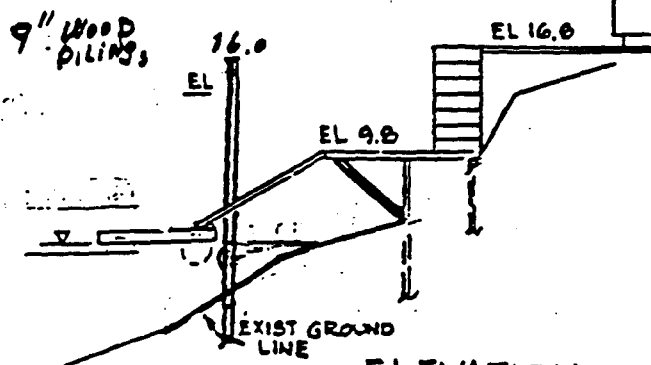

ELEVATION
SCALE IN FEET

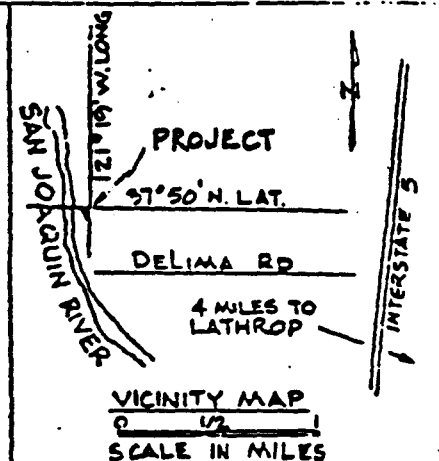

NOTE - DOCK FLOATATION CONSISTS OF TWO 24" DIA.

STEEL PONTONS - COVERED w/ MARINE EPOXY - 4 COATS

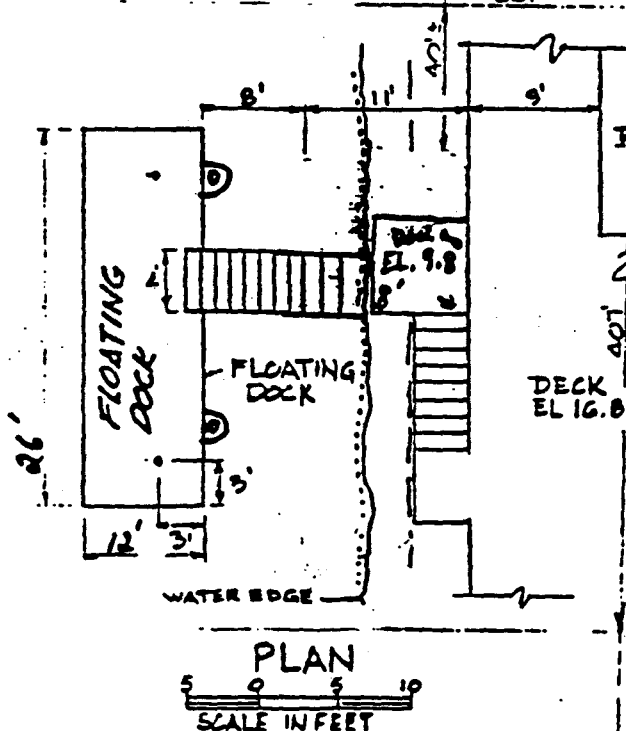

RESIDENCE FF 17.5

EXISTING PRIVATE RESIDENCE
IN SAN JOAQUIN RIVER
LATHROP, CALIFORNIA
COUNTY OF SAN JOAQUIN
APPLICATION BY ALLEN RICHARDS
SHEET 1 of 2 Wm. Schmedel

This exhibit is solely for purposes of generally defining the lease premises, and is not intended to be, nor shall it be construed as, a waiver or limitation of State interest in the subject or any other property.

EXHIBIT "A" 246
EXHIBIT PAGE 6413
MINUTE PAGE 21636

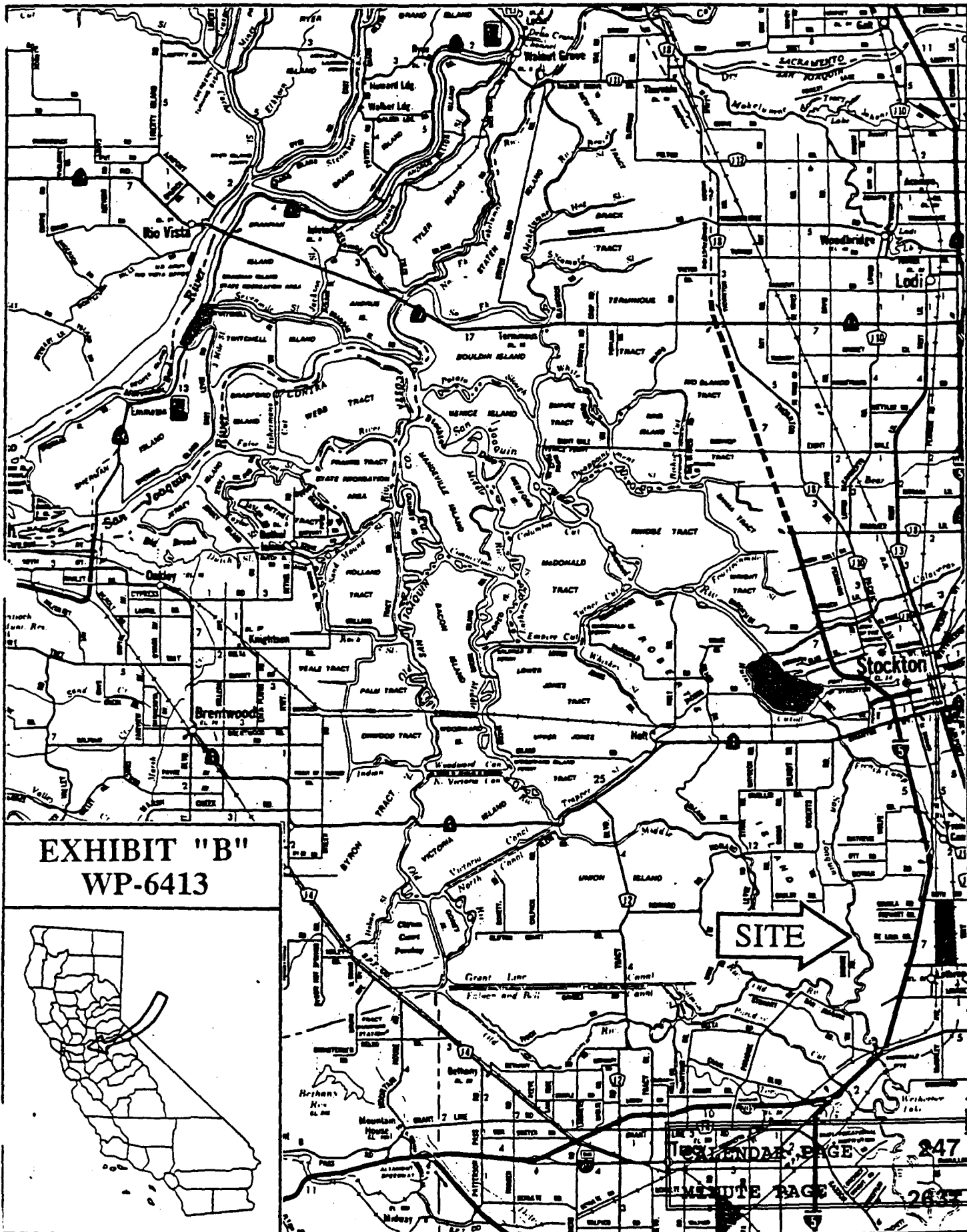

EXHIBIT "B"
WP-6413

