

CALENDAR ITEM

C10

MINUTE ITEM  
This Calendar Item No. C10  
was approved as Minute Item  
No. 10 by the State Lands  
Commission by a vote of 3  
to 0 at its 4/6/94  
meeting.

A 8  
S 4

04/06/94  
WP 5105  
Burks  
PRC 5105

GENERAL LEASE - PROTECTIVE STRUCTURE  
AND RECREATIONAL USE

PARTY: Mickey and Norma Williams  
489 So. Genevieve Lane  
San Jose, California 95128

LOCATION: Tide and submerged land in the San Joaquin River,  
Lot 13 San Andreas Park, Andrus Island, Sacramento  
County.

EXHIBITS: A. Site Map B. Location Map

AB 884: N/A

CEQA FINDING:  
(Recreational Pier)  
FIND THAT THE ACTIVITY IS EXEMPT FROM THE REQUIREMENTS  
OF THE CEQA PURSUANT TO 14 CAL. CODE REGS. 15061 AS A  
CATEGORICALLY EXEMPT PROJECT, CLASS 1, 2 CAL. CODE  
REGS. 2905(a)(2).

CEQA FINDING:  
(Bank Protection)  
FIND THAT THE ACTIVITY IS EXEMPT FROM THE REQUIREMENTS  
OF THE CEQA PURSUANT TO 14 CAL. CODE REGS. 15061 AS A  
CATEGORICALLY EXEMPT PROJECT, CLASS 4, 14 CAL. CODE  
REGS. 15304.

SIGNIFICANT LANDS  
INVENTORY  
FINDING:

FIND THAT THIS ACTIVITY IS CONSISTENT WITH THE USE  
CLASSIFICATION DESIGNATED FOR THE LAND PURSUANT TO  
P.R.C. 6370, ET SEQ.

CALENDAR PAGE	42
MINUTE PAGE	931

**RECOMMENDED  
ACTION:**

IT IS RECOMMENDED THAT THE COMMISSION:

AUTHORIZE ISSUANCE TO MICKEY AND NORMA WILLIAMS OF A TEN (10) YEAR GENERAL LEASE - PROTECTIVE STRUCTURE AND RECREATIONAL USE, BEGINNING MARCH 15, 1994; IN CONSIDERATION OF THE PUBLIC BENEFIT, WITH THE STATE RESERVING THE RIGHT AT ANY TIME TO SET A MONETARY RENTAL IF THE COMMISSION FINDS SUCH ACTION TO BE IN THE STATE'S BEST INTEREST FOR THE BANK PROTECTION, AND PURSUANT TO SECTION 6503.5 OF THE P.R.C. FOR THE RECREATIONAL FACILITIES; PROVISION OF PUBLIC LIABILITY INSURANCE FOR COMBINED SINGLE LIMIT COVERAGE OF \$500,000; FOR THE CONTINUED USE AND MAINTENANCE OF EXISTING BANK PROTECTION ALONG APPROXIMATELY 80 FT. OF SHORELINE FRONTING PROPERTY, A 12 FT. X 16 FT. PLATFORM WITH A 2 1/2 FT. X 31 FT. WALKWAY; ON THE LAND DESCRIBED ON EXHIBIT "A" ATTACHED AND BY REFERENCE MADE A PART HEREOF.

**LIST OF MATERIALS**

**PLATFORM**

- 2- 8x8 BEAMS
- 5- 4x4 CROSS MEMBERS
- 4- 12" MIN BUTT PILING
- 2x8 DECKING

**FLOATS**

- STYROFOAM FLOTATION
- METAL SLIP RINGS
- GALV. HARDWARE
- 2x8 DECK FRAMING
- WOOD DECKING

**SACRAMENTO COUNTY  
ASSESSOR'S PARCEL  
NO. 156-130-13**

This Land description is solely for purposes of generally defining the lease premises, and is not intended to be, nor shall it be construed as, a waiver or limitation of any State interest in the subject or any other property.

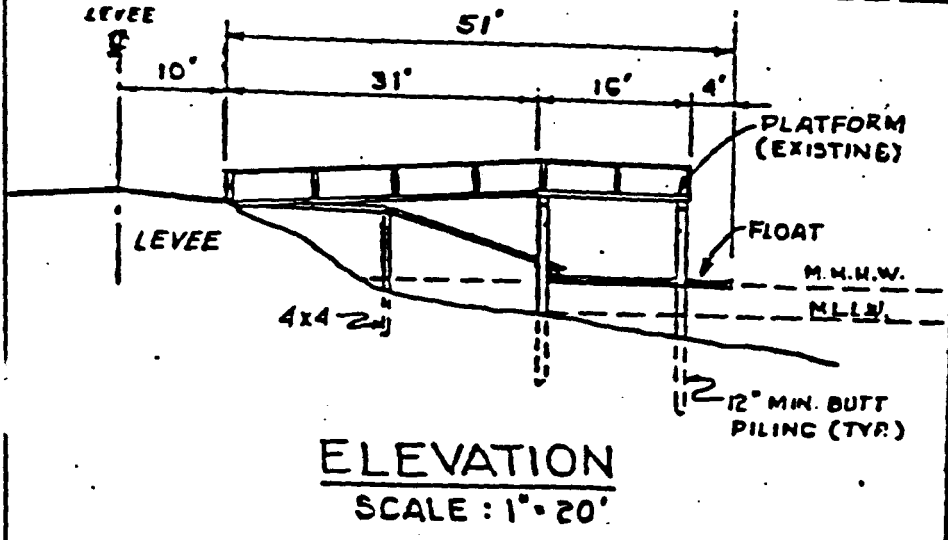
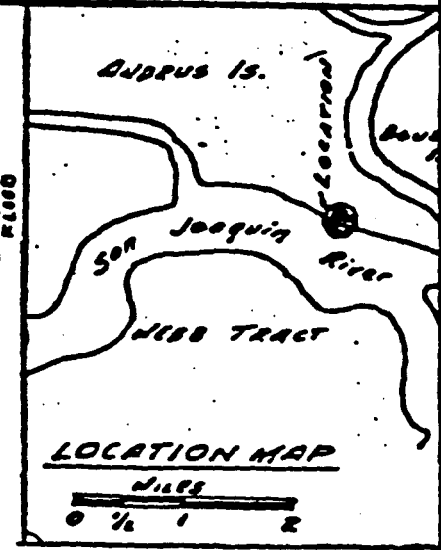
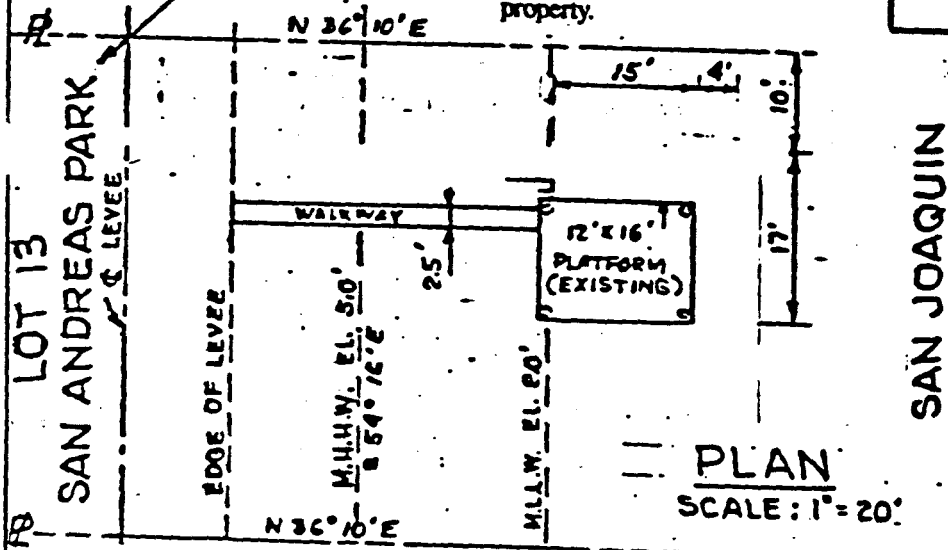
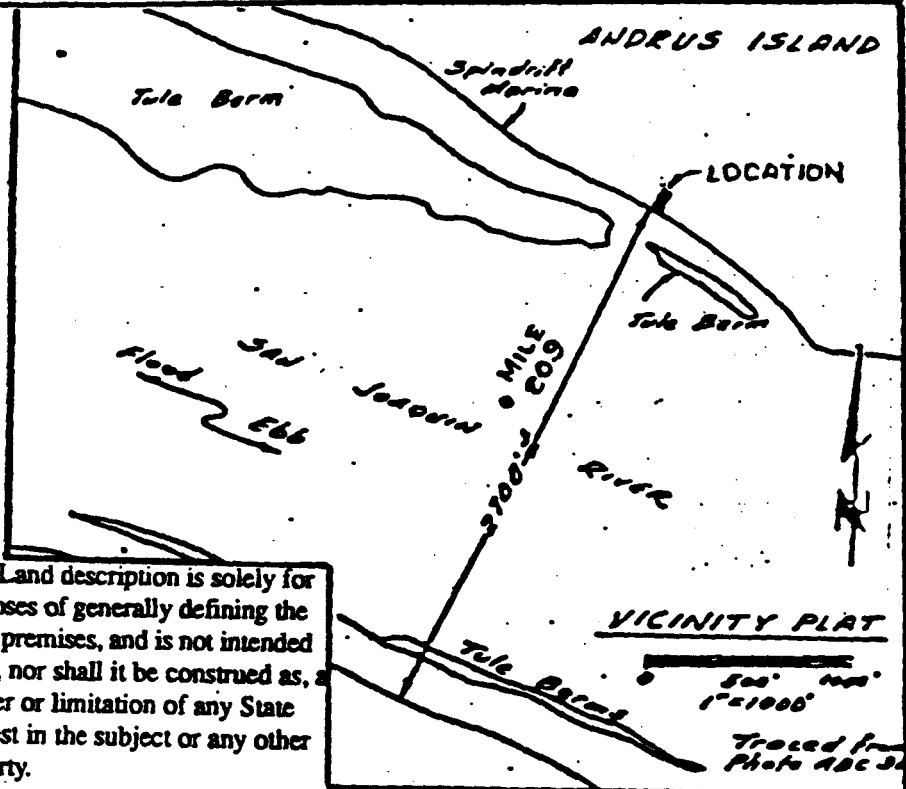

**PROPOSED FLOAT ADDITION  
TO EXISTING PLATFORM**

APPLICATION BY:  
Mickey and Norma Williams  
489 So. Genevieve Lane  
San Jose, CA 95128

LOCATION:  
LOT 13 SAN ANDREAS PARK  
ANDRUS ISLAND PAGE 44  
SACRAMENTO COUNTY, CA  
MINUTE PAGE 933  
EXHIBIT A  
WP 5105

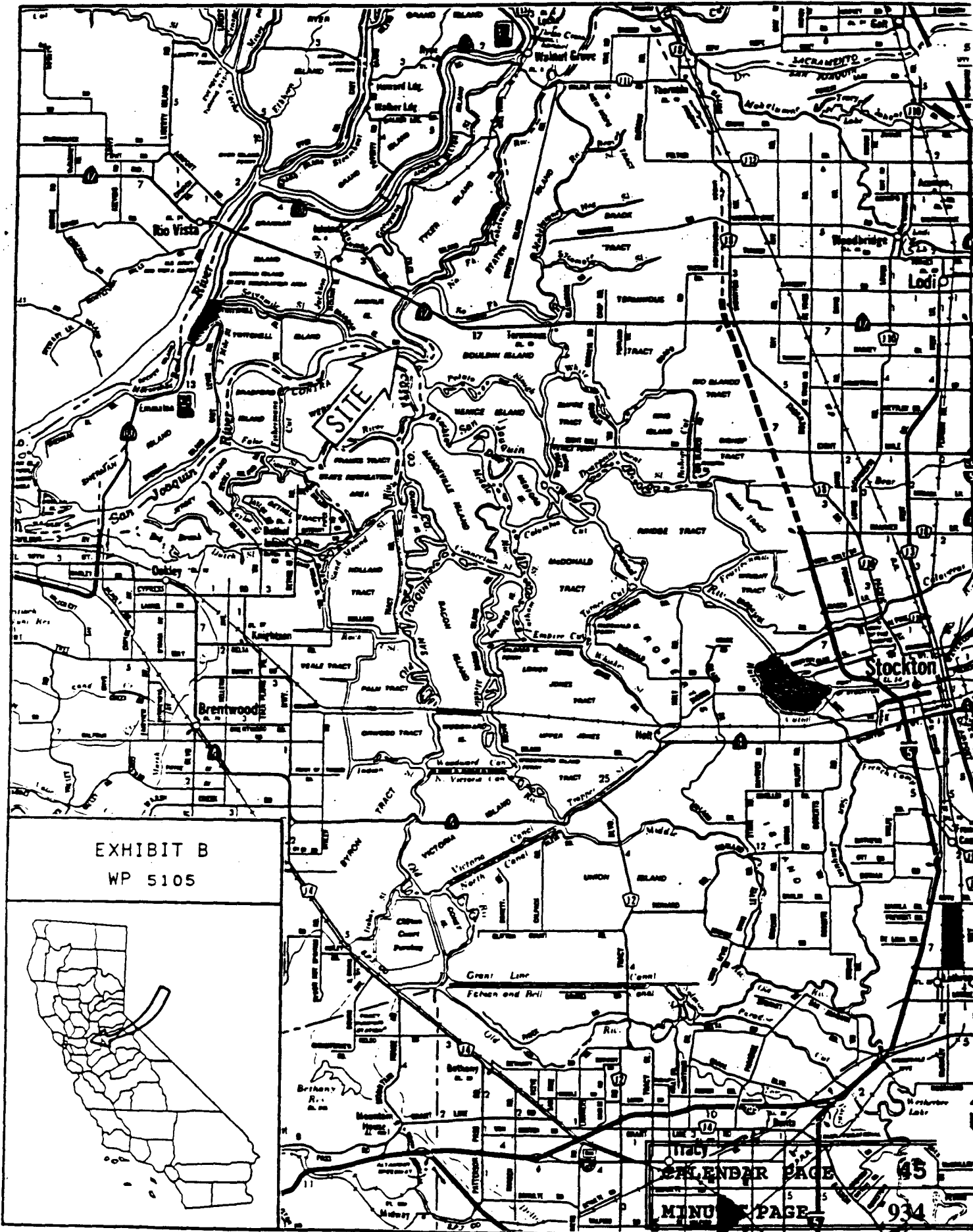

EXHIBIT B  
WP 5105



CALENDAR PAGE 45  
MINUTE PAGE 934