

CALENDAR ITEM

C02

MINUTE ITEM  
This Calendar Item No. C02  
was approved as Minute Item  
No. 02 by the State Lands  
Commission by a vote of 3  
to 0 at its 4/6/94  
meeting.

A 5  
S 4

04/06/94  
WP 6553  
Burks  
PRC 6553

RECREATIONAL PIER PERMIT

**PARTIES:** Louis and Marina Halasz  
7021 Garden Highway  
Sacramento, California 95837

**LOCATION:** Tide and submerged land located in the Sacramento  
River, portion of Lot 11, Sacramento River  
Subdivision, adjacent to Garden Highway (APN 201-  
0260-013), Sacramento County.

**EXHIBITS:** A. Site Map B. Location Map

**AB 884:** N/A

**CEQA**

**FINDING:** FIND THAT THE ACTIVITY IS EXEMPT FROM THE  
REQUIREMENT OF THE CEQA PURSUANT TO 14 CAL. CODE  
REGS. 15061 AS A CATEGORICALLY EXEMPT PROJECT,  
CLASS 1, 2 CAL. CODE REGS. 2905 (a) (2).

**SIGNIFICANT LANDS**

**INVENTORY**

**FINDING:** FIND THAT THIS ACTIVITY IS CONSISTENT WITH THE USE  
CLASSIFICATION DESIGNATED FOR THE LAND PURSUANT TO  
P.R.C. 6370, ET. SEQ.

**RECOMMENDED**

**ACTION:** IT IS RECOMMENDED THAT THE COMMISSION:

AUTHORIZE ISSUANCE TO LOUISE AND MARIAN HALASZ OF A  
10-YEAR RECREATIONAL PIER PERMIT, BEGINNING  
FEBRUARY 23, 1994; NO MONETARY CONSIDERATION  
PURSUANT TO SECTION 6503.5 OF THE P.R.C. FOR  
CONTINUED USE AND MAINTENANCE OF AN EXISTING 6 FT.  
X 24 FT. FLOATING DOCK WITH 16 FT. WALKWAY; ON THE  
LAND DESCRIBED ON EXHIBIT "A" ATTACHED AND BY  
REFERENCE MADE A PART HEREOF.

CALENDAR PAGE	4
MINUTE PAGE	893

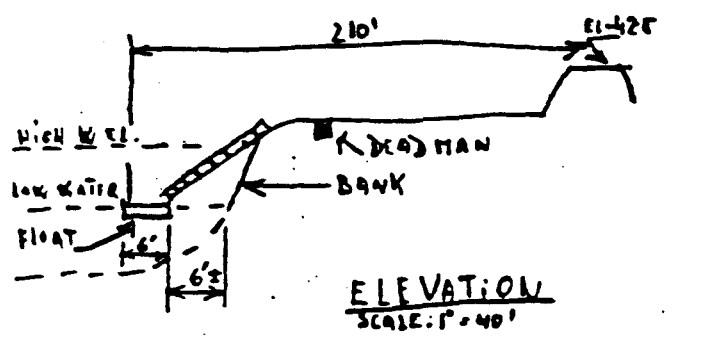
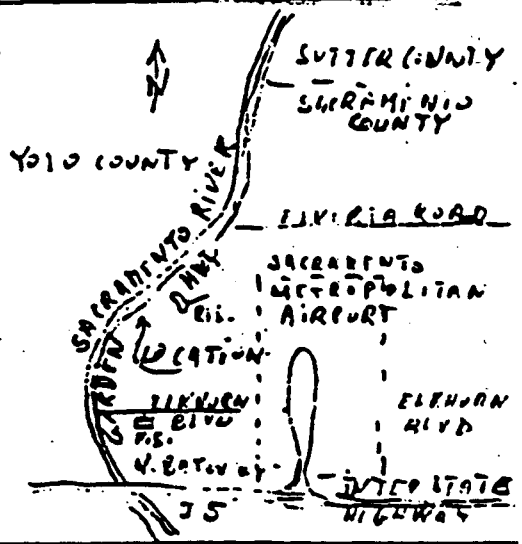
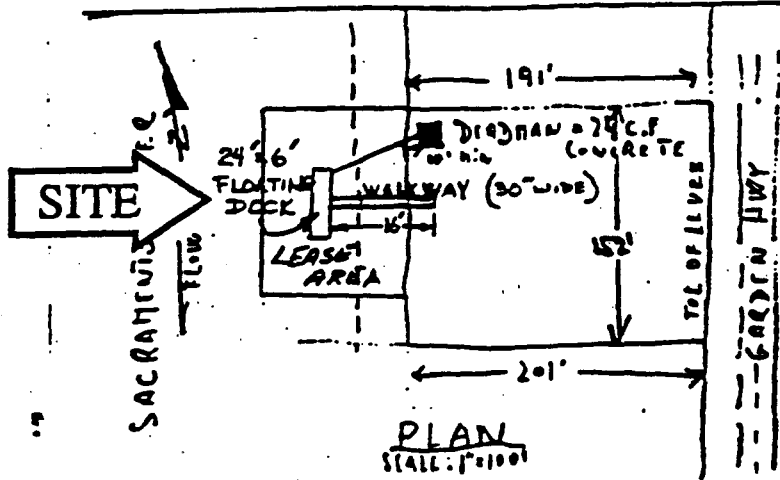

VICINITY MAP SCALE IN MILES

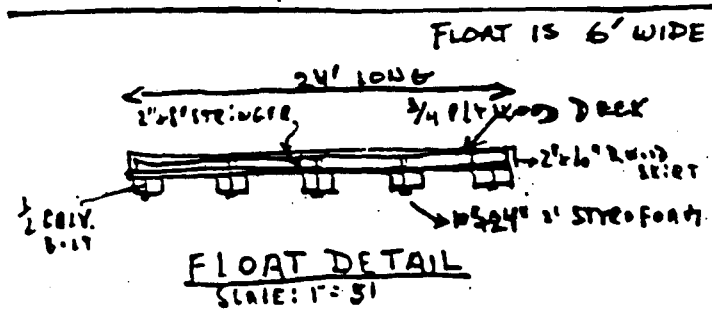
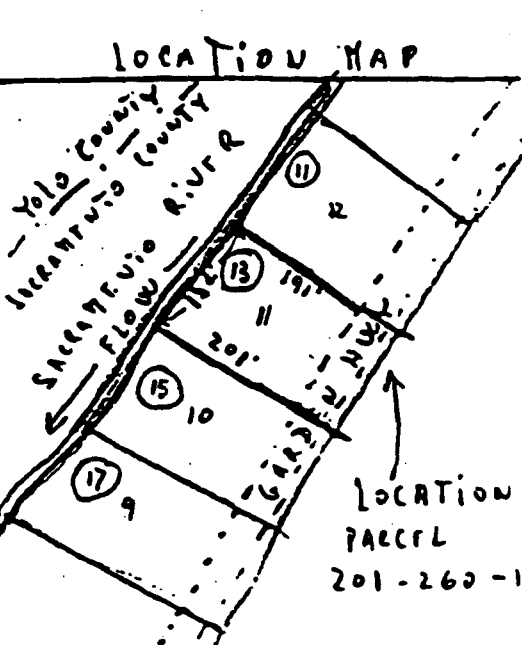

EXISTING BOAT DOCK

Area to be leased lies directly beneath dock and walkway, plus a necessary use area 10 feet in width around the entire dock and walkway. Excepting therefrom any portion lying above the ordinary high water mark.

LOCATION ACCESSOR'S PARCEL NO: 201-260-13 SAC.C.C.  
 APPLICATION BY: LOUIS HALASZ  
 7021 GARDEN HWY  
 SACRTO, CA 95837  
 DATE AUG. 30, 83. SHEET 1 OF  
 REV. SEPT. 2, 83

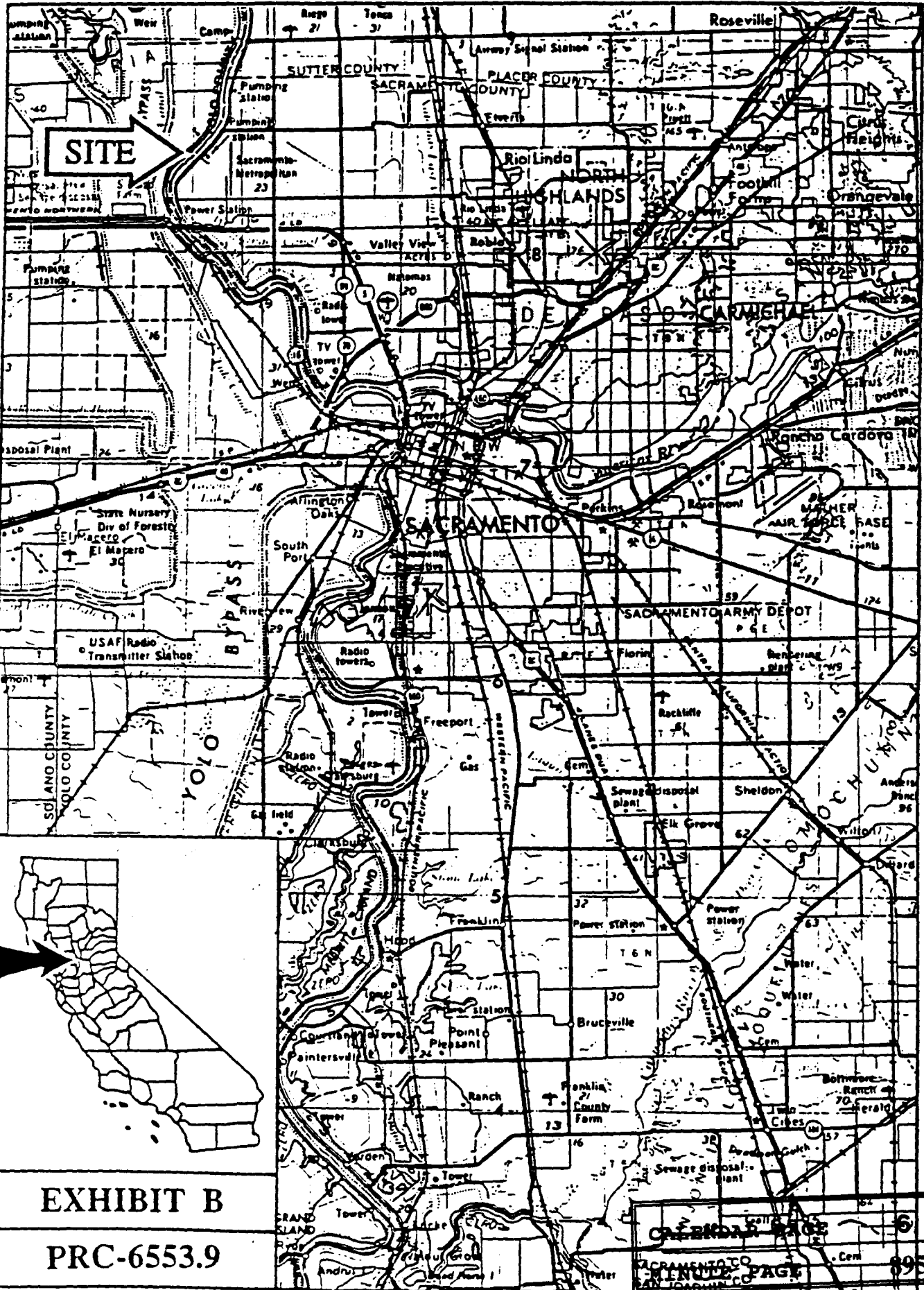

**EXHIBIT B**

**PRC-6553.9**

**CARIBDA PAGE**

**MINUTE PAGE**

**6**

**895**