

MINUTE ITEM
This Calendar Item No. C31
was approved as Minute Item
No. 31 by the State Lands
Commission by a vote of 3
to 0 at its 11-9-93
meeting.

ITEM NO.
C31

PRC 2829
N. Smith
11/09/93

AMENDED DESCRIPTION AND RENT FOR PRC 2829
GENERAL PERMIT-RECREATIONAL AND RESIDENTIAL USE

PARTIES: Dan D. Marsh
796 Vicente
Berkeley, California 94707

LOCATION: Tide and submerged land in Mare Island Straits, Sandy
Beach, City of Vallejo, Solano County.

EXHIBITS: A. Site Map B. Location Map

AB 884: N/A

RECOMMENDED

ACTION: IT IS RECOMMENDED THAT THE COMMISSION

CEQA

FINDING:

FIND THAT THE ACTIVITY IS EXEMPT FROM THE REQUIREMENTS OF
THE CEQA PURSUANT TO 14 CAL. CODE REGS. 15061 BECAUSE THE
ACTIVITY IS NOT A PROJECT AS DEFINED BY P.R.C. 21065 AND
14 CAL. CODE REGS. 15378.

**SIGNIFICANT LANDS
INVENTORY**

FINDING: FIND THAT THIS ACTIVITY IS CONSISTENT WITH THE USE
CLASSIFICATION DESIGNATED FOR THE LAND PURSUANT TO
P.R.C. 6370, ET SEQ.

AUTHORIZATION:

AUTHORIZE AMENDMENT OF GENERAL PERMIT-RECREATIONAL AND
RESIDENTIAL USE, LEASE PRC 2829 TO INCLUDE AN UPDATED
EXHIBIT "A"-SITE MAP AND TO AMEND THE RENT TO THE MINIMUM
\$100 FOR THIS TYPE OF PERMIT. MINOR STAIRCASE
ENCROACHMENT AUTHORIZED SOLELY BECAUSE STAFF WAS AWARE OF
ITS EXISTENCE FROM PROJECT DESIGN MAPS AT TIME OF EARLIER
LEASE AUTHORIZATION.

ALL OTHER TERMS AND CONDITIONS OF LEASE PRC 2829 TO
REMAIN IN EFFECT, INCLUDING REQUIREMENT THAT ALL
APPLICABLE PERMITS BE ACQUIRED INCLUDING A PERMIT FROM
THE SAN FRANCISCO BAY CONSERVATION AND DEVELOPMENT
COMMISSION.

CALENDAR PAGE 348

MINUTE PAGE

2577

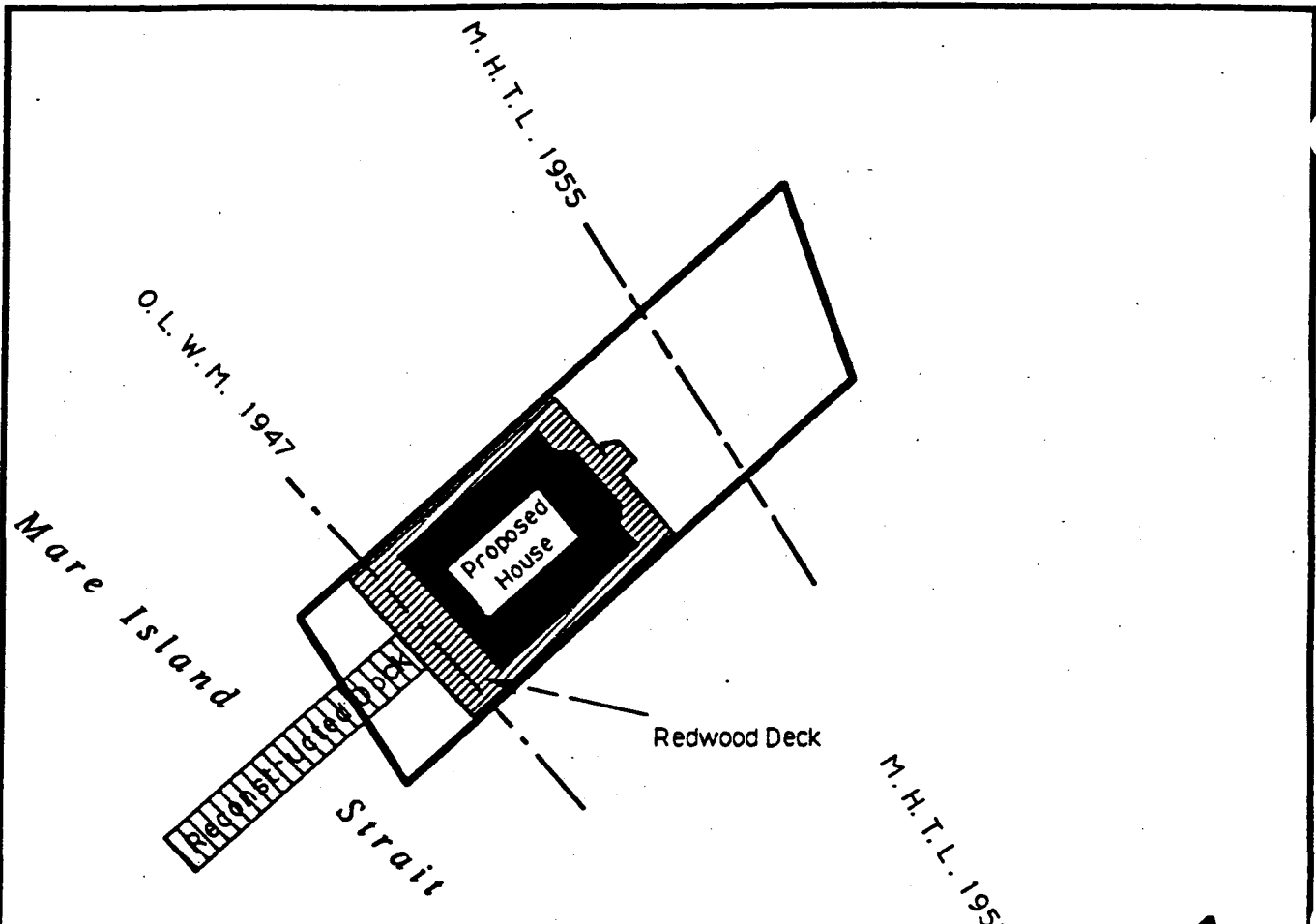
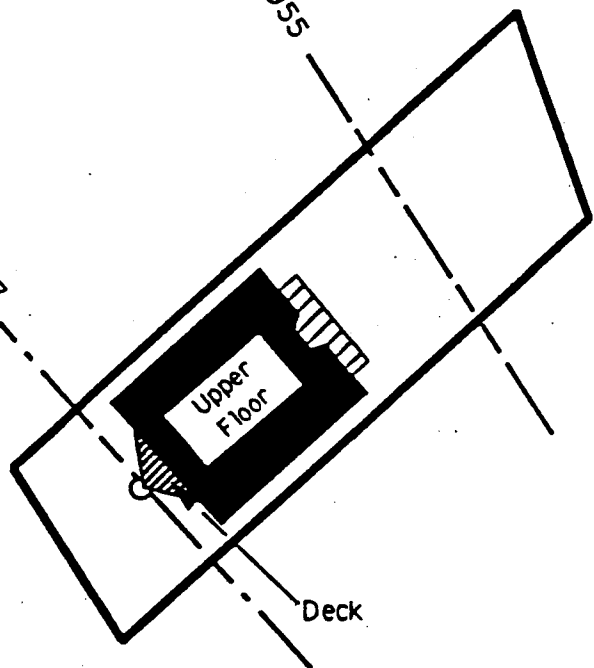

EXHIBIT "A"
 Site Map
 WP 2829
 Mare Island Strait
 SOLANO COUNTY



#2 Sandy Beach Road
 Vallejo, CA

NOTE:
 THIS EXHIBIT IS NOT A SURVEY, NOR
 DOES ANY LINE APPEARING HEREON
 REPRESENT A BOUNDARY LINE.

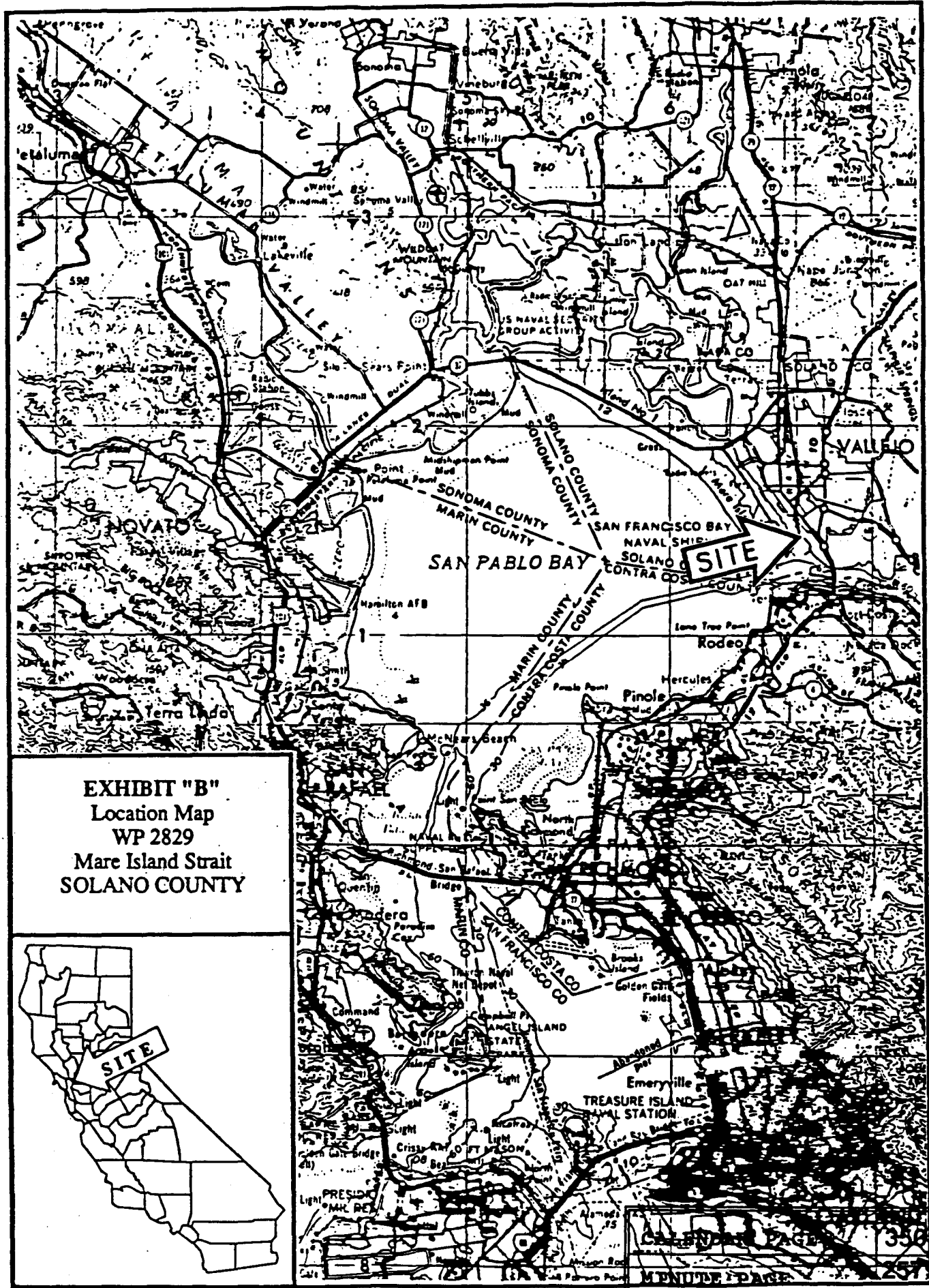

EXHIBIT "B"
Location Map
WP 2829
Mare Island Strait
SOLANO COUNTY



CALENDAR PAGE 356
MINUTE PAGE 257