

MINUTE ITEM
This Calendar Item No. C04
was approved as Minute Item
No. 04 by the State Lands
Commission by a vote of 3
0 at its 11-9-93
meetings 4

ITEM NO.
C04

WP 4762
Burks
11/09/93
PRC 4762

RECREATIONAL PIER PERMIT

PARTIES: Bertram and Jane Burrows
3641 Clay Street
San Francisco, California 94118

LOCATION: Tide and submerged land located in the Sacramento
River, portion of Parcel 1 of Long Island Tract
No. 1 (APN 142-150-09), Sacramento County

EXHIBITS: A. Site Map. B. Location Map.

AB 884: N/A.

CEQA

FINDING: FIND THAT THE ACTIVITY IS EXEMPT FROM THE
REQUIREMENTS OF THE CEQA PURSUANT TO 14 CAL. CODE
REGS. 15061 AS A CATEGORICALLY EXEMPT PROJECT,
CLASS 1, 2 CAL. CODE REGS. 2905(a)(2).

**SIGNIFICANT LANDS
INVENTORY**

FINDING: FIND THAT THIS ACTIVITY IS CONSISTENT WITH THE USE
CLASSIFICATION DESIGNATED FOR THE LAND PURSUANT TO
P.R.C. 6370, ET. SEQ.

**RECOMMENDED
ACTION:**

IT IS RECOMMENDED THAT THE COMMISSION:

AUTHORIZE ISSUANCE TO BERTRAM AND JANE BURROWS OF A
10-YEAR RECREATIONAL PIER PERMIT, BEGINNING MAY 31,
1993; NO MONETARY CONSIDERATION PURSUANT TO
SECTION 6503.5 OF THE P.R.C., FOR CONTINUED USE AND
MAINTENANCE OF A 4 FT. X 24 FT. FLOATING DOCK,
4 FT. X 8 FT. FLOATING DOCK AND A 2.5 FT. X
13.5 FT. GANGWAY; ON THE LAND DESCRIBED ON
EXHIBIT "A" ATTACHED AND BY REFERENCE MADE A PART
HEREOF.

CALENDAR PAGE	9
MINUTE PAGE	2176

This Land description is solely for purposes of generally defining the lease premises, and is not intended to be, nor shall it be construed as, a waiver or limitation of any State interest in the subject or any other property.

No. 4972

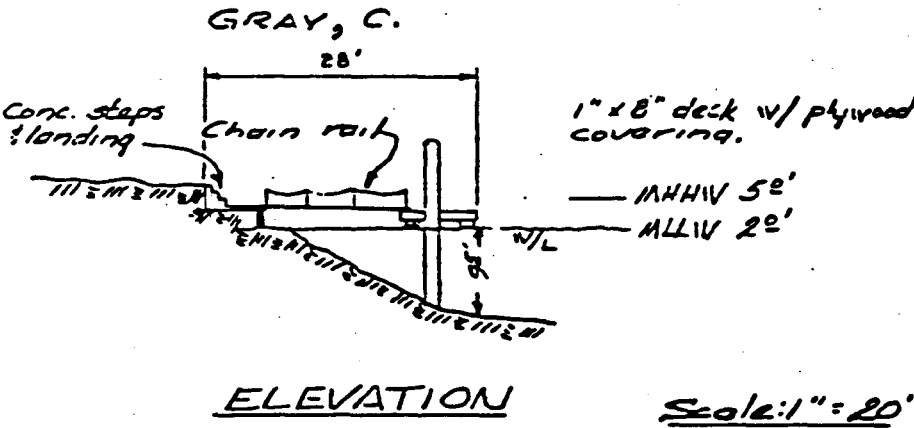
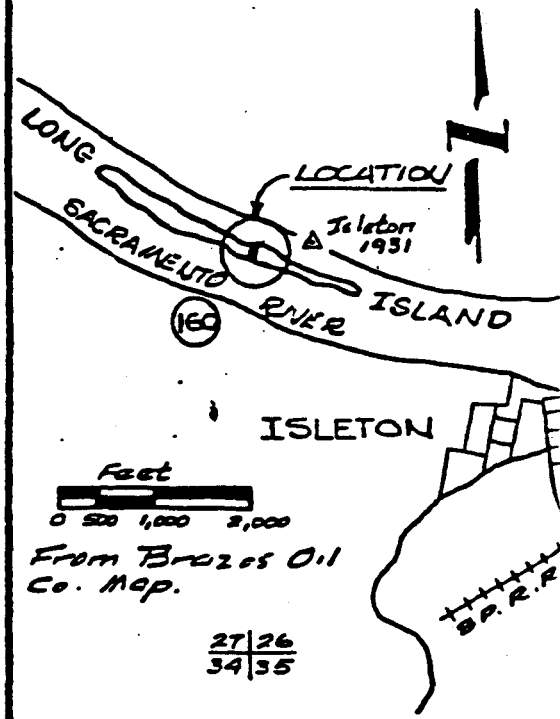
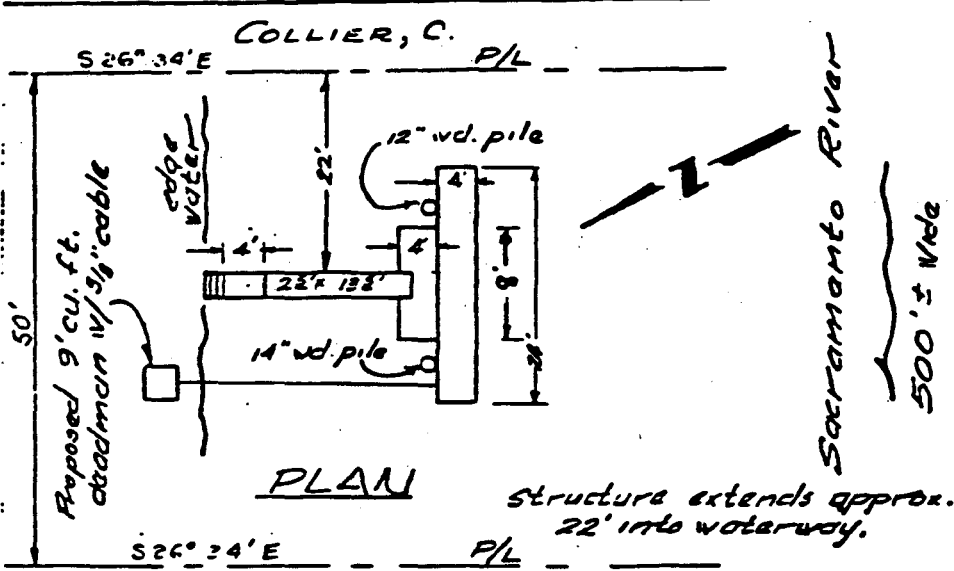

VICINITY MAP
Scale 1"=2000'

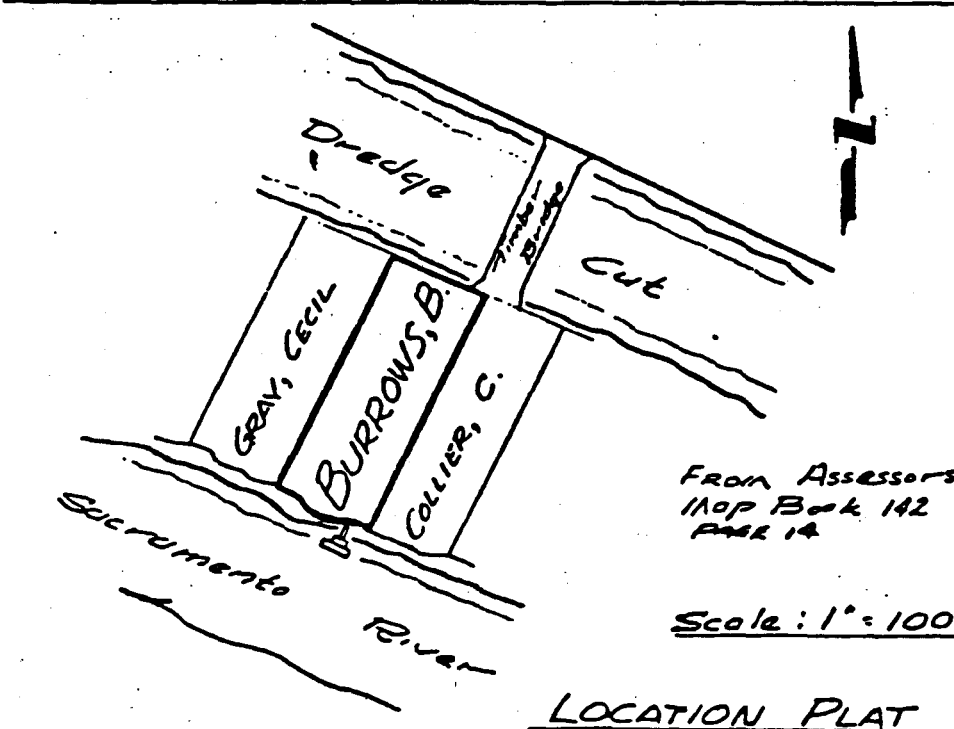

EXISTING FLOATING FISHING PIER

LONG ISLAND
SACRAMENTO COUNTY
CALIFORNIA
PARCEL NO. 142-150-0
BURROWS, BERTRAM
3641 CLAY ST.
SAN FRANCISCO, CALIF
94118
PH: 415-826-1470

CALENDAR PAGE EXHOB1
MINUTE PAGE W24772

JAN. 1971
Notarware & Assoc.
300 E. Van Ness Av. San Francisco, CA

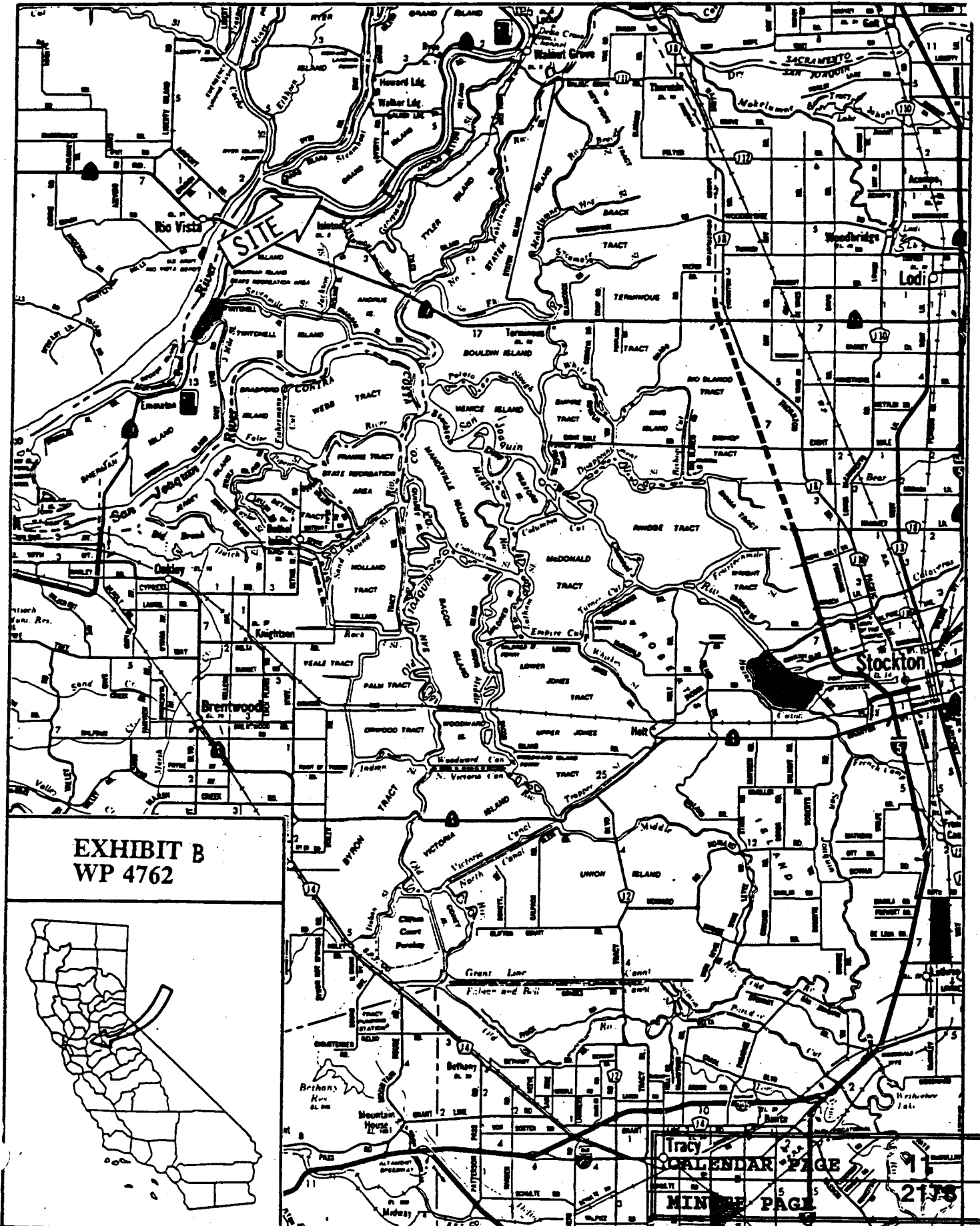

EXHIBIT B
WP 4762



Tracy
CALENDAR PAGE 9
MINUTE PAGE 2178

