

**MINUTE ITEM**

This Calendar Item No. C11  
was approved as Minute Item  
No. 11 by the State Lands  
Commission by a vote of 3  
0 0 at its 9-9-93  
meeting.

**CALENDAR ITEM**

**C11**

A 26  
S 12, 14

9/09/93  
W 23892  
W 24935  
Jones  
PRC 7710

**ISSUANCE OF A GENERAL LEASE - PUBLIC AGENCY USE**

**APPLICANT:**

California Department of Transportation  
Attn: Michael Rodrigues  
District 10  
P. O. Box 2048  
Stockton, California 95201-2048

**AREA, TYPE LAND AND LOCATION:**

An 0.11-acre parcel of submerged land in the Merced River,  
Merced County.

**LAND USE:**

Highway purposes pursuant to Section 101.5 of the Street and  
Highways Code, specifically for use and occupation of lands  
underlying Highway 99, Merced River crossing, City of  
Livingston, Merced County.

**LEASE TERMS:**

Indefinite period from date the permit is executed on behalf  
of the State Lands Commission.

**CONSIDERATION:**

As set forth by Section 101.5, Streets and Highways Code and  
the public use and benefit.

**BASIS FOR CONSIDERATION:**

Pursuant to 2 Cal. Code Regs. 2003.

**PREREQUISITE CONDITIONS, FEES AND EXPENSES:**

Processing costs have been received.

**STATUTORY AND OTHER REFERENCES:**

- A. P.R.C.: Div. 6, Parts 1 and 2; Div. 13.
- B. Cal. Code Regs.: Title 3, Div. 3; Title 14, Div. 6.
- C. Section 101.5 of the Streets and Highways Code.

CALENDAR PAGE	62
MINUTE PAGE	1903

CALENDAR ITEM NO. C11 (CONT'D)

**AB 884:**  
N/A.

**OTHER PERTINENT INFORMATION:**

1. CalTrans is proposing to widen the Highway 99 Bridge over the Merced River near the City of Livingston. When State highway projects involve State sovereign land, Section 101.5 of the Streets and Highways Code requires CalTrans to file a map with the Commission for such projects.
2. This activity involves lands identified as possessing significant environmental values pursuant to P.R.C. 6370, et seq. Based upon the staff's consultation with the persons nominating such lands and through the CEQA review process, it is the staff's opinion that the project, as proposed, is consistent with its use classification.
3. A Negative Declaration was prepared and adopted for this project by the Department of Transportation. The State Lands Commission's staff has reviewed such document.
4. A Mitigation Monitoring Plan was not adopted by the Department of Transportation.

**APPROVALS OBTAINED:**

U.S. Army Corps of Engineers, Central Valley Regional Water Quality Control Board.

**APPROVALS REQUIRED:**

State Department of Fish and Game Streambed Alteration Agreement, State Lands Commission, State Reclamation Board.

**EXHIBITS:**

- A. Streets and Highways Code Section 101.5 Map.

**IT IS RECOMMENDED THAT THE COMMISSION:**

1. FIND THAT A NEGATIVE DECLARATION WAS PREPARED AND ADOPTED FOR THIS PROJECT BY THE DEPARTMENT OF TRANSPORTATION AND THAT THE COMMISSION HAS REVIEWED AND CONSIDERED THE INFORMATION CONTAINED THEREIN.

CALENDAR ITEM NO. C11 (CONT'D)

2. FIND THAT THIS ACTIVITY IS CONSISTENT WITH THE USE CLASSIFICATION DESIGNATED FOR THE LAND PURSUANT TO P.R.C. 6370, ET SEQ.
3. APPROVE THE MAP FILED BY THE CALIFORNIA DEPARTMENT OF TRANSPORTATION PURSUANT TO SECTION 101.5 OF THE STREETS AND HIGHWAYS CODE, AS SHOWN ON EXHIBIT "A" ATTACHED AND BY REFERENCE MADE A PART HEREOF.
4. AUTHORIZE ISSUANCE TO THE CALIFORNIA DEPARTMENT OF TRANSPORTATION OF A GENERAL LEASE - PUBLIC AGENCY USE, FOR AN INDEFINITE PERIOD FROM THE DATE THE PERMIT IS EXECUTED ON BEHALF OF THE STATE LANDS COMMISSION FOR HIGHWAY PURPOSES ON THE LAND DESCRIBED ON EXHIBIT "A" ATTACHED AND BY REFERENCE MADE A PART HEREOF.

CALENDAR PAGE	62.2
MINUTE PAGE	1905

UNIT	DATE	NO.	BY	CHKD.
10	MER	99	REB/R317	1

# T.6S, R.11E., M.D.M.

## SECTION 22

### ENGINEER'S STATEMENT

This map was prepared by me or under my direction to describe an Application for State Lands made pursuant to Sections 1015 of the Streets and Highways Code.

*Robert H. Jones*  
 ROBERT H. JONES R/W Engineer  
 Professional Land Surveyor No. 5702

JOSEPH GALLO

1000-02-000

11-0-00

ROBIN AVE E

R-200'

0-10°42'30"

T-28760'

L-313.90'

DETAIL 'A'

NOT TO SCALE

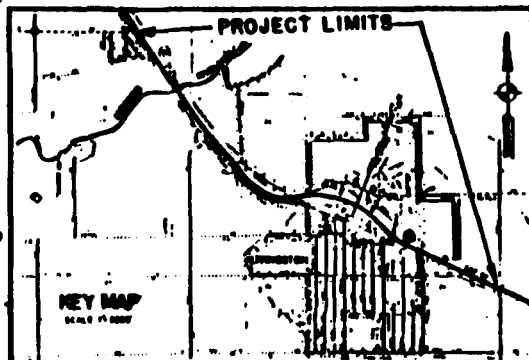
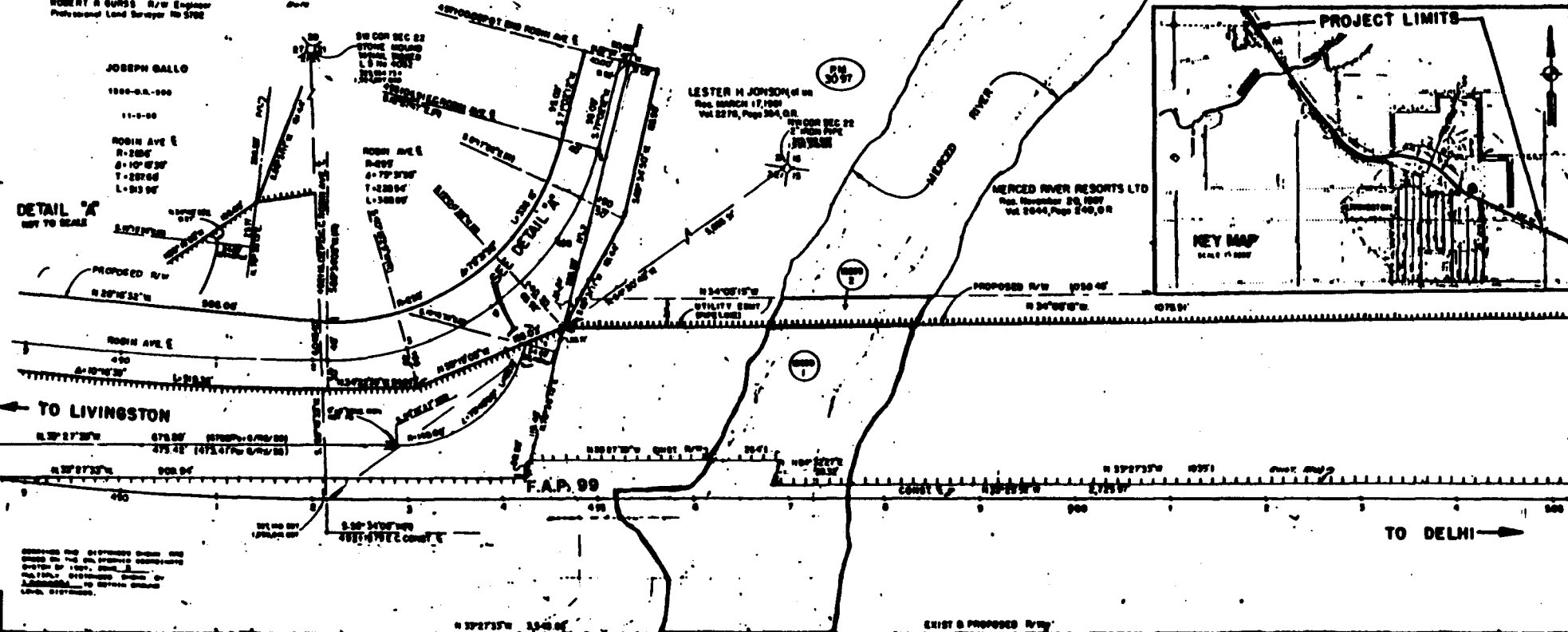

BEARING AND DISTANCE FROM THE CORNER OF THE SECTION TO THE POINT OF BEGINNING OF THE PROPOSED HIGHWAY RIGHT-OF-WAY.

See Record 4, 1971  
 Book 207, Page 174, 175

STATE OF CALIFORNIA  
 STATE LANDS COMMISSION

This map is hereby approved and filed for record with the Division of State Lands pursuant to the provisions of Section 1015 of the Streets and Highways Code. The Surveyor has under the jurisdiction of the State Lands Commission so they may be within the right of way here shown upon this map are hereby reserved for highway purposes.

APPROVED: Meeting of \_\_\_\_\_ 19\_\_\_\_  
 STATE LANDS COMMISSION

- PORTION REQUESTED THROUGH SOVEREIGN LANDS
- ||||| ACCESS RIGHTS RESERVED BY STATE
- ⊕ MONUMENTS FOUND
- CALCULATED POINT

# MERCED COUNTY

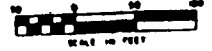

DEPARTMENT OF TRANSPORTATION  
 DISTRICT 10

NOT SHOWING SOVEREIGN LANDS OF THE STATE OF CALIFORNIA IN THE COUNTY OF MERCED, ACROSS THE MERCED RIVER NORTHWESTERLY OF LIVINGSTON, BEING AS A RIGHT OF WAY AND FOR THE PROTECTION OF STATE HIGHWAY ROUTE 10-102-10-020.6(R)1.7.

CALENDAR PAGE

62.3

1975.1

Hard Copy File No.

Approved Map File No.

SL-205