

MINUTE ITEM

This Calendar Item No. C06
was approved as Minute Item
No. 06 by the State Lands
Commission by a vote of 3
0 at its 9-9-93
meeting.

CALENDAR ITEM

C06

A 7
S 2

09/09/93
W 25017 PRC 7708
Burks

GENERAL LEASE - PUBLIC AGENCY USE

APPLICANT:

City of Napa
1600 First Street
Napa, California 94559

AREA, TYPE LAND AND LOCATION:

A 0.01-acre parcel of tide and submerged land in the Napa River located at John F. Kennedy Park, City of Napa, Napa County.

LAND USE:

Proposed placement of rock riprap (not to exceed 25 cubic yards) and a 48-inch water outfall (approximately 10 feet) with slide/flap gate to promote wildlife enhancement.

PROPOSED LEASE TERMS:

Lease period:
25 years beginning August 1, 1993.

CONSIDERATION:

The public use and benefit; with the State reserving the right at any time to set a monetary rental if the Commission finds such action to be in the State's best interest.

BASIS FOR CONSIDERATION:

Pursuant to 2 Cal. Code Regs. 2003.

APPLICANT STATUS:

Applicant is owner of upland.

PREREQUISITE CONDITIONS, FEES AND EXPENSES:

Filing fee and processing costs have been received.

CALENDAR PAGE	21
MINUTE PAGE	1861

CALENDAR ITEM NO. C06 (CONT'D)

STATUTORY AND OTHER REFERENCES:

- A. P.R.C.: Div. 6, Parts 1 and 2; Div. 13.
- B. Cal. Code Regs.: Title 3, Div. 3; Title 14, Div. 6.

AB 884:

N/A

OTHER PERTINENT INFORMATION:

1. This project involves enhancement and restoration of low lying wetlands adjacent to the Napa River at the John F. Kennedy Park, City of Napa. The City plans to install a 48-inch culvert between the marsh and the Napa River to manage the frequency and duration of ponding in the park wetlands. The existing river bank is faced with rock riprap and broken concrete. During the installation of the outfall the existing rock riprap will be removed and replaced.
2. The proposed project will be carried out using heavy equipment from the shore side of the river bank. Backhoe and excavators will be used from the land side of the bank to do all earth work.
3. This activity involves lands identified as possessing significant environmental values pursuant to P.R.C. 6370, et seq. Based upon the staff's consultation with the persons nominating such lands and through the CEQA review process, it is the staff's opinion that the project, as proposed, is consistent with its use classification.
4. A Negative Declaration was prepared and adopted for this project by the City of Napa (SCH 90030885). The State Lands Commission's staff has reviewed such document. The Negative Declaration included a five-year program to monitor on-site physical and biological changes as part of the enhancement process.

APPROVALS OBTAINED:

Regional Water Quality Control Board, U.S. Army Corps of Engineers, State Fish and Game.

FURTHER APPROVALS REQUIRED:

State Lands Commission.

CALENDAR PAGE	22
MINUTE PAGE	1862

CALENDAR ITEM NO. C06 (CONT'D)

EXHIBITS:

- A. Land Description
- B. Location Map

IT IS RECOMMENDED THAT THE COMMISSION:

1. FIND THAT A NEGATIVE DECLARATION WAS PREPARED AND ADOPTED FOR THIS PROJECT BY THE CITY OF NAPA AND THAT THE COMMISSION HAS REVIEWED AND CONSIDERED THE INFORMATION CONTAINED THEREIN.
2. FIND THAT THIS ACTIVITY IS CONSISTENT WITH THE USE CLASSIFICATION DESIGNATED FOR THE LAND PURSUANT TO P.R.C. 6370, ET SEQ.
3. AUTHORIZE ISSUANCE TO THE CITY OF NAPA OF A 25-YEAR GENERAL LEASE - PUBLIC AGENCY USE BEGINNING AUGUST 1, 1993; IN CONSIDERATION OF THE PUBLIC USE, FOR PROPOSED PLACEMENT OF ROCK RIPRAP AND A 48-INCH WATER OUTFALL ON THE LAND DESCRIBED ON EXHIBIT "A" ATTACHED AND BY REFERENCE MADE A PART HEREOF.

CALENDAR PAGE	23
MINUTE PAGE	1863

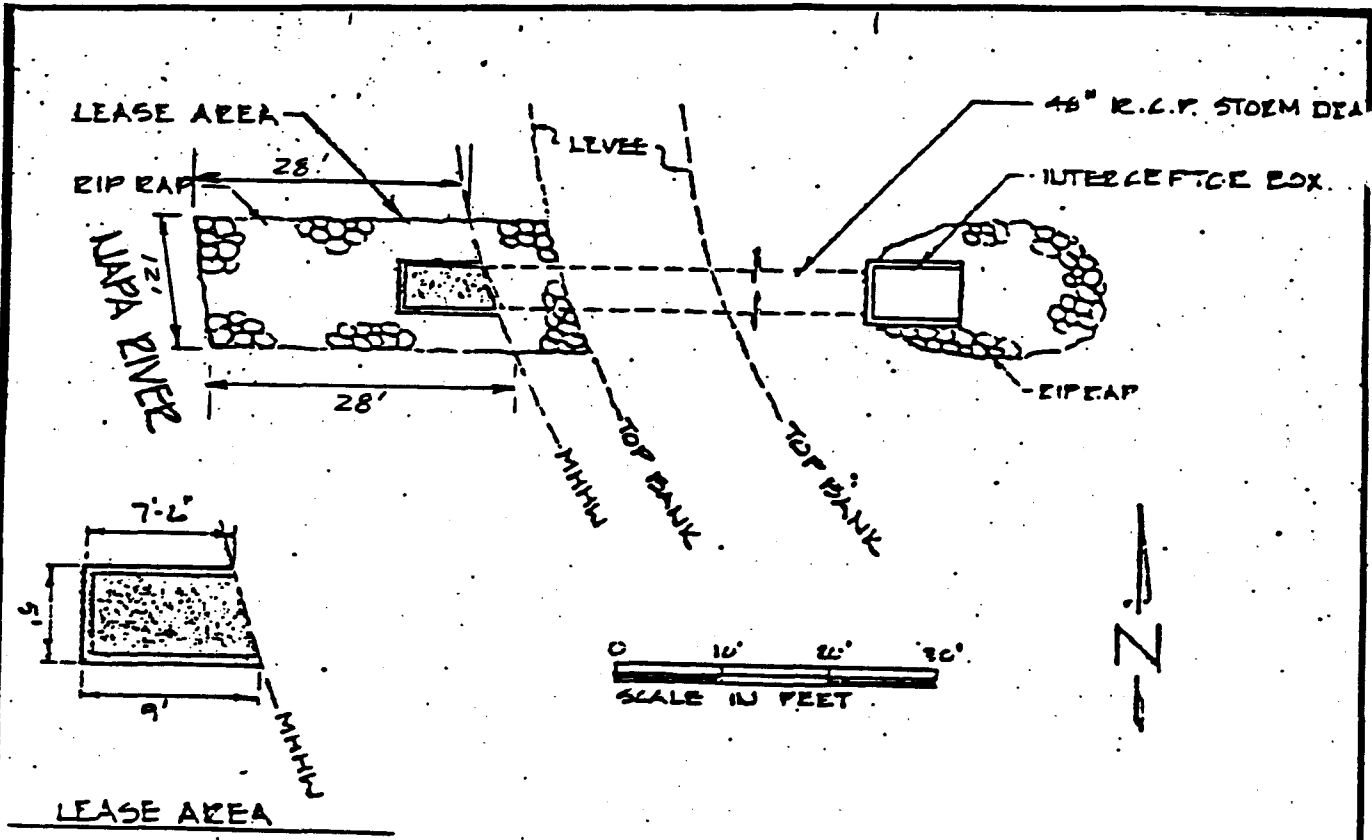

EXHIBIT "A"
 Land Description Exhibit
 W. 25017
 John F. Kennedy Park
 NAPA COUNTY



NOTE:
 THIS EXHIBIT IS NOT A SURVEY, NOR
 DOES ANY LINE APPEARING HEREIN
 REPRESENT A BOUNDARY LINE.

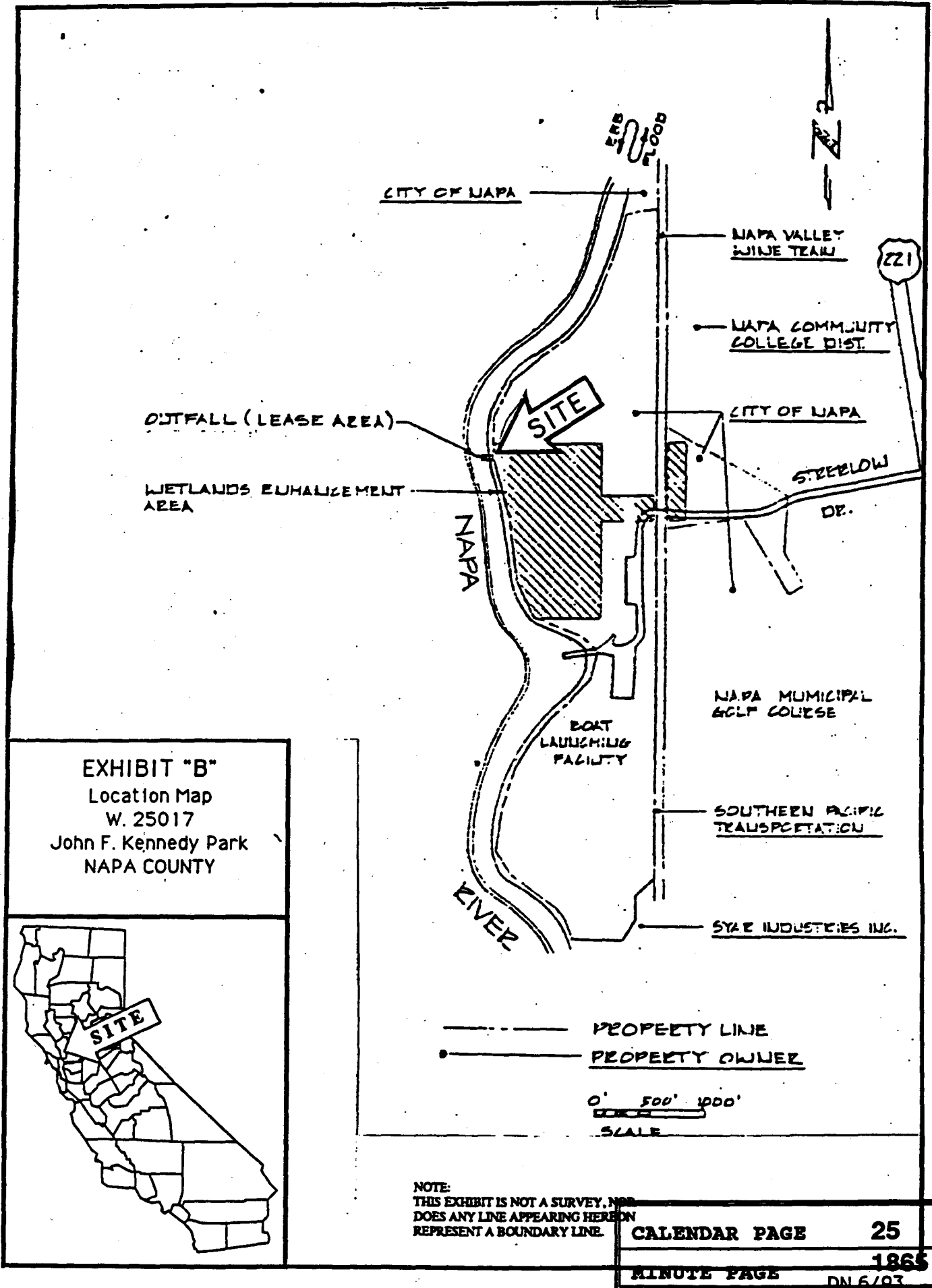

EXHIBIT "B"
 Location Map
 W. 25017
 John F. Kennedy Park
 NAPA COUNTY

