

MINUTE ITEM

This Calendar Item No. C29
was approved as Minute Item
No. 29 by the State Lands
Commission by a vote of 3
to 0 at its 7-19-93
meeting.

CALENDAR ITEM

C29

A 2
S 4

07/19/93
W 24207 PRC 7701
Young

APPROVAL OF A GENERAL LEASE - PUBLIC AGENCY USE

APPLICANT:

Shasta County Department of Public Works
1855 Placer Street
Redding, California 96001

AREA, TYPE LAND AND LOCATION:

An approximate 0.375-acre parcel of submerged land located
in the bed of the Fall River near Fall River Mills, Shasta
County.

LAND USE:

Removal and replacement of the Island Road Bridge.

PROPOSED LEASE TERMS:

Lease period:
Twenty years beginning July 1, 1993.

CONSIDERATION:

The public use and benefit; with the State reserving the
right at any time to set a monetary rental if the Commission
finds such action to be in the State's best interest.

BASIS FOR CONSIDERATION:

Pursuant to 2 Cal. Code Regs. 2003.

APPLICANT STATUS:

Applicant is owner of upland.

PREREQUISITE CONDITIONS, FEES AND EXPENSES:

Filing fees and processing fee have been received.

STATUTORY AND OTHER REFERENCES:

- A. P.R.C.: Div. 6, Parts 1 and 2; Div. 13.
- B. Cal. Code Regs.: Title 3, Div. 3; Title 14, Div. 6.

CALENDAR PAGE	280
MINUTE PAGE	1462

AB 884:

11/06/93

OTHER PERTINENT INFORMATION:

1. A Negative Declaration (SCH #92033028) was prepared and adopted for this project by Shasta County. The State Lands Commission's staff has reviewed such document.
2. A Mitigation Monitoring Plan was not adopted by Shasta County.
3. The bridge and its potential effects on navigability and other public trust uses of the Fall River was evaluated in the Draft and Final Initial Study/Negative Declaration prepared by the County. Several project alternatives were studied, including replacement at the existing height, and two alternatives of higher clearance. The selected alternative, Alternative 1, to replace the bridge at its current height, will allow existing public navigation to continue under the bridge. The selected alternative will also have the least impacts on the wild trout fishery, several special status aquatic species, and vegetation and wildlife generally.
4. This activity involves lands identified as possessing significant environmental values pursuant to P.R.C. 6370, et seq. Based upon the staff's consultation with the persons nominating such lands and through the CEQA review process, it is the staff's opinion that the project, as proposed, is consistent with its use classification.
5. The County of Shasta proposes to remove the existing Island Road Bridge on Island Road over the Fall River and construct a new two-lane bridge at the same location. The project site is located near Fall River Mills, northeast of Redding.

The purpose of the project is to provide a structure constructed of precast concrete and steel piles, wide enough for two 14-foot lanes, with approach roads extending up to 400 feet at both ends. The replacement bridge will meet the current American Association of State Highway and Transportation Officials standards.

CALENDAR ITEM NO. C29 (CONT'D)

APPROVALS OBTAINED:

California Department of Fish and Game, United States Army
Corps of Engineers, Shasta County, Regional Water Quality
Control Board.

FURTHER APPROVALS REQUIRED:

State Lands Commission.

EXHIBITS:

- A. Site Map
- B. Location Map
- C. Shasta County Negative Declaration and Notice of
Determination

IT IS RECOMMENDED THAT THE COMMISSION:

1. FIND THAT A NEGATIVE DECLARATION (SCH #92033028) WAS
PREPARED AND ADOPTED FOR THIS PROJECT BY THE COUNTY OF
SHASTA AND THAT THE COMMISSION HAS REVIEWED AND CONSIDERED
THE INFORMATION CONTAINED WITHIN.
2. AUTHORIZE ISSUANCE TO THE COUNTY OF SHASTA OF A 20-YEAR
GENERAL PERMIT - PUBLIC AGENCY USE EFFECTIVE JULY 1, 1993;
FOR THE REMOVAL AND REPLACEMENT OF THE ISLAND ROAD BRIDGE,
ON THE LAND DESCRIBED ON EXHIBIT "A" ATTACHED AND BY
REFERENCE MADE A PART HEREOF.

CALENDAR PAGE	280.2
MINUTE PAGE	1464



1" = 50'

BASIS OF BEARING
39 LS 78

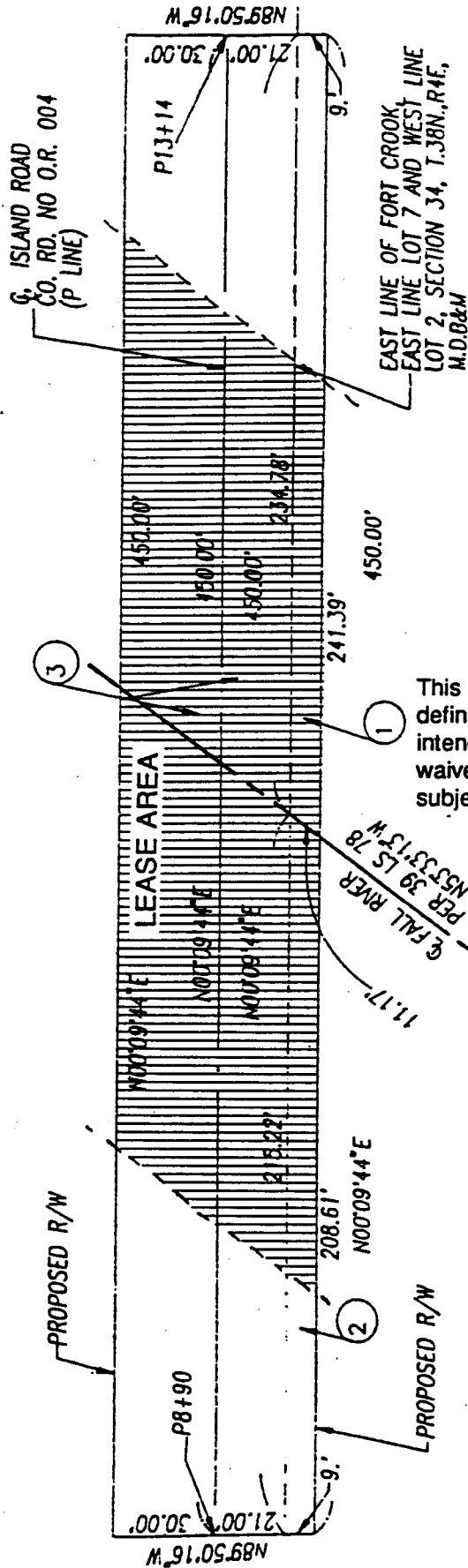

This Exhibit is solely for purposes of generally defining the lease premises, and is not intended to be, nor shall it be construed as, a waiver or limitation of any State interest in the subject or any other property.

EXHIBIT "A"
W 24207
Island Road Bridge
Fall River
SHASTA COUNTY



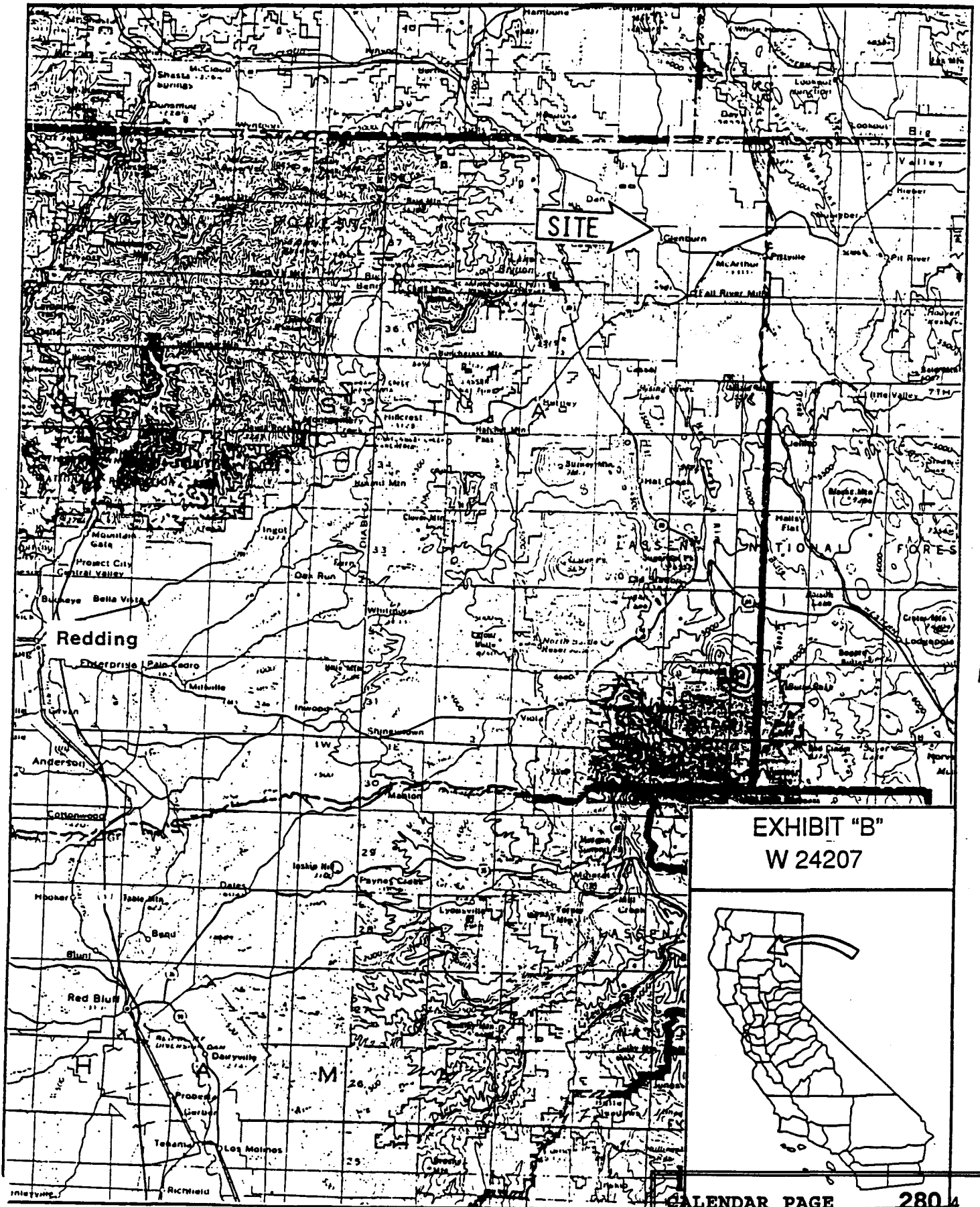

EXHIBIT "B"
W 24207



CALENDAR PAGE 2804

MINUTE PAGE 1466

Notice of Determination

Form C

To: Office of Planning and Research
1400 Tenth Street, Room 121
Sacramento, CA 95814

From: (Public Agency) Shasta Co. Department
1855 Placer Street
Redding, CA 96001
Public Works
(Address)

County Clerk
County of Shasta
P.O. Box 880
Redding, CA 96099

Subject:

Filing of Notice of Determination in compliance with Section 21108 or 21152 of the Public Resources Code.

Shasta County Island Road Bridge Replacement Project
Project Title

SCH #92033028 Ron Hill 916/225-5661
State Clearinghouse Number Lead Agency Area Code/Telephone/Extension
(If submitted to Clearinghouse) Contact Person

Island Road Bridge near Fall River Mills, Shasta County
Project Location (include county)

Project Description: Shasta County Department of Public Works and the Federal Highway Administration (FHWA) jointly propose to replace the Island Road bridge at the same height at the same location as the existing bridge. The existing bridge, a treated-timber structure with an overall length of 240 feet, was constructed in 1945 and is deteriorating and is substandard.

This is to advise that the Shasta County has approved the above described project on
[Lead Agency] [Responsible Agency]
and has made the following determinations regarding the above described project
(Date)

- 1. The project [] will [X] will not have a significant effect on the environment.
2. [] An Environmental Impact Report was prepared for this project pursuant to the provisions of CEQA.
[X] A Negative Declaration was prepared for this project pursuant to the provisions of CEQA.
3. Mitigation measures [X] were [] were not made a condition of the approval of the project.
4. A statement of Overriding Considerations [] was [X] was not adopted for this project.
5. Findings [] were [X] were not made pursuant to the provisions of CEQA.

Negative Declaration

This is to certify that the final EIR with comments and responses and record of project approval is available to the General Public at
Shasta County Department of Public Works, 1855 Placer Street, Redding, CA 96001

Signature (Public Agency) Date July 28, 1992 Title Dir. of Public Works

Date received for filing at OPR:

CALENDAR PAGE 280.5
MINUTE PAGE 1467
Revised October 1989

NEGATIVE DECLARATION

Pursuant to: Division 13, Public Resources Code

Description

Shasta County proposes to replace the Island Road bridge, located in Shasta County near Fall River Mills. The existing bridge, constructed in 1945, is a treated-timber structure that is 18.8 feet wide and has an overall length of 240 feet. The timber structure has deteriorated to the point that it needs to be replaced, and federal bridge replacement funds have been dedicated by the California Department of Transportation (Caltrans) and Federal Highway Administration (FHWA).

The replacement bridge would be meet current American Association of State Highway and Transportation Officials standards, would be constructed of precast concrete and steel piles, and would be the same height as the existing bridge. The bridge would have a clear width between rails of 28 feet, with 22 feet allocated to two 11-foot lanes and 6 feet allowed for 3-foot shoulders on each side. Approach roads would also be 28 feet wide and would extend up to 400 feet north and south of the bridge.

Determination

An initial study/environmental assessment (IS/EA) has been prepared by Shasta County, Caltrans and FHWA. On the basis of the draft and final IS/EA, it is determined that the proposed action, as mitigated, will not have a significant adverse effect on the environment. The following required mitigation measures are included in the project to avoid any potential significant effects:

- Implement strict erosion control practices during and after construction and comply with Central Valley Regional Water Quality Control Board monitoring and reporting provisions.
- Meet all American National Standards Institute and American Association of State Highway and Transportation Officials standard seismic construction and design code requirements.
- Prepare a spill prevention and containment plan.

CALENDAR PAGE	280.6
MINUTE PAGE	1468

- Construct a retaining wall to support the road edges and replace or enhance a nearby marginal wetland in conformance with U.S. Army Corps of Engineers General Permit 002 and in consultation with the California Department of Fish and Game (DFG) to compensate for the loss of 0.01 acre of wetland habitat.
- Avoid use of meadow or riparian scrub for staging areas, fence meadow or riparian scrub areas to avoid incidental impacts, and temporarily fence staging areas in pasture and rehabilitate and restore affected areas.
- Remove all cliff and barn swallow nests before they are active and maintain nest removal efforts throughout the nesting season.
- Restrict instream construction activities to summer (July through September).
- Survey project area for Shasta crayfish, provide survey report to the U.S. Fish and Wildlife Service (USFWS) and DFG, and develop a mitigation plan before construction in coordination with and with concurrence from USFWS and DFG.
- Limit construction activities to between 7:00 a.m. and 7:00 p.m., limit use of impact equipment to between 9:00 a.m. and 5:00 p.m., and ensure that all construction equipment engines are properly maintained and muffled.
- Implement dust control measures.
- If cultural resources are encountered during construction, permitted encroachment work, or maintenance, stop work in the area until the resources can be evaluated by a qualified archeologist.

A mitigation monitoring plan is included in Chapter 3 of the final IS/EA.

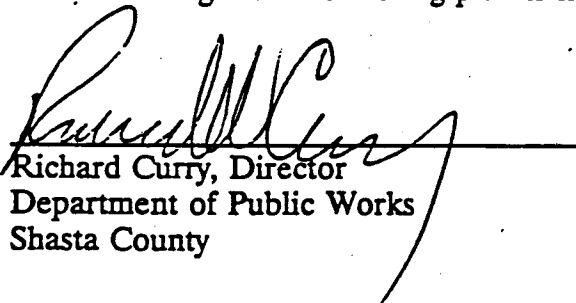
 Richard Curry, Director
 Department of Public Works
 Shasta County

July 28, 1992
 Date

CALENDAR PAGE	280.7
MINUTE PAGE	1469