

**MINUTE ITEM**

This Calendar Item No. C28  
was approved as Minute Item  
No. 28 by the State Lands  
Commission by a vote of 3  
to 0 at its 7-19-93  
meeting.

**CALENDAR ITEM**

**C28**

A 8  
S 4, 5

07/19/93  
WP 6177  
FONG

**TERMINATION OF GENERAL PERMIT - RECREATIONAL USE &  
ISSUANCE OF A RECREATIONAL PIER PERMIT**

**APPLICANT:**

C.L. Malinowski and Etta L. Malinowski  
747 Warford Ave.  
Vallejo, CA 94591

**AREA, TYPE LAND AND LOCATION:**

0.28 acres of tide and submerged land in the Sacramento  
River at Long Island, located near Isleton, Sacramento  
County.

**LAND USE:**

Continued use and maintenance of an existing floating dock  
and gangway.

**CURRENT LEASE TERMS:**

Lease period:  
Ten years beginning August 1, 1982.

Surety bond:  
\$1,000.

Public liability insurance:  
Combined single limit coverage of \$100,000.

Consideration:  
\$220 per annum; five-year rent review.

Special:  
Lessee granted the right to dredge within the leased  
premises described within Parcel 2 subject to certain  
conditions.

**TERMS OF PROPOSED PERMIT:**

Initial period:  
Ten years beginning August 1, 1990.

CALENDAR PAGE	275
MINUTE PAGE	1457

CALENDAR ITEM NO. C28 (CONT'D)

**CONSIDERATION:**

In accordance with the provisions of Section 6503.5 of Division 6 of the Public Resources Code.

**BASIS FOR CONSIDERATION:**

Pursuant to 2 Cal. Code Regs. 2003.

**APPLICANT STATUS:**

Applicant is owner of upland.

**PREREQUISITE CONDITIONS, FEES AND EXPENSES:**

Filing fee and processing expense deposit have been received.

**STATUTORY AND OTHER REFERENCES:**

A. P.R.C.: Div. 6, Parts 1 and 2; Div. 13.

B. Cal. Code Regs.: Title 3, Div. 3; Title 14, Div. 6.

**AB 884:**

N/A.

**OTHER PERTINENT INFORMATION:**

1. This activity involves lands identified as possessing significant environmental values pursuant to P.R.C. 6370, et seq. Based upon the staff's consultation with the persons nominating such lands and through the CEQA review process, it is the staff's opinion that the project, as proposed, is consistent with its use classification.
2. Pursuant to the Commission's delegation of authority and the State CEQA Guidelines (14 Cal. Code Regs. 15061), the staff has determined that this activity is exempt from the requirements of the CEQA as a categorically exempt project. The project is exempt under Class 1, Existing Facilities, 2 Cal. Code Regs. 2905(a)(2).

Authority: P.R.C. 21084, 14 Cal. Code Regs. 15300, and 2 Cal. Code Regs. 2905.

CALENDAR PAGE	276
MINUTE PAGE	1458

CALENDAR ITEM NO. C28 (CONT'D)

3. A General Permit - Recreational Use lease (GP-Rec Use) was issued to the Malinowskis pursuant to Commission action of September 29, 1981 for the use of two sovereign lands parcels. Parcel 1, filled tidelands located on the tip of Long Island is land locked and was used by the Malinowskis for "recreational uses". Parcel 2 is located in the Sacramento River and is occupied by the Malinowskis' existing floating dock and gangways. Parcels 1 and 2 are described and depicted on Exhibit "A".

In 1985, the Malinowskis constructed a single family dwelling on their upland parcel which abuts and is landward of Parcels 1 and 2, thereby making the Malinowskis eligible for a rent free Recreational Pier Permit (RPP) for the docking facilities they maintain on Parcel 2. Mr. Malinowski made a written request on February 7, 1989 to convert his lease into RPP status. Because the Malinowskis' use of Parcel 1 would not qualify for RPP status, Mr. Malinowski asked to purchase Parcel 1. Staff reviewed his request and determined that it would not be possible to make findings necessary to convey Parcel 1. It was subsequently agreed that Parcel 1 would be deleted from the lease. Mr. Malinowski has ceased the use of Parcel 1 of lease PRC 6177 and has removed all improvements from the parcel. Staff has determined that the Malinowskis' use of Parcel 2 will now qualify for the rent free RPP. Mr. Malinowski has submitted an application requesting conversion of his GP (Rec. Use) to an RPP. Staff recommends that Mr. Malinowski's GP-Rec Use Lease for Parcels 1 and 2 be terminated effective July 31, 1990, and that a RPP for a term of ten years be issued for Parcel 2 only, effective August 1, 1990.

**APPROVALS OBTAINED:**

N/A.

**FURTHER APPROVALS REQUIRED:**

State Lands Commission.

**EXHIBIT:**

- A. Land Description and Location Map

CALENDAR PAGE	277
MINUTE PAGE	1459

CALENDAR ITEM NO. C28 (CONT'D)

**IT IS RECOMMENDED THAT THE COMMISSION:**

1. FIND THAT THE ACTIVITY IS EXEMPT FROM THE REQUIREMENTS OF THE CEQA PURSUANT TO 14 CAL. CODE REGS. 15061 AS A CATEGORICALLY EXEMPT PROJECT, CLASS 1, EXISTING FACILITIES, 2 CAL. CODE REGS. 2905(A)(2).
2. FIND THAT THIS ACTIVITY IS CONSISTENT WITH THE USE CLASSIFICATION DESIGNATED FOR THE LAND PURSUANT TO P.R.C. 6370, ET SEQ.
3. AUTHORIZE THE TERMINATION OF A GENERAL PERMIT - RECREATIONAL USE, LEASE NUMBER PRC 6177, EFFECTIVE JULY 31, 1990 AND THE ISSUANCE TO C.L. MALINOWSKI AND ETTA L. MALINOWSKI OF A TEN-YEAR RECREATIONAL PIER PERMIT BEGINNING AUGUST 1, 1990; IN ACCORDANCE WITH THE PROVISIONS OF SECTION 6503.5 OF DIVISION 6 OF THE P.R.C., SUBSTANTIALLY IN THE FORM ON FILE IN THE OFFICES OF THE COMMISSION.

CALENDAR PAGE	278
MINUTE PAGE	1460

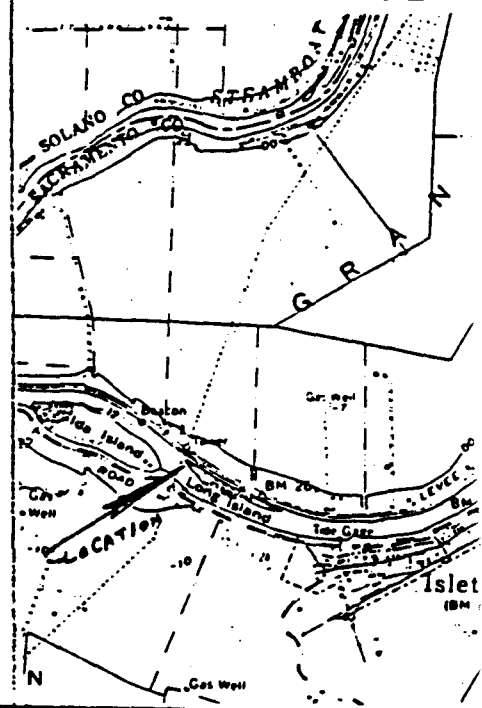

VICINITY MAP

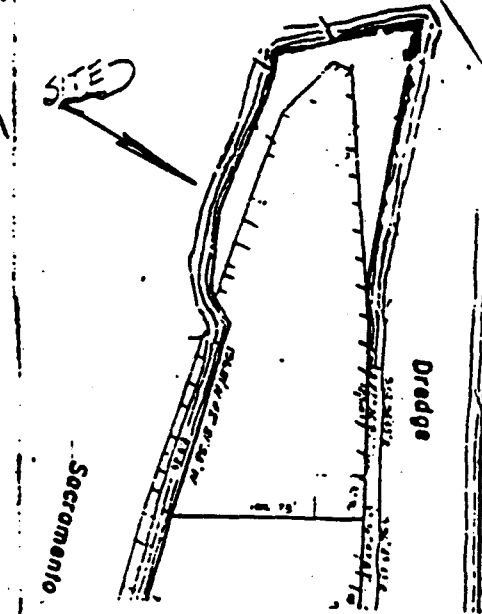

SITE MAP

EXISTING FACILITIES ON LONG ISLAND OWNER:

CASIMER MALINOWSKI  
 747 Warford Avenue  
 Vallejo, CA 94592

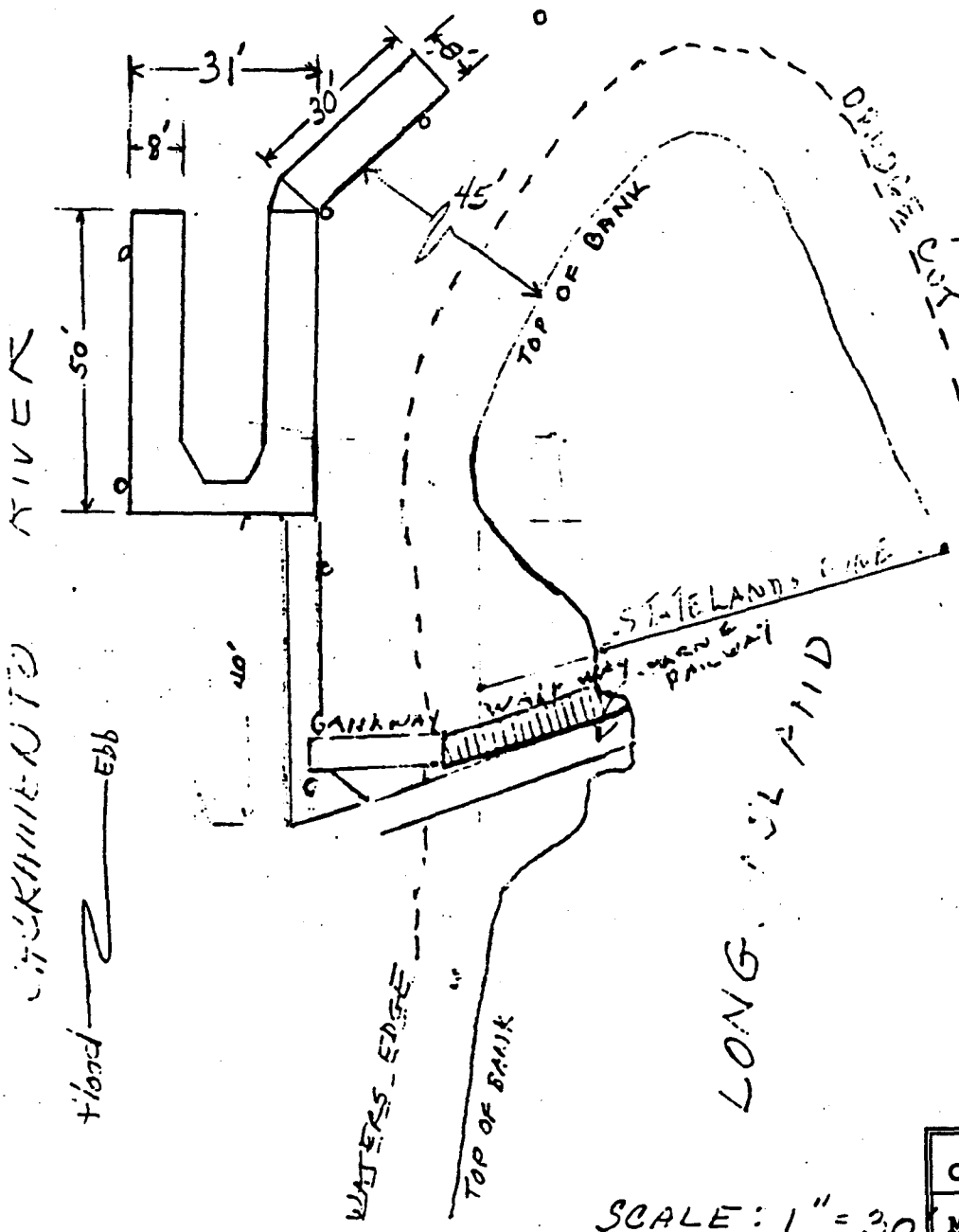

SACRAMENTO RIVER

flood - Ebb

SCALE: 1" = 30'

CALENDAR PAGE	279
MINUTE PAGE	1461
SACRAMENTO COUNTY	
PCL NO. 142-140-0	