

MINUTE ITEM
This Calendar Item No. C02
was approved as Minute Item
No. 02 by the State Lands
Commission by a vote of 2-
to 0 at its 6-21-93
meeting.

CALENDAR ITEM

C02

A 80

S 37

06/21/93
W 2400.188
Fossum

CONSIDERATION OF BOUNDARIES
FOR ANNEXATION NO. 43 AND PROPOSAL TO ANNEX
SOVEREIGN PUBLIC TRUST (SUBMERGED) LANDS
INTO THE CITY OF BLYTHE, RIVERSIDE COUNTY

APPLICANT:

Riverside County LAFCO
3403 Tenth St., Suite 620
Riverside, California 92501-3676

BACKGROUND:

The State Lands Commission has received a request from the Executive Officer of the Riverside County Local Agency Formation Commission, on behalf of the City of Blythe, to approve the proposed boundaries and consent to the annexation of certain lands (Annexation No. 43 - LAFCO No. 93-12-4) to the City of Blythe as required by Government Code Section 56108.

Pursuant to Government Code Section 56108(c) and (d), whenever State-owned submerged lands are included within a proposed annexation, the Commission is required to review and approve or deny the proposed annexation boundaries as appropriate and correct. The Commission must act within 45 days following receipt of the request for approval by the project proponent.

The area proposed for annexation includes both existing submerged lands underlying portions of the Colorado River and historic submerged lands within the former natural bed of the Colorado River. The states of California and Arizona hold title to their respective halves of certain portions of the bed of the last natural locations of the Colorado River. The Commission's approval of the proposed annexation boundaries and/or consent to annexation as a property owner does not constitute or imply approval of the inclusion of state property in any development regarding those lands. Settlement of respective property interests with adjacent property owners is a necessary precursor to development of lands within this area.

CALENDAR PAGE	7
MINUTE PAGE	1001

CALENDAR ITEM NO. C02 (CONT'D)

The Commission retains jurisdiction over these lands pursuant to Public Resources Code § 6301. If approved, this calendar item would merely constitute the state's consent to the change of local police power jurisdiction from the County of Riverside to the City of Blythe. The Commission's jurisdiction and ownership within proposed Annexation No. 43 includes interests in Sections 1 and 2, Township 7 South, Range 23 East, SBB&M.

The staff of the Commission has reviewed the proposed annexation boundary description and finds it adequate pursuant to California Government Code Section 56108(c) and (d).

Furthermore, staff of the Commission has no objection to transfer of political jurisdiction from the County to the City and recommends the Commission consent to the annexation, as property owner, pursuant to California Government Code Section 56108(a).

STATUTORY AND OTHER REFERENCES:

A. P.R.C.: Div. 6, Parts 1 and 2; Div. 13.

B. Cal. Code Regs.: Title 2, Div. 3; Title 14, Div. 6.

AB 884:

N/A

EXHIBITS:

- A. Land Description.
- B. Location Map.
- C. Site Map

IT IS RECOMMENDED THAT THE COMMISSION:

1. FIND THAT THE ACTIVITY IS EXEMPT FROM THE REQUIREMENTS OF THE CEQA PURSUANT TO 14 CAL. CODE REGS. 15061 BECAUSE THE ACTIVITY IS NOT A PROJECT AS DEFINED BY P.R.C. § 21065 AND 14 CAL. CODE REGS. 15378.
2. APPROVE THE PROPOSED BOUNDARIES FOR ANNEXATION NO. 43 TO THE CITY OF BLYTHE, RIVERSIDE COUNTY, AS DESCRIBED IN EXHIBIT "A" ATTACHED HERETO, AND BY THIS REFERENCE MADE A PART HEREOF, PURSUANT TO CALIFORNIA GOVERNMENT CODE SECTION 56108(c) AND (d). SUCH APPROVAL SHALL BE VALID FOR A PERIOD OF 24 MONTHS DURING WHICH TIME THE PROPOSED ANNEXATION MUST BECOME FINAL.

CALENDAR PAGE	8
MINUTE PAGE	1002

CALENDAR ITEM NO. C02 (CONT'D)

3. CONSENT, AS THE LANDOWNER, TO THE PROPOSED ANNEXATION OF SUBMERGED LANDS UNDER THE EXCLUSIVE JURISDICTION OF THE STATE LANDS COMMISSION (P.R.C § 6301) WITHIN BOTH THE PRESENT AND FORMER NATURAL BED OF THE COLORADO RIVER WITHIN THE AREA DESCRIBED IN EXHIBIT "A", PURSUANT TO GOVERNMENT CODE SECTION 56108(a). THIS CONSENT SHALL BE OPERATIVE FOR A PERIOD OF 24 MONTHS DURING WHICH TIME THE PROPOSED ANNEXATION MUST BE FINALIZED.

4. AUTHORIZE STAFF COUNSEL TO GIVE THE REQUISITE NOTICE OF SAID APPROVAL TO THE CITY OF BLYTHE AND TO THE COUNTY OF RIVERSIDE, PURSUANT TO CALIFORNIA GOVERNMENT CODE SECTION 56108(e).

CALENDAR PAGE	9
MINUTE PAGE	1003

EXHIBIT "A"
LEGAL DESCRIPTION FOR
REORGANIZATION TO INCLUDE ANNEXATION NO. 43 TO THE
CITY OF BLYTHE AND CONCURRENT DISSOLUTION OF EAST BLYTHE
COUNTY WATER DISTRICT
LAFCO NO. 93-12-4

PARCEL 1

BEING DESCRIBED AS A PORTION OF SECTION 33; THE SOUTH HALF OF THE NORTH HALF OF SECTION 34; THE SOUTHEAST QUARTER OF SECTION 34; THE SOUTH HALF OF SECTION 35; THAT PORTION OF THE SOUTH HALF OF SECTION 36 LYING WEST OF THE CALIFORNIA-ARIZONA BOUNDARY AS ESTABLISHED BY INTERSTATE COMPACT DEFINING THE BOUNDARY BETWEEN THE STATES OF ARIZONA AND CALIFORNIA, RATIFIED BY THE U.S. CONGRESS, 1966; ALL IN TOWNSHIP 6 SOUTH, RANGE 23 EAST, OF THE SAN BERNARDINO MERIDIAN; AND THAT PORTION OF FRACTIONAL SECTIONS 1 & 2 LYING WEST OF SAID BOUNDARY; A PORTION OF FRACTIONAL SECTION 3; ALL IN TOWNSHIP 7 SOUTH, RANGE 23 EAST, OF THE SAN BERNARDINO MERIDIAN, ALL IN THE COUNTY OF RIVERSIDE, STATE OF CALIFORNIA;

BEING MORE PARTICULARLY DESCRIBED AS FOLLOWS:

BEGINNING AT THE NORTHEAST CORNER OF SAID SECTION 33, AND THE NORTHWEST CORNER OF SAID SECTION 34;

THENCE SOUTH ALONG THE WEST LINE OF SAID SECTION 34, A DISTANCE OF 1320 FEET, MORE OR LESS, TO THE NORTHWEST CORNER OF THE SOUTH HALF OF THE NORTH HALF OF SAID SECTION 34;

THENCE EAST ALONG THE NORTH LINE OF SAID SOUTH HALF, A DISTANCE OF 5280 FEET, MORE OR LESS, TO THE NORTHEAST CORNER OF SAID SOUTH HALF;

THENCE SOUTH 0° 54' 25" EAST ALONG THE EAST LINE OF SAID SOUTH HALF, A DISTANCE OF 1325.68 FEET TO THE NORTHWEST CORNER OF THE SOUTH HALF OF SAID SECTION 35;

THENCE EAST ALONG THE NORTH LINE OF SAID SOUTH HALF, A DISTANCE OF 5280 FEET, MORE OR LESS, TO THE NORTHEAST CORNER OF SAID SOUTH HALF AND THE NORTHWEST CORNER OF THE SOUTH HALF OF SAID SECTION 36;

THENCE EAST ALONG THE NORTH LINE OF SAID SOUTH HALF, A DISTANCE OF 4000 FEET, MORE OR LESS, TO SAID BOUNDARY.

THIS LEGAL DESCRIPTION APPROVED
Wain 17, 1993
BY RIVERSIDE COUNTY SURVEYOR
BY *D. W. Belser*

	CALENDAR PAGE	10
	MINUTE PAGE	1004

THENCE SOUTHWESTERLY ALONG SAID BOUNDARY, A DISTANCE OF 3677 FEET, MORE OR LESS, TO THE NORTH LINE OF SAID FRACTIONAL SECTION 1 OR THE PROLONGATION THEREOF;

THENCE CONTINUING SOUTHWESTERLY ALONG SAID BOUNDARY, A DISTANCE OF 2527 FEET, MORE OR LESS, TO THE WEST LINE OF SAID FRACTIONAL SECTION 1 OR THE PROLONGATION THEREOF;

THENCE CONTINUING SOUTHWESTERLY ALONG SAID BOUNDARY, A DISTANCE OF 3910 FEET, MORE OR LESS, TO THE SOUTH LINE OF SAID FRACTIONAL SECTION 2 OR THE PROLONGATION THEREOF;

THENCE WEST ALONG SAID SOUTH LINE, A DISTANCE OF 3400 FEET TO THE SOUTHWEST CORNER OF SAID FRACTIONAL SECTION 2 AND THE SOUTHEAST CORNER OF SAID FRACTIONAL SECTION 3;

THENCE SOUTH 87° 56' 47" WEST ALONG THE SOUTH LINE OF SAID FRACTIONAL SECTION 3, A DISTANCE OF 2004.83 FEET, TO THE EAST LINE OF ANNEXATION TO THE CITY OF BLYTHE NUMBER 35;

THENCE NORTH 2° 07' 01" WEST, ALONG SAID EAST LINE, A DISTANCE OF 30.00 FEET;

THENCE NORTH 87° 56' 47" EAST, CONTINUING ALONG SAID EAST LINE, A DISTANCE OF 45.14 FEET;

THENCE NORTH 1° 51' 01" WEST, CONTINUING ALONG SAID EAST LINE, A DISTANCE OF 1407.98 FEET;

THENCE NORTH 8° 09' 16" EAST, CONTINUING ALONG SAID EAST LINE, A DISTANCE OF 669.77 FEET;

THENCE NORTH 10° 49' 09" EAST, CONTINUING ALONG SAID EAST LINE, A DISTANCE OF 847.06 FEET;

THENCE NORTH 30° 55' 07" EAST, CONTINUING ALONG SAID EAST LINE, A DISTANCE OF 604.57 FEET;

THENCE NORTH 1° 59' 06" WEST, A DISTANCE OF 529.66 FEET TO THE SOUTH LINE OF THE NORTH HALF OF THE NORTHEAST QUARTER OF SAID FRACTIONAL SECTION 3 AND THE NORTH LINE OF SAID ANNEXATION;

THENCE SOUTH 88° 01' 42" WEST ALONG SAID SOUTH LINE A DISTANCE OF 1320 FEET, MORE OR LESS, TO THE SOUTHWEST CORNER OF THE NORTH HALF OF THE

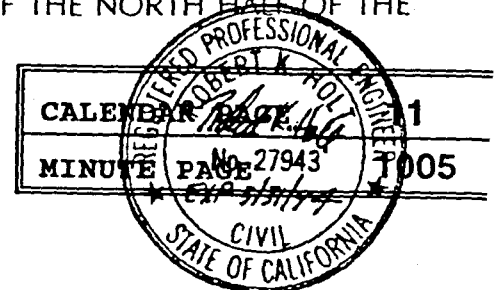

NORTHEAST QUARTER OF SAID FRACTIONAL SECTION 3;

THENCE NORTH ALONG THE WEST LINE OF SAID NORTH HALF, A DISTANCE OF 1320 FEET, MORE OR LESS, TO THE SOUTHWEST CORNER OF THE SOUTHEAST QUARTER OF SAID SECTION 34;

THENCE NORTH 0° 53' 23" WEST ALONG THE WEST LINE OF SAID SOUTHEAST QUARTER, A DISTANCE OF 2640 FEET, MORE OR LESS, TO THE CENTER OF SAID SECTION 34;

THENCE SOUTH 88° 00' 22" WEST ALONG THE SOUTH LINE OF THE NORTHWEST QUARTER OF SAID SECTION 34, A DISTANCE OF 2634.24 FEET TO THE SOUTHWEST CORNER OF SAID NORTHWEST QUARTER;

THENCE SOUTH 87° 55' 06" WEST ALONG THE NORTH LINE OF THE SOUTHEAST QUARTER OF SAID SECTION 33, A DISTANCE OF 1220.64 FEET;

THENCE SOUTH 1° 55' 01" EAST, A DISTANCE OF 485.60 FEET;

THENCE SOUTH 87° 55' 06" WEST, A DISTANCE OF 100.00 FEET;

THENCE SOUTH 1° 55' 01" EAST, A DISTANCE OF 856.04 FEET TO A POINT ON THE SOUTHERLY RIGHT-OF-WAY LINE OF INTERSTATE 10, SAID POINT BEING ON THE NORTHERLY LINE OF ANNEXATION TO THE CITY OF BLYTHE NUMBER 28;

THENCE NORTH 89° 18' 55" WEST ALONG SAID SOUTHERLY RIGHT-OF-WAY LINE AND SAID NORTHERLY LINE OF ANNEXATION NUMBER 28, A DISTANCE OF 94.04 FEET;

THENCE SOUTH 89° 09' 32" WEST CONTINUING ALONG SAID SOUTHERLY RIGHT-OF-WAY LINE AND SAID NORTHERLY LINE OF ANNEXATION NUMBER 28, A DISTANCE OF 300.08 FEET;

THENCE SOUTH 87° 49' 20" WEST, CONTINUING ALONG SAID SOUTHERLY RIGHT-OF-WAY LINE AND SAID NORTHERLY LINE OF ANNEXATION NUMBER 28, A DISTANCE OF 1414.72 FEET TO THE BEGINNING OF A TANGENT CURVE, CONCAVE SOUTHERLY, HAVING A RADIUS OF 35100.00 FEET;

THENCE WESTERLY ALONG THE ARC OF SAID CURVE, AND CONTINUING ALONG SAID SOUTHERLY RIGHT-OF-WAY LINE AND SAID NORTHERLY LINE OF ANNEXATION NUMBER 28, A DISTANCE OF 534.33 FEET, THROUGH A CENTRAL ANGLE OF 0° 52' 20";

THENCE SOUTH 85° 19' 18" WEST CONTINUING ALONG SAID SOUTHERLY RIGHT-OF-WAY LINE AND SAID NORTHERLY LINE OF ANNEXATION NUMBER 28, A DISTANCE OF

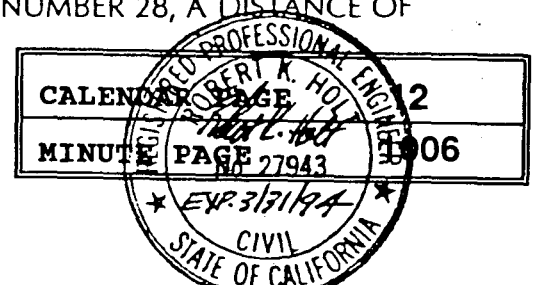

963.83 FEET TO WEST LINE OF THE EAST HALF OF THE WEST HALF OF THE SOUTHWEST QUARTER OF SAID SECTION 33;

THENCE NORTH 0° 58' 10" WEST ALONG SAID WEST LINE, A DISTANCE OF 1320 FEET, MORE OR LESS, TO THE NORTH LINE OF SAID SOUTHWEST QUARTER OF SECTION 33 AND TO AN ANGLE POINT ON THE EXISTING BLYTHE CITY LIMITS;

THENCE NORTH 88° 54' EAST ALONG SAID NORTH LINE AND ALONG SAID CITY LIMITS, A DISTANCE OF 495 FEET, MORE OR LESS, TO AN ANGLE POINT ON SAID CITY LIMITS;

THENCE NORTH 0° 58' 10" WEST ALONG SAID CITY LIMITS, A DISTANCE OF 405 FEET, MORE OR LESS, TO AN ANGLE POINT ON SAID CITY LIMITS;

THENCE NORTH 88° 54' EAST ALONG SAID CITY LIMITS, A DISTANCE OF 150 FEET, MORE OR LESS, TO AN ANGLE POINT ON SAID CITY LIMITS;

THENCE NORTH 0° 58' 10" WEST ALONG SAID CITY LIMITS, A DISTANCE OF 925 FEET, MORE OR LESS, TO AN ANGLE POINT ON SAID CITY LIMITS, SAID ANGLE POINT BEING ON THE NORTH LINE OF THE SOUTH HALF OF THE NORTHWEST QUARTER OF SAID SECTION 33;

THENCE NORTH 88° 53' 10" EAST ALONG THE NORTH LINE OF THE SOUTH HALF OF SAID NORTHWEST QUARTER OF SECTION 33, A DISTANCE OF 2670 FEET, MORE OR LESS, TO THE SOUTHEAST CORNER OF THE NORTHWEST QUARTER OF THE NORTHEAST QUARTER OF SAID SECTION 33;

THENCE NORTH 1° 53' 01" WEST ALONG THE EAST LINE OF SAID NORTHWEST QUARTER, A DISTANCE OF 1092.96 FEET;

THENCE SOUTH 87° 54' 48" WEST A DISTANCE OF 200.00 FEET;

THENCE NORTH 1° 53' 01" WEST, A DISTANCE OF 230.00 FEET, TO THE NORTH LINE OF SAID NORTHEAST QUARTER;

THENCE NORTH 87° 54' 48" EAST ALONG THE NORTH LINE OF SAID NORTHEAST QUARTER, A DISTANCE OF 1520.91 FEET TO THE NORTHEAST CORNER OF SAID SECTION 33, AND TO THE POINT OF BEGINNING, CONTAINING 1836 ACRES, MORE OR LESS.

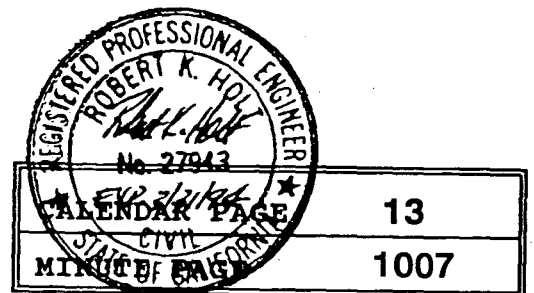

PARCEL 2

A PORTION OF THE NORTH HALF OF FRACTIONAL SECTION 4, TOWNSHIP 7 SOUTH RANGE 23 EAST, SAN BERNARDINO MERIDIAN, BEING MORE PARTICULARLY DESCRIBED AS FOLLOWS:

BEGINNING AT THE NORTHEAST CORNER OF SAID FRACTIONAL SECTION 4, SAID CORNER BEING THE CENTERLINE INTERSECTION OF INTAKE BOULEVARD AND FOURTEENTH AVENUE;

THENCE SOUTH $87^{\circ} 55' 14''$ WEST ALONG THE NORTH LINE OF SAID SECTION 4 AND CENTERLINE OF FOURTEENTH AVENUE, A DISTANCE OF 4610, MORE OR LESS, TO THE WEST LINE OF THE EAST HALF OF GOVERNMENT LOT 4 OF SAID FRACTIONAL SECTION 4 AND TO THE EASTERLY BOUNDARY OF THE EXISTING CITY LIMITS;

THENCE SOUTH ALONG SAID WEST LINE AND SAID BOUNDARY, A DISTANCE OF 653 FEET, MORE OR LESS, TO THE SOUTH LINE OF THE NORTH 653 FEET OF SAID GOVERNMENT LOT 4;

THENCE NORTH $88^{\circ} 53' 20''$ EAST ALONG SAID SOUTH LINE, A DISTANCE OF 332 FEET, MORE OR LESS, TO THE WEST LINE OF TRACT NO. 4071, FILED IN BOOK 66, AT PAGES 44 AND 45, OF MAPS, OFFICIAL RECORDS OF SAID COUNTY AND STATE;

THENCE SOUTH $0^{\circ} 57' 28''$ EAST, A DISTANCE OF 657.14 FEET TO THE SOUTH LINE OF SAID GOVERNMENT LOT 4;

THENCE NORTH $88^{\circ} 59' 33''$ EAST ALONG THE SOUTH LINE OF GOVERNMENT LOTS 3 AND 2 OF SAID FRACTIONAL SECTION 4, A DISTANCE OF 2940 FEET, MORE OR LESS TO THE NORTHWEST CORNER OF THE SOUTHEAST QUARTER OF THE NORTHEAST QUARTER OF SAID FRACTIONAL SECTION 4;

THENCE SOUTH ALONG THE WEST LINE OF SAID SOUTHEAST QUARTER, A DISTANCE OF 1323.37 FEET, MORE OR LESS, TO THE SOUTHWEST CORNER OF SAID SOUTHEAST QUARTER;

THENCE NORTH $88^{\circ} 56' 41''$ EAST ALONG THE SOUTH LINE OF SAID SOUTHEAST QUARTER, A DISTANCE OF 1320 FEET, MORE OR LESS, TO THE SOUTHEAST CORNER OF SAID NORTHEAST QUARTER;

THENCE NORTH $0^{\circ} 55' 36''$ WEST ALONG THE EAST LINE OF SAID NORTHEAST QUARTER, A DISTANCE OF 2640.58 FEET, TO THE NORTHEAST CORNER OF SAID FRACTIONAL SECTION 4, AND TO THE POINT OF BEGINNING. CONTAINING 177 ACRES, MORE OR LESS.

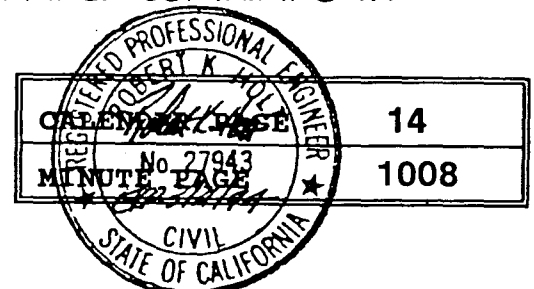

PARCEL 3

THAT PORTION OF SECTION 10, TOWNSHIP 7 SOUTH, RANGE 23 EAST OF THE SAN BERNARDINO MERIDIAN, COUNTY OF RIVERSIDE, STATE OF CALIFORNIA, DESCRIBED AS FOLLOWS:

COMMENCING AT THE NORTHEAST CORNER OF SAID SECTION 10;

THENCE SOUTH 87° 56' 47" WEST ALONG THE NORTH LINE OF SAID SECTION 10, A DISTANCE OF 3239.21 FEET TO THE POINT OF INTERSECTION OF SAID NORTH LINE WITH NORTHERLY PROLONGATION OF THE EAST LINE OF PARCEL 3 OF PARCEL MAP 9912, FILED IN BOOK 89, AT PAGES 63 THROUGH 65, INCLUSIVE, OF PARCEL MAPS, OFFICIAL RECORDS OF SAID COUNTY, SAID POINT BEING THE POINT OF BEGINNING;

THENCE SOUTH 2° 06' 32" EAST ALONG SAID PROLONGATION AND ALONG THE EAST LINE OF SAID PARCEL 3, A DISTANCE OF 492.72 FEET TO THE SOUTHEAST CORNER OF SAID PARCEL 3;

THENCE SOUTH 87° 56' 47" WEST ALONG THE SOUTH LINE OF SAID PARCEL MAP, A DISTANCE OF 663.00 FEET TO THE SOUTHWEST CORNER OF PARCEL 1 OF SAID PARCEL MAP;

THENCE NORTH 2° 06' 32" WEST ALONG THE WEST LINE OF SAID PARCEL 1 AND THE NORTHERLY PROLONGATION THEREOF, A DISTANCE OF 492.72 FEET, TO THE NORTH LINE OF SAID SECTION 10;

THENCE NORTH 87° 56' 47" EAST ALONG SAID NORTH LINE, A DISTANCE OF 663.00 FEET, TO THE POINT OF BEGINNING, CONTAINING 7.49 ACRES, MORE OR LESS.

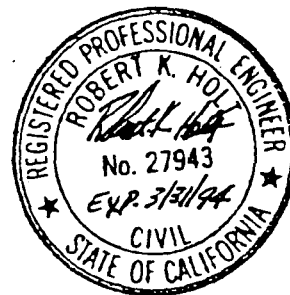

CALENDAR PAGE	15
MINUTE PAGE	1009

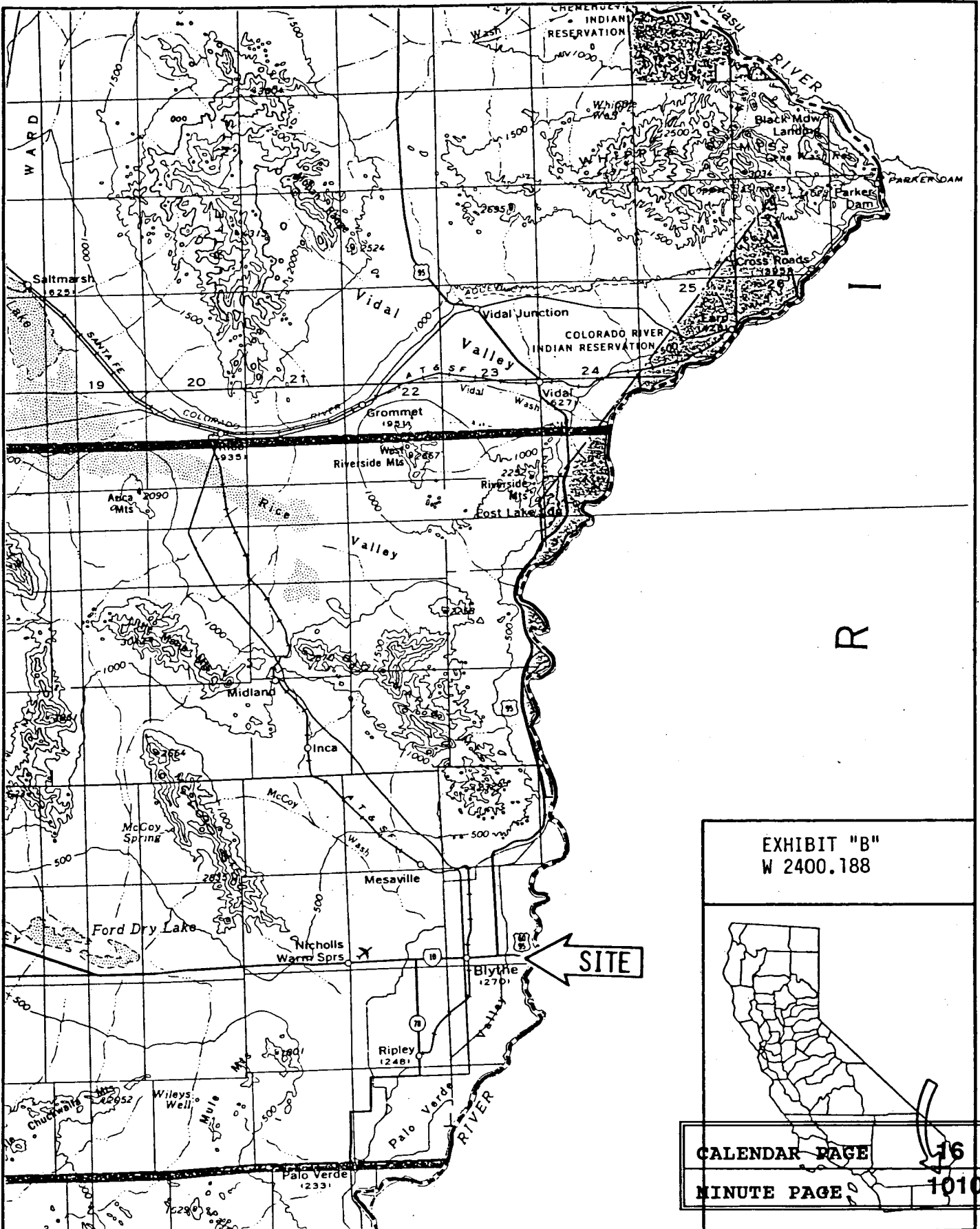

I
R

EXHIBIT "B"
W 2400.188



SITE

CALENDAR PAGE	16
MINUTE PAGE	1010

Exhibit "C"

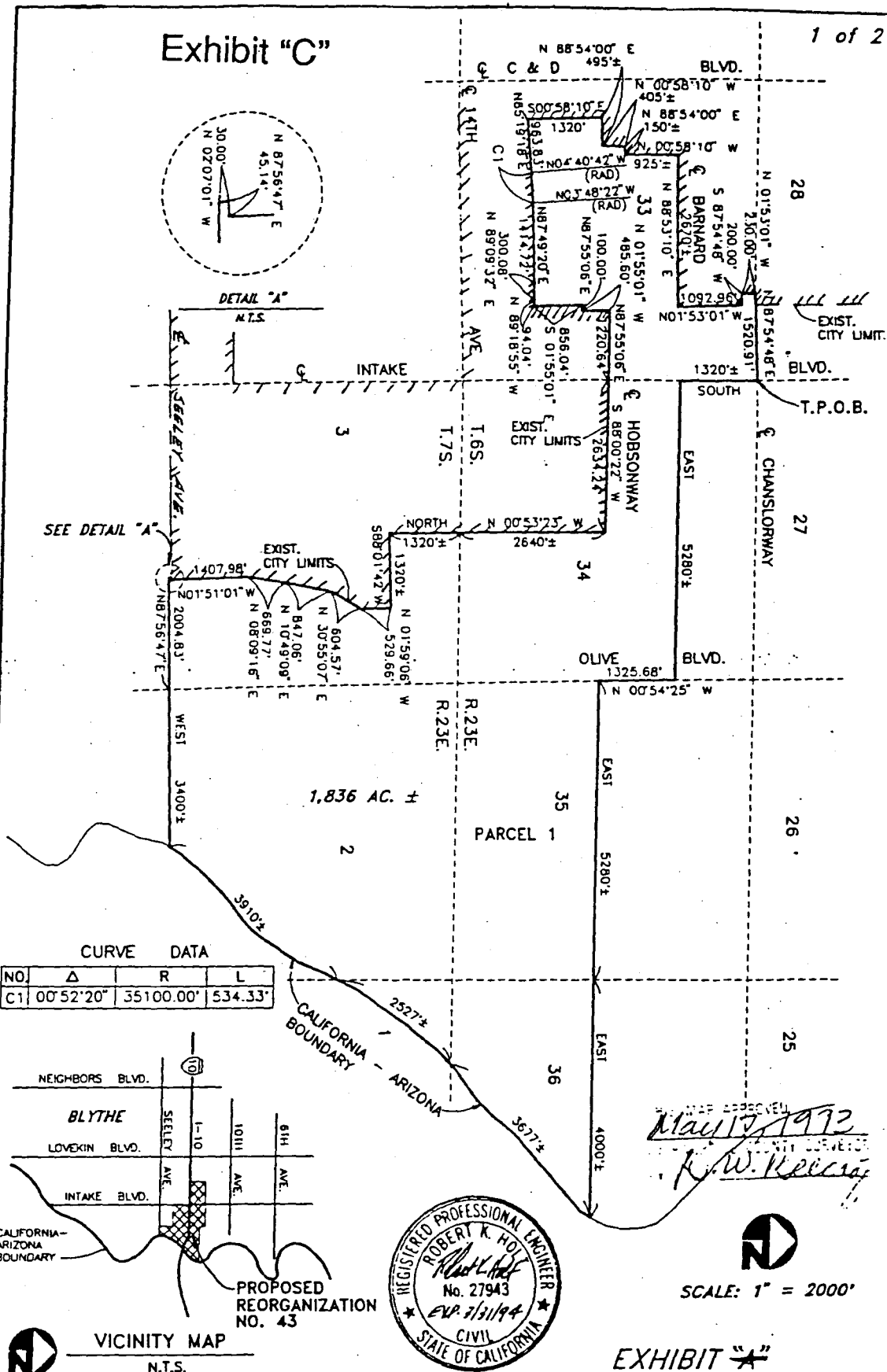
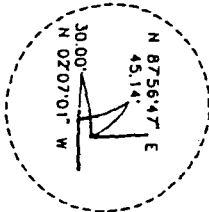

CURVE DATA

NO.	Δ	R	L
C1	00°52'20"	35100.00'	534.33'

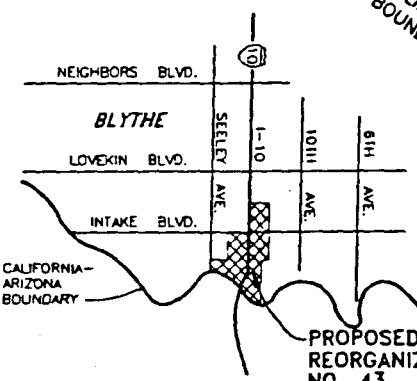

May 17 1993
K.W. Keenan

SCALE: 1" = 2000'

EXHIBIT "A"

CITY OF BLYTHE

LAFCO NO. 93-12-4

REORGANIZATION TO INCLUDE ANNEXATION NO. 43 TO THE CITY OF BLYTHE AND CONCURRENT DISSOLUTION OF EAST BLYTHE COUNTY WATER DISTRICT.

A PORTION OF SECS. 33-36, T.6S., R.23E. AND SECS. 1-4, & 10, T.7S., R.23E., S.B.M.

CALIFORNIA PAGE 17

MINUTE PACE ENGINEERS 1011

275 N. El Centro, Suite 203 Azusa, California 91702
46th Highway 111 Azusa, California 91702

Exhibit "C"

COUNTY OF RIVERSIDE

PARCEL 3
7.49 AC ±

PARCEL 2

177 AC. ±

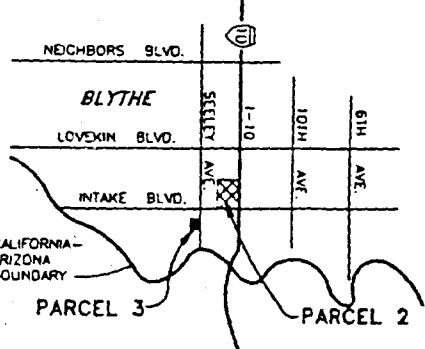

VICINITY MAP
N.T.S.

SCALE: 1" = 1000'

EXHIBIT

CITY OF BLYTHE

LAFCD NO. 93-12-4
 REORGANIZATION TO INCLUDE ANNEXATION NO. 43 TO
 THE CITY OF BLYTHE AND CONCURRENT DISSOLUTION
 OF EAST BLYTHE COUNTY WATER DISTRICT.
 A PORTION OF SECS. 33-36, T.6S., R.23E. AND
 SECS. 1-4, & 10, T.7S., R.23E., S.B.M.

CALIFORNIA ENGINEERS AND ARCHITECTS GROUP 18
 PROJECTS PAGE ENGINEERS 1012
 275 N. E. Cmo. Suite 63 Palm Springs, California 92262
 4764 Highway 711 Blythe, California 92227

