

MINUTE ITEM  
This Calendar Item No. C08  
was approved as Minute Item  
No. 08 by the State Lands  
Commission by a vote of 3  
to 0 at its 2-28-93  
meeting.

CALENDAR ITEM

C08

A 10

S 5

02/25/93  
W 24863  
Gordon  
PRC 7674

GENERAL PERMIT - PUBLIC AGENCY USE

**APPLICANT:**

East Bay Municipal Utility District  
P.O. Box 24055  
Oakland, California 94623

**AREA, TYPE LAND AND LOCATION:**

Two 0.0046-acre parcels of submerged lands located in the Mokelumne River at North Elliot Road in Lockeford and at North Mackville Road Near Clemente, San Joaquin County.

**LAND USE:**

Construction, placement, and maintenance of river gauging station facilities for purpose of monitoring river flow and river temperature at two sites, respectively.

**PROPOSED PERMIT TERMS:**

Initial period:  
30 years beginning March 1, 1993.

**CONSIDERATION:**

The public benefit; with the State reserving the right at any time to set a monetary rental if the Commission finds such action to be in the State's best interest.

**BASIS FOR CONSIDERATION:**

Pursuant to 2 Cal. Code Regs. 2003.

**APPLICANT STATUS:**

Applicant is permittee of upland.

**PREREQUISITE CONDITIONS, FEES AND EXPENSES:**

Filing fee and estimated processing costs have been received.

**STATUTORY AND OTHER REFERENCES:**

A. P.R.C.: Div. 6, Parts 1 and 2; Div. 13.

CALENDAR ITEM NO. C08 (CONT'D)

B. Cal. Code Regs.: Title 3, Div. 3; Title 14, Div. 6.

**AB 884:**

05/19/93

**OTHER PERTINENT INFORMATION:**

1. Applicant is a public corporation operating as a municipal utility which supplies water, generates electricity, and provides other services that benefit California's citizens on a statewide basis. The proposed monitoring sites will represent an enhancement of the existing monitoring system which applicant presently utilizes in the gathering of statistical data that enables it to fulfill its obligations to water rights holders, fisheries, and specific flood control requirements. The purpose of the proposed facilities is the measurement of both the flow and temperature of the river at the two proposed sites. The information provided by this project will allow the applicant to better manage Mokelumne River resources.
2. The annual rental value of the two sites are estimated to be \$100 each site.
3. Pursuant to the Commission's delegation of authority and the State CEQA Guidelines (14 Cal. Code Regs. 15061), the staff has determined that this activity is exempt from the requirements of the CEQA as a categorically exempt project. The project is exempt under Class 6, Information Collection, 14 Cal. Code Regs. 15306.

Authority: P.R.C. 21084 and 14 Cal. Code Regs. 15300.

4. This activity involves lands identified as possessing significant environmental values pursuant to P.R.C. 6370, et seq. Based upon the staff's consultation with the persons nominating such lands and through the CEQA review process, it is the staff's opinion that the project, as proposed, is consistent with its use classification.

**APPROVALS OBTAINED OR NOT REQUIRED:**

United States Army Corps of Engineers, California Department of Fish and Game, California Central Valley Regional Water Quality Control Board, and County of San Joaquin.

CALENDAR ITEM NO. C08 (CONT'D)

**FURTHER APPROVALS REQUIRED:**

California Reclamation Board.

**EXHIBITS:**

- A. Land Description
- B. Location Map
- C. Local Government Comment

**IT IS RECOMMENDED THAT THE COMMISSION:**

1. FIND THAT THE ACTIVITY IS EXEMPT FROM THE REQUIREMENTS OF THE CEQA PURSUANT TO 14 CAL. CODE REGS. 15061 AS A CATEGORICALLY EXEMPT PROJECT, CLASS 6, INFORMATION COLLECTION, 14 CAL. CODE REGS. 15306.
2. FIND THAT THIS ACTIVITY IS CONSISTENT WITH THE USE CLASSIFICATION DESIGNATED FOR THE LAND PURSUANT TO P.R.C. 6370, ET SEQ.
3. AUTHORIZE ISSUANCE TO EAST BAY MUNICIPAL UTILITY DISTRICT OF A 30-YEAR GENERAL PERMIT - PUBLIC AGENCY USE, BEGINNING MARCH 1, 1993; IN CONSIDERATION OF THE PUBLIC BENEFIT WITH THE STATE RESERVING THE RIGHT AT ANY TIME TO SET A MONETARY RENTAL IF THE COMMISSION FINDS SUCH ACTION TO BE IN THE STATE'S BEST INTEREST; FOR CONSTRUCTION, PLACEMENT, AND MAINTENANCE OF RIVER GAUGING STATION FACILITIES UTILIZED FOR PURPOSES OF MONITORING RIVER FLOW AND RIVER TEMPERATURE ON THE LAND DELINEATED ON EXHIBIT "A" ATTACHED AND BY REFERENCE MADE A PART HEREOF.

MOKELUMNE RIVER

N 45°56'00" W

LOW WATER LINE

FLOW

NORTH ELLIOTT ROAD BRIDGE

ELLIOTT RD 80 FT R/W

HIGH WATER LINE

C/L ALIGNMENT  
BUBLER TUBE & PROBE WIRE

N 45°56'00" W - 181.80

N 44°04'00" E - 12.50

N 45°56'00" W - 717.70 TOTAL (REF 1)

N 45°56'00" W - 209.60

C/L PROPOSED  
EBMUD 5' R/W

PROP. LINE (REF 1)  
S 41°45'00" W  
Approximate  
LOW WATER LINE

APN 051-210-38  
SAN JOAQUIN COUNTY  
SCALE: 0 25' 50'

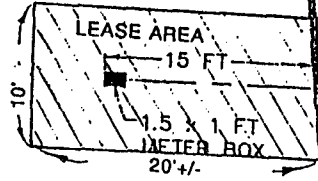

1/4" PVC  
BUBLER TUBE &  
TEMP. PROBE WIRE

4'x4'  
CONC. PAD

1 1/2" TEL.  
CONDUIT

S/E LINE ELLIOTT RD R/W

MOKELUMNE RIVER  
EBMUD OP/NET FACILITIES

FACILITIES DETAILS  
SCALE 0 5' 10'

N 45° 56' 00 W 209.60

S 44° 04' W  
33.42

2" POWER  
CONDUIT

UTILITY POLE

EXHIBIT "A"

Page 1

W 24863

MOKELUMNE RIVER  
SAN JOAQUIN COUNTY



- REF: 1) RECORD OF SURVEY  
20 SURVEYS 30  
SAN JOAQUIN COUNTY  
2) EB/MUD DWG 9602-G  
3) 25144 ELLIOTT



This drawing is solely for purposes of generally defining the lease premises, and is not intended to be, nor shall it be construed as, a waiver or limitation of any State interest in the subject or any other property.

CALENDAR PAGE 48  
MINUTE PAGE 80

This drawing is solely for purposes of generally defining the lease premises, and is not intended to be, nor shall it be construed as, a waiver or limitation of any State interest in the subject or any other property.

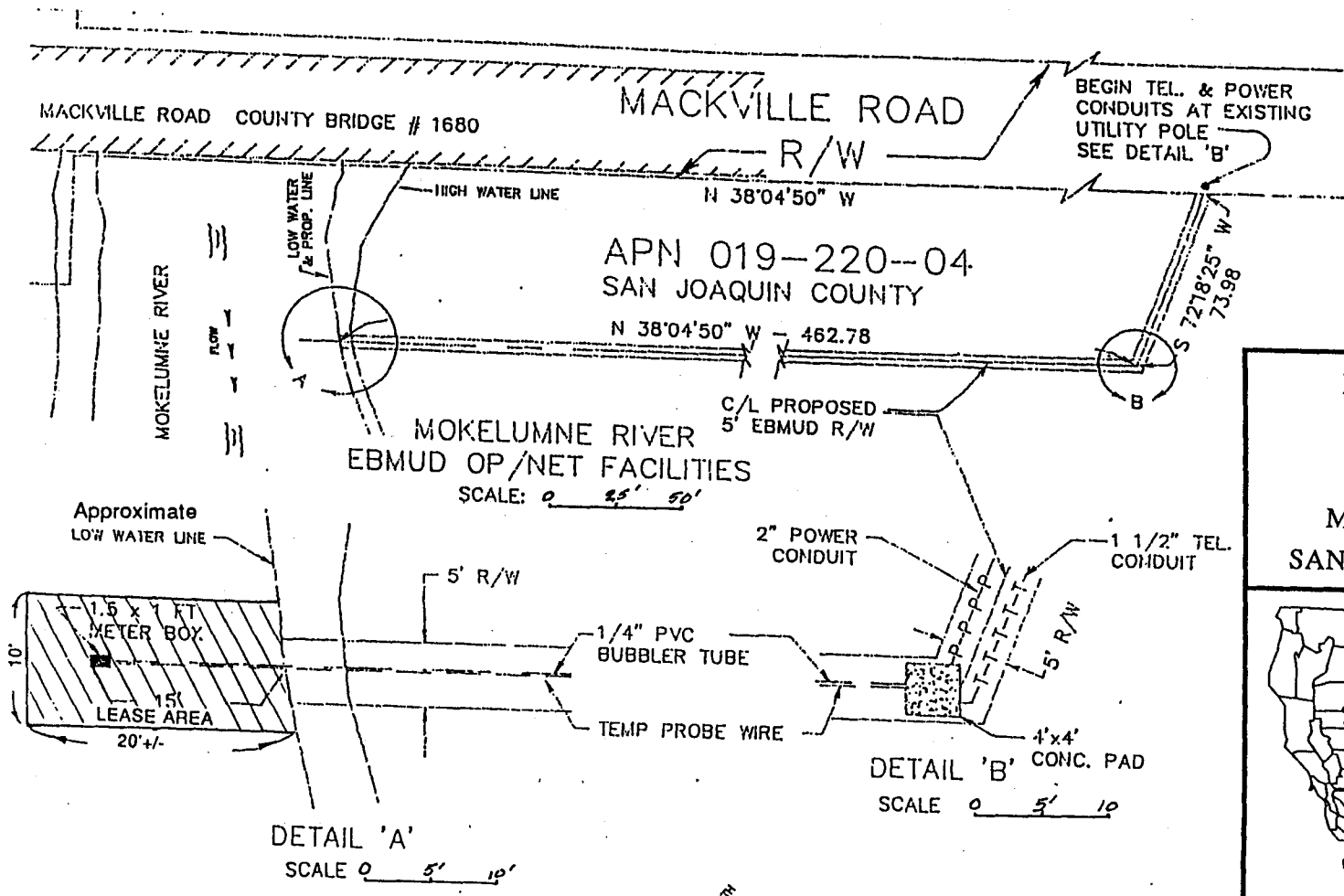

**EXHIBIT "A"**

Page 2

W 24863

MOKELUMNE RIVER  
SAN JOAQUIN COUNTY



- REF: 1) EBMUD DWG 9605-G
- 2) 25144, MACKVILL

CALENDAR PAGE 49  
 MINUTE PAGE 81

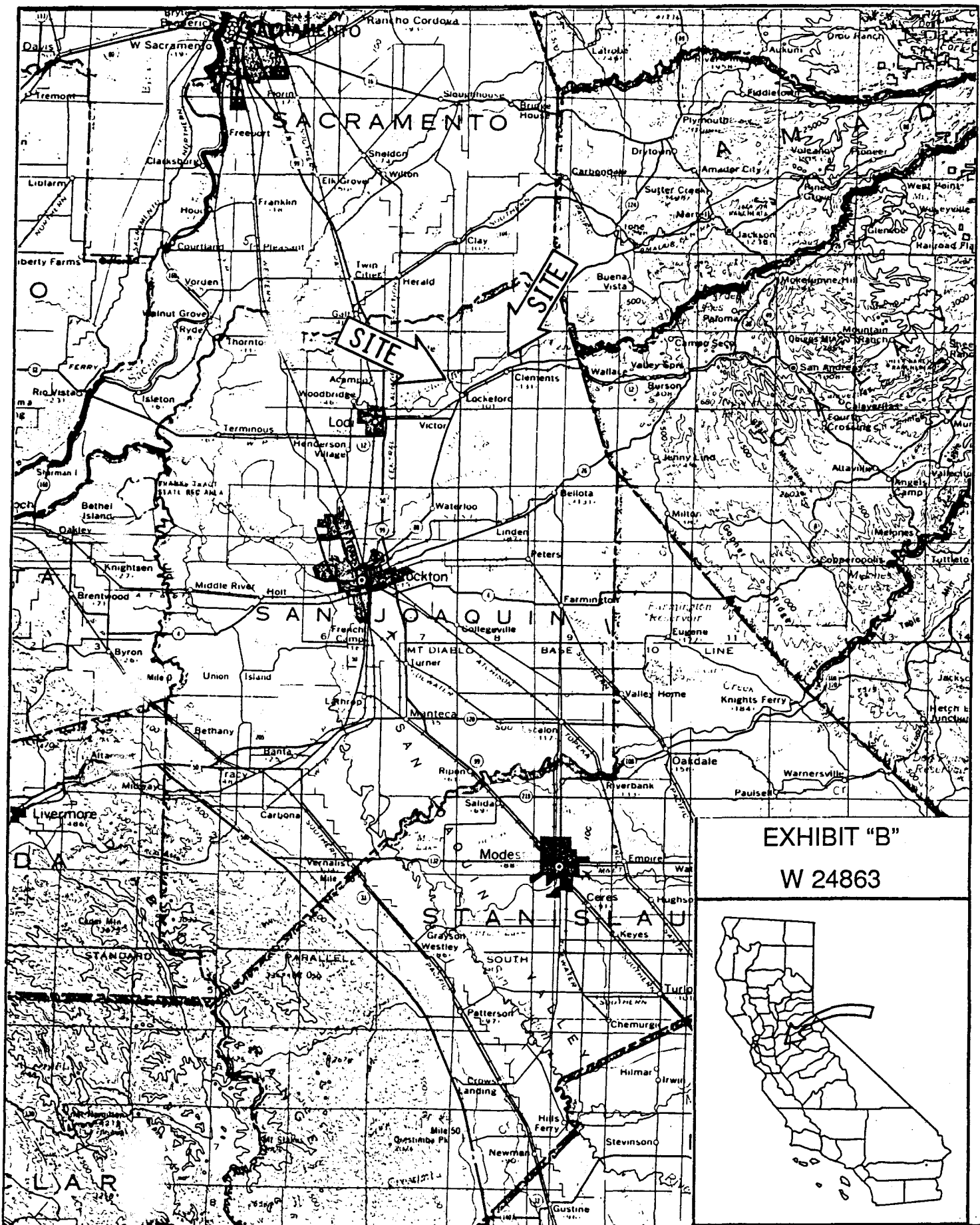

EXHIBIT "B"  
W 24863





SAN JOAQUIN COUNTY  
COMMUNITY DEVELOPMENT DEPARTMENT

1810 E. HAZELTON AVE., STOCKTON, CA 95205-6232  
DEVELOPMENT SERVICES PHONE: (209) 468-3120  
PLANNING PHONE: (209) 468-3120  
BUILDING PHONE: (209) 468-3123  
NEIGHBORHOOD PRESERVATION PHONE: (209) 468-3021

WATER OPERATIONS DEPARTMENT  
Water Supply Section  
MAY 22 1992

May 20, 1992

Mark A. Rincon  
Associate Civil Engineer  
East Bay Municipal Utility District  
375 Eleventh Street  
Oakland, CA 94607 - 4240

Dear Mr. Rincon:

RE: Installation of Telephone, Electricity and Instrumentation to  
Mokelumne River Gaging Sites at Mackville and Elliott Roads

The proposed project noted above is allowed under the provisions of the San Joaquin County Planning Title as a permitted use in all zones. The described project is not subject to any zoning permit requirements. Although zoning permits are not required you should contact the County Building Division to determine if any local building permits may be required.

Please call if you have any questions.

Sincerely,

DOM DE LA TORRE  
COUNTER MANAGER,  
DEVELOPMENT SERVICES

DD/vm  
c: Public Works  
Building Division

CALENDAR PAGE	51
MINUTE PAGE	83



**SAN JOAQUIN COUNTY  
COMMUNITY DEVELOPMENT DEPARTMENT**

1810 E HAZELTON AVE. STOCKTON, CA 95205  
DEVELOPMENT SERVICES PHONE (209) 468-3120  
PLANNING PHONE (209) 468-3120  
BUILDING PHONE (209) 468-3123  
NEIGHBORHOOD PRESERVATION PHONE (209) 468-3021

STATU

July 7, 1992

Mark A. Rincon  
East Bay Municipal Utility District  
375 Eleventh Street  
Oakland, CA 94607-4240

INSTALLATION OF TELEPHONE, ELECTRICITY AND INSTRUMENTATION TO  
MOKELUMNE RIVER GAGING SITES AT MACKVILLE ROAD AND AT ELLIOTT  
ROAD

Dear Mr. Rincon:

The San Joaquin County Building Inspection Division has determined  
the subject project to be exempt from all local building permit and  
inspection requirements.

If you have any questions please feel free to call me.

Sincerely,

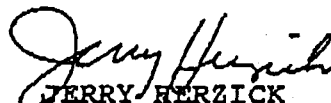
  
JERRY HERZICK  
DEPUTY DIRECTOR

JH/lc