

MINUTE ITEM
This Calendar Item No. C14
approved as Minute Item
by the State Lands
Commission by a vote of 3
to 0 at its 4-30-92
meeting.

A 7

S 1

CALENDAR ITEM

C 1 4

06/30/92
PRC 5405
Gordon

AMENDMENT OF GENERAL PERMIT - RECREATIONAL USE PRC 5405

PERMITTEE:

Elizabeth C. Lewis
c/o Ted Lewis
P. O. Box 836
Tahoe City, California 96145

AREA, TYPE LAND AND LOCATION:

A 0.0397-acre parcel of submerged land located in Lake Tahoe
at Cedar Flat, Placer County.

LAND USE:

Reconstruction and maintenance of a pier and installation of
a low-level boat lift utilized for recreational purposes.

TERMS OF ORIGINAL PERMIT:

Initial period:

Fifteen (15) years beginning August 1, 1985.

Public liability insurance:

Combined single limit coverage of \$300,000 per
occurrence for bodily injury and property damage.

Special:

1. The permit is conditioned on Permittee's
conformance with the Tahoe Regional Planning Agency's
Shorezone Ordinance.
2. The permit is conditioned on the authorization and
consent of Forest Homes of Cedar Flat, Inc., for any of
the subject facility found to be on or adjacent to its
lands.
3. The permit conforms to the Lyon/Fogerty decision.

192
110

CALENDAR ITEM NO. C 1 4 (CONT'D)

CONSIDERATION:

\$235.22 per annum; with the State reserving the right to fix a different rental on each fifth anniversary of the permit.

TERMS OF PROPOSED AMENDMENT OF PERMIT:

Initial period:

Fifteen (15) years beginning August 1, 1985.

Public liability insurance:

Combined single limit coverage of \$500,000.

Special:

1. The amendment authorizes reconstruction of the pier.

2. Reconstruction limitation dates shall be:

Beginning: June 15, 1992

Completion: September 30, 1993

3. The amendment increases the area of use and annual rental; prohibits any residential use of the facilities; and conditions the permit on the right of public access along the shorezone, Permittee's retention of the public trust area and Rorippa habitat area in its natural condition, and conservation of natural resources and the protection of the environment.

4. All other provisions remain in full force and effect.

CONSIDERATION:

\$373.68 per annum; with the State reserving the right to fix a different rental on each fifth anniversary of the permit.

BASIS FOR CONSIDERATION:

Pursuant to 2 Cal. Code Regs. 2003.

APPLICANT STATUS:

Applicant is owner of upland.

CALENDAR ITEM NO. C 1 4 (CONT'D)

PREREQUISITE CONDITIONS, FEES AND EXPENSES:

Filing fee and estimated processing costs have been received.

STATUTORY AND OTHER REFERENCES:

A. P.R.C.: Div. 6, Parts 1 and 2; Div. 13.

B. Cal. Code Regs.: Title 3, Div. 3; Title 14, Div. 6.

AB 234:

08/05/92

OTHER PERTINENT INFORMATION:

1. At its June 26, 1985 meeting, in Minute Item 6, the Commission authorized issuance of the subject permit to applicant for the existing pier. This is an application to reconstruct the pier and to install a low-level boat lift.
2. Pursuant to the Commission's delegation of authority and the State CEQA Guidelines (14 Cal. Code Regs. 15025), the staff has prepared a Proposed Negative Declaration identified as EIR ND 591, State Clearinghouse No. 92052040. Such Proposed Negative Declaration was prepared and circulated for public review pursuant to the provisions of CEQA.

Based upon the Initial Study, the Proposed Negative Declaration, and the comments received in response thereto, there is no substantial evidence that the project will have a significant effect on the environment. (14 Cal. Code Regs. 15074(b))

3. In order to determine the potential trust uses in the area of the activity, the staff contacted representatives of the following agencies: Tahoe Regional Planning Agency, California Department of Fish and Game, Placer County, and the Tahoe Conservancy. None of these agencies expressed a concern that the activity would have a significant effect on trust uses in the area. The agencies did not identify any trust needs which were not being met by existing facilities in the area. Identified trust uses in this area would include swimming, boating, walking along the beach, and views of the lake.

CALENDAR ITEM NO. C-14 (CONT'D)

4. Staff has physically inspected the site for purposes of evaluating the impact of the activity on the Public Trust.
5. This activity involves lands identified as possessing significant environmental values pursuant to P.R.C. 6370, et seq. Based upon the staff's consultation with the persons nominating such lands and through the CEQA review process, it is the staff's opinion that the project, as proposed, is consistent with its use classification.

APPROVALS OBTAINED:

Tahoe Regional Planning Agency, California Department of Fish and Game, Lahontan Regional Water Quality Control Board, and County of Placer.

FURTHER APPROVALS REQUIRED:

United States Army Corps of Engineers.

EXHIBITS:

- A. Land Description and Site Map
- B. Location Map
- C. Local Government Comment
- D. Proposed Negative Declaration/Monitoring Program

IT IS RECOMMENDED THAT THE COMMISSION:

1. CERTIFY THAT A NEGATIVE DECLARATION, EIR ND 591, STATE CLEARINGHOUSE NO. 92052040, WAS PREPARED FOR THIS PROJECT PURSUANT TO THE PROVISIONS OF THE CEQA AND THAT THE COMMISSION HAS REVIEWED AND CONSIDERED THE INFORMATION CONTAINED THEREIN.
2. ADOPT THE NEGATIVE DECLARATION AND DETERMINE THAT THE PROJECT, AS APPROVED, WILL NOT HAVE A SIGNIFICANT EFFECT ON THE ENVIRONMENT.
3. ADOPT THE MONITORING PROGRAM ATTACHED AS EXHIBIT "D" WHICH HAS BEEN PREPARED IN CONFORMANCE WITH P.R.C. 21081.6.

CALENDAR ITEM NO. C 1 4 (CONT'D)

4. FIND THAT THIS ACTIVITY IS CONSISTENT WITH THE USE CLASSIFICATION DESIGNATED FOR THE LAND PURSUANT TO P.R.C. 6370, ET SEQ.
5. AUTHORIZE THE AMENDMENT OF A GENERAL PERMIT - RECREATIONAL USE PRC 5405, EFFECTIVE JUNE 15, 1992, TO RECONSTRUCT A PIER, INSTALL A LOW-LEVEL BOATLIFT, AND ADD NEW STANDARD PROVISIONS TO THE PERMIT; IN CONSIDERATION OF ANNUAL RENT IN THE AMOUNT OF \$373.68, WITH THE STATE RESERVING THE RIGHT TO FIX A DIFFERENT RENTAL ON EACH FIFTH ANNIVERSARY OF THE PERMIT; AND WITH PROVISION OF PUBLIC LIABILITY INSURANCE FOR COMBINED SINGLE LIMIT COVERAGE OF \$500,000; FOR RECONSTRUCTION AND MAINTENANCE OF A PIER AND INSTALLATION OF A LOW-LEVEL BOAT LIFT. ALL CONSTRUCTION TO BE CONDUCTED FROM A BARGE WITH NO USE OF THE LAKESHORE ABOVE LOW WATER MARK ON THE LAND DESCRIBED ON EXHIBIT "A" ATTACHED AND BY REFERENCE MADE A PART HEREOF.

106
114

EXHIBIT "A"

PRC 5405.1

LAND DESCRIPTION

A parcel of land in the bed of Lake Tahoe, Placer County, California more particularly described as follows:

All that land immediately beneath an existing reconstructed pier, TOGETHER WITH the necessary use area extending 10 feet beyond its extremities, said structure lying adjacent to and easterly of Lot 6, Block 8, Cedar Flat Subdivision, as shown on the map filed in Book H of Maps, Page 82 in the office of the Recorder of said County.

EXCEPTING THEREFROM any portion lying landward of the ordinary low water mark of Lake Tahoe.

END OF DESCRIPTION

REVISED APRIL, 1992 BY LLB

107
115

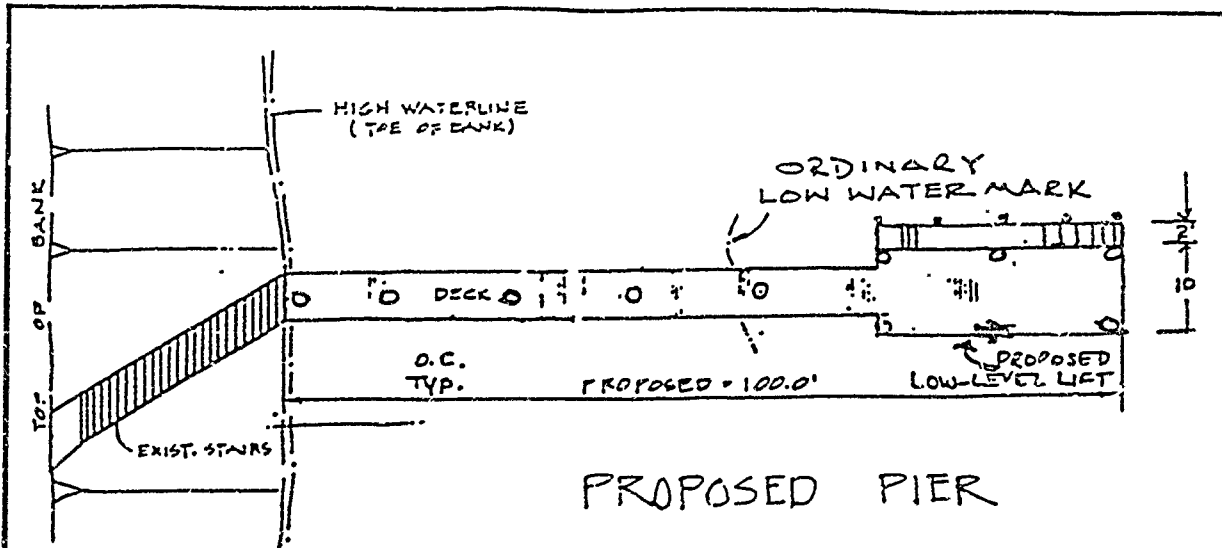

PROPOSED PIER

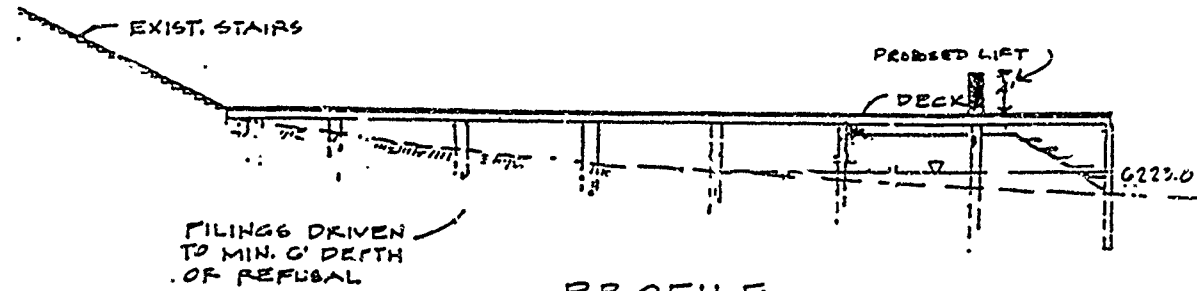

PROFILE
 SCALE: HORIZ. 1" = 20'
 VERT. 1" = 20'

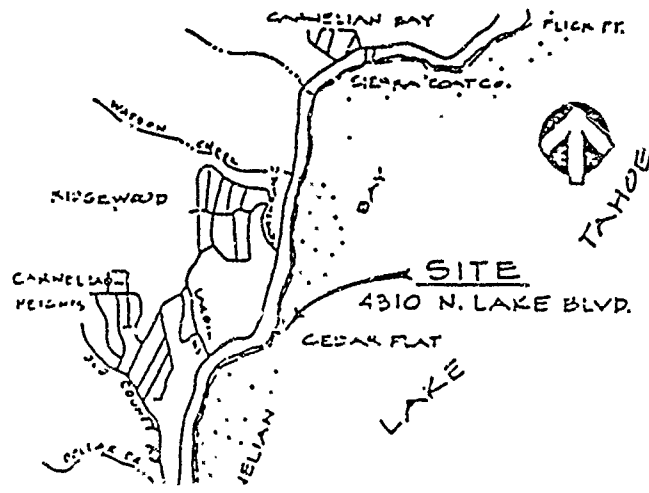
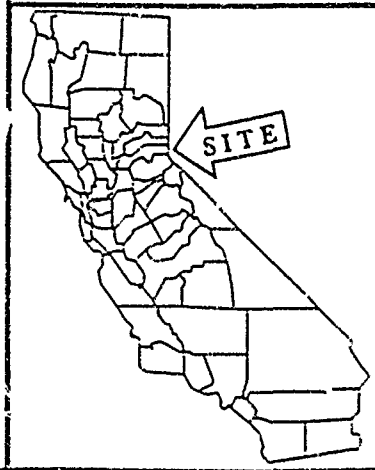

EXHIBIT "A"
 Site Map
 PRC 5405.1
 Pier Reconstruction
 APN 92 - 180 - 39
 Lake Tahoe
 PLACER COUNTY



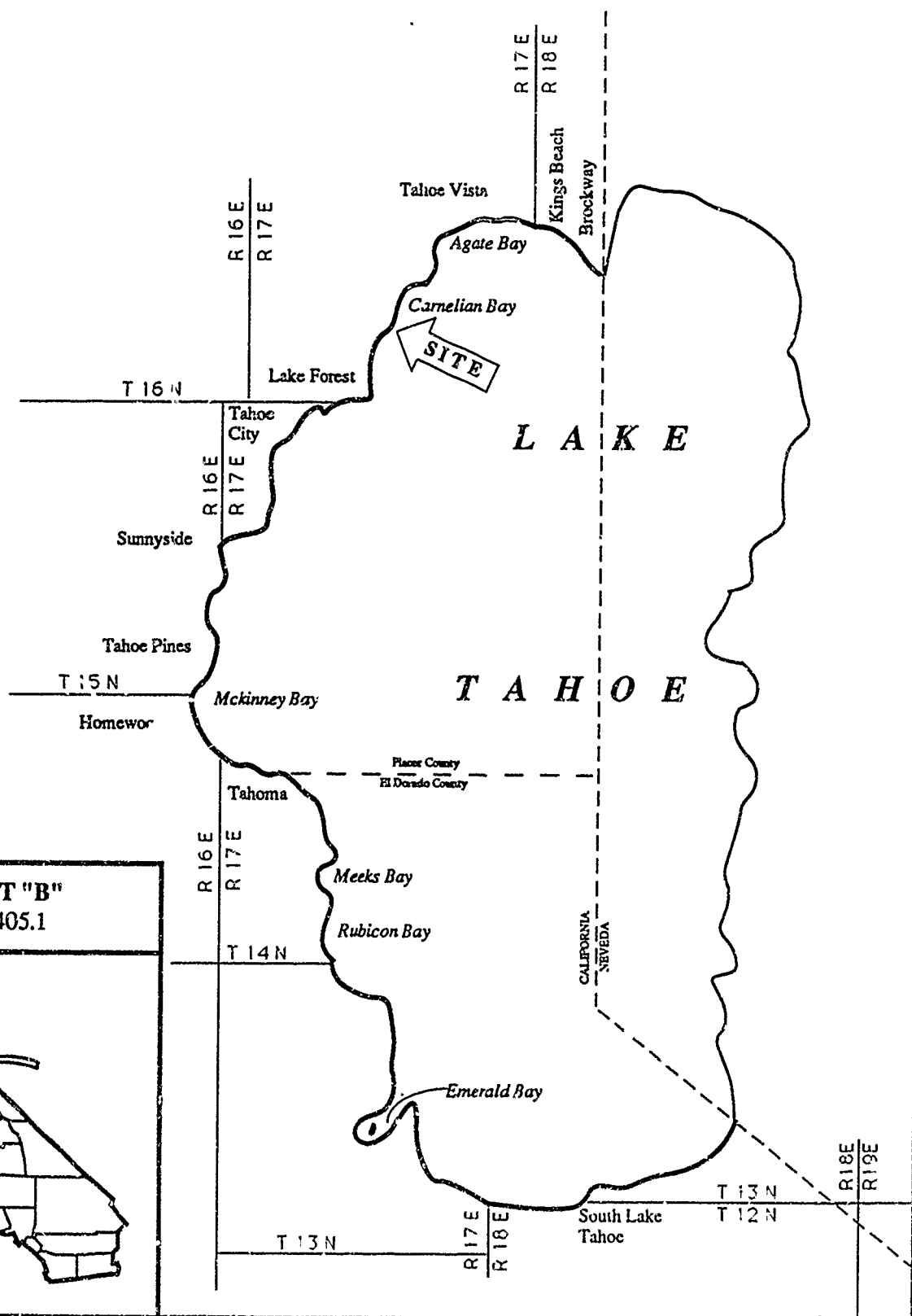

EXHIBIT "B"
PRC 5405.1



EXHIBIT "C"

Date September 18, 1989

File Ref: PRC 5405.9

Ms. Judy Ludlow
California State Lands Commission
1807 13th Street
Sacramento, California 95814

Subject: Building Permit for Pier (Reconstruction and expansion of
an existing pier plus the addition
of a low-level boatlift.)

Name: Elizabeth Lewis

Address P.O. Box 394

Tiburon, CA 94920

Placer County Assessor's Parcel No. 92-180-39

Upland Address: 4310 North Lake Boulevard

Dear Ms. Ludlow:

The County of Placer has received notice of the above-referenced project in Lake Tahoe and has no objection to the pier repair/construction or to the issuance of the State Lands Commission's permit.

If you have any questions, you may reach me at (916) ~~889-7870~~ 889-7584

Sincerely,

Eric Erickson for ERE

ERICK ERICKSON
Associate Civil Engineer

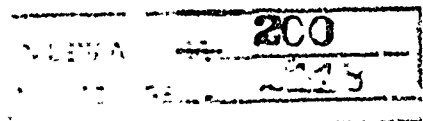
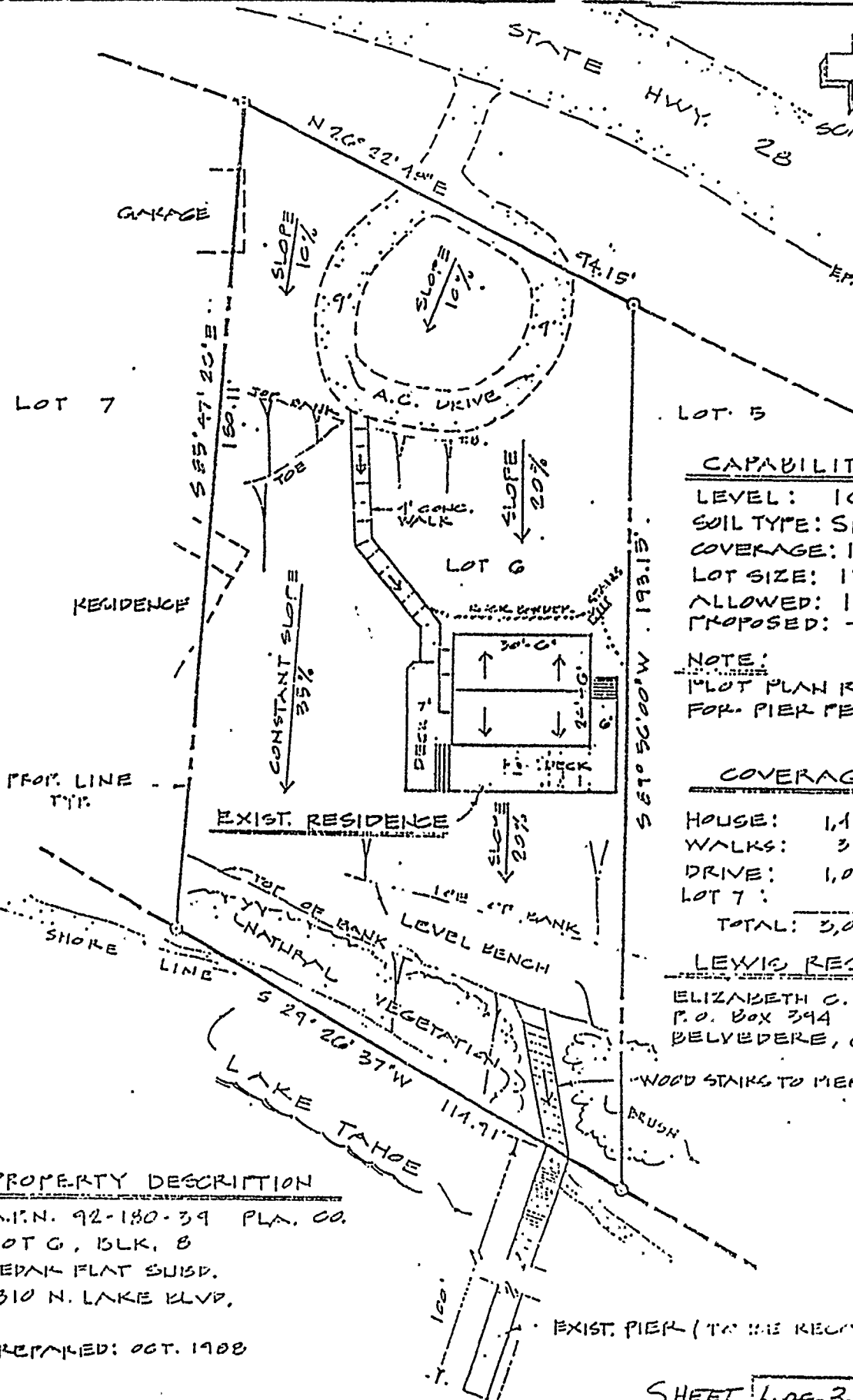

EXHIBIT "C"



SCALE: 1"=30'



CAPABILITY

LEVEL: 1C
 SOIL TYPE: SM
 COVERAGE: 1%
 LOT SIZE: 17,575^{sq}
 ALLOWED: 176^{sq}
 PROPOSED: 0

NOTE:
 PLOT PLAN REQUIRED
 FOR PIER PERMIT

COVERAGE

HOUSE: 1,100^{sq}
 WALKS: 392^{sq}
 DRIVE: 1,080^{sq}
 LOT 7: 99^{sq}
 TOTAL: 3,057^{sq}

LEWIS RESIDENCE

ELIZABETH C. LEWIS
 P.O. Box 394
 BELLEVILLE, CA. 94715

PROPERTY DESCRIPTION

A.P.N. 92-180-39 PLA. CO.
 LOT 6, BLK. B
 CEDAR FLAT SUBD.
 4310 N. LAKE BLVD.

PREPARED: OCT. 1988

SHEET

1 OF 3

201

MINUTE PAGE

PLAN
SCALE: 1" = 20'

EXISTING

SHEET 2 of 3

PIER RECONSTRUCTION

CEDAR FLAT, L. TAHOE
PLACER CO., CA.
4310 NO. LAKE BLVD.

APPLICANT:

ELIZABETH C. LEWIS
P.O. BOX 394
BELVEDERE, CA. 94920

202
A.P.N. 92-180-391
MINUTE PAGE

PLAN
SCALE: 1" = 20'

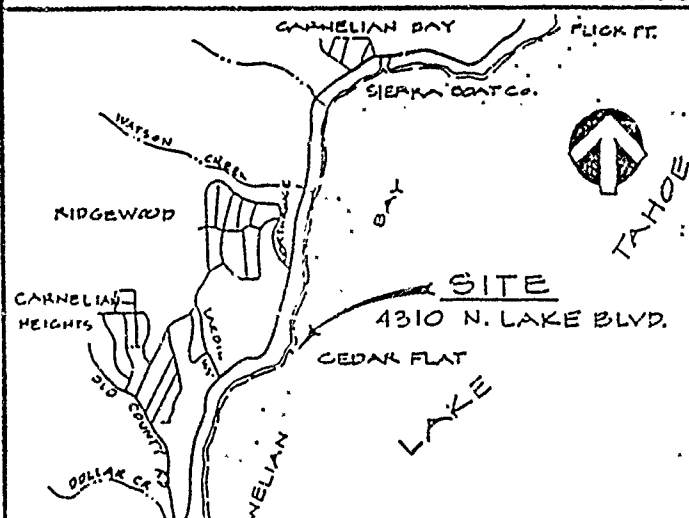
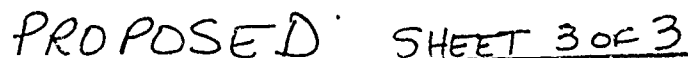

CEDAR FLAT, L. TAHOE.
PLACER CO., CA.
4310 NO. LAKE BLVD.

APPLICANT:

ELIZABETH C. LEWIS
P.O. BOX 394
BELVEDERE, CA. 94008

A.P.N. 92-180-39-~~BLK~~ 2800

WATERGATE

STATE LANDS COMMISSION

LEO T. McCARTHY, Lieutenant Governor
GRAY DAVIS, Controller
THOMAS W. HAYES, Director of Finance

EXECUTIVE OFFICE
1807 - 13th Street
Sacramento, CA 95814

CHARLES WARREN
Executive Officer

PROPOSED NEGATIVE DECLARATION

File: PRC 5405
ND 591
SCH No. 92052040

Project Title: Lewis Pier Reconstruction/Boat Lift Installation
Proponents: Elizabeth Lewis
Project Location: 4310 North Lake Blvd. (Hwy. 28), four miles east of Tahoe City, APN 92-180-39, Placer County.
Project Description: Authorization to repair/reconstruct an existing pier and boat hoist, and install a boat lift.
Contact Person: Doug Miller Telephone: 916/322-7826

This document is prepared pursuant to the requirements of the California Environmental Quality Act (Section 21000 et seq., Public Resources Code), the State CEQA Guidelines (Section 15000 et seq., Title 14, California Code Regulations), and the State Lands Commission regulations (Section 2901 et seq., Title 2, California Code Regulations).

Based upon the attached Initial Study, it has been found that:

☐ this project will not have a significant effect on the environment.

☒ mitigation measures included in the project will avoid potentially significant effects.

204
202

ENVIRONMENTAL IMPACT ASSESSMENT CHECKLIST - PART II

Form 13.26 (7/82)

File Ref. RRC 5405.1

I. BACKGROUND INFORMATION

- A. Applicant: Elizabeth Lewis c/o Jan Brisco- Agent
Brisco Enterprises
P.O. Box 7468
Tahoe City, CA 96145
- B. Checklist Date: / /
- C. Contact Person: Doug Miller
 Telephone: (916) 322-7826
- D. Purpose: Proposed pier reconstruction and install a low level boat lift.
- E. Location: 4310 North Lake Blvd. (Highway 28) Cedar Flat Area, four miles east of
Tahoe City, Placer County APN 92-180-39
- F. Description: Authorization to repair/reconstruct an existing pier and boat hoist.
and install a boat lift.
- G. Persons Contacted: Jan Brisco- Agent
Jim Hamilton- TRPA - Tahoe Regional Planning Agency
Jerry Mensch D.F.&G. - Department of Fish and Game

II. ENVIRONMENTAL IMPACTS. (Explain all "yes" and "maybe" answers)

A. Earth. Will the proposal result in:

Yes Maybe No

- | | | | |
|---|--------------------------|--------------------------|-------------------------------------|
| 1 Unstable earth conditions or changes in geologic substructures? | <input type="checkbox"/> | <input type="checkbox"/> | <input checked="" type="checkbox"/> |
| 2 Disruptions, displacements, compaction, or overcovering of the soil? | <input type="checkbox"/> | <input type="checkbox"/> | <input checked="" type="checkbox"/> |
| 3 Change in topography or ground surface relief features? | <input type="checkbox"/> | <input type="checkbox"/> | <input checked="" type="checkbox"/> |
| 4 The destruction, covering, or modification of any unique geologic or physical features? | <input type="checkbox"/> | <input type="checkbox"/> | <input checked="" type="checkbox"/> |
| 5 Any increase in wind or water erosion of soils, either on or off the site? | <input type="checkbox"/> | <input type="checkbox"/> | <input checked="" type="checkbox"/> |
| 6 Changes in deposition or erosion of beach sands, or changes in siltation, deposition or erosion which may modify the channel of a river or stream or the bed of the ocean or any bay, inlet, or lake? | <input type="checkbox"/> | <input type="checkbox"/> | <input checked="" type="checkbox"/> |
| 7 Exposure of all people or property to geologic hazards such as earthquakes, landslides, mudslides, ground failure, or similar hazards? | <input type="checkbox"/> | <input type="checkbox"/> | <input checked="" type="checkbox"/> |

205

223

- B. *Air*. Will the proposal result in:
- | | Yes | Maybe | No |
|---|--------------------------|--------------------------|-------------------------------------|
| 1. Substantial air emissions or deterioration of ambient air quality? | <input type="checkbox"/> | <input type="checkbox"/> | <input checked="" type="checkbox"/> |
| 2. The creation of objectionable odors? | <input type="checkbox"/> | <input type="checkbox"/> | <input checked="" type="checkbox"/> |
| 3. Alteration of air movement, moisture or temperature, or any change in climate, either locally or regionally? | <input type="checkbox"/> | <input type="checkbox"/> | <input checked="" type="checkbox"/> |
- C. *Water*. Will the proposal result in:
- | | | | |
|---|--------------------------|--------------------------|-------------------------------------|
| 1. Changes in the currents, or the course or direction of water movements, in either marine or fresh waters? | <input type="checkbox"/> | <input type="checkbox"/> | <input checked="" type="checkbox"/> |
| 2. Changes in absorption rates, drainage patterns, or the rate and amount of surface water runoff? | <input type="checkbox"/> | <input type="checkbox"/> | <input checked="" type="checkbox"/> |
| 3. Alterations to the course or flow of flood waters? | <input type="checkbox"/> | <input type="checkbox"/> | <input checked="" type="checkbox"/> |
| 4. Change in the amount of surface water in any water body? | <input type="checkbox"/> | <input type="checkbox"/> | <input checked="" type="checkbox"/> |
| 5. Discharge into surface water, or in any alteration of surface water quality, including but not limited to temperature, dissolved oxygen or turbidity? | <input type="checkbox"/> | <input type="checkbox"/> | <input checked="" type="checkbox"/> |
| 6. Alteration of the direction or rate of flow of ground waters? | <input type="checkbox"/> | <input type="checkbox"/> | <input checked="" type="checkbox"/> |
| 7. Change in the quantity of ground waters, either through direct additions or withdrawals, or through interception of an aquifer by cuts or excavations? | <input type="checkbox"/> | <input type="checkbox"/> | <input checked="" type="checkbox"/> |
| 8. Substantial reduction in the amount of water otherwise available for public water supplies? | <input type="checkbox"/> | <input type="checkbox"/> | <input checked="" type="checkbox"/> |
| 9. Exposure of people or property to water-related hazards such as flooding or tidal waves? | <input type="checkbox"/> | <input type="checkbox"/> | <input checked="" type="checkbox"/> |
| 10. Significant changes in the temperature, flow or chemical content of surface thermal springs? | <input type="checkbox"/> | <input type="checkbox"/> | <input checked="" type="checkbox"/> |
- D. *Plant Life*. Will the proposal result in:
- | | | | |
|--|--------------------------|--------------------------|-------------------------------------|
| 1. Change in the diversity of species, or number of any species of plants (including trees, shrubs, grass, crops, and aquatic plants)? | <input type="checkbox"/> | <input type="checkbox"/> | <input checked="" type="checkbox"/> |
| 2. Reduction of the numbers of any unique, rare or endangered species of plants? | <input type="checkbox"/> | <input type="checkbox"/> | <input checked="" type="checkbox"/> |
| 3. Introduction of new species of plants into an area, or in a barrier to the normal replenishment of existing species? | <input type="checkbox"/> | <input type="checkbox"/> | <input checked="" type="checkbox"/> |
| 4. Reduction in acreage of any agricultural crop? | <input type="checkbox"/> | <input type="checkbox"/> | <input checked="" type="checkbox"/> |
- E. *Animal Life*. Will the proposal result in:
- | | | | |
|--|--------------------------|--------------------------|-------------------------------------|
| 1. Change in the diversity of species, or numbers of any species of animals (birds, land animals including reptiles, fish and shellfish, benthic organisms, or insects)? | <input type="checkbox"/> | <input type="checkbox"/> | <input checked="" type="checkbox"/> |
| 2. Reduction of the numbers of any unique, rare or endangered species of animals? | <input type="checkbox"/> | <input type="checkbox"/> | <input checked="" type="checkbox"/> |
| 3. Introduction of new species of animals into an area, or result in a barrier to the migration or movement of animals? | <input type="checkbox"/> | <input type="checkbox"/> | <input checked="" type="checkbox"/> |
| 4. Deterioration to existing fish or wildlife habitat? | <input type="checkbox"/> | <input type="checkbox"/> | <input checked="" type="checkbox"/> |
- F. *Noise*. Will the proposal result in:
- | | | | |
|---|--------------------------|--------------------------|-------------------------------------|
| 1. Increase in existing noise levels? | <input type="checkbox"/> | <input type="checkbox"/> | <input checked="" type="checkbox"/> |
| 2. Exposure of people to severe noise levels? | <input type="checkbox"/> | <input type="checkbox"/> | <input checked="" type="checkbox"/> |
- G. *Light and Glare*. Will the proposal result in:
- | | | | |
|--|--------------------------|--------------------------|-------------------------------------|
| 1. The production of new light or glare? | <input type="checkbox"/> | <input type="checkbox"/> | <input checked="" type="checkbox"/> |
|--|--------------------------|--------------------------|-------------------------------------|
- H. *Land Use*. Will the proposal result in:
- | | | | |
|--|--------------------------|--------------------------|-------------------------------------|
| 1. A substantial alteration of the present or planned land use of an area? | <input type="checkbox"/> | <input type="checkbox"/> | <input checked="" type="checkbox"/> |
|--|--------------------------|--------------------------|-------------------------------------|
- I. *Natural Resources*. Will the proposal result in:
- | | | | |
|--|--------------------------|--------------------------|-------------------------------------|
| 1. Increase in the rate of use of any natural resources? | <input type="checkbox"/> | <input type="checkbox"/> | <input checked="" type="checkbox"/> |
| 2. Substantial depletion of any nonrenewable resources? | <input type="checkbox"/> | <input type="checkbox"/> | <input checked="" type="checkbox"/> |

- J. *Risk of Upset.* Does the proposal result in:
- | | Yes | Maybe | No |
|---|--------------------------|--------------------------|-------------------------------------|
| 1. A risk of an explosion or the release of hazardous substances (including, but not limited to, oil, pesticides, chemicals, or radiation) in the event of an accident or upset conditions? | <input type="checkbox"/> | <input type="checkbox"/> | <input checked="" type="checkbox"/> |
| 2. Possible interference with emergency response plan or an emergency evacuation plan? | <input type="checkbox"/> | <input type="checkbox"/> | <input checked="" type="checkbox"/> |
- K. *Population.* Will the proposal result in:
- | | | | |
|---|--------------------------|--------------------------|-------------------------------------|
| 1. The alteration, distribution, density, or growth rate of the human population of the area? | <input type="checkbox"/> | <input type="checkbox"/> | <input checked="" type="checkbox"/> |
|---|--------------------------|--------------------------|-------------------------------------|
- L. *Housing.* Will the proposal result in:
- | | | | |
|---|--------------------------|--------------------------|-------------------------------------|
| 1. Affecting existing housing, or create a demand for additional housing? | <input type="checkbox"/> | <input type="checkbox"/> | <input checked="" type="checkbox"/> |
|---|--------------------------|--------------------------|-------------------------------------|
- M. *Transportation/Circulation.* Will the proposal result in:
- | | | | |
|---|--------------------------|--------------------------|-------------------------------------|
| 1. Generation of substantial additional vehicular movement? | <input type="checkbox"/> | <input type="checkbox"/> | <input checked="" type="checkbox"/> |
| 2. Affecting existing parking facilities, or create a demand for new parking? | <input type="checkbox"/> | <input type="checkbox"/> | <input checked="" type="checkbox"/> |
| 3. Substantial impact upon existing transportation systems? | <input type="checkbox"/> | <input type="checkbox"/> | <input checked="" type="checkbox"/> |
| 4. Alterations to present patterns of circulation or movement of people and/or goods? | <input type="checkbox"/> | <input type="checkbox"/> | <input checked="" type="checkbox"/> |
| 5. Alterations to waterborne, rail, or air traffic? | <input type="checkbox"/> | <input type="checkbox"/> | <input checked="" type="checkbox"/> |
| 6. Increase in traffic hazards to motor vehicles, bicyclists, or pedestrians? | <input type="checkbox"/> | <input type="checkbox"/> | <input checked="" type="checkbox"/> |
- N. *Public Services.* Will the proposal have an effect upon, or result in a need for new or altered governmental services in any of the following areas:
- | | | | |
|---|--------------------------|--------------------------|-------------------------------------|
| 1. Fire protection? | <input type="checkbox"/> | <input type="checkbox"/> | <input checked="" type="checkbox"/> |
| 2. Police protection? | <input type="checkbox"/> | <input type="checkbox"/> | <input checked="" type="checkbox"/> |
| 3. Schools? | <input type="checkbox"/> | <input type="checkbox"/> | <input checked="" type="checkbox"/> |
| 4. Parks and other recreational facilities? | <input type="checkbox"/> | <input type="checkbox"/> | <input checked="" type="checkbox"/> |
| 5. Maintenance of public facilities, including roads? | <input type="checkbox"/> | <input type="checkbox"/> | <input checked="" type="checkbox"/> |
| 6. Other governmental services? | <input type="checkbox"/> | <input type="checkbox"/> | <input checked="" type="checkbox"/> |
- O. *Energy.* Will the proposal result in:
- | | | | |
|---|--------------------------|--------------------------|-------------------------------------|
| 1. Use of substantial amounts of fuel or energy? | <input type="checkbox"/> | <input type="checkbox"/> | <input checked="" type="checkbox"/> |
| 2. Substantial increase in demand upon existing sources of energy, or require the development of new sources? | <input type="checkbox"/> | <input type="checkbox"/> | <input checked="" type="checkbox"/> |
- P. *Utilities.* Will the proposal result in a need for new systems, or substantial alterations to the following utilities:
- | | | | |
|------------------------------------|--------------------------|--------------------------|-------------------------------------|
| 1. Power or natural gas? | <input type="checkbox"/> | <input type="checkbox"/> | <input checked="" type="checkbox"/> |
| 2. Communication systems? | <input type="checkbox"/> | <input type="checkbox"/> | <input checked="" type="checkbox"/> |
| 3. Water? | <input type="checkbox"/> | <input type="checkbox"/> | <input checked="" type="checkbox"/> |
| 4. Sewer or septic tanks? | <input type="checkbox"/> | <input type="checkbox"/> | <input checked="" type="checkbox"/> |
| 5. Storm water drainage? | <input type="checkbox"/> | <input type="checkbox"/> | <input checked="" type="checkbox"/> |
| 6. Solid waste and disposal? | <input type="checkbox"/> | <input type="checkbox"/> | <input checked="" type="checkbox"/> |
- Q. *Human Health.* Will the proposal result in:
- | | | | |
|--|--------------------------|--------------------------|-------------------------------------|
| 1. Creation of any health hazard or potential health hazard (excluding mental health)? | <input type="checkbox"/> | <input type="checkbox"/> | <input checked="" type="checkbox"/> |
| 2. Exposure of people to potential health hazards? | <input type="checkbox"/> | <input type="checkbox"/> | <input checked="" type="checkbox"/> |
- R. *Aesthetics.* Will the proposal result in:
- | | | | |
|--|--------------------------|--------------------------|-------------------------------------|
| 1. The obstruction of any scenic vista or view open to the public, or will the proposal result in the creation of an aesthetically offensive site open to public view? | <input type="checkbox"/> | <input type="checkbox"/> | <input checked="" type="checkbox"/> |
|--|--------------------------|--------------------------|-------------------------------------|
- S. *Recreation.* Will the proposal result in:
- | | | | |
|---|--------------------------|--------------------------|-------------------------------------|
| 1. An impact upon the quality or quantity of existing recreational opportunities? | <input type="checkbox"/> | <input type="checkbox"/> | <input checked="" type="checkbox"/> |
|---|--------------------------|--------------------------|-------------------------------------|

207
PAGE 125

T. *Cultural Resources.*

Yes Maybe No

1. Will the proposal result in the alteration of or the destruction of a prehistoric or historic archeological site? ☐ ☐ ☒
2. Will the proposal result in adverse physical or aesthetic effects to a prehistoric or historic building, structure, or object? ☐ ☐ ☒
3. Does the proposal have the potential to cause a physical change which would affect unique ethnic cultural values? ☐ ☐ ☒
4. Will the proposal restrict existing religious or sacred uses within the potential impact area? ☐ ☐ ☒

U. *Mandatory Findings of Significance.*

1. Does the project have the potential to degrade the quality of the environment, reduce the habitat of a fish or wildlife species, cause a fish or wildlife population to drop below self-sustaining levels, threaten to eliminate a plant or animal community, reduce the number or restrict the range of a rare or endangered plant or animal or eliminate important examples of the major periods of California history or prehistory? ☐ ☐ ☒
2. Does the project have the potential to achieve short-term, to the disadvantage of long-term, environmental goals? ☐ ☐ ☒
3. Does the project have impacts which are individually limited, but cumulatively considerable? ☐ ☐ ☒
4. Does the project have environmental effects which will cause substantial adverse effects on human beings, either directly or indirectly? ☐ ☐ ☒

III. DISCUSSION OF ENVIRONMENTAL EVALUATION (See Comments Attached)

see attached

IV. PRELIMINARY DETERMINATION

On the basis of this initial evaluation:

- ☐ I find the proposed project COULD NOT have a significant effect on the environment, and a NEGATIVE DECLARATION will be prepared.
- ☒ I find that although the proposed project could have a significant effect on the environment, there will not be a significant effect in this case because the mitigation measures described on an attached sheet have been added to the project. A NEGATIVE DECLARATION will be prepared
- ☐ I find the proposed project MAY have a significant effect on the environment, and an ENVIRONMENTAL IMPACT REPORT is required.

Date: 4/30/92

Doug Miller 203
For the State Lands Commission
PAGE 125

PROJECT DESCRIPTION

PROJECT NARRATIVE

PRC 5405.1 authorizes the use of a recreational pier. The proposed project involves the authorization for the reconstruction of the existing recreational pier, and installation of an electric low level boat lift (hoist) immediately adjacent to the pier (See attached plan: Exhibit "A"). The repairs will consist of removal and replacement of all rotten wood pilings, stringers, and decking for the pier and boat lift.

The reconstruction will use steel pilings, steel H beams, wood stringers and wood decking. The repair will be accomplished through use of a "Lark" vessel, a boat/floating barge with over inflated tires which allows it to leave the water and come up on the beach. Access to the site will be completely from the water for both materials and equipment. The low level boat lift is affixed to a single self supportive 10 inch H beam driven into the lake bottom making the whole system independent of the pier. The H beam will be driven at the same time the rest of the piers are driven.

The first stage of the construction will be to remove the old structure. Access will be from the lark vessel and the existing structure. Disturbance will be restricted to the footprint of the existing structure plus a ten foot construction zone running the complete pier length on one side of the pier. The ten foot construction zone location will be determined at the TRPA reconstruction meeting.

The pier will be dismantled from the beach end to the lake end. The pilings will be removed by a clam-shell type attachment to the pile driver on the lark vessel. The second phase will consist of driving the new steel piles in a single (centered) piling style spaced 15 ft. apart, for the first 70 ft., and then changing to a double piling configuration, also spaced 15 feet apart for the rest of the length of the pier. The new pilings will be driven whenever possible into the old piling holes of the previous structure. If this is not possible, the new pilings will be driven as close to the old hole as structurally permissible.

The pilings located below 6223 ft. will be driven by the pile driver mounted on the "Lark" vessel while it is in the lake. Pilings located above the lake level will be accessed from the "Lark" while within the 10 ft. construction zone. Both sides of the pier can be accessed by the pile driver from the construction zone. Next the H beams will be attached to the pilings, the stringers mounted on the H beams, the decking installed, and the

203

127

boat lift constructed. This will all be accomplished within the existing footprint of the pier and boat hoist, plus the 10 ft. construction zone on one side of the pier. The materials generated by the demolition and materials for the reconstruction will be stored on the "Lark" vessel or within the construction zone.

CONSTRUCTION METHOD

This project consists of the removal of the existing rotten wooden pilings and replacing them with 10-3/4" diameter steel piling, "H" beam caps, wood stringers, and wood decking. The low level boat lift is proposed for the south side of the pier. Best practical control technology shall be employed to prevent earthen materials to be resuspended as a result of pier construction and from being transported to adjacent lake waters. The applicant shall install a turbidity screen around the entire construction site (in the water), or use caissons or vertical cylinders (sleeves) to prevent the release of resuspended sediments during pile placement activities from entering the lake. Small boats and/or tarps will be placed under the reconstruction area as necessary to collect construction debris. If disturbed lakebottom sediments are found due to the construction activity associated with the installation of this project, the affected areas will be hand rolled and/or rock cobble to be hand picked to reconsolidate the lakebottom sediments. There will be no storage of materials above the low water line of the subject property.

DESCRIPTION OF ENVIRONMENTAL SETTING

PRC 5405.1

The proposed reconstruction project is located at 4310 North Lake Blvd., Placer County, California. This is a private residence in the Cedar Flat area, approximately four miles east of Tahoe City on Highway 28 (North Lake Blvd.). The present use of the area is private recreation. A pier and boat hoist presently exist on site. The Carnelian Bay shoreline is very rocky, generally offering little habitat for Tahoe Yellow Cress, Rorippa subumbellata.

SITE DESCRIPTION

The Lewis property and the two adjacent lots presently have piers. There is a back beach bank; the homes sit high above the lake level on a bluff. Each pier has stairs which descend the steep bank to the pier level. Although beach access is possible, the use of the piers does not require any foot traffic between the elevation of 6232 ft. and 6223 ft. The survey area includes both neighboring piers since the distance from the Lewis pier to the two adjacent piers is approximately 83 ft. and 76 ft. There is an established path through the rocks on the north side of the Lewis pier, probably created for boat launching of water access. The lake level was recorded at 6222.4 ft. at Tahoe City on the date of the survey.

SUBSTRATE AND TOPOGRAPHY

The substrate on the site consists of unsorted rock 6 to 8 inches in diameter with occasional small boulders overlying a sand and silt mixture at a minimum depth of 2 inches. There is one pocket of a sand/clay mixture adjacent to the Lewis pier which is orange in color and does not appear to be derived from native material. Within the survey area there are two sand pockets, both adjacent to the neighboring piers. The sand is well sorted, and approximately 1 mm. in size.

The topography of the beach is a gentle steady upslope from 6224 ft up to a steep back beach bank at 6232 ft. At the maximum lake elevation, beach exists at this site. No back beach depressions or wave berms are present. High and low water levels are indicated in relation to the pier on the attached map Exhibit "A" along with the topographic profile of the site.

VEGETATION

There is very little vegetation present on the site, which is typical of the rocky shoreline areas around Lake Tahoe. The species noted in the survey are scattered primarily in the back beach area. Willow, mullein and willow herb are the most common, being scattered across the beach; the other species are quite sparse.

211
229

CONCLUSIONS

TYC was not found within the survey area nor has it ever been documented to occur in the general area of Cedar Flat. The closest documented sighting of TYC to the Lewis property is a 1949 reference for Agate Bay which is presently considered to be extirpated (Ferreira et al 1991). The rocky schoreline of Carnelian Bay does not offer the typical sand/cobble substrate with which TYC is associated, nor does the steepness of the shoreline offer much width at either minimum or maximum lake levels. The two small pockets of sand present are the size sand substrate TYC is most commonly associated with; however, the low elevation of the pockets, the small size, and the isolated nature, reduce the possibility of producing TYC habitat. Besides willows, the typical plantspecies with which TYC is associated are not present at this site. Ms. Jean E. Ferreira states in her *Rorippa Subumbellata* report for the Lewis property: "The Lewis property as surveyed on May 13, 1991 does not offer good potential or present habitat for TYC."

The shorezone in the area of the proposed project is mapped as spawning habitat on the Prime Fish Habitat Maps identified by the Tahoe Regional Planning Agency. There are existing piers located approximately 20 feet north and 60 feet south of the Lewis' property lines.

222
230

DISCUSSION OF ENVIRONMENTAL EVALUATION
LEWIS RECREATIONAL
PIER RECONSTRUCTION AND BOAT LIFT PROJECT

PRC 5405.1

A. Earth

1. Earth Conditions

No. The pier reconstruction and boat lift project is confined to the surface and will not create any unstable conditions or change any geological structure.

2. Compaction, Overcovering of Soil

No. The pier reconstruction operation will be essentially confined to the footprint of the existing pier. See exhibit A. There will be no overcovering of lake bottom strata or upland soils during pier reconstruction because of the open pile design of the pier..

3. Topography

No. This open piling pier reconstruction project will not create any changes in ground surface relief. There will not be any excavating. This project will not create any new significant impacts to ground surface relief.

4. Unique Features

No. The geology in the project area consists of glacial and alluvial deposits. The lake bed at the site is essentially flat and lacks unique features. The removal and driving of replacement piles for the pier and the H beam for the boat lift will not change any geological or physical features.

5. Erosion

No. This pier reconstruction project is simply repairing an existing structure and will have no effect on wind or water erosion on or off the site.

6. Siltation

No. This project is a repair project confined to an existing structure which will not create any channel changes nor erosion of non-existent beach sands. The beach is comprised of cobble with very little sand present to erode.

7. Geologic Hazards

No. The reconstruction of the existing pier and installation of the low level boat lift are not deep enough to induce any seismic instabilities or ground failures. The pilings and H beam being driven in to support the pier and boat lift will not create any new significant geological impacts or hazards.

B. Air

1. Emissions

No. The reconstructed pier and boat lift will not affect the air quality. However, during construction hours, there will be about a four week period when fumes from the diesel engine will be emitted in the immediate vicinity of the project. These emissions will be immediately dispersed by the prevailing winds. Upon completion this proposed pier reconstruction project will not create any new significant emissions.

2. Odors

No. The reconstructed pier and boat lift will not create objectionable odors. However, during construction hours, there will be about a four week period when fumes from the diesel engine will be noticeable in the immediate vicinity of the project. These emissions will be immediately dispersed by the prevailing winds. Upon completion this proposed pier reconstruction project will not create any new significant emissions.

3. Climate

No. The reconstructed pier and boat lift will not create any major changes in air movements, temperature, or climate, nor create any abnormal weather conditions.

C. Water

1. Currents

No. The boat lift (H beam piling), and replaced piles supporting the pier are of a static nature and will not create any changes in water currents or movements.

2. Runoff

No. The existing buoy, boat lift, and replaced pilings of the existing pier will not affect absorption rates, drainage patterns, etc. The area adjacent to the pier is submerged.

3. Flood Waters

No. The reconstructed existing pier and boat lift will not create any new effects upon flood waters.

4. Surface Water

No. The reconstructed pier and boat lift are static in nature and will not affect the area of surface water at Lake Tahoe.

5. Turbidity

No. Mitigation measures required by the Tahoe Regional Planning Agency (TRPA) include the applicant installing a turbidity screen around the entire construction site (in the water), or using caissons or vertical cylinders (sleeves) to prevent the release of resuspended sediments during pile (includes H beams) placement activities from entering the lake. Small boats and/or tarps will be placed under the reconstruction area as necessary to collect construction debris. The reconstructed pier and boat lift will not change the water quality.

6. Ground Water Flows

No. The geology of the project area is composed of glacial and alluvial deposits. The replacement of the existing pilings for the pier and the H beam for the boat lift are all relatively shallow operations and should not affect ground water flows.

7. Ground Water Quantity

No. This project will not alter any aquifers nor consume any ground water. There will not be any changes to ground water quantity caused by the installed boat lift, or reconstructed pier.

8. Water Supplies

No. This is not a water consuming project. The boat lift, and the repaired pier will have no effect on public water supplies.

9. Flooding

No. The new boat lift and repaired existing pier will not expose people or property to water-related hazards such as tidal waves or induce flooding.

10. Thermal Springs

No. There are no thermal springs in the vicinity which

213
233

could be affected by this project.

D. Plant Life

1. Species Diversity

No. There will be a temporary change in aquatic sessile plants during the reconstruction period which will be approximately four weeks. This temporary change will only affect the construction area which will be isolated by a turbidity screen, caisson, etc. This will not constitute a permanent or significant change. The indigenous aquatic flora will shortly begin recolonizing the affected area after the project has been completed. The impact to aquatic plants will be temporary.

2. Endangered Species

No. There are no rare or endangered species on the property. In the report for Tahoe Yellow Cress (Rorippa subumbellata) habitat, no TYC was found on the project property or adjacent properties.

3. Introduction of Plants

No. The pier reconstruction and boat lift project will not introduce new species to the area nor exclude existing species from becoming established.

4. Agriculture Crops

No. The reconstruction project will not reduce the acreage of agricultural crops. There are no known agriculture or aquaculture activities in this area; therefore, there will be no impacts.

E. Animal Life

1. Species Diversity

No. There will be a temporary disruption in aquatic animal life confined to the actual reconstruction area by the turbidity screens. The construction period will be approximately four weeks. Upon completion of the project, the indigenous aquatic fauna will begin to re-occupy any voids created during the repair operation. The reconstruction project will be conducted during the non-spawning season, identified to be between July 1, 1992 and September 15, 1992 to minimize the impact on fish spawning habitat.

2. Endangered Species

No. There have not been any rare or endangered aquatic animals reported within the project area. No impacts are anticipated.

3. Introduction of Plants

No. The pier reconstruction and boat lift project will not introduce any new species to the area nor create a new barrier to aquatic animals.

4. Habitat Deterioration

No. The reconstruction project will not reduce the aquatic animal habitat area upon completion.

F. Noise

1. Increases

No. The repaired private recreational pier and boat lift will not increase existing noise levels. There will be short term additional noises during the reconstruction period, but there will not be an increase in long term noise levels.

2. Severe Noise

No. The repaired pier and boat lift will not create any new severe noise levels; however, there will be a temporary period when the noise levels increase during the period of reconstruction. Upon completion of the project, the noise levels will return to normal. The construction personnel will be subjected to higher noise levels, but they wear hearing protective devices. The general public will not be exposed to this increased noise level because the private property between the project and Highway 28 will act as a buffer.

G. Light and Glare

1. No. Neither the reconstructed pier or boat lift will result in creating any new significant light or glare.

H. Land Use

1. No. The repair of the existing private recreational pier and boat lift will not alter the present or planned use of the area. The existing pier serves a private residence and not the general public. There are presently piers on adjacent properties. This project will not substantially alter the land use in the area.

I. Natural Resources

1. Increase in Use

No. The continued seasonal recreational use of this private pier by the Lewis family will not create any new effects upon the use rate of the natural resource.

2. Depletion of any Nonrenewable Resources

No. The Lewis family's seasonal use of their private recreational pier will not create any changes which could deplete any nonrenewable resource.

J. Risk of Upset

1. Risk of Explosion

No. The project involves the dismantling and reconstruction of an existing pier. The "Lark" vessel being used is diesel operated which reduces the risk of explosion. Hazardous materials are not to be used during the reconstruction phase, but mitigation measures have been planned in the event that there is an accidental spill.

Small boats and/or tarps will be placed under the reconstruction area as necessary to collect construction debris. The use of a turbidity screen surrounding the construction area or caissons or vertical cylinders (sleeves) will be required to prevent the release of resuspended sediments during the pile placement activities from entering the lake during reconstruction.

The past limited seasonal use of this and adjacent private family recreational piers have not demonstrated a risk of releasing hazardous substances, creating upset conditions, or explosions in the Lake Tahoe Basin. Precautions will be taken to minimize these risks.

2. Emergency Plan Response

No. The seasonal use of the Lewis's existing private recreational pier and low level boat lift will not create an interface with any emergency response or any evacuation plan.

K. Population

1. No. The seasonal use of the existing Lewis family

SEARCHED	243
SERIALIZED	235

recreational pier will not alter the population in the lake basin.

L. Housing

1. No. Neither this existing private recreational pier nor boat lift will create a demand for additional housing.

M. Transportation/Circulation

1. Vehicular Movement

No. This is a private residence and the pier and boat lift is for the benefit of the members of the Lewis family and not the general public. There are no facilities being added to attract more people. The use of this private residence will not be changed by this project nor will there be any substantial increase in vehicle movement created by this project.

2. Parking

No. See #1 above.

3. Transportation System

No. See #1 above.

4. Circulation

No. See #1 above.

5. Traffic

No. See #1 above.

6. Traffic Hazards

No. See #1 above.

N. Public Services

1. Fire Protection

No. This is a private residence and the repaired pier and boat lift will not create any additional use or increase of use by the general public. This project will not create any new demands on government agencies and services such as fire, police protection, parks and recreation, road maintenance, etc.

2. Police Protection

No. See #1 above.

3. Schools

No. See #1 above.

4. Parks and Recreation Facilities

No. See #1 above.

5. Maintenance of Public Facilities

No. See #1 above.

6. Government services

No. See #1 above.

O. Energy

1. Fuel and Energy

1

No. This pier repair project will not have any significant affect on additional energy consumption. The boat lift is powered by a 1 hp., single phase 230 volt, 60 cycle, 7.15 amp electric motor. This is equivalent to about sixteen 100 watt light bulbs. The lift is only used when lowering or raising the boat. This use will not constitute a substantial increase in energy being used in the Lake Tahoe Basin.

2. Existing Energy Sources

No. See #1 above.

P. Utilities

1. Power or Natural Gas

No. The reconstruction of the private recreational pier will not create any changes in utilities. This project is for the private benefit of the Lewis family. There will be no additions to the existing facilities which will significantly affect the current uses of power, communications, water, septic tanks, storm water drainage, or solid waste disposal.

2. Communication Systems

No. See #1 above.

3. Water

No. See #1 above.

4. Sewer or Septic Tanks

No. See #1 above.

5. Storm Water Drainage

No. See #1 above.

6. Solid Waste Disposal

No. See #1 above.

Q. Human Health

1. Health Hazard

No. This repaired private recreational pier and boat lift will not create any new health hazards to humans.

2. Exposure of People to Health Hazards

No. The repaired private recreational pier will not expose people to any new potential health hazards.

R. Aesthetics

1. No. The Lewis' recreational pier is an existing facility. There are no new facilities being added. The reconstruction of the pier will not be a distraction from the aesthetics of this residential recreational area consisting of homes, piers, buoys and boats.

S. Recreation

1. No. The repair of this private recreational pier will have no effect on public recreation in the area.

T. Cultural Resources

1. Archaeological Sites

No. This project consists of repairing an existing private recreational pier and installing a boat lift within the footprint of the existing pier. There are no identified cultural, ethnic, religious, or sacred uses pertinent to this project area which could be significantly affected.

2. Historic Buildings
No. See No.# 1 above.
3. Ethnic Cultural Values
No. See No.# 1 above.
4. Religious/Sacred Uses
No. See No.# 1 above.

U. Mandatory Findings of Significance

1. Environmental Quality Degradation

No. The open pile designed pier is to be reconstructed in its footprint. There will be about a four week period during reconstruction when the indigenous aquatic biota will be displaced but will recolonize and return to normal after the project is completed. Mitigation measures, including turbidity screens or caissons or vertical sleeves will be incorporated to protect Lake Tahoe during the reconstruction phase of the operation. With the mitigation measures incorporated into the reconstruction process, this project will not create any long term significant degradational environmental effects.

2. Short Term vs. Long Term Environmental Goals

No. There will be a short term, approximately four weeks, disruption of the marine environment in the immediate vicinity of the pier being repaired. This area will be separated by a turbidity screen or the use of caissons or vertical cylinders (sleeves) to prevent the release of resuspended sediments during pile placement activities as determined by TRPA. Upon completion of the project, the indigenous marine biota will re-colonize and fill any voids created during the pier reconstruction. There will not be any long term significant degradational environmental changes created by this project.

3. Cumulative Impacts

No. The Lewis' private family recreational pier is an existing facility. The pier repair and the boat lift project do not add or create any new impacts which will increase the propensity for considerable cumulative effects.

4. Adverse Effects on Human Beings

No. This private pier reconstruction boat lift project will not create any new environmental effects which could create a significant adverse effect on human beings.

EXHIBIT "C "
MONITORING PROGRAM
FOR THE LEWIS PIER RECONSTRUCTION AND BOAT LIFT PROJECT

1. Impact: The proposed project may cause minimal turbidity to lake waters during the driving of piling into the lake bed, and there is the possibility of an upset or spill of construction materials or debris.

Project Modification:

- a) The use of either a turbidity screen surrounding the project area will be installed prior to the commencement of operations or the use of caissons or vertical cylinders (sleeves) to prevent the release of resuspended sediments during pile placement activities will be determined by TRPA prior to construction;
- b) Small boats and/or tarps will be placed under the reconstruction area as necessary to collect construction debris; and,
- c) Waste materials will be collected onto the lark vehicle or dumpsters for disposal at an approved landfill site.

Monitoring:

Staff of the State Lands Commission, or its designated representative, will periodically monitor the pier reconstruction and boat lift project during the placement of the pilings.

2. Impact: The proposed project is located in designated fish spawning habitat and could have an impact on the habitat.

Project Modification:

The pier reconstruction project involving disturbance to the lake bed will be conducted during the non-spawning season, identified to be between July 1 - September 15, to reduce impacts to fish habitat.

Monitoring:

Staff of the State Lands Commission, or its designated representative, will periodically site inspect the pier reconstruction project to ensure the proposed activity will occur within the allowable construction time period.

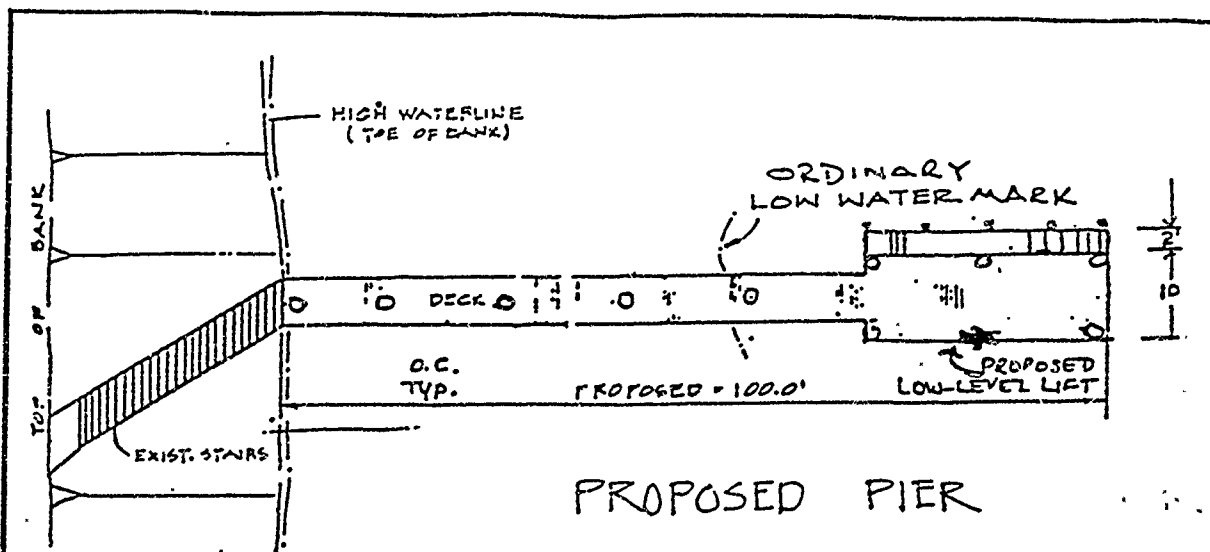

PROPOSED PIER

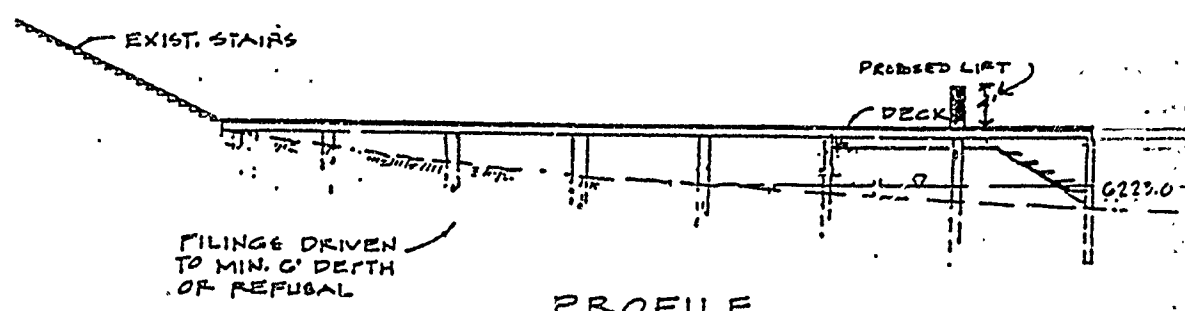

PROFILE
 SCALE: HORIZ. 1" = 20'
 VERT. 1" = 20'

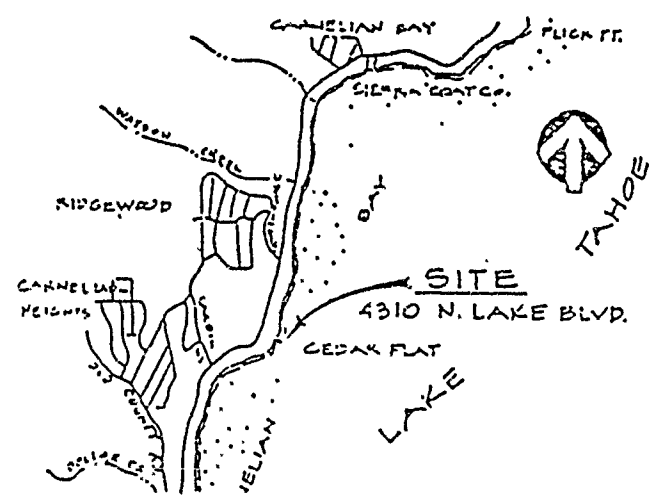
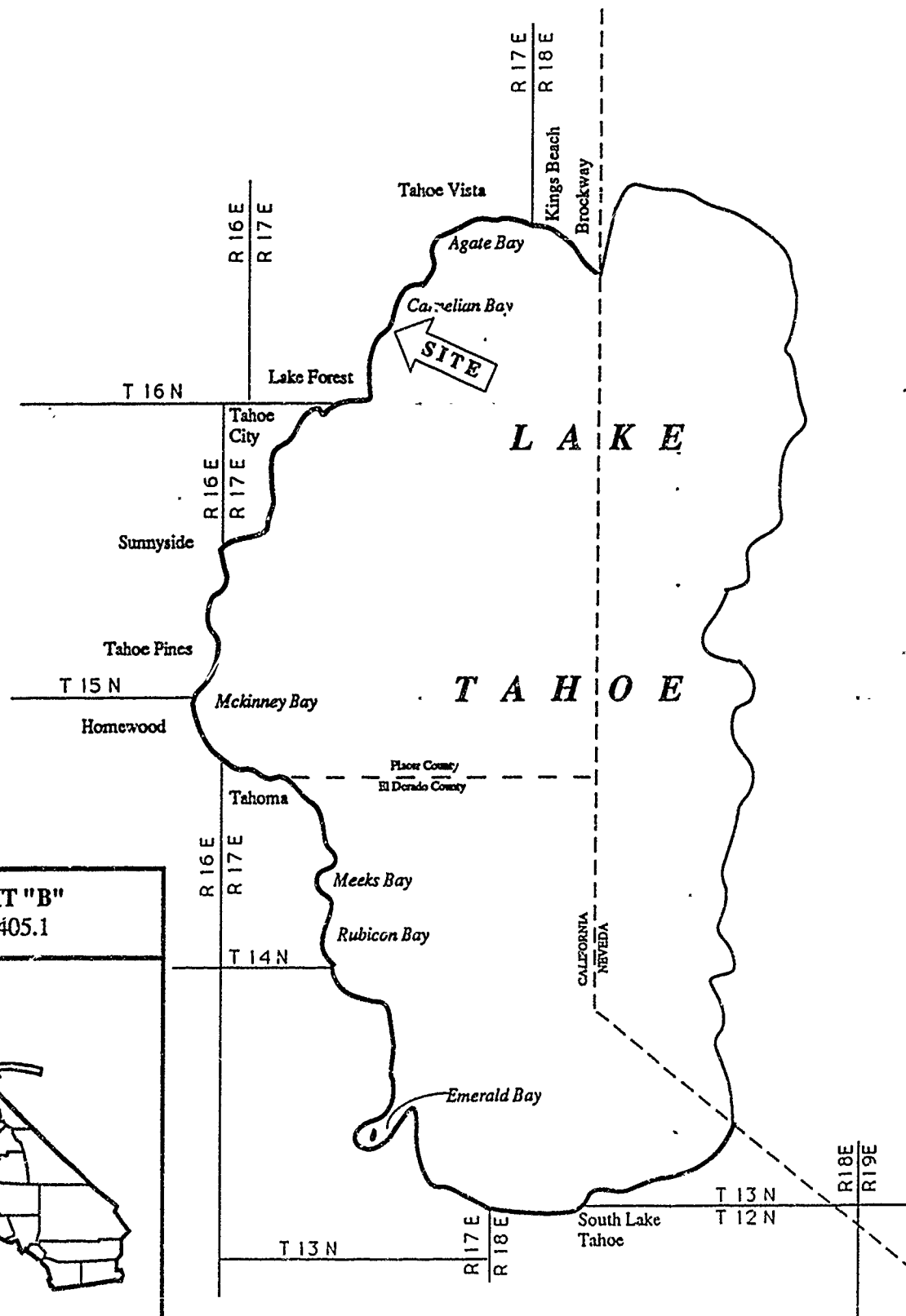

EXHIBIT "A"
 Site Map
 PRC 5405.1
 Pier Reconstruction
 APN 92 - 180 - 39
 Lake Tahoe
 PLACER COUNTY





EXHIBIT "B"
PRC 5405.1



227
2145