

MINUTE ITEM

This Calendar Item No. C14
was approved as Minute Item
No. 14 by the State Lands
Commission by a vote of 3
to 0 at its 7/15/91
meeting.

CALENDAR ITEM

C 1 4

07/15/91
W 24208 PRC 7550
J. Ludlow

A 1
S 4

**APPROVAL OF A GENERAL PERMIT -
PUBLIC AGENCY USE**

APPLICANT:

City of Redding
Department of Planning and Community Development
760 Parkview Avenue
Redding, California 96001-3396

AREA, TYPE LAND AND LOCATION:

A .02-acre parcel of submerged land located in the
Sacramento River, City of Redding, Shasta County.

LAND USE:

Proposed construction, use and maintenance of a boat
launching facility.

TERMS OF PROPOSED PERMIT:

Initial period: Twenty years beginning June 1, 1991.

CONSIDERATION:

The public use and benefit; with the State reserving the
right at any time to set a monetary rental if the Commission
finds such action to be in the State's best interest.

BASIS FOR CONSIDERATION:

Pursuant to 2 Cal. Code Regs. 2003

APPLICANT STATUS:

Applicant is permittee of the upland.

PREREQUISITE CONDITIONS, FEES AND EXPENSES:

Filing fee and processing costs have been received.

STATUTORY AND OTHER REFERENCES:

A. P.R.C.: Div. 6, Parts 1 and 2: Div. 13.

B. Cal Code Regs.: Title 2, Div. 3: Title 14, Div. 6.

AB 984:

10/15/91

CALENDAR ITEM NO. 1 4 (CONT'D)

OTHER PERTINENT INFORMATION:

1. A Negative Declaration, SCH 88072608, was prepared and adopted for this project by the City of Redding. The State Lands Commission's staff has reviewed such document.
2. This activity involves lands identified as possessing significant environmental values pursuant to P.R.C. 6370, et seq. Based upon the staff's consultation with the persons nominating such lands and through the CEQA process, it is the staff's opinion that the project, as proposed, is consistent with its use classification.
3. The proposed boat ramp, which will be located on the Sacramento River, south of the South Bonnyview Bridge, is part of a riverfront park project the City of Redding has been interested in developing since the early 1980's. In 1986, the City purchased 6.1 acres and recently sold it to the State of California, Wildlife Conservation Board, for a boat launching facility. In late 1986, the State Department of Boating and Waterways became involved in the design and shared funding of the project.

This is, therefore, a joint project by the State Department of Fish and Game, Wildlife Conservation Board, State Department of Boating and Waterways, and the City of Redding.

The overall project will consist of the two-lane (30-foot wide) boat ramp; a 66-car/trailer parking lot; a small craft-launching beach for canoes and rafts; restroom facilities; picnic facilities and a 600-foot access road.

4. The annual rental value of the site is estimated to be \$50.00, which is the minimum annual rental for this type of permit.

APPROVALS OBTAINED:

City of Redding, Department of Fish and Game, Water Quality Control Board Waiver.

FURTHER APPROVALS REQUIRED:

United States Army Corps of Engineers and State Reclamation Board.

EXHIBITS:

- A. Land Description.
- B. Location Map.
- C. Negative Declaration and Notice of Determination.

IT IS RECOMMENDED THAT THE COMMISSION:

1. FIND THAT A NEGATIVE DECLARATION SCH 88072608, WAS PREPARED AND ADOPTED FOR THIS PROJECT BY THE CITY OF REDDING AND THAT THE COMMISSION HAS REVIEWED AND CONSIDERED THE INFORMATION CONTAINED THEREIN.
2. AUTHORIZE ISSUANCE TO THE CITY OF REDDING, DEPARTMENT OF PLANNING AND COMMUNITY DEVELOPMENT OF A 20-YEAR GENERAL PERMIT - PUBLIC AGENCY USE, EFFECTIVE JUNE 1, 1991, FOR THE CONSTRUCTION, USE AND MAINTENANCE OF A BOAT LAUNCHING FACILITY, ON THE LAND DESCRIBED ON EXHIBIT "A" ATTACHED, AND BY REFERENCE MADE A PART HEREOF.

LAND DESCRIPTION

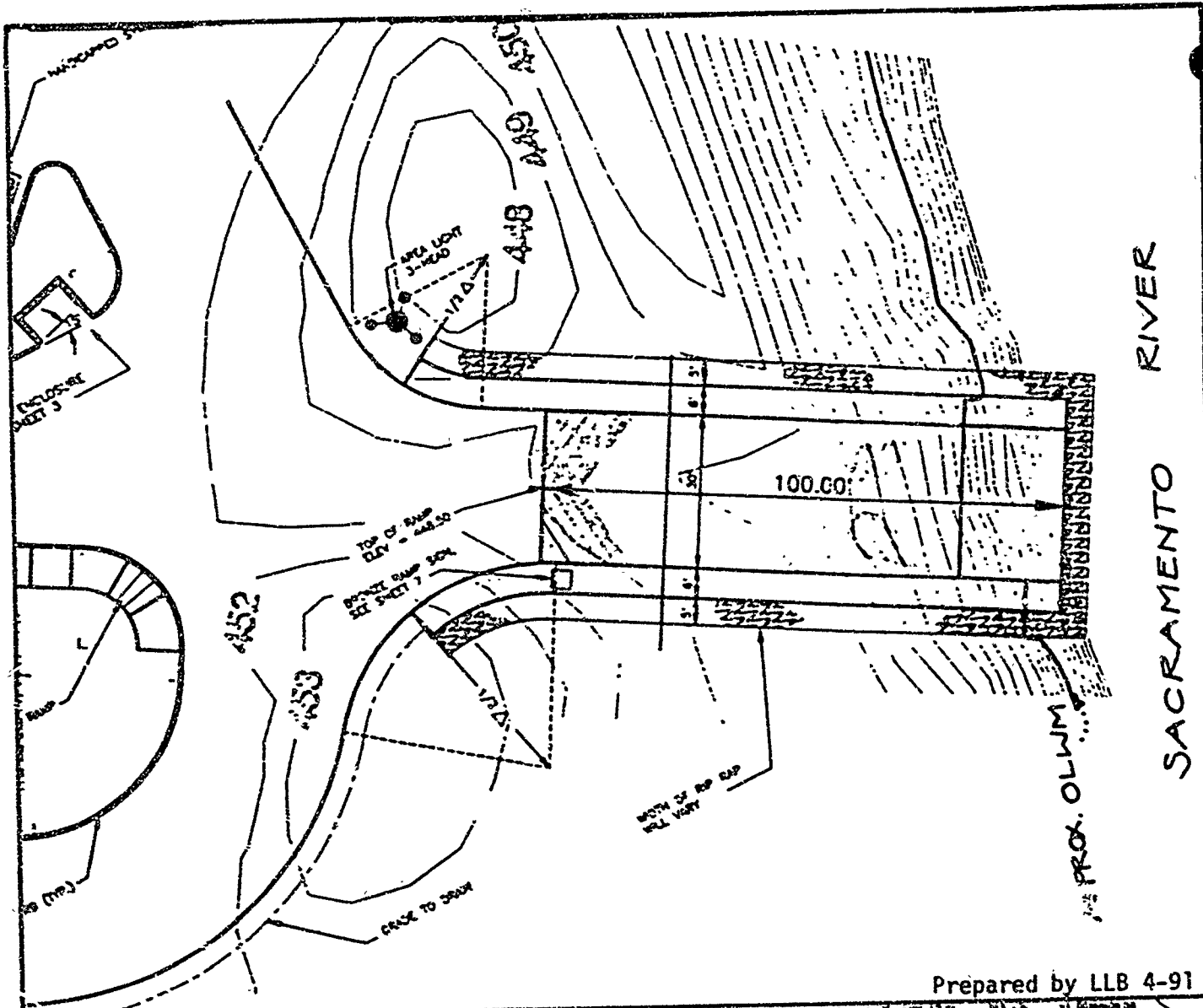

SACRAMENTO RIVER

PROX. OLWM

Prepared by LLB 4-91

EXHIBIT "A"
W 24208

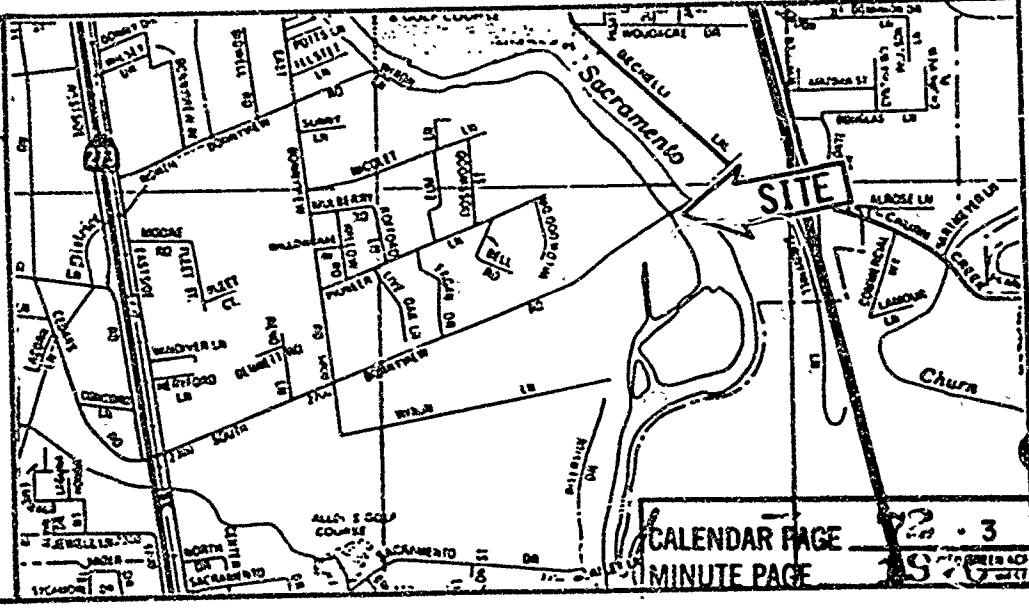

CALENDAR PAGE 3
MINUTE PAGE 3

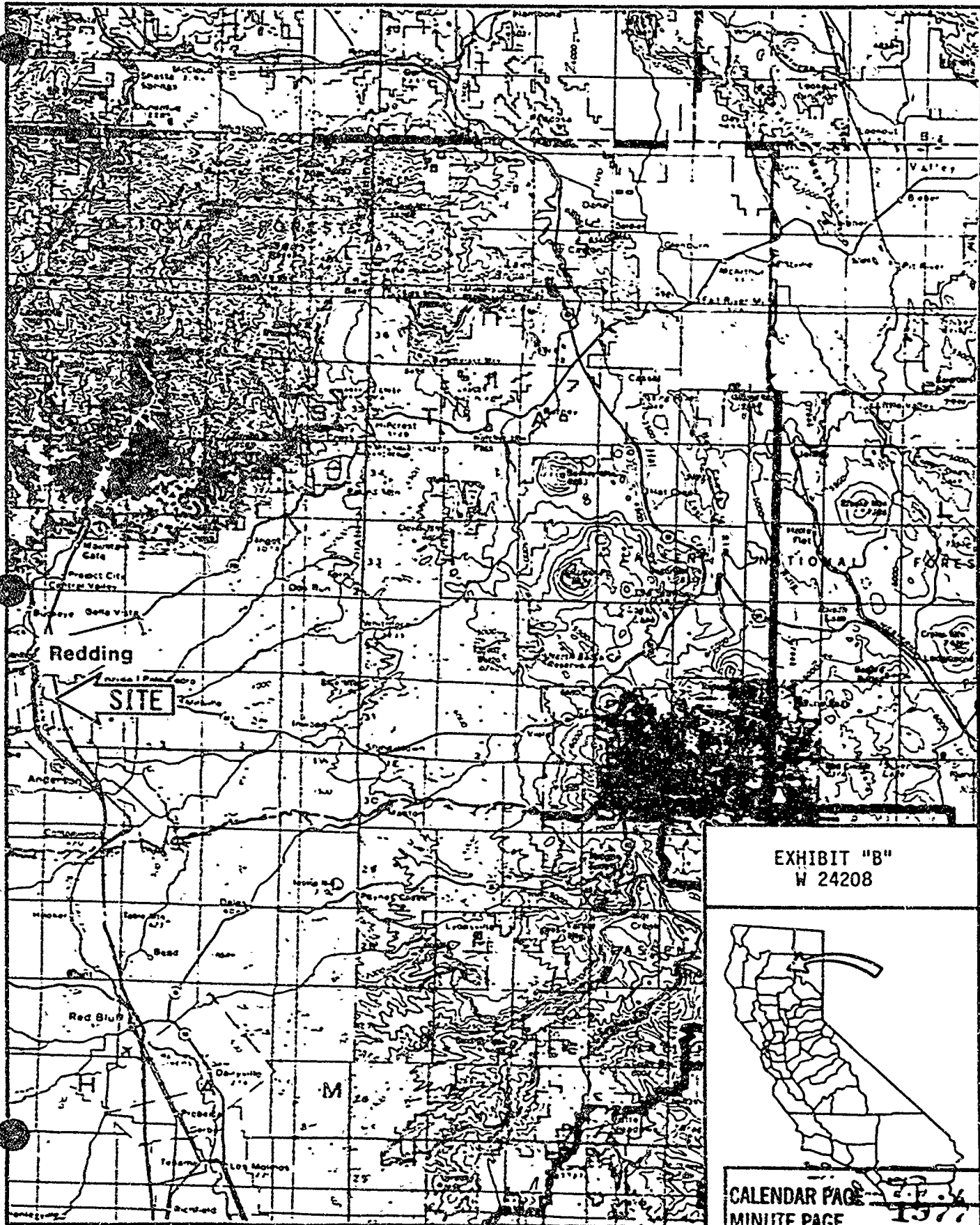

EXHIBIT "B"
W 24208



CALENDAR PAGE
MINUTE PAGE



NOTICE OF DETERMINATION

City of Redding

RECEIVED

OCT 11 1988

CLERK OF THE BOARD

EXHIBIT

TO: xx Clerk of the Board
County of Shasta
1500 Court St., Rm 206
Redding, CA 96001

xx Ms. Norma Wood
State Clearinghouse
Office of Planning & Research
1400 Tenth St. Room 121
Sacramento, CA 95814

P-050-650

SUBJECT: Filing of Notice of Determination in compliance with Section 21108 or 21152 of the Public Resources Code

PROJECT TITLE: South Bonnyview Boat Launch

STATE CLEARINGHOUSE NUMBER (If submitted to State Clearinghouse): #88072608

CONTACT PERSON: Telephone: 225-4055
Phillip A. Perry, Director of Planning and Community Development

PROJECT LOCATION: West bank of the Sacramento River and south of and adjacent to the South Bonnyview Road Bridge

PROJECT DESCRIPTION: Construction of a public boat launch

It is to advise that the City Council, Lead Agency, has approved the above described project and has made the following determinations regarding the above described project:

1. The project will have a significant effect on the environment.
2. An Environmental Impact Report was prepared for this project pursuant to the provisions of CEQA.
 Findings were made pursuant to Section 15091 of CEQA.
3. A Negative Declaration was prepared for this project pursuant to the provisions of CEQA. A copy of the Negative Declaration may be obtained at the Planning and Community Development Department.
4. Mitigated measures were made a condition of the approval of the project.
5. A Statement of Overriding Considerations was adopted for this project.
6. A copy of the Negative Declaration and the record of project approval may be examined in the City Clerk's Office, 760 Parkview Avenue, Redding, California.

Date Approved: October 4, 1988

Ethel A. Nichols
Ethel A. Nichols, City Clerk

cc: Planning Dept.

CALENDAR PAGE	72.5
MINUTE PAGE	1978

NOTICE OF DETERMINATION



City of Redding

TO: Clerk of the Board
 County of Shasta
 1500 Court St., Rm 206
 Redding, CA 96001

Ms. Norma Wood
 State Clearinghouse
 Office of Planning & Research
 1400 Tenth St. Room 121
 Sacramento, CA 95814

P-050-650

SUBJECT: Filing of Notice of Determination in compliance with Section 21108 or 21152 of the Public Resources Code

PROJECT TITLE: South Bonnyview Boat Launch

STATE CLEARINGHOUSE NUMBER (if submitted to State Clearinghouse): 983072608

CONTACT PERSON: Telephone: 225-4055
 Phillip A. Perry, Director of Planning and Community Development

PROJECT LOCATION: West bank of the Sacramento River and south of and adjacent to the South Bonnyview Road Bridge

PROJECT DESCRIPTION: Construction of a public boat launch

This is to advise that the City Council, Lead Agency, has approved the above described project and has made the following determinations regarding the above described project:

1. The project will have a significant effect on the environment.
2. An Environmental Impact Report was prepared for this project pursuant to the provisions of CEQA.
 Findings were made pursuant to Section 15091 of CEQA.
3. A Negative Declaration was prepared for this project pursuant to the provisions of CEQA. A copy of the Negative Declaration may be obtained at the Planning and Community Development Department.
4. Mitigatid measures were made a condition of the approval of the project.
5. A Statement of Overriding Considerations was adopted for this project.
6. A copy of the Negative Declaration and the record of project approval may be examined in the City Clerk's Office, 760 Parkview Avenue, Redding, California.

Date Approved: October 4, 1979

Ethel A. Nichols
 Ethel A. Nichols, City Clerk

c: Planning Dept.

760 PARKVIEW AVENUE, REDDING, CA 96001-3306 TELEPHONE 916-215-0100

CALENDAR PAGE 73 . 6
 MINUTE PAGE 1979



City of Redding

NOTICE OF NEGATIVE DECLARATION

The Redding Planning Commission, at their regular meeting of July 26, 1988, found that

ENVIRONMENTAL IMPACT DETERMINATION ED-18-87, by the City of Redding, proposing construction of a public boat launch on the west bank of the Sacramento River south of and adjacent to the South Bonnyview Road bridge

has no substantial impact upon the environment and that an environmental impact report is not necessary. The Planning Commission made its decision on the basis of the following findings:

1. Project is compatible with the Redding General Plan.
2. Project will not significantly alter existing land form.
3. Project is compatible with surrounding land use.
4. Project is compatible with the Code of the City of Redding, California.

The foregoing decision that the proposed project will have no significant effect upon the environment is based on an initial study prepared by the City Planning Department and reviewed at a Planning Commission meeting. If there are substantial changes that alter the character of the proposed project, another environmental impact determination will be necessary.

A copy of the initial study may be obtained at the City of Redding Planning Department, 760 Parkview Avenue, Redding, California 96001.

Phillip M. Perry, Director
Planning and Community Development

B. No Project Alternative

This alternative would restrict convenient boating access to the River as channel conditions, both upstream and downstream, restrict access to this portion of the River. Completion of the project will also benefit small-craft recreation use. Canoe and raft use are limited as there is no safe public access for launching or retrieving between downtown Redding and Anderson, a distance of over 11 river miles. Shallow riffles just below the posse-ground launching ramp create hazards for most recreational boaters. These hazards limit access to several miles of waterway, especially during periods of lower releases from Shasta and Keswick Dams.

IV. POTENTIAL IMPACTS AND MITIGATION MEASURES

A. Aesthetics

The construction of the project will alter the visual impacts of the west riverbank in the immediate area of the ramp. While it is an unavoidable impact, in staff's opinion, it is not a significant one. Construction of the ramp will require vegetation removal for an area approximately 100 feet wide, including necessary cut banks. Natural riparian species will be reintroduced to the cut-bank areas after completion of the project. Long-term visual impacts will be confined to an area approximately 60 feet in width.

As previously mentioned, this section of the Sacramento River is visually pleasing but cannot be considered a completely natural setting. Immediately adjacent to the proposed ramp location is a 20-foot-high concrete water tower. Just upstream is the South Bonnyview Bridge, which is currently a two-lane structure. Sometime in the future, the bridge will be widened to the south to provide for a four-lane structure.

B. 100-Year Floodplain

The ramp and most of the parking will be constructed within the 100-year floodplain of the Sacramento River. The restrooms will be constructed outside the 100-year floodplain. This project will not introduce any new fill to the floodplain. It will involve the redistribution of existing fill introduced over the last five years prior to public ownership and prior to adoption of the City of Redding Floodplain Ordinance, Chapter 18.47. Some of the existing fill material is unsuitable and will be removed. The remaining fill will be graded and compacted to provide a smooth surface for paving. Also, the ramp construction will require a sizeable cut into the bank with a minor amount of associated fill. The net effect will be to reduce the average elevation of the site, thereby reducing the impact on upstream and downstream flood flows.

The City of Redding's Public Works Department conducted a hydrology study for the project using a U. S. Army Corp of Engineers MEC-2 hydrology program. It analyzed the effects of filling within the

CALENDAR PAGE	73
MINUTE PAGE	198

100-year floodplain and lowering the ground elevation in the vicinity of the proposed ramp. Although no additional fill within the 100-year floodplain is proposed, the computer analysis did demonstrate that fill could be utilized with minimal effect on the upstream water-surface elevation. There would be no change in the water-surface elevations downstream of the study area. As the project does not involve any new fill within the floodplain, no mitigation measures are required or proposed. In fact, the project will result in some removal of existing fill, resulting in a limited beneficial impact to the river hydrology.

The encroachment of the ramp and the parking area into the 100-year floodplain does not constitute a substantial impact based on the hydrology study and on the following:

Based on a 24-year history of releases out of Keswick, the 79,000 flood release has occurred less than .005 percent of the time. Also, that high of a release rarely lasts more than 24 hours at a time.

The parking area, while created technically in the 100-year floodplain, are areas of backwater created by the construction of the South Bonnyview Bridge abutment and approach fill.

C. Construction Impacts

1. Grading and Soil Erosion. Project effects on vegetation and wildlife during construction will be limited to areas disturbed (grading and excavating) for the ramp, parking lot, and access road. There will be some increased runoff and erosion associated with construction of the project. These impacts will be most noticeable in the area of the ramp, which will impact approximately 100 feet of bank. Mitigation measures will include replanting the slopes in the area of the ramp and limiting construction to periods of dry weather. Specific areas will also be fenced off to prohibit encroachment into areas sensitive to construction activities.
2. Hydrology. There will be no construction impacts on the discharge regime of the Sacramento River. Refer to previous section on 100-year floodplain for more details.
3. Noise. Heavy-equipment operation will generate loud on-site noises of up to about 95 decibels at 50 feet. The nearest residences are approximately 800 to 6,000 feet from the construction site and will have some line of sight. At that distance, it is anticipated that construction noises will be noticeable from the residences. Construction activity will be limited to the hours of 7 a.m. and 7 p.m. The activity most noticeable to the residents will be of short duration.

CALENDAR PAGE 72 . 9
MINUTE PAGE 1982