

MINUTE ITEM

This Calendar Item No. C21
was approved as Minute Item
No. C21 by the State Lands
Commission by a vote of 3
to 0 at its 6/11/90
meeting.

CALENDAR ITEM

A 1

C 2 1

06/11/90

S 1

PRC 3999

Martinez

BORROW PERMIT

APPLICANT: Caltrans, Dist. 2
P. O. Box 2107
Redding, California 96001

AREA, TYPE LAND AND LOCATION:
Lieu lands in the SW 1/4 of NW 1/4 of
Section 22, and N 1/2 of Section 27, T26N,
R16E, MDM, near Herlong, Lassen County. The
lands were sold to the Dept. of Fish and Game
with minerals reserved and under the
jurisdiction of the State Lands Commission.

LAND USE:
Continued removal of 6,000 cubic yards of
aggregate annually for five years from
existing, previous used, borrow pits. The
excavated material will be transported by truck
to Caltrans maintenance work areas of State
Route 395 where it will be used for highway
repair and other maintenance uses in the
Susanville and Quincy areas.

TERMS OF PROPOSED PERMIT:
Initial Period: Five years beginning July 1,
1990.

Royalty: \$0.25 per cubic yard.

PREREQUISITE CONDITIONS, FEES AND EXPENSES:
Filing fee has been received.

CALENDAR ITEM NO. 021 (CONT'D)

STATUTORY AND OTHER REFERENCES:

PRC: Div. 6, Parts 1 and 2; Div. 14.
Cal Code Regs.: Title 2, Div. 3; Title 2,
Div. 3; Title 14, Div. 8.

AB 884: 07/09/90.

OTHER PERTINENT INFORMATION:

1. The project is a continuation of an existing use that has been authorized in the past by permits that have now expired.
2. Pursuant to the Commission's delegation of authority and the State's CEQA guidelines (14 Cal. Code Regs. 15025), the staff has prepared a proposed Negative Declaration identified as ND 509, State Clearinghouse Number 90020384. Such proposed Negative Declaration was prepared and circulated for public review pursuant to the provisions of CEQA. Based upon the initial study, the proposed Negative Declaration, and the comments received in response thereto, there is no substantial evidence that the project will have a significant effect on the environment (14 Cal. Code Regs. 15074[b]).

APPROVALS OBTAINED:

Department of Fish and Game and County of Lassen.

EXHIBITS:

- A. Site Map.
- B. Negative Declaration.

IT IS RECOMMENDED THAT THE COMMISSION:

1. CERTIFY THAT A NEGATIVE DECLARATION ND 509, STATE CLEARINGHOUSE NUMBER 90020384 WAS PREPARED FOR THIS PROJECT PURSUANT TO THE PROVISIONS OF CEQA AND THAT THE COMMISSION HAS REVIEWED AND CONSIDERED THE INFORMATION CONTAINED THEREIN.
2. DETERMINE THAT THE PROJECT, AS APPROVED, WILL NOT HAVE A SIGNIFICANT EFFECT ON THE ENVIRONMENT.

CALENDAR ITEM NO. C 2 1 (CONT'D)

3. AUTHORIZE STAFF TO ISSUE TO CALTRANS, DIST. 2 THE BORROW PERMIT ON FILE IN THE OFFICE OF THE STATE LANDS COMMISSION. SAID PERMIT SHALL AUTHORIZE EXTRACTION OF 6,000 CUBIC YARDS OF AGGREGATE ANNUALLY FOR FIVE YEARS BEGINNING JULY 1, 1990 FROM EXISTING BORROW PERMITS IN THE SW 1/4 OF NW 1/2, OF SECTION 22, AND N 1/2 OF SECTION 27, T26N, R16E, MDM, NEAR HERLONG, LASSEN COUNTY. THE EXTRACTIVE MATERIAL WILL BE USED FOR PUBLIC HIGHWAY REPAIRS, A ROYALTY OF \$0.25 PER CUBIC YARD SHALL BE CHARGED FOR MATERIAL REMOVED AS APPROVED. SUCH ACTIVITY IS CONTINGENT UPON APPLICANT'S COMPLIANCE WITH APPLICABLE PERMITS, RECOMMENDATIONS OR LIMITATIONS ISSUED BY FEDERAL, STATE AND LOCAL GOVERNMENT AGENCIES.

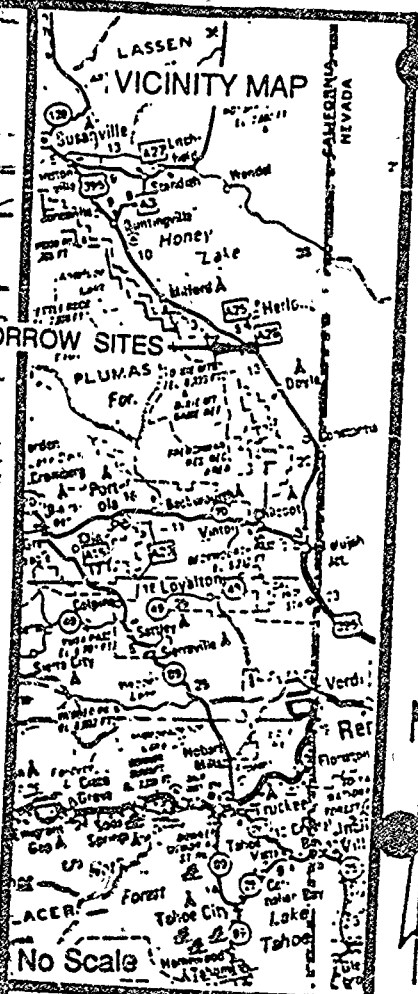
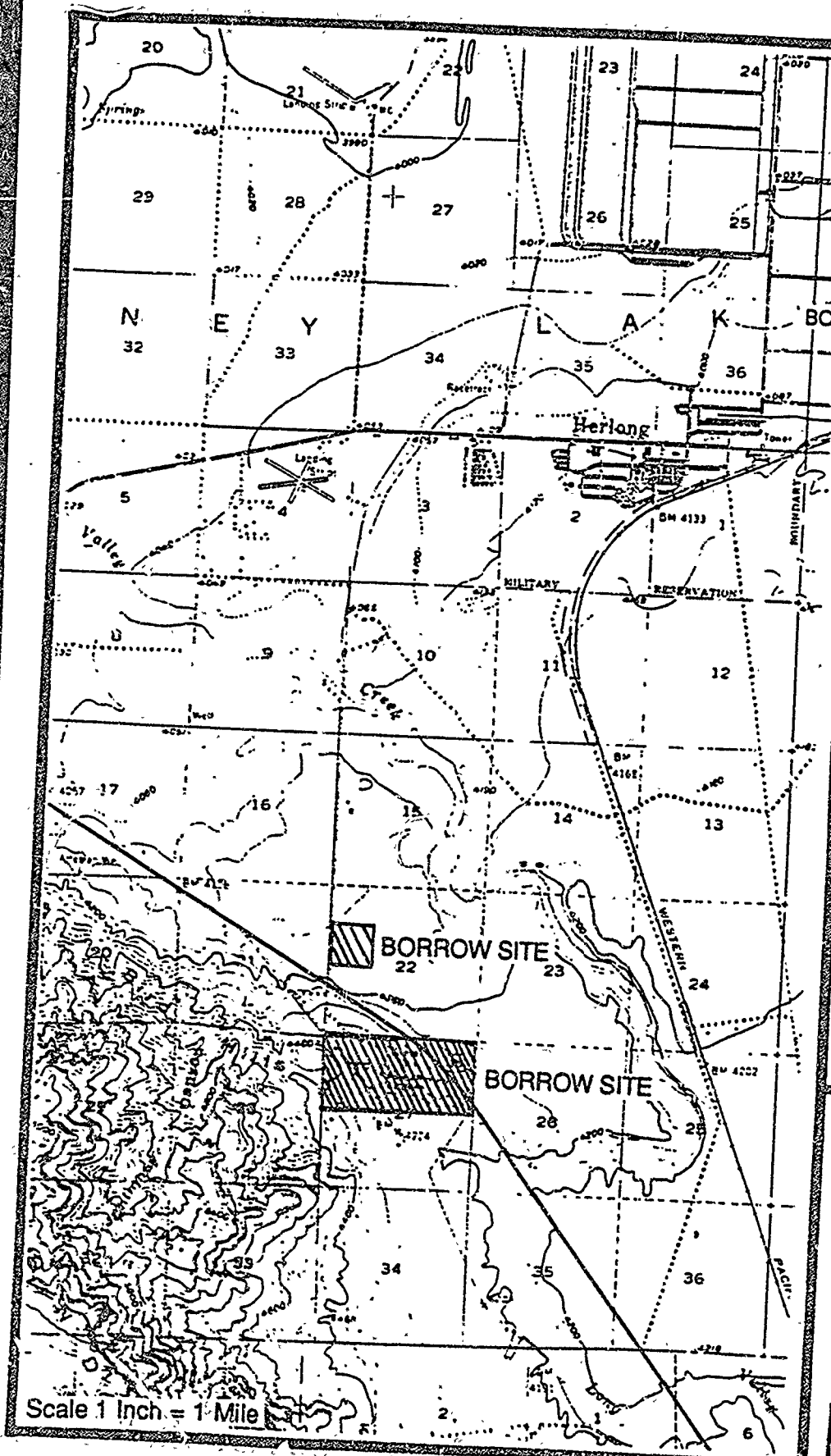

EXHIBIT "A"
 APPLICATION FOR
 BORROW PERMIT
 CALTRANS, District 2
 PRC 3999
 LASSEN, COUNTY



Scale 1 Inch = 1 Mile

STATE OF CALIFORNIA

STATE LANDS COMMISSION

LEO T. McCARTHY, Lieutenant Governor
GRAY DAVIS, Controller
JESSE R. HUFF, Director of Finance

GEORGE DELAMERAN, Governor

EXECUTIVE OFFICE
1227 - 13th Street
Sacramento, CA 95814
CHARLES WARREN
Executive Officer

PROPOSED NEGATIVE DECLARATION

EIR ND: 509

File Ref: WP 3999

SCH. NO.: 9002 0384

Project Title: Continued Aggregate Excavation

Project Proponent: Caltrans

Project Location: Portions of Sections 22 and 27, T. 26N, R.16E, M.D.M., adjacent to Highway 395 near Herlong, Lassen County.

Project Description: Continued removal of 6,000 cubic yards of aggregate annually from existing, previously used, borrow sites. The material will be excavated, loaded with rubber-tired front-end loaders and trucked to Caltrans maintenance work areas.

Contact Person: Linda Martinez Telephone: (916) 322-6375

This document is prepared pursuant to the requirements of the California Environmental Quality Act (Section 21000 et seq., Public Resources Code), the State CEQA Guidelines (Section 15000 et seq., Title 14, California Code Regulations), and the State Lands Commission regulations (Section 2901 et seq., Title 2, California Code Regulations).

Based upon the attached Initial Study, it has been found that:

that project will not have a significant effect on the environment.

mitigation measures included in the project will avoid potentially significant effects.

FORM 13.17 (4/90)

CALENDAR PAGE	170
MINUTE PAGE	1152

PROJECT DESCRIPTION

Caltrans has requested authorization to continue removing 6,000 cubic yards of aggregate annually from existing, previously used, borrow pits in the SW $\frac{1}{4}$ NW $\frac{1}{4}$ of Section 22 and N $\frac{1}{2}$ of Section 27, T 26 N, R 16 E, MDM, on Highway 395 near Herlong, Lassen County. The project site has been used as borrow pits for over 20 years.

The aggregate will continue to be excavated, loaded with rubber-tired front-end loaders and hauled by 10-wheel dump trucks to Caltrans maintenance work areas on State Route 395 where it will be used for highway shoulder repair and other maintenance uses in the Susanville and Quincy areas.

Area vegetation is typical of the northern desert shrub belt. Small quantities of native grasses and brush may be removed in the event the existing pits require reopening or enlargement. Any loss of native plants will be mitigated by stockpiling any overburden, contour grading or depleted areas, and re-spreading of the overburden and re-seeding with grasses.

There are no rare or endangered species of wildlife within the project limits. Wildlife common to the area includes the Rocky Mountain mule deer, jackrabbit, cottontail rabbit, dove quail and chuckar. Coyote and bobcat are frequently seen. While the southern bald eagle is occasionally seen, there are no nesting areas near the project site.

A portion of the project site is a major deer wintering and crossing area. Sites within the project area that are defined by the Department of Fish and Game as migratory deer heard corridor or browse areas will be avoided from October 15 through April 15 of each year and no excavation will be allowed in these areas at any time.

Known historical or archaeological sites identified by Caltrans Archaeological staff will continue to be avoided during project operations.

Noise generated by project operations and from traffic associated with these operations is not considered to be significant due to both the great distance of the noise source from sensitive noise receptors and due to the limited amount of truck haul required.

ENVIRONMENTAL IMPACT ASSESSMENT CHECKLIST - PART II

Form 13.20 (7/82)

File Ref.: WP 3999

I. BACKGROUND INFORMATION

A. Applicant: Department of Transportation (Caltrans), Dist. 2
P. O. Box 2107
Redding CA 96001

B. Checklist Date: 4/16/90

C. Contact Person: Linda Martinez, Dredging Coordinator
Telephone: 916 322-6375

D. Purpose: Obtain aggregate for highway shoulder repairs and other maintenance uses in the Susanville and Quincy areas.

E. Location: SW 1/4 NW 1/4 of Section 22 and N 1/4 of Section 27, T 26 N, R 16 E, MDM, on Highway 395 near Herlong, Lassen County.

F. Description: Continued removal of 6,000 cubic yards of aggregate annually from existing, previously used, borrow sites. The material will be excavated, loaded with rubber-tired front-end loaders and hauled by truck to Caltrans maintenance work areas.

G. Persons Contacted: Lassen County Planning Department
Department of Fish and Game

II. ENVIRONMENTAL IMPACTS. (Explain all "yes" and "maybe" answers)

Table with 3 columns: Question, Yes, Maybe, No. Contains 7 questions regarding earth conditions, soil disruptions, topography changes, geologic features, erosion, and hazards.

CALENDAR PAGE 2
MINUTE PAGE 154

B. *Air*. Will the proposal result in:

Yes Maybe No

- 1. Substantial air emissions or deterioration of ambient air quality?
- 2. The creation of objectionable odors?
- 3. Alteration of air movement, moisture or temperature, or any change in climate, either locally or regionally?

C. *Water*. Will the proposal result in:

- 1. Changes in the currents, or the course or direction of water movements, in either marine or fresh waters?
- 2. Changes in absorption rates, drainage patterns, or the rate and amount of surface water runoff?
- 3. Alterations to the course or flow of flood waters?
- 4. Change in the amount of surface water in any water body?
- 5. Discharge into surface waters, or in any alteration of surface water quality, including but not limited to temperature, dissolved oxygen or turbidity?
- 6. Alteration of the direction or rate of flow of ground waters?
- 7. Change in the quantity of ground waters, either through direct additions or withdrawals, or through interception of an aquifer by cuts or excavations?
- 8. Substantial reduction in the amount of water otherwise available for public water supplies?
- 9. Exposure of people or property to water-related hazards such as flooding or tidal waves?
- 10. Significant changes in the temperature, flow or chemical content of surface thermal springs?

D. *Plant Life*. Will the proposal result in:

- 1. Change in the diversity of species, or number of any species of plants (including trees, shrubs, grass, crops, and aquatic plants)?
- 2. Reduction of the numbers of any unique, rare or endangered species of plants?
- 3. Introduction of new species of plants into an area, or in a barrier to the normal replenishment of existing species?
- 4. Reduction in acreage of any agricultural crop?

E. *Animal Life*. Will the proposal result in:

- 1. Change in the diversity of species, or numbers of any species of animals (birds, land animals including reptiles, fish and shellfish, benthic organisms, or insects)?
- 2. Reduction of the numbers of any unique, rare or endangered species of animals?
- 3. Introduction of new species of animals into an area, or result in a barrier to the migration or movement of animals?
- 4. Deterioration to existing fish or wildlife habitat?

F. *Noise*. Will the proposal result in:

- 1. Increase in existing noise levels?
- 2. Exposure of people to severe noise levels?

G. *Light and Glare*. Will the proposal result in:

- 1. The production of new light or glare?

H. *Land Use*. Will the proposal result in:

- 1. A substantial alteration of the present or planned land use of an area?

I. *Natural Resources*. Will the proposal result in:

- 1. Increase in the rate of use of any natural resources?
- 2. Substantial depletion of any nonrenewable resources?

CALENDAR PAGE	112a
NOTICE PAGE	155

J. *Risk of Upset.* Does the proposal result in:

- | | Yes | Maybe | No |
|---|--------------------------|--------------------------|-------------------------------------|
| 1. A risk of an explosion or the release of hazardous substances (including, but not limited to, oil, pesticides, chemicals, or radiation) in the event of an accident or upset conditions? | <input type="checkbox"/> | <input type="checkbox"/> | <input checked="" type="checkbox"/> |
| 2. Possible interference with emergency response plan or an emergency evacuation plan? | <input type="checkbox"/> | <input type="checkbox"/> | <input checked="" type="checkbox"/> |

K. *Population.* Will the proposal result in:

- | | | | |
|---|--------------------------|--------------------------|-------------------------------------|
| 1. The alteration, distribution, density, or growth rate of the human population of the area? | <input type="checkbox"/> | <input type="checkbox"/> | <input checked="" type="checkbox"/> |
|---|--------------------------|--------------------------|-------------------------------------|

L. *Housing.* Will the proposal result in:

- | | | | |
|---|--------------------------|--------------------------|-------------------------------------|
| 1. Affecting existing housing, or create a demand for additional housing? | <input type="checkbox"/> | <input type="checkbox"/> | <input checked="" type="checkbox"/> |
|---|--------------------------|--------------------------|-------------------------------------|

M. *Transportation/Circulation.* Will the proposal result in:

- | | | | |
|---|--------------------------|--------------------------|-------------------------------------|
| 1. Generation of substantial additional vehicular movement? | <input type="checkbox"/> | <input type="checkbox"/> | <input checked="" type="checkbox"/> |
| 2. Affecting existing parking facilities, or create a demand for new parking? | <input type="checkbox"/> | <input type="checkbox"/> | <input checked="" type="checkbox"/> |
| 3. Substantial impact upon existing transportation systems? | <input type="checkbox"/> | <input type="checkbox"/> | <input checked="" type="checkbox"/> |
| 4. Alterations to present patterns of circulation or movement of people and/or goods? | <input type="checkbox"/> | <input type="checkbox"/> | <input checked="" type="checkbox"/> |
| 5. Alterations to waterborne, rail, or air traffic? | <input type="checkbox"/> | <input type="checkbox"/> | <input checked="" type="checkbox"/> |
| 6. Increase in traffic hazards to motor vehicles, bicyclists, or pedestrians? | <input type="checkbox"/> | <input type="checkbox"/> | <input checked="" type="checkbox"/> |

N. *Public Services.* Will the proposal have an effect upon, or result in a need for new or altered governmental services in any of the following areas:

- | | | | |
|---|--------------------------|--------------------------|-------------------------------------|
| 1. Fire protection? | <input type="checkbox"/> | <input type="checkbox"/> | <input checked="" type="checkbox"/> |
| 2. Police protection? | <input type="checkbox"/> | <input type="checkbox"/> | <input checked="" type="checkbox"/> |
| 3. Schools? | <input type="checkbox"/> | <input type="checkbox"/> | <input checked="" type="checkbox"/> |
| 4. Parks and other recreational facilities? | <input type="checkbox"/> | <input type="checkbox"/> | <input checked="" type="checkbox"/> |
| 5. Maintenance of public facilities, including roads? | <input type="checkbox"/> | <input type="checkbox"/> | <input checked="" type="checkbox"/> |
| 6. Other governmental services? | <input type="checkbox"/> | <input type="checkbox"/> | <input checked="" type="checkbox"/> |

O. *Energy.* Will the proposal result in:

- | | | | |
|---|--------------------------|--------------------------|-------------------------------------|
| 1. Use of substantial amounts of fuel or energy? | <input type="checkbox"/> | <input type="checkbox"/> | <input checked="" type="checkbox"/> |
| 2. Substantial increase in demand upon existing sources of energy, or require the development of new sources? | <input type="checkbox"/> | <input type="checkbox"/> | <input checked="" type="checkbox"/> |

P. *Utilities.* Will the proposal result in a need for new systems, or substantial alterations to the following utilities:

- | | | | |
|------------------------------------|--------------------------|--------------------------|-------------------------------------|
| 1. Power or natural gas? | <input type="checkbox"/> | <input type="checkbox"/> | <input checked="" type="checkbox"/> |
| 2. Communication systems? | <input type="checkbox"/> | <input type="checkbox"/> | <input checked="" type="checkbox"/> |
| 3. Water? | <input type="checkbox"/> | <input type="checkbox"/> | <input checked="" type="checkbox"/> |
| 4. Sewer or septic tanks? | <input type="checkbox"/> | <input type="checkbox"/> | <input checked="" type="checkbox"/> |
| 5. Storm water drainage? | <input type="checkbox"/> | <input type="checkbox"/> | <input checked="" type="checkbox"/> |
| 6. Solid waste and disposal? | <input type="checkbox"/> | <input type="checkbox"/> | <input checked="" type="checkbox"/> |

Q. *Human Health.* Will the proposal result in:

- | | | | |
|--|--------------------------|--------------------------|-------------------------------------|
| 1. Creation of any health hazard or potential health hazard (excluding mental health)? | <input type="checkbox"/> | <input type="checkbox"/> | <input checked="" type="checkbox"/> |
| 2. Exposure of people to potential health hazards? | <input type="checkbox"/> | <input type="checkbox"/> | <input checked="" type="checkbox"/> |

R. *Aesthetics.* Will the proposal result in:

- | | | | |
|--|--------------------------|--------------------------|-------------------------------------|
| 1. The obstruction of any scenic vista or view open to the public, or will the proposal result in the creation of an aesthetically offensive site open to public view? | <input type="checkbox"/> | <input type="checkbox"/> | <input checked="" type="checkbox"/> |
|--|--------------------------|--------------------------|-------------------------------------|

S. *Recreation.* Will the proposal result in:

- | | | | |
|---|--------------------------|--------------------------|-------------------------------------|
| 1. An impact upon the quality or quantity of existing recreational opportunities? | <input type="checkbox"/> | <input type="checkbox"/> | <input checked="" type="checkbox"/> |
|---|--------------------------|--------------------------|-------------------------------------|

CALENDAR PAGE	113	<input type="checkbox"/>
MINUTE PAGE	1156	<input type="checkbox"/>

T. *Cultural Resources.*

Yes Maybe No

- 1. Will the proposal result in the alteration of or the destruction of a prehistoric or historic archeological site?
- 2. Will the proposal result in adverse physical or aesthetic effects to a prehistoric or historic building, structure, or object?
- 3. Does the proposal have the potential to cause a physical change which would affect unique ethnic cultural values?
- 4. Will the proposal restrict existing religious or sacred uses within the potential impact area?

U. *Mandatory Findings of Significance.*

- 1. Does the project have the potential to degrade the quality of the environment, reduce the habitat of a fish or wildlife species, cause a fish or wildlife population to drop below self-sustaining levels, threaten to eliminate a plant or animal community, reduce the number or restrict the range of a rare or endangered plant or animal or eliminate important examples of the major periods of California history or prehistory?
- 2. Does the project have the potential to achieve short-term, to the disadvantage of long-term, environmental goals?
- 3. Does the project have impacts which are individually limited, but cumulatively considerable?
- 4. Does the project have environmental effects which will cause substantial adverse effects on human beings, either directly or indirectly?

III. DISCUSSION OF ENVIRONMENTAL EVALUATION (See Comments Attached)

The project site has been used as borrow pits for over 20 years.

Any loss of native plants will be mitigated by stockpiling any overburden, contour grading or depleted areas, and respreading of the overburden and reseeding with grasses.

IV. PRELIMINARY DETERMINATION

On the basis of this initial evaluation:

- I find the proposed project COULD NOT have a significant effect on the environment, and a NEGATIVE DECLARATION will be prepared.
- I find that although the proposed project could have a significant effect on the environment, there will not be a significant effect in this case because the mitigation measures described on an attached sheet have been added to the project. A NEGATIVE DECLARATION will be prepared.
- I find the proposed project MAY have a significant effect on the environment, and an ENVIRONMENTAL IMPACT REPORT is required.

Date: 4/16/90

Linda Martin
For the State Lands

MINUTE PAGE	113a
MINUTE PAGE	1157