

MINUTE ITEM
This Calendar Item No. 003
was approved as Minute Item
No. 003 by the State Lands
Commission by a vote of 3
to 0 at its 6/11/90
meeting.

CALENDAR ITEM

A 7
S 1

C 0 3

06/11/90
W 21665 PRC 7399
W 24014 PRC 7400
W 24402 PRC 7401
W 24418 PRC 7402
Garibay

APPROVAL OF RECREATIONAL PIER PERMITS

APPLICANT: AS LISTED ON EXHIBIT "A" ATTACHED

AREA, TYPE LAND AND LOCATION:
Four parcels of submerged land in Lake Tahoe in
Placer and El Dorado counties.

LAND USE: Retention of previously unauthorized buoys.

TERMS OF PROPOSED PERMIT:
Initial period: Five years beginning June 11,
1990.

Consideration: Rent-free, pursuant to
Section 6503.5 of the P.R.C.

APPLICANT STATUS:
Applicants are littoral landowners as defined
in Section 6503, P.R.C.

PREREQUISITE CONDITIONS, FEES AND EXPENSES:
Filing fee, processing costs, and environmental
fees have been received.

STATUTORY AND OTHER REFERENCES:
A. P.R.C.: Div. 6, Parts 1 and 2; Div. 13.
B. Cal. Code Regs.: Title 2, Div. 3;
Title 14, Div. 6.

CALENDAR ITEM NO. C 03 (CONT'D)

AB 884: N/A.

OTHER PERTINENT INFORMATION:

1. Pursuant to the Commission's delegation of authority and the State CEQA Guidelines (14 Cal. Code Regs. 15025), the staff has prepared environmental documents, as identified in Exhibit "A". Such Proposed Negative Declarations were prepared and circulated for public review pursuant to the provisions of CEQA.

Based upon the initial studies, the Proposed Negative Declarations, and the comments received in response thereto, there is no substantial evidence that these projects will have a significant effect on the environment. (14 Cal. Code Regs. 15074[b])

2. These activities involve lands identified as possessing significant environmental values pursuant to P.R.C. 6370, et seq. Based upon the staff's consultation with the persons nominating such lands and through the CEQA review process, it is the staff's opinion that the projects, as proposed, are consistent with its use classification.
3. In order to determine the other potential trust uses in the area of the proposed projects, the staff contacted representatives of the following agencies: Tahoe Regional Planning Agency, Department of Fish and Game, County of Placer, County of El Dorado and the Tahoe Conservancy. None of these agencies expressed a concern that the proposed projects would have a significant effect on trust uses in the area. The agencies did not identify any trust needs which were not being met by existing facilities in the area. Identified trust uses in this area would include swimming, boating, walking along

CALENDAR ITEM NO. C 03 (CONT'D)

the beach, and views of the lake. Prior to the issuance of these permits, staff will conduct an inspection of the sites to review the relation of the permitted facilities to other trust uses.

4. All permits issued at Lake Tahoe include special language in which the permittee/lessee agrees to protect and replace or restore, if required, the habitat of *Rorippa subumbellata*, commonly called the Tahoe Yellow Cress, a State-listed endangered plant species.
5. All applicants at Lake Tahoe have been notified that the public has a right to pass along the shorezone and the permittee must provide a reasonable means for public passage along the shorezone occupied by the permitted structure.
5. If any structure hereby authorized is found to be in nonconformance with the Tahoe Regional Planning Agency's Shorezone ordinance, and if any alterations, repairs, or removal required pursuant to said ordinance are not accomplished within the designated time period, then this lease will be automatically terminated, effective upon notice by the State, and the site shall be cleared pursuant to the terms thereof. If the location, size, or number of any structure hereby authorized is to be altered, pursuant to order of the Tahoe Regional Planning Agency, Lessee shall request the consent of State to make such alteration.

APPROVALS OBTAINED:

El Dorado County, Placer County, and Tahoe Regional Planning Association.

FURTHER APPROVALS REQUIRED:

None.

CALENDAR ITEM NO. C 03 (CONT'D)

EXHIBITS: A. Applicant List.
 B. Location Map.
 C. Negative Declarations.

IT IS RECOMMENDED THAT THE COMMISSION:

1. CERTIFY THAT ENVIRONMENTAL DOCUMENTS, AS IDENTIFIED IN EXHIBIT "A", WERE PREPARED FOR THESE PROJECTS PURSUANT TO THE PROVISIONS OF THE CEQA AND THAT THE COMMISSION HAS REVIEWED, CONSIDERED, AND ADOPTED THE INFORMATION CONTAINED THEREIN.
2. DETERMINE THAT THE PROJECTS, AS APPROVED, WILL NOT HAVE SIGNIFICANT EFFECTS ON THE ENVIRONMENT.
3. AUTHORIZE ISSUANCE OF FIVE-YEAR RECREATIONAL PIER PERMITS TO THE APPLICANTS LISTED IN EXHIBIT "A", BEGINNING JUNE 11, 1990, FOR THE RETENTION OF EXISTING BUOYS ON THE LANDS DESCRIBED ON EXHIBIT "B" ATTACHED AND BY REFERENCE MADE A PART HEREOF.

EXHIBIT "A"

RECREATIONAL PIER PERMITS FOR CALENDAR OF JUNE 12, 1990

Page 1 of 1

ITEM	W.O. NO.	APPLICANT	LOCATION	LAND USE & STATUS	UPLAND PROPERTY DESCRIPTION	EIR ND	SCH #
A	W 21565	David & Barbara Hicks 5137 Van Ness Fresno, CA 93711	Lake Tahoe, Placer County	Existing moor- ing buoy	Fraction of Section 28, T16N, R17E	506	90020334
B	W 24014	Bryte Johnson, et al 1147 - 46th Street Sacramento, CA 95819	Lake Tahoe, Placer County	Existing moor- ing buoy	Fraction of Lot 2A, Block 2, Tahoe Pines	504	90020332
C	W 24402	Joan Fiddymont 6405 Fiddymont Road Roseville, CA 95678	Lake Tahoe, Placer County	Two existing mooring buoys	Fraction Lot 1A, Sunnyside tract	501	90020091
D	W 24418	Robert & Marjorie Hadeler 8727 Shoreham Drive, #2 Los Angeles, CA 90067	Lake Tahoe, El Dorado County	Existing moor- ing buoy	Section 17, T14N R17E	505	90020333

201C

ENCLOSURE PAGE

898

18

0.1720

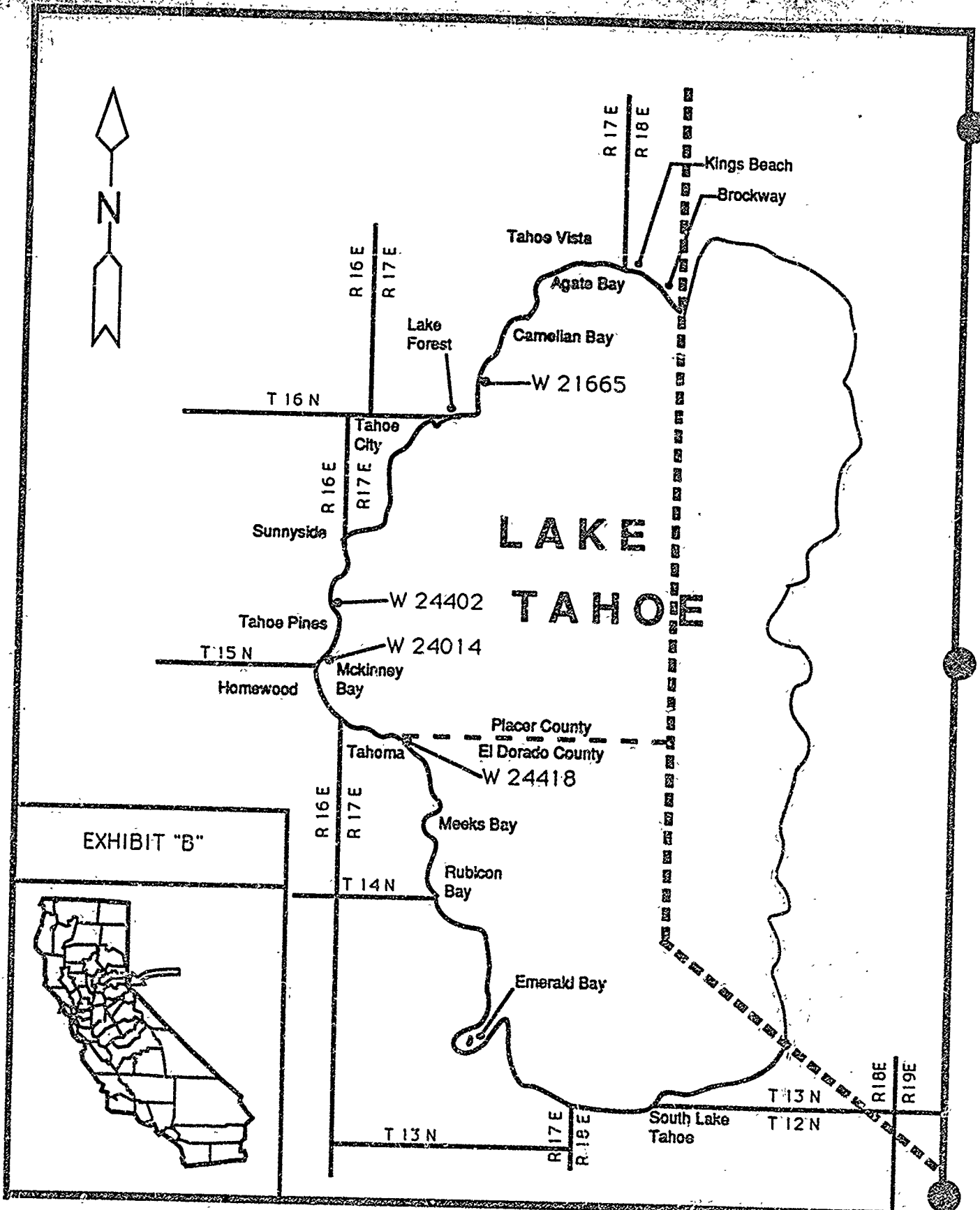

EXHIBIT "B"



CALENDAR PAGE 19
MINUTE PAGE 899

EXHIBIT "C"

STATE OF CALIFORNIA

STATE LANDS COMMISSION

T. McCARTHY, *Lieutenant Governor*
WAY DAVIS, *Controller*
JESSE R. HUFF, *Director of Finance*

GEORGE DEUKMEJIAN, *Governor*

EXECUTIVE OFFICE
1807 - 13th Street
Sacramento, CA 95814
CHARLES WARREN
Executive Officer

PROPOSED NEGATIVE DECLARATION

EIR ND: 506

File Ref.: W 21665

SCH. NO.: 90020334

Project Title: Hicks Mooring Buoy

Project Proponent: David L. Hicks

Project Location: Lake Tahoe, Placer County, 4 miles north of Tahoe City, adjacent to APN 092-100-15, 3850 North Lake Boulevard.

Project Description: Authorization of one existing mooring buoy.

Contact Person: Betty Eubanks Telephone: (916) 322-2795

This document is prepared pursuant to the requirements of the California Environmental Quality Act (Section 2100 et seq., Public Resources Code), the State CEQA Guidelines (Section 15000 et seq., Title 14, California Code Regulations), and the State Lands Commission regulations (Section 2901 et seq., Title 2, California Code Regulations).

Based upon the attached Initial Study, it has been found that:

that project will not have a significant effect on the environment.

mitigation measures included in the project will avoid potentially significant effects.

FORM 13.17 (4/90)

CALENDAR PAGE	20
MINUTE PAGE	900

ENVIRONMENTAL IMPACT ASSESSMENT CHECKLIST - PART II

Form 13.20 (7/82)

File Ref.: W 21665

I. BACKGROUND INFORMATION

A. Applicant: Mr. David L. Hicks
5137 North Van Ness
Fresno, CA 93711

B. Checklist Date: 04 / 10 / 90

C. Contact Person: Betty Eubanks
Telephone: (916) 322-2795

D. Purpose: Authorization for one existing buoy.

E. Location: 4 miles north of Tahoe City, 3850 N. Lake Blvd., Lake Tahoe,
APN 092-100-15

F. Description: One mooring buoy anchored on the bed of Lake Tahoe.

G. Persons Contacted:

II. ENVIRONMENTAL IMPACTS. (Explain all "yes" and "maybe" answers)

A. Earth. Will the proposal result in:

Yes Maybe No

- 1. Unstable earth conditions or changes in geologic substructures?
2. Disruptions, displacements, compaction, or overcovering of the soil?
3. Change in topography or ground surface relief features?
4. The destruction, covering, or modification of any unique geologic or physical features?
5. Any increase in wind or water erosion of soils, either on or off the site?
6. Changes in deposition or erosion of beach sands, or changes in siltation, deposition or erosion which may modify the channel of a river or stream or the bed of the ocean or any bay, inlet, or lake?
7. Exposure of all people or property to geologic hazards such as earthquakes, landslides, mudslides, ground failure, or similar hazards?

CALENDAR PAGE 9-01
MINUTE PAGE

B. Air. Will the proposal result in:

Yes Maybe No

- 1. Substantial air emissions or deterioration of ambient air quality?
- 2. The creation of objectionable odors?
- 3. Alteration of air movement, moisture or temperature, or any change in climate, either locally or regionally?

C. Water. Will the proposal result in:

- 1. Changes in the currents, or the course or direction of water movements, in either marine or fresh waters?
- 2. Changes in absorption rates, drainage patterns, or the rate and amount of surface water runoff?
- 3. Alterations to the course or flow of flood waters?
- 4. Change in the amount of surface water in any water body?
- 5. Discharge into surface waters, or in any alteration of surface water quality, including but not limited to temperature, dissolved oxygen or turbidity?
- 6. Alteration of the direction or rate of flow of ground waters?
- 7. Change in the quantity of ground waters, either through direct additions or withdrawals, or through interception of an aquifer by cuts or excavations?
- 8. Substantial reduction in the amount of water otherwise available for public water supplies?
- 9. Exposure of people or property to water-related hazards such as flooding or tidal waves?
- 10. Significant changes in the temperature, flow or chemical content of surface thermal springs?

D. Plant Life. Will the proposal result in:

- 1. Change in the diversity of species, or number of any species of plants (including trees, shrubs, grass, crops, and aquatic plants)?
- 2. Reduction of the numbers of any unique, rare or endangered species of plants?
- 3. Introduction of new species of plants into an area, or in a barrier to the normal replenishment of existing species?
- 4. Reduction in acreage of any agricultural crop?

E. Animal Life. Will the proposal result in:

- 1. Change in the diversity of species, or numbers of any species of animals (birds, land animals including reptiles, fish and shellfish, benthic organisms, or insects)?
- 2. Reduction of the numbers of any unique, rare or endangered species of animals?
- 3. Introduction of new species of animals into an area, or result in a barrier to the migration or movement of animals?
- 4. Deterioration to existing fish or wildlife habitat?

F. Noise. Will the proposal result in:

- 1. Increase in existing noise levels?
- 2. Exposure of people to severe noise levels?

G. Light and Glare. Will the proposal result in:

- 1. The production of new light or glare?

H. Land Use. Will the proposal result in:

- 1. A substantial alteration of the present or planned land use of an area?

I. Natural Resources. Will the proposal result in:

- 1. Increase in the rate of use of any natural resources?
- 2. Substantial depletion of any nonrenewable resources?

CALENDAR PAGE 22
 MINUTE PAGE 902

- J. Risk of Upset.** Does the proposal result in:
- | | Yes | Maybe | No |
|---|--------------------------|--------------------------|-------------------------------------|
| 1. A risk of an explosion or the release of hazardous substances (including, but not limited to, oil, pesticides, chemicals, or radiation) in the event of an accident or upset conditions? | <input type="checkbox"/> | <input type="checkbox"/> | <input checked="" type="checkbox"/> |
| 2. Possible interference with emergency response plan or an emergency evacuation plan? | <input type="checkbox"/> | <input type="checkbox"/> | <input checked="" type="checkbox"/> |
- K. Population.** Will the proposal result in:
- | | | | |
|---|--------------------------|--------------------------|-------------------------------------|
| 1. The alteration, distribution, density, or growth rate of the human population of the area? | <input type="checkbox"/> | <input type="checkbox"/> | <input checked="" type="checkbox"/> |
|---|--------------------------|--------------------------|-------------------------------------|
- L. Housing.** Will the proposal result in:
- | | | | |
|---|--------------------------|--------------------------|-------------------------------------|
| 1. Affecting existing housing, or create a demand for additional housing? | <input type="checkbox"/> | <input type="checkbox"/> | <input checked="" type="checkbox"/> |
|---|--------------------------|--------------------------|-------------------------------------|
- M. Transportation/Circulation.** Will the proposal result in:
- | | | | |
|---|-------------------------------------|--------------------------|-------------------------------------|
| 1. Generation of substantial additional vehicular movement? | <input type="checkbox"/> | <input type="checkbox"/> | <input checked="" type="checkbox"/> |
| 2. Affecting existing parking facilities, or create a demand for new parking? | <input type="checkbox"/> | <input type="checkbox"/> | <input checked="" type="checkbox"/> |
| 3. Substantial impact upon existing transportation systems? | <input type="checkbox"/> | <input type="checkbox"/> | <input checked="" type="checkbox"/> |
| 4. Alterations to present patterns of circulation or movement of people and/or goods? | <input type="checkbox"/> | <input type="checkbox"/> | <input checked="" type="checkbox"/> |
| 5. Alterations to waterborne, rail, or air traffic? | <input checked="" type="checkbox"/> | <input type="checkbox"/> | <input type="checkbox"/> |
| 6. Increase in traffic hazards to motor vehicles, bicyclists, or pedestrians? | <input type="checkbox"/> | <input type="checkbox"/> | <input checked="" type="checkbox"/> |
- N. Public Services.** Will the proposal have an effect upon, or result in a need for new or altered governmental services in any of the following areas:
- | | | | |
|---|--------------------------|--------------------------|-------------------------------------|
| 1. Fire protection? | <input type="checkbox"/> | <input type="checkbox"/> | <input checked="" type="checkbox"/> |
| 2. Police protection? | <input type="checkbox"/> | <input type="checkbox"/> | <input checked="" type="checkbox"/> |
| 3. Schools? | <input type="checkbox"/> | <input type="checkbox"/> | <input checked="" type="checkbox"/> |
| 4. Parks and other recreational facilities? | <input type="checkbox"/> | <input type="checkbox"/> | <input checked="" type="checkbox"/> |
| 5. Maintenance of public facilities, including roads? | <input type="checkbox"/> | <input type="checkbox"/> | <input checked="" type="checkbox"/> |
| 6. Other governmental services? | <input type="checkbox"/> | <input type="checkbox"/> | <input checked="" type="checkbox"/> |
- O. Energy.** Will the proposal result in:
- | | | | |
|---|--------------------------|--------------------------|-------------------------------------|
| 1. Use of substantial amounts of fuel or energy? | <input type="checkbox"/> | <input type="checkbox"/> | <input checked="" type="checkbox"/> |
| 2. Substantial increase in demand upon existing sources of energy, or require the development of new sources? | <input type="checkbox"/> | <input type="checkbox"/> | <input checked="" type="checkbox"/> |
- P. Utilities.** Will the proposal result in a need for new systems, or substantial alterations to the following utilities:
- | | | | |
|------------------------------------|--------------------------|--------------------------|-------------------------------------|
| 1. Power or natural gas? | <input type="checkbox"/> | <input type="checkbox"/> | <input checked="" type="checkbox"/> |
| 2. Communication systems? | <input type="checkbox"/> | <input type="checkbox"/> | <input checked="" type="checkbox"/> |
| 3. Water? | <input type="checkbox"/> | <input type="checkbox"/> | <input checked="" type="checkbox"/> |
| 4. Sewer or septic tanks? | <input type="checkbox"/> | <input type="checkbox"/> | <input checked="" type="checkbox"/> |
| 5. Storm water drainage? | <input type="checkbox"/> | <input type="checkbox"/> | <input checked="" type="checkbox"/> |
| 6. Solid waste and disposal? | <input type="checkbox"/> | <input type="checkbox"/> | <input checked="" type="checkbox"/> |
- Q. Human Health.** Will the proposal result in:
- | | | | |
|--|--------------------------|--------------------------|-------------------------------------|
| 1. Creation of any health hazard or potential health hazard (excluding mental health)? | <input type="checkbox"/> | <input type="checkbox"/> | <input checked="" type="checkbox"/> |
| 2. Exposure of people to potential health hazards? | <input type="checkbox"/> | <input type="checkbox"/> | <input checked="" type="checkbox"/> |
- R. Aesthetics.** Will the proposal result in:
- | | | | |
|--|--------------------------|-------------------------------------|-------------------------------------|
| 1. The obstruction of any scenic vista or view open to the public, or will the proposal result in the creation of an aesthetically offensive site open to public view? | <input type="checkbox"/> | <input checked="" type="checkbox"/> | <input checked="" type="checkbox"/> |
|--|--------------------------|-------------------------------------|-------------------------------------|
- S. Recreation.** Will the proposal result in:
- | | | | |
|---|--------------------------|-------------------------------------|-------------------------------------|
| 1. An impact upon the quality or quantity of existing recreational opportunities? | <input type="checkbox"/> | <input checked="" type="checkbox"/> | <input checked="" type="checkbox"/> |
|---|--------------------------|-------------------------------------|-------------------------------------|

CALENDAR PAGE	<input type="checkbox"/>	<input checked="" type="checkbox"/>	23
MINUTE PAGE			903

T. Cultural Resources.

Yes Maybe No

- 1. Will the proposal result in the alteration of or the destruction of a prehistoric or historic archeological site?
- 2. Will the proposal result in adverse physical or aesthetic effects to a prehistoric or historic building, structure, or object?
- 3. Does the proposal have the potential to cause a physical change which would affect unique ethnic cultural values?
- 4. Will the proposal restrict existing religious or sacred uses within the potential impact area?

U. Mandatory Findings of Significance.

- 1. Does the project have the potential to degrade the quality of the environment, reduce the habitat of a fish or wildlife species, cause a fish or wildlife population to drop below self-sustaining levels, threaten to eliminate a plant or animal community, reduce the number or restrict the range of a rare or endangered plant or animal or eliminate important examples of the major periods of California history or prehistory?
- 2. Does the project have the potential to achieve short term, to the disadvantage of long-term, environmental goals?
- 3. Does the project have impacts which are individually limited, but cumulatively considerable?
- 4. Does the project have environmental effects which will cause substantial adverse effects on human beings, either directly or indirectly?

III. DISCUSSION OF ENVIRONMENTAL EVALUATION (See Comments Attached)

Attached

IV. PRELIMINARY DETERMINATION

On the basis of this initial evaluation:

- I find the proposed project **COULD NOT** have a significant effect on the environment, and a **NEGATIVE DECLARATION** will be prepared.
- I find that although the proposed project could have a significant effect on the environment, there will not be a significant effect in this case because the mitigation measures described on an attached sheet have been added to the project. A **NEGATIVE DECLARATION** will be prepared.
- I find the proposed project **MAY** have a significant effect on the environment, and an **ENVIRONMENTAL IMPACT REPORT** is required.

Date: 04 / 10 / 90

Betty Eubanks - BETTY EUBANKS
For the State Lands Commission

CALENDAR PAGE 24
MINUTE PAGE 13.20 (7/2/94)

III. DISCUSSION OF ENVIRONMENTAL EVALUATION
ATTACHMENT to ENVIRONMENTAL IMPACT ASSESSMENT CHECKLIST - Part II
W 21665 - David Hicks

- E1. Lake Tahoe in this area is designated a fish spawning/habitat restoration area on the Tahoe Regional Planning Agency maps. Placement of one buoy in this area will not adversely affect the spawning habitat. Recreational use induced in this area by the project may have minimal effects on fish productivity.
- M5. The existing buoy for this application, waterward of APN 092-100-15, lies approximately 250 feet from the shoreline. The nearest pier is located approximately 100 feet to the south and is approximately 115 feet in length. An existing buoy is located approximately 85 feet waterward of the pier. Approximately 200 feet north of the Hick's buoy, there is an existing pier and two buoys.

The applicant's buoy will not significantly change the existing use of the shoreline for boaters and/or topline trollers.

- R1. Buoys alone do not present a significant visual obstruction. According to The Cumulative Impacts of Shorezone Development at Lake Tahoe, by Phillips, Brandt, Reddick, McDonald, and Grefe, dated February 1978, pp. 4-79, in public responses to visual aspects of shorezone development and use, a grouping of seven boats closely spaced was considered to be a "visual dislike". Therefore, this proposal shall not constitute a significant effect.
- S1. The quality/quantity of recreation will change for the owner of this buoy. However, the quality of recreation for topline trollers will not change significantly as a result of this buoy placement as other piers and buoys exist in and near the shore in this vicinity.

(041090)

EXHIBIT "A"

LAND DESCRIPTION

W 21665

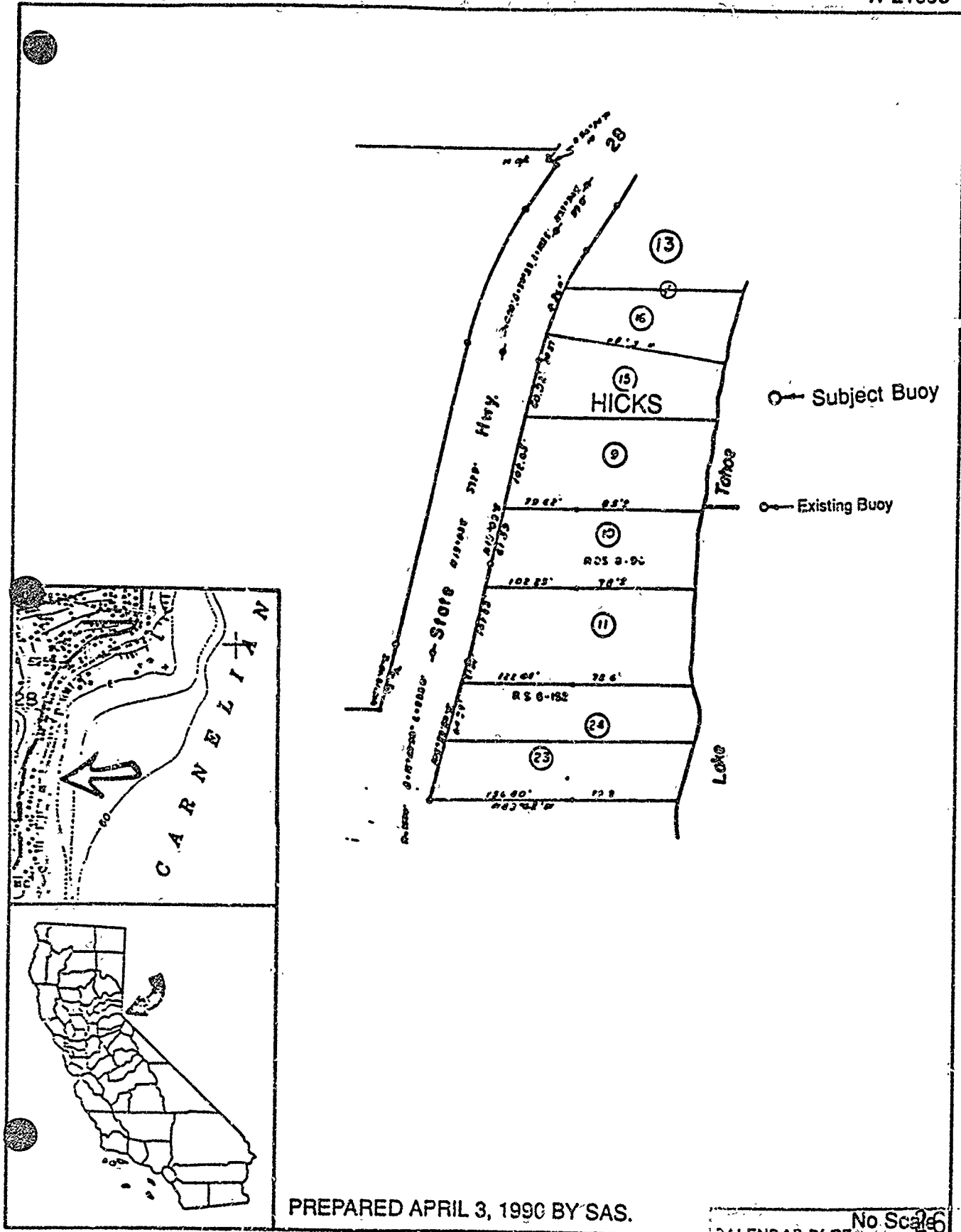

PREPARED APRIL 3, 1990 BY SAS.

EXHIBIT "A"

LAND DESCRIPTION

W 21665

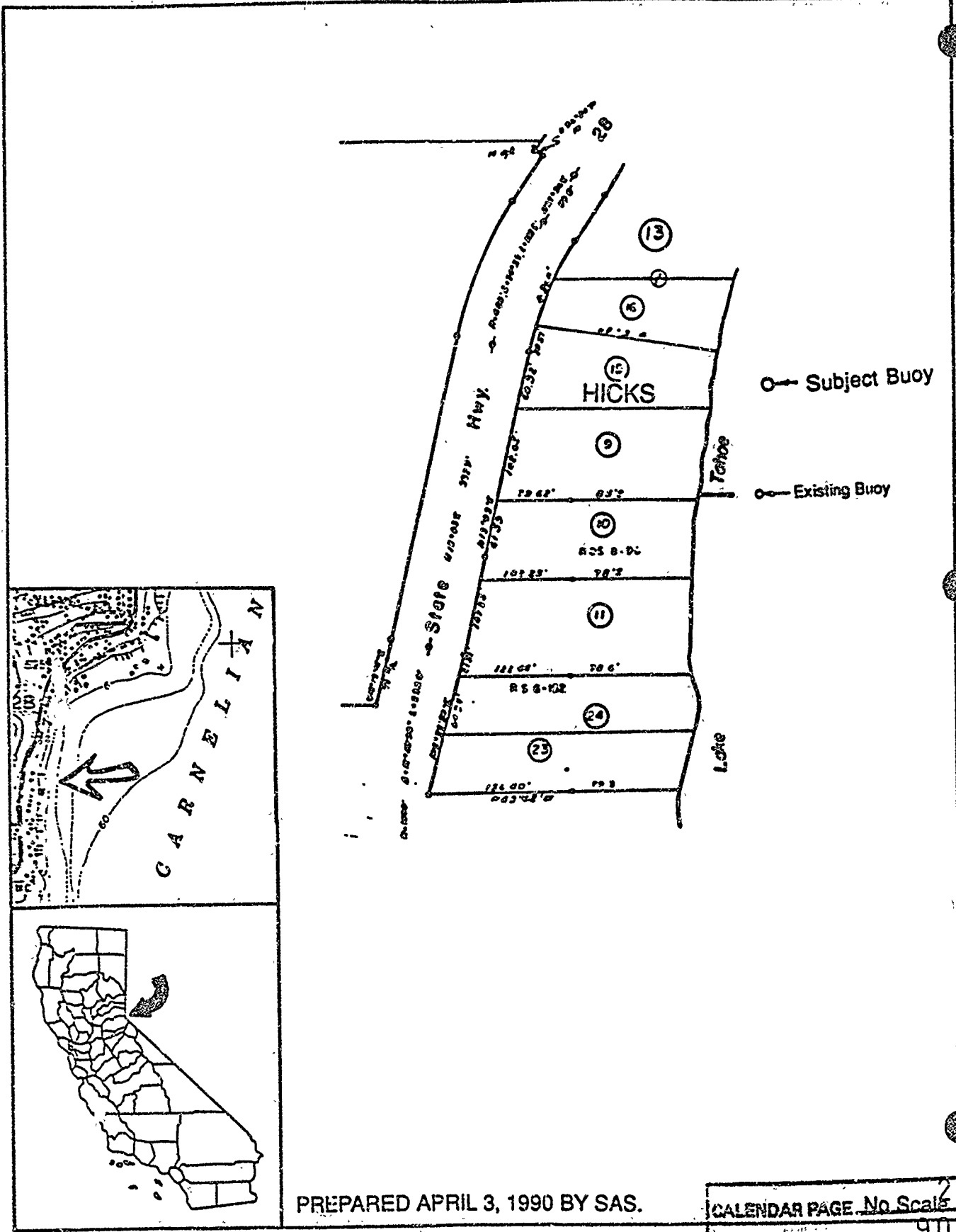

PREPARED APRIL 3, 1990 BY SAS.

CALENDAR PAGE	No Scale
MINUTE PAGE	907

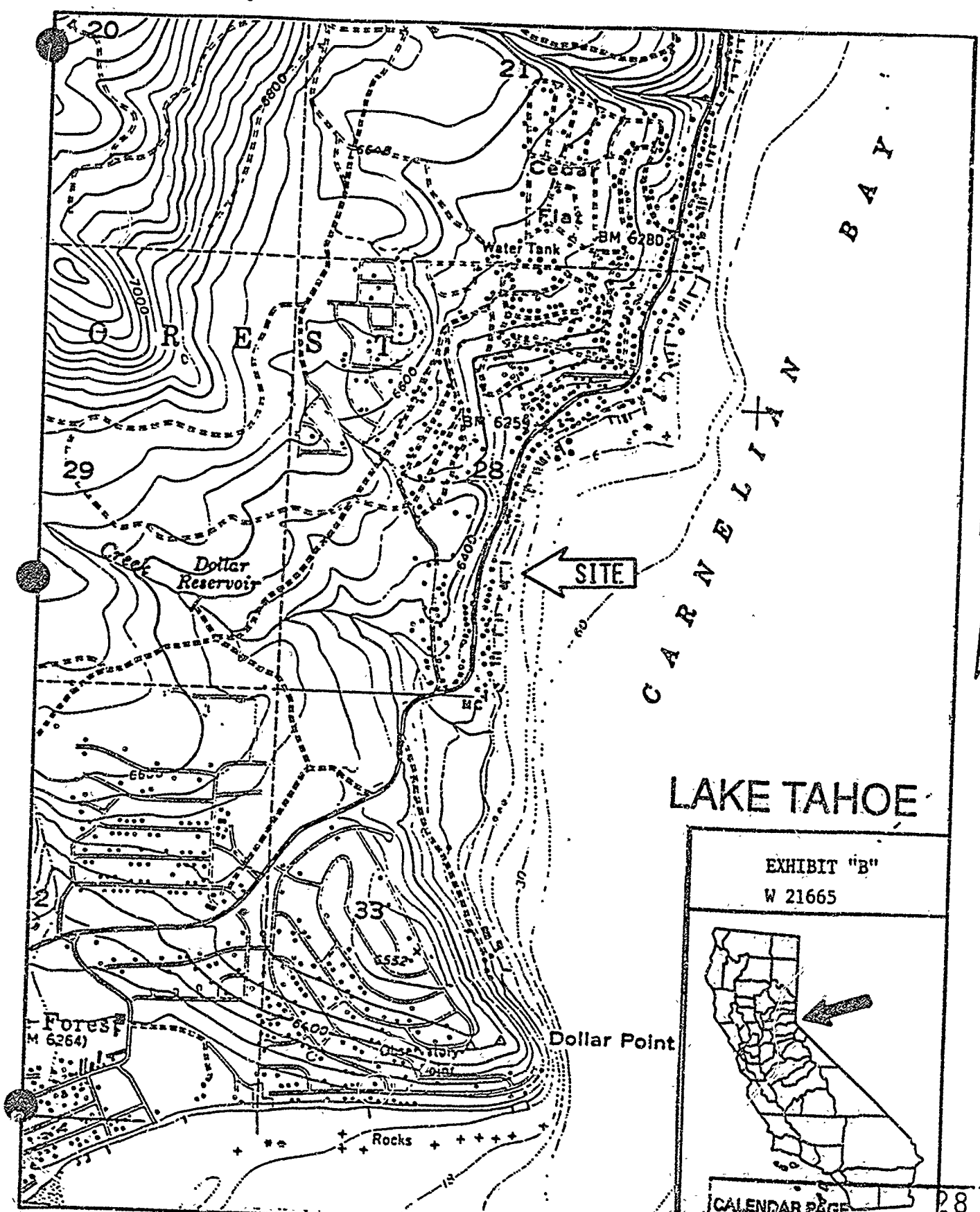

LAKE TAHOE

EXHIBIT "B"
W 21665



CALENDAR PAGE	28
MINUTE PAGE	908

STATE LANDS COMMISSION
1807 13TH STREET
SACRAMENTO, CALIFORNIA 95814



PROPOSED NEGATIVE DECLARATION

EIR ND 504

File Ref.: W 24014

SCH#: 90020332

Project Title: Bryte Johnson Buoy Application

Project Proponent: Bryte Johnson

Project Location: Lake Tahoe, near Tahoe Pines, Placer County

Project Description: Authorize one existing mooring buoy anchored on the bed of Lake Tahoe.

Contact Person: Judy Brown

Telephone: (916) 324-4715

This document is prepared pursuant to the requirements of the California Environmental Quality Act (Section 21000 et seq., Public Resources Code), the State CEQA Guidelines (Section 15000 et seq., Title 14, California Code Regulations), and the State Lands Commission regulations (Section 2901 et seq., Title 2, California Code Regulations).

Based upon the attached Initial Study, it has been found that:

the project will not have a significant effect on the environment.

mitigation measures included in the project will avoid potentially significant effects.

CALENDAR PAGE	29
MINUTE PAGE	909

Form 13.17 (3/89)

ENVIRONMENTAL IMPACT ASSESSMENT CHECKLIST - PART II

Form 13.20, (7/82)

File Ref.: W 24014

I. BACKGROUND INFORMATION

A. Applicant: Mr. Bryte Johnson
1147 - 46th Street
Sacramento, CA 95819

B. Checklist Date: 03 / 09 / 90

C. Contact Person: Judy Brown
Telephone: (916) 324-4715

D. Purpose: Authorization for one existing mooring buoy.

E. Location: Lake Tahoe, Tahoe Pines, adjacent to APN: 85-222-06, Placer County

F. Description: One mooring buoy anchored on the bed of Lake Tahoe.

G. Persons Contacted:

II. ENVIRONMENTAL IMPACTS. (Explain all "yes" and "maybe" answers)

A. Earth. Will the proposal result in:

- 1. Unstable earth conditions or changes in geologic substructures?
2. Disruptions, displacements, compaction, or overcovering of the soil?
3. Change in topography or ground surface relief features?
4. The destruction, covering, or modification of any unique geologic or physical features?
5. Any increase in wind or water erosion of soils, either on or off the site?
6. Changes in deposition or erosion of beach sands, or changes in siltation, deposition, or erosion which may modify the channel of a river or stream or the bed of the ocean or any bay, inlet, or lake?
7. Exposure of all people or property to geologic hazards such as earthquakes, landslides, mudslides, ground failure, or similar hazards?

CALENDAR PAGE 30
MINUTE PAGE 910

B. Air. Will the proposal result in:

Yes Maybe No

- 1. Substantial air emissions or deterioration of ambient air quality?
- 2. The creation of objectionable odors?
- 3. Alteration of air movement, moisture or temperature, or any change in climate, either locally or regionally?

C. Water. Will the proposal result in:

- 1. Changes in the currents, or the course or direction of water movements, in either marine or fresh waters?
- 2. Changes in absorption rates, drainage patterns, or the rate and amount of surface water runoff?
- 3. Alterations to the course or flow of flood waters?
- 4. Change in the amount of surface water in any water body?
- 5. Discharge into surface waters, or in any alteration of surface water quality, including but not limited to temperature, dissolved oxygen or turbidity?
- 6. Alteration of the direction or rate of flow of ground waters?
- 7. Change in the quantity of ground waters, either through direct additions or withdrawals, or through interception of an aquifer by cuts or excavations?
- 8. Substantial reduction in the amount of water otherwise available for public water supplies?
- 9. Exposure of people or property to water-related hazards such as flooding or tidal waves?
- 10. Significant changes in the temperature, flow or chemical content of surface thermal springs?

D. Plant Life. Will the proposal result in:

- 1. Change in the diversity of species, or number of any species of plants (including trees, shrubs, grass, crops, and aquatic plants)?
- 2. Reduction of the numbers of any unique, rare or endangered species of plants?
- 3. Introduction of new species of plants into an area, or in a barrier to the normal replenishment of existing species?
- 4. Reduction in acreage of any agricultural crop?

E. Animal Life. Will the proposal result in:

- 1. Change in the diversity of species, or numbers of any species of animals (birds, land animals including reptiles, fish and shellfish, benthic organisms, or insects)?
- 2. Reduction of the numbers of any unique, rare or endangered species of animals?
- 3. Introduction of new species of animals into an area, or result in a barrier to the migration or movement of animals?
- 4. Deterioration to existing fish or wildlife habitat?

F. Noise. Will the proposal result in:

- 1. Increase in existing noise levels?
- 2. Exposure of people to severe noise levels?

G. Light and Glare. Will the proposal result in:

- 1. The production of new light or glare?

H. Land Use. Will the proposal result in:

- 1. A substantial alteration of the present or planned land use of an area?

I. Natural Resources. Will the proposal result in:

- 1. Increase in the rate of use of any natural resources?
- 2. Substantial depletion of any nonrenewable resources?

J. Risk of Upset. Does the proposal result in:

- | | Yes | Maybe | No |
|---|--------------------------|--------------------------|-------------------------------------|
| 1. A risk of an explosion or the release of hazardous substances (including, but not limited to, oil, pesticides, chemicals, or radiation) in the event of an accident or upset conditions? | <input type="checkbox"/> | <input type="checkbox"/> | <input checked="" type="checkbox"/> |
| 2. Possible interference with emergency response plan or an emergency evacuation plan? | <input type="checkbox"/> | <input type="checkbox"/> | <input checked="" type="checkbox"/> |

K. Population. Will the proposal result in:

- | | | | |
|---|--------------------------|--------------------------|-------------------------------------|
| 1. The alteration, distribution, density, or growth rate of the human population of the area? | <input type="checkbox"/> | <input type="checkbox"/> | <input checked="" type="checkbox"/> |
|---|--------------------------|--------------------------|-------------------------------------|

L. Housing. Will the proposal result in:

- | | | | |
|---|--------------------------|--------------------------|-------------------------------------|
| 1. Affecting existing housing, or create a demand for additional housing? | <input type="checkbox"/> | <input type="checkbox"/> | <input checked="" type="checkbox"/> |
|---|--------------------------|--------------------------|-------------------------------------|

M. Transportation/Circulation. Will the proposal result in:

- | | | | |
|---|-------------------------------------|--------------------------|-------------------------------------|
| 1. Generation of substantial additional vehicular movement? | <input type="checkbox"/> | <input type="checkbox"/> | <input checked="" type="checkbox"/> |
| 2. Affecting existing parking facilities, or create a demand for new parking? | <input type="checkbox"/> | <input type="checkbox"/> | <input checked="" type="checkbox"/> |
| 3. Substantial impact upon existing transportation systems? | <input type="checkbox"/> | <input type="checkbox"/> | <input checked="" type="checkbox"/> |
| 4. Alterations to present patterns of circulation or movement of people and/or goods? | <input type="checkbox"/> | <input type="checkbox"/> | <input checked="" type="checkbox"/> |
| 5. Alterations to waterborne, rail, or air traffic? | <input checked="" type="checkbox"/> | <input type="checkbox"/> | <input type="checkbox"/> |
| 6. Increase in traffic hazards to motor vehicles, bicyclists, or pedestrians? | <input type="checkbox"/> | <input type="checkbox"/> | <input checked="" type="checkbox"/> |

N. Public Services. Will the proposal have an effect upon, or result in a need for new or altered governmental services in any of the following areas:

- | | | | |
|---|--------------------------|--------------------------|-------------------------------------|
| 1. Fire protection? | <input type="checkbox"/> | <input type="checkbox"/> | <input checked="" type="checkbox"/> |
| 2. Police protection? | <input type="checkbox"/> | <input type="checkbox"/> | <input checked="" type="checkbox"/> |
| 3. Schools? | <input type="checkbox"/> | <input type="checkbox"/> | <input checked="" type="checkbox"/> |
| 4. Parks and other recreational facilities? | <input type="checkbox"/> | <input type="checkbox"/> | <input checked="" type="checkbox"/> |
| 5. Maintenance of public facilities, including roads? | <input type="checkbox"/> | <input type="checkbox"/> | <input checked="" type="checkbox"/> |
| 6. Other governmental services? | <input type="checkbox"/> | <input type="checkbox"/> | <input checked="" type="checkbox"/> |

O. Energy. Will the proposal result in:

- | | | | |
|---|--------------------------|--------------------------|-------------------------------------|
| 1. Use of substantial amounts of fuel or energy? | <input type="checkbox"/> | <input type="checkbox"/> | <input checked="" type="checkbox"/> |
| 2. Substantial increase in demand upon existing sources of energy, or require the development of new sources? | <input type="checkbox"/> | <input type="checkbox"/> | <input checked="" type="checkbox"/> |

P. Utilities. Will the proposal result in a need for new systems, or substantial alterations to the following utilities:

- | | | | |
|------------------------------------|--------------------------|--------------------------|-------------------------------------|
| 1. Power or natural gas? | <input type="checkbox"/> | <input type="checkbox"/> | <input checked="" type="checkbox"/> |
| 2. Communication systems? | <input type="checkbox"/> | <input type="checkbox"/> | <input checked="" type="checkbox"/> |
| 3. Water? | <input type="checkbox"/> | <input type="checkbox"/> | <input checked="" type="checkbox"/> |
| 4. Sewer or septic tanks? | <input type="checkbox"/> | <input type="checkbox"/> | <input checked="" type="checkbox"/> |
| 5. Storm water drainage? | <input type="checkbox"/> | <input type="checkbox"/> | <input checked="" type="checkbox"/> |
| 6. Solid waste and disposal? | <input type="checkbox"/> | <input type="checkbox"/> | <input checked="" type="checkbox"/> |

Q. Human Health. Will the proposal result in:

- | | | | |
|--|--------------------------|--------------------------|-------------------------------------|
| 1. Creation of any health hazard or potential health hazard (excluding mental health)? | <input type="checkbox"/> | <input type="checkbox"/> | <input checked="" type="checkbox"/> |
| 2. Exposure of people to potential health hazards? | <input type="checkbox"/> | <input type="checkbox"/> | <input checked="" type="checkbox"/> |

R. Aesthetics. Will the proposal result in:

- | | | | |
|--|--------------------------|-------------------------------------|--------------------------|
| 1. The obstruction of any scenic vista or view open to the public, or will the proposal result in the creation of an aesthetically offensive site open to public view? | <input type="checkbox"/> | <input checked="" type="checkbox"/> | <input type="checkbox"/> |
|--|--------------------------|-------------------------------------|--------------------------|

S. Recreation. Will the proposal result in:

- | | | | |
|---|--------------------------|-------------------------------------|--------------------------|
| 1. An impact upon the quality or quantity of existing recreational opportunities? | <input type="checkbox"/> | <input checked="" type="checkbox"/> | <input type="checkbox"/> |
|---|--------------------------|-------------------------------------|--------------------------|

CALENDAR PAGE	<input type="checkbox"/>	32	<input type="checkbox"/>
MINUTE PAGE	<input checked="" type="checkbox"/>	912	<input type="checkbox"/>

T. Cultural Resources:

Yes Maybe No

- 1. Will the proposal result in the alteration of or the destruction of a prehistoric or historic archeological site?
- 2. Will the proposal result in adverse physical or aesthetic effects to a prehistoric or historic building, structure, or object?
- 3. Does the proposal have the potential to cause a physical change which would affect unique ethnic cultural values?
- 4. Will the proposal restrict existing religious or sacred uses within the potential impact area?

U. Mandatory Findings of Significance.

- 1. Does the project have the potential to degrade the quality of the environment, reduce the habitat of a fish or wildlife species, cause a fish or wildlife population to drop below self-sustaining levels, threaten to eliminate a plant or animal community, reduce the number or restrict the range of a rare or endangered plant or animal or eliminate important examples of the major periods of California history or prehistory?
- 2. Does the project have the potential to achieve short-term, to the disadvantage of long-term, environmental goals?
- 3. Does the project have impacts which are individually limited, but cumulatively considerable?
- 4. Does the project have environmental effects which will cause substantial adverse effects on human beings, either directly or indirectly?

III. DISCUSSION OF ENVIRONMENTAL EVALUATION (See Comments Attached)

See Attachment.

IV. PRELIMINARY DETERMINATION

On the basis of this initial evaluation:

- I find the proposed project **COULD NOT** have a significant effect on the environment, and a **NEGATIVE DECLARATION** will be prepared.
- I find that although the proposed project could have a significant effect on the environment, there will not be a significant effect in this case because the mitigation measures described on an attached sheet have been added to the project. A **NEGATIVE DECLARATION** will be prepared.
- I find the proposed project **MAY** have a significant effect on the environment, and an **ENVIRONMENTAL IMPACT REPORT** is required.

Date: 04 / 10 / 90

CALIFORNIA PAGE	33
MINUTE PAGE	913

For the State Lands Commission

III. DISCUSSION OF ENVIRONMENTAL EVALUATION
(Attachment to Environmental Impact Assessment Checklist - Part II
W 24014 - Bryte Johnson

- E1. Lake Tahoe in the Tahoe Pines area is designated as a fish spawning/habitat restoration area on the Tahoe Regional Planning Agency maps. Placement of buoys at this location will not substantially change the lake bottom and will not adversely affect the spawning habitat. Recreational use induced in this area of the Lake by the project may affect fish productivity minimally.
- M5. The existing buoy of this application is located approximately 20 feet from the low water mark (elev. 6223'). The upland area along this stretch of beach is Lakeside Park, owned by Placer County (see Exhibit "A"). Approximately 20 feet north of the buoy is an existing pier, owned by the adjacent property owner of APN: 85-222-05. Approximately 50 feet south of the existing buoy is a private pier leased by the Tahoe Pines Homeowner's Association.

Public access will not be unusually restricted by the use of this buoy. The use of the shore area for trolling fishermen will not change with the cluster of the buoy and two piers within close proximity to one another.

For navigational safety purposes, the Coast Guard may request a minimum spacing, between the existing buoy and the pier directly to the north, of 50 feet.

- R1. Buoys themselves do not present much of a visual obstruction. According to The Cumulative Impacts of Shorezone Development at Lake Tahoe, by Phillipa Brandt, Reddick, McDonald, and Grefe, dated February 1978, pp. 4-79, in public responses to visual aspects of shorezone development and use, a grouping of seven boats closely spaced was considered to be a "visual dislike", therefore this proposal does not constitute a significant effect.
- S1. The quality and quantity of recreation will change to the owner of this buoy, who will benefit in more convenient, and perhaps more frequent recreational use of Lake Tahoe. Recreational quality for topline trollers will not change as a result of this buoy application.

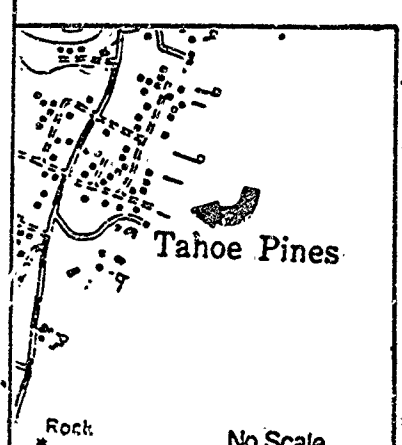
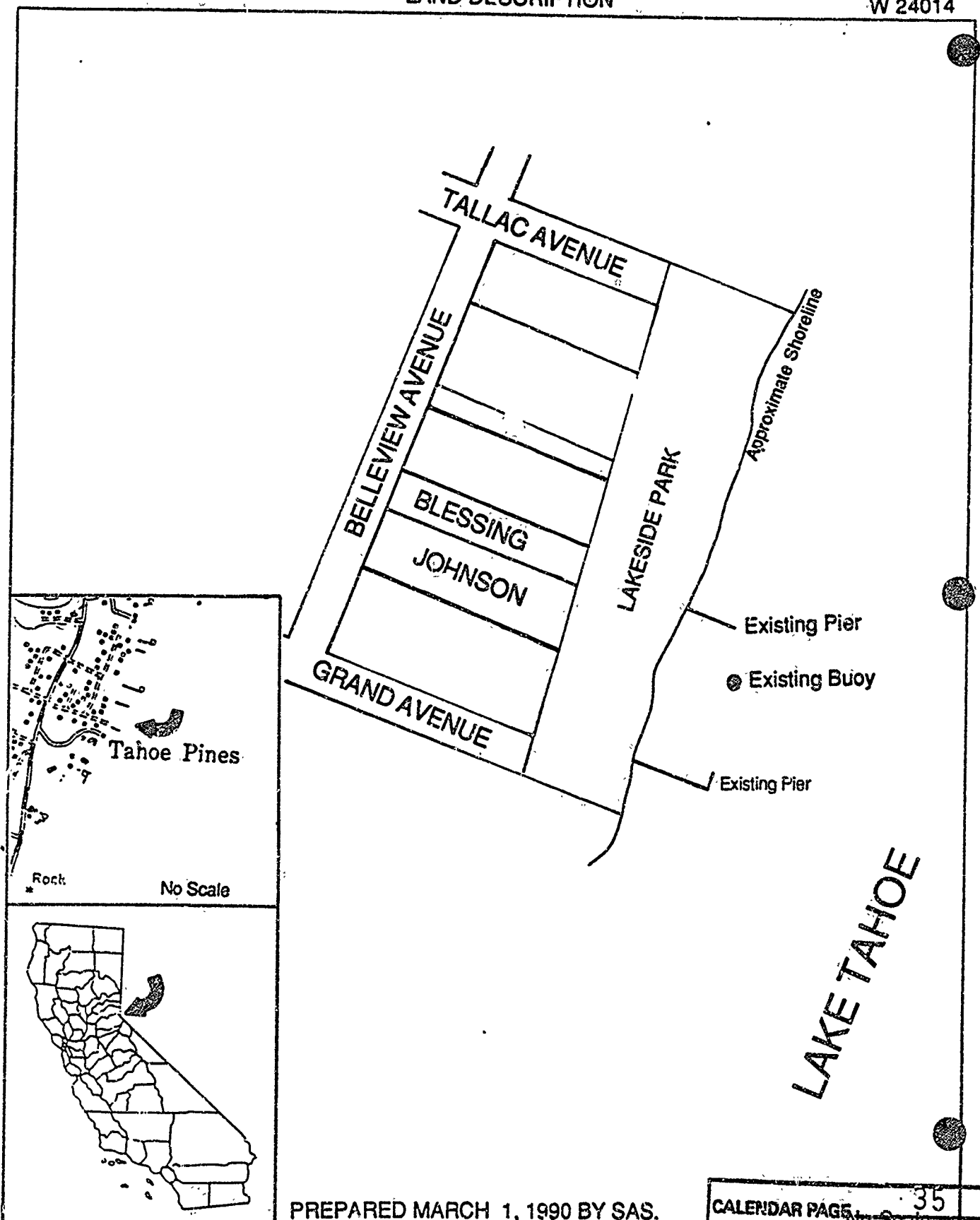

PREPARED MARCH 1, 1990 BY SAS.

CALENDAR PAGE	35
MINUTE PAGE	915

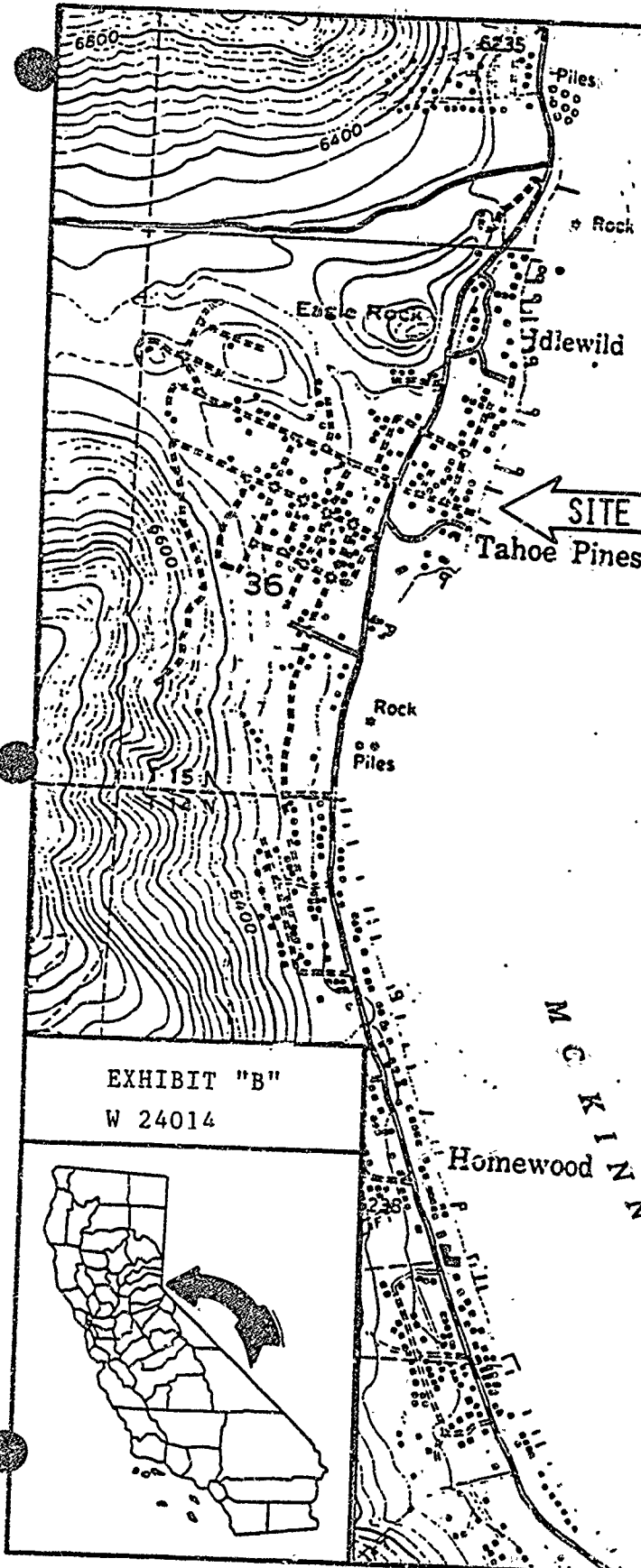

L A K E

MAXIMUM ELEVATION 6229

T A H O E



EXHIBIT "B"
W 24014



M C K I N N E Y

Homewood

B A Y

CALENDAR PAGE	36
MINUTE PAGE	916

STATE OF CALIFORNIA-STATE LANDS COMMISSION

STATE LANDS COMMISSION
1807 13TH STREET
SACRAMENTO, CALIFORNIA 95814

GEORGE DEUKMEJIAN, Governor

PROPOSED NEGATIVE DECLARATION

EIR NO 501

File Ref.: W24402

SCH#:

Project Title: Fiddymment Buoys Application

Project Proponent: Joan Fiddymment

Project Location: Lake Tahoe, near Tahoe City, Placer County.
Adjacent to: APN 84-132-06Project Description: Authorize two existing mooring
buoys anchored on the bed of
Lake Tahoe.

Contact Person: Judy Brown

Telephone: 916)324-4715

This document is prepared pursuant to the requirements of the California Environmental Quality Act (Section 21000 et seq., Public Resources Code), the State CEQA Guidelines (Section 15000 et seq., Title 14, California Code Regulations), and the State Lands Commission regulations (Section 2901 et seq., Title 2, California Code Regulations).

Based upon the attached Initial Study, it has been found that:

the project will not have a significant effect on the environment.

mitigation measures included in the project will avoid potentially significant effects.

CALENDAR PAGE	37
MINUTE PAGE	917

Form 13.17 (3/89)

ENVIRONMENTAL IMPACT ASSESSMENT FORM - Part I
(To be completed by applicant)
FORM 69.3111/82)

A. GENERAL INFORMATION

1. Name, address, and telephone number:

a. Applicant

b. Contact person if other than applicant:

Joan Claus Fidyment
6405 Fidyment Rd.
Roseville - CA 95678
916-771-0330

2. a. Project location: (Please reference to nearest town or community and include county)

2600 Westlake Blvd
Home wood - CA Placer Co

b. Assessor's parcel number:

084-132-06-0-0

3. Existing zoning of project site:

residential

4. Existing land use of project site:

''

5. Proposed use of site:

''

6. Other permits required:

none

B. PROJECT DESCRIPTION

1. For building construction projects, complete "ATTACHMENT A".

2. For non-building construction projects: Describe fully, the proposed activity, its purpose and intended use, e.g. for proposed mineral prospecting permits, include the number of test holes, size of holes, amount of material to be excavated, maximum surface area of disturbance, hole locations, depth of holes, etc. Attach plans or other drawings as necessary.

CALENDAR PAGE 38

DATE PAGE 918

C. ENVIRONMENTAL SETTING

1. Describe the project site as it exists before the project, including information on topography, soil stability, plants and animals, and any cultural, historical, or scenic aspects. Describe any existing structures on the site, and the use of the structures.
2. Describe the surrounding properties, including information on plants and animals and any cultural, historical, or scenic aspects indicate the type of land use (residential, commercial, etc.), intensity of land use (one-family, apartment houses, shops, department stores, etc.), and scale of development (height, frontage, set-back, rear yard, etc.).

D. ENVIRONMENTAL IMPACT ASSESSMENT

Answer the following questions by placing a check in the appropriate box. Discuss all items checked, "yes" or "maybe". (Attach additional sheets as necessary)

Will the project involve:	YES	MAYBE	NO
1. a change in existing features of any bays, tidelands, beaches, lakes, or hills, or substantial alteration of ground contours?	<input type="checkbox"/>	<input type="checkbox"/>	<input checked="" type="checkbox"/>
2. a change in scenic views or vistas from existing residential areas or public lands or roads?	<input type="checkbox"/>	<input type="checkbox"/>	<input checked="" type="checkbox"/>
3. a change in pattern, scale, or character of the general area of project?	<input type="checkbox"/>	<input type="checkbox"/>	<input checked="" type="checkbox"/>
4. a significant effect on plant or animal life?	<input type="checkbox"/>	<input type="checkbox"/>	<input checked="" type="checkbox"/>
5. significant amounts of solid waste or litter?	<input type="checkbox"/>	<input type="checkbox"/>	<input checked="" type="checkbox"/>
6. a change in dust, ash, smoke, fumes, or odors in the vicinity?	<input type="checkbox"/>	<input type="checkbox"/>	<input checked="" type="checkbox"/>
7. a change in ocean, bay, lake, stream, or ground water quality or quantity, or alteration of existing drainage patterns?	<input type="checkbox"/>	<input checked="" type="checkbox"/>	<input checked="" type="checkbox"/>
8. a change in existing noise or vibration levels in the vicinity?	<input type="checkbox"/>	<input type="checkbox"/>	<input checked="" type="checkbox"/>
9. construction on filled land or on slope of 10 percent or more?	<input type="checkbox"/>	<input type="checkbox"/>	<input checked="" type="checkbox"/>
10. use or disposal of potentially hazardous materials, such as toxic or radioactive substances, flammables, or explosives?	<input type="checkbox"/>	<input type="checkbox"/>	<input checked="" type="checkbox"/>
11. a change in demand for municipal services (police, fire, water, sewage, etc.)?	<input type="checkbox"/>	<input type="checkbox"/>	<input checked="" type="checkbox"/>
12. an increase in fossil fuel consumption (electricity, oil, natural gas, etc.)?	<input type="checkbox"/>	<input type="checkbox"/>	<input checked="" type="checkbox"/>
13. a larger project or a series of projects?	<input type="checkbox"/>	<input type="checkbox"/>	<input checked="" type="checkbox"/>

E. CERTIFICATION

I hereby certify that the statements furnished above and in the attached exhibits present the data and information required for this initial evaluation to the best of my ability, and that the facts, statements, and information presented are true and correct to the best of my knowledge and belief.

Date: 7-20-89

Signed: Jocyn Clouss Kiddimo

CALENDAR PAGE 39
 MINUTE PAGE 919

ENVIRONMENTAL IMPACT ASSESSMENT CHECKLIST - PART II

Form 13.20 (7/82)

File Ref.: W 24402

I. BACKGROUND INFORMATION

A. Applicant: Joan Fiddymment
6405 Fiddymment Road
Roseville, CA 95678

B. Checklist Date: 01 / 10 / 90

C. Contact Person: Judy Brown
Telephone: (916) 324-4715

D. Purpose: Authorize two existing mooring buoys

E. Location: Lake Tahoe, near Tahoe City, Placer County

F. Description: Two existing mooring buoys anchored on the bed of Lake Tahoe.

G. Persons Contacted:

II. ENVIRONMENTAL IMPACTS. (Explain all "yes" and "maybe" answers)

Table with 3 columns: Question, Yes, Maybe, No. Contains 7 rows of environmental impact questions with checkboxes and 'X' marks.

CALENDAR PAGE 40
MINUTE PAGE 920

- B Air** Will the proposal result in:
- 1 Substantial air emissions or deterioration of ambient air quality? Yes Maybe No
 - 2 The creation of objectionable odors? Yes Maybe No
 - 3 Alteration of air movement, moisture or temperature, or any change in climate, either locally or regionally? Yes Maybe No
- C Water** Will the proposal result in:
- 1 Changes in the currents, or the course or direction of water movements, in either marine or fresh waters? Yes Maybe No
 - 2 Changes in absorption rates, drainage patterns, or the rate and amount of surface water runoff? Yes Maybe No
 - 3 Alterations to the course or flow of flood waters? Yes Maybe No
 - 4 Change in the amount of surface water in any water body? Yes Maybe No
 - 5 Discharge into surface waters, or in any alteration of surface water quality, including but not limited to temperature, dissolved oxygen or turbidity? Yes Maybe No
 - 6 Alteration of the direct on or rate of flow of ground waters? Yes Maybe No
 - 7 Change in the quantity of ground waters, either through direct additions or withdrawals, or through inter-ception of an aquifer by cuts or excavations? Yes Maybe No
 - 8 Substantial reduction in the amount of water otherwise available for public water supplies? Yes Maybe No
 - 9 Exposure of people or property to water-related hazards such as flooding or tidal waves? Yes Maybe No
 - 10 Significant changes in the temperature, flow or chemical content of surface thermal springs? Yes Maybe No
- D Plant Life** Will the proposal result in:
- 1 Change in the diversity of species, or number of any species of plants (including trees, shrubs, grass, crops, and aquatic plants)? Yes Maybe No
 - 2 Reduction of the numbers of any unique, rare or endangered species of plants? Yes Maybe No
 - 3 Introduction of new species of plants into an area, or in a barrier to the normal replenishment of existing species? Yes Maybe No
 - 4 Reduction in acreage of any agricultural crop? Yes Maybe No
- E Animal Life** Will the proposal result in:
- 1 Change in the diversity of species, or numbers of any species of animals (birds, land animals including reptiles, fish, shellfish, benthic organisms, or insects)? Yes Maybe No
 - 2 Reduction of the numbers of any unique, rare or endangered species of animals? Yes Maybe No
 - 3 Introduction of new species of animals into an area, or result in a barrier to the migration or movement of animals? Yes Maybe No
 - 4 Deterioration to existing fish or wildlife habitat? Yes Maybe No
- F Noise** Will the proposal result in:
- 1 Increase in existing noise levels? Yes Maybe No
 - 2 Exposure of people to severe noise levels? Yes Maybe No
- G Light and Glare** Will the proposal result in:
- 1 The production of new light or glare? Yes Maybe No
- ii Land Use** Will the proposal result in:
- 1 A substantial alteration of the present or planned land use of an area? Yes Maybe No
- Natural Resources** Will the proposal result in:
- 1 Increase in the rate of use of any natural resources? Yes Maybe No
 - 2 Substantial depletion of any nonrenewable resources? Yes Maybe No

J. Risk of Upset. Does the proposal result in:

Yes Maybe No

- 1. A risk of an explosion or the release of hazardous substances (including, but not limited to, oil, pesticides, chemicals, or radiation) in the event of an accident or upset conditions?
- 2. Possible interference with emergency response plan or an emergency evacuation plan?

K. Population. Will the proposal result in:

- 1. The alteration, distribution, density, or growth rate of the human population of the area?

L. Housing. Will the proposal result in:

- 1. Affecting existing housing, or create a demand for additional housing?

M. Transportation/Circulation. Will the proposal result in:

- 1. Generation of substantial additional vehicular movement?
- 2. Affecting existing parking facilities, or create a demand for new parking?
- 3. Substantial impact upon existing transportation systems?
- 4. Alterations to present patterns of circulation or movement of people and/or goods?
- 5. Alterations to waterborne, rail, or air traffic?
- 6. Increase in traffic hazards to motor vehicles, bicyclists, or pedestrians?

N. Public Services. Will the proposal have an effect upon, or result in a need for new or altered governmental services in any of the following areas:

- 1. Fire protection?
- 2. Police protection?
- 3. Schools?
- 4. Parks and other recreational facilities?
- 5. Maintenance of public facilities, including roads?
- 6. Other governmental services?

O. Energy. Will the proposal result in:

- 1. Use of substantial amounts of fuel or energy?
- 2. Substantial increase in demand upon existing sources of energy, or require the development of new sources?

P. Utilities. Will the proposal result in a need for new systems, or substantial alterations to the following utilities:

- 1. Power or natural gas?
- 2. Communication systems?
- 3. Water?
- 4. Sewer or septic tanks?
- 5. Storm water drainage?
- 6. Solid waste and disposal?

Q. Human Health. Will the proposal result in:

- 1. Creation of any health hazard or potential health hazard (excluding mental health)?
- 2. Exposure of people to potential health hazards?

R. Aesthetics. Will the proposal result in:

- 1. The obstruction of any scenic vista or view open to the public, or will the proposal result in the creation of an aesthetically offensive site open to public view?

S. Recreation. Will the proposal result in:

- 1. An impact upon the quality or quantity of existing recreational opportunities?

MINUTE PAGE	<input checked="" type="checkbox"/>	42
MINUTE PAGE	<input type="checkbox"/>	922

T. Cultural Resources.

Yes Maybe No

- 1. Will the proposal result in the alteration of or the destruction of a prehistoric or historic archeological site?
- 2. Will the proposal result in adverse physical or aesthetic effects to a prehistoric or historic building, structure, or object?
- 3. Does the proposal have the potential to cause a physical change which would affect unique ethnic cultural values?
- 4. Will the proposal restrict existing religious or sacred uses within the potential impact area?

U. Mandatory Findings of Significance.

- 1. Does the project have the potential to degrade the quality of the environment, reduce the habitat of a fish or wildlife species, cause a fish or wildlife population to drop below self-sustaining levels, threaten to eliminate a plant or animal community, reduce the number or restrict the range of a rare or endangered plant or animal or eliminate important examples of the major periods of California history or prehistory?
- 2. Does the project have the potential to achieve short term, to the disadvantage of long-term, environmental goals?
- 3. Does the project have impacts which are individually limited, but cumulatively considerable?
- 4. Does the project have environmental effects which will cause substantial adverse effects on human beings, either directly or indirectly?

III. DISCUSSION OF ENVIRONMENTAL EVALUATION (See Comments Attached)

IV. PRELIMINARY DETERMINATION

On the basis of this initial evaluation:

- I find the proposed project **COULD NOT** have a significant effect on the environment, and a **NEGATIVE DECLARATION** will be prepared.
- I find that although the proposed project could have a significant effect on the environment, there will not be a significant effect in this case because the mitigation measures described on an attached sheet have been added to the project. A **NEGATIVE DECLARATION** will be prepared.
- I find the proposed project **MAY** have a significant effect on the environment, and an **ENVIRONMENTAL IMPACT REPORT** is required.

Date 01 / 09 / 90

Judy A. Brown
 For the State Lands Commission AR PAGE 43
 MINUTE PAGE 923

III. DISCUSSION OF ENVIRONMENTAL EVALUATION
Attachment to Environmental Impact Assessment Checklist - Part II
W 24402

E1. Lake Lake adjacent to APN: 84-132-06 is designated a fish spawning/habitat restoration area on the Tahoe Regional Planning Agency maps. Placement of two buoys at this location will not substantially alter the lake bottom and thus will not adversely affect the spawning habitat. Recreational use induced in this area of the Lake by the project may affect fish productivity minimally.

M5. This application is for consideration of two existing mooring buoys. One is placed 30 feet from the north property line, approximately 100 feet from the low water line (elev. 6223'). The second buoy is located 50' south of the first buoy, approximately 70 feet from the low water line. There is a pier waterward of the adjacent parcel on the north, and a pier and buoy waterward of the adjacent parcel to the south. Spacing between waterward facilities is approximately 50 feet.

The buoys are located adjacent to private upland ownership and when boats are secured to them, they will limit public access by boat to the shore area at this location, and will continue to restrict use of the shore area available to topline trolling.

R1. Buoys themselves do not present much of a visual obstruction. According to The Cumulative Impacts of Shorezone Development at Lake Tahoe, by Phillips, Brandt, Reddick, McDonald, and Grefe, dated February 1978, pp. 4-79, in public responses to visual aspects of shorezone development and use, a grouping of seven boats closely spaced was considered to be a "visual dislike", therefore this proposal does not constitute a significant effect.

S1. The quality and quantity of recreation will change to the owner of these buoys, who will benefit in more convenient, and perhaps more frequent recreational use of Lake Tahoe. Recreational quality will not substantially change for topline trollers as was discussed in M5, above.

EXHIBIT "A"

LAND DESCRIPTION

W 24402

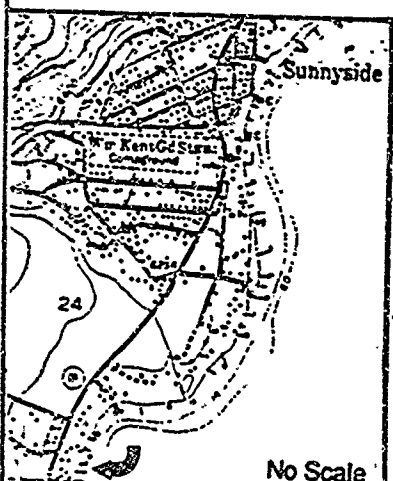
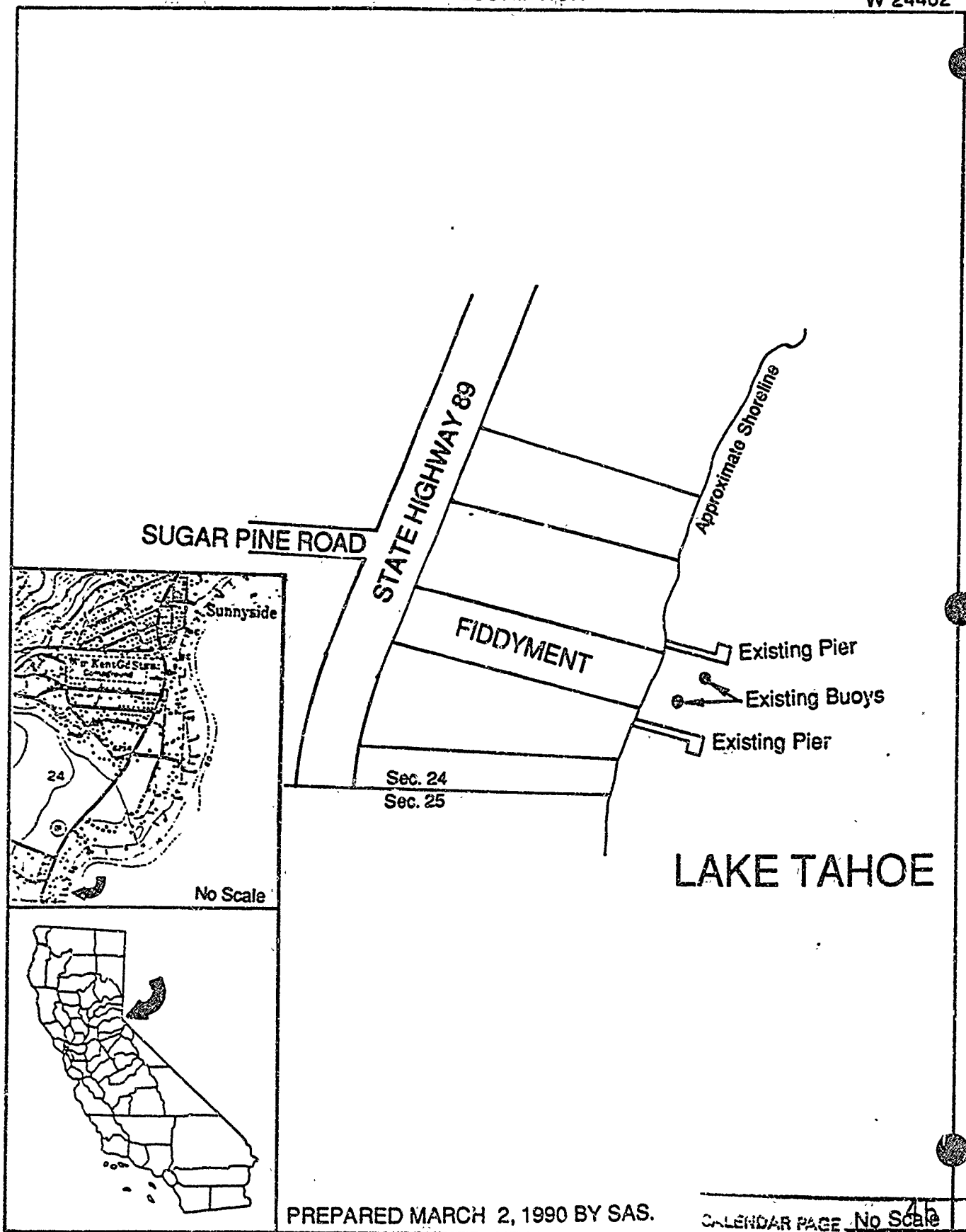

PREPARED MARCH 2, 1990 BY SAS.

CALENDAR PAGE	No Scale
MINUTE PAGE	925

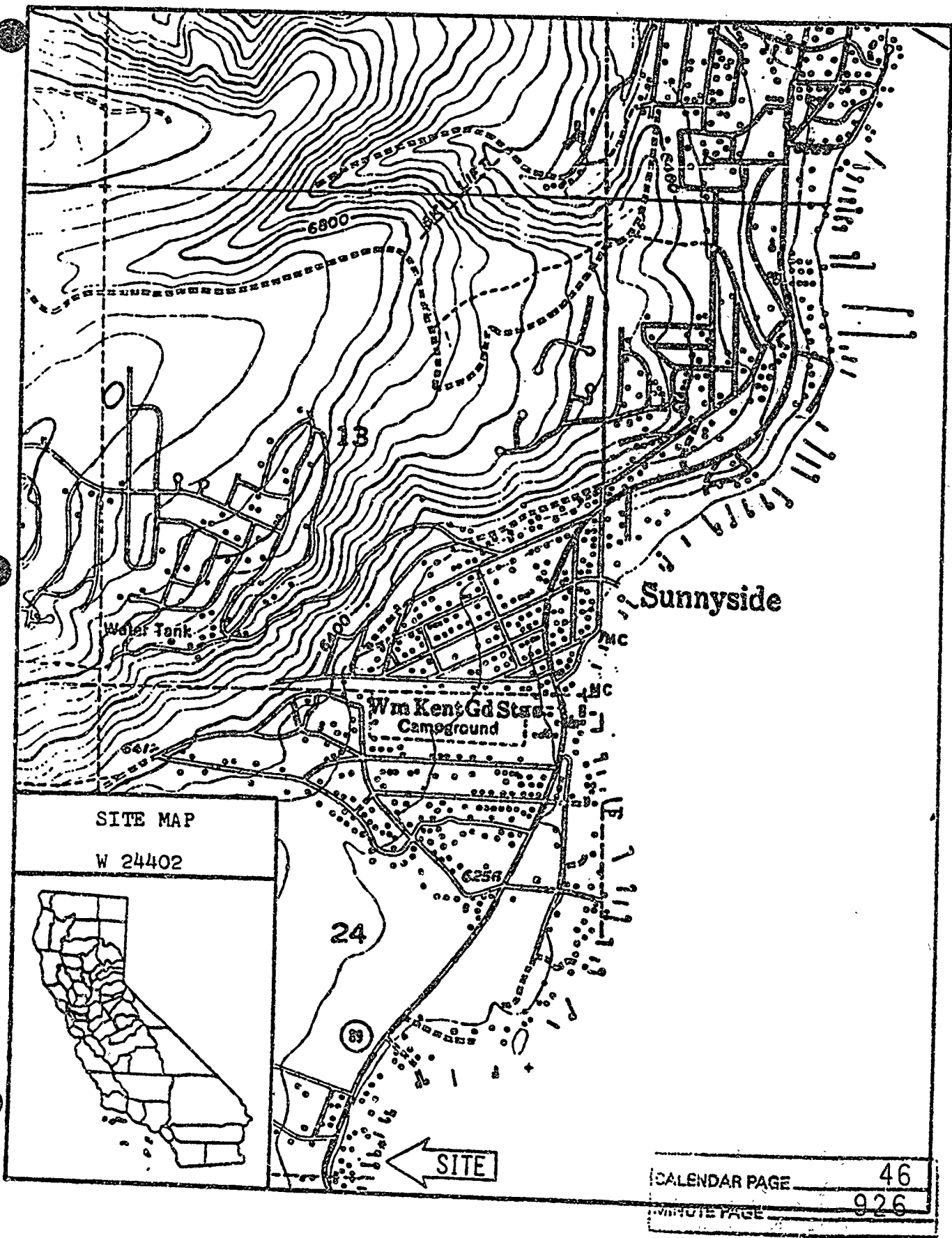

EXHIBIT "C"

STATE OF CALIFORNIA

STATE LANDS COMMISSION

LEO T. McCARTHY, *Lieutenant Governor*
GRAY DAVIS, *Controller*
JESSE R. HUFF, *Director of Finance*

GEORGE DEUKMEJIAN, *Governor*

EXECUTIVE OFFICE
1807 - 13th Street
Sacramento, CA 95834

CHARLES WARREN
Executive Officer

PROPOSED NEGATIVE DECLARATION

EIR ND: 505

File Ref: W 24418

SCH. NO.: 90020333

Project Title: Hadelor Buoy Application

Project Proponent: Robert Hadelor

Project Location: Lake Tahoe, El Dorado County, adjacent to APN 15-370-06, 7175 Westlake Boulevard, Tahoma

Project Description: Authorization of one existing mooring buoy.

Contact Person: Betty Eubanks Telephone: (916) 322-2795

This document is prepared pursuant to the requirements of the California Environmental Quality Act (Section 2100 et seq., Public Resources Code), the State CEQA Guidelines (Section 15000 et seq., Title 14, California Code Regulations), and the State Lands Commission regulations (Section 2901 et seq., Title 2, California Code Regulations).

Based upon the attached Initial Study, it has been found that:

that project will not have a significant effect on the environment.

mitigation measures included in the project will avoid potentially significant effects.

FORM 13.17 (4/90)

CALENDAR PAGE 47
MINUTE PAGE 927

ENVIRONMENTAL IMPACT ASSESSMENT CHECKLIST - PART II

Form 13.20 (7/82)

File Ref.: W 24418

I. BACKGROUND INFORMATION

A. Applicant: Robert Haderl
8727 Shoreham Drive #2
Los Angeles, CA 90069

B. Checklist Date: 4 / 10 / 90

C. Contact Person: Betty Eubanks
Telephone: (916) 322-2795

D. Purpose: Authorization for one existing buoy.

E. Location: 7175 Westlake Blvd., Tahoma, CA 95733, El Dorado County, Lake Tahoe
adjacent to APN 15-370-06

F. Description: One existing mooring buoy anchored on bed of Lake Tahoe.

G. Persons Contacted:

II. ENVIRONMENTAL IMPACTS. (Explain all "yes" and "maybe" answers)

Table with 3 columns: Question, Yes, Maybe, No. Contains 7 rows of environmental impact questions with checkboxes.

CALENDAR PAGE: 48
MINUTE PAGE: 928

B. *Air*. Will the proposal result in:

Yes Maybe No

- 1. Substantial air emissions or deterioration of ambient air quality?
- 2. The creation of objectionable odors?
- 3. Alteration of air movement, moisture or temperature, or any change in climate, either locally or regionally?

C. *Water*. Will the proposal result in:

- 1. Changes in the currents, or the course or direction of water movements, in either marine or fresh waters?
- 2. Changes in absorption rates, drainage patterns, or the rate and amount of surface water runoff?
- 3. Alterations to the course or flow of flood waters?
- 4. Change in the amount of surface water in any water body?
- 5. Discharge into surface waters, or in any alteration of surface water quality, including but not limited to temperature, dissolved oxygen or turbidity?
- 6. Alteration of the direction or rate of flow of ground waters?
- 7. Change in the quantity of ground waters, either through direct additions or withdrawals, or through interception of an aquifer by cuts or excavations?
- 8. Substantial reduction in the amount of water otherwise available for public water supplies?
- 9. Exposure of people or property to water-related hazards such as flooding or tidal waves?
- 10. Significant changes in the temperature, flow or chemical content of surface thermal springs?

D. *Plant Life*. Will the proposal result in:

- 1. Change in the diversity of species, or number of any species of plants (including trees, shrubs, grass, crops, and aquatic plants)?
- 2. Reduction of the numbers of any unique, rare or endangered species of plants?
- 3. Introduction of new species of plants into an area, or in a barrier to the normal replenishment of existing species?
- 4. Reduction in acreage of any agricultural crop?

E. *Animal Life*. Will the proposal result in:

- 1. Change in the diversity of species, or numbers of any species of animals (birds, land animals including reptiles, fish and shellfish, benthic organisms, or insects)?
- 2. Reduction of the numbers of any unique, rare or endangered species of animals?
- 3. Introduction of new species of animals into an area, or result in a barrier to the migration or movement of animals?
- 4. Deterioration to existing fish or wildlife habitat?

F. *Noise*. Will the proposal result in:

- 1. Increase in existing noise levels?
- 2. Exposure of people to severe noise levels?

G. *Light and Glare*. Will the proposal result in:

- 1. The production of new light or glare?

H. *Land Use*. Will the proposal result in:

- 1. A substantial alteration of the present or planned land use of an area?

I. *Natural Resources*. Will the proposal result in:

- 1. Increase in the rate of use of any natural resources?
- 2. Substantial depletion of any nonrenewable resources?

- J. *Risk of Upset.* Does the proposal result in:
- | | Yes | Maybe | No |
|---|--------------------------|--------------------------|-------------------------------------|
| 1. A risk of an explosion or the release of hazardous substances (including, but not limited to, oil, pesticides, chemicals, or radiation) in the event of an accident or upset conditions? | <input type="checkbox"/> | <input type="checkbox"/> | <input checked="" type="checkbox"/> |
| 2. Possible interference with emergency response plan or an emergency evacuation plan? | <input type="checkbox"/> | <input type="checkbox"/> | <input checked="" type="checkbox"/> |
- K. *Population.* Will the proposal result in:
- | | | | |
|---|--------------------------|--------------------------|-------------------------------------|
| 1. The alteration, distribution, density, or growth rate of the human population of the area? | <input type="checkbox"/> | <input type="checkbox"/> | <input checked="" type="checkbox"/> |
|---|--------------------------|--------------------------|-------------------------------------|
- L. *Housing.* Will the proposal result in:
- | | | | |
|---|--------------------------|--------------------------|-------------------------------------|
| 1. Affecting existing housing, or create a demand for additional housing? | <input type="checkbox"/> | <input type="checkbox"/> | <input checked="" type="checkbox"/> |
|---|--------------------------|--------------------------|-------------------------------------|
- M. *Transportation/Circulation.* Will the proposal result in:
- | | | | |
|---|-------------------------------------|--------------------------|-------------------------------------|
| 1. Generation of substantial additional vehicular movement? | <input type="checkbox"/> | <input type="checkbox"/> | <input checked="" type="checkbox"/> |
| 2. Affecting existing parking facilities, or create a demand for new parking? | <input type="checkbox"/> | <input type="checkbox"/> | <input checked="" type="checkbox"/> |
| 3. Substantial impact upon existing transportation systems? | <input type="checkbox"/> | <input type="checkbox"/> | <input checked="" type="checkbox"/> |
| 4. Alterations to present patterns of circulation or movement of people and/or goods? | <input type="checkbox"/> | <input type="checkbox"/> | <input checked="" type="checkbox"/> |
| 5. Alterations to waterborne, rail, or air traffic? | <input checked="" type="checkbox"/> | <input type="checkbox"/> | <input checked="" type="checkbox"/> |
| 6. Increase in traffic hazards to motor vehicles, bicyclists, or pedestrians? | <input type="checkbox"/> | <input type="checkbox"/> | <input checked="" type="checkbox"/> |
- N. *Public Services.* Will the proposal have an effect upon, or result in a need for new or altered governmental services in any of the following areas:
- | | | | |
|---|--------------------------|--------------------------|-------------------------------------|
| 1. Fire protection? | <input type="checkbox"/> | <input type="checkbox"/> | <input checked="" type="checkbox"/> |
| 2. Police protection? | <input type="checkbox"/> | <input type="checkbox"/> | <input checked="" type="checkbox"/> |
| 3. Schools? | <input type="checkbox"/> | <input type="checkbox"/> | <input checked="" type="checkbox"/> |
| 4. Parks and other recreational facilities? | <input type="checkbox"/> | <input type="checkbox"/> | <input checked="" type="checkbox"/> |
| 5. Maintenance of public facilities, including roads? | <input type="checkbox"/> | <input type="checkbox"/> | <input checked="" type="checkbox"/> |
| 6. Other governmental services? | <input type="checkbox"/> | <input type="checkbox"/> | <input checked="" type="checkbox"/> |
- O. *Energy.* Will the proposal result in:
- | | | | |
|---|--------------------------|--------------------------|-------------------------------------|
| 1. Use of substantial amounts of fuel or energy? | <input type="checkbox"/> | <input type="checkbox"/> | <input checked="" type="checkbox"/> |
| 2. Substantial increase in demand upon existing sources of energy, or require the development of new sources? | <input type="checkbox"/> | <input type="checkbox"/> | <input checked="" type="checkbox"/> |
- P. *Utilities.* Will the proposal result in a need for new systems, or substantial alterations to the following utilities:
- | | | | |
|------------------------------------|-------------------------------------|--------------------------|-------------------------------------|
| 1. Power or natural gas? | <input checked="" type="checkbox"/> | <input type="checkbox"/> | <input checked="" type="checkbox"/> |
| 2. Communication systems? | <input type="checkbox"/> | <input type="checkbox"/> | <input checked="" type="checkbox"/> |
| 3. Water? | <input type="checkbox"/> | <input type="checkbox"/> | <input checked="" type="checkbox"/> |
| 4. Sewer or septic tanks? | <input type="checkbox"/> | <input type="checkbox"/> | <input checked="" type="checkbox"/> |
| 5. Storm water drainage? | <input type="checkbox"/> | <input type="checkbox"/> | <input checked="" type="checkbox"/> |
| 6. Solid waste and disposal? | <input type="checkbox"/> | <input type="checkbox"/> | <input checked="" type="checkbox"/> |
- Q. *Human Health.* Will the proposal result in:
- | | | | |
|--|--------------------------|--------------------------|-------------------------------------|
| 1. Creation of any health hazard or potential health hazard (excluding mental health)? | <input type="checkbox"/> | <input type="checkbox"/> | <input checked="" type="checkbox"/> |
| 2. Exposure of people to potential health hazards? | <input type="checkbox"/> | <input type="checkbox"/> | <input checked="" type="checkbox"/> |
- R. *Aesthetics.* Will the proposal result in:
- | | | | |
|--|--------------------------|-------------------------------------|--------------------------|
| 1. The obstruction of any scenic vista or view open to the public, or will the proposal result in the creation of an aesthetically offensive view open to public view? | <input type="checkbox"/> | <input checked="" type="checkbox"/> | <input type="checkbox"/> |
|--|--------------------------|-------------------------------------|--------------------------|
- S. *Recreation.* Will the proposal result in:
- | | | | |
|---|--------------------------|-------------------------------------|--------------------------|
| 1. An impact upon the quality or quantity of existing recreational opportunities? | <input type="checkbox"/> | <input checked="" type="checkbox"/> | <input type="checkbox"/> |
|---|--------------------------|-------------------------------------|--------------------------|

CALENDAR PAGE 20

MINUTE PAGE 930

T. Cultural Resources.

Yes Maybe No

- 1. Will the proposal result in the alteration of or the destruction of a prehistoric or historic archeological site?
- 2. Will the proposal result in adverse physical or aesthetic effects to a prehistoric or historic building, structure, or object?
- 3. Does the proposal have the potential to cause a physical change which would affect unique ethnic cultural values?
- 4. Will the proposal restrict existing religious or sacred uses within the potential impact area?

U. Mandatory Findings of Significance.

- 1. Does the project have the potential to degrade the quality of the environment, reduce the habitat of a fish or wildlife species, cause a fish or wildlife population to drop below self-sustaining levels, threaten to eliminate a plant or animal community, reduce the number or restrict the range of a rare or endangered plant or animal or eliminate important examples of the major periods of California history or prehistory?
- 2. Does the project have the potential to achieve short-term, to the disadvantage of long-term, environmental goals?
- 3. Does the project have impacts which are individually limited, but cumulatively considerable?
- 4. Does the project have environmental effects which will cause substantial adverse effects on human beings, either directly or indirectly?

III. DISCUSSION OF ENVIRONMENTAL EVALUATION (See Comments Attached)

IV. PRELIMINARY DETERMINATION

On the basis of this initial evaluation:

- I find the proposed project COULD NOT have a significant effect on the environment, and a NEGATIVE DECLARATION will be prepared.
- I find that although the proposed project could have a significant effect on the environment, there will not be a significant effect in this case because the mitigation measures described on an attached sheet have been added to the project. A NEGATIVE DECLARATION will be prepared.
- I find the proposed project MAY have a significant effect on the environment, and an ENVIRONMENTAL IMPACT REPORT is required.

Date: 04 / 10 / 90

Betty Eubanks
 For the State Lands Commission

CALENDAR PAGE	51
MINUTE PAGE	931
BETTY EUBANKS	

III. DISCUSSION OF ENVIRONMENTAL EVALUATION
ATTACHMENT to ENVIRONMENTAL IMPACT ASSESSMENT CHECKLIST - Part II
W 24418 - Robert Hadelers

E1. Lake Tahoe in this area is designated a fish spawning/habitat restoration area on the Tahoe Regional Planning Agency maps. Placement of one buoy in this area will not adversely affect the spawning habitat. Recreational use may be induced in this area by the project, but should have only minimal effects on fish productivity.

M5. The existing buoy for this application is located approximately 300 feet from the waterline. Existing piers, each approximately 100 feet long, are located on the adjacent property lines both to the north and south of the applicant's property approximately 63 feet apart. The applicant's buoy is approximately 200 feet waterward of the piers. There are two buoys, one on each side of the applicant's buoy, located approximately 25 yards to the north and south of the Hadelers buoy.

The buoys are located adjacent to private upland ownership. When boats are secured to the buoys, public access to the shore area will continue to be restricted at this location for recreational boaters as well as topline trollers. The clustering of the buoys and piers will not significantly change the navigational use of the shore area.

R1. Buoys alone do not present a significant visual obstruction. According to The Cumulative Impacts of Shorezone Development at Lake Tahoe, by Phillips, Brandt, Reddick, McDonald, and Grefe, dated February 1978, pp. 4-79, in public responses to visual aspects of shorezone development and use, a grouping of seven boats closely spaced was considered to be a "visual dislike". Therefore, this proposal does not constitute a significant effect.

S1. The quality/quantity of recreation will change for the owner of the buoy. However, the quality of recreation for topline trollers will not change significantly as a result of this buoy placement as other buoys and piers exist in and near the shore in this vicinity.

(041090)

CALENDAR PAGE	52
MINUTE PAGE	932

EXHIBIT "A"

LAND DESCRIPTION

W 24418

LAKE TAHOE

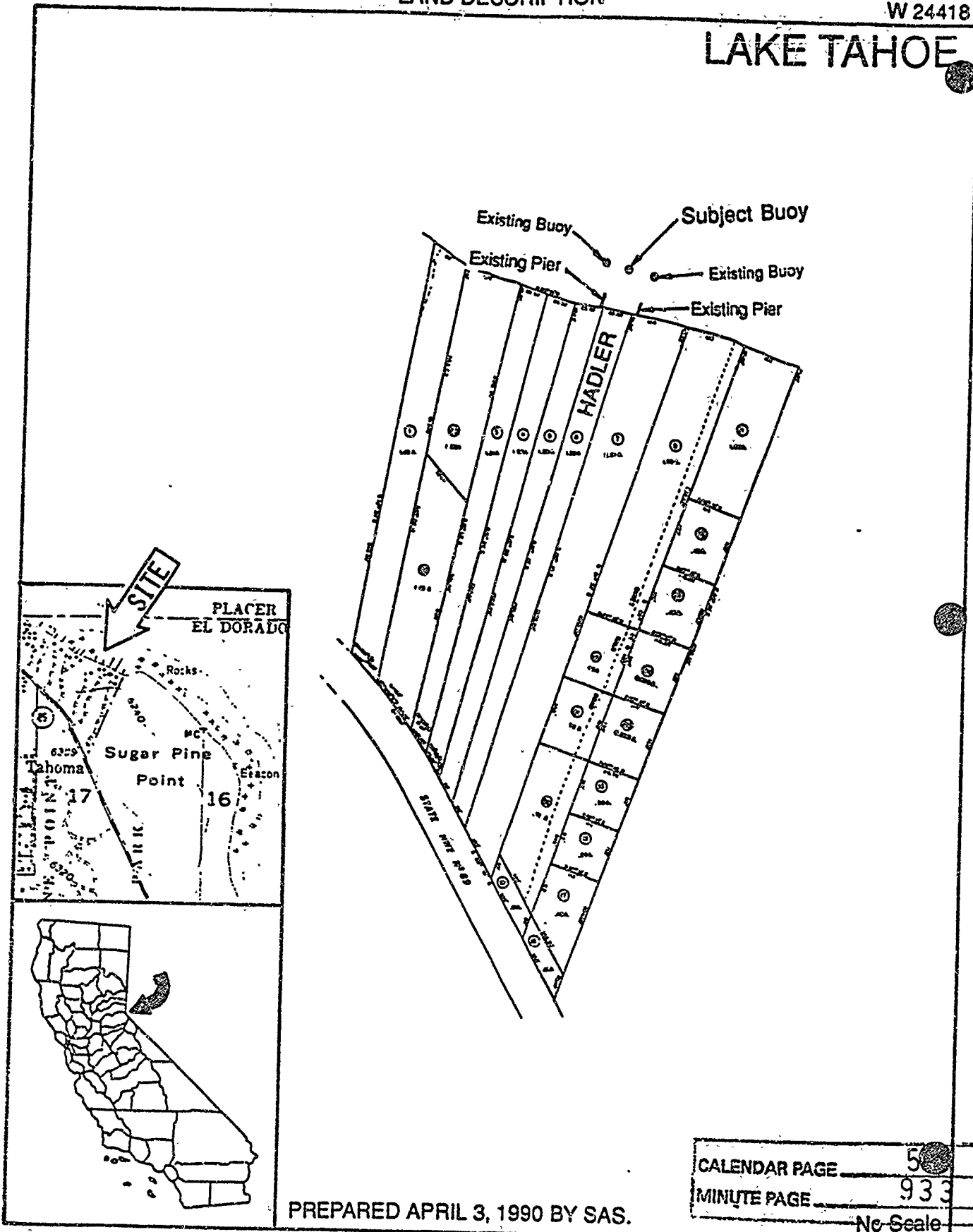

PREPARED APRIL 3, 1990 BY SAS.

CALENDAR PAGE	50
MINUTE PAGE	933
No Scale	

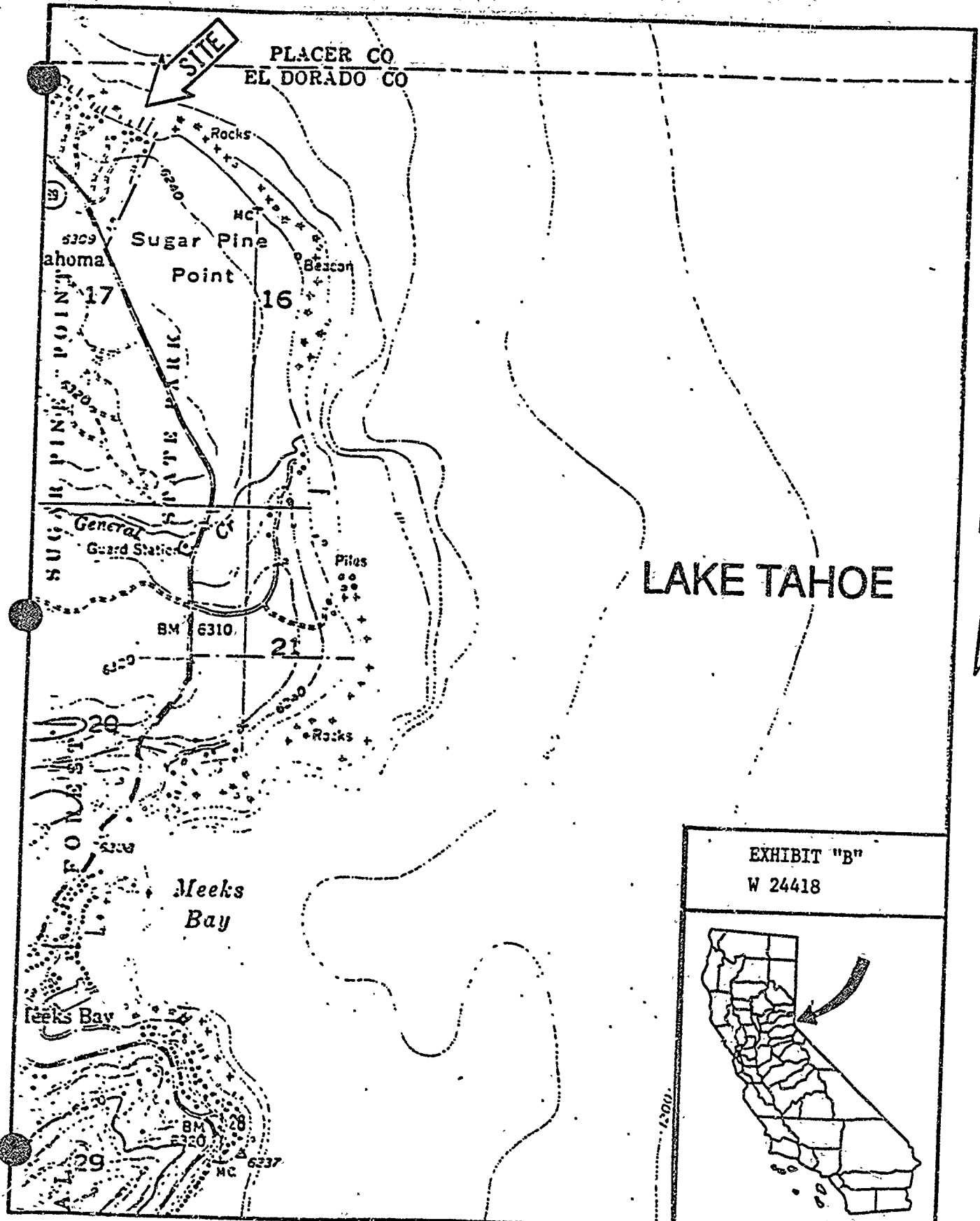

EXHIBIT "B"
W 24418



CALENDAR PAGE 54
MINUTE PAGE 934