

MINUTE ITEM

25

03/27/90
W 24200
Bancroft

GENERAL LEASE - PUBLIC AGENCY USE

Calendar Item 25, attached, was pulled from the agenda prior to the meeting.

Attachment: Calendar Item 25.

A 1
~ 4

CALENDAR PAGE	_____
MINUTE PAGE	542

CALENDAR ITEM

A 1
S 4

25

03/27/90
W 24200
Bancroft

GENERAL LEASE - PUBLIC AGENCY USE

APPLICANT: Transmission Agency of Northern California
P. O. Box 661030
Sacramento, California 95866

AREA, TYPE LAND AND LOCATION:
A 1.194-acre parcel of submerged land located
in the Sacramento River in Shasta County.

LAND USE: Right-of-way for a 500kv powerline crossing.

TERMS OF PROPOSED LEASE:
Initial period: Forty-nine (49) years
beginning January 1, 1990.

CONSIDERATION: The public use and benefit; with the State
reserving the right at any time to set a
monetary rental if the Commission finds such
action to be in the State's best interest.

BASIS FOR CONSIDERATION:
Pursuant to 2 Cal. Code Regs. 2003.

APPLICANT STATUS:
Applicant is permittee of upland and is a Joint
Powers Agency qualifying for rent-free status..

PREREQUISITE CONDITIONS, FEES AND EXPENSES:
Filing fee and processing costs have been
received.

(ADDED pgs. 224-224.5)

-1-

CALENDAR PAGE	224
MINUTE PAGE	543

STATUTORY AND OTHER REFERENCES:

- A. P.R.C.: Div. 6, Parts 1 and 2; Div. 13.
- B. Cal. Code Regs.: Title 2, Div. 3;
Title 14, Div. 6.

AB 884: 08/16/90.

OTHER PERTINENT INFORMATION:

1. The subject right-of-way is one of a number of crossings of State Lands required for the proposed 330-mile-long California-Oregon Transmission Project sponsored by a coalition of communities, public agencies, and utility companies.
2. The annual rental value of the site is estimated to be \$333.
3. An EIR was prepared and adopted for this project by the Transmission Agency of Northern California. The State Lands Commission's staff has reviewed such document and has identified no significant environmental effects which involve the proposed lease action that the Commission will be considering for approval.

APPROVALS OBTAINED:

United States Army Corps of Engineers.

EXHIBITS:

- A. Land Description.
- B. Location Map.
- C. Notice of Determination.

IT IS RECOMMENDED THAT THE COMMISSION:

1. FIND THAT AN EIR WAS PREPARED AND ADOPTED FOR THIS PROJECT BY THE TRANSMISSION AGENCY OF NORTHERN CALIFORNIA AND THAT THE COMMISSION HAS REVIEWED AND CONSIDERED THE INFORMATION CONTAINED THEREIN.
2. FIND THAT THERE WERE NO SIGNIFICANT ENVIRONMENTAL EFFECTS IDENTIFIED IN THE EIR WHICH INVOLVE THE PROPOSED LEASE ACTION THAT THE COMMISSION IS CONSIDERING FOR APPROVAL.

CALENDAR ITEM NO. 25 (CONT'D)

3. AUTHORIZE ISSUANCE TO TRANSMISSION AGENCY OF NORTHERN CALIFORNIA OF A 49-YEAR GENERAL LEASE - PUBLIC AGENCY USE, BEGINNING JANUARY 1, 1990; IN CONSIDERATION OF THE PUBLIC USE AND BENEFIT, WITH THE STATE RESERVING THE RIGHT AT ANY TIME TO SET A MONETARY RENTAL IF THE COMMISSION FINDS SUCH ACTION TO BE IN THE STATE'S BEST INTEREST; FOR A RIGHT-OF-WAY FOR A 500KV POWERLINE CROSSING OF THE SACRAMENTO RIVER IN SHASTA COUNTY ON THE LAND DESCRIBED ON EXHIBIT "A" ATTACHED AND BY REFERENCE MADE A PART HEREOF.

EXHIBIT "A"
LAND DESCRIPTION

W 24200

SIMPSON LEE
PAPER CO.
APN 91-04-01

WENWOOD PARTNERS
APN 57-29-03

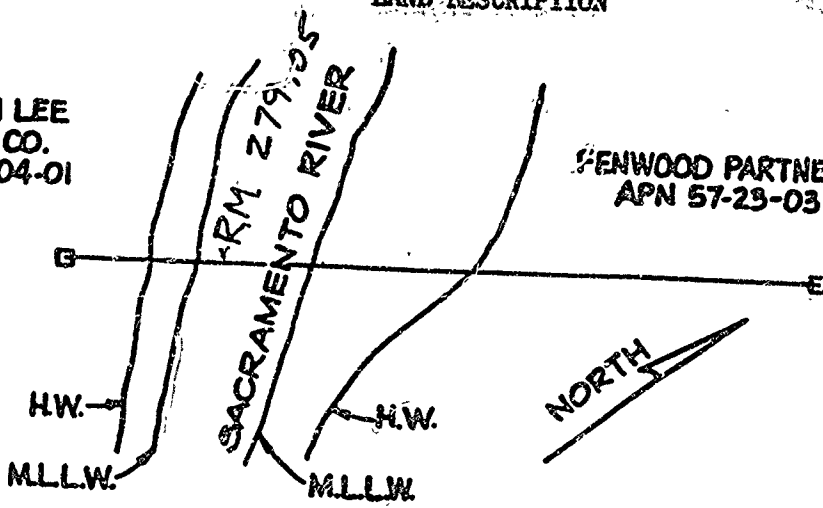

PLAN

FOR TRANSMISSION OF POWER FOR COMMERCIAL USE
3-PHASE 500KV 1942.6 KCMIL ACSR
ALUMINUM CONDUCTOR STEEL REINFORCED
(3 CONDUCTORS PER PHASE)

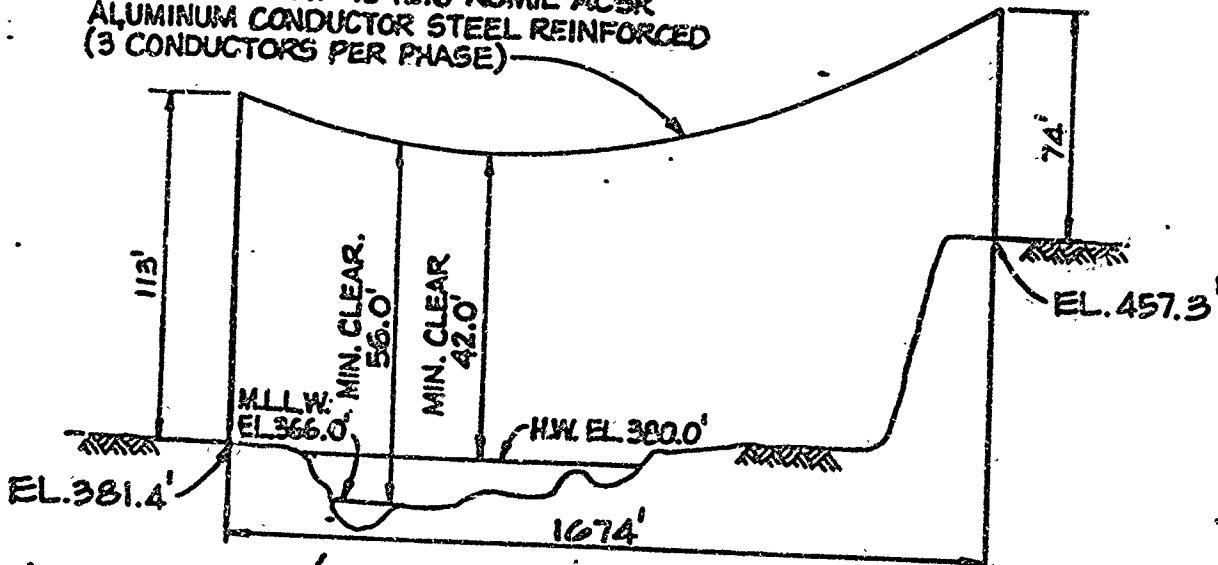

PROFILE

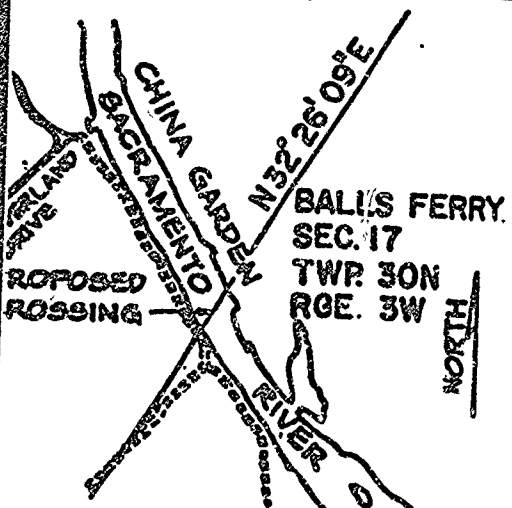

VICINITY MAP

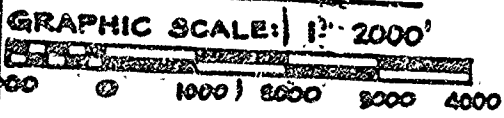

PROPOSED
OVERHEAD WIRE CROSSING
OVER SACRAMENTO RIVER
15 MILES SOUTHEAST OF
REDDING, CALIFORNIA
AND 3 MILES NORTHWEST OF
THE BALLS FERRY BRIDGE
SHASTA COUNTY, CALIFORNIA

CALIFORNIA PUBLIC UTILITIES COMMISSION
MAY 25 1988
APPLICATION BY
PAGE 546

TRANSMISSION AGENCY OF NORTHERN CALIFORNIA

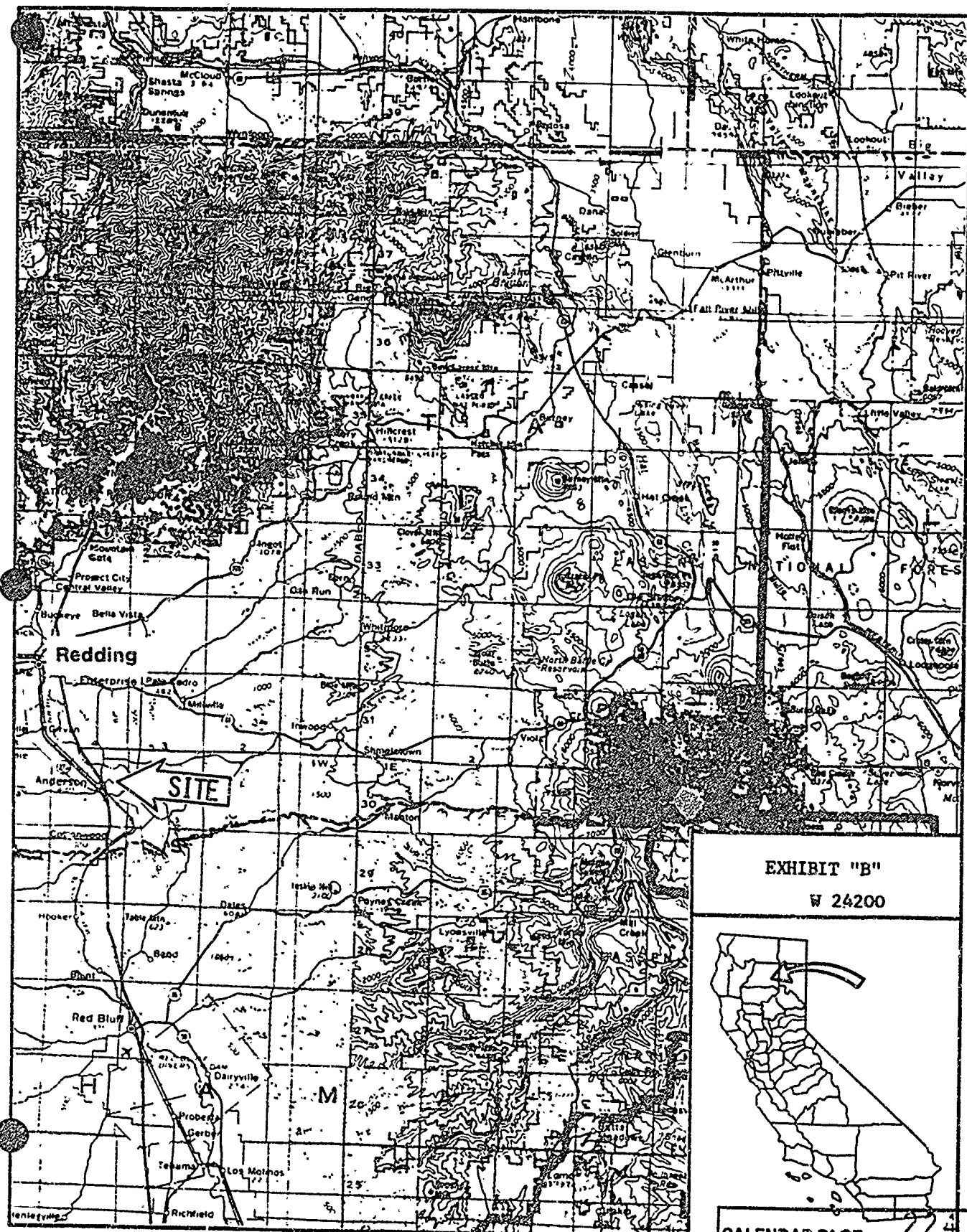

EXHIBIT "B"
W 24200



CALENDAR PAGE 224 - 4
MINUTE PAGE 547

