

MINUTE ITEM

This Calendar Item No. C14
was approved as Minute Item
No. C14 by the State Lands
Commission by a vote of 3
to 0 at its 3/27/90
meeting.

CALENDAR ITEM

A 7
S 1

C 1 4

03/27/90
PRC 3623
Garibay

APPROVAL OF A RECREATIONAL PIER PERMIT

APPLICANT: Joseph Lanza
PO Box 141
Tahoe City, California 95730

AREA, TYPE LAND AND LOCATION: A parcel of submerged land in Lake Tahoe near
Tahoe City, Placer County.

LAND USE: Retention of two (2) previously unauthorized
buoys.

TERMS OF PROPOSED PERMIT:

Initial period: Five years beginning
March 27, 1990.

Consideration: Rent-free pursuant to
Section 6503.5 of the P.R.C.

APPLICANT STATUS:

Applicant is owner of upland.

PREREQUISITE CONDITIONS, FEES AND EXPENSES:

Filing fee, processing costs, and environmental
fees have been received.

STATUTORY AND OTHER REFERENCES:

A. P.R.C.: Div. 6, Parts 1 and 2; Div. 13.

B. Cal. Code Regs.: Title 2, Div. 3;
Title 14, Div. 6.

CALENDAR ITEM NO. C 1 4 (CONT'D)

AB 884:

05/29/90.

OTHER PERTINENT INFORMATION:

1. Pursuant to the Commission's delegation of authority and the State CEQA Guidelines (14 Cal. Code Regs. 15025), the staff has prepared a Proposed Negative Declaration identified as EIR ND 502, State Clearinghouse No. 90020090. Such Proposed Negative Declaration was prepared and circulated for public review pursuant to the provisions of CEQA.

Based upon the Initial Study, the Proposed Negative Declaration, and the comments received in response thereto, there is no substantial evidence that the project will have a significant effect on the environment. (14 Cal. Code Regs. 15074(b))

2. This activity involves lands identified as possessing significant environmental values pursuant to P.R.C. 6370, et seq. Based upon the staff's consultation with the persons nominating such lands and through the CEQA review process, it is the staff's opinion that the project, as proposed, is consistent with its use classification.
3. In order to determine the other potential trust uses in the area of the proposed project, the staff contacted representatives of the following agencies: Tahoe Regional Planning Agency, Department of Fish and Game, County of Placer, and the Tahoe Conservancy. None of these agencies expressed a concern that the proposed project would have a significant effect on trust uses in the area. The agencies did not identify any trust needs which were not being met by existing facilities in the area. Identified trust uses in this area would include swimming, boating, walking along the beach, and views of the lake. Prior to the issuance of this permit, staff will conduct an inspection of the site to review the relation of the permitted facilities to other trust uses.

CALENDAR PAGE	114
MINUTE PAGE	426

0. 1200

CALENDAR ITEM NO. C 1 4 (CONT'D)

4. All permits issued at Lake Tahoe include special language in which the permittee/lessee agrees to protect and replace or restore, if required, the habitat of *Rorippa subumbellata*, commonly called the Tahoe Yellow Cress, a State-listed endangered plant species.
5. All applicants at Lake Tahoe will be notified that the public has a right to pass along the shoreline and the permittee must provide a reasonable means for public passage along the shorezone area occupied by the permitted structure.
6. If any structure hereby authorized is found to be in nonconformance with the Tahoe Regional Planning Agency's shorezone ordinance, and if any alterations, repairs, or removal required pursuant to said ordinance are not accomplished within the designated time to said ordinance are not accomplished within the designated time period, then this lease is automatically terminated, effective upon notice by the State, and the site shall be cleared pursuant to the terms thereof. If the location, size, or number of any structure hereby authorized is to be altered, pursuant to order of the Tahoe Regional Planning Agency, Lessee shall request the consent of State to make such alteration.
7. The existing pier is located landward of the 6,223-foot low water mark.

APPROVALS OBTAINED:

Placer County and Tahoe Regional Planning Association.

CALENDAR PAGE	115
MINUTE PAGE	427

CALENDAR ITEM NO. C 7 4 (CONT'D)

FURTHER APPROVALS REQUIRED:

None.

EXHIBITS:

- A. Land Description.
- B. Location Map.
- C. Placer County Letter of Approval.
- D. Negative Declaration.

IT IS RECOMMENDED THAT THE COMMISSION:

1. CERTIFY THAT A NEGATIVE DECLARATION, EIR ND 502, STATE CLEARINGHOUSE NO. 90020090, WAS PREPARED FOR THIS PROJECT PURSUANT TO THE PROVISIONS OF THE CEQA AND THAT THE COMMISSION HAS REVIEWED AND CONSIDERED THE INFORMATION CONTAINED THEREIN.
2. DETERMINE THAT THE PROJECT, AS APPROVED, WILL NOT HAVE A SIGNIFICANT EFFECT ON THE ENVIRONMENT.
4. AUTHORIZE ISSUANCE TO JOSEPH LANZA OF A FIVE-YEAR RECREATIONAL PIER PERMIT, BEGINNING MARCH 27, 1990 FOR THE RETENTION OF TWO EXISTING BUOYS ON THE LAND DESCRIBED ON EXHIBIT "A" ATTACHED AND BY REFERENCE MADE A PART HEREOF.

EXHIBIT "A"

LAND DESCRIPTION

PRC 3623.9

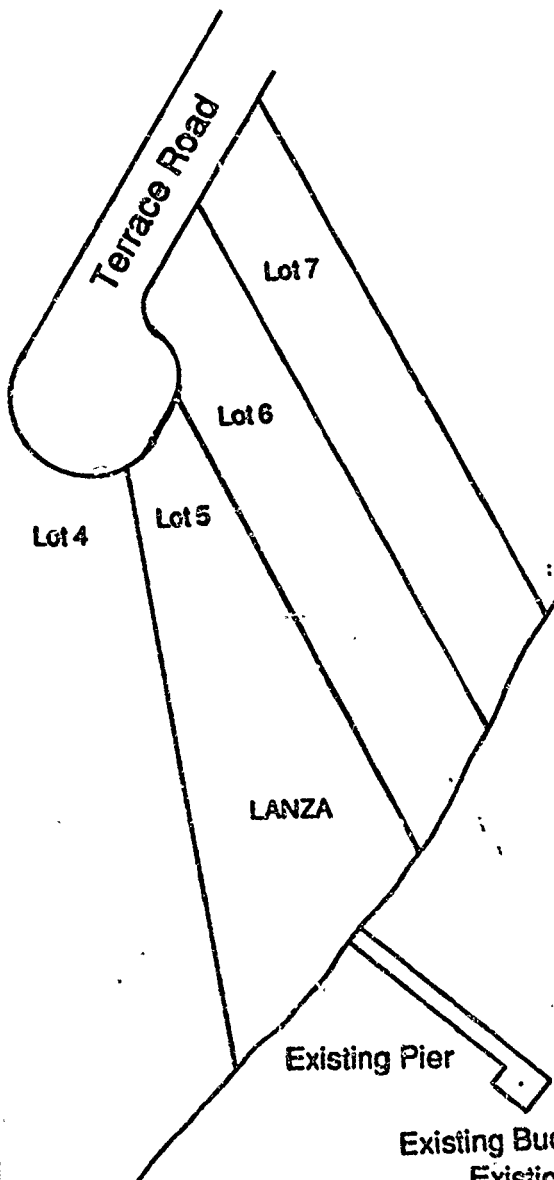

Existing Buoy ●
Existing Buoy ●

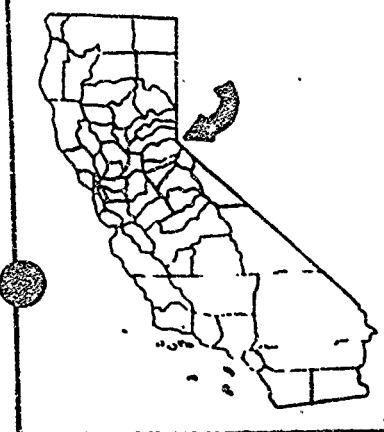
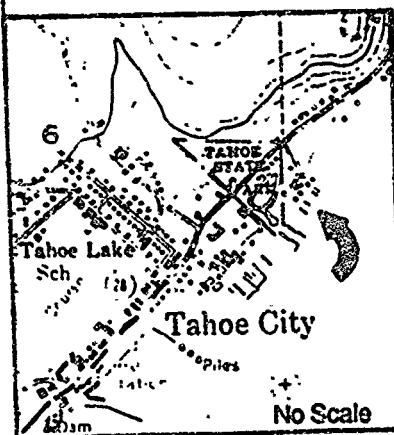

LAKE TAHOE

CALENDAR PAGE	117
MINUTE PAGE	429
	No Scale

PREPARED MARCH 1, 1990 BY SAS.

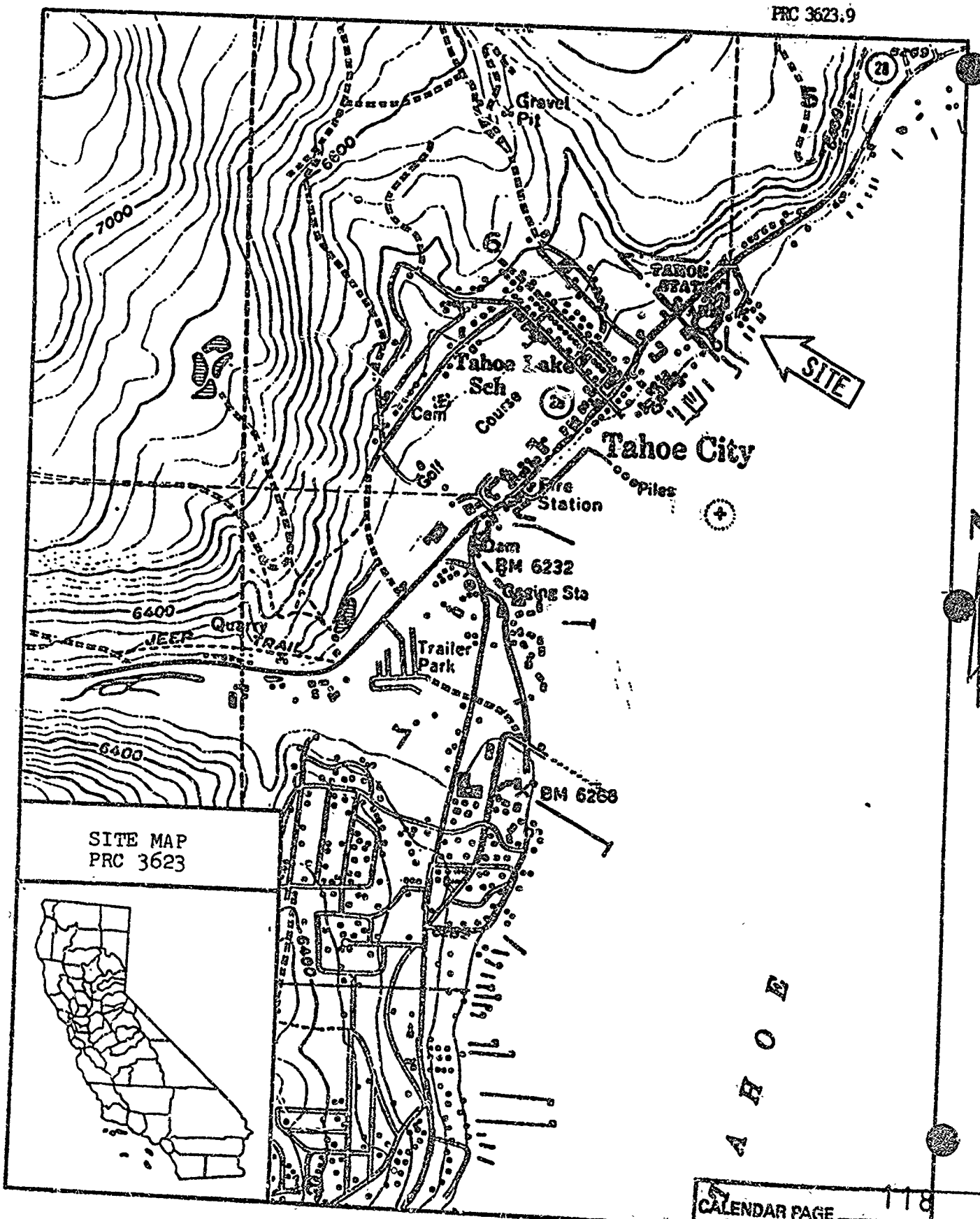

SITE MAP
PRC 3623



CALENDAR PAGE	118
MINUTE PAGE	430

STATE OF CALIFORNIA
STATE LANDS COMMISSION
1807 13TH STREET
SACRAMENTO, CALIFORNIA 95814

GEORGE DEUKHEJIAN, Governor

October 13, 1989

File Ref.: WP 3623

Ms. Amy Garibay
California State Lands Commission
1807 13th Street
Sacramento, California 95814

Subject: Permit for Buoy(s)

Name: Joseph Lanza

Address: F.O. Box 141

Tahoe City, CA 95730

Placer County Assessor's Parcel No: 94-150-22

Upland Address: 120 Sierra Terrace, Tahoe City

Dear Ms. Garibay:

The County of Placer has received notice of the above-referenced project in Lake Tahoe has no objection to the buoy or to the issuance of the State Lands Commission's permit.

If you have any questions, you may reach me at (916) 889-7584.

Sincerely,

Margaret Kochan
for ERICK ERICKSON
Associate Civil Engineer

CALENDAR PAGE 119
MINUTE PAGE 431

STATE LANDS COMMISSION
1807 15TH STREET
SACRAMENTO, CALIFORNIA 95814



PROPOSED NEGATIVE DECLARATION

EIR NO 502

File Ref.: PRC 3623

SCH#: 90020090

Project Title: Joseph Lanza Buoys Application

Project Proponent: Joseph S. Lanza

Project Location: Lake Tahoe, near Tahoe City; adjacent
to: APN 94-150-22, Placer County.

Project Description: Authorization to permit two existing
mooring buoys anchored on the bed of
Lake Tahoe.

Contact Person: Judy Brown

Telephone: (916) 324-4715

This document is prepared pursuant to the requirements of the California Environmental Quality Act (Section 21000 et seq., Public Resources Code), the State CEQA Guidelines (Section 15000 et seq., Title 14, California Code Regulations), and the State Lands Commission regulations (Section 2901 et seq., Title 2, California Code Regulations).

Based upon the attached Initial Study, it has been found that:

the project will not have a significant effect on the environment.

mitigation measures included in the project will avoid potentially significant effects.

CALENDAR PAGE	120
MINUTE PAGE	432

Form 13.17 (3/89)

ENVIRONMENTAL IMPACT ASSESSMENT FORM - Part I
(To be completed by applicant)
FORM 69.3111/82)

A. GENERAL INFORMATION

1. Name, address, and telephone number:

a. Applicant

Joseph S. LAMZA
BOX 1411 T.C.
CA 95730
(916) 583 8519

b. Contact person if other than applicant:

2. a. Project location: (Please reference to nearest town or community and include county)

Placer County - Tahoe City CA
120 Sutter Terrace

Assessor's parcel number: _____

3. Existing zoning of project site: _____

4. Existing land use of project site: _____

5. Proposed use of site: Existing pipe & bays

Note: existing pipe is 12" diameter of 6223' el.
Dumps were placed when pipe was built
(1966)

6. Other permits required: _____

B. PROJECT DESCRIPTION

1. For building construction projects, complete "ATTACHMENT A".

2. For non-building construction projects: Describe fully, the proposed activity, its purpose and intended use, e.g. for proposed mineral prospecting permits, include the number of test holes, size of holes, amount of material to be excavated, maximum surface area of disturbances, hole locations, depth of holes, etc. Attach plans or other drawings as necessary.

Existing pipe & bays

CALENDAR PAGE	121
MINUTE PAGE	433

C. ENVIRONMENTAL SETTING

1. Describe the project site as it exists before the project, including information on topography, soil stability, plants and animals and any cultural, historical, or scenic aspects. Describe any existing structures on the site, and the use of the structures.
2. Describe the surrounding properties, including information on plants and animals and any cultural, historical, or scenic aspects. Indicate the type of land use (residential, commercial, etc.), intensity of land use (one-family, apartment houses, shops, department stores, etc.), and scale of development (height, frontage, set-back, rear yard, etc.).

D. ENVIRONMENTAL IMPACT ASSESSMENT

Answer the following questions by placing a check in the appropriate box. Discuss all items checked "yes" or "maybe". (Attach additional sheets as necessary)

Will the project involve:	YES	MAYBE	NO
1. a change in existing features of any bays, tidelands, beaches, lakes, or hills, or substantial alteration of ground contours?	<input type="checkbox"/>	<input type="checkbox"/>	<input checked="" type="checkbox"/>
2. a change in scenic views or vistas from existing residential areas or public lands or roads?	<input type="checkbox"/>	<input type="checkbox"/>	<input checked="" type="checkbox"/>
3. a change in pattern, scale, or character of the general area of project?	<input type="checkbox"/>	<input type="checkbox"/>	<input checked="" type="checkbox"/>
4. a significant effect on plant or animal life?	<input type="checkbox"/>	<input type="checkbox"/>	<input checked="" type="checkbox"/>
5. significant amounts of solid waste or litter?	<input type="checkbox"/>	<input type="checkbox"/>	<input checked="" type="checkbox"/>
6. a change in dust, ash, smoke, fumes, or odors in the vicinity?	<input type="checkbox"/>	<input type="checkbox"/>	<input checked="" type="checkbox"/>
7. a change in ocean, bay, lake, stream, or ground water quality or quantity, or alteration of existing drainage patterns?	<input type="checkbox"/>	<input type="checkbox"/>	<input checked="" type="checkbox"/>
8. a change in existing noise or vibration levels in the vicinity?	<input type="checkbox"/>	<input type="checkbox"/>	<input checked="" type="checkbox"/>
9. construction on filled land or on slope of 10 percent or more?	<input type="checkbox"/>	<input type="checkbox"/>	<input checked="" type="checkbox"/>
10. use or disposal of potentially hazardous materials, such as toxic or radioactive substances, flammables, or explosives?	<input type="checkbox"/>	<input type="checkbox"/>	<input checked="" type="checkbox"/>
11. a change in demand for municipal services (police, fire, water, sewage, etc.)?	<input type="checkbox"/>	<input type="checkbox"/>	<input checked="" type="checkbox"/>
12. an increase in fossil fuel consumption (electricity, oil, natural gas, etc.)?	<input type="checkbox"/>	<input type="checkbox"/>	<input checked="" type="checkbox"/>
13. a larger project or a series of projects?	<input type="checkbox"/>	<input type="checkbox"/>	<input checked="" type="checkbox"/>

E. CERTIFICATION

I hereby certify that the statements furnished above and in the attached exhibits present the data and information required for this initial evaluation to the best of my ability, and that the facts, statements, and information presented are true and correct to the best of my knowledge and belief.

Date: FEB 7 1989

Signed: [Signature]

CALENDAR PAGE	122
MINUTE PAGE	434

ENVIRONMENTAL IMPACT ASSESSMENT CHECKLIST - PART II

Form 13.20 (7/82)

File Ref.: MP 3623

I. BACKGROUND INFORMATION

A. Applicant: Joseph Lanza
P.O. Box 141
Tahoe City, CA 95830

B. Checklist Date: 01 / 12 / 90

C. Contact Person: Judy Brown
Telephone: (916) 324-4715

D. Purpose: Authorization for two mooring buoys.

E. Location: Lake Tahoe near Tahoe City

F. Description: Two existing mooring buoys anchored on the bed of Lake Tahoe

G. Persons Contacted: _____

II. ENVIRONMENTAL IMPACTS. (Explain all "yes" and "maybe" answers)

A. Earth. Will the proposal result in:	Yes	Maybe	No
1. Unstable earth conditions or changes in geologic substructures?	<input type="checkbox"/>	<input type="checkbox"/>	<input checked="" type="checkbox"/>
2. Disruptions, displacements, compaction, or overcovering of the soil?	<input type="checkbox"/>	<input type="checkbox"/>	<input checked="" type="checkbox"/>
3. Change in topography or ground surface relief features?	<input type="checkbox"/>	<input type="checkbox"/>	<input checked="" type="checkbox"/>
4. The destruction, covering, or modification of any unique geologic or physical features?	<input type="checkbox"/>	<input type="checkbox"/>	<input checked="" type="checkbox"/>
5. Any increase in wind or water erosion of soils, either on or off the site?	<input type="checkbox"/>	<input type="checkbox"/>	<input checked="" type="checkbox"/>
6. Changes in deposition or erosion of beach sands, or changes in siltation, deposition or erosion which may modify the channel of a river or stream or the bed of the ocean or any bay, inlet, or lake?	<input type="checkbox"/>	<input type="checkbox"/>	<input checked="" type="checkbox"/>
7. Exposure of all people or property to geologic hazards such as earthquakes, landslides, mudslides, ground failure, or similar hazards?	<input type="checkbox"/>	<input type="checkbox"/>	<input checked="" type="checkbox"/>

CALENDAR PAGE	1	2	3	IX
MINUTE PAGE	4	35		IX

- | | Yes | Maybe | No |
|---|--------------------------|-------------------------------------|-------------------------------------|
| B Air. Will the proposal result in: | | | |
| 1 Substantial air emissions or deterioration of ambient air quality? | <input type="checkbox"/> | <input type="checkbox"/> | <input checked="" type="checkbox"/> |
| 2 The creation of objectionable odors? | <input type="checkbox"/> | <input type="checkbox"/> | <input checked="" type="checkbox"/> |
| 3 Alteration of air movement, moisture or temperature, or any change in climate, either locally or regionally? | <input type="checkbox"/> | <input type="checkbox"/> | <input checked="" type="checkbox"/> |
| C Water. Will the proposal result in: | | | |
| 1 Changes in the currents, or the course or direction of water movements, in either marine or fresh waters? | <input type="checkbox"/> | <input type="checkbox"/> | <input checked="" type="checkbox"/> |
| 2 Changes in absorption rates, drainage patterns, or the rate and amount of surface water runoff? | <input type="checkbox"/> | <input type="checkbox"/> | <input checked="" type="checkbox"/> |
| 3 Alterations to the course or flow of flood waters? | <input type="checkbox"/> | <input type="checkbox"/> | <input checked="" type="checkbox"/> |
| 4 Change in the amount of surface water in any water body? | <input type="checkbox"/> | <input type="checkbox"/> | <input checked="" type="checkbox"/> |
| 5 Discharge into surface waters, or in any alteration of surface water quality, including but not limited to temperature, dissolved oxygen or turbidity? | <input type="checkbox"/> | <input type="checkbox"/> | <input checked="" type="checkbox"/> |
| 6 Alteration of the direction or rate of flow of ground waters? | <input type="checkbox"/> | <input type="checkbox"/> | <input checked="" type="checkbox"/> |
| 7 Change in the quantity of ground waters, either through direct additions or withdrawals, or through interception of an aquifer by cuts or excavations? | <input type="checkbox"/> | <input type="checkbox"/> | <input checked="" type="checkbox"/> |
| 8 Substantial reduction in the amount of water otherwise available for public water supplies? | <input type="checkbox"/> | <input type="checkbox"/> | <input checked="" type="checkbox"/> |
| 9 Exposure of people or property to water-related hazards such as flooding or tidal waves? | <input type="checkbox"/> | <input type="checkbox"/> | <input checked="" type="checkbox"/> |
| 10 Significant changes in the temperature, flow or chemical content of surface thermal springs? | <input type="checkbox"/> | <input type="checkbox"/> | <input checked="" type="checkbox"/> |
| D Plant Life Will the proposal result in: | | | |
| 1 Change in the diversity of species, or number of any species of plants (including trees, shrubs, grass, crops, and aquatic plants)? | <input type="checkbox"/> | <input type="checkbox"/> | <input checked="" type="checkbox"/> |
| 2 Reduction of the numbers of any unique, rare or endangered species of plants? | <input type="checkbox"/> | <input type="checkbox"/> | <input checked="" type="checkbox"/> |
| 3 Introduction of new species of plants into an area, or in a barrier to the normal replenishment of existing species? | <input type="checkbox"/> | <input type="checkbox"/> | <input checked="" type="checkbox"/> |
| 4 Reduction in acreage of any agricultural crop? | <input type="checkbox"/> | <input type="checkbox"/> | <input checked="" type="checkbox"/> |
| E Animal Life Will the proposal result in: | | | |
| 1 Change in the diversity of species, or numbers of any species of animals (birds, land animals including reptiles, fish and shellfish, benthic organisms, or insects)? | <input type="checkbox"/> | <input checked="" type="checkbox"/> | <input type="checkbox"/> |
| 2 Reduction of the numbers of any unique, rare or endangered species of animals? | <input type="checkbox"/> | <input type="checkbox"/> | <input checked="" type="checkbox"/> |
| 3 Introduction of new species of animals into an area, or result in a barrier to the migration or movement of animals? | <input type="checkbox"/> | <input type="checkbox"/> | <input checked="" type="checkbox"/> |
| 4 Deterioration to existing fish or wildlife habitat? | <input type="checkbox"/> | <input type="checkbox"/> | <input checked="" type="checkbox"/> |
| F Noise. Will the proposal result in: | | | |
| 1 Increase in existing noise levels? | <input type="checkbox"/> | <input type="checkbox"/> | <input checked="" type="checkbox"/> |
| 2 Exposure of people to severe noise levels? | <input type="checkbox"/> | <input type="checkbox"/> | <input checked="" type="checkbox"/> |
| G Light and Glare. Will the proposal result in: | | | |
| 1 The production of new light or glare? | <input type="checkbox"/> | <input type="checkbox"/> | <input checked="" type="checkbox"/> |
| H Land Use Will the proposal result in: | | | |
| 1 A substantial alteration of the present or planned land use of an area? | <input type="checkbox"/> | <input type="checkbox"/> | <input checked="" type="checkbox"/> |
| I Natural Resources. Will the proposal result in: | | | |
| 1 Increase in the rate of use of any natural resources? | <input type="checkbox"/> | <input type="checkbox"/> | <input checked="" type="checkbox"/> |
| 2 Substantial depletion of any nonrenewable resources? | <input type="checkbox"/> | <input type="checkbox"/> | <input checked="" type="checkbox"/> |

J. *Risk of Upset.* Does the proposal result in:

- | | Yes | Maybe | No |
|---|--------------------------|--------------------------|-------------------------------------|
| 1. A risk of an explosion or the release of hazardous substances (including, but not limited to, oil, pesticides, chemicals, or radiation) in the event of an accident or upset conditions? | <input type="checkbox"/> | <input type="checkbox"/> | <input checked="" type="checkbox"/> |
| 2. Possible interference with emergency response plan or an emergency evacuation plan? | <input type="checkbox"/> | <input type="checkbox"/> | <input checked="" type="checkbox"/> |

K. *Population.* Will the proposal result in:

- | | | | |
|---|--------------------------|--------------------------|-------------------------------------|
| 1. The alteration, distribution, density, or growth rate of the human population of the area? | <input type="checkbox"/> | <input type="checkbox"/> | <input checked="" type="checkbox"/> |
|---|--------------------------|--------------------------|-------------------------------------|

L. *Housing.* Will the proposal result in:

- | | | | |
|---|--------------------------|--------------------------|-------------------------------------|
| 1. Affecting existing housing, or create a demand for additional housing? | <input type="checkbox"/> | <input type="checkbox"/> | <input checked="" type="checkbox"/> |
|---|--------------------------|--------------------------|-------------------------------------|

M. *Transportation/Circulation.* Will the proposal result in:

- | | | | |
|---|-------------------------------------|--------------------------|-------------------------------------|
| 1. Generation of substantial additional vehicular movement? | <input type="checkbox"/> | <input type="checkbox"/> | <input checked="" type="checkbox"/> |
| 2. Affecting existing parking facilities, or create a demand for new parking? | <input type="checkbox"/> | <input type="checkbox"/> | <input checked="" type="checkbox"/> |
| 3. Substantial impact upon existing transportation systems? | <input type="checkbox"/> | <input type="checkbox"/> | <input checked="" type="checkbox"/> |
| 4. Alterations to present patterns of circulation or movement of people and/or goods? | <input type="checkbox"/> | <input type="checkbox"/> | <input checked="" type="checkbox"/> |
| 5. Alterations to waterborne, rail, or air traffic? | <input checked="" type="checkbox"/> | <input type="checkbox"/> | <input type="checkbox"/> |
| 6. Increase in traffic hazards to motor vehicles, bicyclists, or pedestrians? | <input type="checkbox"/> | <input type="checkbox"/> | <input checked="" type="checkbox"/> |

N. *Public Services.* Will the proposal have an effect upon, or result in a need for new or altered governmental services in any of the following areas:

- | | | | |
|---|--------------------------|--------------------------|-------------------------------------|
| 1. Fire protection? | <input type="checkbox"/> | <input type="checkbox"/> | <input checked="" type="checkbox"/> |
| 2. Police protection? | <input type="checkbox"/> | <input type="checkbox"/> | <input checked="" type="checkbox"/> |
| 3. Schools? | <input type="checkbox"/> | <input type="checkbox"/> | <input checked="" type="checkbox"/> |
| 4. Parks and other recreational facilities? | <input type="checkbox"/> | <input type="checkbox"/> | <input checked="" type="checkbox"/> |
| 5. Maintenance of public facilities, including roads? | <input type="checkbox"/> | <input type="checkbox"/> | <input checked="" type="checkbox"/> |
| 6. Other governmental services? | <input type="checkbox"/> | <input type="checkbox"/> | <input checked="" type="checkbox"/> |

O. *Energy.* Will the proposal result in:

- | | | | |
|--|--------------------------|--------------------------|-------------------------------------|
| 1. Use of substantial amounts of fuel or energy? | <input type="checkbox"/> | <input type="checkbox"/> | <input checked="" type="checkbox"/> |
| 2. Substantial increase in demand upon existing sources of energy, or require the development of new sources? .. | <input type="checkbox"/> | <input type="checkbox"/> | <input checked="" type="checkbox"/> |

P. *Utilities.* Will the proposal result in a need for new systems, or substantial alterations to the following utilities:

- | | | | |
|------------------------------------|--------------------------|--------------------------|-------------------------------------|
| 1. Power or natural gas? | <input type="checkbox"/> | <input type="checkbox"/> | <input checked="" type="checkbox"/> |
| 2. Communication systems? | <input type="checkbox"/> | <input type="checkbox"/> | <input checked="" type="checkbox"/> |
| 3. Water? | <input type="checkbox"/> | <input type="checkbox"/> | <input checked="" type="checkbox"/> |
| 4. Sewer or septic tanks? | <input type="checkbox"/> | <input type="checkbox"/> | <input checked="" type="checkbox"/> |
| 5. Storm water drainage? | <input type="checkbox"/> | <input type="checkbox"/> | <input checked="" type="checkbox"/> |
| 6. Solid waste and disposal? | <input type="checkbox"/> | <input type="checkbox"/> | <input checked="" type="checkbox"/> |

Q. *Human Health.* Will the proposal result in:

- | | | | |
|--|--------------------------|--------------------------|-------------------------------------|
| 1. Creation of any health hazard or potential health hazard (excluding mental health)? | <input type="checkbox"/> | <input type="checkbox"/> | <input checked="" type="checkbox"/> |
| 2. Exposure of people to potential health hazards? | <input type="checkbox"/> | <input type="checkbox"/> | <input checked="" type="checkbox"/> |

R. *Aesthetics.* Will the proposal result in:

- | | | | |
|--|--------------------------|-------------------------------------|--------------------------|
| 1. The obstruction of any scenic vista or view open to the public, or will the proposal result in the creation of an aesthetically offensive site open to public view? | <input type="checkbox"/> | <input checked="" type="checkbox"/> | <input type="checkbox"/> |
|--|--------------------------|-------------------------------------|--------------------------|

S. *Recreation.* Will the proposal result in:

- | | | | |
|--|--------------------------|-------------------------------------|--------------------------|
| 1. An impact upon the quality or quantity of existing recreational opportunities? .. | <input type="checkbox"/> | <input checked="" type="checkbox"/> | <input type="checkbox"/> |
|--|--------------------------|-------------------------------------|--------------------------|

CALENDAR PAGE 25
MINUTE PAGE 437

T Cultural Resources.

Yes Maybe No

- 1. Will the proposal result in the alteration of or the destruction of a prehistoric or historic archeological site?
- 2. Will the proposal result in adverse physical or aesthetic effects to a prehistoric or historic building, structure, or object?
- 3. Does the proposal have the potential to cause a physical change which would affect unique ethnic cultural values?
- 4. Will the proposal restrict existing religious or sacred uses within the potential impact area?

U. Mandatory Findings of Significance.

- 1. Does the project have the potential to degrade the quality of the environment, reduce the habitat of a fish or wildlife species, cause a fish or wildlife population to drop below self-sustaining levels, threaten to eliminate a plant or animal community, reduce the number or restrict the range of a rare or endangered plant or animal or eliminate important examples of the major periods of California history or prehistory?
- 2. Does the project have the potential to achieve short-term, to the disadvantage of long-term, environmental goals?
- 3. Does the project have impacts which are individually limited, but cumulatively considerable?
- 4. Does the project have environmental effects which will cause substantial adverse effects on human beings, either directly or indirectly?

III. DISCUSSION OF ENVIRONMENTAL EVALUATION (See Comments Attached)

IV. PRELIMINARY DETERMINATION

On the basis of this initial evaluation:

- I find the proposed project COULD NOT have a significant effect on the environment, and a NEGATIVE DECLARATION will be prepared.
- I find that although the proposed project could have a significant effect on the environment, there will not be a significant effect in this case because the mitigation measures described on an attached sheet have been added to the project. A NEGATIVE DECLARATION will be prepared.
- I find the proposed project MAY have a significant effect on the environment, and an ENVIRONMENTAL IMPACT REPORT is required.

Date: 01 / 09 / 90

Judy A. Brown
 For the State Lands Commission
 CALENDAR PAGE 126
 MINUTE PAGE 438

III. DISCUSSION OF ENVIRONMENTAL EVALUATION
(Attachment to Environmental Impact Assessment Checklist - Part II
PRC 3623 - Joseph Lanza

E1. Lake Tahoe, adjacent to APN 94-150-22 is designated as a fish feeding/escape cover habitat location on the Tahoe Regional Planning Agency maps. Placement of these buoys will not substantially alter the lake bottom features at this location. The Tahoe Regional Planning Agency's fish habitat study indicates that buoys do not have an impact on fish spawning habitat. Recreational use induced in this area of the Lake by the project may affect fish productivity minimally.

M5. The applicant submits that the adjacent parcel owner and three parcel owners to the north each have a pier and two buoys. The adjacent parcel owner and four parcel owners to the south each have piers with no buoys. Spacing between structures occurs approximately every 100 feet. Two parcels south of this proposal is the Tahoe State Recreation Area which maintains a pier at each site. Applicant submits the buoys in this reported area are approximately 200 feet from the end of each pier. The existing pier adjacent to the parcel of this application, 94-150-22, is located landward of the State Lands Commission's permitting jurisdiction.

Recreational activity will not significantly increase in this area because surrounding waterward uses are similar. This proposal will continue to limit public access to shore along this area, which will not change the area currently available to topline trollers.

R1. Buoys themselves do not present much of a visual obstruction. According to The Cumulative Impacts of Shorezone Development at Lake Tahoe, by Phillips, Brandt, Reddick, McDonald, and Grefe, dated February 1978, PP. 4-79, in public responses to visual aspects of shorezone development and use, a grouping of seven boats closely spaced was considered to be a "visual dislike", therefore this proposal itself does not constitute a significant effect, but may add incremental effects to the overall waterward aesthetics in this area.

S1. The quality and quantity of recreation will change to the owners of these buoys, who will benefit in more convenient, and perhaps more frequent recreational use of Lake Tahoe. Recreational quality will not substantially change for topline trollers as was mentioned in discussion of M5 above.

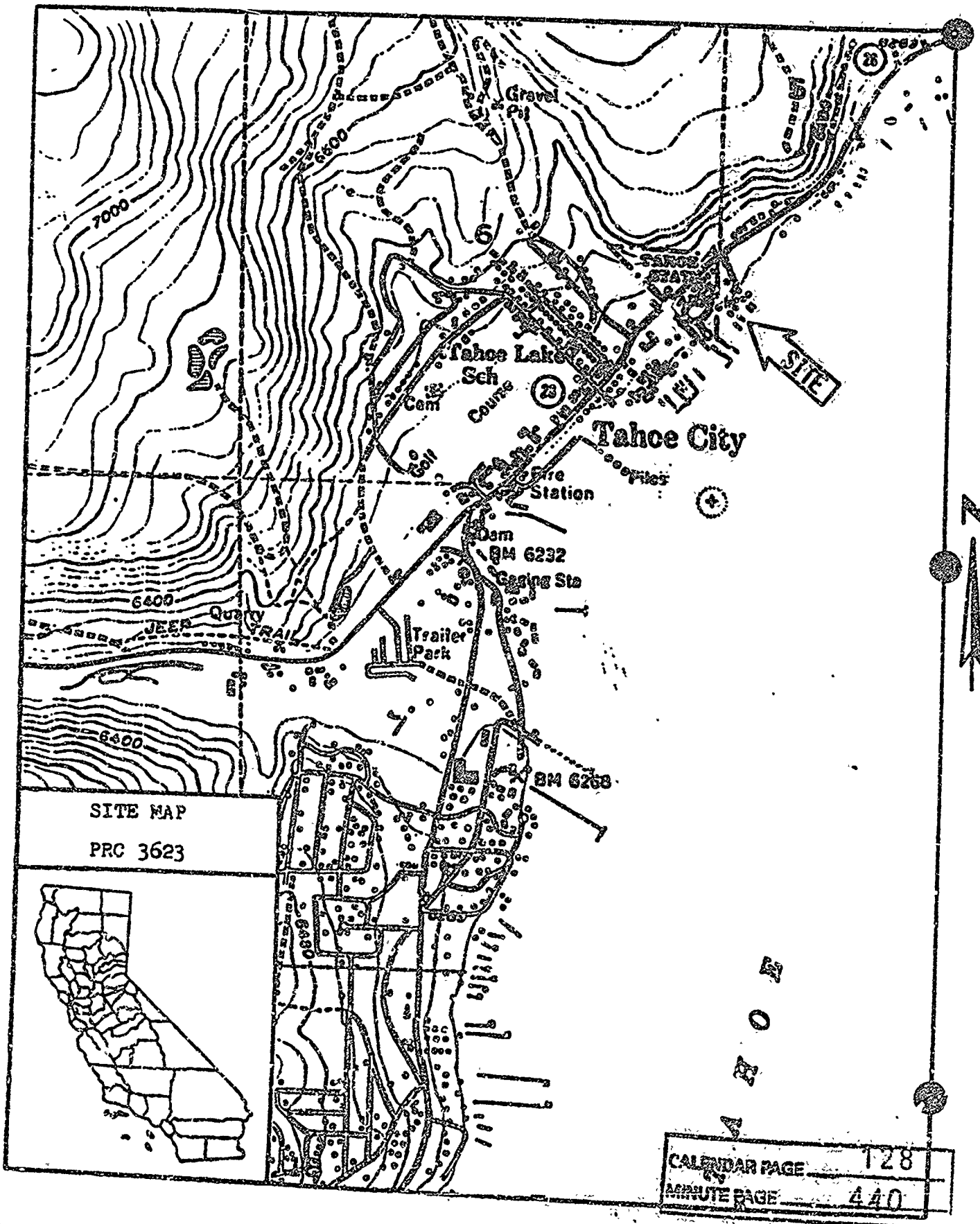

SITE MAP
 PRC 3623



CALENDAR PAGE	128
MINUTE PAGE	440