

MINUTE ITEM

This Calendar Item No. 20
was approved as Minute Item
No. 20 by the State Lands
Commission by a vote of 3
0 at its 9/27/89
meeting.

CALENDAR ITEM

- 20

A 7
S 1

09/27/89
PRC 4172
J. Ludlow

APPROVAL OF RECREATIONAL PIER PERMIT

APPLICANTS: Elsie M. Fabian and Michael H. Fabian, Trustees
808 Arbutus
Chico, California 95926

AREA, TYPE LAND AND LOCATION:
A parcel of submerged land in Lake Tahoe at
Homewood, Placer County.

LAND USE: Use and maintenance of an existing pier and
boathouse and retention of one previously
unauthorized mooring buoy.

TERMS OF PROPOSED PERMIT:
Initial period: Five years beginning
September 27, 1989.

CONSIDERATION: Rent-free, pursuant to Section 6503.5 of the
P.R.C.

APPLICANT STATUS:
Applicants are owners of upland.

PREREQUISITE CONDITIONS, FEES AND EXPENSES:
Filing fee and processing costs have been
received.

STATUTORY AND OTHER REFERENCES:
A. P.R.C.: Div. 6, Parts 1 and 2; Div. 13.
B. Cal. Code Regs.: Title 2, Div. 3;
Title 14, Div. 6.

AB 884: 11/04/89.

CALENDAR ITEM NO. 20 (CONT'D)

OTHER PERTINENT INFORMATION:

1. As to the existing pier and boathouse, pursuant to the Commission's delegation of authority and the State CEQA Guidelines (14 Cal. Code Regs. 15061), the staff has determined that this activity is exempt from the requirements of the CEQA as a categorically exempt project. The project is exempt under Class 1, Existing Facility, 2 Cal. Code Regs 2905(a)(2).

Authority: P.R.C. 21084, 14 Cal. Code Regs. 15300, and 2 Cal. Code Regs. 2905.

2. As to the existing unauthorized mooring buoy, pursuant to the Commission's delegation of authority and the State CEQA Guidelines (14 Cal. Code Regs. 15025), the staff has prepared a Proposed Negative Declaration identified as EIR ND 476, State Clearinghouse No. 89051502. Such Proposed Negative Declaration was prepared and circulated for public review pursuant to the provisions of CEQA.

Based upon the Initial Study, the Proposed Negative Declaration, and the comments received in response thereto, there is no substantial evidence that the project will have a significant effect on the environment. (14 Cal. Code Regs. 15074[b])

3. In order to determine the other potential trust uses in the area of the proposed project, the staff contacted representatives of the following agencies: Tahoe Regional Planning Agency, Department of Fish and Game, County of Placer, and the Tahoe Conservancy. None of these agencies expressed a concern that the proposed project would have a significant effect on trust uses in the area. The agencies did not identify any trust needs which were not being met by existing facilities in the area. Identified trust uses in this area would include swimming, boating, walking along the beach, and views of the lake.

CALENDAR ITEM NO. 20 (CONT'D)

4. All permits issued at Lake Tahoe include special language in which the permittee/lessee agrees to protect and replace or restore, if required, the habitat of *Rorippa subumbellata*, commonly called the Tahoe Yellow Cress, a State-listed endangered plant species.
5. This activity involves lands identified as possessing significant environmental values pursuant to P.R.C. 6370, et seq. Based upon the staff's consultation with the persons nominating such lands and through the CEQA review process, it is the staff's opinion that the project, as proposed, is consistent with its use classification.
6. All permits covering structures in Lake Tahoe will include a condition subsequent that if any structure authorized is found to be in nonconformance with the Tahoe Regional Planning Agency's shorezone ordinance and if any alterations, repairs, or removal required pursuant to said ordinance are not accomplished within the designated time period, then the permit will be automatically terminated, effective upon notice by the State, and the site shall be cleared pursuant to the terms thereof.

APPROVALS OBTAINED:

All permits for pier and boathouse previously obtained.

EXHIBITS:

- A. Land Description.
- B. Location Map.
- C. Negative Declaration.

IT IS RECOMMENDED THAT THE COMMISSION:

1. AS TO THE EXISTING PIER AND BOATHOUSE, FIND THAT THE ACTIVITY IS EXEMPT FROM THE REQUIREMENTS OF THE CEQA PURSUANT TO 14 CAL. CODE REGS. 15061 AS A CATEGORICALLY EXEMPT PROJECT, CLASS 1, EXISTING FACILITY, 2 CAL. CODE REGS. 2905(a)(2).

CALENDAR ITEM NO. 20 (CONT'D)

2. AS TO THE EXISTING UNAUTHORIZED MOORING BUOY, CERTIFY THAT A NEGATIVE DECLARATION, EIR ND 476, STATE CLEARINGHOUSE NO. 89051502, WAS PREPARED FOR THIS PROJECT PURSUANT TO THE PROVISIONS OF THE CEQA AND THAT THE COMMISSION HAS REVIEWED AND CONSIDERED THE INFORMATION CONTAINED THEREIN.
3. DETERMINE THAT THE PROJECT, AS APPROVED, WILL NOT HAVE A SIGNIFICANT EFFECT ON THE ENVIRONMENT.
4. AUTHORIZE ISSUANCE TO ELSIE M. FABIAN AND MICHAEL H. FABIAN, TRUSTEES OF A FIVE-YEAR RECREATIONAL PIER PERMIT BEGINNING SEPTEMBER 27, 1989, FOR THE USE AND MAINTENANCE OF AN EXISTING PIER AND FOR THE RETENTION OF ONE EXISTING MOORING BUOY, ON THE LAND DESCRIBED ON EXHIBIT "A" ATTACHED AND BY REFERENCE MADE A PART HEREOF.

Prepared on August 21, 1989
by Judy Ludlow

LAND DESCRIPTION

EXHIBIT "A"
PRC 4172.9

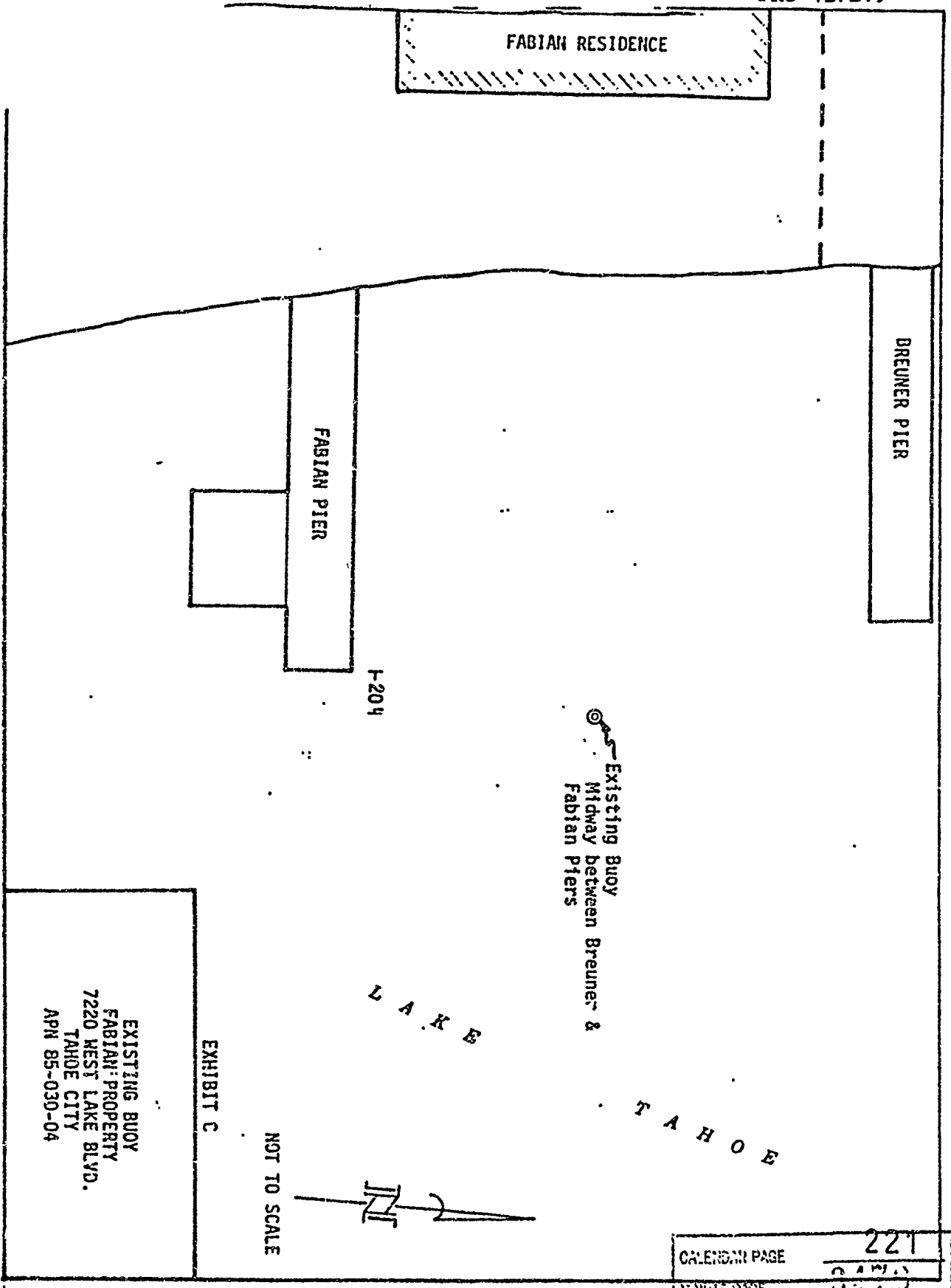

EXISTING BUOY
FABIAN PROPERTY
7220 WEST LAKE BLVD.
TAHOE CITY
APN 85-030-04

EXHIBIT C

NOT TO SCALE

CALENDAR PAGE	221
MINUTE PAGE	22.0

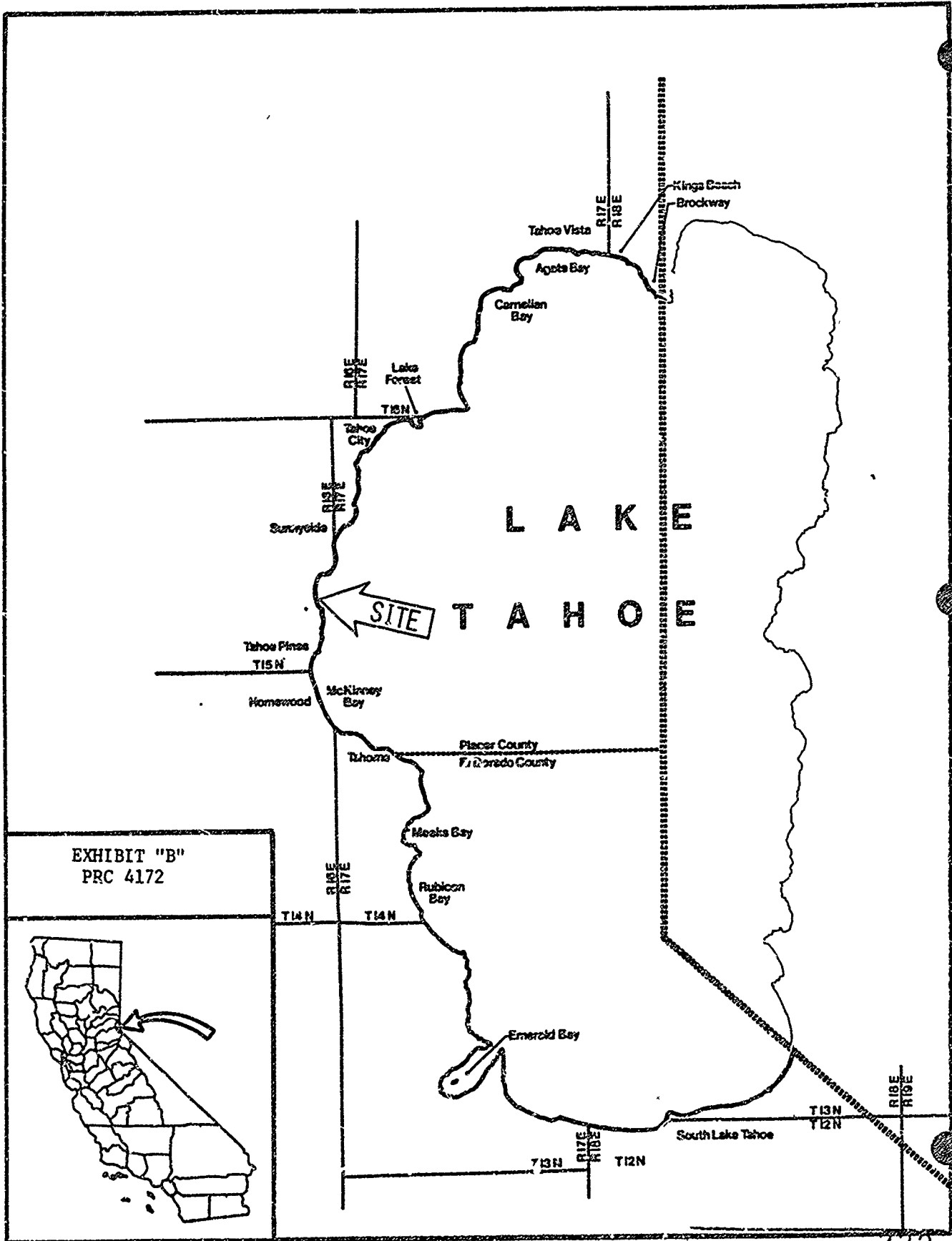

EXHIBIT "B"
 PRC 4172



CALENDAR PAGE	222
MINUTE PAGE	3477

EXHIBIT "C"

89051502

STATE OF CALIFORNIA—STATE LANDS COMMISSION

GEORGE DEUKMEJIAN, Governor

STATE LANDS COMMISSION

1007 13TH STREET
SACRAMENTO, CALIFORNIA 95814



EXHIBIT "C"

PROPOSED NEGATIVE DECLARATION

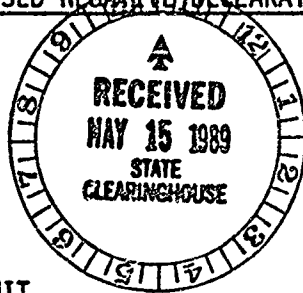

EIR ND 476

File Ref.: PRC 4172

SCH#: 89051502

Project Title: FABIAN BUOY PERMIT

Project Proponent: Elsie M. & Michael H. Fabian, Trustees

Project Location: In Lake Tahoe adjacent to Fractional Section 25, T.15 N., R.16 E.,
M.D.M., 2720 Westlake Blvd., Tahoe City, Placer County.

Project Description: Continued use and maintenance of an existing unauthorized buoy.

Contact Person: TED T. FUKUSHIMA

Telephone: (916)322-7813

This document is prepared pursuant to the requirements of the California Environmental Quality Act (Section 21000 et seq., Public Resources Code), the State CEQA Guidelines (Section 15000 et seq., Title 14, California Code Regulations), and the State Lands Commission regulations (Section 2901 et seq., Title 2, California Code Regulations).

Based upon the attached Initial Study, it has been found that:

the project will not have a significant effect on the environment.

mitigation measures included in the project will avoid potentially significant effects.

CALENDAR PAGE	223
MINUTE PAGE	3173
Form 13-17 (2/85)	

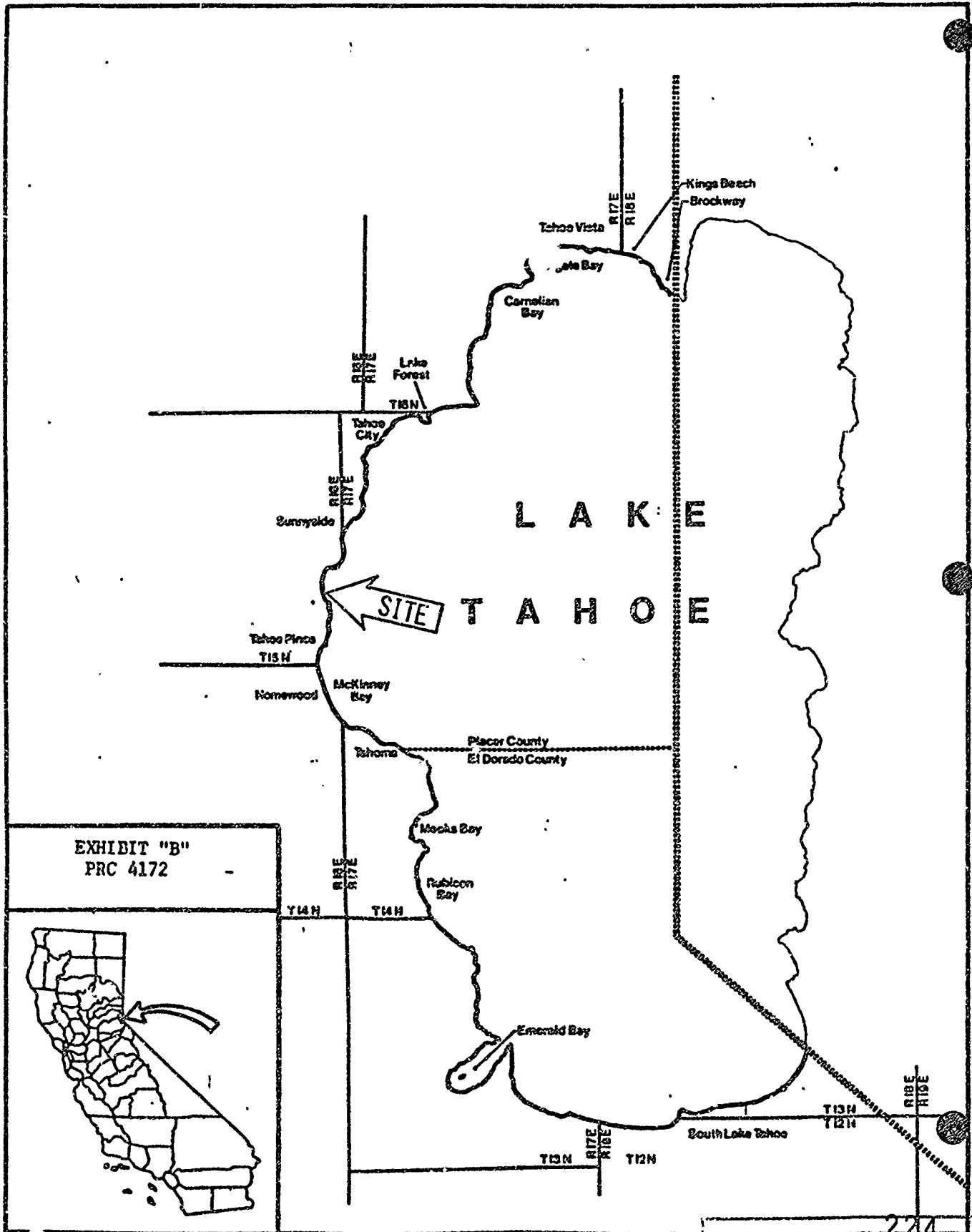
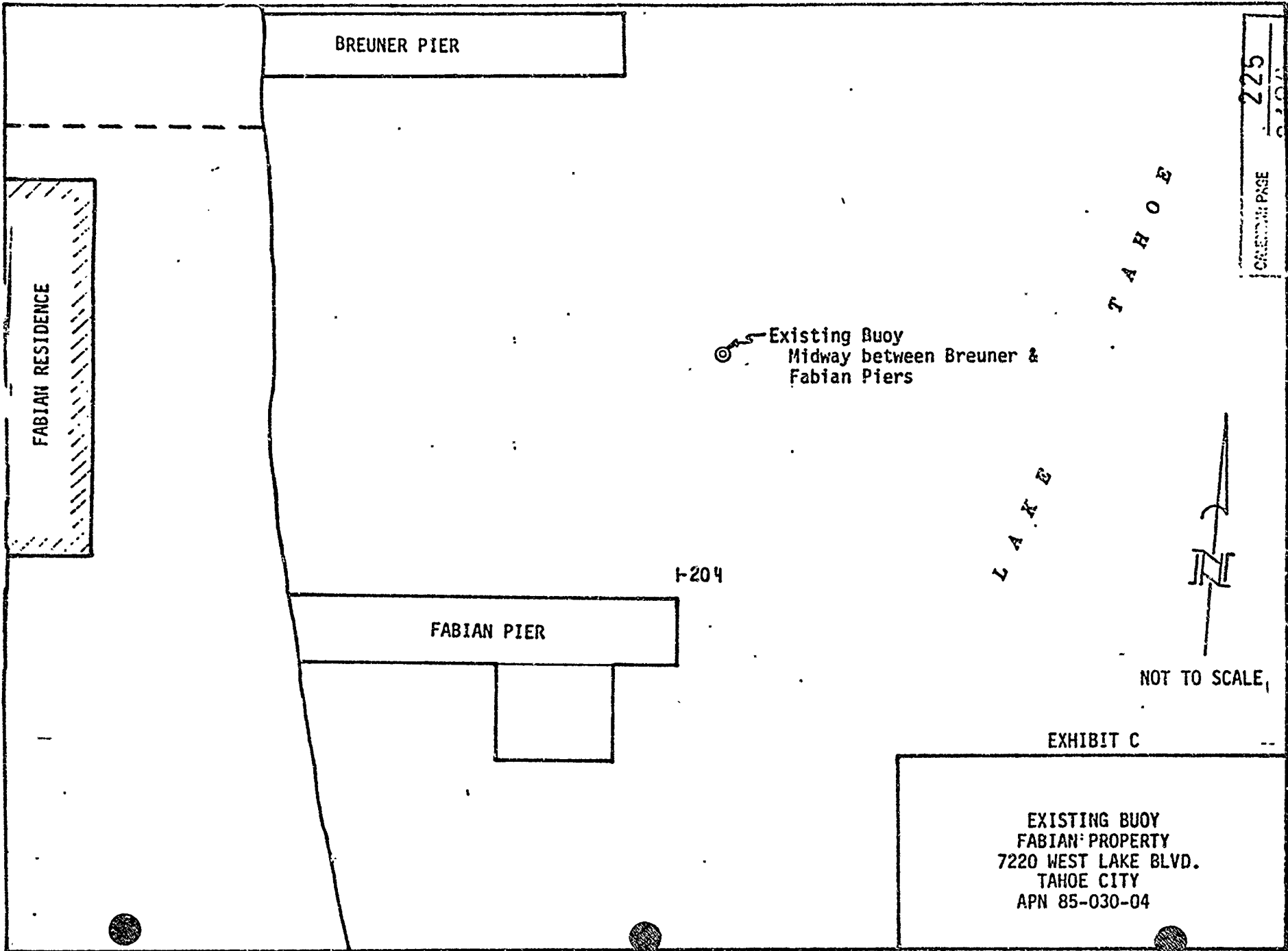

EXHIBIT "B"
 PRC 4172



224
 3179
 MINUTE INCHES



CREATED PAGE 225
DATE 01/01/04
DRAWN BY J. J. J.

EXHIBIT C

EXISTING BUOY
FABIAN PROPERTY
7220 WEST LAKE BLVD.
TAHOE CITY
APN 85-030-04

ENVIRONMENTAL IMPACT ASSESSMENT FORM – Part I
(To be completed by applicant)
FORM 69 3(11/82)

A. GENERAL INFORMATION

1. Name, address, and telephone number:

a. Applicant

b. Contact person if other than applicant:

Elsie M. & Michael H. Fabian, Trustees

4706 Dovercourt Circle

Carmichael, CA 95608

(916) 483-5926

2. a. Project location: (Please reference to nearest town or community and include county)

In Lake Tahoe adjacent to Fractional Section 25, T.15 N., R.16 E., M.D.M., 2720
Westlake Blvd., Tahoe City, Placer County.

b. Assessor's parcel number: 85-030-04

3. Existing zoning of project site:

4. Existing land use of project site: Existing unauthorized buoy

5. Proposed use of site: To obtain a permit for the buoy.

6. Other permits required: None

B. PROJECT DESCRIPTION

1. For building construction projects, complete "ATTACHMENT A".

2. For non building construction projects. Describe fully, the proposed activity, its purpose and intended use, e.g. for proposed mineral prospecting permits, include the number of test holes, size of holes, amount of material to be excavated, maximum surface area of disturbance, hole locations, depth of holes, etc. Attach plans or other drawings as necessary.

C. ENVIRONMENTAL SETTING

- 1. Describe the project site as it exists before the project, including information on topography, soil stability, plants and animals, and any cultural, historical, or scenic aspects. Describe any existing structures on the site, and the use of the structures.
- 2. Describe the surrounding properties, including information on plants and animals and any cultural, historical, or scenic aspects. Indicate the type of land use (residential, commercial, etc.), intensity of land use (one family, apartment houses, shops, department stores, etc.), and scale of development (height, frontage, set-back, rear yard, etc.).

D. ENVIRONMENTAL IMPACT ASSESSMENT

Answer the following questions by placing a check in the appropriate box. Discuss all items checked "yes" or "maybe". (Attach additional sheets as necessary)

Will the project involve:	YES	MAYBE	NO
1. a change in existing features of any bays, tidelands, beaches, lakes, or hills, or substantial alteration of ground contours?	<input type="checkbox"/>	<input type="checkbox"/>	<input checked="" type="checkbox"/>
2. a change in scenic views or vistas from existing residential areas or public lands or roads?	<input type="checkbox"/>	<input type="checkbox"/>	<input checked="" type="checkbox"/>
3. a change in pattern, scale, or character of the general area of project?	<input type="checkbox"/>	<input type="checkbox"/>	<input checked="" type="checkbox"/>
4. a significant effect on plant or animal life?	<input type="checkbox"/>	<input type="checkbox"/>	<input checked="" type="checkbox"/>
5. significant amounts of solid waste or litter?	<input type="checkbox"/>	<input type="checkbox"/>	<input checked="" type="checkbox"/>
6. a change in dust, ash, smoke, fumes, or odors in the vicinity?	<input type="checkbox"/>	<input type="checkbox"/>	<input checked="" type="checkbox"/>
7. a change in ocean, bay, lake, stream, or ground water quality or quantity, or alteration of existing drainage patterns?	<input type="checkbox"/>	<input type="checkbox"/>	<input checked="" type="checkbox"/>
8. a change in existing noise or vibration levels in the vicinity?	<input type="checkbox"/>	<input type="checkbox"/>	<input checked="" type="checkbox"/>
9. construction on filled land or on slopes of 10 percent or more?	<input type="checkbox"/>	<input type="checkbox"/>	<input checked="" type="checkbox"/>
10. use or disposal of potentially hazardous materials, such as toxic or radioactive substances, flammables, or explosives?	<input type="checkbox"/>	<input type="checkbox"/>	<input checked="" type="checkbox"/>
11. a change in demand for municipal services (police, fire, water, sewage, etc.)?	<input type="checkbox"/>	<input type="checkbox"/>	<input checked="" type="checkbox"/>
12. an increase in fossil fuel consumption (electricity, oil, natural gas, etc.)?	<input type="checkbox"/>	<input type="checkbox"/>	<input checked="" type="checkbox"/>
13. a larger project or a series of projects?	<input type="checkbox"/>	<input type="checkbox"/>	<input checked="" type="checkbox"/>

E. CERTIFICATION

I hereby certify that the statements furnished above and in the attached exhibits present the data and information required for this initial evaluation to the best of my ability, and that the facts, statements, and information presented are true and correct to the best of my knowledge and belief.

Date: 12-5-88

Signed: *Mark L...*

CALENDAR PAGE	227
MINUTE PAGE	3432

ENVIRONMENTAL IMPACT ASSESSMENT CHECKLIST - PART II

Form 13.20 (7/82)

File Ref.: PRC 4172

I. BACKGROUND INFORMATION

A. Applicant: Elsie M. & Michael H. Fabian, Trustees
4706 Dovercourt Circle
Carmichael, CA 95608

B. Checklist Date: 5 / 15 / 89

C. Contact Person: TED T. FUKUSHIMA
Telephone: (916) 322-7813

D. Purpose: To place under permit an existing unauthorized buoy.

E. Location: In Lake Tahoe adjacent to Fractional Section 25, T.15 N., R.16 E., M.D.M.,
2720 Westlake Blvd., Tahoe City, Placer County.

F. Description: Continued use and maintenance of an existing buoy.

G. Persons Contacted:

II. ENVIRONMENTAL IMPACTS. (Explain all "yes" and "maybe" answers)

A. Earth. Will the proposal result in:

- 1. Unstable earth conditions or changes in geologic substructures?
2. Disruptions, displacements, compaction, or overcovering of the soil?
3. Change in topography or ground surface relief features?
4. The destruction, covering, or modification of any unique geologic or physical features?
5. Any increase in wind or water erosion of soils, either on or off the site?
6. Changes in deposition or erosion of beach sands, or changes in siltation, deposition or erosion which may modify the channel of a river or stream or the bed of the ocean or any bay, inlet, or lake?
7. Exposure of all people or property to geologic hazards such as earthquakes, landslides, mudslides, ground failure, or similar hazards?

Yes Maybe No

Grid of checkboxes for Yes, Maybe, No corresponding to items 1-7.

228
319
319

- | | Yes | Maybe | No |
|--|--------------------------|--------------------------|-------------------------------------|
| B. Air. Will the proposal result in: | | | |
| 1. Substantial air emissions or deterioration of ambient air quality? | <input type="checkbox"/> | <input type="checkbox"/> | <input checked="" type="checkbox"/> |
| 2. The creation of objectionable odors? | <input type="checkbox"/> | <input type="checkbox"/> | <input checked="" type="checkbox"/> |
| 3. Alteration of air movement, moisture or temperature, or any change in climate, either locally or regionally? | <input type="checkbox"/> | <input type="checkbox"/> | <input checked="" type="checkbox"/> |
| C. Water. Will the proposal result in: | | | |
| 1. Changes in the currents, or the course or direction of water movements, in either marine or fresh waters? | <input type="checkbox"/> | <input type="checkbox"/> | <input checked="" type="checkbox"/> |
| 2. Changes in absorption rates, drainage patterns, or the rate and amount of surface water runoff? | <input type="checkbox"/> | <input type="checkbox"/> | <input checked="" type="checkbox"/> |
| 3. Alterations to the course or flow of flood waters? | <input type="checkbox"/> | <input type="checkbox"/> | <input checked="" type="checkbox"/> |
| 4. Change in the amount of surface water in any water body? | <input type="checkbox"/> | <input type="checkbox"/> | <input checked="" type="checkbox"/> |
| 5. Discharge into surface waters, or in any alteration of surface water quality, including but not limited to temperature, dissolved oxygen or turbidity? | <input type="checkbox"/> | <input type="checkbox"/> | <input checked="" type="checkbox"/> |
| 6. Alteration of the direction or rate of flow of ground waters? | <input type="checkbox"/> | <input type="checkbox"/> | <input checked="" type="checkbox"/> |
| 7. Change in the quantity of ground waters, either through direct additions or withdrawals, or through interception of an aquifer by cuts or excavations? | <input type="checkbox"/> | <input type="checkbox"/> | <input checked="" type="checkbox"/> |
| 8. Substantial reduction in the amount of water otherwise available for public water supplies? | <input type="checkbox"/> | <input type="checkbox"/> | <input checked="" type="checkbox"/> |
| 9. Exposure of people or property to water-related hazards such as flooding or tidal waves? | <input type="checkbox"/> | <input type="checkbox"/> | <input checked="" type="checkbox"/> |
| 10. Significant changes in the temperature, flow or chemical content of surface thermal springs? | <input type="checkbox"/> | <input type="checkbox"/> | <input checked="" type="checkbox"/> |
| D. Plant Life. Will the proposal result in: | | | |
| 1. Change in the diversity of species, or number of any species of plants (including trees, shrubs, grass, crops, and aquatic plants)? | <input type="checkbox"/> | <input type="checkbox"/> | <input checked="" type="checkbox"/> |
| 2. Reduction of the numbers of any unique, rare or endangered species of plants? | <input type="checkbox"/> | <input type="checkbox"/> | <input checked="" type="checkbox"/> |
| 3. Introduction of new species of plants into an area, or in a barrier to the normal replenishment of existing species? | <input type="checkbox"/> | <input type="checkbox"/> | <input checked="" type="checkbox"/> |
| 4. Reduction in acreage of any agricultural crop? | <input type="checkbox"/> | <input type="checkbox"/> | <input checked="" type="checkbox"/> |
| E. Animal Life. Will the proposal result in: | | | |
| 1. Change in the diversity of species, or numbers of any species of animals (birds, land animals including reptiles, fish and shellfish, benthic organisms, or insects)? | <input type="checkbox"/> | <input type="checkbox"/> | <input checked="" type="checkbox"/> |
| 2. Reduction of the numbers of any unique, rare or endangered species of animals? | <input type="checkbox"/> | <input type="checkbox"/> | <input checked="" type="checkbox"/> |
| 3. Introduction of new species of animals into an area, or result in a barrier to the migration or movement of animals? | <input type="checkbox"/> | <input type="checkbox"/> | <input checked="" type="checkbox"/> |
| 4. Deterioration to existing fish or wildlife habitat? | <input type="checkbox"/> | <input type="checkbox"/> | <input checked="" type="checkbox"/> |
| F. Noise. Will the proposal result in: | | | |
| 1. Increase in existing noise levels? | <input type="checkbox"/> | <input type="checkbox"/> | <input checked="" type="checkbox"/> |
| 2. Exposure of people to severe noise levels? | <input type="checkbox"/> | <input type="checkbox"/> | <input checked="" type="checkbox"/> |
| G. Light and Glare. Will the proposal result in: | | | |
| 1. The production of new light or glare? | <input type="checkbox"/> | <input type="checkbox"/> | <input checked="" type="checkbox"/> |
| H. Land Use. Will the proposal result in: | | | |
| 1. A substantial alteration of the present or planned land use of an area? | <input type="checkbox"/> | <input type="checkbox"/> | <input checked="" type="checkbox"/> |
| I. Natural Resources. Will the proposal result in: | | | |
| 1. Increase in the rate of use of any natural resources? | <input type="checkbox"/> | <input type="checkbox"/> | <input checked="" type="checkbox"/> |
| 2. Substantial depletion of any nonrenewable resources? | <input type="checkbox"/> | <input type="checkbox"/> | <input checked="" type="checkbox"/> |

CALENDAR PAGE	229
MINUTE PAGE	343

- J. Risk of Upset.** Does the proposal result in:
- | | Yes | Maybe | No |
|---|--------------------------|--------------------------|-------------------------------------|
| 1. A risk of an explosion or the release of hazardous substances (including, but not limited to, oil, pesticides, chemicals, or radiation) in the event of an accident or upset conditions? | <input type="checkbox"/> | <input type="checkbox"/> | <input checked="" type="checkbox"/> |
| 2. Possible interference with emergency response plan or an emergency evacuation plan? | <input type="checkbox"/> | <input type="checkbox"/> | <input checked="" type="checkbox"/> |
- K. Population.** Will the proposal result in:
- | | | | |
|---|--------------------------|--------------------------|-------------------------------------|
| 1. The alteration, distribution, density, or growth rate of the human population of the area? | <input type="checkbox"/> | <input type="checkbox"/> | <input checked="" type="checkbox"/> |
|---|--------------------------|--------------------------|-------------------------------------|
- L. Housing.** Will the proposal result in:
- | | | | |
|---|--------------------------|--------------------------|-------------------------------------|
| 1. Affecting existing housing, or create a demand for additional housing? | <input type="checkbox"/> | <input type="checkbox"/> | <input checked="" type="checkbox"/> |
|---|--------------------------|--------------------------|-------------------------------------|
- M. Transportation/Circulation.** Will the proposal result in:
- | | | | |
|---|--------------------------|--------------------------|-------------------------------------|
| 1. Generation of substantial additional vehicular movement? | <input type="checkbox"/> | <input type="checkbox"/> | <input checked="" type="checkbox"/> |
| 2. Affecting existing parking facilities, or create a demand for new parking? | <input type="checkbox"/> | <input type="checkbox"/> | <input checked="" type="checkbox"/> |
| 3. Substantial impact upon existing transportation systems? | <input type="checkbox"/> | <input type="checkbox"/> | <input checked="" type="checkbox"/> |
| 4. Alterations to present patterns of circulation or movement of people and/or goods? | <input type="checkbox"/> | <input type="checkbox"/> | <input checked="" type="checkbox"/> |
| 5. Alterations to waterborne, rail, or air traffic? | <input type="checkbox"/> | <input type="checkbox"/> | <input checked="" type="checkbox"/> |
| 6. Increase in traffic hazards to motor vehicles, bicyclists, or pedestrians? | <input type="checkbox"/> | <input type="checkbox"/> | <input checked="" type="checkbox"/> |
- N. Public Services.** Will the proposal have an effect upon, or result in a need for new or altered governmental services in any of the following areas:
- | | | | |
|---|--------------------------|--------------------------|-------------------------------------|
| 1. Fire protection? | <input type="checkbox"/> | <input type="checkbox"/> | <input checked="" type="checkbox"/> |
| 2. Police protection? | <input type="checkbox"/> | <input type="checkbox"/> | <input checked="" type="checkbox"/> |
| 3. Schools? | <input type="checkbox"/> | <input type="checkbox"/> | <input checked="" type="checkbox"/> |
| 4. Parks and other recreational facilities? | <input type="checkbox"/> | <input type="checkbox"/> | <input checked="" type="checkbox"/> |
| 5. Maintenance of public facilities, including roads? | <input type="checkbox"/> | <input type="checkbox"/> | <input checked="" type="checkbox"/> |
| 6. Other governmental services? | <input type="checkbox"/> | <input type="checkbox"/> | <input checked="" type="checkbox"/> |
- O. Energy.** Will the proposal result in:
- | | | | |
|---|--------------------------|--------------------------|-------------------------------------|
| 1. Use of substantial amounts of fuel or energy? | <input type="checkbox"/> | <input type="checkbox"/> | <input checked="" type="checkbox"/> |
| 2. Substantial increase in demand upon existing sources of energy, or require the development of new sources? | <input type="checkbox"/> | <input type="checkbox"/> | <input checked="" type="checkbox"/> |
- P. Utilities.** Will the proposal result in a need for new systems, or substantial alterations to the following utilities:
- | | | | |
|------------------------------------|--------------------------|--------------------------|-------------------------------------|
| 1. Power or natural gas? | <input type="checkbox"/> | <input type="checkbox"/> | <input checked="" type="checkbox"/> |
| 2. Communication systems? | <input type="checkbox"/> | <input type="checkbox"/> | <input checked="" type="checkbox"/> |
| 3. Water? | <input type="checkbox"/> | <input type="checkbox"/> | <input checked="" type="checkbox"/> |
| 4. Sewer or septic tanks? | <input type="checkbox"/> | <input type="checkbox"/> | <input checked="" type="checkbox"/> |
| 5. Storm water drainage? | <input type="checkbox"/> | <input type="checkbox"/> | <input checked="" type="checkbox"/> |
| 6. Solid waste and disposal? | <input type="checkbox"/> | <input type="checkbox"/> | <input checked="" type="checkbox"/> |
- Q. Human Health.** Will the proposal result in:
- | | | | |
|--|--------------------------|--------------------------|-------------------------------------|
| 1. Creation of any health hazard or potential health hazard (excluding mental health)? | <input type="checkbox"/> | <input type="checkbox"/> | <input checked="" type="checkbox"/> |
| 2. Exposure of people to potential health hazards? | <input type="checkbox"/> | <input type="checkbox"/> | <input checked="" type="checkbox"/> |
- R. Aesthetics.** Will the proposal result in:
- | | | | |
|--|--------------------------|--------------------------|-------------------------------------|
| 1. The obstruction of any scenic vista or view open to the public, or will the proposal result in the creation of an aesthetically offensive site open to public view? | <input type="checkbox"/> | <input type="checkbox"/> | <input checked="" type="checkbox"/> |
|--|--------------------------|--------------------------|-------------------------------------|
- S. Recreation.** Will the proposal result in:
- | | | | |
|---|--------------------------|--------------------------|-------------------------------------|
| 1. An impact upon the quality or quantity of existing recreational opportunities? | <input type="checkbox"/> | <input type="checkbox"/> | <input checked="" type="checkbox"/> |
|---|--------------------------|--------------------------|-------------------------------------|

Yes Maybe No

T. Cultural Resources.

- 1. Will the proposal result in the alteration of or the destruction of a prehistoric or historic archeological site?
- 2. Will the proposal result in adverse physical or aesthetic effects to a prehistoric or historic building, structure, or object?
- 3. Does the proposal have the potential to cause a physical change which would affect unique ethnic cultural values?
- 4. Will the proposal restrict existing religious or sacred uses within the potential impact area?

U. Mandatory Findings of Significance.

- 1. Does the project have the potential to degrade the quality of the environment, reduce the habitat of a fish or wildlife species, cause a fish or wildlife population to drop below self-sustaining levels, threaten to eliminate a plant or animal community, reduce the number or restrict the range of a rare or endangered plant or animal or eliminate important examples of the major periods of California history or prehistory?
- 2. Does the project have the potential to achieve short-term, to the disadvantage of long-term, environmental goals?
- 3. Does the project have impacts which are individually limited, but cumulatively considerable?
- 4. Does the project have environmental effects which will cause substantial adverse effects on human beings, either directly or indirectly?

III. DISCUSSION OF ENVIRONMENTAL EVALUATION (See Comments Attached)

IV. PRELIMINARY DETERMINATION

On the basis of this initial evaluation:

- I find the proposed project COULD NOT have a significant effect on the environment, and a NEGATIVE DECLARATION will be prepared.
- I find that although the proposed project could have a significant effect on the environment, there will not be a significant effect in this case because the mitigation measures described on an attached sheet have been added to the project. A NEGATIVE DECLARATION will be prepared.
- I find the proposed project MAY have a significant effect on the environment, and an ENVIRONMENTAL IMPACT REPORT is required.

Date: 5 / 15 / 89

John J. Hutchinson
 For the State Lands Commission
 RECEIVED DATE 5/23/89
 3436