

MINUTE ITEM

This Calendar Item No. 17
was approved as Minute Item
No. 17 by the State Lands
Commission by a vote of 3
to 0 at its 08/30/89
meeting.

CALENDAR ITEM

- 17

A 7

08/30/89

S 1

PRC 4314

J. Ludlow

APPROVAL OF A RECREATIONAL PIER PERMIT

APPLICANT: Ann Milton Wallis Trust
151 Hazel Lane
Piedmont, California 94611

AREA, TYPE LAND AND LOCATION:
A parcel of submerged land in Lake Tahoe at
Sunnyside, Placer County.

LAND USE: Partial reconstruction of an existing pier,
reconstruction of an existing boathouse, and
continued use and maintenance of two mooring
buoys.

TERMS OF PROPOSED PERMIT:
Initial period: Five-years beginning
August 30, 1989.

CONSIDERATION: Rent-free, pursuant to Section 6503.5 of the
P.R.C.

APPLICANT STATUS:
Applicant is owner of upland.

PREREQUISITE CONDITIONS, FEES AND EXPENSES:
Filing fee and processing costs have been
received.

STATUTORY AND OTHER REFERENCES:
A. P.R.C.: Div. 6, Parts 1 and 2; Div. 13.
B. Cal. Code Regs.: Title 2, Div. 3;
Title 14, Div. 6.

AB 884: 01/13/90.

| | |
|---------------|------|
| CALENDAR PAGE | 224 |
| MINUTE PAGE | 2316 |

OTHER PERTINENT INFORMATION:

1. Pursuant to the Commission's delegation of authority and the State CEQA Guidelines (14 Cal. Code Regs. 15025), the staff has prepared a Proposed Negative Declaration identified as EIR ND 468, State Clearinghouse No. 89032013. Such Proposed Negative Declaration was prepared and circulated for public review pursuant to the provisions of CEQA.

Based upon the Initial Study, the Proposed Negative Declaration, and the comments received in response thereto, there is no substantial evidence that the project will have a significant effect on the environment. (14 Cal. Code Regs. 15074(b))

2. In lieu of total reconstruction, the applicant proposes to reconstruct only that portion of the pier waterward of the low water mark (6223' elevation). That portion of the pier located in the shorezone area shall remain as is. It has been found that that portion of the pier within the shorezone area is in a safe and serviceable condition and is not in need of reconstruction at this time.
3. The work, as proposed, will be done from a barge that will be located in the lake. First, the existing sections of the pier to be replaced will be removed, placed on the barge, and hauled away. Once the barge is unloaded, the new materials to construct the new sections of the pier will be placed on the barge and taken to the construction site. The new portion of the pier and boathouse will be constructed entirely from the barge with a crane and a pile driver that are located on the floating platform.
4. Materials will be neither stored or placed, nor will any activity associated with construction, be conducted above the low water line on the subject property. This will prevent any disturbance to what may be considered a Tahoe Yellow Cress (Rorippa) habitat.

CALENDAR ITEM NO. 17 (CONT'D)

5. The existing pier, boathouse and mooring buoys are all previously authorized structures.
6. In order to determine the other potential trust uses in the area of the proposed project, the staff contacted representatives of the following agencies: TRPA, Department of Fish and Game, County of Placer, and the Tahoe Conservancy. None of these agencies expressed a concern that the proposed project would have a significant effect on trust uses in the area. The agencies did not identify any trust needs which were not being met by existing facilities in the area. Identified trust uses in this area would include swimming, boating, walking along the beach, and views of the lake.
7. This activity involves lands identified as possessing significant environmental values pursuant to P.R.C. 6370, et seq. Based upon the staff's consultation with the persons nominating such lands and through the CEQA review process, it is the staff's opinion that the project, as proposed, is consistent with its use classification.
8. All permits covering structures in Lake Tahoe will include a condition subsequent that if any structure authorized is found to be in nonconformance with the Tahoe Regional Planning Agency's shorezone ordinance, and if any alterations, repairs, or removal required pursuant to said ordinance are not accomplished within the designated time period, then the permit will be automatically terminated, effective upon notice by the State, and the site shall be cleared pursuant to the terms thereof.

APPROVALS OBTAINED:

Placer County, Tahoe Regional Planning Agency, California Department of Fish and Game, and United States Army Corps of Engineers .

CALENDAR ITEM NO. 17 (CONT'D)

FURTHER APPROVALS REQUIRED:

Lanham Regional Water Quality Control Board,
U.S. Army Corps of Engineers.

EXHIBITS:

- A. Site Map.
- B. Location Map.
- C. Placer County Letter of Approval.
- D. Negative Declaration.

IT IS RECOMMENDED THAT THE COMMISSION:

1. CERTIFY THAT A NEGATIVE DECLARATION, EIR ND 468, STATE CLEARINGHOUSE NO. 89032013, WAS PREPARED FOR THIS PROJECT PURSUANT TO THE PROVISIONS OF THE CEQA AND THAT THE COMMISSION HAS REVIEWED AND CONSIDERED THE INFORMATION CONTAINED THEREIN.
2. DETERMINE THAT THE PROJECT, AS APPROVED, WILL NOT HAVE A SIGNIFICANT EFFECT ON THE ENVIRONMENT.
3. AUTHORIZE ISSUANCE TO ANN MILTON WALLIS TRUST OF A FIVE-YEAR RECREATIONAL PIER PERMIT, BEGINNING AUGUST 30, 1989; FOR THE PARTIAL RECONSTRUCTION OF AN EXISTING PIER, RECONSTRUCTION OF AN EXISTING BOATHOUSE, AND THE CONTINUED USE AND MAINTENANCE OF TWO MOORING BUOYS, ON THE LAND DESCRIBED ON EXHIBIT "A" ATTACHED AND BY REFERENCE MADE A PART HEREOF.

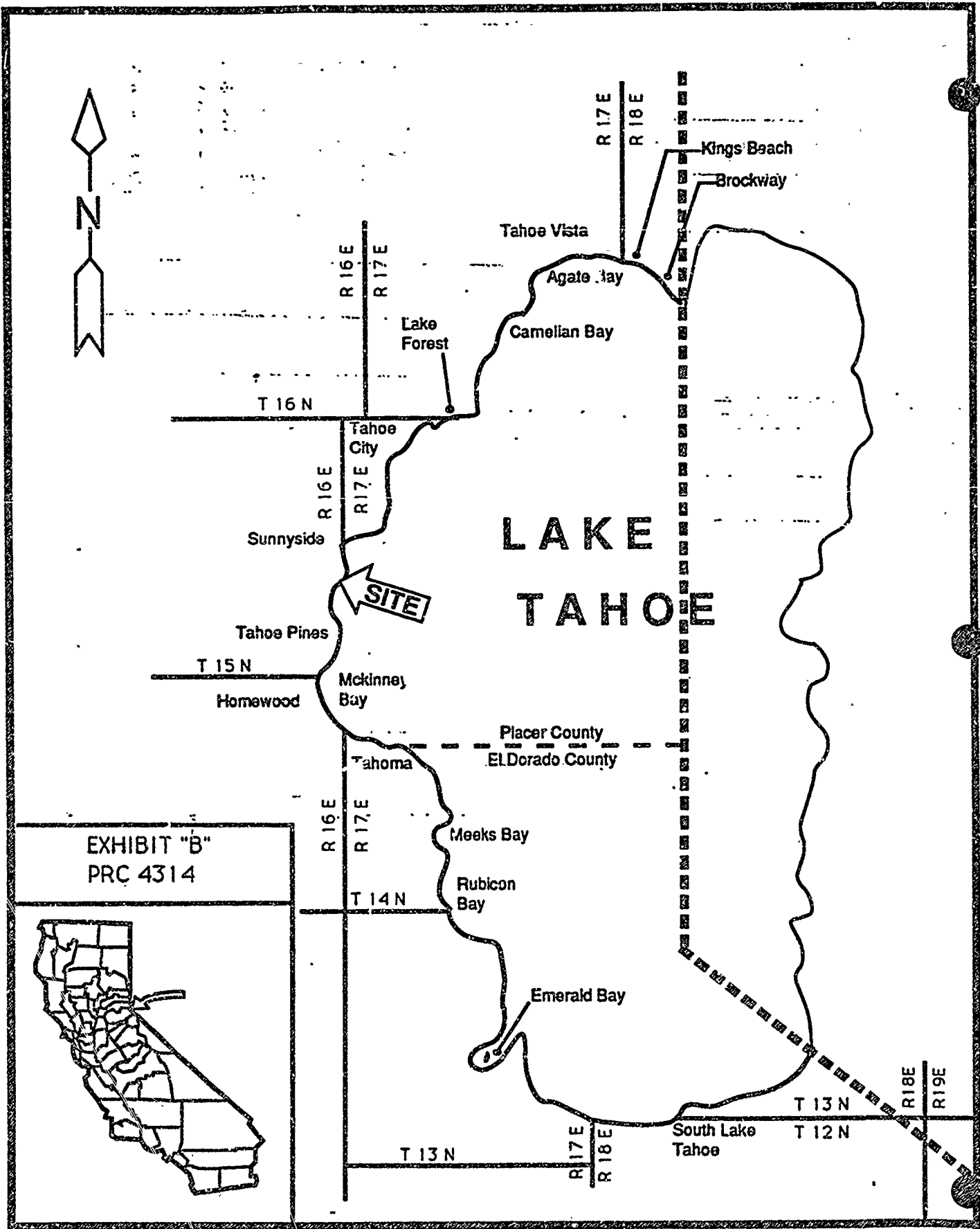

EXHIBIT "B"
PRC 4314





PLACER COUNTY

DEPARTMENT OF PUBLIC WORKS

JACK WARREN, Director
JAN WITTER, Assistant Director
LARRY ODDO, Deputy Director
ALAN ROY, Deputy Director

OPERATING DIVISION:
Administration
Engineering
Equipment Maintenance
Road Maintenance
Special Districts
Surveying
Transportation

March 3, 1989

Judy Ludlow
California State Lands Commission
1807 - 13th Street
Sacramento, CA 95814

RE: PIER - SHOREZONE CONSTRUCTION

The County of Placer has reviewed the below referenced requests for construction activities within the Shorezone of Lake Tahoe. We have no objection to the construction activities described in the below applications contingent upon approval by your office.

- | | | |
|-----|-----------------------------|------------|
| 1. | E.S. Bertagnolli | PRC 3209.9 |
| 2. | Charlotte and Robert Angell | W 24144 |
| 3. | Sweet/Avanessian | PRC 5022 |
| 4. | Wickland | PRC 3599 |
| 5. | Lyons/Hawkins | WP 5884 |
| 6. | Mein - 83-162-28 | PRC 6714 |
| 7. | Mein - 83-162-31 | W 24134 |
| 8. | McFarland | PRC 3659 |
| 9. | Gibb | WP 3652 |
| 10. | Crabtree | W 21445 |
| 11. | English | W 1124.38 |
| 12. | Wallis | PRC 4314 |
| 13. | Metas | W 24103 |
| 14. | Barrow | PRC 7167.9 |
| 15. | Nahas | PRC 4066 |
| 16. | Hicks | W 21665 |

Should you have any questions or if I can be of further assistance, please call at your convenience.

COUNTY OF PLACER
DEPARTMENT OF PUBLIC WORKS
JACK WARREN, DIRECTOR

James McLeod
JAMES MCLEOD
ASSISTANT CIVIL ENGINEER

JH:ms

| | |
|---------------|------|
| CALENDAR PAGE | 230 |
| MINUTE PAGE | 2523 |



PROPOSED NEGATIVE DECLARATION

EIR ND 468

File Ref.: PRC 4314

SCH#: 8903 2013

Project Title: WALLIS PIER REPLACEMENT/RECONSTRUCTION

Project Proponent: Ann Milton Wallis

Project Location: In Lake Tahoe adjacent to 2490 West Lake Blvd., Sunnyside,
Placer County.

Project Description: Reconstruction of an existing pier and boathouse.

Contact Person: TED T. FUKUSHIMA

Telephone: (916)322-7813

This document is prepared pursuant to the requirements of the California Environmental Quality Act (Section 21000 et seq., Public Resources Code), the State CEQA Guidelines (Section 15000 et seq., Title 14, California Code Regulations), and the State Lands Commission regulations (Section 2901 et seq., Title 2, California Code Regulations).

Based upon the attached Initial Study, it has been found that:

the project will not have a significant effect on the environment.

mitigation measures included in the project will avoid potentially significant effects.

| | |
|---------------|------|
| CALENDAR PAGE | 231 |
| MINUTE PAGE | 3533 |

PROJECT DESCRIPTION

The proposed project will involve the following:

1. Replacement of all wood piles with 10.75" O steel piles with 6x15 H 8M's.
2. Replacement of all old decking and joists with new 4x12 joists at 24" o.c. with 2x6 cedar decking.
3. Replacement of old open pile boat house and roof with new open pile (10.75" O steel piles) boathouse and roof.
4. Replacement of old wood ladders with new ladders.

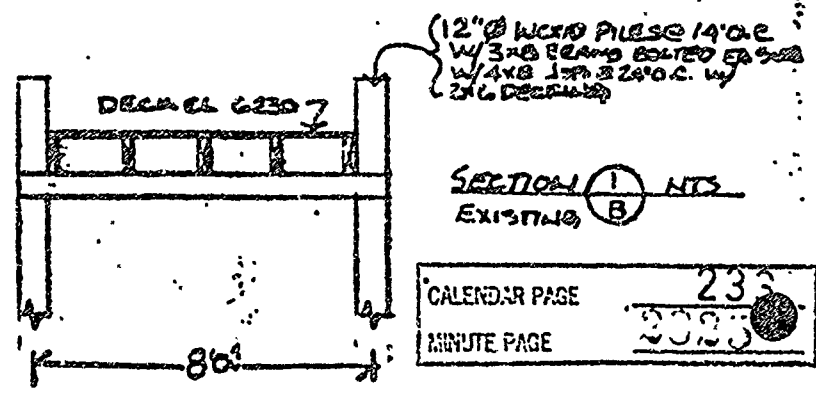
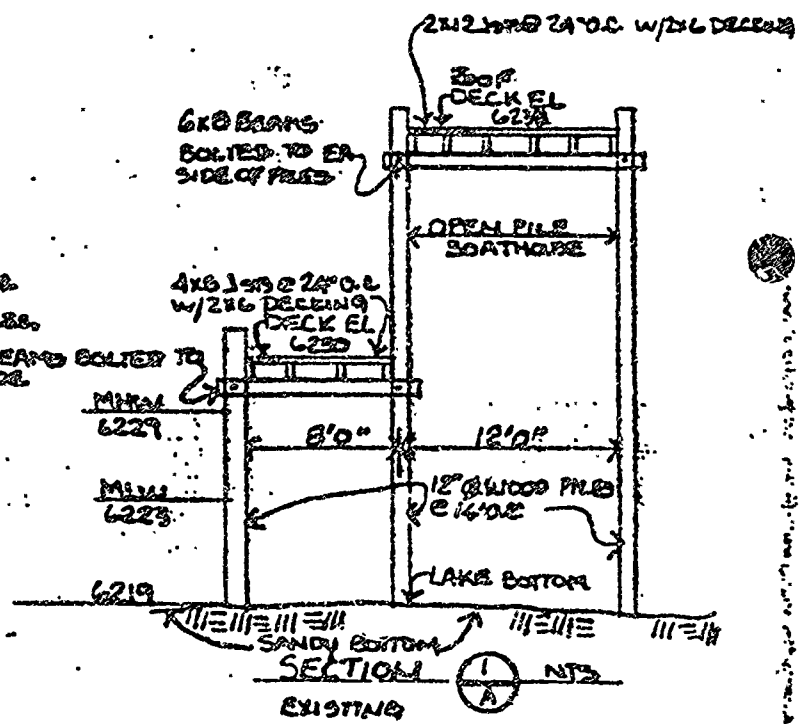
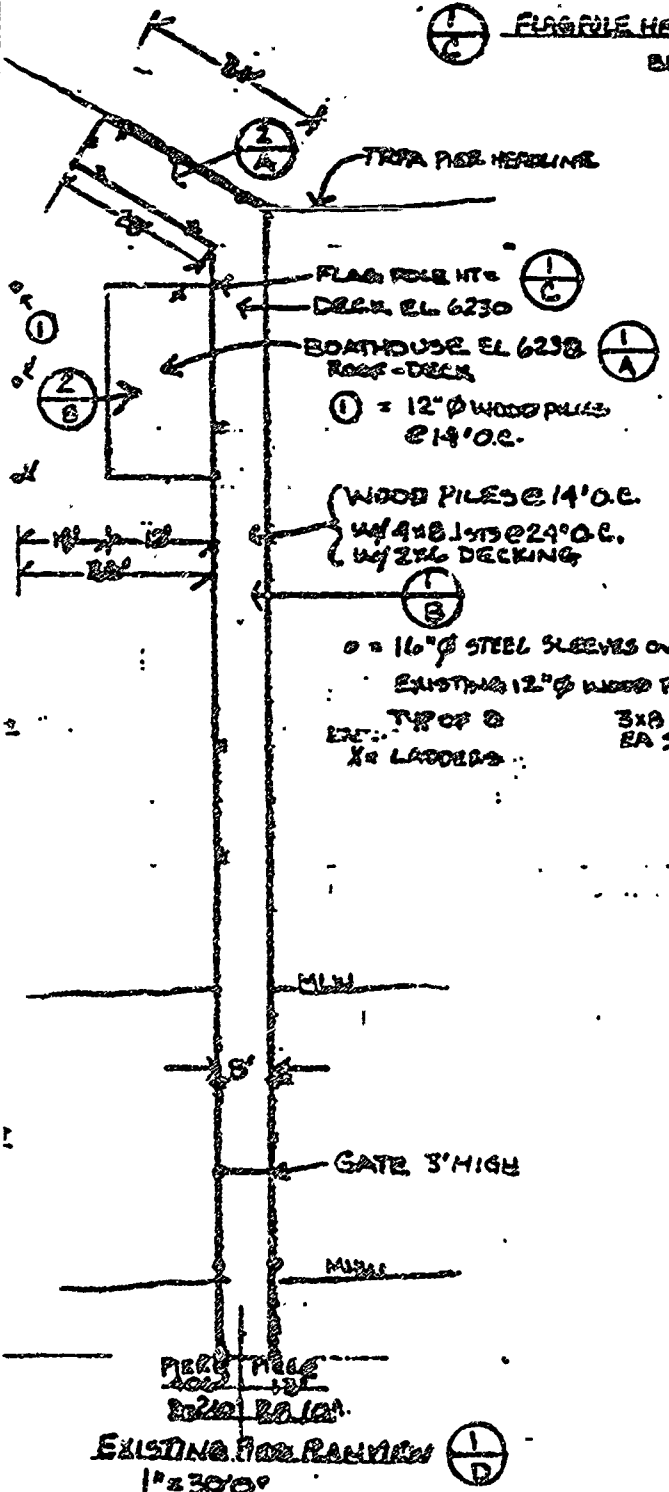
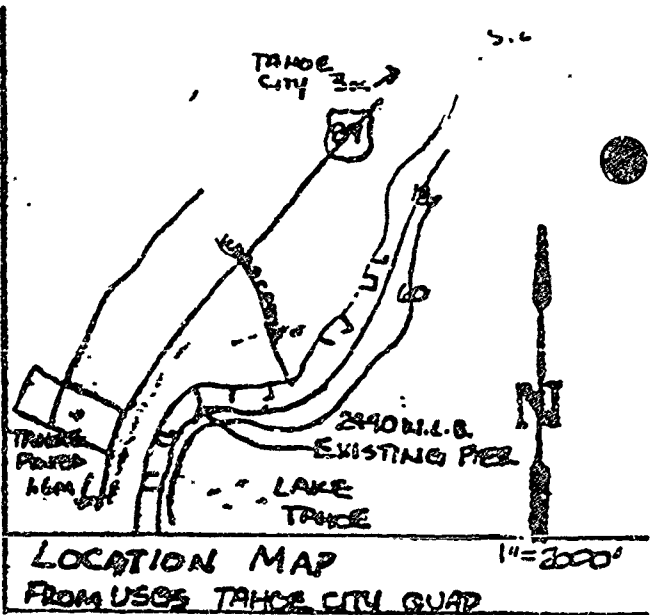
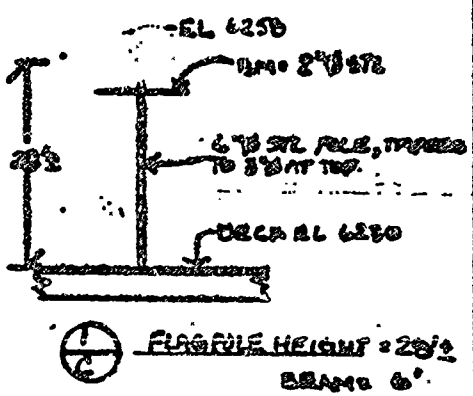

CALENDAR PAGE 233
MINUTE PAGE 2025

ENVIRONMENTAL IMPACT ASSESSMENT FORM -- Part I

(To be completed by applicant)

FORM 60.3(11/83)

A. GENERAL INFORMATION

1. Name, address, and telephone number:

a. Applicant

ANN MILTON WALLIS
191 HAZEL LANE
PIEDMONT, CA 94611
(415) 547-5355

b. Contact person if other than applicant:

GARY R. TRAYLOR, CONSULTANT
PO Box 1715
CRYSTAL BAY, ND 58402
(702) 831-8676

2. a. Project location: (Please reference to nearest town or community and include county)

3 MILES SOUTH OF TAGE CITY ON HWY 89
2990 WEST LAKE BLVD, SUNNYSIDE, PLACER COUNTY, CA

b. Assessor's parcel number: 84-121-03

3. Existing zoning of project site: R1

4. Existing land use of project site: RECREATIONAL

5. Proposed use of site: SAME AS ABOVE

6. Other permits required: ARMY CORPS OF ENGINEERS, TRPA, LAHCNTAN,
CALIF DEPT OF FISH AND GAME, PLACER COUNTY DPW

B. PROJECT DESCRIPTION

1. For building construction projects, complete "ATTACHMENT A".

2. For non-building construction projects: Describe fully, the proposed activity, its purpose and intended use, e.g. for proposed mineral prospecting permits, include the number of test holes, size of holes, amount of material to be excavated, maximum surface area of disturbance, hole locations, depth of holes, etc. Attach plans or other drawings as necessary.

CALENDAR PAGE 235
MINUTE PAGE 3827

C. ENVIRONMENTAL SETTING

- 1. Describe the project site as it exists before the project, including information on topography, soil stability, plants and animals, and any cultural, historical, or scenic aspects. Describe any existing structures on the site, and the use of the structures.
- 2. Describe the surrounding properties, including information on plants and animals and any cultural, historical, or scenic aspects. Indicate the type of land use (residential, commercial, etc.), intensity of land use (one-family, apartment houses, shops, department stores, etc.), and scale of development (height, frontage, set-back, rear yard, etc.).

D. ENVIRONMENTAL IMPACT ASSESSMENT

Answer the following questions by placing a check in the appropriate box. Discuss all items checked "yes" or "maybe". (Attach additional sheets as necessary)

Will the project involve:

| | YES | MAYBE | NO |
|--|--------------------------|--------------------------|-------------------------------------|
| 1. a change in existing features of any bays, tidalands, beaches, lakes, or hills, or substantial alteration of ground contours? | <input type="checkbox"/> | <input type="checkbox"/> | <input checked="" type="checkbox"/> |
| 2. a change in scenic views or vistas from existing residential areas or public lands or roads? | <input type="checkbox"/> | <input type="checkbox"/> | <input checked="" type="checkbox"/> |
| 3. a change in pattern, scale, or character of the general area of project? | <input type="checkbox"/> | <input type="checkbox"/> | <input checked="" type="checkbox"/> |
| 4. a significant effect on plant or animal life? | <input type="checkbox"/> | <input type="checkbox"/> | <input checked="" type="checkbox"/> |
| 5. significant amounts of solid waste or litter? | <input type="checkbox"/> | <input type="checkbox"/> | <input checked="" type="checkbox"/> |
| 6. a change in dust, ash, smoke, fumes, or odors in the vicinity? | <input type="checkbox"/> | <input type="checkbox"/> | <input checked="" type="checkbox"/> |
| 7. a change in ocean, bay, lake, stream, or ground water quality or quantity, or alteration of existing drainage patterns? | <input type="checkbox"/> | <input type="checkbox"/> | <input checked="" type="checkbox"/> |
| 8. a change in existing noise or vibration levels in the vicinity? | <input type="checkbox"/> | <input type="checkbox"/> | <input checked="" type="checkbox"/> |
| 9. construction on filled land or on slope of 10 percent or more? | <input type="checkbox"/> | <input type="checkbox"/> | <input checked="" type="checkbox"/> |
| 10. use or disposal of potentially hazardous materials, such as toxic or radioactive substances, flammables, or explosives? | <input type="checkbox"/> | <input type="checkbox"/> | <input checked="" type="checkbox"/> |
| 11. a change in demand for municipal services (police, fire, water, sewage, etc.)? | <input type="checkbox"/> | <input type="checkbox"/> | <input checked="" type="checkbox"/> |
| 12. an increase in fossil fuel consumption (electricity, oil, natural gas, etc.)? | <input type="checkbox"/> | <input type="checkbox"/> | <input checked="" type="checkbox"/> |
| 13. a large project or a series of projects? | <input type="checkbox"/> | <input type="checkbox"/> | <input checked="" type="checkbox"/> |

E. CERTIFICATION

I hereby certify that the statements furnished above and in the attached exhibits present the data and information required for this initial evaluation to the best of my ability, and that the facts, statements, and information presented are true and correct to the best of my knowledge and belief.

Date: 12-2-1984 X Signed: Ann Marie Lohlin

ENVIRONMENTAL IMPACT ASSESSMENT CHECKLIST - PART II

Form 13.20 (7/82)

File Ref.: PRC 4314

I. BACKGROUND INFORMATION

A. Applicant: Ann Milton Wallis
141 Hazel Lane
Piedmont, CA 94611

B. Checklist Date: 3 / 21 / 89

C. Contact Person: TED T. FUKUSHIMA
Telephone: (916) 322-7813

D. Purpose: To renovate an existing pier and boat house.

E. Location: In Lake Tahoe adjacent to 2490 West Lake Blvd., Sunnyside, Placer County.

F. Description: Replace/reconstruct existing facility with a new structure.

G. Persons Contacted:

II. ENVIRONMENTAL IMPACTS. (Explain all "yes" and "maybe" answers)

Table with 3 columns: Question, Yes, Maybe, No. Contains 7 rows of environmental impact questions with checkboxes.

B. *Air*. Will the proposal result in:

Yes Maybe No

- 1. Substantial air emissions or deterioration of ambient air quality?
- 2. The creation of objectionable odors?
- 3. Alteration of air movement, moisture or temperature, or any change in climate, either locally or regionally?

C. *Water*. Will the proposal result in:

- 1. Changes in the currents, or the course or direction of water movements, in either marine or fresh waters?
- 2. Changes in absorption rates, drainage patterns, or the rate and amount of surface water runoff?
- 3. Alterations to the course or flow of flood waters?
- 4. Change in the amount of surface water in any water body?
- 5. Discharge into surface waters, or in any alteration of surface water quality, including but not limited to temperature, dissolved oxygen or turbidity?
- 6. Alteration of the direction or rate of flow of ground waters?
- 7. Change in the quantity of ground waters, either through direct additions or withdrawals, or through interception of an aquifer by cuts or excavations?
- 8. Substantial reduction in the amount of water otherwise available for public water supplies?
- 9. Exposure of people or property to water-related hazards such as flooding or tidal waves?
- 10. Significant changes in the temperature, flow or chemical content of surface thermal springs?

D. *Plant Life*. Will the proposal result in:

- 1. Change in the diversity of species, or number of any species of plants (including trees, shrubs, grass, crops, and aquatic plants)?
- 2. Reduction of the numbers of any unique, rare or endangered species of plants?
- 3. Introduction of new species of plants into an area, or in a barrier to the normal replenishment of existing species?
- 4. Reduction in acreage of any agricultural crop?

E. *Animal Life*. Will the proposal result in:

- 1. Change in the diversity of species, or numbers of any species of animals (birds, land animals including reptiles, fish and shellfish, benthic organisms, or insects)?
- 2. Reduction of the numbers of any unique, rare or endangered species of animals?
- 3. Introduction of new species of animals into an area, or result in a barrier to the migration or movement of animals?
- 4. Deterioration to existing fish or wildlife habitat?

F. *Noise*. Will the proposal result in:

- 1. Increase in existing noise levels?
- 2. Exposure of people to severe noise levels?

G. *Light and Glare*. Will the proposal result in:

- 1. The production of new light or glare?

H. *Land Use*. Will the proposal result in:

- 1. A substantial alteration of the present or planned land use of an area?

I. *Natural Resources*. Will the proposal result in:

- 1. Increase in the rate of use of any natural resources?
- 2. Substantial depletion of any nonrenewable resources?

- J. Risk of Upset.** Does the proposal result in:
- | | | | |
|---|--------------------------|--------------------------|-------------------------------------|
| | Yes | Maybe | <input checked="" type="checkbox"/> |
| 1. A risk of an explosion or the release of hazardous substances (including, but not limited to, oil, pesticides, chemicals, or radiation) in the event of an accident or upset conditions? | <input type="checkbox"/> | <input type="checkbox"/> | <input checked="" type="checkbox"/> |
| 2. Possible interference with emergency response plan or an emergency evacuation plan? | <input type="checkbox"/> | <input type="checkbox"/> | <input checked="" type="checkbox"/> |
- K. Population.** Will the proposal result in:
- | | | | |
|---|--------------------------|--------------------------|-------------------------------------|
| 1. The alteration, distribution, density, or growth rate of the human population of the area? | <input type="checkbox"/> | <input type="checkbox"/> | <input checked="" type="checkbox"/> |
|---|--------------------------|--------------------------|-------------------------------------|
- L. Housing.** Will the proposal result in:
- | | | | |
|---|--------------------------|--------------------------|-------------------------------------|
| 1. Affecting existing housing, or create a demand for additional housing? | <input type="checkbox"/> | <input type="checkbox"/> | <input checked="" type="checkbox"/> |
|---|--------------------------|--------------------------|-------------------------------------|
- M. Transportation/Circulation.** Will the proposal result in:
- | | | | |
|---|--------------------------|--------------------------|-------------------------------------|
| 1. Generation of substantial additional vehicular movement? | <input type="checkbox"/> | <input type="checkbox"/> | <input checked="" type="checkbox"/> |
| 2. Affecting existing parking facilities, or create a demand for new parking? | <input type="checkbox"/> | <input type="checkbox"/> | <input checked="" type="checkbox"/> |
| 3. Substantial impact upon existing transportation systems? | <input type="checkbox"/> | <input type="checkbox"/> | <input checked="" type="checkbox"/> |
| 4. Alterations to present patterns of circulation or movement of people and/or goods? | <input type="checkbox"/> | <input type="checkbox"/> | <input checked="" type="checkbox"/> |
| 5. Alterations to waterborne, rail, or air traffic? | <input type="checkbox"/> | <input type="checkbox"/> | <input checked="" type="checkbox"/> |
| 6. Increase in traffic hazards to motor vehicles, bicyclists, or pedestrians? | <input type="checkbox"/> | <input type="checkbox"/> | <input checked="" type="checkbox"/> |
- N. Public Services.** Will the proposal have an effect upon, or result in a need for new or altered governmental services in any of the following areas:
- | | | | |
|---|--------------------------|--------------------------|-------------------------------------|
| 1. Fire protection? | <input type="checkbox"/> | <input type="checkbox"/> | <input checked="" type="checkbox"/> |
| 2. Police protection? | <input type="checkbox"/> | <input type="checkbox"/> | <input checked="" type="checkbox"/> |
| 3. Schools? | <input type="checkbox"/> | <input type="checkbox"/> | <input checked="" type="checkbox"/> |
| 4. Parks and other recreational facilities? | <input type="checkbox"/> | <input type="checkbox"/> | <input checked="" type="checkbox"/> |
| 5. Maintenance of public facilities, including roads? | <input type="checkbox"/> | <input type="checkbox"/> | <input checked="" type="checkbox"/> |
| 6. Other governmental services? | <input type="checkbox"/> | <input type="checkbox"/> | <input checked="" type="checkbox"/> |
- O. Energy.** Will the proposal result in:
- | | | | |
|---|--------------------------|--------------------------|-------------------------------------|
| 1. Use of substantial amounts of fuel or energy? | <input type="checkbox"/> | <input type="checkbox"/> | <input checked="" type="checkbox"/> |
| 2. Substantial increase in demand upon existing sources of energy, or require the development of new sources? | <input type="checkbox"/> | <input type="checkbox"/> | <input checked="" type="checkbox"/> |
- P. Utilities.** Will the proposal result in a need for new systems, or substantial alterations to the following utilities:
- | | | | |
|------------------------------------|--------------------------|--------------------------|-------------------------------------|
| 1. Power or natural gas? | <input type="checkbox"/> | <input type="checkbox"/> | <input checked="" type="checkbox"/> |
| 2. Communication systems? | <input type="checkbox"/> | <input type="checkbox"/> | <input checked="" type="checkbox"/> |
| 3. Water? | <input type="checkbox"/> | <input type="checkbox"/> | <input checked="" type="checkbox"/> |
| 4. Sewer or septic tanks? | <input type="checkbox"/> | <input type="checkbox"/> | <input checked="" type="checkbox"/> |
| 5. Storm water drainage? | <input type="checkbox"/> | <input type="checkbox"/> | <input checked="" type="checkbox"/> |
| 6. Solid waste and disposal? | <input type="checkbox"/> | <input type="checkbox"/> | <input checked="" type="checkbox"/> |
- Q. Human Health.** Will the proposal result in:
- | | | | |
|--|--------------------------|--------------------------|-------------------------------------|
| 1. Creation of any health hazard or potential health hazard (excluding mental health)? | <input type="checkbox"/> | <input type="checkbox"/> | <input checked="" type="checkbox"/> |
| 2. Exposure of people to potential health hazards? | <input type="checkbox"/> | <input type="checkbox"/> | <input checked="" type="checkbox"/> |
- R. Aesthetics.** Will the proposal result in:
- | | | | |
|--|--------------------------|--------------------------|-------------------------------------|
| 1. The obstruction of any scenic vista or view open to the public, or will the proposal result in the creation of an aesthetically offensive site open to public view? | <input type="checkbox"/> | <input type="checkbox"/> | <input checked="" type="checkbox"/> |
|--|--------------------------|--------------------------|-------------------------------------|
- S. Recreation.** Will the proposal result in:
- | | | | |
|---|--------------------------|--------------------------|-------------------------------------|
| 1. An impact upon the quality or quantity of existing recreational opportunities? | <input type="checkbox"/> | <input type="checkbox"/> | <input checked="" type="checkbox"/> |
|---|--------------------------|--------------------------|-------------------------------------|

T. Cultural Resources.

Yes Maybe No

- 1. Will the proposal result in the alteration of or the destruction of a prehistoric or historic archeological site?
- 2. Will the proposal result in adverse physical or aesthetic effects to a prehistoric or historic building, structure, or object?
- 3. Does the proposal have the potential to cause a physical change which would affect unique ethnic cultural values?
- 4. Will the proposal restrict existing religious or sacred uses within the potential impact area?

U. Mandatory Findings of Significance.

- 1. Does the project have the potential to degrade the quality of the environment, reduce the habitat of a fish or wildlife species, cause a fish or wildlife population to drop below self-sustaining levels, threaten to eliminate a plant or animal community, reduce the number or restrict the range of a rare or endangered plant or animal or eliminate important examples of the major periods of California history or prehistory?
- 2. Does the project have the potential to achieve short-term, to the disadvantage of long-term, environmental goals?
- 3. Does the project have impacts which are individually limited, but cumulatively considerable?
- 4. Does the project have environmental effects which will cause substantial adverse effects on human beings, either directly or indirectly?

III. DISCUSSION OF ENVIRONMENTAL EVALUATION (See Comments Attached)

- C5 - There could be a slight rise in the turbidity level during the construction however, compliance with water quality control requirements should reduce this potential impact to a minimum.
- E4 - This project could substantially adversely affect existing fish resources however, compliance with the proposed mitigation measures by the Department of Fish and Game's stream or lake alteration agreement should reduce this potential impact to a minimum.
- F1 - There could be a rise in the ambient noise levels during construction however, this should be of relatively short term duration.

IV. PRELIMINARY DETERMINATION

On the basis of this initial evaluation:

- I find the proposed project COULD NOT have a significant effect on the environment, and a NEGATIVE DECLARATION will be prepared.
- I find that although the proposed project could have a significant effect on the environment, there will not be a significant effect in this case because the mitigation measures described on an attached sheet have been added to the project. A NEGATIVE DECLARATION will be prepared.
- I find the proposed project MAY have a significant effect on the environment, and an ENVIRONMENTAL IMPACT REPORT is required.

Date: 3 / 21 / 89

 CALIFORNIA
 For the State Lands Commission

A permit fee of \$125.00 PAID

Notification No. 11-0R-89 THP No. _____

This permit is not valid until payment received.

AGREEMENT REGARDING PROPOSED STREAM OR LAKE ALTERATION

THIS AGREEMENT entered into between the State of California, Department of Fish and Game, hereinafter called the Department, and Mr. Gary Taylor (representing Ann Hilton Wallis) of Crystal Bay, State of Nevada, hereinafter called the operator, is as follows:

WHEREAS, pursuant to Division 2, Chapter 6 of California Fish and Game Code, the operator, on the 10 day of Jan, 1989, notified the Department that he intends to substantially divert or obstruct the natural flow of, or substantially change the bed, channel, or bank of, or use material from the streambed of, the following water: Lake Tahoe 2490 W. Lake Blvd Sunnyside, in the County of Placer, State of California, S. 29, T. 15N, R. 16E.

WHEREAS, the Department (represented by Ronald C. Perrault) has made an inspection of subject area on the 15 day of January, 1989, and has determined that such operations may substantially adversely affect existing fish and wildlife resources including: Trout, resident fish, aquatic insects, and their habitat.

THEREFORE, the Department hereby proposes measures to protect fish and wildlife during the operator's work. The operator hereby agrees to accept the following recommendations as part of his work: Numbers 13, 16, 21, 22 from the list of recommendations on the back of this page and the following special recommendations:

- All work in or near the stream or lake shall be confined to the period July 1 thru November 1, 1989.
- No wood products, soil, silt, sand, rubbish, oil or petroleum products are allowed to enter the any surface waters in the Lake Tahoe Basin. Any mechanical equipment operating within the lake will be cleaned and maintained prior to use. All construction waste products will be removed from the project site and dumped at a legal point of disposal. The use of wood preservatives on wood in contact with the lake water is prohibited. Waste shall not cause a pollution or threatened pollution. If necessary a flat bottomed boat will be located under the work area; and a tarp and water skimmer net will be used to prevent debris from falling into the lake.
- Pilings are to be driven within a caisson or turbidity curtain. The disturbance of lake bed materials shall be kept to a minimum during construction. Best practicable control technology shall be used to keep suspended earthen materials out of Lake Tahoe. In addition if necessary a turbidity screen will surround the work site in areas of loose sediment to retain resuspended sediments.
- This agreement shall become an integral part of any bid contract for this pier construction; and the contractor doing the work shall be bound by this agreement and all its requirements. A copy of this permit shall be given to the contractor, and a copy shall be maintained at the work site.
- The contractor shall notify Fish and Game as per recommendation number 22 on the back of this permit at least five days prior to commencement and completion dates. Contact DFG-Perrault by mail P.O. Box 6498, Tahoe City or by telephone.

The operator, as designated by the signature on this agreement, shall be responsible for the execution of all elements of this agreement. A copy of this agreement must be provided to contractors and subcontractors and must be in their possession at the work site.

If the operator's work changes from that stated in the notification specified above, this agreement is no longer valid and a new notification shall be submitted to the Department of Fish and Game. Failure to comply with the provisions of this agreement and with other pertinent Code Sections, including but not limited to Fish and Game Code Sections 5650, 5652 and 5948, may result in prosecution.

Nothing in this agreement authorizes the operator to trespass on any land or property, nor does it relieve the operator of responsibility for compliance with applicable federal, state, or local laws or ordinances.

THIS AGREEMENT IS NOT INTENDED AS AN APPROVAL OF A PROJECT OR OF SPECIFIC PROJECT FEATURES BY THE DEPARTMENT OF FISH AND GAME. INDEPENDENT REVIEW AND RECOMMENDATIONS WILL BE PROVIDED BY THE DEPARTMENT AS APPROPRIATE ON THOSE PROJECTS WHERE LOCAL, STATE, OR FEDERAL PERMITS OR OTHER ENVIRONMENTAL REPORTS ARE REQUIRED.

This agreement becomes effective on July 1 thru November 1, 1989

Operator Gary R. Taylor

Ronald C. Perrault
Department Representative

Title AGENT

Title F & G Warden

Organization _____

Department of Fish and Game, State of California

Date 1/25/89

Date 1-15-89

| | |
|---------------|------------|
| CALENDAR PAGE | <u>241</u> |
| NOTE PAGE | <u>300</u> |

*If inspection was not made, cross out words within parentheses.

THERE ARE NO MINUTE PAGES 2834 AND 2835

MINUTE ITEM

This Calendar Item No. 17
was approved as Minute Item
No. 17 by the State Lands
Commission by a vote of 3
to 0 at its 08/30/89
meeting.

CALENDAR ITEM

- 17

A 7

08/30/89

S 1

PRC 4314

J. Ludlow

APPROVAL OF A RECREATIONAL PIER PERMIT

APPLICANT: Ann Milton Wallis Trust
151 Hazel Lane
Piedmont, California 94611

AREA, TYPE LAND AND LOCATION:
A parcel of submerged land in Lake Tahoe at
Sunnyside, Placer County.

LAND USE: Partial reconstruction of an existing pier,
reconstruction of an existing boathouse, and
continued use and maintenance of two mooring
buoys.

TERMS OF PROPOSED PERMIT:
Initial period: Five-years beginning
August 30, 1989.

CONSIDERATION: Rent-free, pursuant to Section 6503.5 of the
P.R.C.

APPLICANT STATUS:
Applicant is owner of upland.

PREREQUISITE CONDITIONS, FEES AND EXPENSES:
Filing fee and processing costs have been
received.

STATUTORY AND OTHER REFERENCES:
A. P.R.C.: Div. 6, Parts 1 and 2; Div. 13.
B. Cal. Code Regs.: Title 2, Div. 3;
Title 14, Div. 6.

AB 884: 01/13/90.

OTHER PERTINENT INFORMATION:

1. Pursuant to the Commission's delegation of authority and the State CEQA Guidelines (14 Cal. Code Regs. 15025), the staff has prepared a Proposed Negative Declaration identified as EIR ND 468, State Clearinghouse No. 89032013. Such Proposed Negative Declaration was prepared and circulated for public review pursuant to the provisions of CEQA.

Based upon the Initial Study, the Proposed Negative Declaration, and the comments received in response thereto, there is no substantial evidence that the project will have a significant effect on the environment. (14 Cal. Code Regs. 15074(b))

2. In lieu of total reconstruction, the applicant proposes to reconstruct only that portion of the pier waterward of the low water mark (6223' elevation). That portion of the pier located in the shorezone area shall remain as is. It has been found that that portion of the pier within the shorezone area is in a safe and serviceable condition and is not in need of reconstruction at this time.
3. The work, as proposed, will be done from a barge that will be located in the lake. First, the existing sections of the pier to be replaced will be removed, placed on the barge, and hauled away. Once the barge is unloaded, the new materials to construct the new sections of the pier will be placed on the barge and taken to the construction site. The new portion of the pier and boathouse will be constructed entirely from the barge with a crane and a pile driver that are located on the floating platform.
4. Materials will be neither stored or placed, nor will any activity associated with construction, be conducted above the low water line on the subject property. This will prevent any disturbance to what may be considered a Tahoe Yellow Cress (*Rorippa*) habitat.

CALENDAR ITEM NO. 17 (CONT'D)

5. The existing pier, boathouse and mooring buoys are all previously authorized structures.
6. In order to determine the other potential trust uses in the area of the proposed project, the staff contacted representatives of the following agencies: TRPA, Department of Fish and Game, County of Placer, and the Tahoe Conservancy. None of these agencies expressed a concern that the proposed project would have a significant effect on trust uses in the area. The agencies did not identify any trust needs which were not being met by existing facilities in the area. Identified trust uses in this area would include swimming, boating, walking along the beach, and views of the lake.
7. This activity involves lands identified as possessing significant environmental values pursuant to P.R.C. 6370, et seq. Based upon the staff's consultation with the persons nominating such lands and through the CEQA review process, it is the staff's opinion that the project, as proposed, is consistent with its use classification.
8. All permits covering structures in Lake Tahoe will include a condition subsequent that if any structure authorized is found to be in nonconformance with the Tahoe Regional Planning Agency's shorezone ordinance, and if any alterations, repairs, or removal required pursuant to said ordinance are not accomplished within the designated time period, then the permit will be automatically terminated, effective upon notice by the State, and the site shall be cleared pursuant to the terms thereof.

APPROVALS OBTAINED:

Placer County, Tahoe Regional Planning Agency, California Department of Fish and Game, and United States Army Corps of Engineers .

FURTHER APPROVALS REQUIRED:

Lanhattan Regional Water Quality Control Board,
U.S. Army Corps of Engineers.

EXHIBITS:

- A. Site Map.
- B. Location Map.
- C. Placer County Letter of Approval..
- D. Negative Declaration.

IT IS RECOMMENDED THAT THE COMMISSION:

1. CERTIFY THAT A NEGATIVE DECLARATION, EIR ND 468, STATE CLEARINGHOUSE NO. 89032013, WAS PREPARED FOR THIS PROJECT PURSUANT TO THE PROVISIONS OF THE CEQA AND THAT THE COMMISSION HAS REVIEWED AND CONSIDERED THE INFORMATION CONTAINED THEREIN.
2. DETERMINE THAT THE PROJECT, AS APPROVED, WILL NOT HAVE A SIGNIFICANT EFFECT ON THE ENVIRONMENT.
3. AUTHORIZE ISSUANCE TO ANN MILTON WALLIS TRUST OF A FIVE-YEAR RECREATIONAL PIER PERMIT, BEGINNING AUGUST 30, 1989; FOR THE PARTIAL RECONSTRUCTION OF AN EXISTING PIER, RECONSTRUCTION OF AN EXISTING BOATHOUSE, AND THE CONTINUED USE AND MAINTENANCE OF TWO MOORING BUOYS, ON THE LAND DESCRIBED ON EXHIBIT "A" ATTACHED AND BY REFERENCE MADE A PART HEREOF.

EXHIBIT "A"
LAND DESCRIPTION

PRC 4314
Sheet 2 of 2

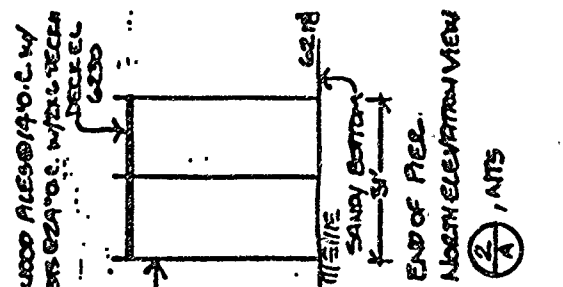
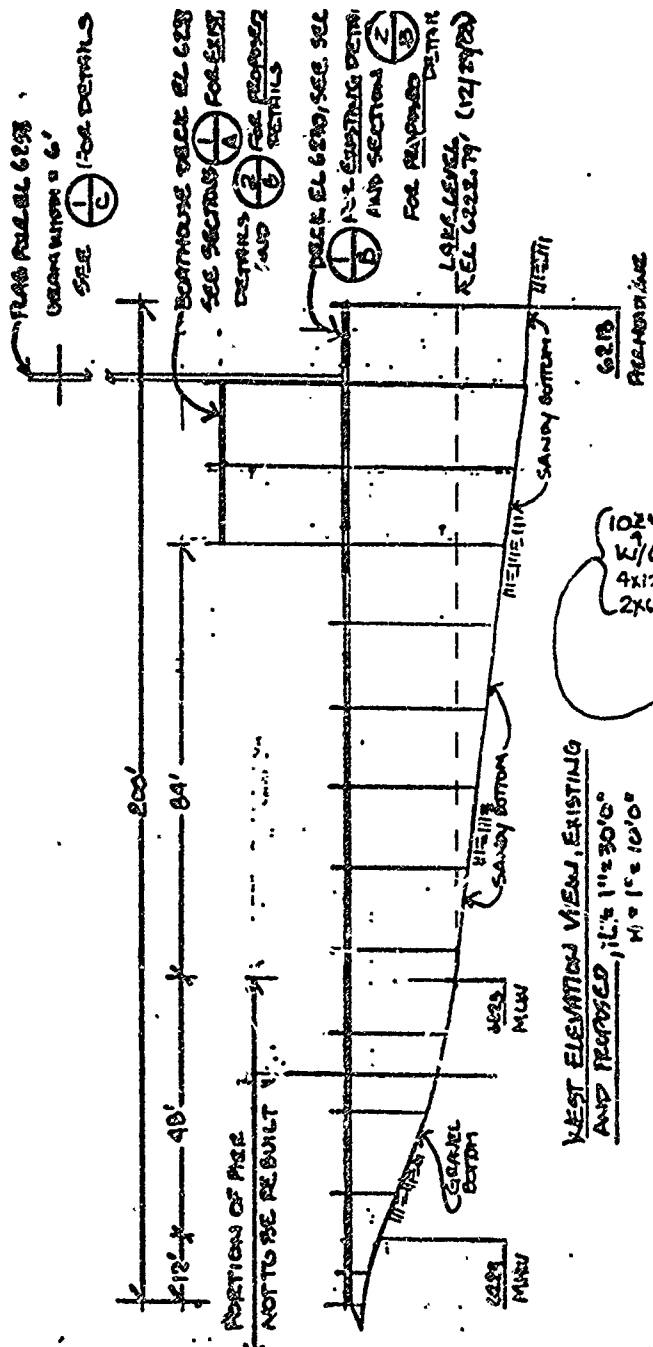

WEST ELEVATION VIEW, EXISTING AND PROPOSED 12' x 30'0" W x 1' x 10'0"

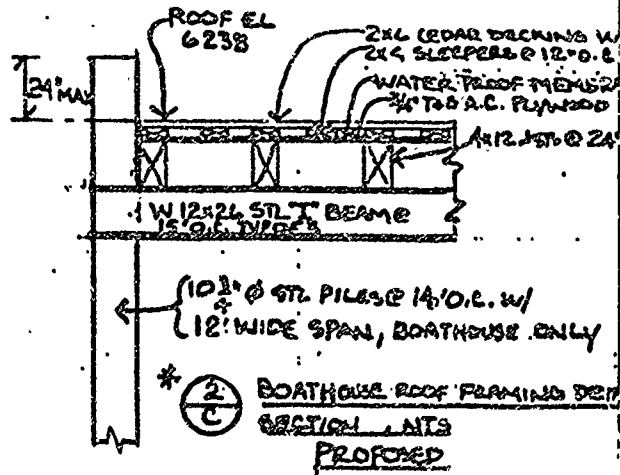
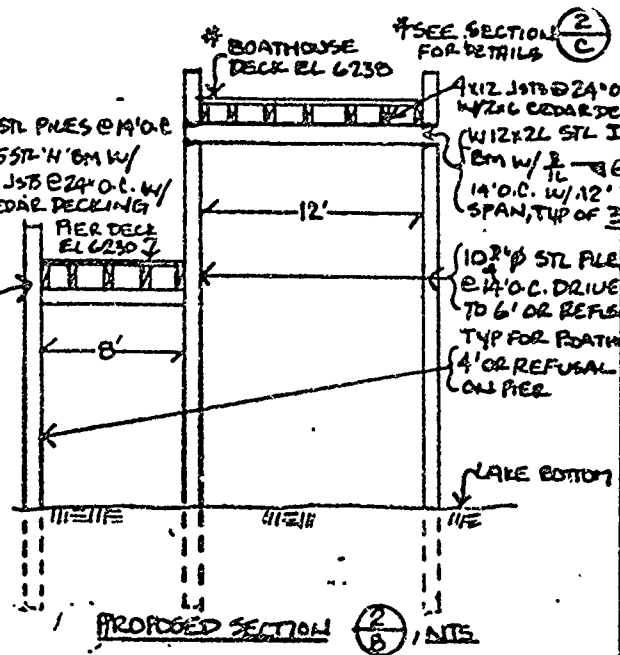

* FOR PLANVIEW DETAILS SEE DETAIL 1, EXISTING PIER PLANVIEW

* BOATHOUSE ROOF FRAMING DETAIL SECTION 2, NITS PROPOSED

| | | |
|--|---|-------------------------------------|
| SCALE: HT: 1" = 10'0" HT: 3/8" = 30'0" | ANN WALLIS PIER REPAIR 2990 WEST LAKE BLVD, SUNNYSIDE, PLACER CO, CA APN 8A-121-03 EXISTING ELEVATION VIEWS, PROPOSED SECTIONS | DRAWN BY: G.T. PAGE 2 OF 2 |
| DATE 12/25/88 | | |

PREPARED JULY 13, 1989 BY BIU 1

CALENDAR PAGE 228
MINUTE PAGE 2810

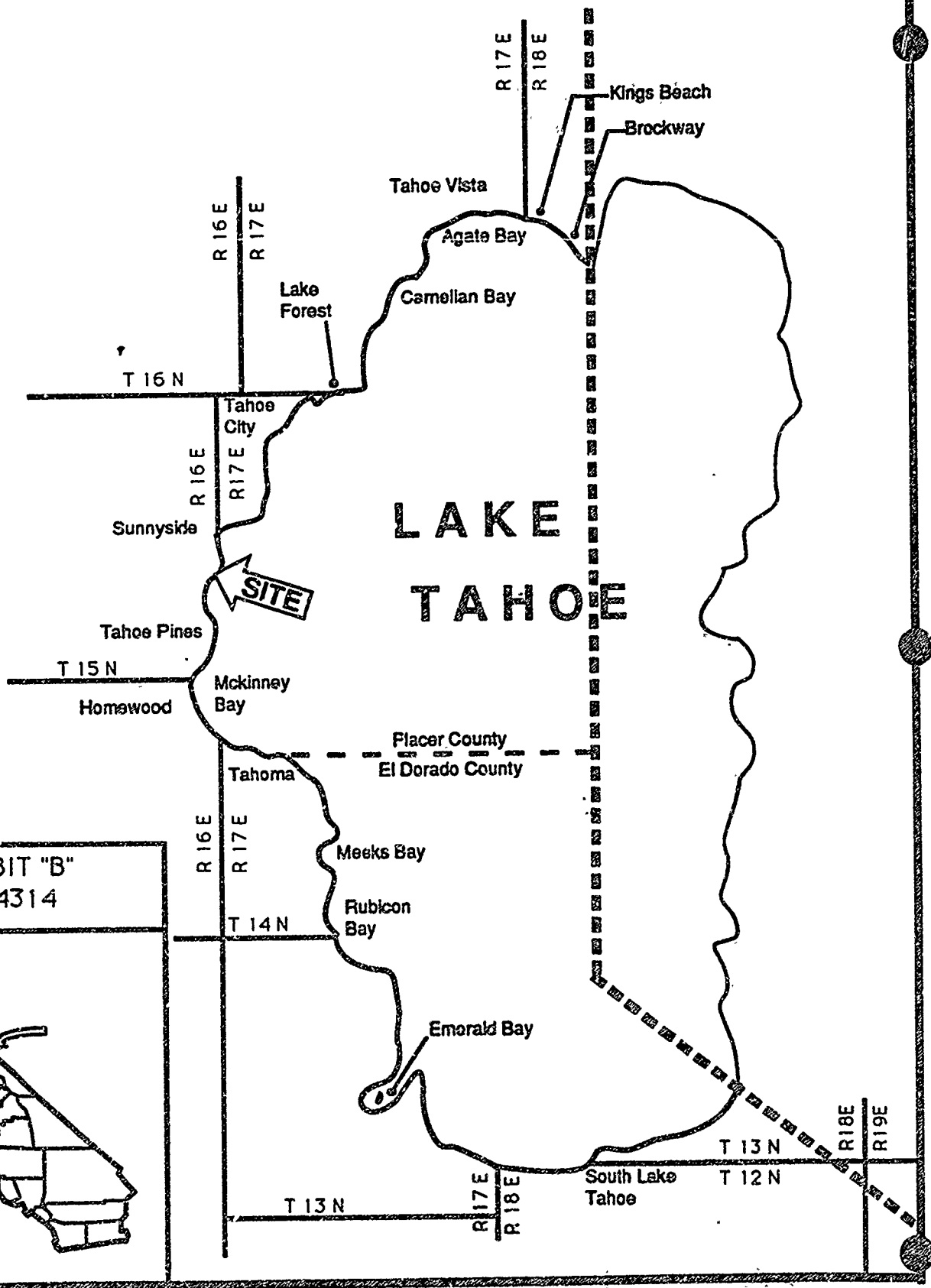

EXHIBIT "B"
PRC 4314





PLACER COUNTY

DEPARTMENT OF PUBLIC WORKS

JACK WARREN, Director
 JAN WITTER, Assistant Director
 LARRY ODDO, Deputy Director
 ALAN ROY, Deputy Director

OPERATING DIVISION.

Administration
 Engineering
 Equipment Maintenance
 Road Maintenance
 Special Districts
 Surveying
 Transportation

March 3, 1989

Judy Ludlow
 California State Lands Commission
 1807 - 13th Street
 Sacramento, CA 95814

RE: PIER - SHOREZONE CONSTRUCTION

The County of Placer has reviewed the below referenced requests for construction activities within the Shorezone of Lake Tahoe. We have no objection to the construction activities described in the below applications contingent upon approval by your office.

| | | |
|-----|-----------------------------|------------|
| 1. | E.S. Bertagnolli | PRC 3209.9 |
| 2. | Charlotte and Robert Angell | W 24144 |
| 3. | Sweet/Avanessian | PRC 5022 |
| 4. | Wickland | PRC 3599 |
| 5. | Lyons/Hawkins | WP 5884 |
| 6. | Mein - 83-162-28 | PRC 6714 |
| 7. | Mein - 83-162-31 | W 24134 |
| 8. | McFarland | PRC 3659 |
| 9. | Gibb | WP 3652 |
| 10. | Crabtree | W 21445 |
| 11. | English | W 1124.38 |
| 12. | Wallis | PRC 4314 |
| 13. | Metas | W 24103 |
| 14. | Barrow | PRC 7167.9 |
| 15. | Nahas | PRC 4066 |
| 16. | Hicks | W 21665 |

Should you have any questions or if I can be of further assistance, please call at your convenience.

COUNTY OF PLACER
 DEPARTMENT OF PUBLIC WORKS
 JACK WARREN, DIRECTOR

James McLeod
 JAMES MCLEOD
 ASSISTANT CIVIL ENGINEER

JH:ms

CALENDAR PAGE
 MINUTE PAGE

230
 2842



PROPOSED NEGATIVE DECLARATION

EIR ND 468

File Ref.: PRC 4314

SCH#: 8903 2013

Project Title: WALLIS PIER REPLACEMENT/RECONSTRUCTION

Project Proponent: Ann Milton Wallis

Project Location: In Lake Tahoe adjacent to 2490 West Lake Blvd., Sunnyside,
Placer County.

Project Description: Reconstruction of an existing pier and boathouse.

Contact Person: TED T. FUKUSHIMA Telephone: (916)322-7813

This document is prepared pursuant to the requirements of the California Environmental Quality Act (Section 21000 et seq., Public Resources Code), the State CEQA Guidelines (Section 15000 et seq., Title 14, California Code Regulations), and the State Lands Commission regulations (Section 2901 et seq., Title 2, California Code Regulations).

Based upon the attached Initial Study, it has been found that:

the project will not have a significant effect on the environment.

mitigation measures included in the project will avoid potentially significant effects.

| | |
|---------------|------|
| CALENDAR PAGE | 231 |
| MINUTE PAGE | 2643 |

PROJECT DESCRIPTION

The proposed project will involve the following:

1. Replacement of all wood piles with 10.75" O steel piles with 6x15 H BH's.
2. Replacement of all old decking and joists with new 4x12 joists at 24" o.c. with 2x6 cedar decking.
3. Replacement of old open pile boat house and roof with new open pile (10.75" O steel piles) boathouse and roof.
4. Replacement of old wood ladders with new ladders.

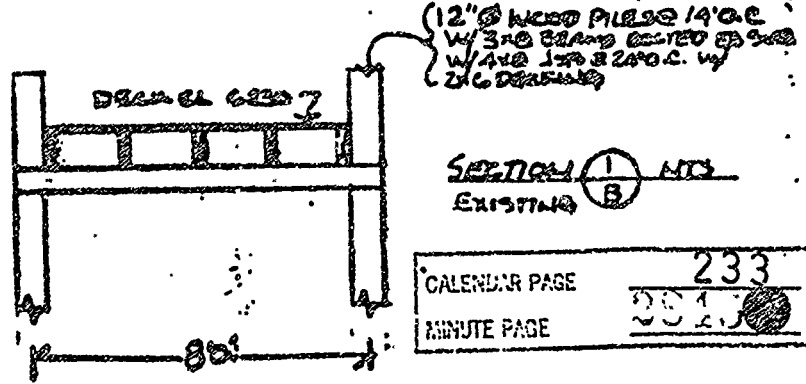
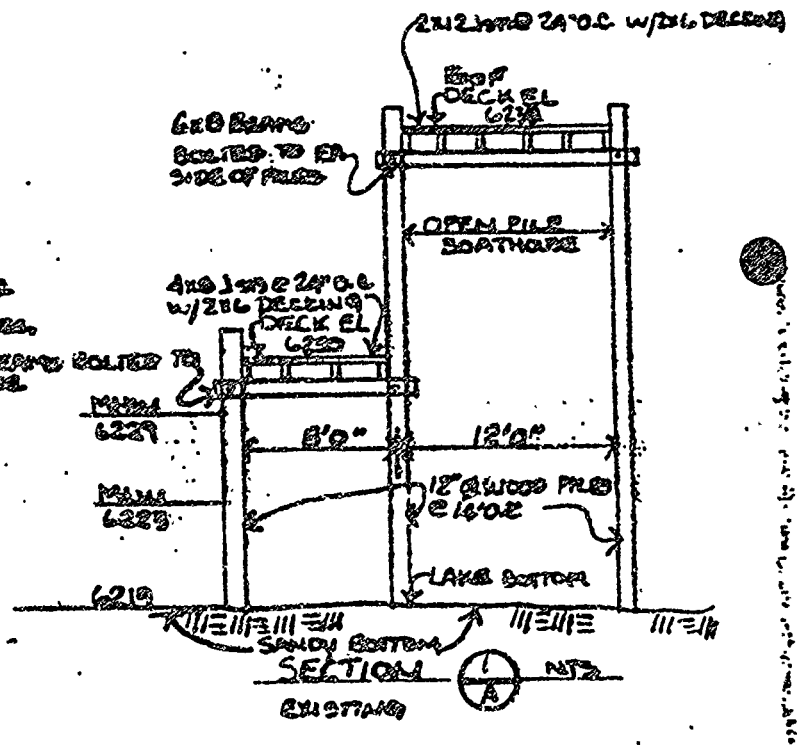
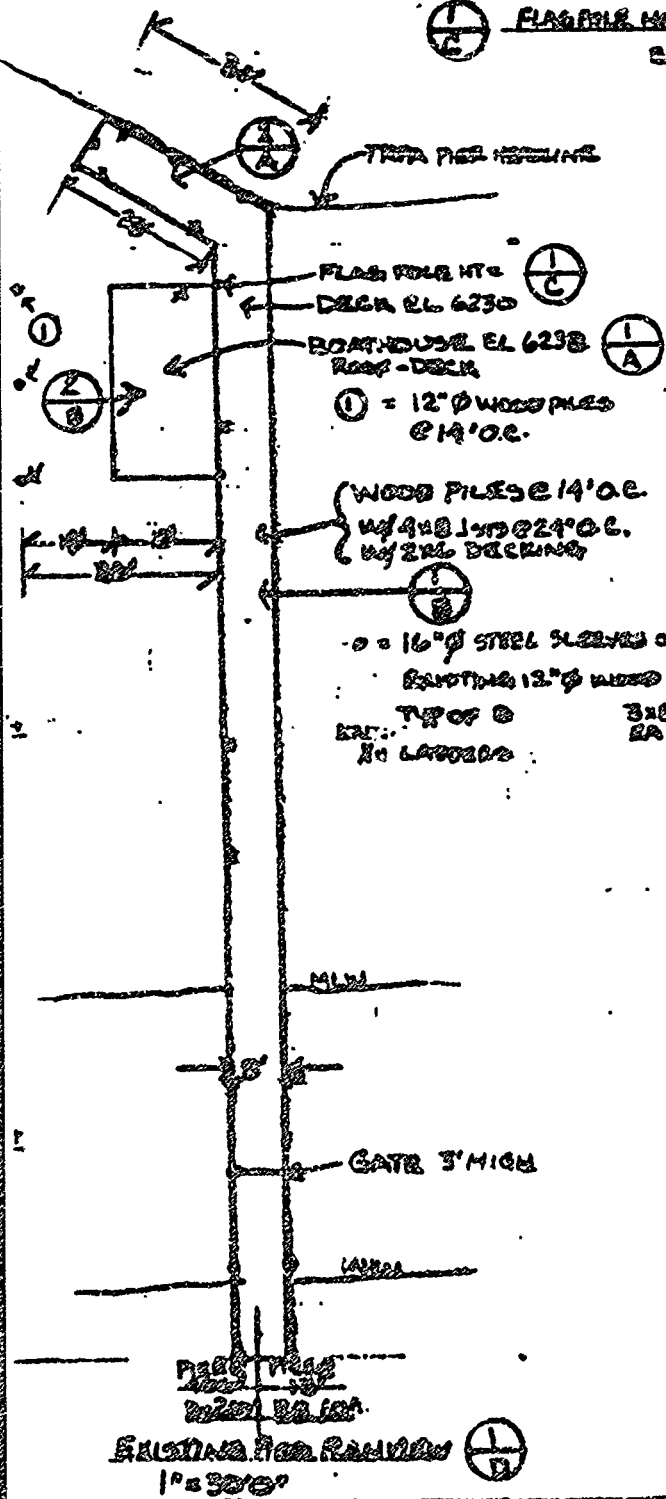
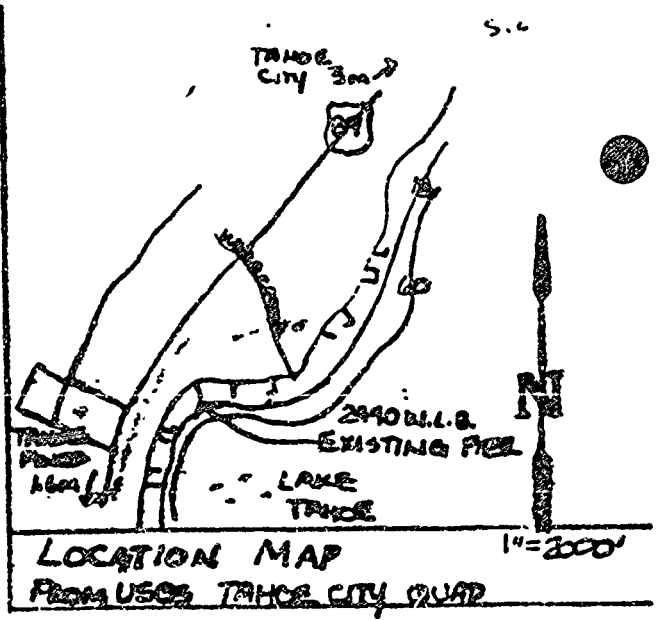
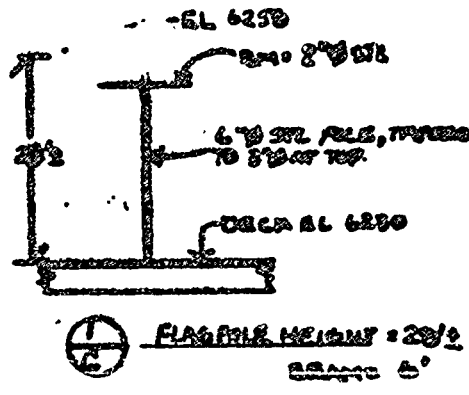

CALENDAR PAGE 233
MINUTE PAGE 231

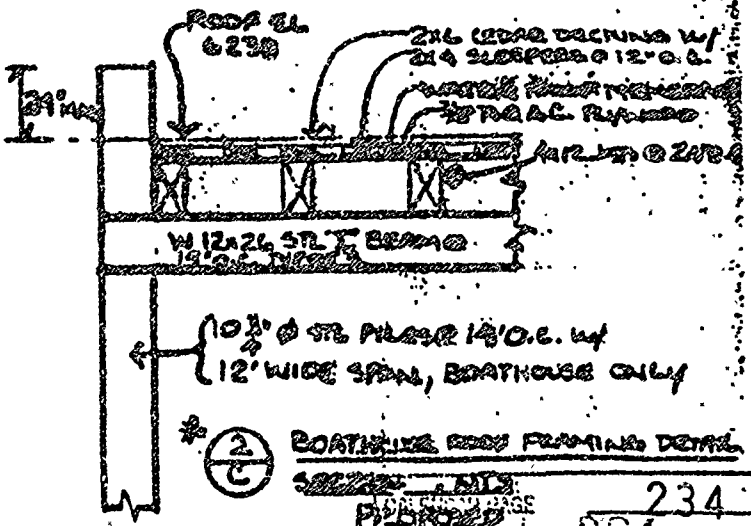
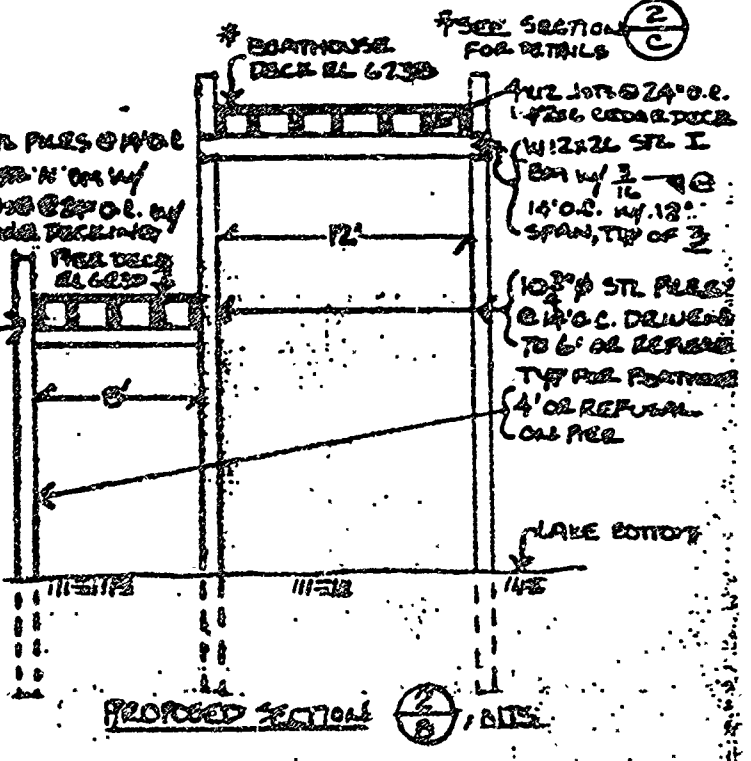
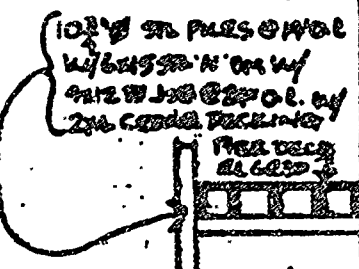
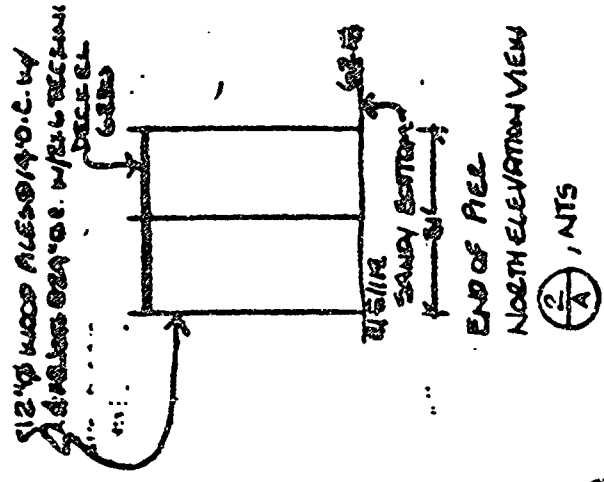
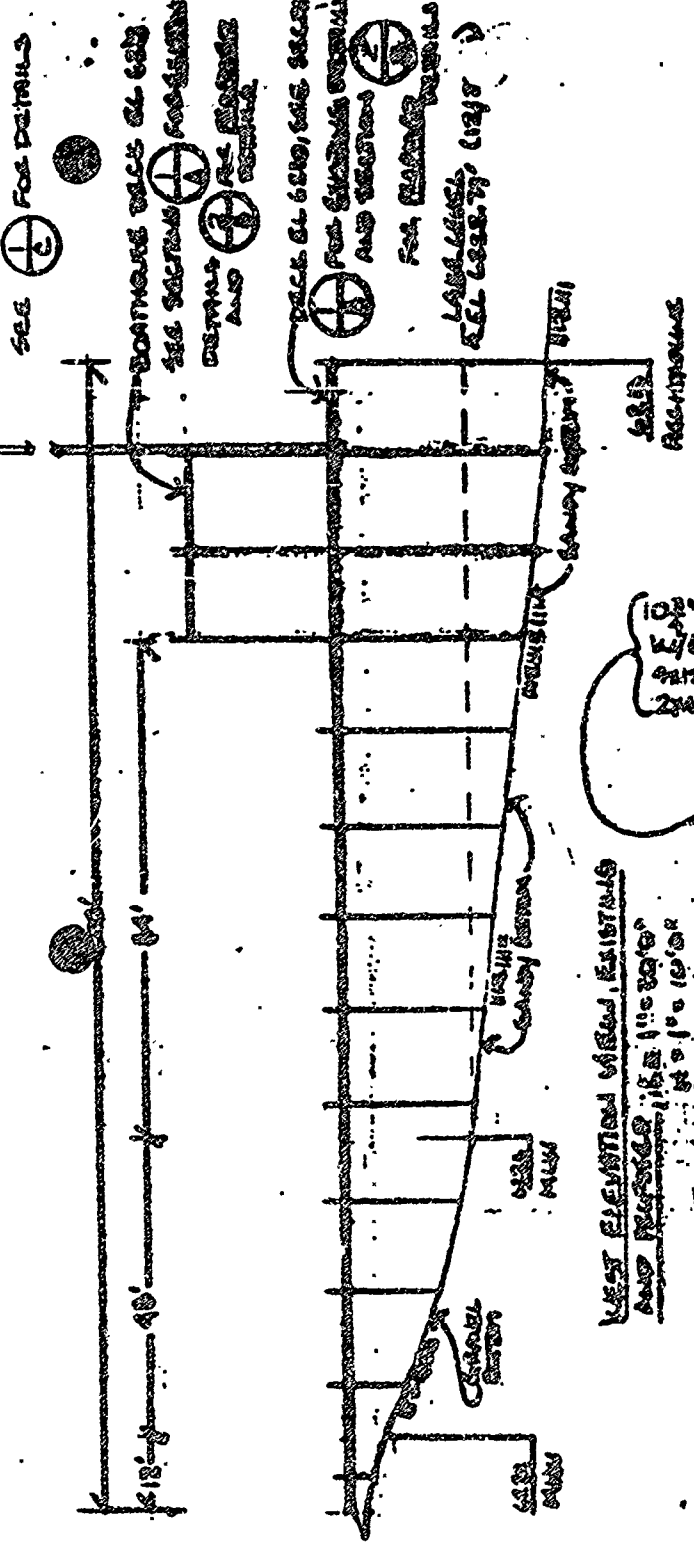

FOR PLANVIEW DETAILS
 SEE SECTION 1, EXISTING
 FOR PLANVIEW

SCALE:
 1/4" = 1'-0"
 1/8" = 3/4'-0"
 DATE: APR 12-11-09

ANN WALKER FIRE REPAIR
 2496 WEST LAKE BLVD, SUNNYSIDE, PALMER CA, CA
 APR 12-11-09

DESIGNED BY
 G.T.
 PAGE

234
 5520
 MINUTE PAGE

ENVIRONMENTAL IMPACT ASSESSMENT FORM - Part I

(To be completed by applicant)

FORM 60.3(11/83)

A. GENERAL INFORMATION

1. Name, address, and telephone number:

a. Applicant

ANN MILTON KILLIS
191 HAZEL LANE
PEDDONT, CA 94611
415 547-5355

b. Contact person if other than applicant:

GARY R. TRAYLOR, CONSULTANT
PO BOX 1715
CRYSTAL BAY, NV 89402
702 1831-8676

2. a. Project location: (Please reference to nearest town or community and include county)

3 MILES SOUTH OF TAYLOR CITY ON HWY 89
2490 WEST LAKE BLVD, SUNNYSIDE, PLACER COUNTY, CA

b. Assessor's parcel number: 84-121-03

3. Existing zoning of project site: R1

4. Existing land use of project site: RECREATIONAL

5. Proposed use of site: SAME AS ABOVE

6. Other permits required: ARMY CORPS OF ENGINEERS, TRPA, LANDMAN,

CALIF DEPT OF FISH AND GAME, PLACER COUNTY DPW

B. PROJECT DESCRIPTION

1. For building construction projects, complete "ATTACHMENT A".

2. For non-building construction projects: Describe fully, the proposed activity, its purpose and intended use, e.g. for proposed mineral prospecting permits, include the number of test holes, size of holes, amount of material to be excavated, maximum surface area of disturbance, hole locations, depth of holes, etc. Attach plans or other drawings as necessary.

CALCULATED PAGE 235
MINUTE PAGE 0017

C. ENVIRONMENTAL SETTING

- 1. Describe the project site as it exists before the project, including information on topography, soil stability, plants and animals, and any cultural, historical, or scenic aspects. Describe any existing structures on the site, and the use of the structures.
- 2. Describe the surrounding properties, including information on plants and animals and any cultural, historical, or scenic aspects. Indicate the type of land use (residential, commercial, etc.), intensity of land use (one-family, apartment houses, shops, department stores, etc.), and scale of development (height, frontage, set-back, rear yard, etc.).

D. ENVIRONMENTAL IMPACT ASSESSMENT

Answer the following questions by placing a check in the appropriate box. Discuss all items checked "yes" or "maybe". (Attach additional sheets as necessary)

| Will the project involve: | YES | MAYBE | NO |
|--|--------------------------|--------------------------|-------------------------------------|
| 1. a change in existing features of any bays, tidelands, beaches, lakes, or hills, or substantial alteration of ground contours? | <input type="checkbox"/> | <input type="checkbox"/> | <input checked="" type="checkbox"/> |
| 2. a change in scenic views or vistas from existing residential areas or public lands or roads? | <input type="checkbox"/> | <input type="checkbox"/> | <input checked="" type="checkbox"/> |
| 3. a change in pattern, scale, or character of the general area of project? | <input type="checkbox"/> | <input type="checkbox"/> | <input checked="" type="checkbox"/> |
| 4. a significant effect on plant or animal life? | <input type="checkbox"/> | <input type="checkbox"/> | <input checked="" type="checkbox"/> |
| 5. significant amounts of solid waste or litter? | <input type="checkbox"/> | <input type="checkbox"/> | <input checked="" type="checkbox"/> |
| 6. a change in dust, ash, smoke, fumes, or odors in the vicinity? | <input type="checkbox"/> | <input type="checkbox"/> | <input checked="" type="checkbox"/> |
| 7. a change in ocean, bay, lake, stream, or ground water quality or quantity, or alteration of existing drainage patterns? | <input type="checkbox"/> | <input type="checkbox"/> | <input checked="" type="checkbox"/> |
| 8. a change in existing noise or vibration levels in the vicinity? | <input type="checkbox"/> | <input type="checkbox"/> | <input checked="" type="checkbox"/> |
| 9. construction on filled land or on slopes of 10 percent or more? | <input type="checkbox"/> | <input type="checkbox"/> | <input checked="" type="checkbox"/> |
| 10. use or disposal of potentially hazardous materials, such as toxic or radioactive substances, flammables, or explosives? | <input type="checkbox"/> | <input type="checkbox"/> | <input checked="" type="checkbox"/> |
| 11. a change in demand for municipal services (police, fire, water, sewage, etc.)? | <input type="checkbox"/> | <input type="checkbox"/> | <input checked="" type="checkbox"/> |
| 12. an increase in fossil fuel consumption (electricity, oil, natural gas, etc.)? | <input type="checkbox"/> | <input type="checkbox"/> | <input checked="" type="checkbox"/> |
| 13. a larger project or a series of projects? | <input type="checkbox"/> | <input type="checkbox"/> | <input checked="" type="checkbox"/> |

E. CERTIFICATION

I hereby certify that the statements furnished above and in the attached exhibits present the data and information required for this initial evaluation to the best of my ability, and that the facts, statements, and information presented are true and correct to the best of my knowledge and belief.

Date: 12-2-88 X Signed: Ann M. Kelly

ENVIRONMENTAL IMPACT ASSESSMENT CHECKLIST - PART II

Form 13.20 (7/82)

File Ref.: PRC 4314

I. BACKGROUND INFORMATION

A. Applicant: Ann Milton Wallis
141 Hazel Lane
Piedmont, CA 94611

B. Checklist Date: 3 / 21 / 89

C. Contact Person: TED T. FUKUSHIMA
Telephone: (916) 322-7813

D. Purpose: To renovate an existing pier and boat house.

E. Location: In Lake Tahoe adjacent to 2490 West Lake Blvd., Sunnyside, Placer County.

F. Description: Replace/reconstruct existing facility with a new structure.

G. Persons Contacted:

II. ENVIRONMENTAL IMPACTS. (Explain all "yes" and "maybe" answers)

A. Excess. Will the proposal result in:

Yes Maybe No

- 1. Unstable earth conditions or changes in geologic substructures?
2. Disruptions, displacements, compaction, or overcovering of the soil?
3. Changes in topography or ground surface relief features?
4. The destruction, covering, or modification of any unique geologic or physical features?
5. Any increase in wind or water erosion of soils, either on or off the site?
6. Changes in deposition or erosion of beach sands, or changes in siltation, deposition or erosion which may modify the channel of a river or stream or the bed of the ocean or any bay, inlet, or lake?
7. Exposure of all people or property to geologic hazards such as earthquakes, landslides, mudflows, ground failure, or similar hazards?

23711
END OF PAGE
DATE

- B. Air.** Will the proposal result in:
- | | Yes | Maybe | No |
|---|--------------------------|--------------------------|-------------------------------------|
| 1. Substantial air emissions or deterioration of ambient air quality? | <input type="checkbox"/> | <input type="checkbox"/> | <input checked="" type="checkbox"/> |
| 2. The creation of objectionable odors? | <input type="checkbox"/> | <input type="checkbox"/> | <input checked="" type="checkbox"/> |
| 3. Alteration of air movement, moisture or temperature, or any change in climate, either locally or regionally? | <input type="checkbox"/> | <input type="checkbox"/> | <input checked="" type="checkbox"/> |
- C. Water.** Will the proposal result in:
- | | | | |
|---|--------------------------|-------------------------------------|-------------------------------------|
| 1. Changes in the currents, or the course or direction of water movements, in either marine or fresh waters? | <input type="checkbox"/> | <input type="checkbox"/> | <input checked="" type="checkbox"/> |
| 2. Changes in absorption rates, drainage patterns, or the rate and amount of surface water runoff? | <input type="checkbox"/> | <input type="checkbox"/> | <input checked="" type="checkbox"/> |
| 3. Alterations to the course or flow of flood waters? | <input type="checkbox"/> | <input type="checkbox"/> | <input checked="" type="checkbox"/> |
| 4. Change in the amount of surface water in any water body? | <input type="checkbox"/> | <input type="checkbox"/> | <input checked="" type="checkbox"/> |
| 5. Discharge into surface waters, or in any alteration of surface water quality, including but not limited to temperature, dissolved oxygen or turbidity? | <input type="checkbox"/> | <input checked="" type="checkbox"/> | <input type="checkbox"/> |
| 6. Alteration of the direction or rate of flow of ground waters? | <input type="checkbox"/> | <input type="checkbox"/> | <input checked="" type="checkbox"/> |
| 7. Change in the quantity of ground waters, either through direct additions or withdrawals, or through interception of an aquifer by cuts or excavations? | <input type="checkbox"/> | <input type="checkbox"/> | <input checked="" type="checkbox"/> |
| 8. Substantial reduction in the amount of water otherwise available for public water supplies? | <input type="checkbox"/> | <input type="checkbox"/> | <input checked="" type="checkbox"/> |
| 9. Exposure of people or property to water-related hazards such as flooding or tidal waves? | <input type="checkbox"/> | <input type="checkbox"/> | <input checked="" type="checkbox"/> |
| 10. Significant changes in the temperature, flow or chemical content of surface thermal springs? | <input type="checkbox"/> | <input type="checkbox"/> | <input checked="" type="checkbox"/> |
- D. Plant Life.** Will the proposal result in:
- | | | | |
|--|--------------------------|--------------------------|-------------------------------------|
| 1. Change in the diversity of species, or number of any species of plants (including trees, shrubs, grass, crops, and aquatic plants)? | <input type="checkbox"/> | <input type="checkbox"/> | <input checked="" type="checkbox"/> |
| 2. Reduction of the numbers of any unique, rare or endangered species of plants? | <input type="checkbox"/> | <input type="checkbox"/> | <input checked="" type="checkbox"/> |
| 3. Introduction of new species of plants into an area, or in a barrier to the normal replenishment of existing species? | <input type="checkbox"/> | <input type="checkbox"/> | <input checked="" type="checkbox"/> |
| 4. Reduction in acreage of any agricultural crop? | <input type="checkbox"/> | <input type="checkbox"/> | <input checked="" type="checkbox"/> |
- E. Animal Life.** Will the proposal result in:
- | | | | |
|--|--------------------------|-------------------------------------|-------------------------------------|
| 1. Change in the diversity of species, or numbers of any species of animals (birds, land animals including reptiles, fish and shellfish, benthic organisms, or insects)? | <input type="checkbox"/> | <input type="checkbox"/> | <input checked="" type="checkbox"/> |
| 2. Reduction of the numbers of any unique, rare or endangered species of animals? | <input type="checkbox"/> | <input type="checkbox"/> | <input checked="" type="checkbox"/> |
| 3. Introduction of new species of animals into an area, or result in a barrier to the migration or movement of animals? | <input type="checkbox"/> | <input type="checkbox"/> | <input checked="" type="checkbox"/> |
| 4. Deterioration to existing fish or wildlife habitat? | <input type="checkbox"/> | <input checked="" type="checkbox"/> | <input type="checkbox"/> |
- F. Noise.** Will the proposal result in:
- | | | | |
|---|--------------------------|-------------------------------------|-------------------------------------|
| 1. Increase in existing noise levels? | <input type="checkbox"/> | <input checked="" type="checkbox"/> | <input type="checkbox"/> |
| 2. Exposure of people to severe noise levels? | <input type="checkbox"/> | <input type="checkbox"/> | <input checked="" type="checkbox"/> |
- G. Light and Glare.** Will the proposal result in:
- | | | | |
|--|--------------------------|--------------------------|-------------------------------------|
| 1. The production of new light or glare? | <input type="checkbox"/> | <input type="checkbox"/> | <input checked="" type="checkbox"/> |
|--|--------------------------|--------------------------|-------------------------------------|
- H. Land Use.** Will the proposal result in:
- | | | | |
|--|--------------------------|--------------------------|-------------------------------------|
| 1. A substantial alteration of the present or planned land use of an area? | <input type="checkbox"/> | <input type="checkbox"/> | <input checked="" type="checkbox"/> |
|--|--------------------------|--------------------------|-------------------------------------|
- I. Natural Resources.** Will the proposal result in:
- | | | | |
|--|--------------------------|--------------------------|-------------------------------------|
| 1. Increase in the rate of use of any natural resources? | <input type="checkbox"/> | <input type="checkbox"/> | <input checked="" type="checkbox"/> |
| 2. Substantial depletion of any nonrenewable resources? | <input type="checkbox"/> | <input type="checkbox"/> | <input checked="" type="checkbox"/> |

J. Risk of Upset. Does the proposal result in:

| | | | |
|---|--------------------------|--------------------------|-------------------------------------|
| | Yes | Maybe | <input checked="" type="radio"/> |
| 1. A risk of an explosion or the release of hazardous substances (including, but not limited to, oil, pesticides, chemicals, or radiation) in the event of an accident or upset conditions? | <input type="checkbox"/> | <input type="checkbox"/> | <input checked="" type="checkbox"/> |
| 2. Possible interference with emergency response plan or an emergency evacuation plan? | <input type="checkbox"/> | <input type="checkbox"/> | <input checked="" type="checkbox"/> |

K. Population. Will the proposal result in:

| | | | |
|---|--------------------------|--------------------------|-------------------------------------|
| 1. The alteration, distribution, density, or growth rate of the human population of the area? | <input type="checkbox"/> | <input type="checkbox"/> | <input checked="" type="checkbox"/> |
|---|--------------------------|--------------------------|-------------------------------------|

L. Housing. Will the proposal result in:

| | | | |
|---|--------------------------|--------------------------|-------------------------------------|
| 1. Affecting existing housing, or create a demand for additional housing? | <input type="checkbox"/> | <input type="checkbox"/> | <input checked="" type="checkbox"/> |
|---|--------------------------|--------------------------|-------------------------------------|

M. Transportation/Circulation. Will the proposal result in:

| | | | |
|---|--------------------------|--------------------------|-------------------------------------|
| 1. Generation of substantial additional vehicular movement? | <input type="checkbox"/> | <input type="checkbox"/> | <input checked="" type="checkbox"/> |
| 2. Affecting existing parking facilities, or create a demand for new parking? | <input type="checkbox"/> | <input type="checkbox"/> | <input checked="" type="checkbox"/> |
| 3. Substantial impact upon existing transportation systems? | <input type="checkbox"/> | <input type="checkbox"/> | <input checked="" type="checkbox"/> |
| 4. Alterations to present patterns of circulation or movement of people and/or goods? | <input type="checkbox"/> | <input type="checkbox"/> | <input checked="" type="checkbox"/> |
| 5. Alterations to waterborne, rail, or air traffic? | <input type="checkbox"/> | <input type="checkbox"/> | <input checked="" type="checkbox"/> |
| 6. Increase in traffic hazards to motor vehicles, bicyclists, or pedestrians? | <input type="checkbox"/> | <input type="checkbox"/> | <input checked="" type="checkbox"/> |

N. Public Services. Will the proposal have an effect upon, or result in a need for new or altered governmental services in any of the following areas:

| | | | |
|---|--------------------------|--------------------------|-------------------------------------|
| 1. Fire protection? | <input type="checkbox"/> | <input type="checkbox"/> | <input checked="" type="checkbox"/> |
| 2. Police protection? | <input type="checkbox"/> | <input type="checkbox"/> | <input checked="" type="checkbox"/> |
| 3. Schools? | <input type="checkbox"/> | <input type="checkbox"/> | <input checked="" type="checkbox"/> |
| 4. Parks and other recreational facilities? | <input type="checkbox"/> | <input type="checkbox"/> | <input checked="" type="checkbox"/> |
| 5. Maintenance of public facilities, including roads? | <input type="checkbox"/> | <input type="checkbox"/> | <input checked="" type="checkbox"/> |
| 6. Other governmental services? | <input type="checkbox"/> | <input type="checkbox"/> | <input checked="" type="checkbox"/> |

O. Energy. Will the proposal result in:

| | | | |
|---|--------------------------|--------------------------|-------------------------------------|
| 1. Use of substantial amounts of fuel or energy? | <input type="checkbox"/> | <input type="checkbox"/> | <input checked="" type="checkbox"/> |
| 2. Substantial increase in demand upon existing sources of energy, or require the development of new sources? | <input type="checkbox"/> | <input type="checkbox"/> | <input checked="" type="checkbox"/> |

P. Utilities. Will the proposal result in a need for new systems, or substantial alterations to the following utilities:

| | | | |
|------------------------------------|--------------------------|--------------------------|-------------------------------------|
| 1. Power or natural gas? | <input type="checkbox"/> | <input type="checkbox"/> | <input checked="" type="checkbox"/> |
| 2. Communication systems? | <input type="checkbox"/> | <input type="checkbox"/> | <input checked="" type="checkbox"/> |
| 3. Water? | <input type="checkbox"/> | <input type="checkbox"/> | <input checked="" type="checkbox"/> |
| 4. Sewer or septic tanks? | <input type="checkbox"/> | <input type="checkbox"/> | <input checked="" type="checkbox"/> |
| 5. Storm water drainage? | <input type="checkbox"/> | <input type="checkbox"/> | <input checked="" type="checkbox"/> |
| 6. Solid waste and disposal? | <input type="checkbox"/> | <input type="checkbox"/> | <input checked="" type="checkbox"/> |

Q. Human Health. Will the proposal result in:

| | | | |
|--|--------------------------|--------------------------|-------------------------------------|
| 1. Creation of any health hazard or potential health hazard (excluding mental health)? | <input type="checkbox"/> | <input type="checkbox"/> | <input checked="" type="checkbox"/> |
| 2. Exposure of people to potential health hazards? | <input type="checkbox"/> | <input type="checkbox"/> | <input checked="" type="checkbox"/> |

R. Aesthetics. Will the proposal result in:

| | | | |
|--|--------------------------|--------------------------|-------------------------------------|
| 1. The obstruction of any scenic vista or view open to the public, or will the proposal result in the creation of an aesthetically offensive site open to public view? | <input type="checkbox"/> | <input type="checkbox"/> | <input checked="" type="checkbox"/> |
|--|--------------------------|--------------------------|-------------------------------------|

S. Recreation. Will the proposal result in:

| | | | |
|---|--------------------------|--------------------------|-------------------------------------|
| 1. An impact upon the quality or quantity of existing recreational opportunities? | <input type="checkbox"/> | <input type="checkbox"/> | <input checked="" type="checkbox"/> |
|---|--------------------------|--------------------------|-------------------------------------|

CALENDAR PAGE 239
 NOTE PAGE 235

T. Cultural Resources.

Yes Maybe No

- 1. Will the proposal result in the alteration of or the destruction of a prehistoric or historic archeological site?
- 2. Will the proposal result in adverse physical or aesthetic effects to a prehistoric or historic building, structure, or object?
- 3. Does the proposal have the potential to cause a physical change which would affect unique ethnic cultural values?
- 4. Will the proposal restrict existing religious or sacred uses within the potential impact area?

U. Mandatory Findings of Significance.

- 1. Does the project have the potential to degrade the quality of the environment, reduce the habitat of a fish or wildlife species, cause a fish or wildlife population to drop below self-sustaining levels, threaten to eliminate a plant or animal community, reduce the number or restrict the range of a rare or endangered plant or animal or eliminate important examples of the major periods of California history or prehistory?
- 2. Does the project have the potential to achieve short term, to the disadvantage of long-term, environmental goals?
- 3. Does the project have impacts which are individually limited, but cumulatively considerable?
- 4. Does the project have environmental effects which will cause substantial adverse effects on human beings, either directly or indirectly?

III. DISCUSSION OF ENVIRONMENTAL EVALUATION (See Comments Attached)

- C5 - There could be a slight rise in the turbidity level during the construction however, compliance with water quality control requirements should reduce this potential impact to a minimum.
- E4 - This project could substantially adversely affect existing fish resources however, compliance with the proposed mitigation measures by the Department of Fish and Game's stream or lake alteration agreement should reduce this potential impact to a minimum.
- F1 - There could be a rise in the ambient noise levels during construction however, this should be of relatively short term duration.

IV. PRELIMINARY DETERMINATION

On the basis of this initial evaluation:

- I find the proposed project COULD NOT have a significant effect on the environment, and a NEGATIVE DECLARATION will be prepared.
- I find that although the proposed project could have a significant effect on the environment, there will not be a significant effect in this case because the mitigation measures described on an attached sheet have been added to the project. A NEGATIVE DECLARATION will be prepared.
- I find the proposed project MAY have a significant effect on the environment, and an ENVIRONMENTAL IMPACT REPORT is required.

Date: 3 / 21 / 89

 CALIFORNIA PAGE 240
 For the State Lands Commission

A permit fee of \$125.00 PAID

Notification No. 11-02-89 THP No. _____

This permit is not valid until payment ^{received}

AGREEMENT REGARDING PROPOSED STREAM OR LAKE ALTERATION

THIS AGREEMENT entered into between the State of California, Department of Fish and Game, hereinafter called the Department, and Mr. Gary Taylor (representing Ann Hilton Wallis) of Crystal Bay, State of Nevada, hereinafter called the operator, is as follows:

WHEREAS, pursuant to Division 2, Chapter 6 of California Fish and Game Code, the operator, on the 16 day July 1989, notified the Department that he intends to substantially divert or obstruct the natural flow of, or substantially change the bed, channel, or bank of, or use material from the streambed of, the following water Lake Tahoe 2490 W. Lake Blvd Sunnyside, in the County of Placer, State of California, S. 24, T. 15N, R. 16E.

WHEREAS, the Department (represented by Ronald C. Ferrault) has made an inspection of subject area on the 15 day of January 1989 and has determined that such operations may substantially adversely affect existing fish and wildlife resources including: trout, resident fish, aquatic insects, and their habitat.

THEREFORE, the Department hereby proposes measures to protect fish and wildlife during the operator's work. The operator hereby agrees to accept the following recommendations as part of his work: Numbers 13, 16, 21, 22 from the list of recommendations on the back of this page and the following special recommendations:

1. All work in or near the stream or lake shall be confined to the period July 1 thru November 1, 1989.
2. No wood products, soil, silt, sand, rubbish, oil or petroleum products are allowed to enter the any surface waters in the Lake Tahoe Basin. Any mechanical equipment operating within the lake will be cleaned and maintained prior to use. All construction waste products will be removed from the project site and dumped at a legal point of disposal. The use of wood preservatives on wood in contact with the lake water is prohibited. Waste shall not cause a pollution or threatened pollution. If necessary a flat bottomed boat will be located under the work areas; and a tarp and water skimmer net will be used to prevent debris from falling into the lake.
3. Piling are to be driven within a caisson or turbidity curtain. The disturbance of lake bed materials shall be kept to a minimum during construction. Best practicable control technology shall be used to keep suspended earthen materials out of Lake Tahoe. In addition if necessary a turbidity screen will surround the work site in areas of loose sediment to retain resuspended sediments.
4. This agreement shall become an integral part of any bid contract for this pier construction; and the contractor doing the work shall be bound by this agreement and all its requirements. A copy of this permit shall be given to the contractor, and a copy shall be maintained at the work site.
5. The contractor shall notify Fish and Game as per recommendation number 22 on the back of this permit at least five days prior to commencement and completion dates. Contact RCF-Ferrault by mail P.O. Box 4498, Tahoe City or by telephone.

The operator, as designated by the signature on this agreement, shall be responsible for the execution of all elements of this agreement. A copy of this agreement must be provided to contractors and subcontractors and must be in their possession at the work site.

If the operator's work changes from that stated in the notification specified above, this agreement is no longer valid and a new notification shall be submitted to the Department of Fish and Game. Failure to comply with the provisions of this agreement and with other pertinent Code Sections, including but not limited to Fish and Game Code Sections 5650, 5652 and 5948, may result in prosecution.

Nothing in this agreement authorizes the operator to trespass on any land or property, nor does it relieve the operator of responsibility for compliance with applicable federal, state, or local laws or ordinances.

THIS AGREEMENT IS NOT INTENDED AS AN APPROVAL OF A PROJECT OR OF SPECIFIC PROJECT FEATURES BY THE DEPARTMENT OF FISH AND GAME. INDEPENDENT REVIEW AND RECOMMENDATIONS WILL BE PROVIDED BY THE DEPARTMENT AS APPROPRIATE ON THOSE PROJECTS WHERE LOCAL, STATE, OR FEDERAL PERMITS OR OTHER ENVIRONMENTAL REPORTS ARE REQUIRED.

This agreement becomes effective on July 1 thru November 1, 1989

Operator Gary B. Taylor

Title AGENT

Organization _____

Date 1/25/89

Ronald C. Ferrault
Department Representative

Title F-G Warden

Department of Fish and Game, State of California

Date 1-15-89

CALENDAR PAGE 241
INDEX PAGE 335

*If inspection was not made, cross out words within parentheses.