

MINUTE ITEM

30

07/10/89  
PRC 3209  
J. Ludlow

APPROVAL OF A RECREATIONAL PIER PERMIT

Calendar Item 30, attached, was pulled from the agenda prior to the meeting.

Attachment: Calendar Item 30.

A 7

S 1

CALENDAR PAGE	2191
MINUTE PAGE	

1989 06 24 08:11:31

CALENDAR ITEM

30

A 7  
S 1

07/10/89  
PRC 3209  
J. Ludlow

APPROVAL OF A RECREATIONAL PIER PERMIT

APPLICANT: E. S. and Geraldine Bertagnolli  
P.O. Box 1400  
Tahoe City, California 95730

AREA, TYPE LAND AND LOCATION: A parcel of submerged land in Lake Tahoe near  
Tahoe City, Placer County.

LAND USE: Reconstruction of an existing pier and  
boathouse and the retention of two previously  
unauthorized mooring buoys.

TERMS OF PROPOSED PERMIT:  
Initial period: Five-years beginning July 12,  
1989.

CONSIDERATION: Rent-free, pursuant to Section 6503.5 of the  
P.R.C.

APPLICANT STATUS: Applicant is owner of upland.

PREREQUISITE CONDITIONS, FEES AND EXPENSES:  
Filing fee and processing costs have been  
received.

CALENDAR PAGE	465
MINUTE PAGE	2192

STATUTORY AND OTHER REFERENCES:

- A. P.R.C.: Div. 6, Parts 1 and 2; Div. 13.
- B. Cal. Code Regs.: Title 2, Div. 3;  
Title 14, Div. 6.

AB 884: 10/02/89.

OTHER PERTINENT INFORMATION:

1. Pursuant to the Commission's delegation of authority and the State CEQA Guidelines (14 Cal. Code Regs. 15025), the staff has prepared a Proposed Negative Declaration identified as EIR ND 475, State Clearinghouse No. 89052204. Such Proposed Negative Declaration was prepared and circulated for public review pursuant to the provisions of CEQA.

Based upon the Initial Study, the Proposed Negative Declaration, and the comments received in response thereto, there is no substantial evidence that the project will have a significant effect on the environment. (14 Cal. Code Regs. 15074(b))

2. The reconstruction of the existing pier and boathouse will be done from a barge with pile driver. All construction wastes will be collected onto the barge and disposed of at the nearest dumpster/sanitary landfill site.
3. Materials will neither stored or placed, nor will any activity associated with the construction, be conducted above the low waterline of the subject property. This will prevent any disturbance to what may be considered a Tahoe Yellow Cress (Rorippa) habitat.

4. In order to determine the other potential trust uses in the area of the proposed project, the staff contacted representatives of the following agencies: Tahoe Regional Planning Agency, Department of Fish and Game, County of Placer, and the Tahoe Conservancy. None of these agencies expressed a concern that the proposed project would have a significant effect on trust uses in the area. The agencies did not identify any trust needs which were not being met by existing facilities in the area. Identified trust uses in this area would include swimming, boating, walking along the beach, and views of the lake.
5. This activity involves lands identified as possessing significant environmental values pursuant to P.R.C. 6370, et seq. Based upon the staff's consultation with the persons nominating such lands and through the CEQA review process, it is the staff's opinion that the project, as proposed, is consistent with its use classification.
6. All permits covering structures in Lake Tahoe will include a condition subsequent that if any structure authorized is found to be in nonconformance with the Tahoe Regional Planning Agency's shorezone ordinance and if any alterations, repairs, or removal required pursuant to said ordinance are not accomplished within the designated time period, then the permit will be automatically terminated, effective upon notice by the State, and the site shall be cleared pursuant to the terms thereof.

APPROVALS OBTAINED:

Placer County, Tahoe Regional Planning Agency, Department of Fish and Game, Lahontan Regional Water Quality Control Board, and United States Army Corps of Engineers (GPO16-003).

FURTHER APPROVALS REQUIRED:

None.

EXHIBITS:

- A. Land Description.
- B. Location Map.
- C. Negative Declaration.
- D. Placer County Letter of Approval.

IT IS RECOMMENDED THAT THE COMMISSION:

1. CERTIFY THAT A NEGATIVE DECLARATION, EIR ND 475, STATE CLEARINGHOUSE NO. 89052204, WAS PREPARED FOR THIS PROJECT PURSUANT TO THE PROVISIONS OF THE CEQA AND THAT THE COMMISSION HAS REVIEWED AND CONSIDERED THE INFORMATION CONTAINED THEREIN.
2. DETERMINE THAT THE PROJECT, AS APPROVED, WILL NOT HAVE A SIGNIFICANT EFFECT ON THE ENVIRONMENT.
3. AUTHORIZE ISSUANCE TO E.S. BERTAGNOLLI AND GERALDINE BERTAGNOLLI OF A FIVE-YEAR RECREATIONAL PIER PERMIT, BEGINNING JULY 12, 1989; IN CONSIDERATION OF THE RECONSTRUCTION OF AN EXISTING PIER AND BOATHOUSE AND THE RETENTION OF TWO PREVIOUSLY UNAUTHORIZED MOORING BUOYS ON THE LAND DESCRIBED ON EXHIBIT "A" ATTACHED AND BY REFERENCE MADE A PART HEREOF.

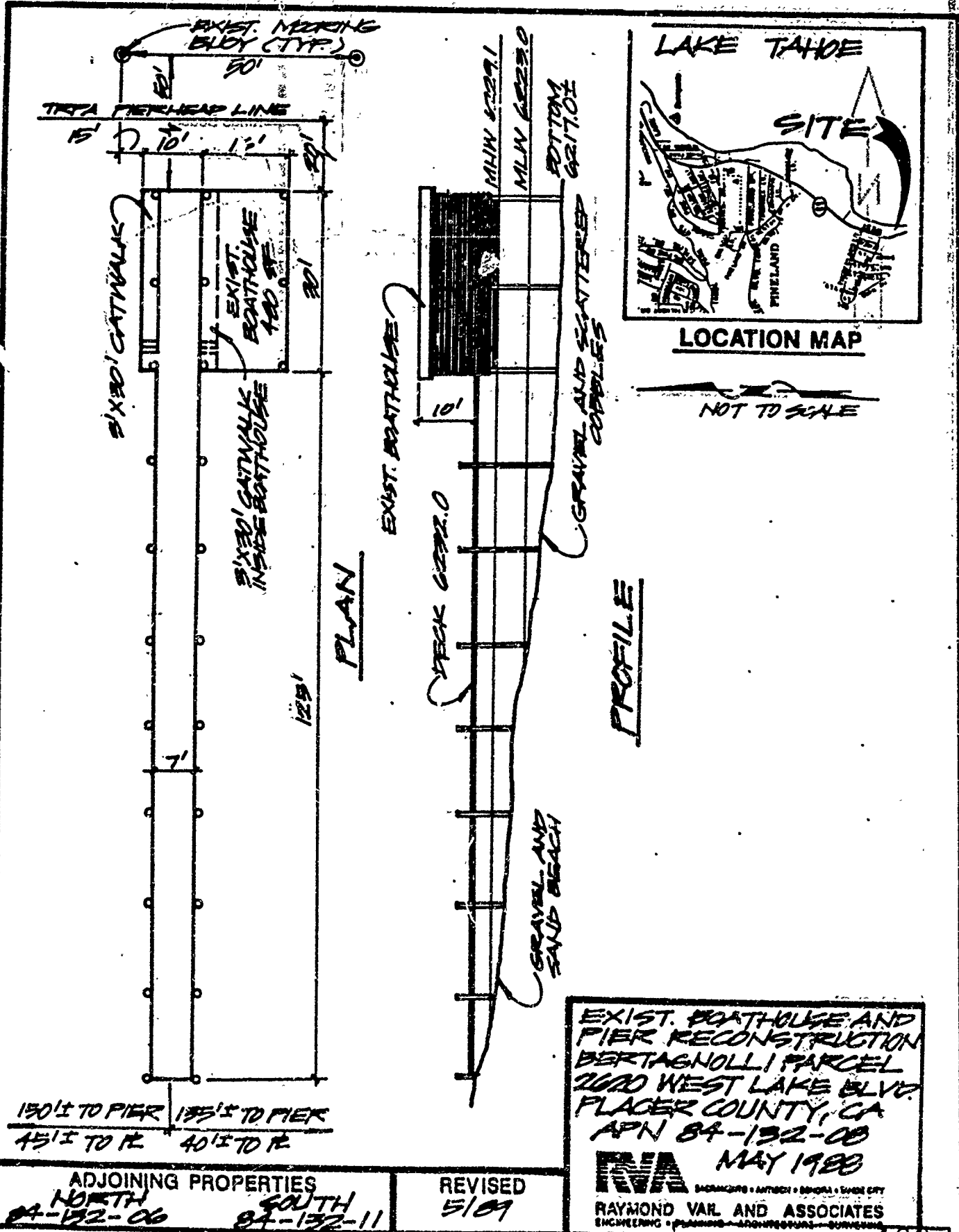

PREPARED JUNE 6, 1989 BY BIU 1.

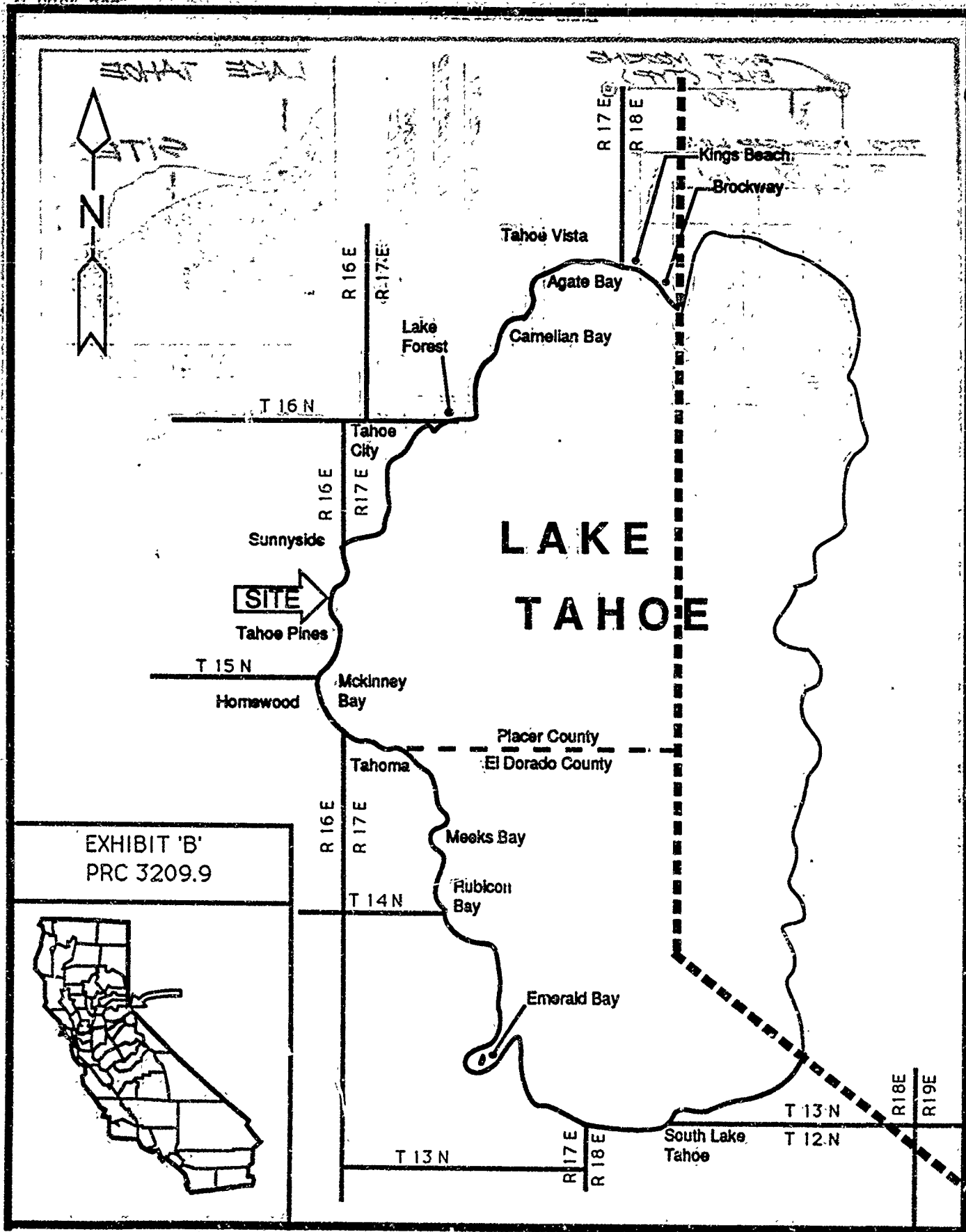

EXHIBIT 'B'  
PRC 3209.9

STATE LANDS COMMISSION  
207 13TH STREET  
SACRAMENTO, CALIFORNIA 95814



PROPOSED NEGATIVE DECLARATION

EIR NO. 475

File Ref.: WP 3209

SCH#:

Project Title: BERTAGNOLLI PIER AND BOATHOUSE RECONSTRUCTION

Project Proponent: Ettore Bertagnolli

Project Location: In Lake Tahoe adjacent to 2620 West Lake Blvd. - McKinney Bay south-westerly of Tahoe City, Placer County.

Project Description: Reconstruction of an existing pier and boathouse and the retention of two existing, unauthorized mooring buoys.

Contact Person: TED T. FUKUSHIMA

Telephone: (916)322-7813

This document is prepared pursuant to the requirements of the California Environmental Quality Act (Section 21000 et seq., Public Resources Code), the State CEQA Guidelines (Section 15000 et seq., Title 14, California Code Regulations), and the State Lands Commission regulations (Section 2901 et seq., Title 2, California Code Regulations).

Based upon the attached Initial Study, it has been found that:

the project will not have a significant effect on the environment.

mitigation measures included in the project will avoid potentially significant effects.

CALENDAR PAGE	471
MINUTE PAGE	2197



EXHIBIT 1  
84025501  
H05520P8

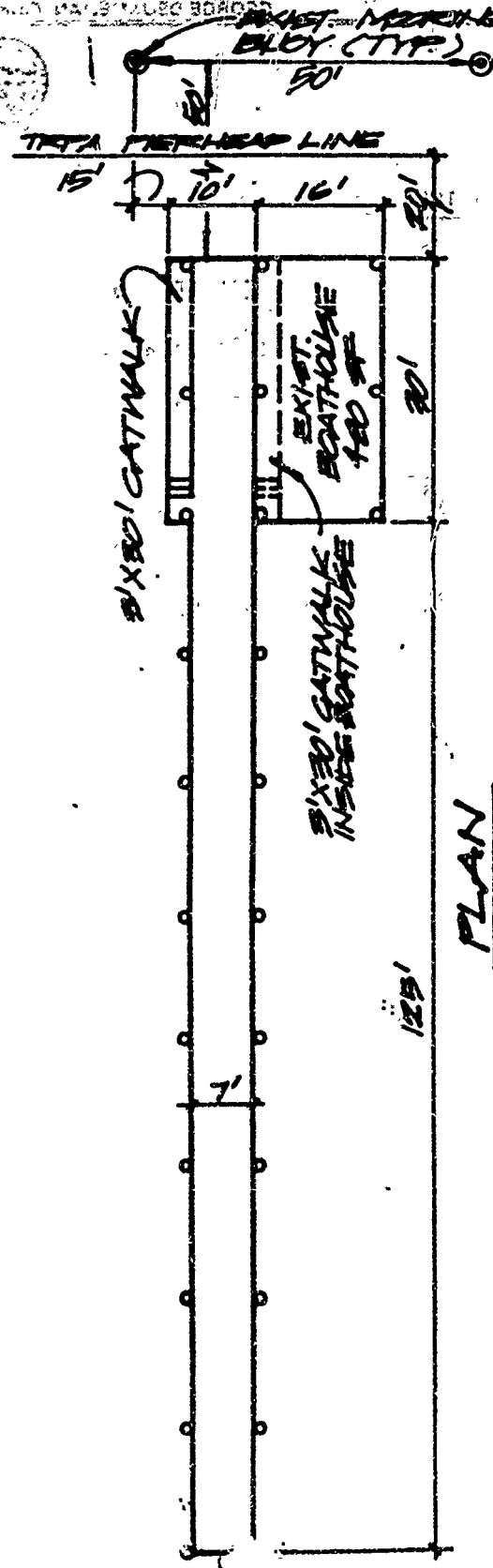

PLAN

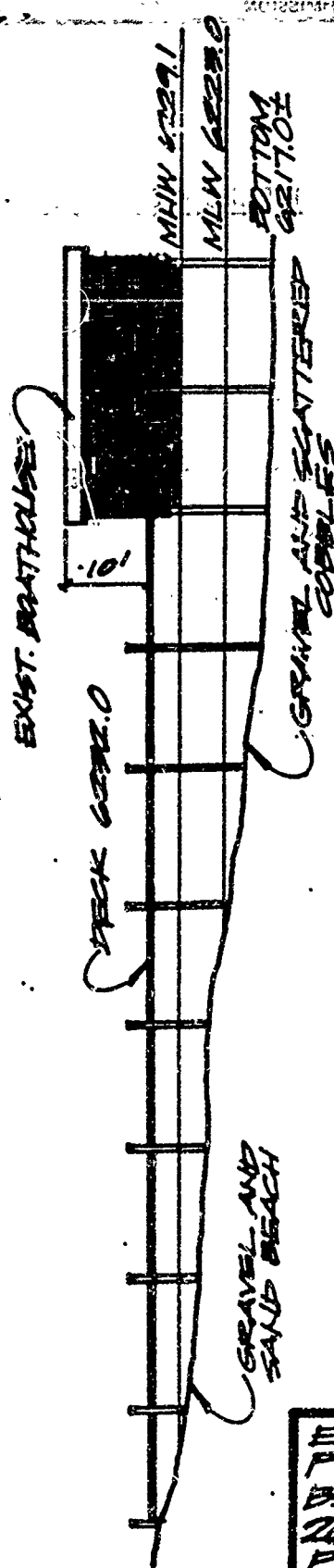

PROFILE

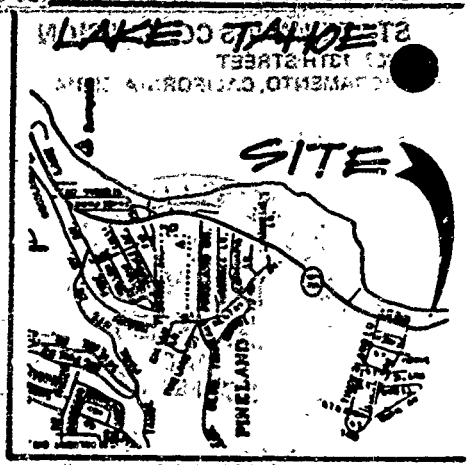

LOCATION MAP

NOT TO SCALE

CALENDAR PAGE	472
MINUTE PAGE	2198

EXIST. BOATHOUSE AND  
PIER RECONSTRUCTION  
BERTAGNOLLI PARCEL  
2600 WEST LAKE BLVD  
PLACER COUNTY, CA  
APN 84-132-08  
MAY 1988

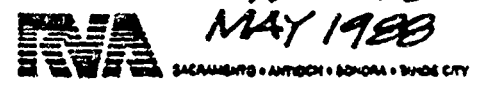

RAYMOND VAIL AND ASSOCIATES  
ENGINEERING • PLANNING • ARCHITECTURE • SURVEYING

ADJOINING PROPERTIES  
NORTH 84-132-06  
SOUTH 84-132-11

REVISED  
5/89

W.O. 7125.31L  
December 28, 1988

RE: PIER BOATHOUSE REPAIR - BERTAGNOLLI PROPERTY  
PLACER COUNTY APN: 84-132-08

PROJECT NARRATIVE

Reconstruction of existing boathouse/pier: to be constructed with 10.75" diameter steel piles at 15' O.C., repair and/or replace existing wood siding and roof. Pier to be constructed with 10.75" diameter steel piles at 15' O.C., 6" steel "H" beams, 4" x 10" wood joists at 24" O.C., 2" x 6" min. cedar deck, 3' x 45' catwalks. Repair and/or replace existing electric service. No change of location, configuration, or increase in size of existing boathouse/pier (see submittal drawing.)

CONSTRUCTION METHOD

Reconstruction of existing boathouse/pier is to be by barge with pile driver; cassion or sleeve will be used when sediment is resuspended while pile driving. Anchorage of barge will be to existing structure and/or anchors required for adequate stabilization of barge on the lake. All construction wastes will be collected onto barge and/or onshore dumpster and disposed at the nearest dumpster/sanitary landfill site. Small boats (John boats) and tarps to be under construction areas to provide collection of construction debris preventing any discharge of wastes to the lake.

CALENDAR PAGE	473
MINUTE PAGE	2199



7

**ENVIRONMENTAL IMPACT ASSESSMENT FORM – Part I**

(To be completed by applicant)

FORM 69.3(11/82)

**A. GENERAL INFORMATION**

**1. Name, address, and telephone number:**

a. Applicant

Ettore Bertagnoli

P.O. Box 1400

Tahoe City, CA 95730

( 916 ) 583-6898

b. Contact person if other than applicant:

Kevin M. Agan - Agent  
Raymond Vail & Associates

P.O. Box 879

Tahoe City, CA 95730

( 916 ) 583-3417

**2. a. Project location: (Please reference to nearest town or community and include county)**

In Lake Tahoe adjacent to 2620 West Lake Blvd.

McKinney Bay southwesterly of Tahoe City, Placer County

b. Assessor's parcel number: 84-132-08

3. Existing zoning of project site: \_\_\_\_\_

4. Existing land use of project site: Pier and boathouse with two mooring buoys

5. Proposed use of site: Reconstruction of pier and boathouse

6. Other permits required: Tahoe Regional Planning Agency, Placer County

**B. PROJECT DESCRIPTION**

1. For building construction projects, complete "ATTACHMENT A".

2. For non-building construction projects: Describe fully, the proposed activity, its purpose and intended use, e.g. for proposed mineral prospecting permits, include the number of test holes, size of holes, amount of material to be excavated, maximum surface area of disturbance, hole locations, depth of holes, etc. Attach plans or other drawings as necessary.

C. ENVIRONMENTAL SETTING

- 1. Describe the project site as it exists before the project, including information on topography, soil stability, plants and animals, and any cultural, historical, or scenic aspects. Describe any existing structures on the site, and the use of the structures.
- 2. Describe the surrounding properties, including information on plants and animals and any cultural, historical, or scenic aspects. Indicate the type of land use (residential, commercial, etc.), intensity of land use (one-family, apartment houses, shops, department stores, etc.), and scale of development (height, frontage, set-back, rear yard, etc.).

D. ENVIRONMENTAL IMPACT ASSESSMENT

Answer the following questions by placing a check in the appropriate box. Discuss all items checked "yes" or "maybe". (Attach additional sheets as necessary)

Will the project involve:	YES	MAYBE	NO
1. a change in existing features of any bays, tidelands, beaches, lakes, or hills, or substantial alteration of ground contours? .....	<input type="checkbox"/>	<input type="checkbox"/>	<input checked="" type="checkbox"/>
2. a change in scenic views or vistas from existing residential areas or public lands or roads? .....	<input type="checkbox"/>	<input type="checkbox"/>	<input checked="" type="checkbox"/>
3. a change in pattern, scale, or character of the general area of project? .....	<input type="checkbox"/>	<input type="checkbox"/>	<input checked="" type="checkbox"/>
4. a significant effect on plant or animal life? .....	<input type="checkbox"/>	<input type="checkbox"/>	<input checked="" type="checkbox"/>
5. significant amounts of solid waste or litter? .....	<input type="checkbox"/>	<input type="checkbox"/>	<input checked="" type="checkbox"/>
6. a change in dust, ash, smoke, fumes, or odors in the vicinity? .....	<input type="checkbox"/>	<input type="checkbox"/>	<input checked="" type="checkbox"/>
7. a change in ocean, bay, lake, stream, or ground water quality or quantity, or alteration of existing drainage patterns? .....	<input type="checkbox"/>	<input type="checkbox"/>	<input checked="" type="checkbox"/>
8. a change in existing noise or vibration levels in the vicinity? .....	<input type="checkbox"/>	<input type="checkbox"/>	<input checked="" type="checkbox"/>
9. construction on filled land or on slope of 10 percent or more? .....	<input type="checkbox"/>	<input type="checkbox"/>	<input checked="" type="checkbox"/>
10. use or disposal of potentially hazardous materials, such as toxic or radioactive substances, flammables, or explosives? .....	<input type="checkbox"/>	<input type="checkbox"/>	<input checked="" type="checkbox"/>
11. a change in demand for municipal services (police, fire, water, sewage, etc.)? .....	<input type="checkbox"/>	<input type="checkbox"/>	<input checked="" type="checkbox"/>
12. an increase in fossil fuel consumption (electricity, oil, natural gas, etc.)? .....	<input type="checkbox"/>	<input type="checkbox"/>	<input checked="" type="checkbox"/>
13. a larger project or a series of projects? .....	<input type="checkbox"/>	<input type="checkbox"/>	<input checked="" type="checkbox"/>

E. CERTIFICATION

I hereby certify that the statements furnished above and in the attached exhibits present the data and information required for this initial evaluation to the best of my ability, and that the facts, statements, and information presented are true and correct to the best of my knowledge and belief.

Date: \_\_\_\_\_

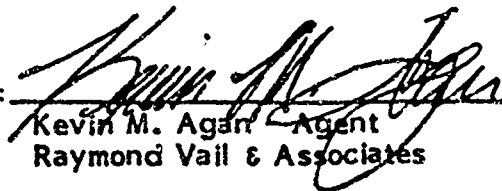
Signed:   
 Kevin M. Agan - Agent  
 Raymond Vail & Associates

ENVIRONMENTAL IMPACT ASSESSMENT CHECKLIST - PART II

Form 13-20 (7/82)

File Ref.: WP 3209

I. BACKGROUND INFORMATION

A. Applicant: Ettore Bertagnoli
P.O. Box 1400
Tahoe City, CA 95730

B. Checklist Date: 5 / 18 / 89

C. Contact Person: TED T. FUKUSHIMA
Telephone: ( 916 ) 322-7813

D. Purpose: A permit for the reconstruction and the continued and maintenance of a existing pier and boathouse and to place under permit, two existing unauthorized mooring buoys

E. Location: In Lake Tahoe adjacent to 2620 West Lake Blvd. - McKinney Bay southwesterly of Tahoe City, Placer County.

F. Description: Reconstruction of an existing pier and boathouse and the retention of two existing, unauthorized mooring buoys.

G. Persons Contacted:

II. ENVIRONMENTAL IMPACTS. (Explain all "yes" and "maybe" answers)

A. Earth. Will the proposal result in:

- 1. Unstable earth conditions or changes in geologic substructures?
2. Disruptions, displacements, compaction, or overcovering of the soil?
3. Change in topography or ground surface relief features?
4. The destruction, covering, or modification of any unique geologic or physical features?
5. Any increase in wind or water erosion of soils, either on or off the site?
6. Changes in deposition or erosion of beach sands, or changes in siltation, deposition or erosion which may modify the channel of a river or stream or the bed of the ocean or any bay, inlet, or lake?
7. Exposure of all people or property to geologic hazards such as earthquakes, landslides, ground failure, or similar hazards?

4767
2202

B. Air. Will the proposal result in:

- |   | Yes                      | Maybe                    | No                                  |
|---|--------------------------|--------------------------|-------------------------------------|
| 1. Substantial air emissions or deterioration of ambient air quality? . . . . .   | <input type="checkbox"/> | <input type="checkbox"/> | <input checked="" type="checkbox"/> |
| 2. The creation of objectionable odors? . . . . .   | <input type="checkbox"/> | <input type="checkbox"/> | <input checked="" type="checkbox"/> |
| 3. Alteration of air movement, moisture or temperature, or any change in climate, either locally or regionally? . . . . . | <input type="checkbox"/> | <input type="checkbox"/> | <input checked="" type="checkbox"/> |

C. Water. Will the proposal result in:

- |   |                                     |                                     |                                     |
|---|-------------------------------------|-------------------------------------|-------------------------------------|
| 1. Changes in the currents, or the course or direction of water movements, in either marine or fresh waters? . . . . .  | <input type="checkbox"/>            | <input type="checkbox"/>            | <input checked="" type="checkbox"/> |
| 2. Changes in absorption rates, drainage patterns, or the rate and amount of surface water runoff? . . . . .  | <input checked="" type="checkbox"/> | <input type="checkbox"/>            | <input checked="" type="checkbox"/> |
| 3. Alterations to the course or flow of flood waters? . . . . .   | <input checked="" type="checkbox"/> | <input type="checkbox"/>            | <input checked="" type="checkbox"/> |
| 4. Change in the amount of surface water in any water body? . . . . .   | <input type="checkbox"/>            | <input type="checkbox"/>            | <input checked="" type="checkbox"/> |
| 5. Discharge into surface waters, or in any alteration of surface water quality, including but not limited to temperature, dissolved oxygen or turbidity? . . . . . | <input type="checkbox"/>            | <input checked="" type="checkbox"/> | <input type="checkbox"/>            |
| 6. Alteration of the direction or rate of flow of ground waters? . . . . .  | <input type="checkbox"/>            | <input type="checkbox"/>            | <input checked="" type="checkbox"/> |
| 7. Change in the quantity of ground waters, either through direct additions or withdrawals, or through interception of an aquifer by cuts or excavations? . . . . . | <input type="checkbox"/>            | <input type="checkbox"/>            | <input checked="" type="checkbox"/> |
| 8. Substantial reduction in the amount of water otherwise available for public water supplies? . . . . .  | <input type="checkbox"/>            | <input type="checkbox"/>            | <input checked="" type="checkbox"/> |
| 9. Exposure of people or property to water-related hazards such as flooding or tidal waves? . . . . .   | <input type="checkbox"/>            | <input type="checkbox"/>            | <input checked="" type="checkbox"/> |
| 10. Significant changes in the temperature, flow or chemical content of surface thermal springs? . . . . .  | <input type="checkbox"/>            | <input type="checkbox"/>            | <input checked="" type="checkbox"/> |

D. Plant Life. Will the proposal result in:

- |  |                          |                          |                                     |
|--|--------------------------|--------------------------|-------------------------------------|
| 1. Change in the diversity of species, or number of any species of plants (including trees, shrubs, grass, crops, and aquatic plants)? . . . . . | <input type="checkbox"/> | <input type="checkbox"/> | <input checked="" type="checkbox"/> |
| 2. Reduction of the numbers of any unique, rare or endangered species of plants? . . . . .   | <input type="checkbox"/> | <input type="checkbox"/> | <input checked="" type="checkbox"/> |
| 3. Introduction of new species of plants into an area, or in a barrier to the normal replenishment of existing species? . . . . .                | <input type="checkbox"/> | <input type="checkbox"/> | <input checked="" type="checkbox"/> |
| 4. Reduction in acreage of any agricultural crop? . . . . .  | <input type="checkbox"/> | <input type="checkbox"/> | <input checked="" type="checkbox"/> |

E. Animal Life. Will the proposal result in:

- |  |                          |                          |                                     |
|--|--------------------------|--------------------------|-------------------------------------|
| 1. Change in the diversity of species, or numbers of any species of animals (birds, land animals including reptiles, fish and shellfish, benthic organisms, or insects)? . . . . . | <input type="checkbox"/> | <input type="checkbox"/> | <input checked="" type="checkbox"/> |
| 2. Reduction of the numbers of any unique, rare or endangered species of animals? . . . . .  | <input type="checkbox"/> | <input type="checkbox"/> | <input checked="" type="checkbox"/> |
| 3. Introduction of new species of animals into an area, or result in a barrier to the migration or movement of animals? . . . . .  | <input type="checkbox"/> | <input type="checkbox"/> | <input checked="" type="checkbox"/> |
| 4. Deterioration to existing fish or wildlife habits? . . . . .  | <input type="checkbox"/> | <input type="checkbox"/> | <input checked="" type="checkbox"/> |

F. Noise. Will the proposal result in:

- |   |                          |                                     |                                     |
|---|--------------------------|-------------------------------------|-------------------------------------|
| 1. Increase in existing noise level? . . . . .          | <input type="checkbox"/> | <input checked="" type="checkbox"/> | <input type="checkbox"/>            |
| 2. Exposure of people to severe noise levels? . . . . . | <input type="checkbox"/> | <input type="checkbox"/>            | <input checked="" type="checkbox"/> |

G. Light and Glare. Will the proposal result in:

- |  |                          |                          |                                     |
|--|--------------------------|--------------------------|-------------------------------------|
| 1. The production of new light or glare? . . . . . | <input type="checkbox"/> | <input type="checkbox"/> | <input checked="" type="checkbox"/> |
|--|--------------------------|--------------------------|-------------------------------------|

H. Land Use. Will the proposal result in:

- |  |                          |                          |                                     |
|--|--------------------------|--------------------------|-------------------------------------|
| 1. A substantial alteration of the present or planned land use of an area? . . . . . | <input type="checkbox"/> | <input type="checkbox"/> | <input checked="" type="checkbox"/> |
|--|--------------------------|--------------------------|-------------------------------------|

I. Natural Resources. Will the proposal result in:

- |  |                          |                          |                                     |
|--|--------------------------|--------------------------|-------------------------------------|
| 1. Increase in the rate of use of any natural resources? . . . . . | <input type="checkbox"/> | <input type="checkbox"/> | <input checked="" type="checkbox"/> |
| 2. Substantial depletion of any nonrenewable resources? . . . . .  | <input type="checkbox"/> | <input type="checkbox"/> | <input checked="" type="checkbox"/> |

J. Risk of Upset. Does the proposal result in:

Yes Maybe No

- 1. A risk of an explosion or the release of hazardous substances (including, but not limited to, oil, pesticides, chemicals, or radiation) in the event of an accident or upset conditions?
- 2. Possible interference with emergency response plan or an emergency evacuation plan?

K. Population. Will the proposal result in:

- 1. The alteration, distribution, density, or growth rate of the human population of the area?

L. Housing. Will the proposal result in:

- 1. Affecting existing housing, or create a demand for additional housing?

M. Transportation/Circulation. Will the proposal result in:

- 1. Generation of substantial additional vehicular movement?
- 2. Affecting existing parking facilities, or create a demand for new parking?
- 3. Substantial impact upon existing transportation systems?
- 4. Alterations to present patterns of circulation or movement of people and/or goods?
- 5. Alterations to waterborne, rail, or air traffic?
- 6. Increase in traffic hazards to motor vehicles, bicyclists, or pedestrians?

N. Public Services. Will the proposal have an effect upon, or result in a need for new or altered governmental services in any of the following areas:

- 1. Fire protection?
- 2. Police protection?
- 3. Schools?
- 4. Parks and other recreational facilities?
- 5. Maintenance of public facilities, including roads?
- 6. Other governmental services?

O. Energy. Will the proposal result in:

- 1. Use of substantial amounts of fuel or energy?
- 2. Substantial increase in demand upon existing sources of energy, or require the development of new sources?

P. Utilities. Will the proposal result in a need for new systems, or substantial alterations to the following utilities:

- 1. Power or natural gas?
- 2. Communication systems?
- 3. Water?
- 4. Sewer or septic tanks?
- 5. Storm water drainage?
- 6. Solid waste and disposal?

Q. Human Health. Will the proposal result in:

- 1. Creation of any health hazard or potential health hazard (excluding mental health)?
- 2. Exposure of people to potential health hazards?

R. Aesthetics. Will the proposal result in:

- 1. The obstruction of any scenic vista or view open to the public, or will the proposal result in the creation of an aesthetically offensive site open to public view?

S. Recreation. Will the proposal result in:

- 1. An impact upon the quality or quantity of existing recreational opportunities?

T. Cultural Resources

Yes Maybe No

- 1. Will the proposal result in the alteration of or the destruction of a prehistoric or historic archeological site?
- 2. Will the proposal result in adverse physical or aesthetic effects to a prehistoric or historic building structure, or object?
- 3. Does the proposal have the potential to cause a physical change which would affect unique ethnic cultural values?
- 4. Will the proposal restrict existing religious or sacred uses within the potential impact area?

U. Mandatory Findings of Significance

- 1. Does the project have the potential to degrade the quality of the environment, reduce the habitat of a fish or wildlife species, cause a fish or wildlife population to drop below self-sustaining levels, threaten to eliminate a plant or animal community, reduce the number or restrict the range of a rare or endangered plant or animal or eliminate important examples of the major periods of California history or prehistory?
- 2. Does the project have the potential to achieve short-term, to the disadvantage of long-term, environmental goals?
- 3. Does the project have impacts which are individually limited, but cumulatively considerable?
- 4. Does the project have environmental effects which will cause substantial adverse effects on human beings, either directly or indirectly?

III. DISCUSSION OF ENVIRONMENTAL EVALUATION (See Comments Attached)

- C5 - There could be a slight rise in the turbidity level during the construction however, compliance with water quality control requirements should this impact to a minimum.
- F1 - There could be a rise in the ambient noise levels during construction however, this should be of relatively short term duration.

IV. PRELIMINARY DETERMINATION

On the basis of this initial evaluation:

- I find the proposed project COULD NOT have a significant effect on the environment, and a NEGATIVE DECLARATION will be prepared.
- I find that although the proposed project could have a significant effect on the environment, there will not be a significant effect in this case because the mitigation measures described on an attached sheet have been added to the project. A NEGATIVE DECLARATION will be prepared.
- I find the proposed project MAY have a significant effect on the environment, and an ENVIRONMENTAL IMPACT REPORT is required.

Date: 5 / 18 / 89

*Spencer Lukashina*  
 For the State Lands Commission  
 2205  
 MINUTE PAGE



03/22/89

16:24

STATE LANDS SALES

802

EXHIBIT "D"



**PLACER COUNTY**

**DEPARTMENT OF PUBLIC WORKS**

JACK WARREN, Director  
JAN WITTER, Assistant Director  
LARRY ODDO, Deputy Director  
ALAN ROY, Deputy Director

RVA - TAHOE

MAR 22 1989

RECEIVED

March 3, 1989

OPERATING DIVISIONS:  
Administration  
Engineering  
Equipment Maintenance  
Road Maintenance  
Special Services  
Surveying  
Transportation

Judy Ludlow  
California State Lands Commission  
1807 - 13th Street  
Sacramento, CA 95814

RE: PIER - SHOREZONE CONSTRUCTION

The County of Placer has reviewed the below referenced requests for construction activities within the Shorezone of Lake Tahoe. We have no objection to the construction activities described in the below applications contingent upon approval by your office.

- |     |                             |            |
|-----|-----------------------------|------------|
| 1.  | R.S. Bertagnoli             | PRC 3209.9 |
| 2.  | Charlotte and Robert Angell | W 24144    |
| 3.  | Sweet/Avanessian            | PRC 5022   |
| 4.  | Wickland                    | PRC 3599   |
| 5.  | Lyons/Hawkins               | WP 5884    |
| 6.  | Main - 83-162-28            | PRC 6714   |
| 7.  | Main - 83-162-31            | W 24134    |
| 8.  | McFarland                   | PRC 3659   |
| 9.  | Gibb                        | WP 3652    |
| 10. | Crabtree                    | W 21445    |
| 11. | English                     | W 1124.38  |
| 12. | Wallis                      | PRC 4314   |
| 13. | Metas                       | W 24103    |
| 14. | Barrow                      | PRC 7167.9 |
| 15. | Mahas                       | PRC 4066   |
| 16. | Hicks                       | W 21665    |

Should you have any questions or if I can be of further assistance, please call at your convenience.

COUNTY OF PLACER  
DEPARTMENT OF PUBLIC WORKS  
JACK WARREN, DIRECTOR

*James McLeod*  
JAMES MCLEOD  
ASSISTANT CIVIL ENGINEER

JH:ms

CALENDAR PAGE  
MINUTE PAGE

480  
2206