

**MINUTE ITEM:**  
This Calendar Item No. C10  
was approved as Minute Item  
No. 19 by the State Lands  
Commission by a vote of 3  
to 0 at its 7/10/89  
meeting.

CALENDAR ITEM

**C10**

A 32

S 15

07/10/89  
PRC 6194  
S. Jones

APPROVAL OF MANAGEMENT PLAN AND AUTHORIZATION FOR THE  
CALIFORNIA DEPARTMENT OF FORESTRY AND FIRE PROTECTION  
TO PROCEED WITH THE FOREST DEMONSTRATION PROJECT ON THE  
THE MEADOW LAKES STATE SCHOOL LAND PARCEL IN FRESNO COUNTY

APPLICANT: California Department of Forestry  
and Fire Protection  
1416 9th Street  
Sacramento, California 95814

LAND USE: Forest Demonstration Project.

BACKGROUND INFORMATION:

The interagency agreement, under which certain school lands are managed by the California Department of Forestry and Fire Protection (CDF), requires submittal of management plans for Commission approval and authorization to proceed with projects on specific parcels.

The specific activities planned on the Meadow Lakes parcel include: boundary surveying, brush clearing with the use of herbicides and mechanical methods, tree planting, timber harvesting, precommercial thinning, fencing, and development of water sources for wildlife.

Staff has reviewed the management plan and concluded that it is in keeping with the objectives sought in the interagency agreement.

BASIS FOR CONSIDERATION:  
Pursuant to 2 Cal. Code Regs. 2003.

MINUTE  
178  
1823

CALENDAR ITEM NO. 61 (CONT'D)

STATUTORY AND OTHER REFERENCES:

- A. P.R.C.: Div. 6, Parts 1 and 2; Div. 13.
- B. Cal. Code Regs.: Title 2, Div. 3;  
Title 14, Div. 6.

AB 884:

N/A.

OTHER PERTINENT INFORMATION:

1. A Third Supplement to Environmental Impact Report (SCH #88080821) was prepared and adopted for this project by the Lead Agency specified by law, the California Department of Forestry and Fire Protection (CDF).
2. Comments were received on the supplement during the review period from the California Department of Fish and Game (DFG) and the Fresno County Air Pollution Control District.
3. Mitigation measures identified in the supplement and made a condition of the approval of the project by the California Department of Forestry and Fire Protection include:
  1. Vegetation control, by use of herbicides, within timber stands will retain an early-successional brush component and will be conducted only after a field review and approval by the DFG.
  2. Vegetative cover on steep slopes and for 50 feet on both sides of drainages will remain undisturbed.
  3. Timber harvesting will be conducted under the Forest Practice Act using selective harvest of over-mature and high-risk trees and thinning of dense timber stands.

CALENDAR PAGE	178
MINUTE PAGE	1823

CALENDAR ITEM NO. C10 (CONT'D)

4. A joint CDF/DFG vegetation treatment project will be developed on the parcel's rocky brushlands.
5. With DFG input, hardwoods, dead/down logs and snags will be managed to improve wildlife habitat.
6. Brush fuel loads will be reduced to minimize fire danger to State lands and adjacent ownership.
7. An archaeological survey will be made prior to any ground disturbing activities.
8. Fresno County Air Pollution Control District burn permits will be acquired prior to any wildland vegetation burning.

EXHIBITS:

- A. Land Description.
- B. Location Map.
- C. EIR Supplement.
- D. Management Plan.

IT IS RECOMMENDED THAT THE COMMISSION:

1. FIND THAT A SUPPLEMENT TO AN EIR WAS PREPARED AND CERTIFIED FOR THIS PROJECT BY THE CALIFORNIA DEPARTMENT OF FORESTRY AND FIRE PROTECTION AND THAT THE COMMISSION HAS REVIEWED AND CONSIDERED THE INFORMATION CONTAINED THEREIN.
2. DETERMINE THAT THE PROJECT, AS MODIFIED, WILL NOT HAVE A SIGNIFICANT ADVERSE EFFECT ON THE ENVIRONMENT.
3. AUTHORIZE THE CALIFORNIA DEPARTMENT OF FORESTRY AND FIRE PROTECTION TO PROCEED WITH IMPLEMENTATION OF THE MANAGEMENT PLAN SUBMITTED FOR THE MEADOW LAKES PARCEL AS CONDITIONED HEREIN.

COMMISSIONERS OF THE LAND COMMISSION

**EXHIBIT "A"**

**PRC 6194.2**

**LAND DESCRIPTION**

**Those state - owned school lands in the vicinity of Shaver Lake, Fresno County, California, described as follows:**

**The SE 1/4 NE 1/4, NW 1/4 NE 1/4, E 1/2 SE 1/4, E 1/2 SW 1/4 of Section 36, T 9 N, R 23 E, MDM.**

**END OF DESCRIPTION**

**PREPARED MAY 31, 1989 BY BIU 1.**

CALENDAR PAGE	180
MINUTE PAGE	1825

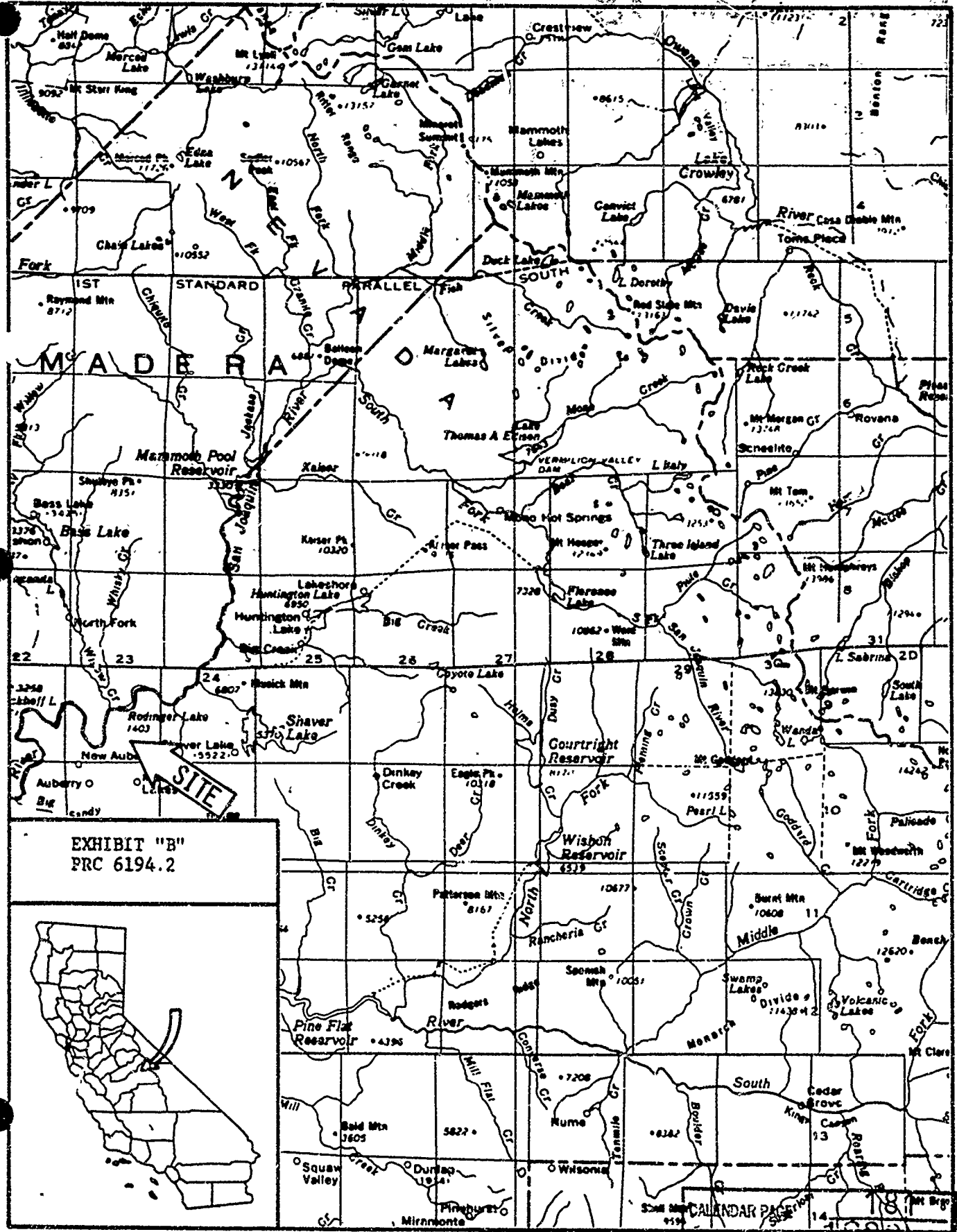

EXHIBIT "B"  
 PRC 6194.2



SOME MAPS CALNDAR PAGE 14  
 MINUTE PAGE 2500

Memorandum

EXHIBIT C

To: Mr. James F. Trout  
Assistant Executive Officer  
State Lands Commission  
1807 - 13th Street  
Sacramento, CA 95814

Telephone: ATSS ( 8 ) 492-0169  
(916 ) 322-0169

From : Department of Forestry and Fire Protection

Subject: 4100 STATE FORESTS  
Contract Land Management  
State Lands Commission  
Meadow Lakes Parcel

*John  
in action*

Attached is a Final EIR Supplement, covering Department of Forestry and Fire Protection management of the Meadow Lakes School Lands Parcel in Fresno County. Our management plan for this parcel was submitted to you on April 11, 1988. Now that the EIR has been completed, your approval of the management plan is requested.

*Kenneth L. Delfino*  
Kenneth L. Delfino  
Deputy Director for  
Resource Management

rm

Attachment

cc: Norm Cook, Region IV

NOTICE OF DETERMINATION

TO:  Office of Planning  
and Research  
1400 Tenth Street  
Sacramento, CA 95814

FROM: California Dept. of Forestry  
and Fire Protection  
1416 Ninth Street  
P. O. Box 944246  
Sacramento, CA 94244-2460

County Clerk  
County of Fresno  
1100 Van Ness  
4th Floor, Room 401  
Fresno, CA 93721

May 10, 1989

SUBJECT: Filing of Notice of Determination in compliance with  
Section 21108 or 21152 of the Public Resources Code

PROJECT TITLE: Management of State Lands Commission Parcels by the  
California Department of Forestry and Fire Protection

STATE CLEARINGHOUSE NUMBER: Original SCH #81082617  
New SCH #88080821

CONTACT PERSON: Clifford E. Fago TELEPHONE NO. (916) 322-0169

PROJECT LOCATION: Section 36, T9S, R23E, MDB&M; near Auberry in Fresno County

PROJECT DESCRIPTION: Under agreement with the State Lands Commission, the California  
Department of Forestry and Fire Protection will manage forest resources on the Meadow  
Lakes State School Lands Parcel (in addition to the 16 parcels discussed in the  
original EIR and two previous Supplements) for experimentation, demonstration, and  
timber production.

This is to advise that the California Department of Forestry and Fire  
Protection has approved the above described project and has made the  
following determinations regarding the above described project:

- (1) The project  will,  will not, have a significant effect on the environment.
- (2)  An Environmental Impact Report was prepared for this project pursuant to the provisions of CEQA. A copy is attached for the appropriate planning agency.  
 A Negative Declaration was prepared for this project pursuant to the provisions of CEQA. A copy of the Negative Declaration is available at the California Department of Forestry and Fire Protection address above.
- (3) Mitigation measures  were,  were not, made a condition of the approval of the project, and are included in the original EIR on pages 11-14 and in the third Supplement on pages 6-7; also in the 4-17-89 DE&G letter.
- (4) A Statement of Overriding Considerations  was,  was not, adopted for this project.

Date received for filing:

  
Signature

Director  
Title

CALENDAR PAGE	183
MINUTE PAGE	1828

UNCLASSIFIED//FOR OFFICIAL USE ONLY  
SACRAMENTO, CALIFORNIA  
SACRAMENTO, CALIFORNIA  
SACRAMENTO, CALIFORNIA

**FINAL**  
~~Draft~~

**Third Supplement to Environmental Impact Report**

for

**Management of State Lands Commission Parcels  
(Meadow Lakes Parcel)**

by

**California Department of Forestry and Fire Protection**

PROJECT LOCATION: Section 30, T9S, R3E, NE1/4, near Auburn in Fresno County

SCH #81082617(old)

SCH #88080821 (new)

State of California  
Department of Forestry and Fire Protection  
1416 Ninth Street  
P. O. Box 944246  
Sacramento, CA 94244-2460

July 1988  
April 1989



MINUTE

TABLE OF CONTENTS

Comments received on the Draft EIR Supplement

Department of Fish and Game / Nokes / 4-17-89	iii
Department of Fish and Game / Bontadelli / 9-15-88	v
Fresno County Air Pollution Control District / Bearden / 10-13-88	vii
Response to comments received on Draft EIR Supplement:	viii
Department of Forestry and Fire Protection / Dulitz / 1-13-89	ix
Notice of Completion	xi
Draft Third Supplement to EIR	1-12

CALENDAR PAGE	185
MINUTE PAGE	1830

## Memorandum

To : Clifford Fago  
Project Coordinator  
Dept. of Forestry and Fire Protection  
P.O. Box 944246  
Sacramento, CA 94244-2460

Date : April 17, 1989

Comments received on the draft management plan

From : Department of Fish and Game, Region 4  
Department of Forestry and Fire Protection  
Subject : Draft Management Plan for Meadow Lakes State Lands Parcel

Response to comments received on draft management plan

Department of Forestry and Fire Protection  
We recently had the opportunity to meet with Dave Dulitz, CDFFP Forest Manager, and discuss the future management of the 240 acre Meadow Lakes State Lands Parcel. During that meeting, we agreed that CDFFP treatment of this state parcel will be done in such a manner that timber production will be well balanced with wildlife management needs. We agreed that the following specific points will need to be incorporated in the project plans when they are developed:

- 1) Any required herbicide or mechanical control of competing vegetation within timber stands will be conducted in a way that will retain an early-successional brush component (the appropriate level to be determined after field review).
- 2) All existing vegetation would remain undisturbed along a minimum 50-foot buffer on both sides of the parcel's intermittent/ephemeral water courses (the need for a buffer >50' can be assessed during the field inspection).
- 3) Timber harvesting would be restricted to: (a) selective harvest, primarily of over-mature and high risk trees, or (b) pre-commercial thinning of dense timber stands. Either of these methods could benefit early-successional wildlife by stimulating brush growth in stand openings.
- 4) An attempt will be made to develop a joint DFG/CDFFP vegetation treatment project on the site's rocky brushlands for wildlife habitat improvement.
- 5) Hardwoods, dead/down logs, and snags will be managed such that wildlife resources on the parcel are maintained or improved. Specific management goals for these key wildlife habitat components will be developed after field review.

m u b n o t o m e M

6) A DFG Biologist would have the opportunity and reasonable prior notice to accompany CDFP staff during on-the-ground planning activities. Specific details regarding wildlife improvement measures could be worked out at that time.

We believe that if all of the above measures are agreed upon by your Department and incorporated into the Meadow Lakes Management Plan, CEQA compliance will be achieved. During the field inspection and planning phase of the project, our wildlife biologist contact will be Mary Boland. She can be reached at our Region 4 office, 1234 East Shaw Avenue, Fresno 93710 or phone (8) 421-5415.

If you have any questions regarding these comments, please contact Rod Goss at our Region 4 office.

*George D. Nokes*  
 George D. Nokes  
 Regional Manager

CALENDAR PAGE	187
MINUTE PAGE	1832

## Memorandum

To : 1. Project Coordinator  
Resources Agency

Date : September 15, 1988

2. Mr. Clifford E. Fago  
California Department of Forestry  
and Fire Protection  
1416 Ninth Street  
Sacramento, CA 95814

From : Department of Fish and Game

Subject: SCH 88080821, Draft Third Supplement to Environmental Impact Report (EIR) for Management of State Lands Commission Parcels (Meadow Lakes Parcel), Fresno County

We have reviewed the Draft Third Supplement to the EIR for Management of State Lands Commission parcels which provides management direction for 240 acres of wildlife habitat (primarily conifers, oaks, and associate shrubs) located east of Auberry, Fresno County.

Wildlife resources include deer, gray squirrels, quail, hummingbirds, (Anna's, black chinned, etc.) rufous-sided towhees, Cooper's hawks, etc. The area may also provide wintering areas for spotted owls. While there are no fisheries resources on the state lands, the ephemeral drainages do contribute significant water to downstream ponds located on U.S. Forest Service lands which support a unique and valuable fisheries resource.

We believe the Draft Supplement to the EIR does not provide adequate information to determine the impacts to fish, wildlife and botanical resources that will result from intensive management of these lands. In the absence of such a plan, we believe the Draft Supplement to the EIR is inadequate and requires significant revisions to comply with the California Environmental Quality Act (CEQA). The following should be included in the document to bring it into conformance with CEQA:

1. Site specific analysis of the beneficial and adverse impacts that will result to fish, wildlife and botanical resources from the implementation of the proposed action.
2. Specific mitigation measures designed to mitigate adverse impacts to fish, wildlife and botanical resources.
3. Evaluation of alternatives to the proposed action (site specific), including an environmentally superior alternative.
4. Findings of overriding need if adverse impacts to fish, wildlife and botanical resources are not fully mitigated.



10 0000

A balanced approach for the management of state lands would incorporate multiple resource needs including fish, wildlife, and botanical resources and as identified in the present draft, timber production. To accomplish this goal, we suggest that the Department of Fish and Game and the California Department of Forestry and Fire Protection jointly prepare a management plan (including specific measures to protect and enhance wildlife and botanical resources) for the parcels. This plan should then be appended to the Draft Supplement to the EIR and recirculated for public review and comment.

If you have any questions or need additional information, please contact George Nokes, Regional Manager of Region 4, at 1234 E. Shaw Avenue, Fresno, CA 93710 or telephone (209) 222-3761.

*Pete Bontadelli*  
**Pete Bontadelli**  
 Director

CALENDAR PAGE	189
MINUTE PAGE	1834

October 13, 1988

...resources available for the management of the...  
...resource needs...  
...to accomplish this goal...  
...game and the...  
...  
Mr. Clifford E. Fago  
California Department of Forestry &  
Fire Protection  
P.O. Box 944246  
Sacramento, California 94244-2460

Dear Mr. Fago:

Subject: SCH NO. 81082617  
Management of State Lands  
Commissions Parcels

Our District was notified through the State Clearinghouse of the above referenced project. The Fresno County Air Pollution Control District has rules governing wildland vegetation burning and Permits to burn are required. In mid-October it is anticipated that a San Joaquin Basin-wide rule on this subject will be implemented (Rule 416.1 in Fresno).

We would appreciate continued coordination between our offices in relation to the required burn permits.

If you have any questions, please give me a call.

Sincerely,

*Katie Bearden*

Katie Bearden  
Staff Analyst  
Fresno County Air Pollution Control  
District

KB:ad

RESPONSE TO COMMENTS

Response to Department of Fish and Game/Pete Bontadei in letter dated 9-15-88:

After review of the project and discussion with Department of Fish and Game staff, we believe their specific concerns have been answered. See attached letter to Rod Gross, DF&G from Dave Dulitz, CDF, dated 1-13-89; and letter from George D. Nokes, DF&G to Clifford Fago, CDF, dated 4-17-89. CDF agrees to closely coordinate all on the ground project activity with DF&G staff as outlined in these letters which are considered additional mitigation measures.

Response to Fresno County Air Pollution Control District/Katie Bearden, 10-13-88:

CDF will comply with all state and local Fresno County burning regulations.

## DEPARTMENT OF FORESTRY AND FIRE PROTECTION

Mt. Home Demonstration State Forest

P. O. Box 517

Springville, CA 93265

Telephones: (209) 539-2855 (winter)

(209) 539-2721 (summer)

Rod Goss, California Department of Fish and Game, January 15, 1989

Calif. Dept. of Fish and Game

1234 East Shaw Ave.

Fresno, CA 93710

Dear Mr. Goss:

I would like to thank you for spending the time with me on January 12th to discuss the Department of Fish & Game's concerns regarding our Draft Management Plan for the Meadow Lakes State Lands Parcel. I would like to outline a few of the things that we talked about to help you in the evaluation of the plan.

The majority of the parcel is vegetated with a dense stand of over-mature chaparral. Some of the proposed projects would result in clearing this brush and planting conifer tree species. Some vegetation control may be needed in the establishment years of a conifer stand to control competing vegetation. Herbicide treatments or mechanical control methods would be conducted in such a way as to leave a certain percentage of early-successional brush vegetation in areas between rows of trees or in unstocked areas. A balance can be maintained between survival and growth of the tree seedlings and maintenance of browse species for wildlife.

Only those portions of the parcel which have topography and soils suitable for brush clearing and timber production would be treated. Vegetation would be undisturbed in steep, rocky areas and along streams and drainages. The opportunity would exist for some type of vegetation treatment in these areas, strictly for wildlife habitat improvement, if plans could be worked out jointly with Fish & Game and CDF.

Very little timber harvesting is proposed in the near future. Less than 20 acres of the parcel has enough timber on it to consider harvesting. If harvesting were to occur, only over-mature and high risk trees would be removed in a selective harvest. The disturbance from such a harvest would result in an increase in early-successional brush with benefits to wildlife. Timber harvesting along the one intermittent stream and other ephemeral draws would meet or exceed the standards for stream protection in the Forest Practice Rules.

Pre-commercial thinning of dense timber stands would also be considered as a project on this parcel. The opening up of these dense stands would also benefit wildlife by stimulating brush growth under the trees.



would propose that all of our specific project plans be submitted to your office for consideration and comments. It would also be helpful if a wildlife biologist would accompany our staff on the ground when in the planning stage for specific projects. At this time, site specific details for wildlife improvement could be worked out and incorporated in to the project plans or contract.

We feel that we have the opportunity to demonstrate to other landowners that land of this type can be improved for both timber production and wildlife values. The best approach to accomplish this is the utilization of the various expertise of our respective Departments in planning the projects on this parcel.

Would you please direct your comments on this letter and our draft plan directly to Clifford Fago, Project Coordinator, Calif. Department of Forestry and Fire Protection, P.O. Box 944246, Sacramento, CA. 94244-2460. Could you also supply me with the name of a contact in your Department that would be available to meet with us on the parcel to provide input into our specific project plans?

I look forward to working with you or your staff on the future management of this parcel.

Sincerely,

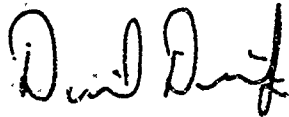

David Dulitz  
Forest Manager

cc: Norman Cook  
Cliff Fago

CALENDAR PAGE	193
MINUTE PAGE	1838

NOTICE OF COMPLETION

of

DRAFT THIRD SUPPLEMENT TO ENVIRONMENTAL IMPACT REPORT

State of California

The Resources Agency

DEPARTMENT OF FORESTRY AND FIRE PROTECTION

1416 Ninth Street

P. O. Box 944246

Sacramento, CA 94244-2460

Project Title: Management of State Lands Commission Parcels by  
the California Department of Forestry and Fire  
Protection.

Original SCH # 81082617

New SCH # 88080821

Project Location: Section 36, T9S, R23E, MDB&M near Auberry  
in Fresno County

Description of Nature, Purpose, and Beneficiaries of Project:  
Under agreement with the State Lands Commission, the California  
Department of Forestry and Fire Protection will manage forest  
resources on the Meadow Lakes State School Lands Parcel (in  
addition to the 16 parcels discussed in the original EIR and two  
previous Supplements) for experimentation, demonstration, and  
timber production.

Lead Agency: California Department of Forestry and Fire  
Protection

Address Where Copy of EIR is Available: 1416 Ninth Street,  
P. O. Box 944246  
Sacramento, CA 94244-2460

Review Period: August 10 - September 23, 1988

Contact Person: Clifford E. Fago Phone: (916) 322-0169

MEMORANDUM

DATE: 7/15/88  
TO: THE RESOURCE AGENCY  
FROM: THE RESOURCE AGENCY  
SUBJECT: Draft Environmental Impact Report  
The Resource Agency  
Department of Forestry and Fire Protection

Third Supplement to Environmental Impact Report

Sacramento  
for

Management of State Lands Commission Parcels

Project Title: Management of State Lands Commission Parcels  
(Meadow Lakes Parcel)  
The Resource Agency  
by

California Department of Forestry and Fire Protection

Project Location: Section 14, T11N, R12E, M28E, near Arroyo  
in Fresno County  
SCH #81082617

Description of Nature, Purpose and Water Right of the Project  
Under agreement No. 10, State Lands Commission, the  
Department of Forestry and Fire Protection is  
responsible for the Meadow Lakes Forest, Sch. 10, 11, 12, 13,  
14, 15, 16, 17, 18, 19, 20, 21, 22, 23, 24, 25, 26, 27, 28, 29, 30,  
31, 32, 33, 34, 35, 36, 37, 38, 39, 40, 41, 42, 43, 44, 45, 46, 47, 48,  
49, 50, 51, 52, 53, 54, 55, 56, 57, 58, 59, 60, 61, 62, 63, 64, 65, 66,  
67, 68, 69, 70, 71, 72, 73, 74, 75, 76, 77, 78, 79, 80, 81, 82, 83, 84,  
85, 86, 87, 88, 89, 90, 91, 92, 93, 94, 95, 96, 97, 98, 99, 100.

State of California  
Department of Forestry and Fire Protection  
1416 Ninth Street  
P. O. Box 944246  
Sacramento, CA 94244-2460

July 1988

CALENDAR PAGE 195  
MINUTE PAGE 1840

## SUMMARY

Through an interagency agreement, dated July 1, 1980, and amended March 1, 1983, July 1, 1986, and March 2, 1988, between the State Lands Commission (SLC) and the California Department of Forestry and Fire Protection (CDF), CDF is authorized to conduct management of the surface resources of 18 State School Lands parcels located in Shasta, Trinity, Lake, Alpine, Tulare, Santa Cruz, Tehama, and Fresno Counties. Under the terms of the agreement, CDF is managing the parcels for: 1) experimentation, 2) demonstration of sound and innovative forest management techniques to small private owners, and 3) acceleration of the sale and harvesting of merchantable timber from the parcels. As part of the project, the full range of approved California Forest Improvement Program (CFIP) practices would be incorporated, as appropriate to the parcels. In 1982, CDF prepared, circulated, and adopted an EIR for the project (SCH #81082617) covering 10 of the parcels. Two supplemental EIRs covering six additional parcels were prepared in 1985 and 1987 pursuant to Section 15163 of the State CEQA Guidelines based upon the rationale that the addition of these parcels did not materially alter the program goals. Road construction, timber harvesting, Christmas tree harvesting, forest land conservation measures, wildlife habitat improvement, and fuel reduction have been accomplished on various parcels to date.

Now, this third supplement to EIR SCH #81082617 covers planned management activities on one additional 240-acre parcel

known as the "Meadow Lakes Parcel" located five miles east of Auberry in Fresno County. Inclusion of this parcel does not change the program's goals or objectives as described in the original EIR. Specific activities planned on the Meadow Lakes Parcel include: boundary surveying, brush clearing, tree planting, timber harvesting, precommercial thinning, fencing, and development of water sources for wildlife.

#### ENVIRONMENTAL SETTING

##### Location

The Meadow Lakes State Lands Parcel consists of 240 acres described as follows: SE1/4NW1/4, NW1/4NE1/4, E1/2SE1/4, E1/2SW1/4, Section 36, Township 9 South, Range 23 East, M.D.B.&M. The parcel lies north of the Meadow Lakes subdivision which is located five miles east of Auberry in Fresno County, as shown on Map #1. The property forms three separate parcels within Section 36 with two of them having a common corner.

##### Access

Three main access routes exist into the property and are shown on Map #2. All routes are unpaved and are undrivable during a portion of the winter.

##### Boundaries

The exterior boundaries of Section 36 are currently being surveyed under a contract administered by the U. S. Forest Service. This survey will result in all of the exterior corners of the Section being set. Existing corners as of February 1988

are shown on Map #3. When the U. S. Forest Service survey is complete, three 1/16-corners within the Section will need to be set to establish all of the State-property corners.

#### Topography

Elevations on the property range from 3,400 feet to 4,400 feet. Slopes occur over a broad range from flat to very steep.

The average slopes are moderate, running from 20% to 40%.

Aspects on the parcel also vary, but the predominate aspects are northerly and easterly, as shown on Map #4.

#### Soils and Geology

Soils on the property include 21 acres of Chawanakee (7129), 44 acres of Shaver (7127), and 175 acres of Holland (716), as shown on Map #5. These soils exhibit moderate to high erosion potential depending on slope. Soil depths range from two feet to over five feet.

All of the soils on the property are suitable for timber production. 219 acres are classified as site II with the remaining 21 acres classified as site III.

#### History

Very little is known about the history of the property. Some logging activity has occurred on the parcel which may date from 30-50 years ago. It appears that wildfire has had an influence on the vegetation of the parcel. It can be inferred that some of the even-aged young timber stands and homogeneous brushy sites are a result of intense historical wildfires.

Vegetation

Predominant vegetation on the property is chaparral with scattered timber in the form of ponderosa pine and incense cedar.

Timber volume information is not available for the property. The majority of the timber exists in the southeastern corner and western edge of the property.

Major brush species include mountain mahogany, Mariposa manzanita, buckbrush, deerbrush and bush lupine. Oak species include black oak, canyon live oak, and Brewer oak.

A portion of the northern parcel has been cleared by the U. S. Forest Service and was converted to annual and perennial grasses.

Water Resources

A small intermittent stream exists in the southeast corner of the property. Many other ephemeral drainages occur throughout the parcel.

Fish and Wildlife

Game species of wildlife which occur on or near the property include deer, bear, gray squirrel, and quail. No fish habitat exists on the property.

Archaeological and Cultural Resources

An Archaeological Records search conducted by the CDF Archaeologist indicated that there are no recorded archaeological sites listed in the California Archaeological Inventory for this

CALENDAR PAGE	1997
MINUTE PAGE	1844

parcel.

However, the area is judged to be of moderate to high archaeological sensitivity in light of numerous sites found in similar terrain nearby.

Seasonal camp sites, bedrock mortar sites, and obsidian flake scatters are expected to be found on this parcel. The remains of an old homestead cabin of unknown age exists near the southern

edge of the parcel.

#### Endangered, Threatened and Rare Species

A computer search of the Department of Fish and Game's Natural Diversity Data Base has been received and reviewed. No endangered, threatened and rare species are known to exist on the parcel.

#### Recreation

No recreation sites exist on the property. Public use of the property is currently low because of the limited access. The main use of the property at present is for hunting.

#### **MITIGATION MEASURES AND CEQA COMPLIANCE**

Vegetative cover in drainages and on steep slopes will be retained for wildlife habitat and watershed protection.

Brush fuel loads will be reduced to minimize fire danger to the State lands and adjacent private and Federal property.

Any timber harvesting will be conducted under the Forest Practice Act, Southern District Forest Practice Rules, and the



Timber Harvest Plan review process.

An archaeological survey will be made prior to conducting any ground disturbing management activities. Any sites located will be protected as recommended by the archaeologist.

Seasonal camp sites, pebble mortar sites, and other site scatters are expected to be found on this site. The site is an old homestead located of unknown age. There is a possibility of some other sites.

RECOMMENDATIONS

1. Conduct an archaeological survey of the site prior to any ground disturbing activities.

2. If any sites are located, they should be protected as recommended by the archaeologist.

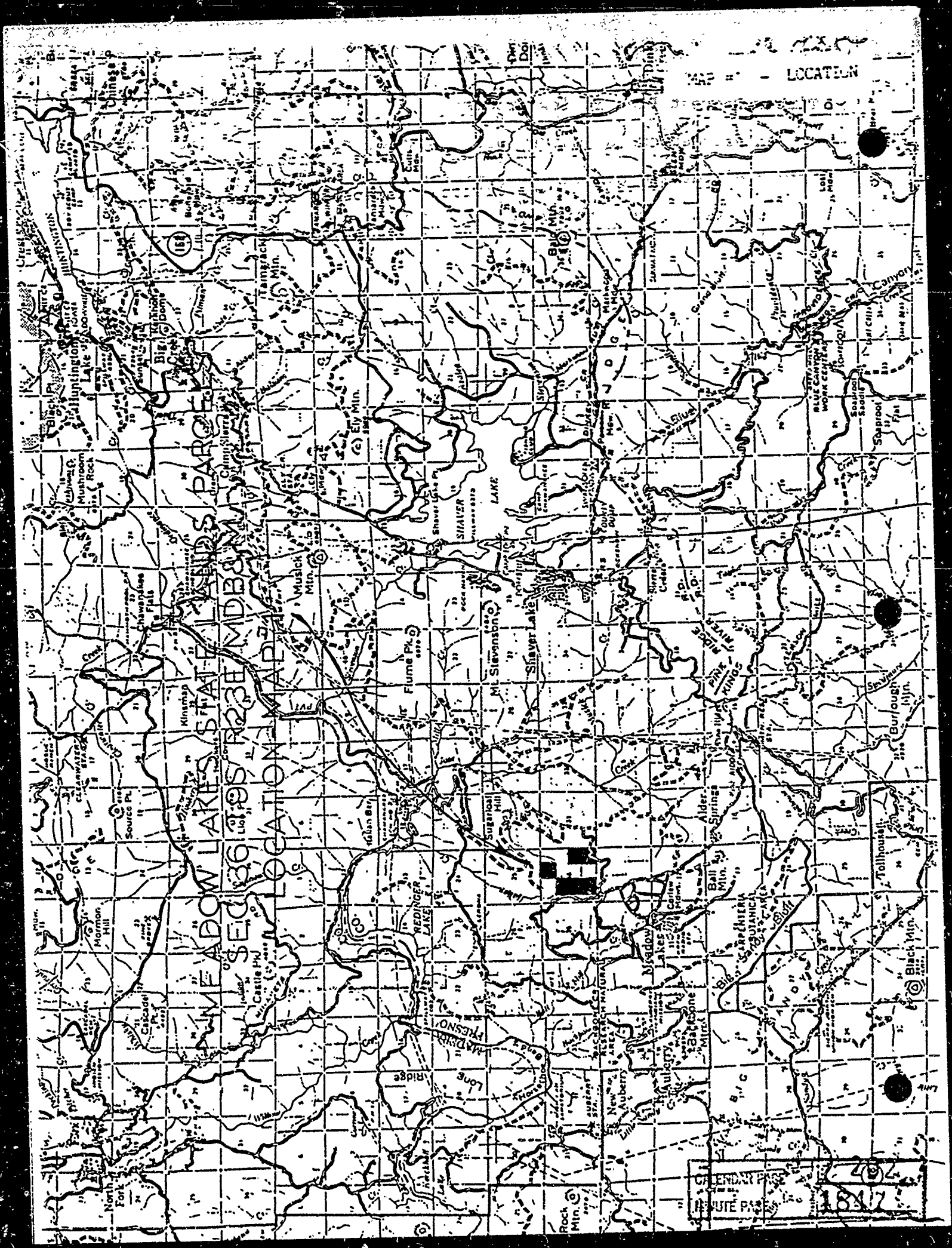

LOCATION

MEADOW LAKES STATE LANDS PARCELS RESERVE  
SECTION 36  
LOCATION MAP

CALENDAR PAGE  
18X7

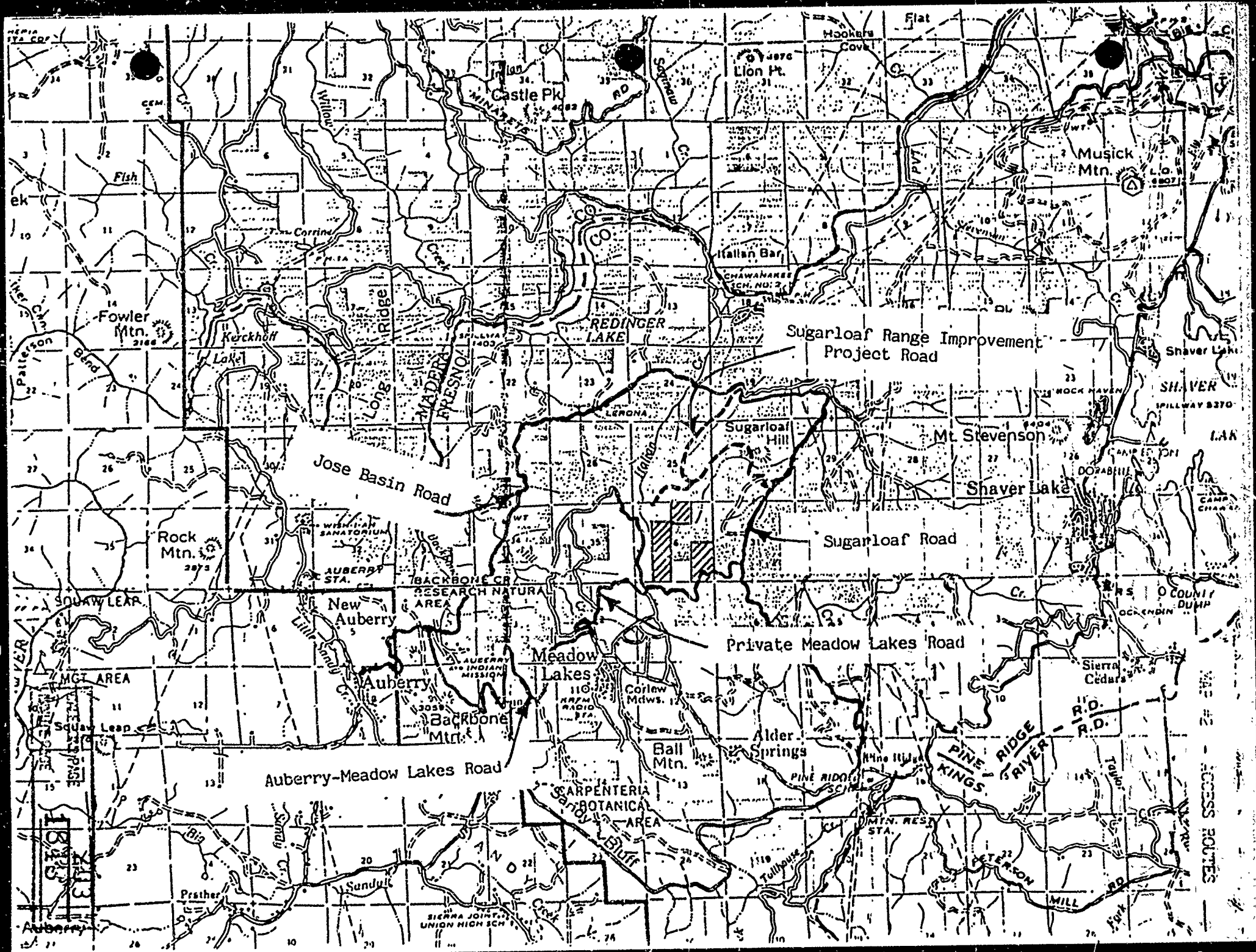

MEADOW/LAKES STATE LANDS PARCEL

SEC. 36 T.9S. R.23E. M.D.B. & M.

BOUNDARY & CORNERS-MAP #3

1" = 800'

26 25  
35 36

25 36  
36 31

STATE

STATE

STATE

35 36  
2 1

36 31  
1 6

◆ Corners set-according to Record of Survey, April 1980

◆ Corners visited by Dulitz & Stahl - Feb. 1988

CALENDAR PAGE

204

MINUTE PAGE

1849



MEADOW LAKES STATE LANDS PARCEL

SEC 36 T.9S. R.23E. M.D.B. & M.

SOIL AND TIMBER SITE MAP #5

1" = 800'

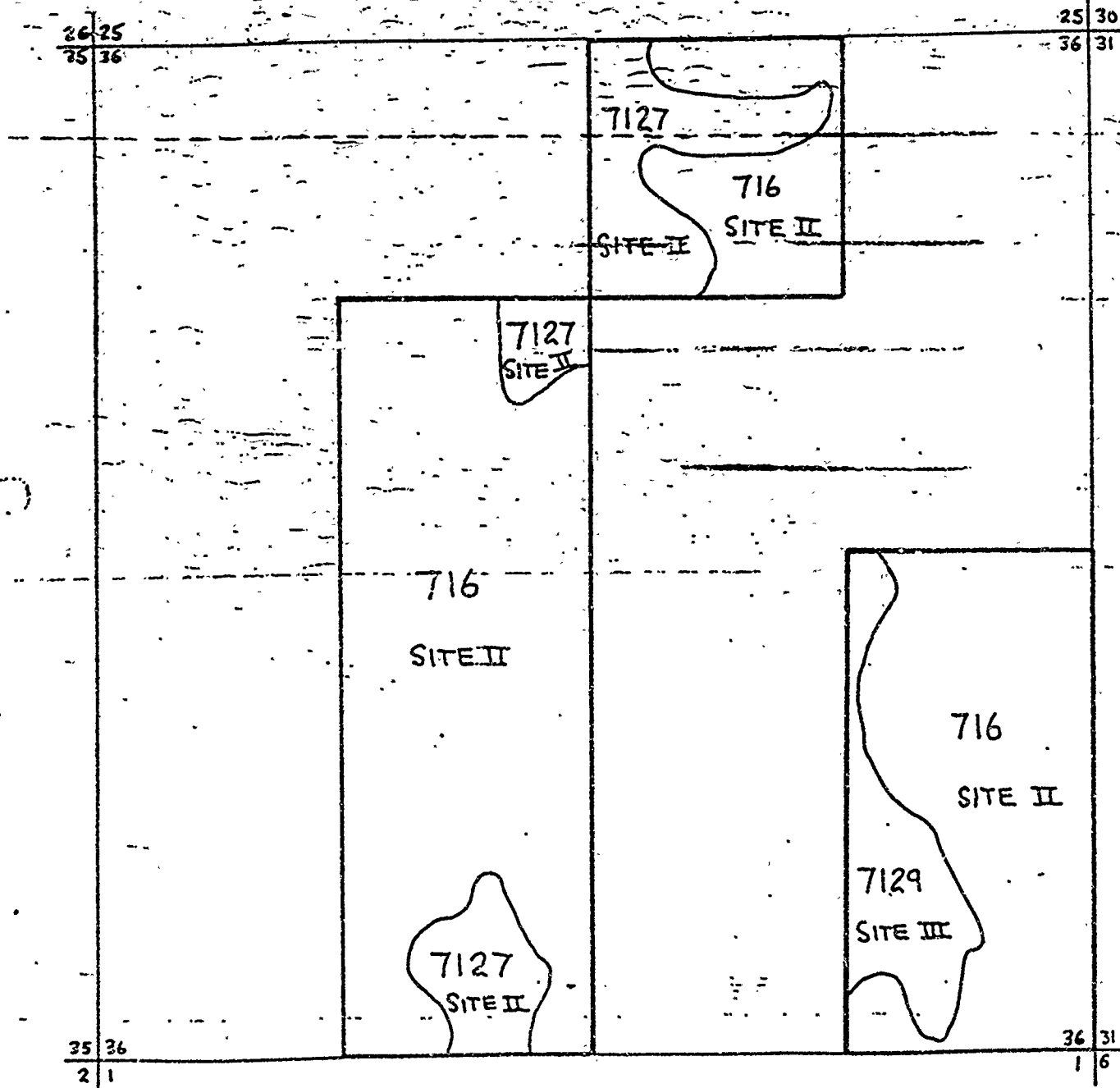

- 716 - Holland
- 7127 - Shaver
- 7129 - Chawanakee

CALENDAR PAGE 206  
MINUTE PAGE 1851

**Memorandum****RECEIVED**

APR 14 1988

5/4/14  
Mr. James F. Trout  
Assistant Executive Officer  
State Lands Commission  
1807 - 13th Street  
Sacramento, CA 95814

STATE LANDS COMMISSION

Date : April 11, 1988  
R 6.Telephone: ATSS ( 8 ) 492-0169  
(916 ) 322-0169

From : Department of Forestry and Fire Protection

Subject: 4100 STATE FORESTS  
Contract Land Management  
State Lands Commission  
Meadow Lakes Parcel

Attached for your review and approval of the State Lands Commission is a management plan for the Meadow Lakes parcel in Fresno County. A supplement to our program EIR covering planned management activities on this parcel is being prepared.

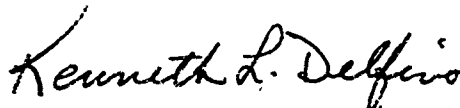

Kenneth L. Delfino  
Deputy Director for  
Resource Management

rt

Attachment

cc: Mr. Norm Cook  
Resource Manager, RIV  
Department of Forestry  
and Fire Protection

MEADOW LAKES STATE LANDS PARCEL  
MANAGEMENT PLAN

Prepared by:

David Dulitz, Forester II

Lloyd Stahl, Forester I

March, 1988



TABLE OF CONTENTS

	Page #
PROPERTY DESCRIPTION .....	1
MANAGEMENT FRAMEWORK .....	4
MANAGEMENT RECOMMENDATIONS .....	5
FOUR YEAR WORK PLAN .....	6
FUTURE PROJECTS AND MAINTENANCE WORK .....	7
MAP # 1 - LOCATION .....	8
MAP # 2 - ACCESS ROUTES .....	9
MAP # 3 - BOUNDARIES AND CORNERS .....	10
MAP # 4 - TOPOGRAPHY .....	11
MAP # 5 - SOILS AND TIMBER SITE .....	12
MAP # 6 - PHOTO POINTS .....	13
PHOTOS .....	13

## PROPERTY DESCRIPTION

### Location

The property consists of 240 acres described as follows; SE1/4NW1/4, NW1/4NE1/4, E1/2SE1/4, E1/2SW1/4, Section 36, Township 9 South, Range 23 East, N.D.B.&M. The parcel lies north of the Meadow Lakes subdivision which is located 5 miles east of Auberry in Fresno County, as shown on Map #1. The property forms three separate parcels within Section 36 with two of them having a common corner.

### Access

Three main access routes exist into the property and are shown on Map #2. All routes are unpaved and are undrivable during a portion of the winter.

One access route is from the south, from the paved Pine Ridge road east of Auberry. This private access road traverses through many private parcels in the Meadow Lakes area, eventually entering the property near the southwest corner. Although this route can provide administrative access, it is undesirable because of the private nature of the road.

The second access is off of the Sugarloaf Road running north from the Pine Ridge school. This road connects the Pine Ridge Road with the Jose Basin Road and is suitable for commercial hauling downhill to the Jose Basin Road. It also provides administrative access to the eastern part of the property. This road is maintained and controlled by the U.S. Forest Service.

The third access route is off of the paved Jose Basin Road. A Forest Service maintained dirt road leads through the Sugarloaf range improvement project and onto the northern part of the property. The road is not suitable for commercial hauling because of the steepness in the upper portions.

### Boundaries

The exterior boundaries of Section 36 are currently being surveyed under a contract administered by the U.S. Forest Service. This survey will result in all of the exterior corners of the Section being set. Existing corners as of February 1988 are shown on Map #3. When the U.S. Forest Service survey is complete, three 1/16 corners within the Section will need to be set to establish all of the State property corners.

### Topography

Elevations on the property range from 3,400 feet to 4,400 feet. Slopes occur over a broad range from flat to very steep. The average slopes are moderate, running from 20% to 40%. Aspects on the parcel also vary, but the predominate aspects are northerly and easterly, as shown on Map #4.

### Soils and Geology

Soils on the property include 21 acres of Chawanakée (7129), 44 acres of Shaver (7127), and 175 acres of Holland (716), as shown on Map #5. These soils exhibit moderate to high erosion potential depending on slope. Soil depths range from 2 feet to over 5 feet.

All of the soils on the property are suitable for timber production. 219 acres are classified as site II with the remaining 21 acres classified as site III.

### History

Very little is known about the history of the property. Some logging activity has occurred on the parcel which may date from 30-50 years ago. It appears that wildfire has had an influence on the vegetation of the parcel. It can be inferred that some of the even-aged young timber stands and homogeneous brushy sites are a result of intense historical wildfires.

### Vegetation

Predominant vegetation on the property is chaparral with scattered timber in the form of ponderosa pine and incense cedar. Timber volume information is not available for the property. The majority of the timber exists in the southeastern corner and western edge of the property.

Major brush species include mountain mahogany, Mariposa manzanita, buckbrush, deerbrush and bush lupine. Oak species include black oak, canyon live oak, and Brewer oak.

A portion of the northern parcel has been cleared by the U.S. Forest Service and was converted to annual and perennial grasses.

### Water Resources

A small intermittent stream exists in the southeast corner of the property. Many other ephemeral drainages occur throughout the parcel.

### Fish and Wildlife

Game species or wildlife which occur on or near the property include, deer, bear, gray squirrel, and quail. It is unknown at this time as to the occurrence of any rare or endangered wildlife species.

No fish habitat exists on the property.

### Cultural Resources

The property has the potential to contain Native American sites. One site has been located within 50 feet of the State boundary. A thorough search of the property is needed to determine if any site exist on State property.

The remains of an old homestead cabin of unknown age exists near the southern edge of the parcel.

### Recreation

No recreation sites exist on the property. Public use of the property is currently low because of the limited access. The main use of the property at present is for hunting.

Very little potential exists on the property for developed recreation.

### Range

The area is suitable for range management as evidenced by the Sugarloaf Range Improvement Project immediately adjacent to the property. Range cattle are currently using a portion of State land in the northern portion of the property. The small acreage of State land and the low return on grazing fees makes range management impractical for this parcel. It would be possible to open certain areas of State land up to the adjacent grazing permittee in order to accomplish vegetation management in selected areas. Some fencing exists on the parcel which controls grazing at present.

## MANAGEMENT FRAMEWORK

The property will be managed by the resource management staff of the Region IV office and Mt. Home State Forest. The nearest inmate manpower source would be the Miramonte Conservation Camp. One way travel time from the camp to the property is estimated to be 1 1/2 hours. Because of the excessive travel time from Miramonte to the parcel, it is foreseen that much of the labor force for projects on the parcel would have to be from private contractors.

Any sales of forest products from the property would be made consistent with current policies of the California Department of Forestry and Fire Protection concerning sales from State Forests.

Specific management criteria for the property would include:

1. Develop an accurate inventory of the resources on the property including: timber, cultural resources, critical wildlife habitat, and watershed resources.
2. Manage the property for timber production, wildlife, and watershed. Reduce the amount of brush cover and reforest cleared sites with commercial timber species. Maintain cover in drainages and steep slopes for wildlife habitat and watershed protection.
3. Make sales of overmature timber where it can be economically removed. Conduct thinnings in dense stands to concentrate growth onto selected crop trees.
4. Reduce the fuel loads on the property to minimize the fire danger to the State lands and adjacent property owners.
5. Take advantage of any opportunity to demonstrate management activities undertaken on the parcel to private or public land managers and to the general public. Investigate different options of land practices to maximize the experimental and demonstrational value.

## MANAGEMENT RECOMMENDATIONS

### Boundary Survey

A high priority should be placed upon setting the remaining property corners after the completion of the current ongoing survey of the exterior of Section 36 by the U.S. Forest Service. Minimal work would be required if the remaining corners could be set using the control established in the Forest Service survey. After all of the corners are established, the lines should be marked in areas of projected project activity.

### Inventory

A timber cruise should be accomplished in the areas where mature timber exists in amounts that could be harvested in the near future. This would generally limit the cruise to the southeastern 40 acres of the property.

Dense stands of young-growth timber in need of pre-commercial thinning should be inventoried as to location and acreage.

All proposed project sites should be surveyed for cultural resources.

Proposed sites to be cleared of brush should be surveyed for acreage. Steep slopes and drainages should be delineated out as equipment exclusion zones.

### Brush Removal

Remove as much brush as possible on the topography suitable for mechanical clearing methods. Limit heavy equipment to slopes of less than 40%. Brush should be piled or windrowed for burning as soon as possible after clearing. Leave stringers of brush in drainages, steep slopes and rocky areas for wildlife habitat and watershed protection.

### Tree Planting

Replant all cleared areas promptly with suitable planting stock. The main tree species to plant would be ponderosa pine and incense cedar. Limited amounts of Douglas fir, Sierra redwood, white fir, Jeffrey pine, and blister rust resistant sugar pine could also be planted. In previously cleared areas which now contain grasses, the vegetation should be controlled with suitable herbicides. Some herbicide application may be needed on planted areas if brush regeneration is a problem.

### Pre-commercial Thinning

Over-stocked stands of young-growth timber should be thinned as soon as possible to maximize growth of selected leave trees. In many of these areas, brush competition also exists which should be removed. Removal methods should include manual and mechanical.

### Wildlife Habitat Improvement

The opportunity exists to improve the wildlife habitat in conjunction with projects to improve the other resources of the property. Vegetation removal should be done in such a way to maximize the edge effect between natural cover and cleared areas. Vegetation should remain as diverse as possible to provide adequate cover and food.

Water sources could be developed to the benefit of wildlife species. Development of seasonal ponds and wildlife guzzlers should be carried out where possible.

### Fencing

A fencing plan should be developed to control the use of portions of State land by adjacent range cattle. These fences should be designed to allow for selective grazing if desired, to experiment with cattle for vegetation control.

## FOUR YEAR WORK PLAN

Note: Estimated budget amounts are shown for the first two fiscal years only.

### Fiscal Year 88-89:

1. Set three interior property corners when the U.S. Forest contract survey of the exterior of Section 36 is completed. This work could be coordinated by licensed land surveyor Dan Seamount with assistance from the State Forest Staff.

Operating costs for the survey work would include per diem, equipment rental, and miscellaneous supplies for an estimated amount of \$3,000.00.

2. Start inventory work. Mark boundary lines and cruise timber in southeast 40. Determine acreage of pre-commercial thinning needed in southern portion of property and mark boundaries of thinning.

Work to be accomplished by State Forest staff with a per diem budget of approximately \$1,500.00.

Fiscal Year 89-90:

1. Lay out and mark a small pre-commercial thinning plot. Thin with hand labor from Miramonte Conservation Camp. Evaluate travel times of crews to project and efficiency of using inmate labor on property. Per diem budget: \$1,000.00.
2. Determine acreage of brushing that could be accomplished in northern 50 acres of property. Mark boundaries and survey area for cultural sites. Determine fencing plan needed to control grazing. Per diem budget: \$1,000.00.
3. Purchase material for any proposed fencing project. Costs will be determined from fencing plan.

Fiscal Year 90-91:

1. Issue brushing contract for a portion of northern 80 acres of property. Costs would be dependent on actual acres treated. Time clearing for spring of the year.

Fiscal Year 91-92

1. Burn brush piles from clearing project in fall months.
2. Construct fencing in areas planned to be planted.
3. Issue tree planting contract for spring or accomplish with inmate labor.
4. Apply herbicide to grass or brush sprouts.

FUTURE PROJECTS AND MAINTENANCE WORK

1. Harvest timber in southeast 40.
2. Construct ponds or guzzlers for wildlife habitat improvement.
3. Continue pre-commercial thinning and clean and release work.
4. Apply herbicide as spot treatment to brush sprouts and seedlings.
5. Develop interpretive material regarding the completed projects to disseminate to interested landowners.



MEADOW LAKES STATE LANDS PARCEL  
SEC 36  
R23E T23N

LOCATION MAP

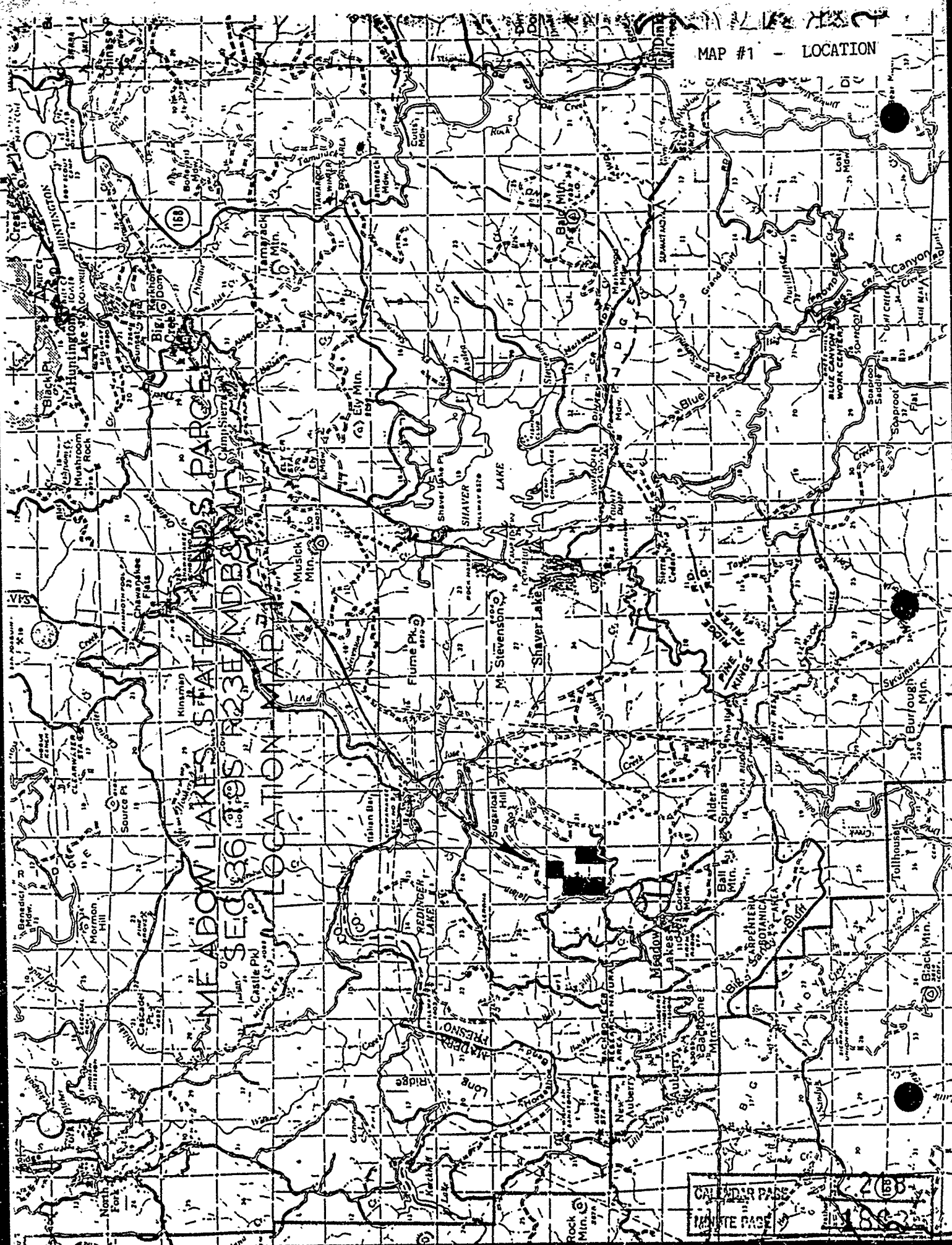

SCALE BAR  
1 INCH = 1 MILE  
188

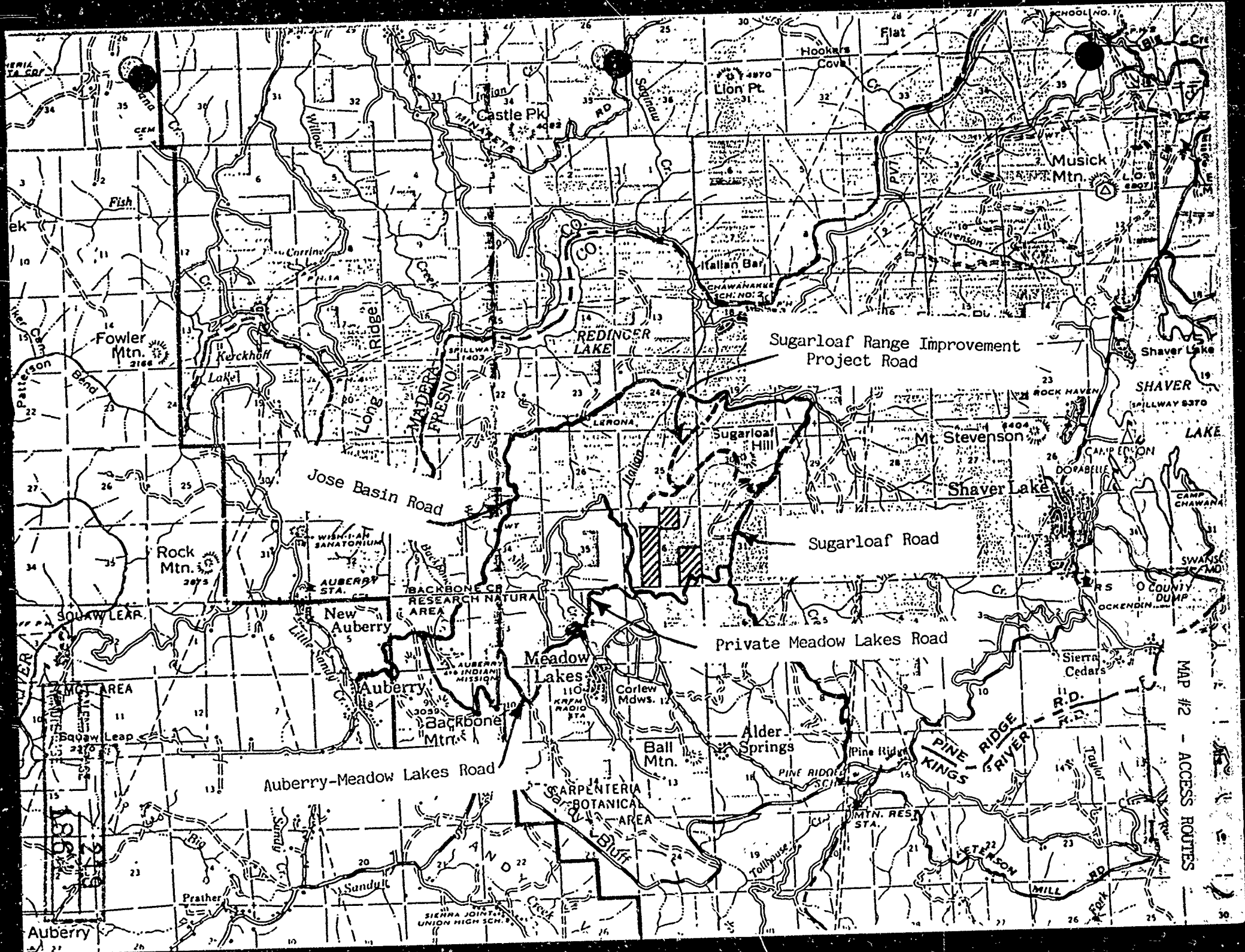

MAP #2 - ACCESS ROUTES

SECTION 36 T.9S. R.23E. M.D.B. & M.

# MEADOW LAKES STATE LANDS PARCEL

## SEC. 36 T.9S. R.23E. M.D.B. & M.

### BOUNDARY & CORNERS - MAP #3

1" = 800'

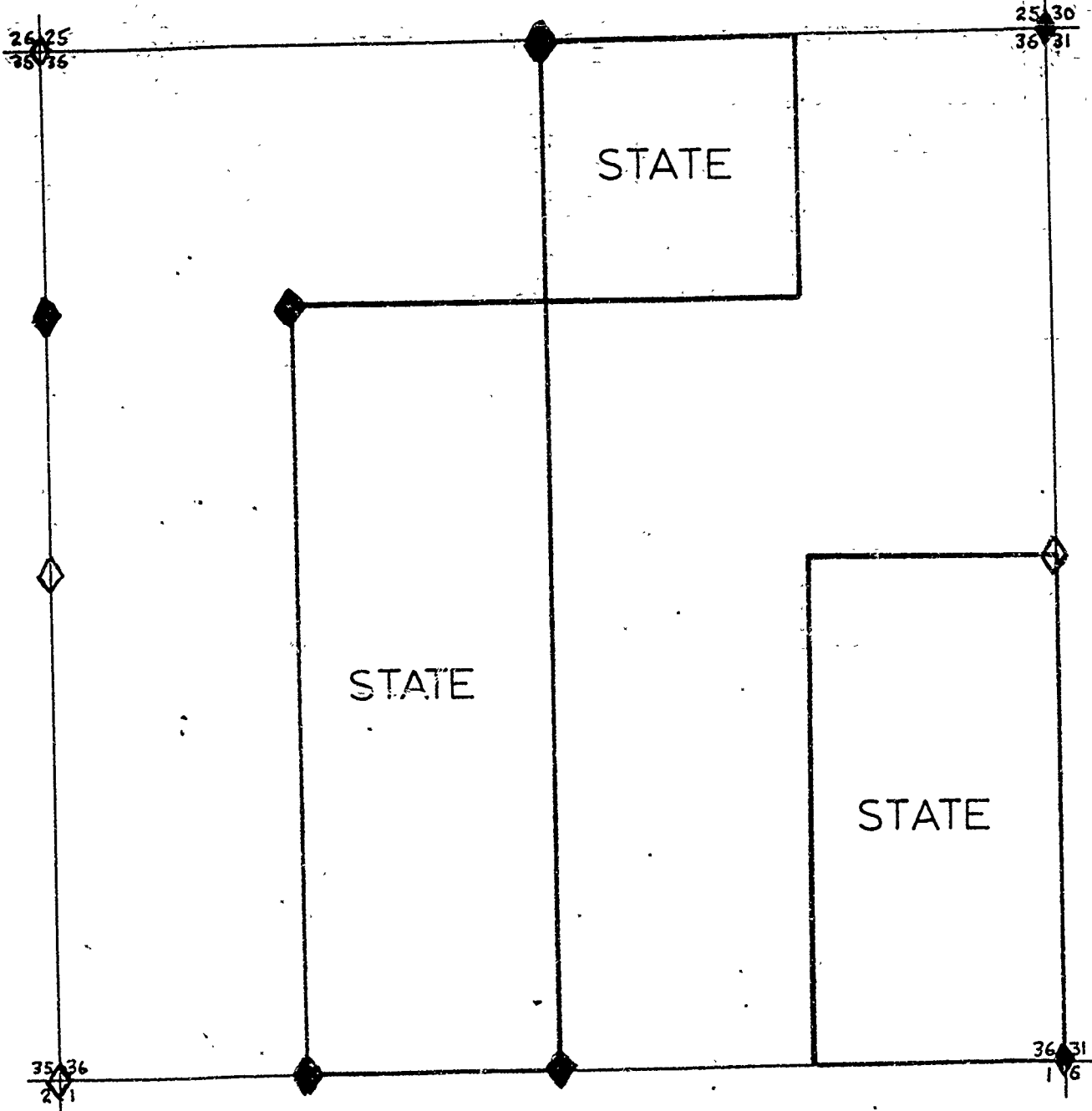

◆ Corners set-according to Record of Survey, April 1980

◆ Corners visited by Dunitz & Stahl - Feb. 1988

CALENDAR PAGE	220
MINUTE PAGE	1865



MEADOW LAKES STATE LANDS PARCEL

SEC. 36 T.9S. R.23E. M.D.B. & M.

SOIL AND TIMBER SITE MAP #5

1" = 800'

26 25  
35 36

25 30  
36 31

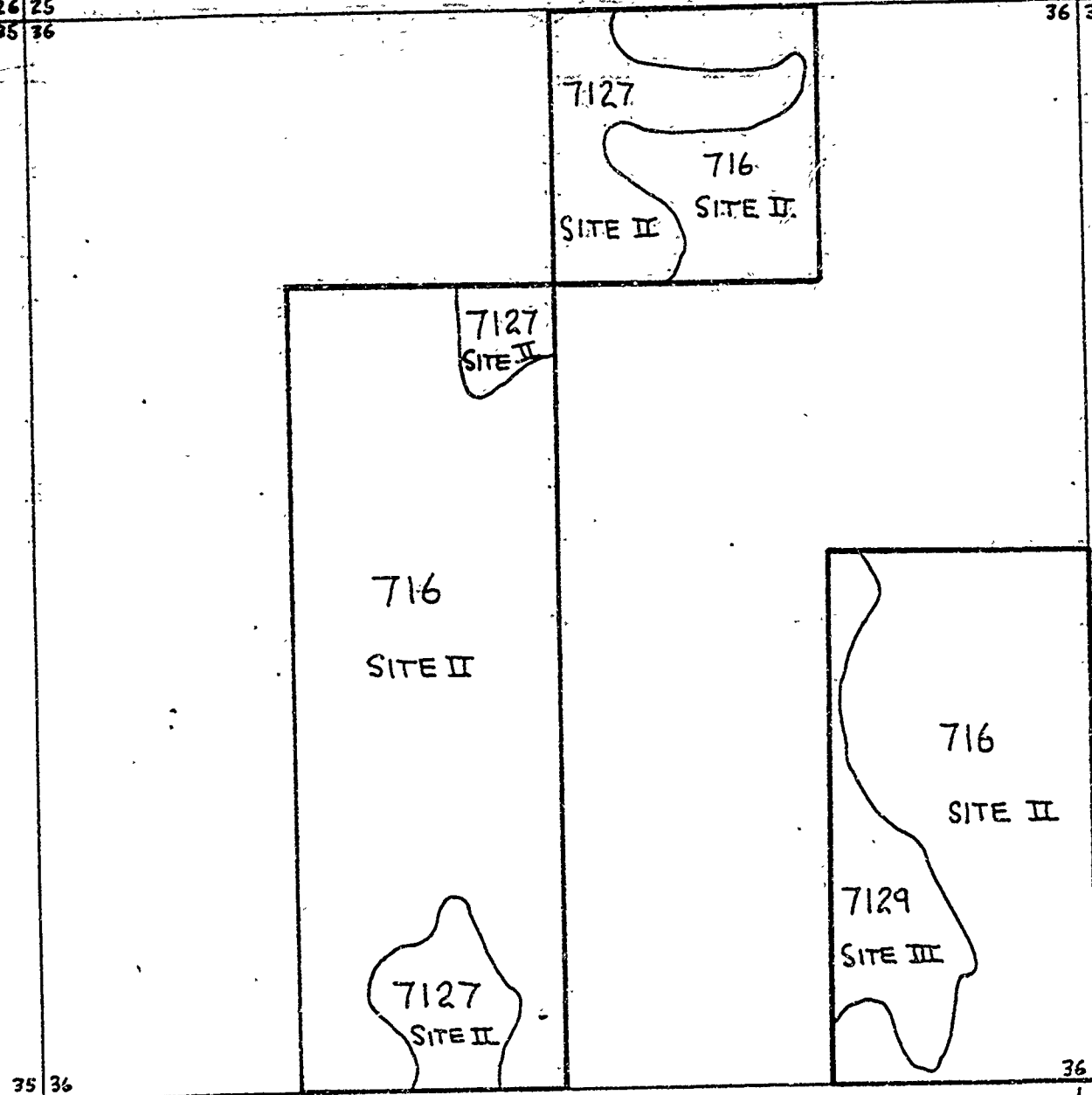

35 36  
2 1

36 31  
1 6

- 716 - Holland
- 7127 - Shaver
- 7129 - Chawanakee

CALENDAR PAGE	222
MINUTE PAGE	1867

# MEADOW LAKES STATE LANDS PARCEL

SEC. 36 T.9S. R.23E. M.D.B.&M.

PHOTO POINTS - MAP #6

1" = 800'

26 25  
36 36

25 30  
36 31

35 36  
2 1

36 31  
1 6

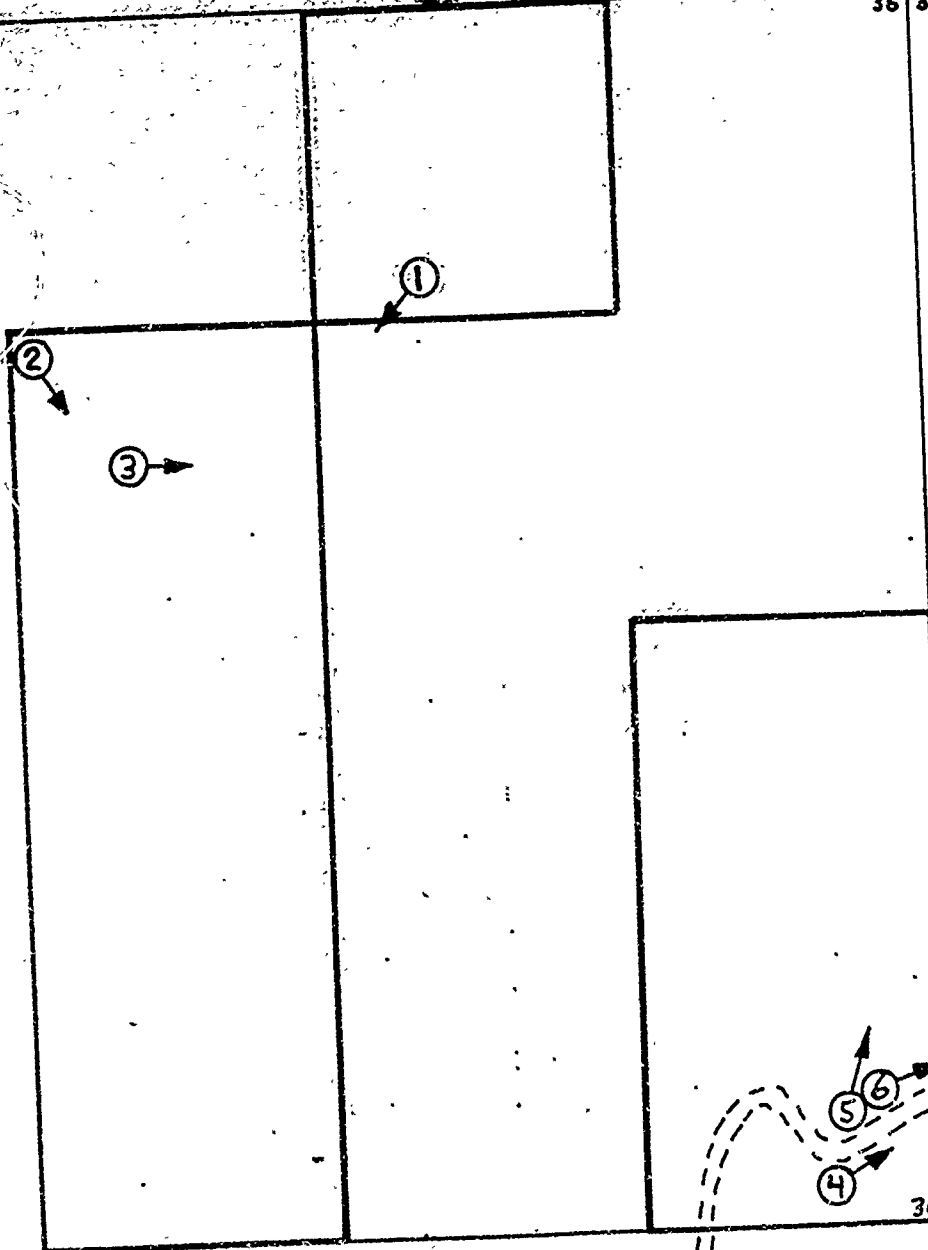

CALENDAR PAGE	223
MINUTE PAGE	1868

PARCEL

MEADOW LAKE

SECTION

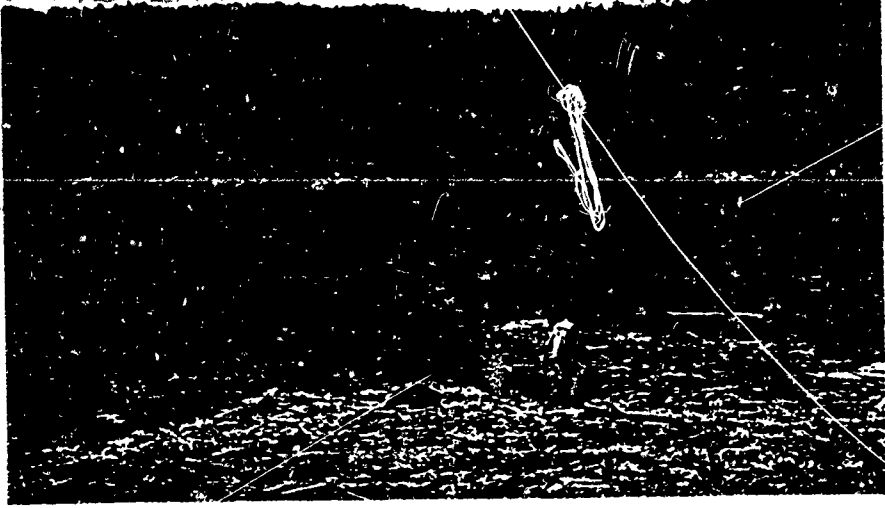

Photo #1 - Overview of western portion of property taken from northern 40. Forest Service clearing on State Land in forground and proposed brush clearing areas in background

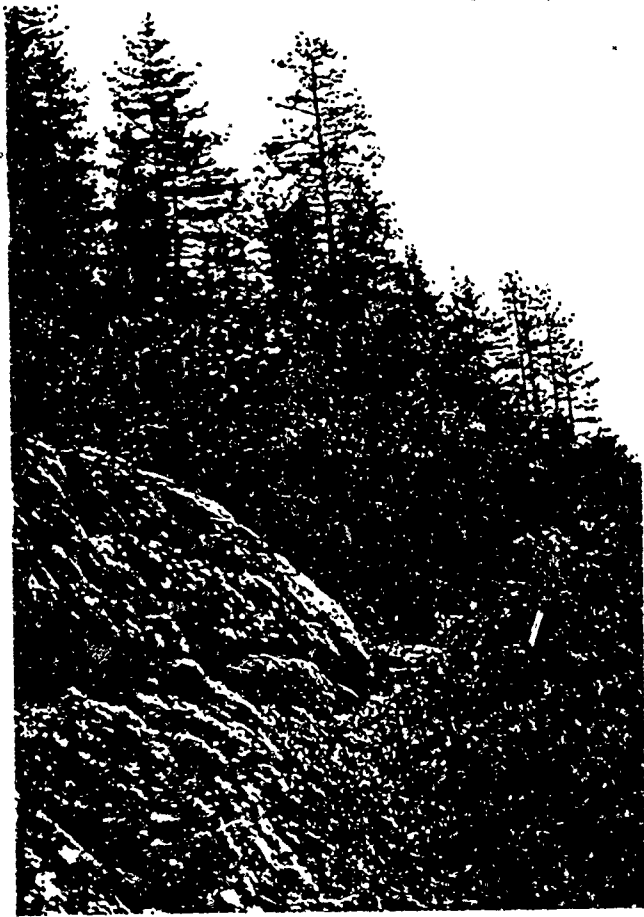

Photo #2 - Brush and timber on ridge along western portion of parcel.

CALENDAR PAGE	224
MINUTE PAGE	1869



Photo #3 - Close shot of brush on ridge shown in photo #2. Most of the brush in photo is Mariposa manzanita.

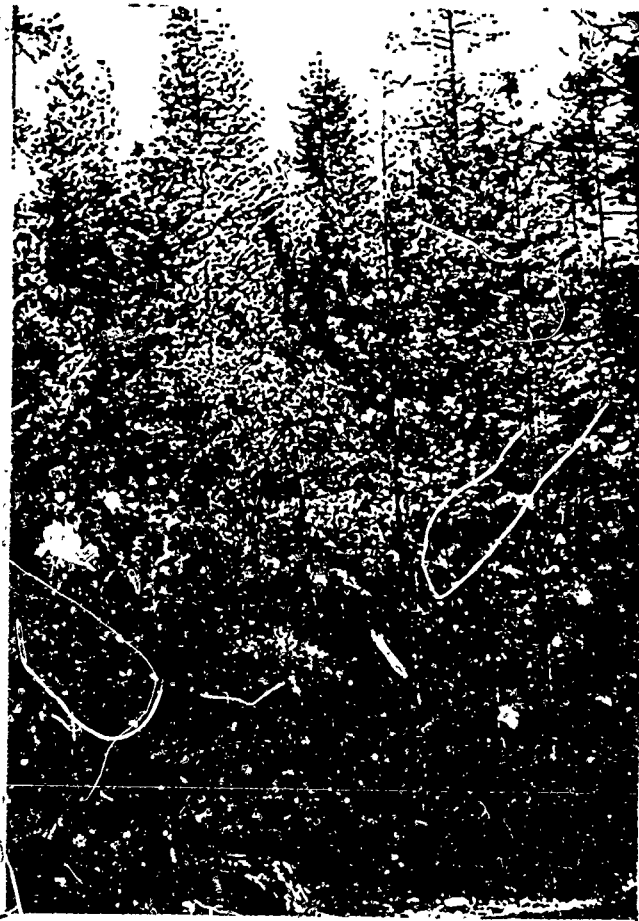

Photo #4 - Young-growth timber in southeastern forest showing need for pre-commercial thinning.

CALENDAR PAGE	225
GRANITE PASS	1870



