

MINUTE ITEM

22

04/26/89
PRC 4362
J. Ludlow

THOMAS E. KALJIAN, MARY GRACE KALJIAN,
GARY P. CARLSON, ANNE KALJIAN CARLSON
(Applicants)

Calendar Item 22, attached, was pulled from the agenda prior to the meeting.

Attachment: Calendar Item 22.

A 7

S 1

CALENDAR PAGE	
MINUTE PAGE	1243

CALENDAR ITEM,

22

A 7
S 1

04/26/89
PRC 4362
J. Ludlow

APPROVAL OF RECREATIONAL PIER PERMIT

APPLICANTS: Thomas E. Kaljian, Mary Grace Kaljian,
Gary P. Carlson, and Anne Kaljian Carlson
836 Sixth Street
Los Banos, California 93635

AREA, TYPE LAND AND LOCATION:
A parcel of submerged land in Lake Tahoe at
Tahoma, Placer County.

LAND USE: Use and maintenance of an existing pier and
retention of two previously unauthorized
mooring buoys.

TERMS OF PROPOSED PERMIT:
Initial period: Ten years beginning March 22,
1989.

CONSIDERATION: Rent-free, pursuant to Section 6503.5 of the
P.R.C.

APPLICANT STATUS:
Applicants are owners of upland.

PREREQUISITE CONDITIONS, FEES AND EXPENSES:
Filing fee and processing costs have been
received.

STATUTORY AND OTHER REFERENCES:
A. P.R.C.: Div. 6, Parts 1 and 2; Div. 13.
B. Cal. Code Regs.: Title 2, Div. 3;
Title 14, Div. 6.

AB 884: 07/18/89.

-1-

(ADDED pgs. 142-142.14)

CALENDAR PAGE	142
MINUTE PAGE	1244

CALENDAR ITEM NO. 22 (CONT'D)

OTHER PERTINENT INFORMATION:

1. As to the existing pier, pursuant to the Commission's delegation of authority and the State CEQA Guidelines (14 Cal. Code Regs. 15061), the staff has determined that this activity is exempt from the requirements of the CEQA as a categorically exempt project. The project is exempt under Class 1, Existing Facility, 2 Cal. Code Regs 2905(a)(2).

Authority: P.R.C. 21084, 14 Cal. Code Regs. 15300, and 2 Cal. Code Regs. 2905.

2. As to the existing unauthorized mooring buoys, pursuant to the Commission's delegation of authority and the State CEQA Guidelines (14 Cal. Code Regs. 15025), the staff has prepared a Proposed Negative Declaration identified as EIR ND 458, State Clearinghouse No. 89020615. Such Proposed Negative Declaration was prepared and circulated for public review pursuant to the provisions of CEQA.

Based upon the Initial Study, the Proposed Negative Declaration, and the comments received in response thereto, there is no substantial evidence that the project will have a significant effect on the environment. (14 Cal. Code Regs. 15074[b])

3. In order to determine the other potential trust uses in the area of the proposed project, the staff contacted representatives of the following agencies: TRPA, Department of Fish and Game, County of Placer, and the Tahoe Conservancy. None of these agencies expressed a concern that the proposed project would have a significant effect on trust uses in the area. The agencies did not identify any trust needs which were not being met by existing facilities in the area. Identified trust uses in this area would include swimming, boating, walking along the beach, and views of the lake.

(ADDED 04/24/89)

CALENDAR PAGE	142.1
MINUTE PAGE	1245

CALENDAR ITEM NO. 22 (CONT'D)

4. This activity involves lands identified as possessing significant environmental values pursuant to P.R.C. 6370, et seq. Based upon the staff's consultation with the persons nominating such lands and through the CEQA review process, it is the staff's opinion that the project, as proposed, is consistent with its use classification.
5. All permits covering structures in Lake Tahoe will include a condition subsequent that if any structure authorized is found to be in nonconformance with the Tahoe Regional Planning Agency's shorezone ordinance and if any alterations, repairs, or removal required pursuant to said ordinance are not accomplished within the designated time period, then the permit will be automatically terminated, effective upon notice by the State, and the site shall be cleared pursuant to the terms thereof.

APPROVALS OBTAINED:

All permits for pier previously obtained.

EXHIBITS:

- A. Land Description.
- B. Location Map.
- C. Negative Declaration.

IT IS RECOMMENDED THAT THE COMMISSION:

1. AS TO THE EXISTING PIER, FIND THAT THE ACTIVITY IS EXEMPT FROM THE REQUIREMENTS OF THE CEQA PURSUANT TO 14 CAL. CODE REGS. 15061 AS A CATEGORICALLY EXEMPT PROJECT, CLASS 1, EXISTING FACILITY, 2 CAL. CODE REGS. 2905(a)(2).
2. AS TO THE EXISTING UNAUTHORIZED MOORING BUOYS, CERTIFY THAT A NEGATIVE DECLARATION, EIR ND 458, STATE CLEARINGHOUSE NO. 89020615, WAS PREPARED FOR THIS PROJECT PURSUANT TO THE PROVISIONS OF THE CEQA AND THAT THE COMMISSION HAS REVIEWED AND CONSIDERED THE INFORMATION CONTAINED THEREIN.
3. DETERMINE THAT THE PROJECT, AS APPROVED, WILL NOT HAVE A SIGNIFICANT EFFECT ON THE ENVIRONMENT.

(ADDED 04/24/89)

CALENDAR PAGE	142,2
MINUTE PAGE	1246

CALENDAR ITEM NO. 22 (CONT'D)

4. AUTHORIZE ISSUANCE TO THOMAS E. KALJIAN, MARY GRACE KALJIAN, GARY P. CARLSON AND ANNE KALJIAN CARLSON OF A TEN-YEAR RECREATIONAL PIER PERMIT BEGINNING MARCH 22, 1989, FOR THE USE AND MAINTENANCE OF AN EXISTING PIER AND FOR THE RETENTION OF TWO EXISTING MOORING BUOYS, ON THE LAND DESCRIBED ON EXHIBIT "A" ATTACHED AND BY REFERENCE MADE A PART HEREOF.

-4-

(ADDED 04/24/89)

CALENDAR PAGE	142.3
MINUTE PAGE	1247

LAND DESCRIPTION

Prepared February 23, 1989 by
BIU 1

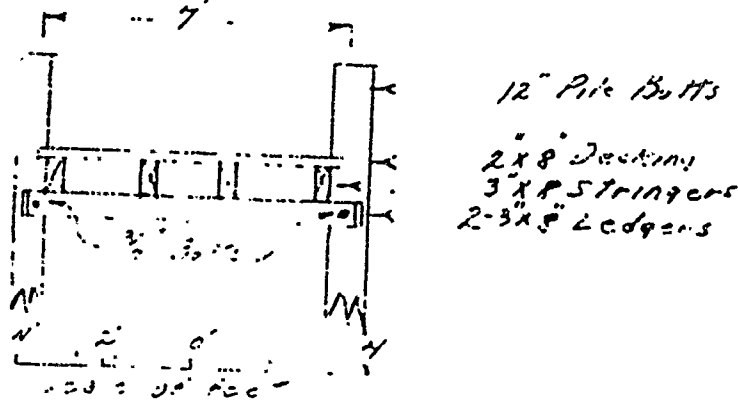

Section A-A

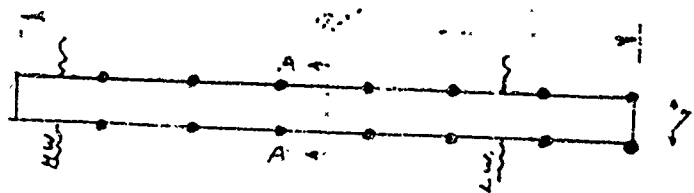
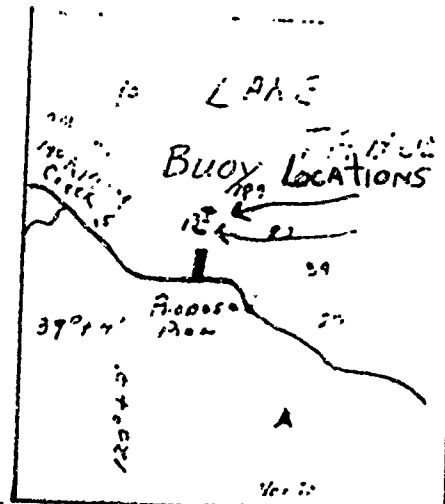

PLAN

Buoy #1

Buoy #2

North

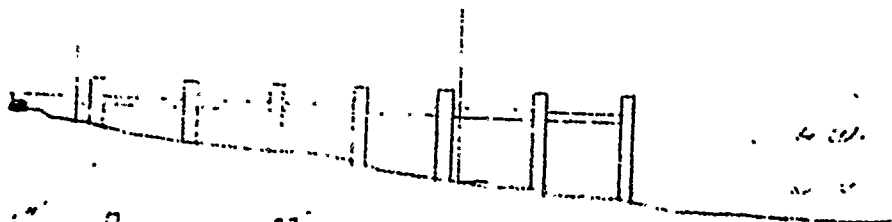

ELEVATION

Scale of feet

Proposed Pier

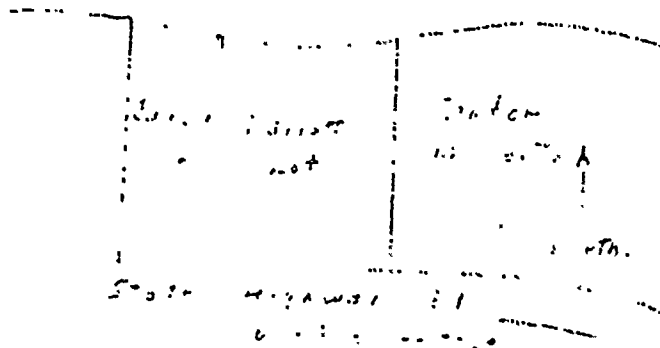

Proposed Pier in Lake Tahoe

950 yds. in. Whitney Crater

Placer Co. California

Map No. 11

Catherine D. Smith

CALENDAR PAGE	142.4
MINUTE PAGE	1248

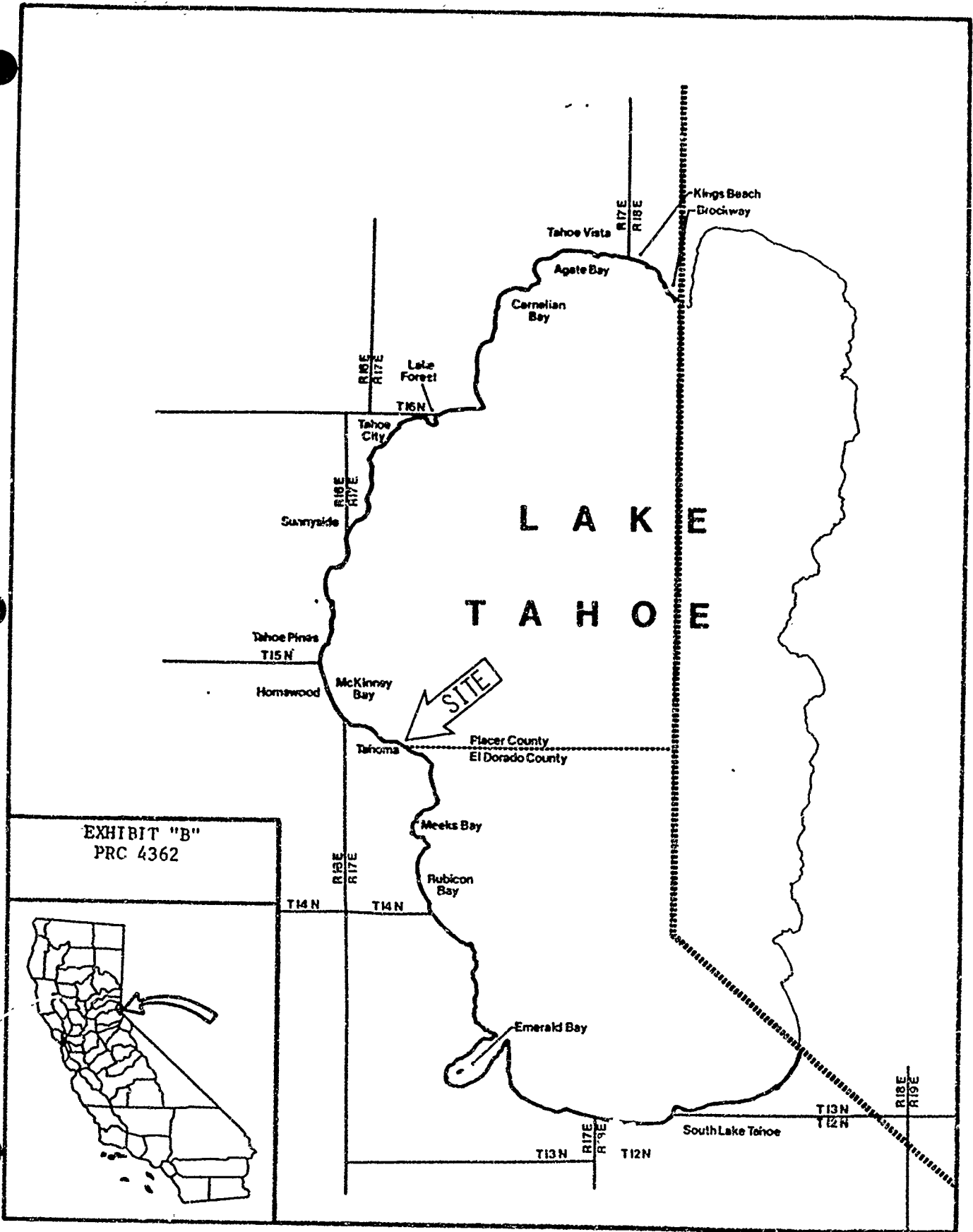

CALENDAR PAGE 142.5
MINUTE PAGE 1249

STATE OF CALIFORNIA—STATE LANDS COMMISSION

GEORGE DEUKMEJIAN, Governor

STATE LANDS COMMISSION
1807 13TH STREET
SACRAMENTO, CALIFORNIA 95814

89020615



PROPOSED NEGATIVE DECLARATION

EIR ND 458

File Ref.: WP 4362

SCH#:

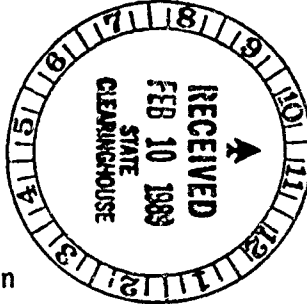

Project Title: BUOY PERMIT

Project Proponent: Thomas E. Kaljian

Project Location: In Lake Tahoe adjacent to 6840 Westlake Blvd., Tahoma, Placer County.

Project Description: Continued use and maintenance of two existing, unauthorized, buoys.

Contact Person:

TED T. FUKUSHIMA

Telephone: (916)322-7813

This document is prepared pursuant to the requirements of the California Environmental Quality Act (Section 21000 et seq., Public Resources Code), the State CEQA Guidelines (Section 15000 et seq., Title 14, California Administrative Code), and the State Lands Commission regulations (Section 2901 et seq., Title 2, California Administrative Code).

Based upon the attached Initial Study, it has been found that:

the project will not have a significant effect on the environment.

mitigation measures included in the project will avoid potentially significant effects.

CALENDAR PAGE	142.6
MINUTE PAGE	1250

T A H O E

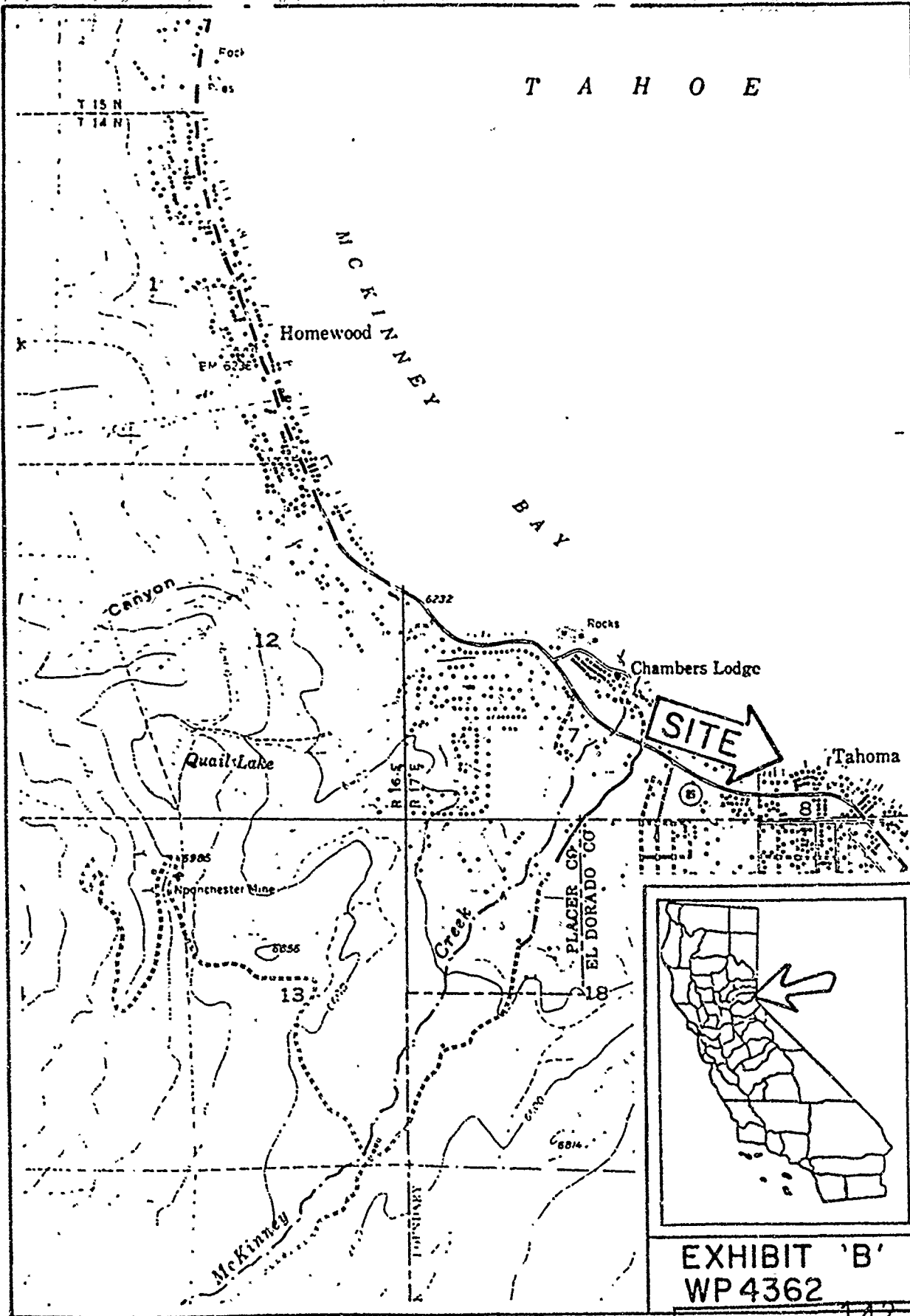
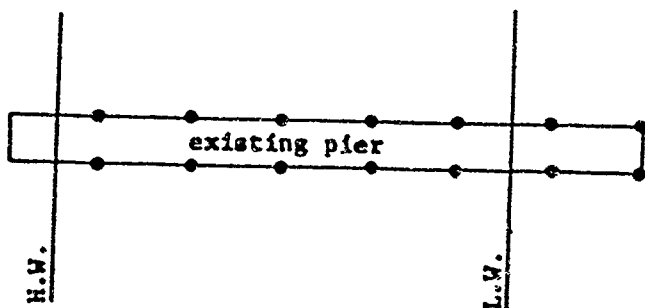

EXHIBIT 'B'
WP 4362

CALENDAR PAGE	142
MINUTE PAGE	1251

PLAN



Existing, Unauthorized
Buoys

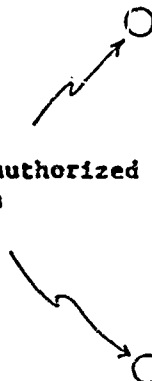

PROFILE

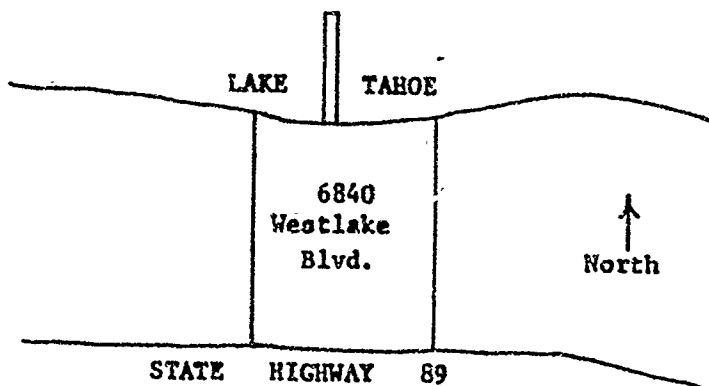
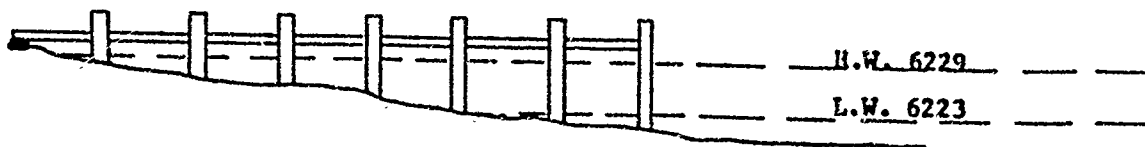

WP 4362
 PERMIT FOR EXISTING, UNAUTHORIZED, BUOYS
 950 yds. So. McKinney Creek
 Placer Co., California
 Application by
 Thomas E. Kaljian

CALENDAR PAGE	142.B
MINUTE PAGE	1252

ENVIRONMENTAL IMPACT ASSESSMENT FORM - Part I

(To be completed by applicant)
FORM 69.3(11/82)

A. GENERAL INFORMATION

1. Name, address, and telephone number:

a. Applicant

Thomas E. Kaljian
836 Sixth Street
Los Banos, CA 93635
(209) 826-2883

b. Contact person if other than applicant:

()

2. a. Project location: (Please reference to nearest town or community and include county)

6840 Westlake Boulevard, Tahoma, Lake Tahoe

b. Assessor's parcel number: 098-200-05-00

3. Existing zoning of project site: Single family residential

4. Existing land use of project site: Existing second home

5. Proposed use of site: same, buoys were purchased with property, we recently became aware that we should apply for a permit

6. Other permits required: None

B. PROJECT DESCRIPTION

1. For building construction projects, complete "ATTACHMENT A".

2. For non-building construction projects: Describe fully, the proposed activity, its purpose and intended use, e.g. for proposed mineral prospecting permits, include the number of test holes, size of holes, amount of material to be excavated, maximum surface area of disturbance, hole locations, depth of holes, etc. Attach plans or other drawings as necessary.

CALENDAR PAGE	<u>142.9</u>
MINUTE PAGE	<u>1253</u>

C. ENVIRONMENTAL SETTING

1. Describe the project site as it exists before the project, including information on topography, soil stability, plants and animals, and any cultural, historical, or scenic aspects. Describe any existing structures on the site, and the use of the structures.
2. Describe the surrounding properties, including information on plants and animals and any cultural, historical, or scenic aspects. Indicate the type of land use (residential, commercial, etc.), intensity of land use (one-family, apartment houses, shops, department stores, etc.), and scale of development (height, frontage, set-back, rear yard, etc.).

D. ENVIRONMENTAL IMPACT ASSESSMENT

Answer the following questions by placing a check in the appropriate box. Discuss all items checked "yes" or "maybe". (Attach additional sheets as necessary)

Will the project involve:	YES	MAYBE	NO
1. a change in existing features of any bays, tidelands, beaches, lakes, or hills, or substantial alteration of ground contours?	<input type="checkbox"/>	<input type="checkbox"/>	<input checked="" type="checkbox"/>
2. a change in scenic views or vistas from existing residential areas or public lands or roads?	<input type="checkbox"/>	<input type="checkbox"/>	<input checked="" type="checkbox"/>
3. a change in pattern, scale, or character of the general area of project?	<input type="checkbox"/>	<input type="checkbox"/>	<input checked="" type="checkbox"/>
4. a significant effect on plant or animal life?	<input type="checkbox"/>	<input type="checkbox"/>	<input checked="" type="checkbox"/>
5. significant amounts of solid waste or litter?	<input type="checkbox"/>	<input type="checkbox"/>	<input checked="" type="checkbox"/>
6. a change in dust, ash, smoke, fumes, or odors in the vicinity?	<input type="checkbox"/>	<input type="checkbox"/>	<input checked="" type="checkbox"/>
7. a change in ocean, bay, lake, stream, or ground water quality or quantity, or alteration of existing drainage patterns?	<input type="checkbox"/>	<input type="checkbox"/>	<input checked="" type="checkbox"/>
8. a change in existing noise or vibration levels in the vicinity?	<input type="checkbox"/>	<input type="checkbox"/>	<input checked="" type="checkbox"/>
9. construction on filled land or on slope of 10 percent or more?	<input type="checkbox"/>	<input type="checkbox"/>	<input checked="" type="checkbox"/>
10. use or disposal of potentially hazardous materials, such as toxic or radioactive substances, flammables, or explosives?	<input type="checkbox"/>	<input type="checkbox"/>	<input checked="" type="checkbox"/>
11. a change in demand for municipal services (police, fire, water, sewage, etc.)?	<input type="checkbox"/>	<input type="checkbox"/>	<input checked="" type="checkbox"/>
12. an increase in fossil fuel consumption (electricity, oil, natural gas, etc.)?	<input type="checkbox"/>	<input type="checkbox"/>	<input checked="" type="checkbox"/>
13. a larger project or a series of projects?	<input type="checkbox"/>	<input type="checkbox"/>	<input checked="" type="checkbox"/>

E. CERTIFICATION

I hereby certify that the statements furnished above and in the attached exhibits present the data and information required for this initial evaluation to the best of my ability, and that the facts, statements, and information presented are true and correct to the best of my knowledge and belief.

Date: March 22, 1987

Signed: [Signature]

ENVIRONMENTAL IMPACT ASSESSMENT CHECKLIST - PART II

Form 13.20 (7/82)

File Ref.: WP 4362

I. BACKGROUND INFORMATION

A. Applicant: Thomas E. Kaljian
836 Sixth Street
Los Banos, CA 93635

B. Checklist Date: 2 / 9 / 89

C. Contact Person: TED T. FUKUSHIMA
Telephone: (916) 322-7813

D. Purpose: Permit for the continued use and maintenance of two existing, unauthorized, buoys.

E. Location: In Lake Tahoe adjacent to 6840 Westlake Blvd., Tahoma, Placer County.

F. Description: Continued use and maintenance of two existing mooring buoys.

G. Persons Contacted: _____

II. ENVIRONMENTAL IMPACTS. (Explain all "yes" and "maybe" answers)

A. Earth. Will the proposal result in:	Yes	Maybe
1. Unstable earth conditions or changes in geologic substructures?	<input type="checkbox"/>	<input type="checkbox"/>
2. Disruptions, displacements, compaction, or overcovering of the soil?	<input type="checkbox"/>	<input type="checkbox"/>
3. Change in topography or ground surface relief features?	<input type="checkbox"/>	<input type="checkbox"/>
4. The destruction, covering, or modification of any unique geologic or physical features?	<input type="checkbox"/>	<input type="checkbox"/>
5. Any increase in wind or water erosion of soils, either on or off the site?	<input type="checkbox"/>	<input type="checkbox"/>
6. Changes in deposition or erosion of beach sands, or changes in siltation, deposition or erosion which may modify the channel of a river or stream or the bed of the ocean or any bay, inlet, or lake?	<input type="checkbox"/>	<input type="checkbox"/>
7. Exposure of all people or property to geologic hazards such as earthquakes, landslides, mudslides, ground failure, or similar hazards?	<input type="checkbox"/>	<input type="checkbox"/>

CALENDAR PAGE	7-42-11
MINUTE PAGE	1255

B. Air. Will the proposal result in: Yes Maybe No

- 1. Substantial air emissions or deterioration of ambient air quality? | | | | X
- 2. The creation of objectionable odors? [] | | | X
- 3. Alteration of air movement, moisture or temperature, or any change in climate, either locally or regionally? | | | | X

C. Water. Will the proposal result in:

- 1. Changes in the currents, or the course or direction of water movements, in either marine or fresh waters? | | | | X
- 2. Changes in absorption rates, drainage patterns, or the rate and amount of surface water runoff? | | | | X
- 3. Alterations to the course or flow of flood waters? | | | | X
- 4. Change in the amount of surface water in any water body? | | | | X
- 5. Discharge into surface waters, or in any alteration of surface water quality, including but not limited to temperature, dissolved oxygen or turbidity? | | | | X
- 6. Alteration of the direction or rate of flow of ground waters? | | | | X
- 7. Change in the quantity of ground waters, either through direct additions or withdrawals, or through interception of an aquifer by cuts or excavations? | | | | X
- 8. Substantial reduction in the amount of water otherwise available for public water supplies? | | | | X
- 9. Exposure of people or property to water-related hazards such as flooding or tidal waves? | | | | X
- 10. Significant changes in the temperature, flow or chemical content of surface thermal springs? | | | | X

D. Plant Life. Will the proposal result in:

- 1. Change in the diversity of species, or number of any species of plants (including trees, shrubs, grass, crops, and aquatic plants)? | | | | X
- 2. Reduction of the numbers of any unique, rare or endangered species of plants? | | | | X
- 3. Introduction of new species of plants into an area, or in a barrier to the normal replenishment of existing species? | | | | X
- 4. Reduction in acreage of any agricultural crop? | | | | X

E. Animal Life. Will the proposal result in:

- 1. Change in the diversity of species, or numbers of any species of animals (birds, land animals including reptiles, fish and shellfish, benthic organisms, or insects)? | | | | X
- 2. Reduction of the numbers of any unique, rare or endangered species of animals? | | | | X
- 3. Introduction of new species of animals into an area, or result in a barrier to the migration or movement of animals? | | | | X
- 4. Deterioration to existing fish or wildlife habitat? | | | | X

F. Noise. Will the proposal result in:

- 1. Increase in existing noise levels? | | | | X
- 2. Exposure of people to severe noise levels? | | | | X

G. Light and Glare. Will the proposal result in:

- 1. The production of new light or glare? [] | | | X

H. Land Use. Will the proposal result in:

- 1. A substantial alteration of the present or planned land use of an area? | | | | X

I. Natural Resources. Will the proposal result in:

- 1. Increase in the rate of use of any natural resources? | | | | X
- 2. Substantial depletion of any nonrenewable resources? | | | | X

- J. Risk of Upset.** Does the proposal result in:
- | | | | |
|---|--------------------------|--------------------------|-------------------------------------|
| | Yes | Maybe | No |
| 1. A risk of an explosion or the release of hazardous substances (including, but not limited to, oil, pesticides, chemicals, or radiation) in the event of an accident or upset conditions? | <input type="checkbox"/> | <input type="checkbox"/> | <input checked="" type="checkbox"/> |
| 2. Possible interference with emergency response plan or an emergency evacuation plan? | <input type="checkbox"/> | <input type="checkbox"/> | <input checked="" type="checkbox"/> |
- K. Population.** Will the proposal result in:
- | | | | |
|---|--------------------------|--------------------------|-------------------------------------|
| 1. The alteration, distribution, density, or growth rate of the human population of the area? | <input type="checkbox"/> | <input type="checkbox"/> | <input checked="" type="checkbox"/> |
|---|--------------------------|--------------------------|-------------------------------------|
- L. Housing.** Will the proposal result in:
- | | | | |
|---|--------------------------|--------------------------|-------------------------------------|
| 1. Affecting existing housing, or create a demand for additional housing? | <input type="checkbox"/> | <input type="checkbox"/> | <input checked="" type="checkbox"/> |
|---|--------------------------|--------------------------|-------------------------------------|
- M. Transportation/Circulation.** Will the proposal result in:
- | | | | |
|---|--------------------------|--------------------------|-------------------------------------|
| 1. Generation of substantial additional vehicular movement? | <input type="checkbox"/> | <input type="checkbox"/> | <input checked="" type="checkbox"/> |
| 2. Affecting existing parking facilities, or create a demand for new parking? | <input type="checkbox"/> | <input type="checkbox"/> | <input checked="" type="checkbox"/> |
| 3. Substantial impact upon existing transportation systems? | <input type="checkbox"/> | <input type="checkbox"/> | <input checked="" type="checkbox"/> |
| 4. Alterations to present patterns of circulation or movement of people and/or goods? | <input type="checkbox"/> | <input type="checkbox"/> | <input checked="" type="checkbox"/> |
| 5. Alterations to waterborne, rail, or air traffic? | <input type="checkbox"/> | <input type="checkbox"/> | <input checked="" type="checkbox"/> |
| 6. Increase in traffic hazards to motor vehicles, bicyclists, or pedestrians? | <input type="checkbox"/> | <input type="checkbox"/> | <input checked="" type="checkbox"/> |
- N. Public Services.** Will the proposal have an effect upon, or result in a need for new or altered governmental services in any of the following areas:
- | | | | |
|---|--------------------------|--------------------------|-------------------------------------|
| 1. Fire protection? | <input type="checkbox"/> | <input type="checkbox"/> | <input checked="" type="checkbox"/> |
| 2. Police protection? | <input type="checkbox"/> | <input type="checkbox"/> | <input checked="" type="checkbox"/> |
| 3. Schools? | <input type="checkbox"/> | <input type="checkbox"/> | <input checked="" type="checkbox"/> |
| 4. Parks and other recreational facilities? | <input type="checkbox"/> | <input type="checkbox"/> | <input checked="" type="checkbox"/> |
| 5. Maintenance of public facilities, including roads? | <input type="checkbox"/> | <input type="checkbox"/> | <input checked="" type="checkbox"/> |
| 6. Other governmental services? | <input type="checkbox"/> | <input type="checkbox"/> | <input checked="" type="checkbox"/> |
- O. Energy.** Will the proposal result in:
- | | | | |
|---|--------------------------|--------------------------|-------------------------------------|
| 1. Use of substantial amounts of fuel or energy? | <input type="checkbox"/> | <input type="checkbox"/> | <input checked="" type="checkbox"/> |
| 2. Substantial increase in demand upon existing sources of energy, or require the development of new sources? | <input type="checkbox"/> | <input type="checkbox"/> | <input checked="" type="checkbox"/> |
- P. Utilities.** Will the proposal result in a need for new systems, or substantial alterations to the following utilities:
- | | | | |
|------------------------------------|--------------------------|--------------------------|-------------------------------------|
| 1. Power or natural gas? | <input type="checkbox"/> | <input type="checkbox"/> | <input checked="" type="checkbox"/> |
| 2. Communication systems? | <input type="checkbox"/> | <input type="checkbox"/> | <input checked="" type="checkbox"/> |
| 3. Water? | <input type="checkbox"/> | <input type="checkbox"/> | <input checked="" type="checkbox"/> |
| 4. Sewer or septic tanks? | <input type="checkbox"/> | <input type="checkbox"/> | <input checked="" type="checkbox"/> |
| 5. Storm water drainage? | <input type="checkbox"/> | <input type="checkbox"/> | <input checked="" type="checkbox"/> |
| 6. Solid waste and disposal? | <input type="checkbox"/> | <input type="checkbox"/> | <input checked="" type="checkbox"/> |
- Q. Human Health.** Will the proposal result in:
- | | | | |
|--|--------------------------|--------------------------|-------------------------------------|
| 1. Creation of any health hazard or potential health hazard (excluding mental health)? | <input type="checkbox"/> | <input type="checkbox"/> | <input checked="" type="checkbox"/> |
| 2. Exposure of people to potential health hazards? | <input type="checkbox"/> | <input type="checkbox"/> | <input checked="" type="checkbox"/> |
- R. Aesthetics.** Will the proposal result in:
- | | | | |
|--|--------------------------|--------------------------|-------------------------------------|
| 1. The obstruction of any scenic vista or view open to the public, or will the proposal result in the creation of an aesthetically offensive site open to public view? | <input type="checkbox"/> | <input type="checkbox"/> | <input checked="" type="checkbox"/> |
|--|--------------------------|--------------------------|-------------------------------------|
- S. Recreation.** Will the proposal result in:
- | | | | |
|---|--------------------------|--------------------------|-------------------------------------|
| 1. An impact upon the quality or quantity of existing recreational opportunities? | <input type="checkbox"/> | <input type="checkbox"/> | <input checked="" type="checkbox"/> |
|---|--------------------------|--------------------------|-------------------------------------|

T. Cultural Resources:

Yes Maybe No

- 1. Will the proposal result in the alteration of or the destruction of a prehistoric or historic archeological site?
- 2. Will the proposal result in adverse physical or aesthetic effects to a prehistoric or historic building, structure, or object?
- 3. Does the proposal have the potential to cause a physical change which would affect unique ethnic cultural values?
- 4. Will the proposal restrict existing religious or sacred uses within the potential impact area?

U. Mandatory Findings of Significance:

- 1. Does the project have the potential to degrade the quality of the environment, reduce the habitat of a fish or wildlife species, cause a fish or wildlife population to drop below self-sustaining levels, threaten to eliminate a plant or animal community, reduce the number or restrict the range of a rare or endangered plant or animal or eliminate important examples of the major periods of California history or prehistory?
- 2. Does the project have the potential to achieve short term, to the disadvantage of long-term, environmental goals?
- 3. Does the project have impacts which are individually limited, but cumulatively considerable?
- 4. Does the project have environmental effects which will cause substantial adverse effects on human beings, either directly or indirectly?

III. DISCUSSION OF ENVIRONMENTAL EVALUATION (See Comments Attached)

IV. PRELIMINARY DETERMINATION

On the basis of this initial evaluation:

- I find the proposed project **COULD NOT** have a significant effect on the environment, and a **NEGATIVE DECLARATION** will be prepared.
- I find that although the proposed project could have a significant effect on the environment, there will not be a significant effect in this case because the mitigation measures described on an attached sheet have been added to the project. A **NEGATIVE DECLARATION** will be prepared.
- I find the proposed project **MAY** have a significant effect on the environment, and an **ENVIRONMENTAL IMPACT REPORT** is required.

Date: 2 / 9 / 89

Jed J. Sukashima
For the State Lands Commission

CALENDAR PAGE	142.14
MINUTE PAGE	258.8