

MINUTE ITEM
This Calendar Item No. C11
was approved as Minute Item
No. 11 by the State Lands
Commission by a vote of 3
to 0 at its 2/6/89
meeting.

CALENDAR ITEM

A 2
S 2

C11

02/06/89
W 24004 PRC 7270
Bancroft

PUBLIC AGENCY PERMIT AND RIGHT-OF-WAY MAP

APPLICANT: California Department
of Transportation
Attn: Jackie Yee
P.O. Box 7791
San Francisco, California 94120-7791

AREA, TYPE LAND AND LOCATION:
An approximate 0.414-acre parcel of sovereign
land, located in the Russian River at
Guerneville, Sonoma County.

LAND USE: Highway purposes pursuant to Section 101.5 of
the Streets and Highways Code, specifically for
use and occupation of lands underlying a
proposed bridge on State Route 116, crossing
the Russian River.

TERMS OF PROPOSED PERMIT:
Indefinite period from date the permit is
executed on behalf of the State Lands
Commission.

CONSIDERATION: As set forth by Section 101.5, Streets and
Highways Code and the public use and benefit.

BASIS FOR CONSIDERATION:
Pursuant to 2 Cal. Code Regs. 2003.

STATUTORY AND OTHER REFERENCES:
A. P.R.C.. Div. 6, Parts 1 and 2; Div. 13.

CALENDAR ITEM NO. C 11 (CONT'D)

- B. Cal. Code Regs.: Title 2, Div. 3;
Title 14, Div. 6.
- C. Section 101.5 of the Streets and Highways
Code.

AB 884: 03/12/89.

OTHER PERTINENT INFORMATION:

1. Staff received a notice from the California Department of Transportation (DOT) in June 1987 regarding proposed replacement of the Route 116 bridge at Guerneville. No record of a permit for the existing bridge was found and, therefore, staff notified DOT of the need to obtain a permit under Section 101.5 of the Streets and Highways Code.
2. The annual rental value of the site is estimated to be \$1,494.
3. A Negative Declaration was prepared and adopted for this project by California Department of Transportation (DOT). The State Lands Commission's staff has reviewed such document and believes that it complies with the requirements of the CEQA.

EXHIBITS:

- A. Right-of-Way Map.
- B. Location Map.
- C. Negative Declaration

IT IS RECOMMENDED THAT THE COMMISSION:

1. FIND THAT A NEGATIVE DECLARATION WAS PREPARED AND ADOPTED FOR THIS PROJECT BY CALIFORNIA DEPARTMENT OF TRANSPORTATION AND THAT THE COMMISSION HAS REVIEWED AND CONSIDERED THE INFORMATION CONTAINED THEREIN.
2. DETERMINE THAT THE PROJECT, AS APPROVED, WILL NOT HAVE A SIGNIFICANT EFFECT ON THE ENVIRONMENT.
3. APPROVE THE MAP FILED BY CALIFORNIA DEPARTMENT OF TRANSPORTATION PURSUANT TO SECTION 101.5 OF THE STREETS AND HIGHWAYS CODE, AS SHOWN ON EXHIBIT "A" ATTACHED AND BY REFERENCE MADE A PART HEREOF.

CALENDAR ITEM NO. C11 (CONT'D)

4. AUTHORIZE ISSUANCE TO CALIFORNIA DEPARTMENT OF TRANSPORTATION OF A PUBLIC AGENCY PERMIT FOR AN INDEFINITE PERIOD FROM THE DATE THE PERMIT IS EXECUTED ON BEHALF OF THE STATE LANDS COMMISSION FOR HIGHWAY PURPOSES ON THE LAND DESCRIBED ON EXHIBIT "A" ATTACHED AND BY REFERENCE MADE A PART HEREOF.

DATE	NAME	SCALE	NO.
04 SON	116	12.1	42

Rita P. ...
REGISTERED CIVIL ENGINEER
September 30, 1988
REVISION DATE

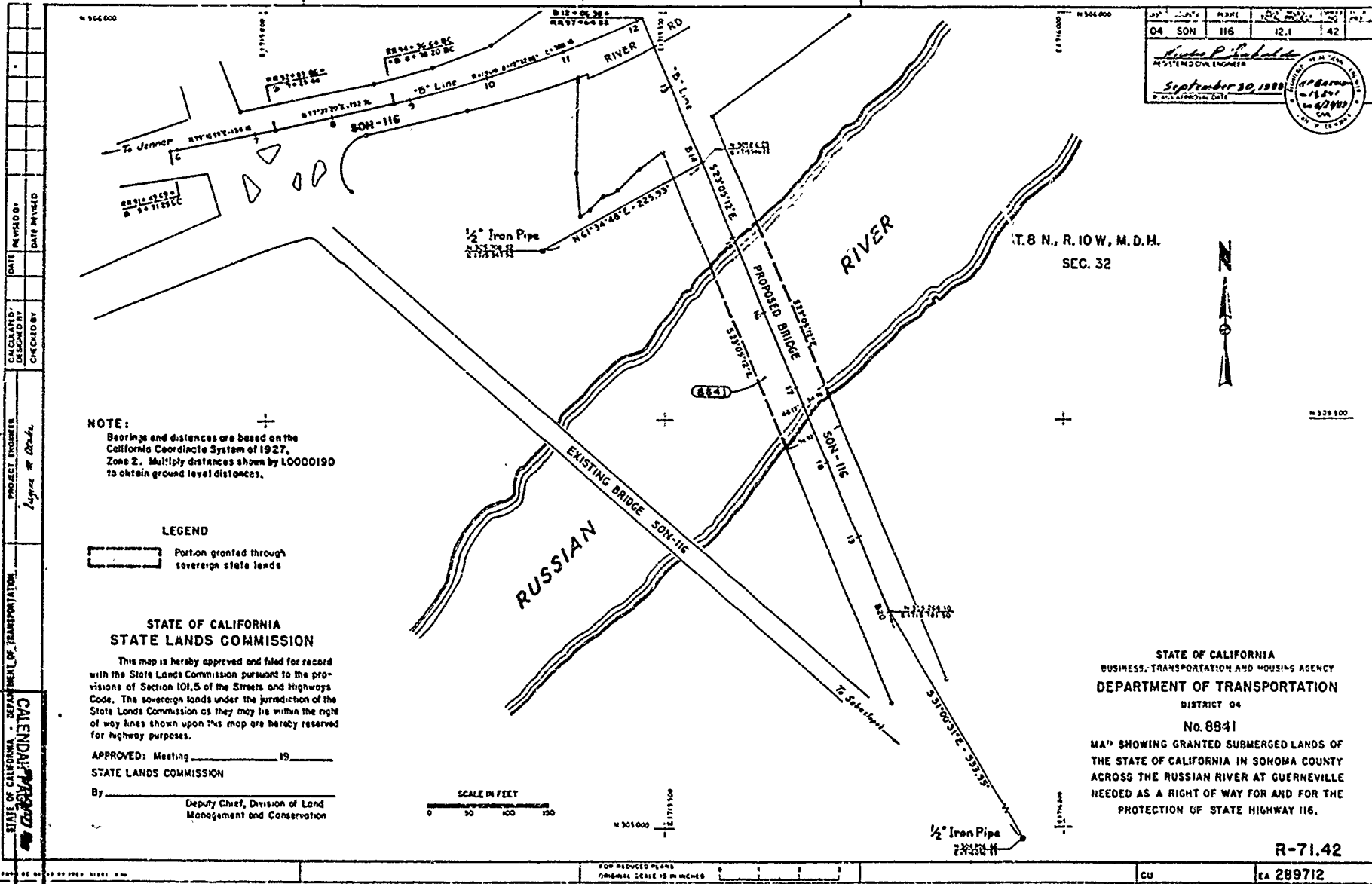

PROJECT ENGINEER: *Lynne M. ...*

INITIATION: _____

CALENDAR PAGE: 53

MINUTE PAGE: 064

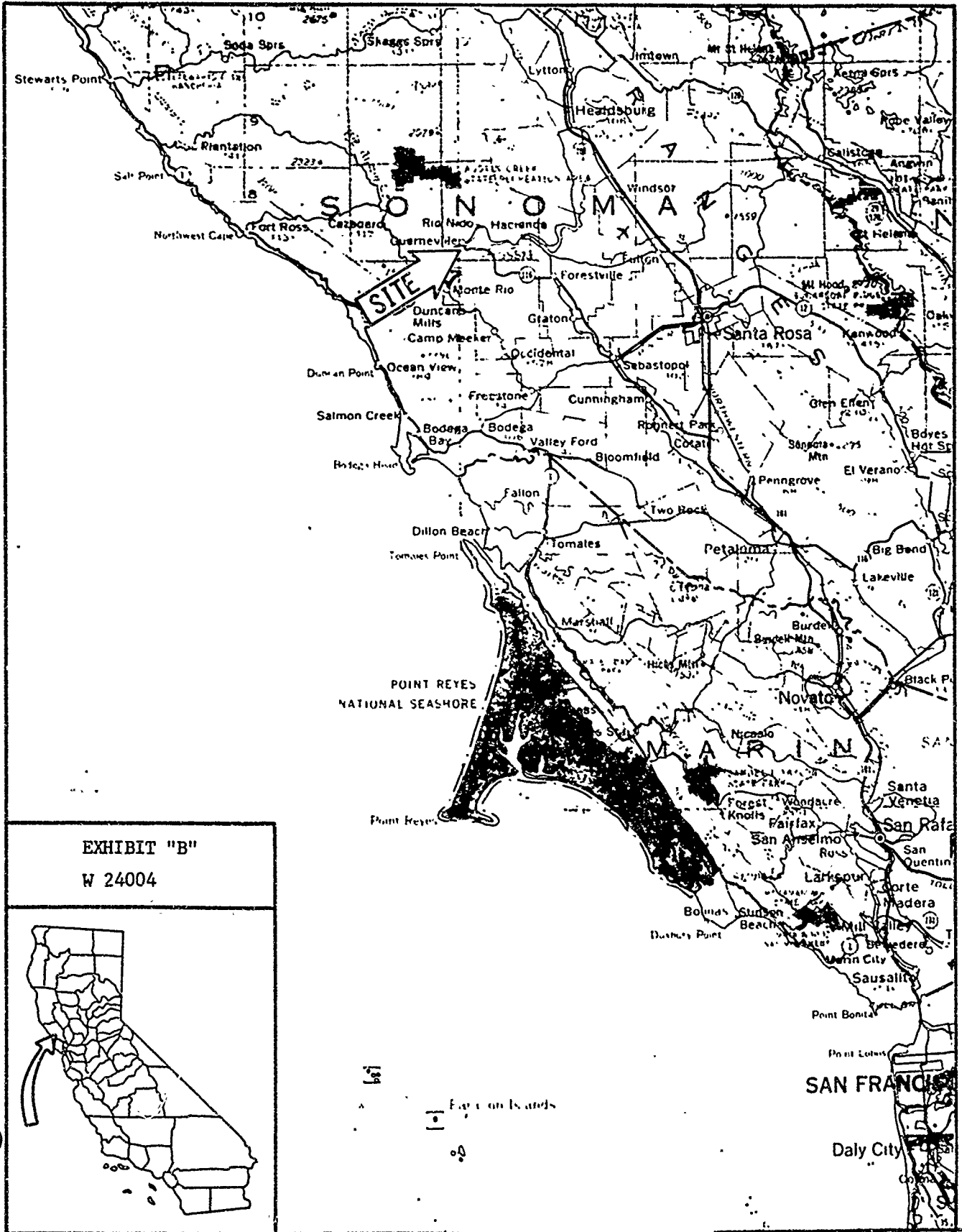

EXHIBIT "B"
W 24004



EXHIBIT C

STATE OF CALIFORNIA
DEPARTMENT OF TRANSPORTATION

SCH No. 83072615
4-Son-116 12.1/12.7
4223 - 289710

NEGATIVE DECLARATION (CEQA)

Pursuant to: Division 13, Public Resources Code

Project Description

Replacement of the bridge over the Russian River at Guerneville with a concrete structure providing two 12-foot lanes, 6-foot shoulders and a 5-foot sidewalk, and barriers for a total of 45.2 feet; reconstruction of the intersection at the north end of the existing bridge and the formation of a new intersection at the crossing of the new bridge approach and River Road; both intersections will have traffic signals. A new connection road will be built between River Road and Old Rio Nido Road.

Determination

An Initial Study has been prepared by the California Department of Transportation (Caltrans). On the basis of this study, it is determined that the proposed action will not have a significant effect upon the environment for the following reasons:

Increased river turbidity will be avoided through restrictions on construction activities in and near the live stream, meeting permit requirements, and using erosion control measures. Construction-related effects will be held to the minimum level consistent with good construction practices.

Removal of riparian vegetation will be limited, and vegetation will be restored at the new bridge site and the site of the existing bridge after it is removed. Work in the stream will be limited to times and methods that avoid impacts on anadromous fish. The project will not affect any rare and endangered species.

Several residential units and three businesses would be displaced. Some of these units are presently in State ownership or are in seasonal use. Relocation is expected to require use only of standard assistance programs.

Although a number of trees will be removed and some fill will be needed, protection of trees where possible in the final design and additional revegetation will reduce long-term visual impacts to an insignificant level.

Traffic congestion in central Guerneville is expected to be reduced. No increase in highway capacity is proposed. The project will not affect 4(f) land or any important farmland. The project will not significantly affect a floodplain or any wetlands.

There will be no significant effects on air, noise, and water quality. The project will not significantly change the rate of use of any natural resources.

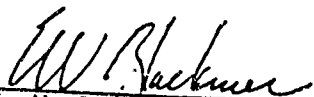
E. W. BLACKMER, Chief
Environmental Analysis
California Department of Transportation

APR 15, 1988
Date

CALENDAR PAGE	55
MINUTE PAGE	066

FEDERAL HIGHWAY ADMINISTRATION
FINDING OF NO SIGNIFICANT IMPACT

FOR

Replacement of Russian River Br. No. 20-91 and Realignment of
Route 116 from PM 12.1 to 12.4 - Guerneville, Sonoma County

The FHWA has determined that this project will not have any significant impact on the human environment. This finding of no significant impact is based on the attached environmental assessment, which has been independently evaluated by the FHWA and determined to adequately and accurately discuss the environmental issues and impacts of the proposed project. It provides sufficient evidence and analysis for determining that an environmental impact statement is not required. The FHWA assumes responsibility for the accuracy, scope, and content of the attached environmental assessment.

7-5-88
Date

For Bruce E. Cannon
Division Administrator

District Engineer
Title