

MINUTE ITEM  
This Calendar Item No. 51  
was approved as Minute Item  
No. 51 by the State Lands  
Commission by a vote of 3  
to 0 at its 12/13/88  
meeting.

CALENDAR ITEM

A 68

51

12/14/88

W 40469 PRC 7269

Pelka

S 36

NEGOTIATED MINERAL EXTRACTION LEASE  
RIVERSIDE COUNTY

APPLICANT: Alfredo A. Figueroa  
424 N. Carlton  
Blythe, California 92225

AREA, TYPE OF LAND AND LOCATION:

Vacant, State-owned, school land further described as follows: The N 1/2, N 1/2 of the SW 1/4, SW 1/4 of the SW 1/4, Lots 1, 2, 3, 4, 5 and 6, Section 36, Township 3 South, Range 20 East, San Bernardino Base and Meridian, eastern Riverside County.

LAND USE:

Surface mining of "driftwood stone", a variety of decorative rock. The stone is gathered by hand and placed in the bucket of a front end loader. Prior to loading into a dump truck any stone which is not of a salable dimension is split with a chisel and hammer. The material is transported to the Midland Santa Fe Railroad siding five miles away for sale. Access will be confined to existing roads and jeep trails. No blasting, ripping or road construction is required.

TERMS OF PROPOSED LEASE:

Initial Period: Annual rent shall be \$1 per acre or fraction thereof for a total of \$544 per year for the first five (5) lease-years. Annual rent shall be adjusted to \$1.50 per acre for a total of \$816 per year beginning with the sixth lease-year.

CALENDAR ITEM NO. 51 (CONT'D)

Royalty:

(a) Ten percent of the gross value of the "driftwood stone" production from the leased lands, less any charges that are made or incurred with respect to transporting or processing the State's royalty share of production. The minimum annual royalty shall never be less than \$2.90 per ton. This minimum annual royalty shall adjust to \$3.20 per ton beginning with the sixth year of the lease term.

(b) Minimum annual production shall be 600 tons per lease-year.

(c) Minimum annual royalty commencing with the first lease-year shall be \$1,740. This minimum royalty shall increase to \$1,920 beginning with the sixth year of lease term.

Term:

(d) The lease term shall be ten years. The lease may be renewed for one additional ten-year period upon such reasonable terms and conditions as may be prescribed by the State including, but not limited to, compliance with CEQA, modification of royalty, rental and bonding provisions and any other provisions which will adequately protect the interests of the State. Lease renewal is at the sole discretion of the State.

Bond:

(e) Lessee shall furnish and maintain a continuous bond in

CALENDAR ITEM NO. 51 (CONT'D)

the sum of \$3,000, guaranteeing faithful performance by Lessee of the terms, covenants and conditions of the lease.

PREREQUISITE CONDITIONS, FEES, AND EXPENSES:

Filing fee, processing fee and executed lease documents have been received.

STATUTORY AND OTHER REFERENCES:

A. P.R.C.: Div. 6, Section 6897.

B. Cal. Adm. Code: Title 2, Section 2200.

AB 884:

N/A.

OTHER PERTINENT INFORMATION:

1. Pursuant to the Commission's delegation of authority and the State CEQA Guidelines (14 Cal. Adm. Code 15061), the staff has prepared and circulated for public review a proposed Negative Declaration identified as EIR ND 435, State Clearinghouse No. 87082411 pursuant to the provision of the CEQA. A copy of this environmental document is attached as Exhibit "C".

Based upon the initial study, the proposed Negative Declaration and the comments received in response thereto, there is no substantial evidence that the project will have a significant effect on the environment (14 Cal. Adm. Code 15074[b]).

2. The market for "driftwood stone" is limited due to available substitute building materials and synthetics. Staff believes a negotiated mineral extraction lease is in the best interest of the State. The Applicant has mined "driftwood stone" since 1952 and has an established market. The Applicant has the necessary equipment and expertise to properly mine the State parcel. He has mined "driftwood stone" on the adjacent federally managed land since

CALENDAR ITEM NO. 51 (CONT'D)

1984 under an approved Plan of Operations, through which existing access to the State parcel is obtained.

APPROVALS OBTAINED:

Pursuant to P.R.C. Section 6890, the subject lease application has been approved by the Office of the Attorney General as to compliance with the applicable provisions of the law.

EXHIBITS:

- A. Land Description.
- B. Site Map.
- C. Negative Declaration.

IT IS RECOMMENDED THAT THE COMMISSION:

1. CERTIFY THAT NEGATIVE DECLARATION EIR ND 435, STATE CLEARINGHOUSE NO. 87082411, WAS PREPARED FOR THIS PROJECT PURSUANT TO THE PROVISIONS OF THE CEQA AND THAT THE COMMISSION HAS REVIEWED AND CONSIDERED THE INFORMATION CONTAINED THEREIN.
2. DETERMINE THAT THE PROJECT, AS DESCRIBED IN THE PROPOSED LEASE, WILL NOT HAVE A SIGNIFICANT EFFECT ON THE ENVIRONMENT.
3. DETERMINE THAT THE LANDS DESCRIBED IN THE PERMIT ARE KNOWN TO CONTAIN COMMERCIALY VALUABLE DEPOSITS OF "DRIFTWOOD STONE".
4. AUTHORIZE THE ISSUANCE OF A NEGOTIATED MINERAL EXTRACTION LEASE AS DESCRIBED HEREIN TO ALFREDO A. FIGUEROA FOR A TERM OF TEN YEARS, FOR "DRIFTWOOD STONE" ON N 1/2, N 1/2 OF SW 1/4, SW 1/4 OF SW 1/4, LOTS 1, 2, 3, 4, 5 AND 6, SECTION 36, T3S, R20E, SBM, APPROXIMATELY 543.79 ACRES; IN ACCORDANCE WITH THE STANDARD FORM OF LEASE; ANNUAL RENTAL SHALL BE \$544, ADJUSTING TO \$816 ON THE SIXTH YEAR OF THE LEASE TERM; ROYALTY SHALL BE TEN PERCENT (10%) OF THE GROSS VALUE OF THE "DRIFTWOOD STONE" FROM THE LEASED LANDS, LESS ANY CHARGES THAT ARE MADE OR INCURRED WITH RESPECT TO TRANSPORTING OR PROCESSING THE STATE'S ROYALTY SHARE OF PRODUCTION, BUT NEVER LESS THAN \$2.90 PER TON, ADJUSTING TO \$3.20 PER TON ON THE SIXTH YEAR OF THE LEASE TERM.

EXHIBIT "A"

LAND DESCRIPTION

W 40469

A parcel of California State school lands in Riverside County, California, described as follows:

The N 1/2, N 1/2 of SW 1/4, SW 1/4 of SW 1/4, and  
Lots 1, 2, 3, 4, 5, & 6 of Section 36, T3S, R20E, SBM.

END OF DESCRIPTION

PREPARED JULY 6, 1987 BY BIU 1.

0513b

CALENDAR PAGE	274
MINUTE PAGE	3494

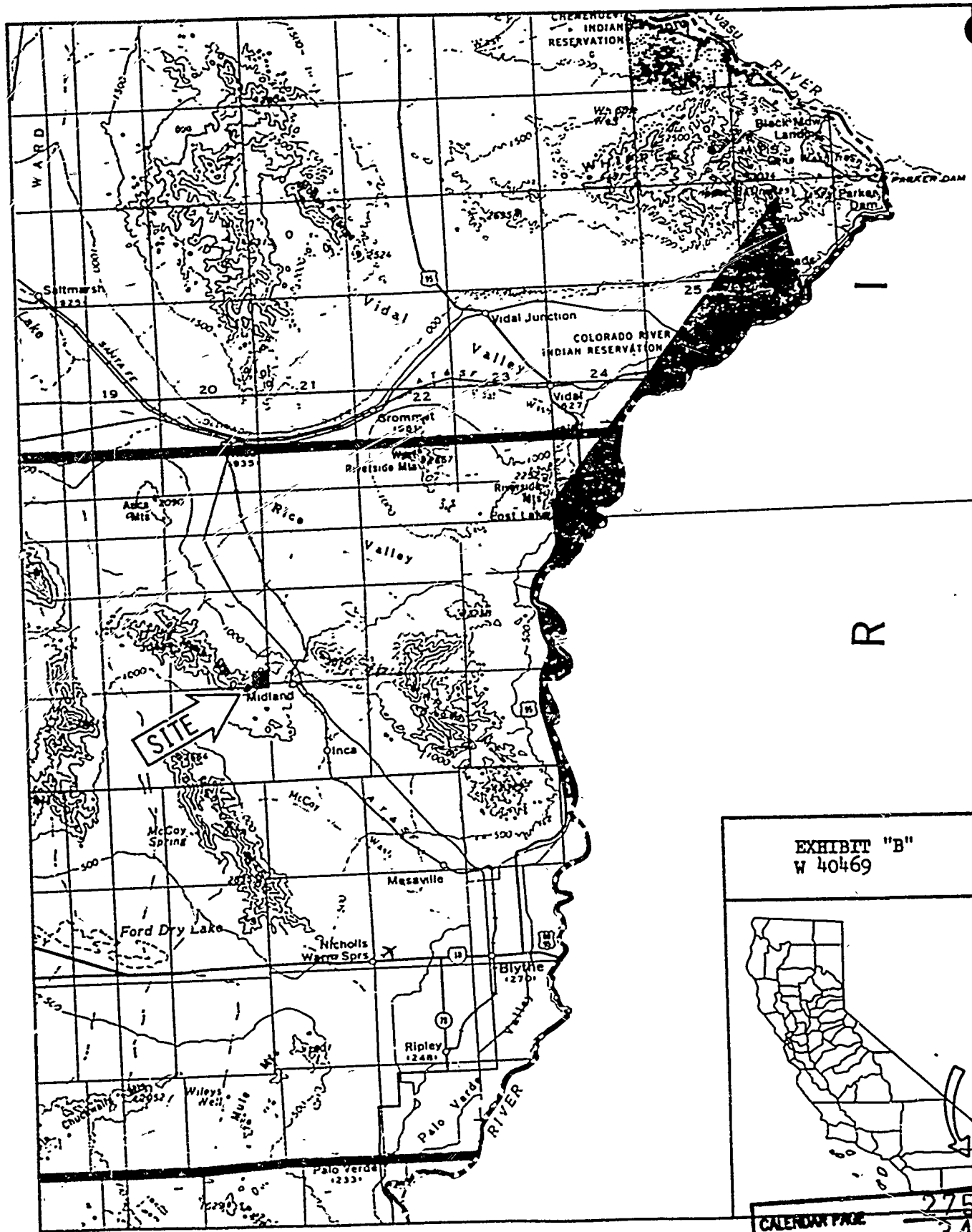

I  
 R



EXHIBIT "B"  
 W 40469





STATE LANDS COMMISSION  
1807 13TH STREET  
SACRAMENTO, CALIFORNIA 95814

EXHIBIT C  
PROPOSED NEGATIVE DECLARATION

EIR ND 435

File Ref.: W 40469

SCH#: 8708 2411

Project Title: Mineral Extraction Lease

Project Proponent: Alfredo A. Figueroa

Project Location: N $\frac{1}{2}$  of N $\frac{1}{2}$  of SW $\frac{1}{4}$ , SW $\frac{1}{4}$  of SW $\frac{1}{4}$ , and Lots 1,2,3,4,5, and 6, Section 36, T.3 S., R.20 E., S.B.M., approximately 20 miles northwest of the town of Blythe, Riverside County.

Project Description: Surface mining of approximately 50 tons per week of Driftwood decorative stone from approximately 20 sites involving 10 to 15 acres each. The material is gathered by hand and placed in the bucket of a front end loader. The material is transferred to a dump truck and taken to the Midland Santa Fe Railroad siding two miles away. No blasting, ripping, or road construction is required.

Contact Person: TED T. FUKUSHIMA Telephone: (916)322-7813

This document is prepared pursuant to the requirements of the California Environmental Quality Act (Section 21000 et seq., Public Resources Code), the State CEQA Guidelines (Section 15000 et seq., Title 14, California Administrative Code), and the State Lands Commission regulations (Section 2901 et seq., Title 2, California Administrative Code).

Based upon the attached Initial Study, it has been found that:

the project will not have a significant effect on the environment.

mitigation measures included in the project will avoid potentially significant effects.

CALNDAR PAGE	276
MINUTE PAGE	3496

MITIGATION MEASURES

Proposed for Incorporation into the Project Description

1. Access to the twenty extraction sites shall be confined to existing roads and jeep trails. Scraping or smoothing of the surface with mechanized equipment shall be restricted to the minimum required for the safety of personnel and equipment. No new road construction is permitted.
2. To minimize the production of fugitive dust, all vehicle speed shall not exceed 20 mph.
3. Lessee shall perform all activities so as to minimize impact on vegetation. No vegetation may be removed.
4. Access routes and areas of surface disturbance shall be inspected to determine if burrowing animals are present and would be adversely affected. If potential impacts could occur, activities should be located where burrows and wildlife would not be adversely affected. The lessee should specifically avoid burrowing areas of the desert tortoise, a State protected species.



Letter

**RIVERSIDE COUNTY  
PLANNING DEPARTMENT**

October 22, 1987

State Lands Commission  
245 West Broadway, Suite 425  
Long Beach, CA 90802  
Attn: E. E. Kruger

SUBJECT: Response to Initial Study  
Figueroa Brothers Mining & Decorative Stone  
Section 36, T35, R20E, S88B1  
Little Maria Mountains

Dear Mr. Kruger:

We have reviewed your initial study prepared for a proposed mineral extraction lease on State of California land by Figueroa Brothers Mining and Decorative Stone.

- 1 Based upon the information provided in your initial study, the project impacts and mitigation measures identified, it appears that a negative declaration is an appropriate response for this project.
- 2 Please note that the operation may be required to secure a Surface Mining Permit before commencing operations. This will depend upon the specific nature of the operation and the proposed volumes to be mined. Enclosed is a copy of Ordinance 555, an Ordinance of Riverside County Implementing the Surface Mining and Reclamation Act of 1975.

Very truly yours,

RIVERSIDE COUNTY PLANNING DEPARTMENT  
Roger S. Streeter, Planning Director

*SAK*  
Steven A. Kupferman,  
Engineering Geologist  
CEG - 1205

Response

1 Comment noted.

2 See Riverside County Planning Department letter dated January 21, 1988.

ck:dl  
enclosure

CALENDAR PAGE
MINUTE PAGE
278
3498

1000 MON STREET 9 - FLOOR  
RIVERSIDE, CALIFORNIA 92501  
(916) 776181

46-209 OASIS STREET, ROOM 304  
INDIO, CALIFORNIA 92201  
(619) 342-8277

Letter

**RIVERSIDE COUNTY  
PLANNING DEPARTMENT**

January 21, 1988

Figueroa Bros. Mining & Decorative Stone  
424 North Carlton  
Blythe, California 92225

Dear Mr. Figueroa:

Based upon our meeting in December, 1987 at the Planning Department offices in Riverside and subsequent telephone discussions, it appears that you do not need to apply for a Surface Mining Permit for your decorative stone gathering project located in the Little Maria Mountains (Section 36, T3S, R20E), near Midland.

Your description of the nature of the work and the pictures that you provided indicate that your operation is one of gathering decorative stone (approximately 12-24 inches in diameter), loading the rock by hand into a loader bucket, and hauling the rock to a nearby highway dump truck for transportation offsite. In the future if your method of operation changes to include excavation, blasting and/or significant expansion and road building, you may then be required to submit an application for a surface mining permit.

Please do not hesitate to call me at (714) 787-1377 if you have any questions.

Very truly yours,

RIVERSIDE COUNTY PLANNING DEPARTMENT  
Roger S. Streeter - Planning Director

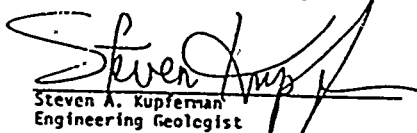
  
Steven A. Kupferman  
Engineering Geologist

SAX:rd  
c.c. Statelands Commission, Greg Pelka  
U.S. Gypsum Co., D. B. Jorgensen

Response

1 Comment noted.

CALENDAR PAGE  
279  
13499  
MINUTE PAGE

30 LEMON STREET, 9<sup>TH</sup> FLOOR  
RIVERSIDE, CALIFORNIA 92501  
(714) 787-6181

46-209 OASIS STREET, ROOM 304  
INDIO, CALIFORNIA 92201  
(619) 342-0277

Letter

GEORGE DEUKERIAN, Governor

DEPARTMENT OF CONSERVATION

Division of Administration  
Division of Mines and Geology  
Division of Oil and Gas



1216 Ninth Street  
SACRAMENTO, CA 95814

OCT 21 1987

Mr. E. L. Kruger  
State Lands Commission  
245 West Broadway, Suite 425  
Long Beach, CA 90802

Dear Mr. Kruger:

Figueroa Brothers Mining and Decorative Stone  
File Ref. W40469, SCH No. 87082411

The Mine Reclamation Program staff of the Department of Conservation's Division of Mines and Geology has reviewed the documents submitted for the Figueroa Brothers Decorative Stone mine. Mine Reclamation Program files were also reviewed. The following comments prepared by James Pompy and Stephen Bezore of the Mine Reclamation Program staff are offered to assist in your review of this project.

The Initial Study does not include a mine reclamation plan for this mining project, and we find no record of one in our files. While a number of the items addressed in the Initial Study are pertinent to mine reclamation, a complete reclamation plan was not included in the documents submitted.

The Surface Mining and Reclamation Act of 1975 (SMARA) and the State Mining and Geology Board regulations for the surface mining and reclamation practice (California Administrative Code (CAC) Title 14, Chapter 8, Article 1, Section 3500 et seq.) (copies enclosed) require that a permit be obtained from, and a reclamation plan be submitted to and approved by, the lead agency prior to the start of any mining operations.

If requested, our Mine Reclamation staff will provide technical assistance in the review of the reclamation plan.

MINUTE PAGE  
CALENDAR PAGE  
280  
3500

Letter

Mr. E. L. Kruger  
Page Two

The Mine Reclamation Program maintains a file of lead agency approved plans. Please send a copy of the final reclamation plan and the mining permit for this project.

If you have any questions on these comments or require any assistance with other mine reclamation issues, please contact James Pompy, Mine Reclamation Program Manager, at (916) 323-8565.

Sincerely,

*Dennis J. O'Bryant*

Dennis J. O'Bryant  
Environmental Program Coordinator

Enclosures

Response

1 See Riverside County Planning Department letter dated January 21, 1988

Letter

STATE OF CALIFORNIA

GEORGE DEUKMEJIAN Governor

CALIFORNIA REGIONAL WATER QUALITY CONTROL BOARD

COLORADO RIVER BASIN - REGION 7

75-271 HIGHWAY 111, SUITE 21

PALM DESERT, CALIFORNIA 92260

Phone (619) 346-7491



Response

October 19, 1987

State Lands Commission  
235 West Broadway, Suite 425  
Long Beach, CA 90802

Attn: Mr. E.L. Kruger

Subj: SCH #57082411, Initial Study File Ref: W40469

Review of the subject Initial Study by this office indicates this project would not utilize or impact surface or ground water resources. Therefore, a Negative Declaration could be sufficient as far as this office is concerned.

1 Comment noted.

Should you need any additional information, please contact Gale Madyun at (619) 346-7491.

GALE MADYUN  
Engineering Geologist

GM/tv

File Ref: Initial Study - San Bernardino Co.



October 2, 1987

4:39 PM

Letter

Response

## Cabazon Band Of Mission Indians

84-245 Indio Springs Drive  
Indio, Ca. 92201

October 2, 1987

D. J. Everitt  
Assistant Chief,  
Executive Development Program  
State Lands Commission  
245 West Broadway, Suite 425  
Long Beach, CA 90802

Att: Mr. E. L. Kruger

Subject: Consultation Pursuant to Section 2080.3 of the Public Resources Code

Dear Mr. Kruger,

1 Comment noted.

The Cabazon Band of Mission Indians takes the position regarding the subject matter that a Negative Declaration (ND) should be sufficient for this project. We appreciate your taking our comments on this project into consideration.

Sincerely,

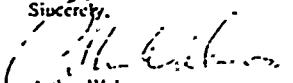
  
Arthur Welmas  
Tribal Chairman

AW:mld

CALENDAR PAGE	282
MINUTE PAGE	3502

File Ref.: W 40469  
SCH#: 87082411  
Date: 9/22/87

INITIAL STUDY  
Section 36, T3S, R20E, SBB&M

Introduction

Figueroa Brothers Mining & Decorative Stone has requested a mineral extraction lease from the State Lands Commission on a property in the southeast part of the Little Maria Mountains, about 25 miles northwest of the eastern Riverside County community of Blythe, California.

The proposed project consists of the surface extraction of California Driftwood Decorative Stone from 20 sites at higher elevations along a ridge northwest of the abandoned Brown Mine. At each of the proposed extraction sites, the stone will be gathered by hand and placed into the bucket of a front-end loader. The stone is then transferred by hand to a dump truck and transported three miles east to a Santa Fe Railroad siding near the old Midland townsite.

The general area surrounding the proposed project is known as the Ironwood Mining District and has been active since 1929. Currently, there are two surface mining operations adjacent to the proposed project. To the north in Section 25, Figueroa Brothers Mining has been extracting decorative stone since 1983 from a federal property under Bureau of Land Management jurisdiction. The extraction method being used in Section 25 is similar to the method described on pages 8 and 9 of this study. To the south and west in portions of the northeast part of T4S, R20E, SBB&M, Superior Gypsum has been extracting gypsum from an open pit operation since 1979.

This Initial Study consists of the following items:

Mailing List (pgs. 4-5).

A small-scale map of the general vicinity of the project area (pg. 6).

A large-scale map of the immediate vicinity of the project area (pg. 7).

Project description (pgs. 8-9).

Environmental setting (pgs. 10-11).

Applicant's assessment of environmental impacts and certification (pg. 12).

State Lands Commission's assessment of environmental impacts, discussion and mitigating measures (pgs. 13-17).

Mailing list - W 40469

Ann Geraghty  
Air Resources Board  
1131 S Street  
Sacramento, CA 95814

Dennis O'Bryant  
Department of Conservation  
1416 Ninth Street, Rm 1326-2  
Sacramento, CA 95814

Charlotte Oakes  
Department of Health  
714 P Street, Rm 1253  
Sacramento, CA 95814

William A. Johnson  
Native American Heritage Commission  
915 Capital Mall, Rm 288  
Sacramento, CA 95814

Hans Kreutzberg  
Office of Historic Preservation  
P.O. Box 942896  
Sacramento, CA 94296

James M. Doyle  
Department of Parks and Recreation  
P.O. Box 942896  
Sacramento, CA 94296

Ed Anton  
State Water Resources  
Control Board  
Division of Water Quality  
P.O. Box 100  
Sacramento, CA 95801

Regional Manager  
Department of Fish & Game  
245 W. Broadway, Suite 350  
Long Beach, CA 90802  
Attn: Jack Spruill

Regional Water Quality  
Control Board  
15371 Bonanza Road  
Victorville, CA 92392

Bill Havert  
Sierra Club  
568 N. Mountain View Ave., Suite 130  
San Bernardino, CA 92401

Dr. Kristen Berry  
California Desert District  
1695 Spruce Street  
Riverside, CA 92507

Evelyn St. Amant  
Desert Tortoise Council  
5319 Cerritos Avenue  
Long Beach, CA 90805

Greg Ouellette  
Western Mining Council  
2051 Pacific Avenue  
Norco, CA 91760

Robert Collins  
Deputy Attorney General  
Office of the Attorney General  
3580 Wilshire Blvd.  
Los Angeles, CA 90010

Dept. of Transportation  
Dist. 11  
2829 Juan St.  
San Diego, CA 92110

Steve Kupferman  
Riverside County  
Planning Dept.  
4080 Lemon St., 9th Floor  
Riverside, CA 92501

Fred Shuster  
Bureau of Land Management  
1900 Tahquitz - McCallum Way, Ste. B1  
Palm Spring, CA 92262

Figueroa Brothers Mining  
424 N. Carlton  
Blythe, CA 92225

Authur Welmas  
Cabazon Band of Mission Indians  
84-245 Indio Springs Dr.  
Indio, CA 92201



Mailing List - W 40469 (Cont.)

Ray Patencio  
Agua Caliente Reservation  
960 E. Tahquitz Way, Suite 106  
Palm Springs, CA 92262

Harvey Duvo  
Torres-Martinez Band of Mission Indians  
66-725 Martinez Rd.  
Thermal, CA 92274

Jeff Sharpe  
Sierra Club  
14944 Lana Road  
Victorville, CA 92392

Superior Gypsum  
P. O. Box 909  
Blythe, CA 92226

U. S. Gypsum Co.  
101 S. Wacker Dr.  
Chicago, IL 60606

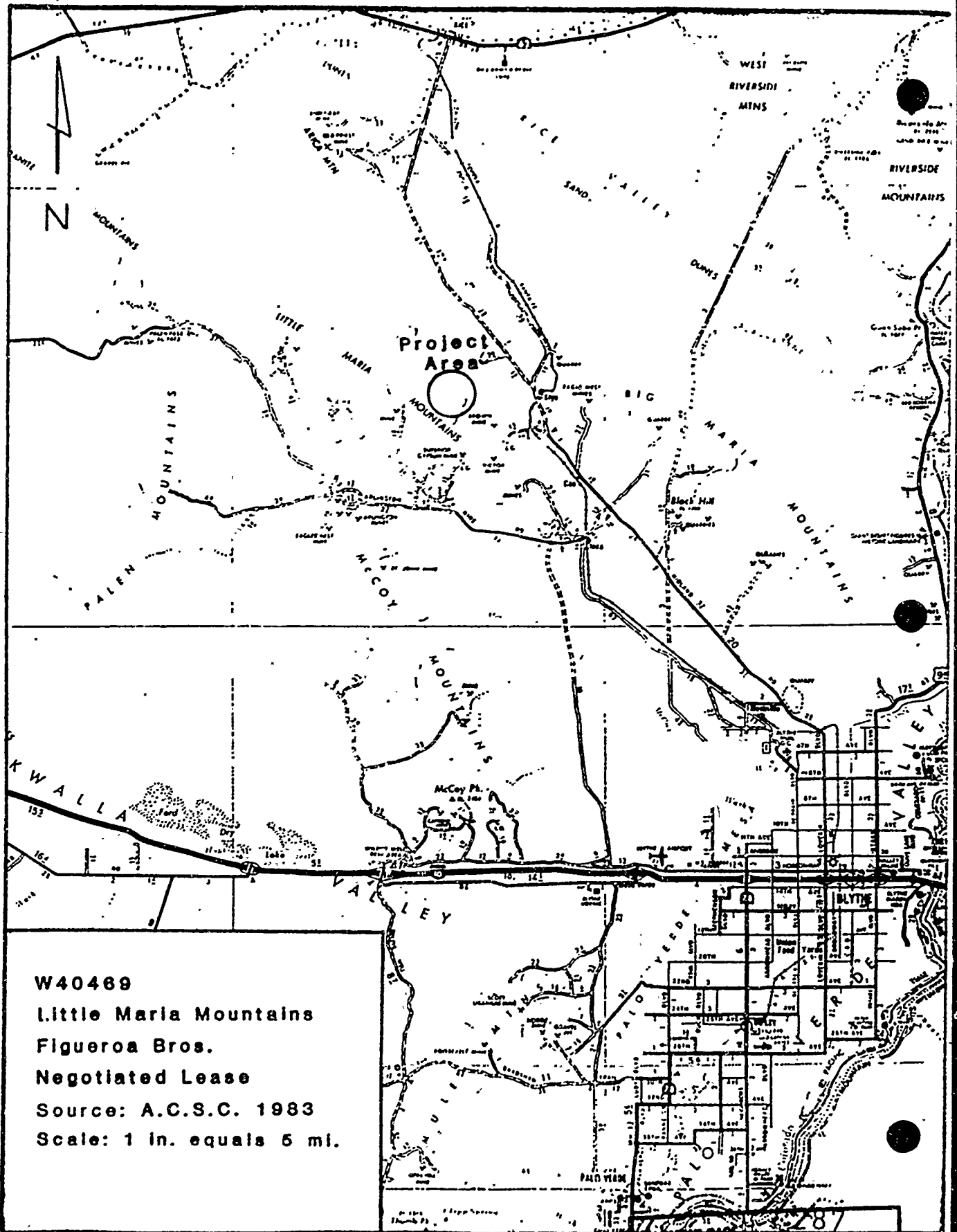

287  
 3507  
 MINUTE PAGE

W 40469

T3S, R20E, Sec. 36 SBB&M

Midland 15' Quad (1952)

Scale: 1 in. equals 2,200 ft.

 Extraction Sites

 Current Mining Activity

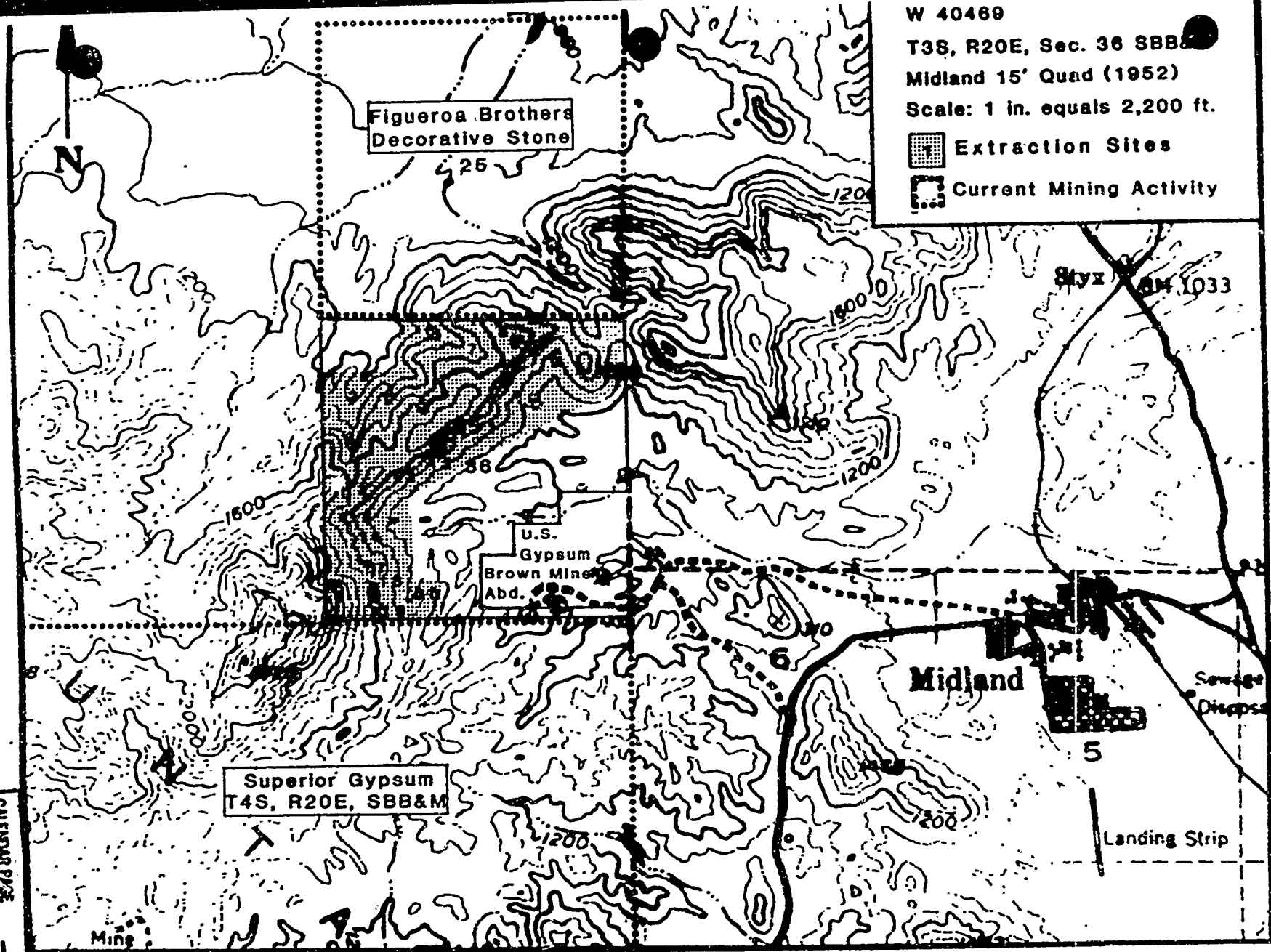

CALENDAR PAGE 288  
 MINUTE PAGE 3508

Project Description

1. Figueroa Brothers propose to conduct the extraction of surface Driftwood stone from the higher elevations of the leased area.
2. There are approximately 20 sites on the property where the extraction operation will take place. These sites cover approximately 12 to 15 acres each and are mostly near existing roads and trails (see attached map).
3. Equipment necessary for the extraction operation includes:

<u>Type</u>	<u>No.</u>
Catapillar 955 Front-end loader	1
HD 4 AC Front-end loader	1
Ten wheel Dump truck	1
Utility truck	1

4. At each site, the stone will be gathered by hand. No blasting or ripping is necessary. Surface disturbance will be confined to the extraction sites.
5. The stone will be split to a thickness of six inches and placed by hand into the bucket of a front-end loader.
6. The stone is then transferred from the loader to a dump truck and taken to the old Midland siding of the Santa Fe Railroad for shipment.
7. Most of the commercial-grade stone located within the section is on a high ridge and some bulldozing is needed to reach it.
8. Stone that is inaccessible to the front-end loader will be hand lifted into a 1/4-ton bucket pulled by a chain hoist and trammed on 3/4-inch cable to the loader.
9. Hauling routes for the trucks will be over existing dirt roads. Vehicle traffic will be kept to a minimum and at a speed of 20 miles per hour.
10. Very little new road construction on the property is necessary due to numerous existing dirt roads.

11. No permanent structures are planned for the property.
12. There is a metal gate on the main road leading to Section 36. The gate will be locked during non-working hours and a watchman will be posted.
13. The stone selected for commercial use is lifted by hand to avoid degradation and debris. No scraping of the landscape is necessary. Desert vegetation and animal life will be protected to the fullest degree.
14. The average weekly tonnage is estimated to be 50 tons.
15. The extraction sites will be cleaned of all trash and debris upon completion of the work.
16. Figueroa Brothers will perform all activities on the property to minimize impact on vegetation. No vegetation will be removed.
17. Access routes and areas of surface disturbance will be inspected to determine if burrowing animals are present and will be adversely effected.
18. The number of workers on the lease area for the proposed project will be 4 to 5.

## Environmental Setting

1. describe the project area as it exists before the project, include information on

- a. surface features:

most of the section is on the east side slope of the Redtail peak, Ele. 2720 ft., and a ridge running through the middle of the section; it is extremely craggy and rough terrain with washes and canyons on the north side; flat ground borders the U.S. Gypsum quarries on the south side with some existing old roads and pathways.

- b. animal life:

chuckawallas, lizards and rattlesnakes

- c. plant life:

very few desert shrubs, octillo, and greasewood; the rest is barren land.

- d. cultural, historical or scenic aspects:

it has no cultural, historical or scenic aspects.

- e. any existing structures and their use:

no existing structures on the land.

2. describe the surrounding area within 1-2 miles, include information on

- a. surface features:

is mostly the same as described above on 1.a. with a southeast side, existing road leading to the old U.S. Gypsum quarry and to the Midland town site; the southwest corner is one mile from the Superior Gypsum claims and their quarry is approximately 1 1/2 miles from section 36.

b. animal life:

same as above in 1.b. with some coyotes roaming the area.

c. plant life:

same as above in 1.c.

d. cultural, historical or scenic aspects:

no cultural aspects, the historical aspects are the old Midland townsite, the railroad siding and the old quarries of U.S. Gypsum.

e. any existing structures and their use:

none.

f. indicate the type of land use, refer to Riverside County Planning and Zoning Department:

Midland town site is W-210, section 36 and surrounding area are N-A.

g. indicate if there are Wilderness Study Areas (WSA) in the surrounding vicinity of the project:

Big Maria Mountains WSA-321  
Palen-McCoy Mountains WSA-325.

## APPLICANT'S ASSESSMENT OF ENVIRONMENTAL IMPACTS

All phases of a project, such as planning, acquisition, development and operation, shall be considered when evaluating its impact on the environment. Please answer the following questions by placing a check in the appropriate box. (Discuss all items checked "yes" or "maybe" on additional sheet(s).)

Will the project involve	YES	MAYBE	NO
1. A change in existing features of any bays, tidelands, beaches, lakes or hills, or substantial alteration of ground contours? . . . . .	[ ]	[ ]	[X]
2. A change in scenic views from existing residential areas or public lands or roads? . . . . .	[ ]	[ ]	[X]
3. A change in pattern, scale or character of the general area of the project? . . . . .	[ ]	[ ]	[X]
4. Significant effect on plant or animal life? . . . . .	[ ]	[ ]	[X]
5. Significant amounts of solid waste or litter? . . . . .	[ ]	[ ]	[X]
6. A change in dust, ash, smoke, fumes or odors in the vicinity? . . . . .	[ ]	[ ]	[X]
7. A change in ocean, bay, lake, stream or ground water quality or quantity, or an altering of existing drainage patterns? . . . . .	[ ]	[ ]	[X]
8. A change in existing noise or vibration levels in the vicinity? . . . . .	[ ]	[ ]	[X]
9. Construction on filled land or on a slope of 10 percent or more? . . . . .	[ ]	[ ]	[X]
10. Use or disposal of potentially hazardous materials such as toxic or radioactive substances, flammables or explosives? . . . . .	[ ]	[ ]	[X]
11. A change in demand for municipal services (e.g., police, fire, water, sewage)? . . . . .	[ ]	[ ]	[X]
12. Increase in fossil fuel consumption (e.g., electricity, oil, natural gas)? . . . . .	[ ]	[ ]	[X]
13. A larger project or a series of projects? . . . . .	[ ]	[ ]	[X]

### APPLICANT'S CERTIFICATION

I hereby certify that the statements furnished above and in the attached exhibits present the data and information required for this initial evaluation to the best of my ability, and that the facts, statements, and information presented are true and correct to the best of my knowledge and belief.

Date: 8-4-87

Signed: Alberto P. Figueroa

CALENDAR PAGE	293
MINUTE PAGE	3513



ENVIRONMENTAL IMPACT ASSESSMENT CHECKLIST - PART II

Form 13.20 (7/82)

File Ref.: W40469

I. BACKGROUND INFORMATION

A. Applicant: Figuerca Brothers Mining and Decorative Stone  
424 North Carlton  
Blythe, California 92225  
619-922-6422

B. Checklist Date: 08 / 14 / 87

Contact Person: E. L. Kruger  
 Telephone: ( 213 ) 590-5201

D. Purpose: Surface extraction of California Driftwood Stone

E. Location: Section 36, T3S, R20E, SBB&M

F. Description: Stone will be extracted from the surface of the higher elevations  
by hand, loaded and then transported off the leased area to a  
railroad siding near the old Midland townsite.

G. Persons Contacted:  
Chris Lal  
Department of Fish and Game  
245 W. Broadway, Ste. 350, IB, CA 90802  
Steve Kupferman  
Riverside County Planning Dept.  
4080 Lemon St., Riverside, CA 92501

II. ENVIRONMENTAL IMPACTS. (Explain all "yes" and "maybe" answers)

A. Earth. Will the proposal result in:	Yes	Maybe	No
1. Unstable earth conditions or changes in geologic substructures? .....	<input type="checkbox"/>	<input type="checkbox"/>	<input checked="" type="checkbox"/>
2. Disruptions, displacements, compaction, or overcovering of the soil? .....	<input type="checkbox"/>	<input checked="" type="checkbox"/>	<input type="checkbox"/>
3. Change in topography or ground surface relief features? .....	<input type="checkbox"/>	<input checked="" type="checkbox"/>	<input type="checkbox"/>
4. The destruction, covering, or modification of any unique geologic or physical features? .....	<input type="checkbox"/>	<input type="checkbox"/>	<input checked="" type="checkbox"/>
5. Any increase in wind or water erosion of soils, either on or off the site? .....	<input type="checkbox"/>	<input type="checkbox"/>	<input checked="" type="checkbox"/>
6. Changes in deposition or erosion of beach sands, or changes in siltation, deposition or erosion which may modify the channel of a river or stream or the bed of the ocean or any bay, inlet, or lake? .....	<input type="checkbox"/>	<input type="checkbox"/>	<input checked="" type="checkbox"/>
7. Exposure of all people or property to geologic hazards such as earthquakes, landslides, or similar hazards? .....	<input type="checkbox"/>	<input type="checkbox"/>	<input checked="" type="checkbox"/>

CALENDAR PAGE 294  
 MINUTE PAGE 3514

	Yes	Maybe	No
<b>B. Air.</b> Will the proposal result in:			
1. Substantial air emissions or deterioration of ambient air quality?	<input type="checkbox"/>	<input type="checkbox"/>	<input checked="" type="checkbox"/>
2. The creation of objectionable odors?	<input type="checkbox"/>	<input type="checkbox"/>	<input checked="" type="checkbox"/>
3. Alteration of air movement, moisture or temperature, or any change in climate, either locally or regionally?	<input type="checkbox"/>	<input type="checkbox"/>	<input checked="" type="checkbox"/>
<b>C. Water.</b> Will the proposal result in:			
1. Changes in the currents, or the course or direction of water movements, in either marine or fresh waters?	<input type="checkbox"/>	<input type="checkbox"/>	<input checked="" type="checkbox"/>
2. Changes in absorption rates, drainage patterns, or the rate and amount of surface water runoff?	<input type="checkbox"/>	<input type="checkbox"/>	<input checked="" type="checkbox"/>
3. Alterations to the course or flow of flood waters?	<input type="checkbox"/>	<input type="checkbox"/>	<input checked="" type="checkbox"/>
4. Change in the amount of surface water in any water body?	<input type="checkbox"/>	<input type="checkbox"/>	<input checked="" type="checkbox"/>
5. Discharge into surface waters, or in any alteration of surface water quality, including but not limited to temperature, dissolved oxygen or turbidity?	<input type="checkbox"/>	<input type="checkbox"/>	<input checked="" type="checkbox"/>
6. Alteration of the direction or rate of flow of ground waters?	<input type="checkbox"/>	<input type="checkbox"/>	<input checked="" type="checkbox"/>
7. Change in the quantity of ground waters, either through direct additions or withdrawals, or through interception of an aquifer by cuts or excavations?	<input type="checkbox"/>	<input type="checkbox"/>	<input checked="" type="checkbox"/>
8. Substantial reduction in the amount of water otherwise available for public water supplies?	<input type="checkbox"/>	<input type="checkbox"/>	<input checked="" type="checkbox"/>
9. Exposure of people or property to water-related hazards such as flooding or tidal waves?	<input type="checkbox"/>	<input type="checkbox"/>	<input checked="" type="checkbox"/>
10. Significant changes in the temperature, flow or chemical content of surface thermal springs?	<input type="checkbox"/>	<input type="checkbox"/>	<input checked="" type="checkbox"/>
<b>D. Plant Life.</b> Will the proposal result in:			
1. Change in the diversity of species, or number of any species of plants (including trees, shrubs, grass, crops, and aquatic plants)?	<input type="checkbox"/>	<input type="checkbox"/>	<input checked="" type="checkbox"/>
2. Reduction of the numbers of any unique, rare or endangered species of plants?	<input type="checkbox"/>	<input type="checkbox"/>	<input checked="" type="checkbox"/>
3. Introduction of new species of plants into an area, or in a barrier to the normal replenishment of existing species?	<input type="checkbox"/>	<input type="checkbox"/>	<input checked="" type="checkbox"/>
4. Reduction in acreage of any agricultural crop?	<input type="checkbox"/>	<input type="checkbox"/>	<input checked="" type="checkbox"/>
<b>E. Animal Life.</b> Will the proposal result in:			
1. Change in the diversity of species, or numbers of any species of animals (birds, land animals including reptiles, fish and shellfish, benthic organisms, or insects)?	<input type="checkbox"/>	<input type="checkbox"/>	<input checked="" type="checkbox"/>
2. Reduction of the numbers of any unique, rare or endangered species of animals?	<input type="checkbox"/>	<input type="checkbox"/>	<input checked="" type="checkbox"/>
3. Introduction of new species of animals into an area, or result in a barrier to the migration or movement of animals?	<input type="checkbox"/>	<input type="checkbox"/>	<input checked="" type="checkbox"/>
4. Deterioration to existing fish or wildlife habitat?	<input type="checkbox"/>	<input type="checkbox"/>	<input checked="" type="checkbox"/>
<b>F. Noise.</b> Will the proposal result in:			
1. Increase in existing noise levels?	<input checked="" type="checkbox"/>	<input type="checkbox"/>	<input type="checkbox"/>
2. Exposure of people to severe noise levels?	<input type="checkbox"/>	<input type="checkbox"/>	<input checked="" type="checkbox"/>
<b>G. Light and Glare.</b> Will the proposal result in:			
1. The production of new light or glare?	<input type="checkbox"/>	<input type="checkbox"/>	<input checked="" type="checkbox"/>
<b>H. Land Use.</b> Will the proposal result in:			
1. A substantial alteration of the present or planned use of an area?	<input type="checkbox"/>	<input type="checkbox"/>	<input checked="" type="checkbox"/>
<b>I. Natural Resources.</b> Will the proposal result in:			
1. Increase in the rate of use of any natural resources?	<input checked="" type="checkbox"/>	<input type="checkbox"/>	<input type="checkbox"/>
2. Substantial depletion of any nonrenewable resources?	<input type="checkbox"/>	<input type="checkbox"/>	<input checked="" type="checkbox"/>

- |   | Yes                      | Maybe                    | No                                  |
|---|--------------------------|--------------------------|-------------------------------------|
| <b>J. Risk of Upset</b> Does the proposal result in   |                          |                          |                                     |
| 1. A risk of an explosion or the release of hazardous substances (including, but not limited to, oil, pesticides, chemicals, or radiation) in the event of an accident or upset conditions? | <input type="checkbox"/> | <input type="checkbox"/> | <input checked="" type="checkbox"/> |
| 2. Possible interference with emergency response plan or an emergency evacuation plan?  | <input type="checkbox"/> | <input type="checkbox"/> | <input checked="" type="checkbox"/> |
| <b>K. Population.</b> Will the proposal result in:  |                          |                          |                                     |
| 1. The alteration, distribution, density, or growth rate of the human population of the area?   | <input type="checkbox"/> | <input type="checkbox"/> | <input checked="" type="checkbox"/> |
| <b>L. Housing.</b> Will the proposal result in:   |                          |                          |                                     |
| 1. Affecting existing housing, or create a demand for additional housing?   | <input type="checkbox"/> | <input type="checkbox"/> | <input checked="" type="checkbox"/> |
| <b>M. Transportation/Circulation.</b> Will the proposal result in:  |                          |                          |                                     |
| 1. Generation of substantial additional vehicular movement?   | <input type="checkbox"/> | <input type="checkbox"/> | <input checked="" type="checkbox"/> |
| 2. Affecting existing parking facilities, or create a demand for new parking?   | <input type="checkbox"/> | <input type="checkbox"/> | <input checked="" type="checkbox"/> |
| 3. Substantial impact upon existing transportation systems?   | <input type="checkbox"/> | <input type="checkbox"/> | <input checked="" type="checkbox"/> |
| 4. Alterations to present patterns of circulation or movement of people and/or goods?   | <input type="checkbox"/> | <input type="checkbox"/> | <input checked="" type="checkbox"/> |
| 5. Alterations to waterborne, rail, or air traffic?   | <input type="checkbox"/> | <input type="checkbox"/> | <input checked="" type="checkbox"/> |
| 6. Increase in traffic hazards to motor vehicles, bicyclists, or pedestrians?   | <input type="checkbox"/> | <input type="checkbox"/> | <input checked="" type="checkbox"/> |
| <b>N. Public Services.</b> Will the proposal have an effect upon, or result in a need for new or altered governmental services in any of the following areas:                               |                          |                          |                                     |
| 1. Fire protection?   | <input type="checkbox"/> | <input type="checkbox"/> | <input checked="" type="checkbox"/> |
| 2. Police protection?   | <input type="checkbox"/> | <input type="checkbox"/> | <input checked="" type="checkbox"/> |
| 3. Schools?   | <input type="checkbox"/> | <input type="checkbox"/> | <input checked="" type="checkbox"/> |
| 4. Parks and other recreational facilities?   | <input type="checkbox"/> | <input type="checkbox"/> | <input checked="" type="checkbox"/> |
| 5. Maintenance of public facilities, including roads?   | <input type="checkbox"/> | <input type="checkbox"/> | <input checked="" type="checkbox"/> |
| 6. Other governmental services?   | <input type="checkbox"/> | <input type="checkbox"/> | <input checked="" type="checkbox"/> |
| <b>O. Energy.</b> Will the proposal result in:  |                          |                          |                                     |
| 1. Use of substantial amounts of fuel or energy?  | <input type="checkbox"/> | <input type="checkbox"/> | <input checked="" type="checkbox"/> |
| 2. Substantial increase in demand upon existing sources of energy, or require the development of new sources?   | <input type="checkbox"/> | <input type="checkbox"/> | <input checked="" type="checkbox"/> |
| <b>P. Utilities.</b> Will the proposal result in a need for new systems, or substantial alterations to the following utilities:   |                          |                          |                                     |
| 1. Power or natural gas?  | <input type="checkbox"/> | <input type="checkbox"/> | <input checked="" type="checkbox"/> |
| 2. Communication systems?   | <input type="checkbox"/> | <input type="checkbox"/> | <input checked="" type="checkbox"/> |
| 3. Water?   | <input type="checkbox"/> | <input type="checkbox"/> | <input checked="" type="checkbox"/> |
| 4. Sewer or septic tanks?   | <input type="checkbox"/> | <input type="checkbox"/> | <input checked="" type="checkbox"/> |
| 5. Storm water drainage?  | <input type="checkbox"/> | <input type="checkbox"/> | <input checked="" type="checkbox"/> |
| 6. Solid waste and disposal?  | <input type="checkbox"/> | <input type="checkbox"/> | <input checked="" type="checkbox"/> |
| <b>Q. Human Health.</b> Will the proposal result in:  |                          |                          |                                     |
| 1. Creation of any health hazard or potential health hazard (excluding mental health)?  | <input type="checkbox"/> | <input type="checkbox"/> | <input checked="" type="checkbox"/> |
| 2. Exposure of people to potential health hazards?  | <input type="checkbox"/> | <input type="checkbox"/> | <input checked="" type="checkbox"/> |
| <b>R. Aesthetics.</b> Will the proposal result in:  |                          |                          |                                     |
| 1. The obstruction of any scenic vista or view open to the public, or will the proposal result in the creation of an aesthetically offensive site open to public view?                      | <input type="checkbox"/> | <input type="checkbox"/> | <input checked="" type="checkbox"/> |
| <b>S. Recreation.</b> Will the proposal result in:  |                          |                          |                                     |
| 1. An impact upon the quality or quantity of existing recreational opportunities?   | <input type="checkbox"/> | <input type="checkbox"/> | <input checked="" type="checkbox"/> |

CALENDAR PAGE 296  
MINUTE PAGE 3516

- I. Cultural Resources** Yes    Maybe    No
1. Will the proposal result in the alteration of or the destruction of a prehistoric or historic archaeological site? | | | | X
  2. Will the proposal result in adverse physical or aesthetic effects to a prehistoric or historic building, structure, or object? | | | | X
  3. Does the proposal have the potential to cause a physical change which would affect unique ethnic cultural values? | | | | X
  4. Will the proposal restrict existing religious or sacred uses within the potential impact area? | | | | X

- U. Mandatory Findings of Significance.**
1. Does the project have the potential to degrade the quality of the environment, reduce the habitat of a fish or wildlife species, cause a fish or wildlife population to drop below self-sustaining levels, threaten to eliminate a plant or animal community, reduce the number or restrict the range of a rare or endangered plant or animal or eliminate important examples of the major periods of California history or prehistory?  | | | X
  2. Does the project have the potential to achieve short term, to the disadvantage of long-term, environmental goals?   X
  3. Does the project have impacts which are individually limited, but cumulatively considerable?   X
  4. Does the project have environmental effects which will cause substantial adverse effects on human beings, either directly or indirectly?   X

**III. DISCUSSION OF ENVIRONMENTAL EVALUATION (See Comments Attached)**

- A.2. Some displacement or compaction of surface material may result from the clearing and smoothing operations of mechanized equipment insuring safe access for personnel and equipment.
- A.3. Some change in topography of the higher elevations may take place due to the extraction of 50 tons of material per week from the leased area.
- F.1. The operation of mechanized equipment will increase existing noise levels in the leased area during working hours.
- I.1. The extraction of decorative stone from the leased area will increase the natural resource use rate of marble occurring in the Paleozoic Maria Formation found in this part of the Little Maria Mountains.

**IV. PRELIMINARY DETERMINATION**

On the basis of this initial evaluation:

- I find the proposed project COULD NOT have a significant effect on the environment, and a NEGATIVE DECLARATION will be prepared.
- I find that although the proposed project could have a significant effect on the environment, there will not be a significant effect in this case because the mitigation measures described on an attached sheet have been added to the project. A NEGATIVE DECLARATION will be prepared.
- I find the proposed project MAY have a significant effect on the environment, and an ENVIRONMENTAL IMPACT REPORT is required.

Date:        /        /

W40469  
MITIGATION MEASURES

1. Surface disturbance will be kept to a minimum.
2. All extraction sites will be cleaned of trash and debris upon completion of work.
3. Lessee will notify State Lands Commission two weeks prior to commencing operations.
4. Lessee will perform all work activities in order to minimize impact on vegetation.
5. No vegetation will be destroyed or removed from State property.
6. Vehicle speed on dirt roads will not exceed 20 miles per hour to minimize dust and insure personnel safety.
7. No new road construction will be permitted.
8. Clearing or smoothing of the surface with mechanized equipment will be restricted to a minimum necessary to insure the safety of personnel and equipment.
9. Access routes and areas of surface disturbance will be inspected to determine if burrowing animals are present and would be adversely affected.