

MINUTE ITEM  
This Calendar Item No. C15  
was approved as Minute Item  
No. 15 by the State Lands  
Commission by a vote of 2  
to 0 at its 6/30/87  
meeting.

CALENDAR ITEM

C15

06/30/87  
W 23183  
Jones, S

A 2

S 2

TIMBER SALE AGREEMENT IN MENDOCINO COUNTY

In furtherance of the timber management program endorsed at the May, 1980 Commission meeting, the staff has prepared a harvest plan and solicited sealed bids for the sale of an estimated 1,500 cords of hardwood timber within a 250-acre portion of State school land, five airmiles southeast of Dos Rios, Mendocino County.

One bid was received as shown on the attached Exhibit "C" and the bid at \$4.00/cord was submitted by Chris Lambert.

AB 884: N/A.

OTHER PERTINENT INFORMATION:

1. A Timber Harvesting Plan was prepared by Commission Staff and submitted to the California Department of Forestry (CDF) for review and approval.
2. The submitted environmental analysis document (Timber Harvest Plan) was certified for this project by the CDF under its certified program (14 Ca. Adm. Code 15251(a)).
3. Staff has reviewed the document and determined that the conditions, as specified in 14 Cal. Adm. Code 15253(b), have been met for the Commission to use the environmental analysis document certified by CDF as an EIR substitute in order to comply with the requirements of the CEQA.

CALENDAR ITEM NO. C 15 (CONT'D)

EXHIBITS.

- A. Land Description.
- B. Location Map.
- C. Summary of Bids.
- D. Timber Sale Boundary Map.
- E. Approved Timber Harvesting Plan.

IT IS RECOMMENDED THAT THE COMMISSION:

1. FIND THAT AN ENVIRONMENTAL ANALYSIS DOCUMENT (TIMBER HARVEST PLAN) WAS CERTIFIED FOR THIS PROJECT BY THE CALIFORNIA DEPARTMENT OF FORESTRY UNDER ITS CERTIFIED PROGRAM (14 CAL ADM. CODE 15251(a), THAT THE STATE LANDS COMMISSION HAS REVIEWED SUCH DOCUMENT AND THAT THE CONDITIONS AS SPECIFIED IN 14 CAL ADM. CODE 15253(b) HAVE BEEN MET.
2. DETERMINE THAT THE PROJECT, AS APPROVED, WILL NOT HAVE A SIGNIFICANT EFFECT ON THE ENVIRONMENT.
3. ACCEPT THE BID IN THE AMOUNT OF \$4.00/CORD AND AUTHORIZE ENTERING INTO A TIMBER SALE AGREEMENT WITH CHRIS LAMBERT FOR THE SALE OF 1,500 CORDS OF HARDWOOD TIMBER IN SECTIONS 22 AND 23, T21NR13W, MDM, MENDOCINO COUNTY, UPON PAYMENT IN FULL OF THE TOTAL BID PRICE.

EXHIBIT "A"

LAND DESCRIPTION

W 23183

A parcel of California State lieu lands near Salt Creek,  
Mendocino County, California, described as follows:

Lots 3-8, Section 22, T21N, R13W, M.D.M.

Lots 5, 12, 13, Section 23, T21N, R13W, M.D.M.

END OF DESCRIPTION

PREPARED MARCH 30, 1987, BY BOUNDARY SERVICES UNIT, M. L.  
SHAFFER, SUPERVISOR.

0406b

CALENDAR PAGE	73
MINUTE PAGE	1922

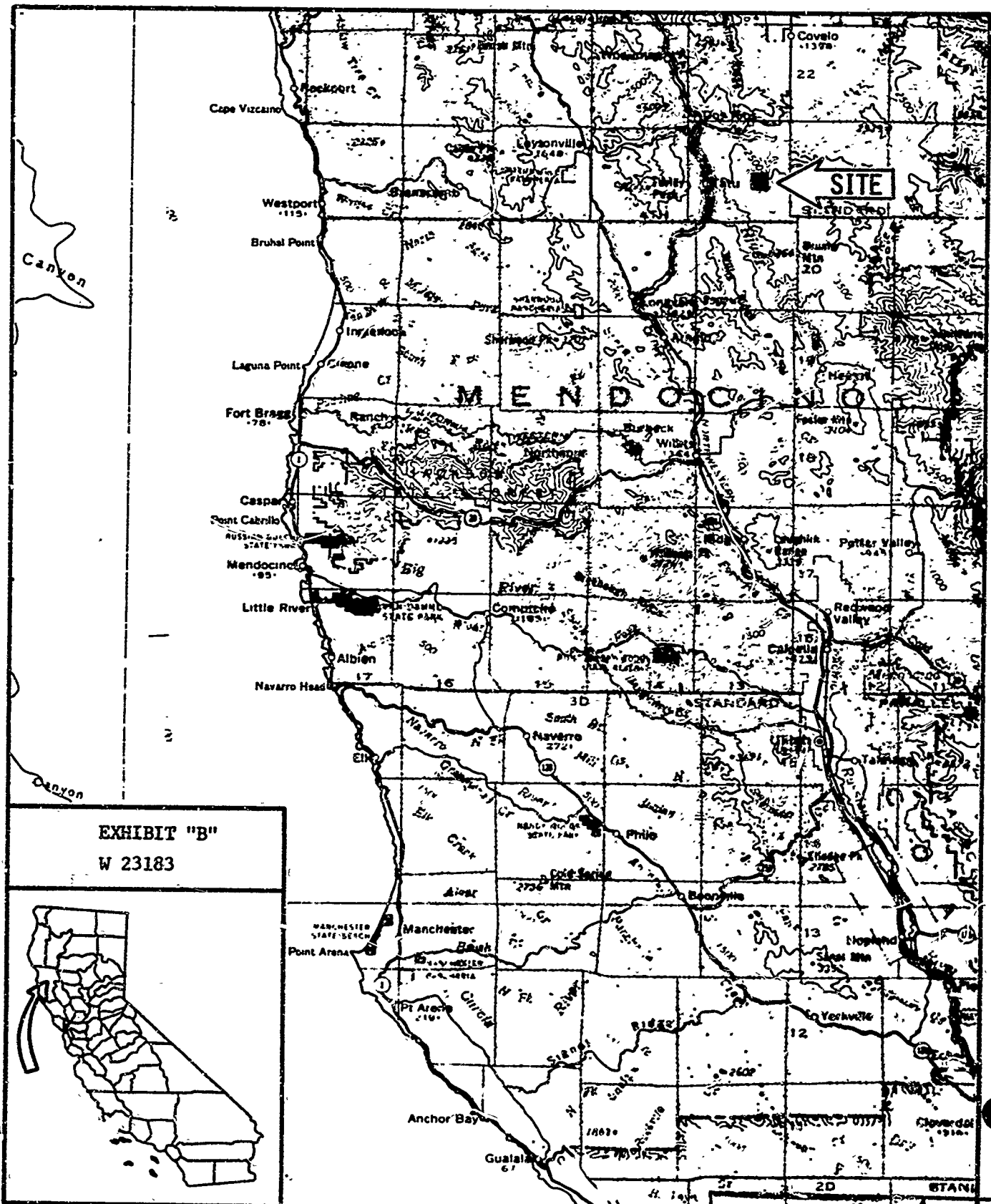

EXHIBIT "B"  
W 23183



CALENDAR PAGE  
MINUTE PAGE 1923

Bidding Record:

Salt Creek

Timber Sale

W23183

Species	Volume in Cords	Minimum Bid \$/Cord	Minimum Bid Extension	Bidder	Bidder	Bidder	Bidder	Bidder	Bidder
				Chris Lambert \$/Cord	\$/Cord	\$/Cord	\$/Cord	\$/Cord	\$/Cord
Hardwood	1500	\$0.00	\$0.00	\$4.00					
<b>Total</b>				\$6,000.00					

Witness to Proceedings

*Stephen M. Jones*

State Lands Commission Presiding Officer

State Lands Commission

State Lands Commission

Date: June 8, 1987Time: 10:00 a.m.Place: SacramentoCALENDAR PAGE  
MINUTE PAGE75  
1924

EXHIBIT "D"

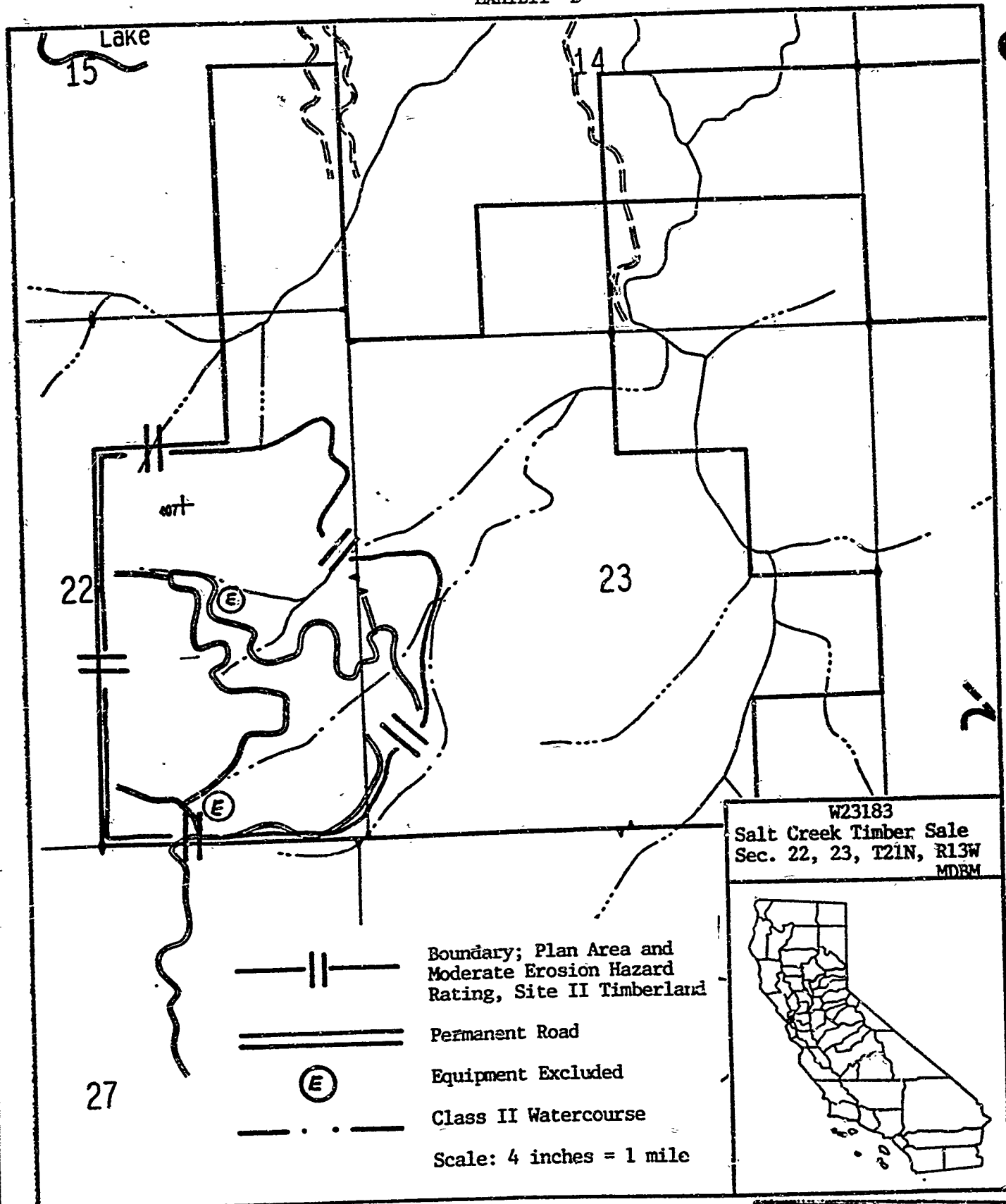

STATE OF CALIFORNIA  
DEPARTMENT OF FORESTRY  
RM-63(6/86)

EXHIBIT "E"  
TIMBER HARVESTING PLAN

Salt Creek  
W 23183

( FOR ADMINISTRATIVE USE ONLY  
( THP No. \_\_\_\_\_  
( Date Recd \_\_\_\_\_  
( Date Filed \_\_\_\_\_  
( Date Apprvd \_\_\_\_\_  
( \_\_\_\_\_

This Timber Harvesting Plan (THP) form, when properly completed, is designed to comply with the Forest Practice Act (FPA) and Board of Forestry rules. See separate instructions for information on completing this form. NOTE: The form must be printed legibly in ink or typewritten.

1. TIMBER OWNER(S): Name California State Lands Commission

Address 1807 13th Street

City Sacramento State CA Zip 95814 Phone (916) 323-7411

2. TIMBERLAND OWNER(S): Name "Same"

Address \_\_\_\_\_

City \_\_\_\_\_ State \_\_\_\_\_ Zip \_\_\_\_\_ Phone \_\_\_\_\_

3. TIMBER OPERATOR(S): Name Unknown

Address \_\_\_\_\_ License # \_\_\_\_\_

City \_\_\_\_\_ State \_\_\_\_\_ Zip \_\_\_\_\_ Phone \_\_\_\_\_

4. PLAN SUBMITTER(S): Name California State Lands Commission

If the plan submitter is different from 1, 2, or 3 explain authority to submit plan:

5. Person to contact on-site who is responsible for the conduct of the operation:

Name Timber Operator

Address \_\_\_\_\_

City \_\_\_\_\_ State \_\_\_\_\_ Zip \_\_\_\_\_ Phone \_\_\_\_\_

6. RPF preparing the THP: Name Stephen M. Jones

Address 1807 13th Street Registration Number 2125

City Sacramento State CA Zip 95814 Phone (916) 323-7411

CDF STOCK NO. 7540-130-0063

CALENDAR PAGE	77
MINUTE PAGE	1926

7. Expected commencement date of timber operations: July 1, 1987

8. Expected completion date of timber operations: July 30, 1990

9. Forest products to be harvested: Firewood, Sawlogs

10. The timber operation is to be within: (check the appropriate boxes)

1.  Coast Forest District  
2.  Northern Forest District  
3.  Southern Forest District  
4.  Southern Subdistrict of the Coast Forest District  
5.  High-Use Subdistrict of the Southern Forest District

11. Location of the timber operation by legal description:

Base and Meridian:  Mount Diablo,  Humboldt,  San Bernardino

Section	Township	Range	Approximate Acreage	County	(Optional, Assessor's Parcel No.)
<u>22</u>	<u>21N</u>	<u>13W</u>	<u>200</u>	<u>Mendocino</u>	
<u>23</u>	<u>21N</u>	<u>13W</u>	<u>50</u>	<u>Mendocino</u>	

TOTAL ACREAGE 250

NOTE: Additional sheets may be necessary.

12.  Yes  No Is a timberland conversion permit in effect? If yes, list permit number and date of expiration: \_\_\_\_\_
13.  Yes  No Is there a THP on file with CDF for any portion of the plan area for which a report of satisfactory stocking has not been issued by CDF?  
If yes, identify the THP number: \_\_\_\_\_
14.  Yes  No Is any part of the plan within a special treatment area, Tahoe Regional Planning Agency jurisdiction, or a county which has special rules?  
If yes, identify the special area: \_\_\_\_\_

### SILVICULTURE

15. Check the method or treatments which are to be applied, and provide any other information required by the rules in an addendum:

- 1  Clearcutting  
2  Shelterwood, preparatory step  
3  Shelterwood, seed step  
4  Shelterwood, removal step  
5  Seed tree, seed tree step  
6  Seed tree, seed tree removal step

7  Selection - designate basal area stocking standards to be met: \_\_\_\_\_

8  Commercial thinning - designate basal area stocking standards to be met: \*75 ft.<sup>2</sup>/acre

9  Sanitation salvage - when will stocking be met: \_\_\_\_\_

10  Special treatment areas  
11  Rehabilitation of understocked areas

12  Alternative prescription  
13  Transition method

NOTE: Where the level of stocking is based upon timberland site, timberland sites must be shown on the map.

\* Stocking requirements will be met with conifers.

CALENDAR PAGE	<u>78</u>
MINUTE PAGE	<u>1927</u>



16.a.  Yes  No Are any exceptions to the standard silvicultural methods or treatments permitted in the rules proposed for this plan? If yes, explain and justify the exception in an addendum.

b.  Yes  No Will artificial regeneration be required to restock the logged area?

17.  Yes  No Are broadleaf or optional species proposed for management? See item 18.

18.  Yes  No Are broadleaf or optional species to be used to meet stocking standards?

If the answer to items 17 or 18 is yes, list the species and provide the information required by the rules:

Black Oak, Madrone, Oregon White Oak, Canyon Live Oak and Tanoak. The Objective of this THP is to adjust the species composition of hardwoods and conifers to that level prior to BLM's timber sale in 1982. This operation will release the conifers, and leave the hardwoods in clumps and draws with a minimum of 15 square feet of basal area of hardwood per acre, meeting the Department of Fish and Game recommendations.

### HARVESTING PRACTICES AND EROSION CONTROL

19. Indicate type of yarding systems to be used this plan:

1  Tractor, skidder, forwarder    2  Balloon, helicopter    3  Cable, ground-lead  
4  Cable, high-lead    5  Cable, skyline    6  Animal

7  Other: \_\_\_\_\_

20.  Yes  No Will tractor constructed layouts be used?

21.  Yes  No Will tractors be used for directional tree pulling?

Check items 22 through 25 that apply to the use of tractors.

22.  Yes  No Operations on unstable soils or slide areas?

23.  Yes  No Operations on slopes over 65%?

24.  Yes  No Operations on slopes over 50% with high or extreme EPH?

25.  Yes  No Operations within cable yarding areas?

If any of items 22 through 25 are answered yes, explain and justify as required by the rules:

\_\_\_\_\_  
\_\_\_\_\_

26. Indicate erosion hazard ratings present on this THP:

Low,     Moderate,     High,     Extreme

27. Describe soil stabilization measures to be implemented or any additional erosion control measures proposed in this THP where required by the rules:

All skid trails will have sufficient waterbars installed.

\_\_\_\_\_  
\_\_\_\_\_

28.  Yes  No Are any alternative practices or exceptions to the standard harvesting or erosion control practices permitted in the rules proposed for this plan? If yes, explain and justify:

-----  
-----  
-----

29.  Yes  No Are timber operations proposed for the winter period? If yes, provide a winter period plan as an addendum or specify compliance with 14 CAC 914.7(c), 934.7(c) or 954.7(c). No winter period plan is needed for cable, helicopter, or balloon yarding.

ROADS AND LANDINGS

30.  Yes  No Will any roads or landings be constructed or reconstructed?  
If yes, check items 31 through 37 that apply:

31.  Yes  No Will new roads be wider than single lane with turnouts?

32.  Yes  No Will any landings exceed the maximum size specified in the rules?

33.  Yes  No Are logging roads or landings proposed in areas of unstable soils or known slide-prone areas?

34.  Yes  No Will new roads exceed a grade of 15% or pitches of 20% for distance greater than 500 feet?

35.  Yes  No Are roads to be constructed, other than crossings, within the watercourse and lake protection zone of a class I or II watercourse?

36.  Yes  No Will roads or landings longer than 100 feet in length be located on slopes over 65%, or on slopes over 50% which are within 100 feet of the boundary of a watercourse or lake protection zone?

37.  Yes  No Are exemptions proposed for flagging or otherwise identifying the location of roads to be constructed?

38. If any of items 31 through 37 are answered yes, explain, justify, and give site-specific measures to reduce adverse impacts or, if there is any additional or special information concerning the construction and/or maintenance of roads or landings, if required by the rules. Provide necessary information in an addendum.

WATERCOURSE AND LAKES

39.  Yes  No Are there any watercourses or lakes which contain class I through IV waters on or adjacent to the plan area? If yes, complete items 40 through 50.

40.  Yes  No Are any in-lieu practices and/or alternative practices proposed for watercourse or lake protection? If yes, explain and justify:

Hardwood will be left standing in the WLPZ.  
-----  
-----  
-----

Are any exceptions proposed for the following watercourse and lake protection zone practices? Check items 41 through 48 that apply.

41.  Yes  No Exclusion of the use of watercourses, marshes, wet meadows, and other wet areas, for landings, roads, or tractor roads?

42.  Yes  No Retention of non-commercial vegetation bordering and covering meadows and wet areas?

CALENDAR PAGE	LC
MINUTE PAGE	1929

43.  Yes  No Directional felling of trees within the zone away from the watercourse or lake?
44.  Yes  No Increase or decrease of width(s) of the zone(s)?
45.  Yes  No Protection of watercourses which conduct class IV waters?
46.  Yes  No Exclusion of heavy equipment from the zone?
47.  Yes  No Retention of 50% of the overstory canopy in the zone?
48.  Yes  No Retention of 50% of the understory in the zone?

If any of items 41 through 48 are answered yes, explain and justify if required by the rules and provide necessary information in an addendum.

49.  Yes  No Are residual trees or harvest trees going to be marked within the watercourse or lake protection zone? If no, explain:

-----

-----

-----

50. In an addendum describe the protective measures and zone widths for the watercourse and lake protection zones that are in the plan area.

The Class II watercourses on the plan area will have a minimum 50 feet WLPZ, designated on the ground.

WILDLIFE

51.  Yes  No Are any known rare or endangered species or species of special concern, including key habitat, associated with the THP area? If yes, in an addendum identify the species and the provisions to be taken for protection of the species.
52.  Yes  No Are there any snags which must be felled for fire protection or other reasons? If yes, describe which snags are going to be felled:

-----

-----

53.  Yes  No Are any other provisions for wildlife protection required by the rules? If yes, describe provisions:

-----

-----

CULTURAL RESOURCES

- 54.a.  Yes  No Has an archaeological survey been made of the areas to be harvested?
- b.  Yes  No Have the California Archaeological Inventory records been checked for any recorded archaeological or historical sites located in the area to be harvested?
55.  Yes  No Are there any archaeological or historical sites located in the area to be harvested? If yes, describe in an addendum how the sites are to be protected.  
The perimeter of the sites are flagged with orange and white candy stripe flagging, operations will be excluded from these areas.

CALENDAR PAGE	61
MINUTE PAGE	1930

HAZARD REDUCTION

56. What type of slash treatment will be used in the fire protection zone?

- 1[X] Pile and burn ; 2[X] Lopping; 3[ ] Other: \_\_\_\_\_
- 4[ ] Not applicable no fire protection zone present

57. [ ] Yes [X] No If the clearcutting method is used, will broadcast burning be used for site preparation?

58. If milling and burning is to be used for hazard reduction, who will be responsible for compliance?

- 1[ ] Timber owner; 2[X] Timber operator; 3[ ] Timberland owner

PUBLIC NOTICE

59. [X] Yes [ ] No Are there any ownerships within 300 feet of the plan boundary which are owned by persons other than the persons executing this plan? If yes, a list of the names and addresses of the adjacent property owners and a Notice of Intent to Harvest Timber must be included with the plan.

PESTS

60. [ ] Yes [X] No Are there any adverse insect, disease, or pest problems of significance in the plan area? If yes, describe the mitigation measures, if any, to improve the health and productivity of the stand in an addendum.

OTHER INFORMATION

61. Are there any other existing or planned land use activities including but not limited to other THP in the area of the proposed THP which may combine with the effects of your timber harvesting operation to cause significant adverse cumulative environmental effects? [ ] Yes [X] No If yes, please describe the other land use(s) and the likely effect as well as any mitigation which would reduce the negative effect in an addendum.

ATTACHMENTS

62. Check if the attachments listed are included with the plan:

- 1[ ] Notice of Stream Bed Alteration to Department of Fish and Game (A copy of this notice is attached to the instructions for your use.)
- 2[X] Estimated Surface Soil Erosion Hazard Calculations
- 3[X] Notice of Intent to Harvest Timber and a list of names and addresses of adjacent property owners
- 4[X] Maps
- 5[ ] Addendum for silviculture information
- 6[ ] Written notice of plan to the timber operator, timberland owner, or timber owner that did not sign the THP.

REGISTERED PROFESSIONAL FORESTER

63. I have the following authority, responsibilities, and limitation for preparation or administration of the THP and timber operation:

\_\_\_\_\_ I have responsibility for preparing the plan.

\_\_\_\_\_

\_\_\_\_\_

\_\_\_\_\_

CALENDAR PAGE	62
MINUTE PAGE	1931

64. I have notified the timber owner and the timberland owner, in writing, of their responsibilities for:
1.  Yes  No The stocking requirements of the rules
  2.  Yes  No The maintenance of erosion control structures requirements of the rules
  3.  Yes  No The marking requirements contained in the rules

65.  Yes  No I will provide the timber operator with a copy of the approved THP.

66. After considering the rules of the Board of Forestry and the mitigation measures I have proposed I have determined that the timber operation:

will have a significant adverse impact on the environment

will not have a significant adverse impact on the environment.

If the operation will have a significant adverse impact on the environment, in an addendum explain why any alternatives or additional mitigation measures that would reduce the impact are not feasible.

67. Registered Professional Forester: I certify that I, or my designee, personally inspected the plan area, and the plan complies with the Forest Practice Act and the Forest practice rules.

Signature: Stephen M. Jones Date 5/18/87

68. CERTIFICATION

The above conforms to my/our plan and, upon filing, I/we agree to conduct harvesting in accordance therewith. Consent is hereby given to the Director of Forestry, his agents and employees, to enter the premises to inspect timber operations for compliance with the Forest Practice Act and forest practice rules.

Timber Owner: California State Lands Commission

Signature: Robert J. Shiner Date 5-18-87

Printed Name: (Signed) Robert J. Shiner

Timberland Owner: California State Lands Commission

Signature: Robert J. Shiner Date 5-18-87

Printed Name: (Signed) Robert J. Shiner

Timber Operator: Unknown

Signature: \_\_\_\_\_ Date \_\_\_\_\_

Printed Name: \_\_\_\_\_

DIRECTOR OF FORESTRY

This Timber Harvesting Plan conforms to the rules and regulations of the Board of Forestry and with the Forest Practice Act.

By: \_\_\_\_\_ (Date) \_\_\_\_\_

(Signature)

(Date)

(Printed Name)

(Title)

NOTICE OF INTENT TO HARVEST TIMBER

A Timber Harvesting Plan or an amendment to an existing plan that may be of interest to you has been submitted to the California Department of Forestry for a determination as to whether the timber operation described in the plan or amendment complies with state laws and rules. The following briefly describes the timber operation, where and how to obtain more details of the operation, and to whom and by when documents concerning the timber operation should be submitted. Questions about the plan or amendment or the California Forest Practice Act should be made to the following office(s):

California Department of Forestry  
135 Ridgeway Avenue  
P.O. Box 670  
Santa Rosa, California 95402  
(707) 576-2275

California Department of Forestry  
6105 Airport Road  
Redding, California 96002  
(916) 225-2445

California Department of Forestry  
1234 East Shaw Avenue  
Fresno, California 93710  
(209) 222-3716

California Department of Forestry  
2526 Mulberry Street  
Riverside, California 92501  
(714) 761-6140

A copy of the plan may be obtained for \$1.00 from the Department of Forestry. The following is a summary of the information contained in the plan or amendment:

1. Plan Submitter: California State Lands Commission
2. Timberland Owner: "Same"
3. Location of the plan area (county, section, township and range, and approximate direction and distance to the plan area from the nearest community or well-known landmark):  
Mendocino, Section 22, Lots 3-8, Section 23, Lots 5, 12, 13, T21N R13W, MDM  
5 miles southeast of Dos Rios
4. Name of nearest perennial stream flowing through or downstream from plan area:  
Salt Creek
5. Acres on plan: 250
6. Proposed harvesting method or treatment: Commercial thinning
7. The earliest estimated date for the Director's determination on the plan is \_\_\_\_\_  
(This is 15 days from the date of receipt of the plan by the Department.) Depending on the review required, the Director's determination on the plan will probably be made 20 to 25 days from the date of receipt of the plan by the Department. Date of receipt was: \_\_\_\_\_ Check with the Department for the date of decision.

**ESTIMATED SURFACE SOIL EROSION HAZARD**  
RM-87 (4/84)

STATE OF CALIFORNIA  
BOARD OF FORESTRY

I. SOIL FACTORS				FACTOR RATING BY AREA				
<b>A. SOIL TEXTURE</b>	Fine	Medium	Coarse	A	B	C		
<b>1. DETACHABILITY</b>	Low	Moderate	High	14				
Rating	1-9	10-18	19-30					
<b>2. PERMEABILITY</b>	Slow	Moderate	Rapid	3				
Rating	5-4	3-2	1					
<b>B. DEPTH TO RESTRICTIVE LAYER OR BEDROCK</b>								
	Shallow	Moderate	Deep	3				
	1"-19"	20"-39"	40"-60" (+)					
Rating	15-9	8-4	3-1					
<b>C. PERCENT SURFACE COARSE FRAGMENTS GREATER THAN 2 MM IN SIZE INCLUDING ROCKS OR STONES</b>								
	Low	Moderate	High	2				
	(-) 10-39%	40-70%	71-100%					
Rating	10-6	5-3	2-1					
				SUBTOTAL		22		

II. SLOPE FACTOR									
Slope	5-15%	16-30%	31-40%	41-50%	51-70%	71-80% (+)	15		
Rating	1-3	4-6	7-10	11-15	16-25	26-35			

III. PROTECTIVE VEGETATIVE COVER REMAINING AFTER DISTURBANCE						
	Low	Moderate	High	5		
	0-40%	41-80%	81-100%			
Rating	15-8%	7-4	3-1			

IV. TWO-YEAR, ONE-HOUR RAINFALL INTENSITY (Hundredths Inch)								
	Low	Moderate	High	Extreme	8			
	(-) 30-39	40-59	60-69	70-80 (+)				
Rating	1-3	4-7	8-11	12-15				
				TOTAL SUM OF FACTORS		50		

**EROSION HAZARD RATING**

<50	50-65	66-75	>75			
LOW (L)	MODERATE (M)	HIGH (H)	EXTREME (E)			
				THE DETERMINATION IS		
				CALENDAR PAGE		5
				MINUTE PAGE		37
						7540-130-2435

SALT CREEK

W 23183

Addendum

3. Timber operator will be supplied after sale has sold.

29. The winter operation will consist of falling the timber and leaving it lay. If there are extended dry periods where the soil dries sufficiently so that it is not saturated, tractor yarding will take place. Erosion control structures will be installed prior to shutdown periods or at the end of the day if the U.S. Weather Service forecast is for a 30% or more chance of rain before the next day.

59. Louisiana Pacific Corp.  
P.O. Box 158  
Samoa, CA 95564

Fred Filippo  
2816 Rivera Drive  
Burlingame, CA 94010

W.J. & J.R. Hammonds  
47375 West Dakota Ave.  
Firebaugh, CA 93622



## DEPARTMENT OF FISH AND GAME

POST OFFICE BOX 47  
MOUNTAIN VIEW, CALIFORNIA 94999  
(916) 944-2013

SALT CREEK

W 23183

April 17, 1987

Addendum

W 23183

Steven Jones, Forester II  
State Lands Commission  
1807 13th Street  
Sacramento, California 95814

Dear Mr. Jones:

We have reviewed the proposed hardwood harvest in your Salt Creek Unit near Dos Rios, Mendocino County.

To reduce impacts on wildlife species on the state lands and adjacent property, the following hardwood retention guidelines should be followed:

- A. Our recommendations on timber sites with less than 600 basal square feet is to retain 75% of existing levels. When present, at least 25% must exceed 100 years of age. On non-timber sites, the hardwood component should be maintained at existing levels and age classes.
- B. Our minimum recommended hardwood retention level on non-critical areas is 600 basal square feet per 40 acres (15 basal square feet/acre). This can be achieved by leaving:

Two trees 6" to 8" d.b.h.  
Three trees 12" to 20" d.b.h.  
Three trees 20" to 36" d.b.h.  
One tree 36" d.b.h. or greater

On critical habitat areas, 1400 basal square feet per 40 acres (35 square feet/acre) should be retained. This can be achieved by leaving:

Two trees 8" to 12" d.b.h.  
Three trees 14" to 24" d.b.h.  
Three trees 30" to 36" d.b.h.  
One tree 36" d.b.h. or greater

Using the above criteria, trees to be retained could be readily identified on the ground. Clumping would be more easily achieved as well. Additional flexibility could be obtained on the ground by choosing trees that have good straight boles, with moderate to heavy crowns, that would minimize competition with conifers.

CALENDAR PAGE	87
MINUTE PAGE	1936

Mr. Jones

-2-

April 17, 1987

We certainly appreciate the opportunity to comment and offer additional assistance. Our wildlife biologist for Mendocino County is Jack Booth and he can be reached at (707) 468-0639.

Sincerely,

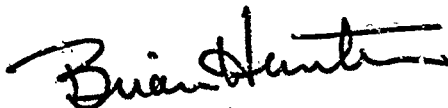

Brian Hunter  
Regional Manager  
Region 3

CALENDAR PAGE	18
MINUTE PAGE	1937

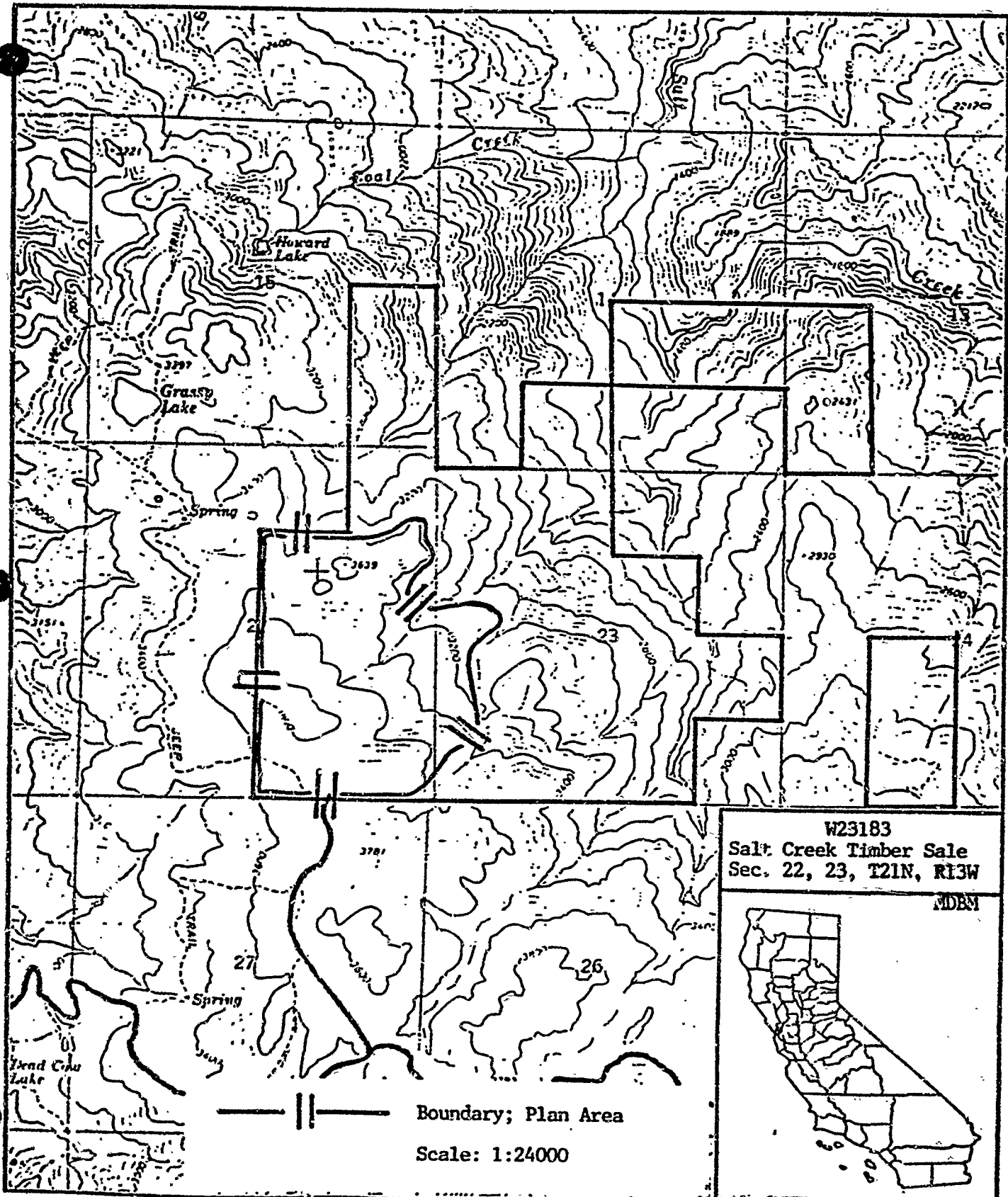

W23183  
 Salt Creek Timber Sale  
 Sec. 22, 23, T21N, R13W

MDBM





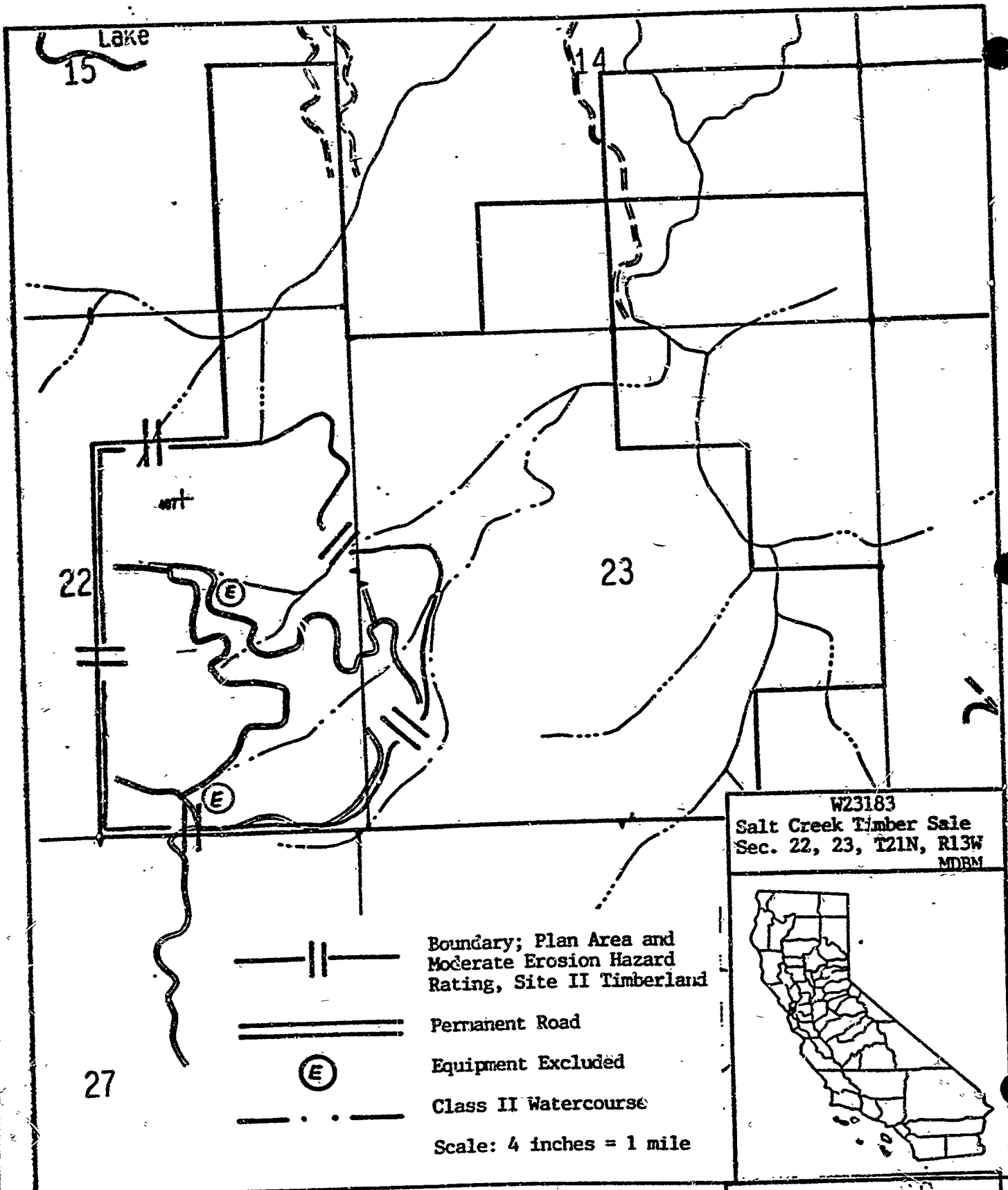

—||— Boundary; Plan Area  
 Scale: 1:24000

CALENDAR PAGE 1938  
 MINUTE PAGE

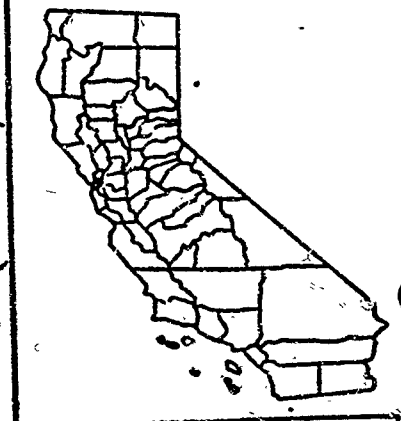

W23183  
 Salt Creek Timber Sale  
 Sec. 22, 23, T21N, R13W  
 MDBM



-  Boundary; Plan Area and Moderate Erosion Hazard Rating, Site II Timberland
  -  Permanent Road
  -  Equipment Excluded
  -  Class II Watercourse
- Scale: 4 inches = 1 mile

CALENDAR PAGE  
 MINUTE PAGE

T939