

MINUTE ITEM

This Calendar Item No. 31
This is a 31 2 3/11/86
Meeting.

CALENDAR ITEM

31

A 1
S 4

02/27/86
W 2400.159
Fossum

ANNEXATION OF SUBMERGED LANDS,
CITY OF REDDING, SHASTA COUNTY

The State Lands Commission has received a request from City of Redding to review and approve the annexation and boundaries of the proposed Sacramento River Trail Annexation (No. 85-10).

This area includes approximately 756.30 acres, more or less, of land including a portion of the present and historic submerged lands in the bed of the Sacramento River. The area proposed for annexation is located westerly of previously annexed areas and involves an approximate one-mile stretch of the Sacramento River in Section 28, T32N R5W, MDM.

Pursuant to Government Code Section 56108(c) and (d), the Commission is to review and approve or deny the proposed annexation boundaries as appropriate and correct within 45 days.

The staff of the Commission has reviewed the proposed annexation boundary description and finds it adequate. Furthermore, staff has no objection to transfer of local police power jurisdiction from the county to the city pursuant to 56108(a) and, therefore, submits the recommendations of approval below.

- EXHIBITS:
- A. Land Description.
 - B. Location Map.
 - C. Site Map.

IT IS RECOMMENDED THAT THE COMMISSION:

1. FIND THAT THE ACTIVITY IS EXEMPT FROM THE REQUIREMENTS OF THE CEQA PURSUANT TO 14 CAL. ADM. CODE 15061 BECAUSE THE ACTIVITY IS NOT A PROJECT AS DEFINED BY P.R.C. 21065 AND 14 CAL. ADM. CODE 15378.

(PAGES 203-203.5 ADDED 02/25/86) -1-

203
MINUTE PAGE 650

CALENDAR ITEM NO. 31 (CONT'D)

2. APPROVE THE PROPOSED BOUNDARIES FOR THE SACRAMENTO RIVER TRAIL ANNEXATION, (NO. 85-10) BY THE CITY OF REDDING, AS DESCRIBED IN EXHIBIT "A" ATTACHED AND BY REFERENCE MADE A PART HEREOF, PURSUANT TO GOVERNMENT CODE SECTION 56108(c) AND (d).
3. CONSENT, AS THE LANDOWNER, TO THE PROPOSED ANNEXATION OF SUBMERGED LANDS UNDER THE OWNERSHIP AND JURISDICTION OF THE STATE LANDS COMMISSION IN THE BED OF THE SACRAMENTO RIVER WITHIN THE AREA DESCRIBED IN EXHIBIT "A" PURSUANT TO GOVERNMENT CODE SECTION 56108(a).
4. AUTHORIZE STAFF COUNSEL TO GIVE THE REQUISITE NOTICE OF SAID APPROVALS TO THE CITY OF REDDING AND TO THE EXECUTIVE OFFICER OF SHASTA COUNTY LAFCO PURSUANT TO CALIFORNIA GOVERNMENT CODE SECTION 56108(e).

EXHIBIT "A"

LEGAL DESCRIPTION

Beginning at the corner common to Sections 20, 21, 28, and 29, T. 32 N., R. 5 W., M.D.M., thence following along the north line of said Section 28 N. 88°48' E., 4882.68 feet to the northeast corner of said Section 28 and the City of Redding boundary line; thence following along said boundary line S. 0°05'44" W., 2647.34 feet; thence S. 0°37'06" W., 2040 feet, more or less, to the south line of the Sacramento River; thence following along said south line, Westerly, 740 feet, more or less, to most westerly corner of a parcel conveyed to the City of Redding, by deed recorded December 3, 1973, in Book 1200, at page 133, Shasta County Records; thence S. 47°37' E., 870 feet, more or less, to a point on the south line of the Southern Pacific Railroad spur line; said point also being the most northwesterly corner of the Sunset West Subdivision, as recorded September 9, 1983, in Book 17 of Maps at page 20, Shasta County Records; thence S. 87°16'30" W., 658.89 feet; thence along a 3152-foot radius curve to the right; through an angle of 01°46'40"; for a distance of 97.81 feet; thence S. 2°43'30" E., 50 feet; thence S. 87°16'30" W., 203.5 feet; thence along a 1533.63-foot radius curve to the right; through an angle of 3°16'35"; for a distance of 87.7 feet; thence S. 20°45'30" E., 96.85 feet; thence S. 41°32' E., 250.14 feet; thence S. 76°42'30" E., 125.70 feet; thence S. 35°04' E., 281.16 feet; thence S. 10°30' E., 427.02 feet; thence S. 47°14' E., 88.40 feet; thence S. 07°28' E., 310.20 feet; thence S. 28°04' E., 250.14 feet; thence S. 24°04' E., 205.92 feet; thence S. 11°35'30" W., 235 feet; thence S. 14°57'48" W., 124.14 feet; thence S. 9°14'50" E., 185.85 feet; thence S. 39°08' W., 270 feet; thence S. 78°05'40" W., 58.54 feet; thence S. 57°28' W., 353.76 feet; thence S. 74°28' W., 9.32 feet; thence S. 74°51' W., 290.32 feet; thence N. 81°29' W., 157.08 feet; thence S. 56°38' W., 126.72 feet; thence leaving said City of Redding boundary line S. 56°51'40" W., 287.7 feet; thence Southerly, 460 feet, more or less, to the north line of State Highway 299, also being the most westerly corner of a parcel conveyed by deed to John Williams, on May 29, 1980, in Book 1727, at page 375, Shasta County Records; thence following along said north line, Westerly, 3700 feet, more or less, to the most southeasterly corner of a parcel conveyed to Max Rudolph, by deed recorded January 2, 1973, in Book 1150, at page 692, Shasta County Records; thence N. 1°54'40" W., 276.83 feet; thence N. 44°10'20" E., 137.93 feet; thence N. 11°15' W., 194.16 feet; thence N. 62°01'40" E., 125.30 feet; thence N. 18°45'40" E., 289.35 feet; thence N. 41°06' E., 223.44 feet; thence N. 29°00'10" E., 242.06 feet; thence N. 32°20' E., 390.19 feet; thence S. 63°16'40" E., 159.21 feet; thence N. 64°37'40" E., 139.09 feet; thence N. 9°08'40" E., 216.36 feet; thence N. 65°44'55" E., 997.71 feet; thence S. 84°01'20" E., 537.53 feet; thence N. 47°01'15" E., 645.07 feet; thence N. 89°49'10" E., 561.86 feet to the south line of the Southern Pacific Railroad; thence along a 1533.63 foot radius curve to the right; through an angle of 13°53'35"; for a distance of 371.88 feet; thence N. 44°42'45" W., 385.75 feet; thence Northerly, 240 feet, more or less, to the most easterly corner of a parcel conveyed to Pearl Robinson, by deed recorded November 14,

1975, in Book 1306, at page 75, Shasta County Records; thence N. 34°08' W., 435 feet; thence following Northwesterly along the Government Meander Line, 580 feet, more or less, to the most southeasterly corner of a parcel conveyed to James McHale, on October 7, 1963, in Book 761, at page 227, Shasta County Records; thence N. 43°44'01" W., 958.47 feet; thence N. 25°44'01" W., 412.50 feet; thence N. 17°44'01" W., 125 feet, more or less, to the northeast corner of said McHale parcel; thence N. 87°35'14" W., 630 feet, more or less, to the northwest corner of said McHale parcel, also being the west one-quarter corner of Section 28, T. 32 N., R. 5 W., M.D.M., thence N. 5°47'14" W., 2356.26 feet to the point of beginning.

LEGEND

_____ ANNEXATION BOUNDARY
 _____ CITY OF REDDING BOUNDARY
 _____ RESOLUTION NO.
 _____ OFFICIAL DATE:
 AREA: 756.33 AC.
 INCLUSIVE ADDRESS

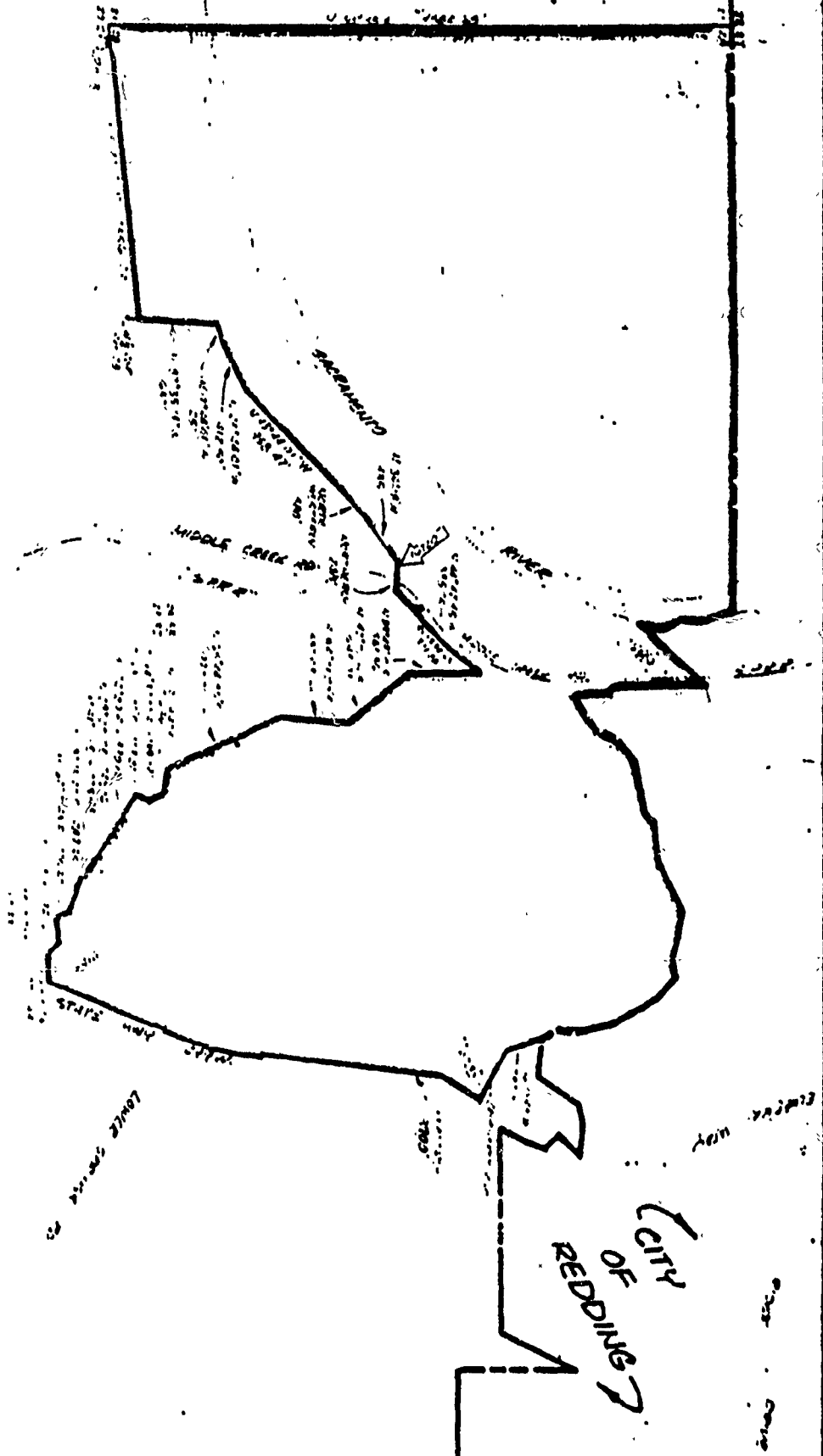

PLANNING DEPT. JANUARY 1986

EXHIBIT B
 BOUNDARY MAP
 CITY OF REDDING
 ANNEX 85-10
 UNINHABITED

A 2400.159

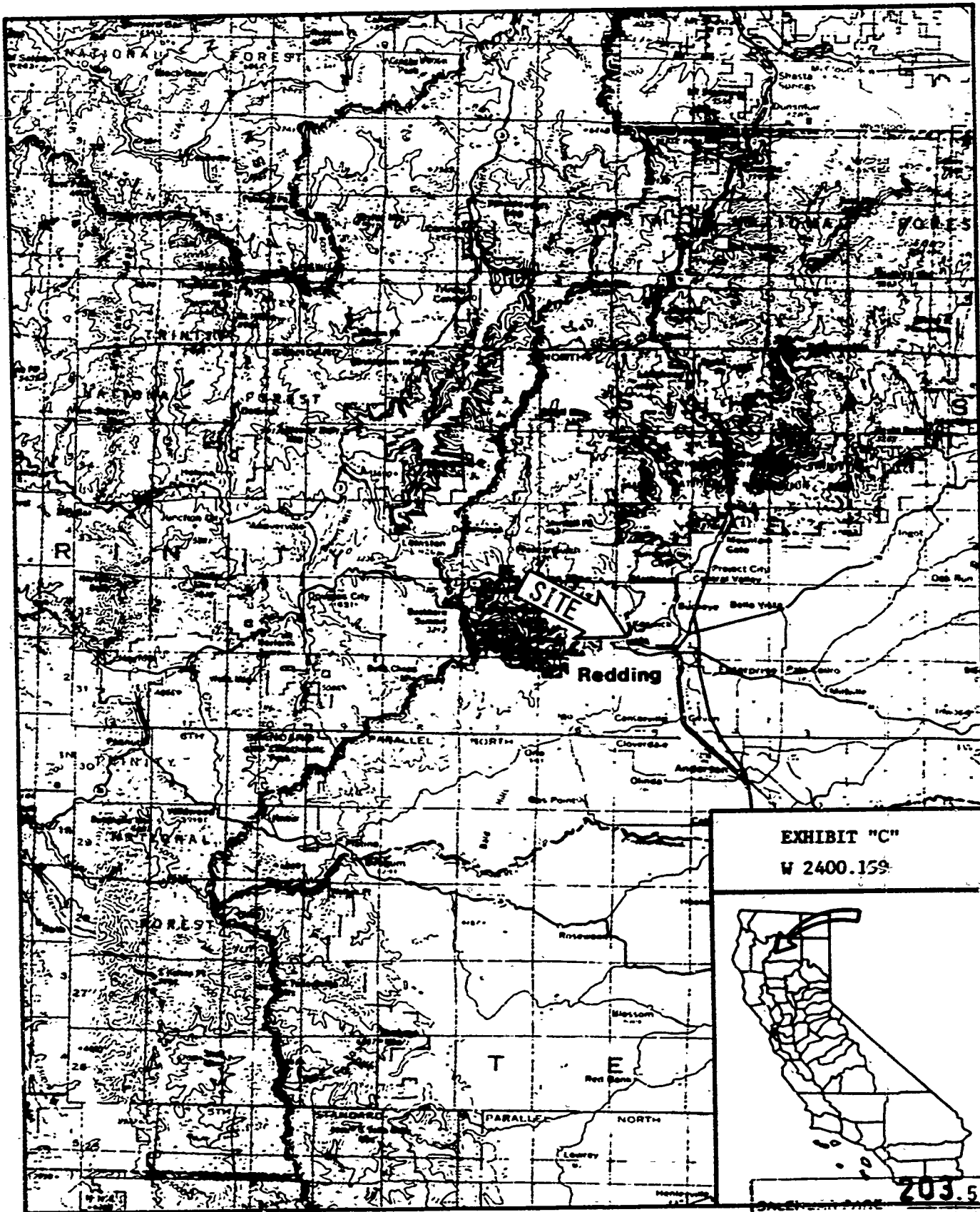

EXHIBIT "C"
W 2400.159



203.5
655