

MINUTE ITEM

This Calendar Item No. 29
was approved as Minute Item
No. 21 by the State Lands
Commission by a vote of 2
to 0 at its 3/6/86
meeting.

CALENDAR ITEM

A 80
S 37

29

02/27/86
W 40459 PRC 6950
W 40460 PRC 6951
W 40461 PRC 6952
W 40462 PRC 6953
Pelka

APPROVAL OF FOUR PROSPECTING PERMITS
FOR MINERALS OTHER THAN
OIL, GAS, GEOTHERMAL RESOURCES, SAND AND GRAVEL,
IMPERIAL COUNTY

APPLICANTS: W 40459 - Mr. and Mrs. Rolla Buck
Box 17
Alamogordo, New Mexico 88310

W 40460 - Conrad Harley
1863 Canyon Road
El Centro, California 92243

W 40461 - Edgar L. Buck
P. O. Box 519
Ruidoso, New Mexico 88345

W 40462 - Tom P. Stephens
P. O. Box 698
Roswell, New Mexico 88201

PROPOSED AUTHORIZATION:

Approval of four prospecting permits for two
years to prospect for gold, silver, and other
valuable minerals, other than oil, gas,
geothermal resources, sand and gravel on
approximately 627.43 acres of land located in
Imperial County.

CONSIDERATION: Filing fees totaling \$100, processing fees
totaling \$1,000 and an acreage deposit of
\$627.43.

CALENDAR ITEM NO. 29 (CONT'D)

TYPE OF LAND AND LOCATION:

- W 40459 - 160.00 acres more or less, of State school land, NW 1/4, Sec 36, T12S R19E, SBM, Imperial County.
- W 40460 - 157.36 acres more or less, of State school land, SE 1/4, Sec 36, T12S R19E, SBM, Imperial County, excepting 2.64 acres for Cal Trans State Highway 78.
- W 40461 - 153.80 acres more or less, of State school land, SW 1/4, Sec 36, T12S R19E, SBM, Imperial County, excepting 6.20 acres for Cal Trans State Highway 78.
- W 40462 - 156.27 acres more or less, of State school land NE 1/4, Sec 36, T12S R19E, SBM, Imperial County, excepting 3.63 acres for Cal Trans State Highway 78.

PROPOSED PROJECT:

The four applicants propose to conduct two-phased exploration for valuable minerals with the execution of Phase II dependent upon the achievement of success in Phase I

Phase I: The four applicants, each on their separate quarter section, propose to auger two inch holes ranging in depth from 2 to 18 feet. In the NW 1/4, 73 holes are proposed to be augered; 54 in the NE 1/4; 72 in the SE 1/4; and 59 in the SW 1/4. The portable hand held auger equipment is manufactured by Little Beaver, Inc. of Livingston Texas, and is powered by both mechanical and hydraulic units. Two or three of these augers will be employed. Testing and assaying of the augered sample will be performed in a variety of ways for the purpose of estimating placer values. Dry wash tests, using a portable dry washer and panning tests will be made. The "free milling" properties of the placer material will be determined by using a portable dry

CALENDAR ITEM NO. 29 (CONT'D)

concentrator. The bulk of the material processed through the dry concentrator will be returned to its original source in virtually the same condition. If this initial exploration justifies extended sub-surface exploration, the permittee will contract with a drill testing service company for Phase II.

Phase II exploration will be limited to the drilling of one or two 4 inch holes in each quarter section to a maximum depth of 400 feet. Depending on the contractors choice of a drilling rig, a mud program may be required. A low density, non-dispersed polymer mud is preferred due to its biodegradable qualities. If a mud program is required, a reserve pit up to 25 feet in diameter may be utilized. Cuttings not saved for testing and assaying will be returned to the drill holes. If the drill testing program penetrates a water bearing formation, normal industry standards will be utilized to seal off the water to prevent circulation between formations.

Comments received on the Initial Study and Proposed Negative Declaration resulted in a slight modification of the project. Prospecting excavations and related activities will be conducted in such a manner that will avoid adverse impacts to desert wildlife and vegetation. If burrowing animals are located at an auger or drill site, the site shall be moved so that the wildlife will not be adversely affected. If hibernating desert tortoise are found within the excavation areas, the Permittee shall contact the local DFG biologist to determine the appropriate action to avoid loss of this state designated protected species.

All vehicle access shall be restricted to existing roads and jeep trails. No new road construction shall be permitted. If excavation of mud pits are required, the top soil shall be stockpiled and spread over the pit surface upon filling. The mud pit shall be seeded with

CALENDAR ITEM NO. 29 (CONT'D)

native annuals after filling. the estimated maximum surface area disturbance of the auger and drill program for each quarter section is 0.1 acre. The estimated maximum excavated volume is 273 cubic feet per quarter section.

Any proposed activity not authorized by the four permits will not proceed without prior approval of a project amendment processed pursuant to the requirements of CEQA. If commercial mining operations are proposed, appropriate environmental documentation will be prepared and certified prior to issuing a mineral extraction lease.

TERM: The primary term of each Prospecting Permit is two years. The Commission may, in its discretion, extend the term for one additional year.

ROYALTY: Royalty payable under the permits shall be 20 percent of the gross value of the minerals secured from the permit areas and sold or otherwise disposed of or held for sale or other disposition.

PREREQUISITE ITEMS:

1. Required statutory filing fees, expense deposits and acreage deposits have been submitted by the applicants.
2. Subject parcels are not known to contain commercially valuable deposits of minerals.
3. Royalty payable under any preferential lease issued shall not be less than 10 percent of the gross value of all mineral production from the leased lands, less any charges approved by the Commission made or incurred with respect to transporting or processing the State's royalty share of production. The determination of said royalty and charges shall be at the discretion of the Commission and set forth in said lease.

CALENDAR ITEM NO. 29 (CONT'D)

STATUTORY REFERENCES:

- A. P.R.C.: Div. 6, Section 6891.
- B. Cal. Adm. Code: Title 2, Section 2200.

AB 884: 03/18/86.

OTHER PERTINENT INFORMATION:

- 1. Pursuant to the Commission's delegation of authority and the State CEQA Guidelines (14 Cal. Adm. Code 15025), the staff has prepared and circulated for public review a proposed Negative Declaration identified as EIR ND 388, State Clearinghouse No. 85073115 pursuant to the provisions of the CEQA. A copy of this environmental document is attached as Exhibit "C".

Based upon the initial study, the proposed Negative Declaration and the comments received in response thereto, there is no substantial evidence that the project will have a significant effect on the environment (14 Cal. Adm. Code 15074(b)).

- 2. Pursuant to P.R.C. Section 6895, upon establishing to the satisfaction of the Commission that commercially valuable deposits of minerals have been discovered within the limits of each permit, the permittee would have a preferential right to a lease for a maximum of 960 acres embraced within each permit provided that there are that many acres in the permit. Said right shall be subject to all necessary environmental approvals. The issuance of each permit shall not affect the discretion of the Commission in granting or denying such lease because of environmental considerations.
- 3. Each permit shall provide for a performance bond of \$5,000 in favor of the State.

CALENDAR ITEM NO. 29 (CONT'D)

APPROVALS OBTAINED:

Pursuant to P.R.C. Section 6890, the subject permit applications and form have been approved by the Office of the Attorney General as to compliance with the applicable provisions of the law.

EXHIBITS:

- A. Land Description.
- B. Site Map.
- C. Negative Declaration.

IT IS RECOMMENDED THAT THE COMMISSION:

1. CERTIFY THAT NEGATIVE DECLARATION 388, STATE CLEARINGHOUSE 85073115, WAS PREPARED FOR THIS PROJECT PURSUANT TO THE PROVISIONS OF THE CEQA AND THAT THE COMMISSION HAS REVIEWED AND CONSIDERED THE INFORMATION CONTAINED THEREIN. THE PROJECT SHALL INCLUDE FOUR PROSPECTING PERMITS AND ANY EXTENSION THE COMMISSION MAY GRANT IN ITS DISCRETION FOR THE SAME PROJECT DESCRIBED IN THE PERMITS, ANY EXTENSION SHALL NOT EXCEED ONE YEAR.
2. DETERMINE THAT THE PROJECT, AS AMENDED, WILL NOT HAVE A SIGNIFICANT EFFECT ON THE ENVIRONMENT.
3. DETERMINE THAT THE LANDS DESCRIBED IN THE FOUR PERMITS ARE NOT PRESENTLY KNOWN TO CONTAIN COMMERCIALY VALUABLE DEPOSITS OF MINERALS.
4. AUTHORIZE THE ISSUANCE OF FOUR PROSPECTING PERMITS FOR A TERM OF TWO YEARS, FOR ALL MINERALS, OTHER THAN OIL, GAS, GEOTHERMAL RESOURCES, SAND AND GRAVEL TO (I) MR. & MRS. ROLLA BUCK FOR THE NW 1/4, SEC 36, T12S, R19E, SBM, IMPERIAL COUNTY, CONTAINING APPROXIMATELY 160.00 ACRES, (II) CONRAD HARLEY FOR THE SE 1/4, SEC 36, T12S, R19E, SBM, IMPERIAL COUNTY, EXCEPTING 2.64 ACRES FOR CAL TRANS STATE HIGHWAY 78, THEREBY CONTAINING APPROXIMATELY 157.36 ACRES, (III) EDGAR L. BUCK FOR THE SW 1/4, SEC 36, T12S, R19E, SBM, IMPERIAL COUNTY, EXCEPTING 6.20 ACRES FOR CAL TRANS STATE HIGHWAY 78, THEREBY CONTAINING APPROXIMATELY 153.80 ACRES, (IV) TOM P. STEPHENS FOR THE NE 1/4, SEC 36, T12S, R19E, SBM, IMPERIAL COUNTY, EXCEPTING 3.63 ACRES FOR CAL TRANS STATE HIGHWAY 78 THEREBY CONTAINING APPROXIMATELY 156.27 ACRES: IN ACCORDANCE WITH THE STANDARD FORM OF PERMIT. ROYALTY PAYABLE UNDER THE FOUR PERMITS SHALL BE 20 PERCENT. ROYALTY PAYABLE UNDER ANY PREFERENTIAL LEASE

CALENDAR ITEM NO. 29 (CONT'D)

ISSUED UPON THE DISCOVERY OF COMMERCIALY VALUABLE DEPOSITS OF MINERALS SHALL NOT BE LESS THAN TEN PERCENT OF THE GROSS VALUE OF ALL MINERAL PRODUCTION FROM THE LEASED LANDS, LESS ANY CHARGES APPROVED BY THE COMMISSION MADE OR INCURRED WITH RESPECT TO TRANSPORTING OR PROCESSING THE STATE'S ROYALTY SHARE OF PRODUCTION. THE DETERMINATION OF SAID ROYALTY AND CHARGES SHALL BE AT THE DISCRETION OF THE COMMISSION.

EXHIBIT "A"

LAND DESCRIPTION

W40459

A parcel of California State school lands in Imperial County, California,
described as follows:

The NW $\frac{1}{2}$ of Section 36, T12S, R19E, SBM.

END OF DESCRIPTION

PREPARED APRIL 25, 1985, BY BOUNDARY SERVICES UNIT, M. L. SHAFER, SUPERVISOR.

CALENDAR PAGE	158
MINUTE PAGE	605

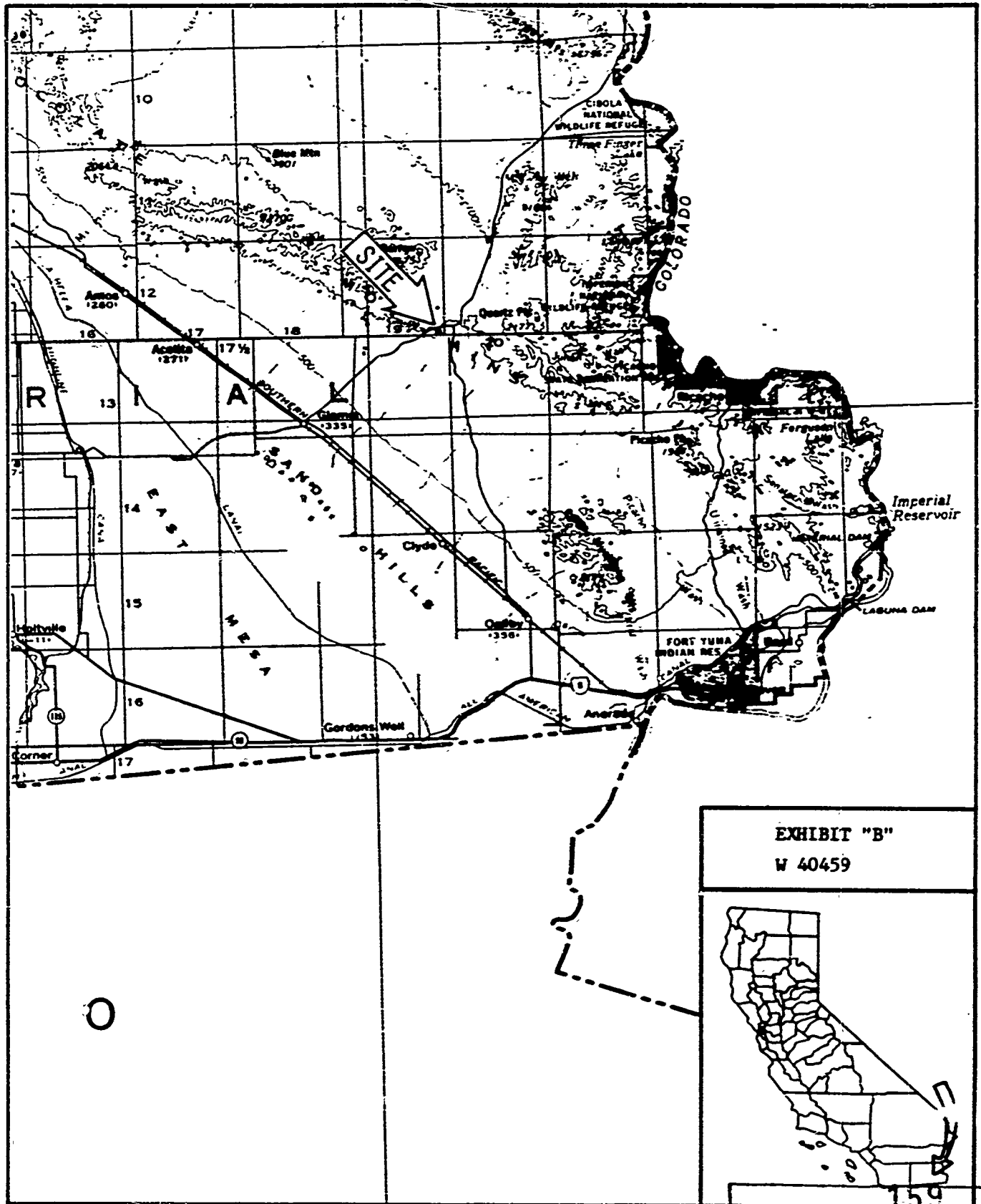

EXHIBIT "B"
W 40459



CALIFORNIA PAGE

MINUTE PAGE

159
606

EXHIBIT "A"

LAND DESCRIPTION

W40460

A parcel of California State school lands in Imperial County, California,
described as follows:

The SE $\frac{1}{4}$ of Section 36, T12S, R19E, SBM.

EXCEPTING THEREFROM any portion thereof lying within the 100 foot right-of-way
of California State Highway 78.

END OF DESCRIPTION

PREPARED APRIL 25, 1985, BY BOUNDARY SERVICES UNIT, M. L. SHAFER, SUPERVISOR.

EXHIBIT "A"

LAND DESCRIPTION

W40461

A parcel of California State school lands in Imperial County, California,
described as follows:

The SW $\frac{1}{4}$ of Section 36, T12S, R19E, SBM.

EXCEPTING THEREFROM any portion thereof lying within the 100 foot right-of-way
of California State Highway 78.

END OF DESCRIPTION

PREPARED APRIL 25, 1985, BY BOUNDARY SERVICES UNIT, M. L. SHAFER, SUPERVISOR.

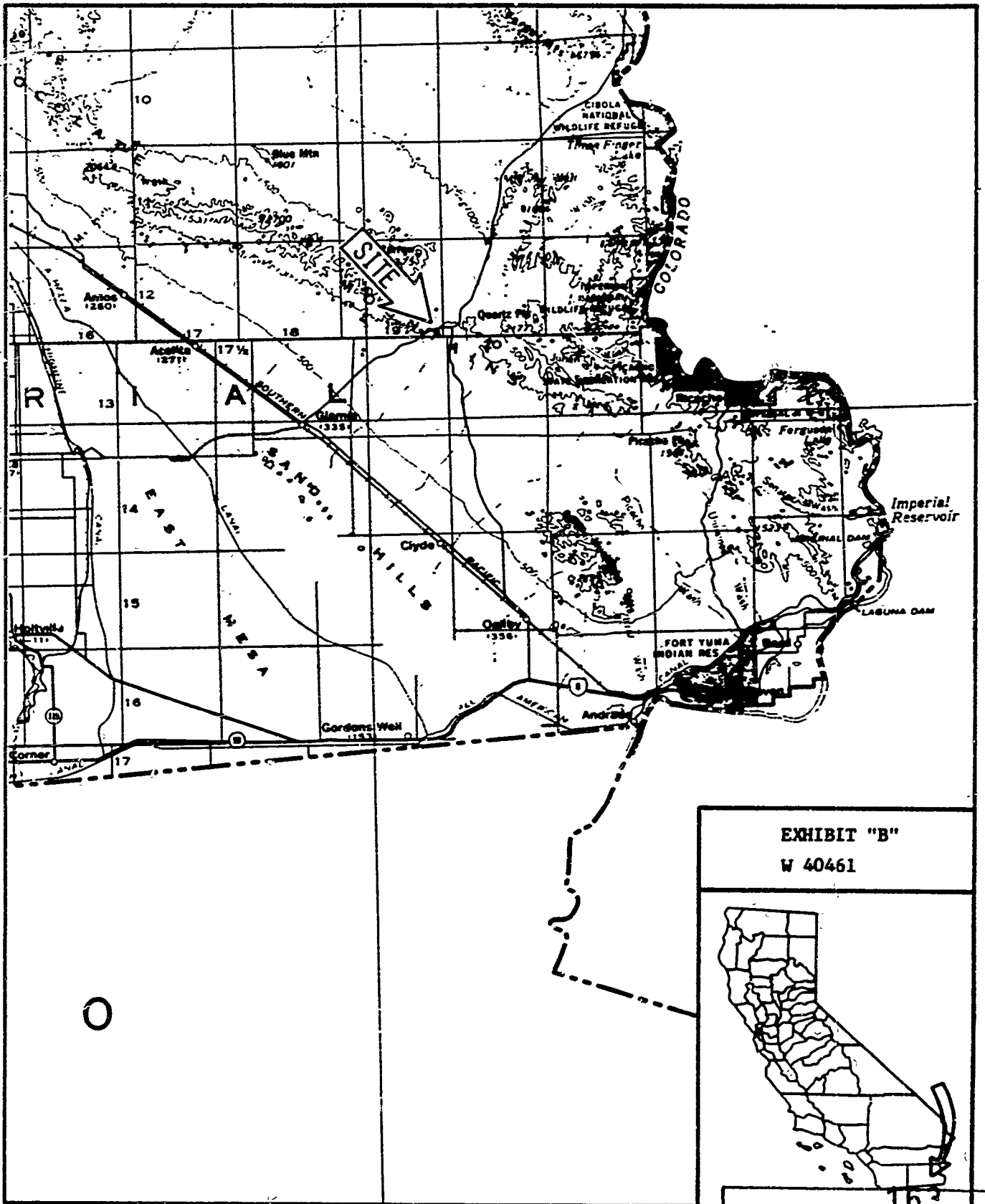

EXHIBIT "B"

W 40461



CALENDAR PAGE

MINUTE PAGE

610

EXHIBIT "A"

LAND DESCRIPTION

W40462

A parcel of California State school lands in Imperial County, California,
described as follows:

The NE¼ of Section 36, T12S, R19E, SBM.

EXCEPTING THEREFROM any portion thereof lying within the 100 foot right-of-way
of California State Highway 78.

END OF DESCRIPTION

PREPARED APRIL 25, 1985, BY BOUNDARY SERVICES UNIT, M. L. SHAFER, SUPERVISOR.

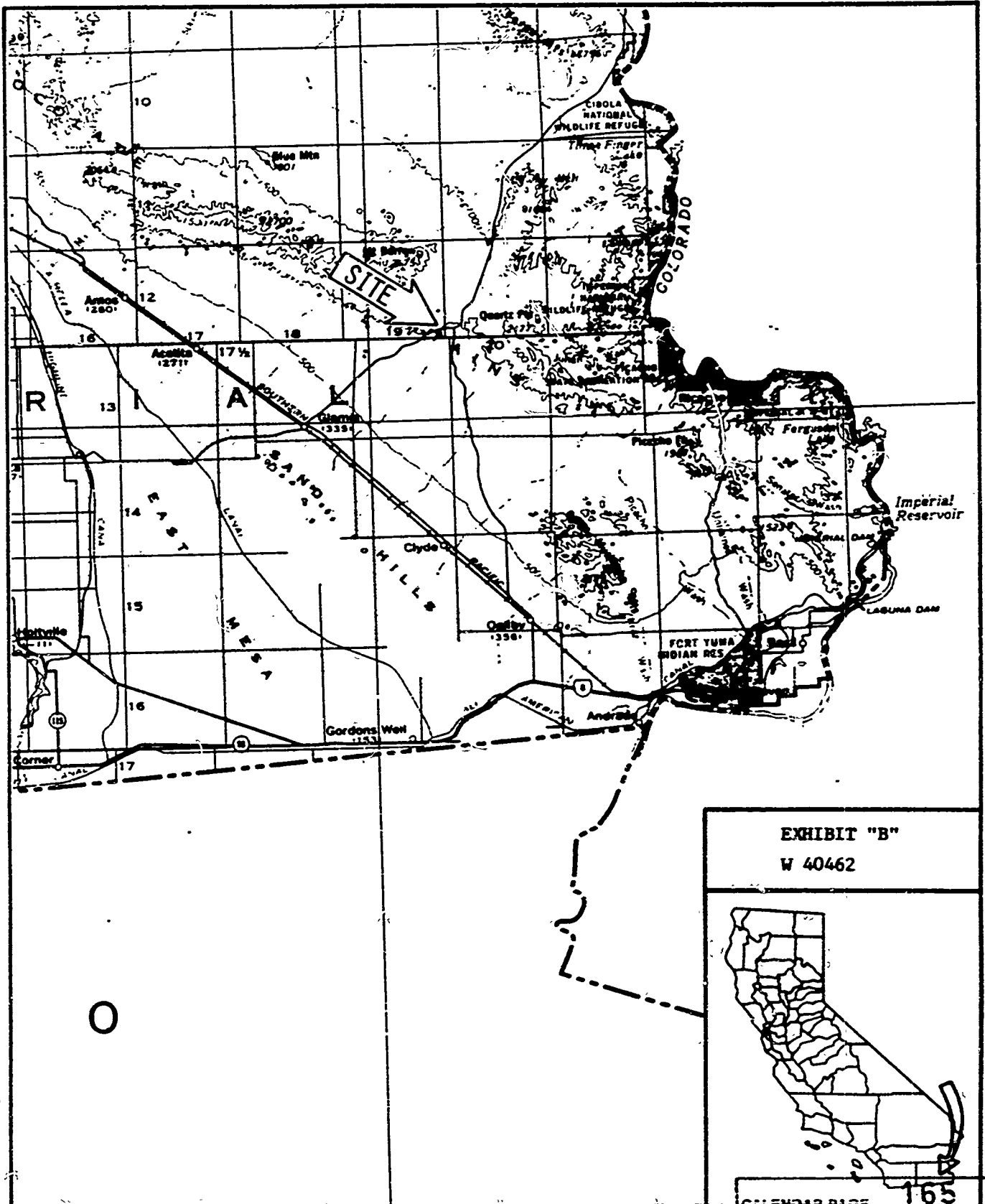

EXHIBIT "B"
W 40462



CALENDAR PAGE 165
MINUTE PAGE 612

EXHIBIT "C"

STATE OF CALIFORNIA—STATE LANDS COMMISSION

GEORGE DEUKMEJIAN, Governor

STATE LANDS COMMISSION
1807 13TH STREET
SACRAMENTO, CALIFORNIA 95814



PROPOSED NEGATIVE DECLARATION

EIR NO 388

File Ref.: W 40459, W 40460,
W 40461, W 40462
SCH#: 85073115

Project Title: Four Mineral Prospecting Permits - Southern Chocolate Mountains

Project Proponent: Mr. & Mrs. Rolla Buck, Conrad Harley, Edgar L. Buck, and Tom P. Stephens

Project Location: Section 36, T.12 S., R.19 E., S.B.M., except that portion within State Highway 78, approximately 10 miles northeast of Glamis, Imperial County.

Project Description: The four applicants, each on a quarter section (approximately 160 acres), will drill approximately 64 holes on each quarter section ranging in depth from 2' to 18' using a portable hand held auger. In addition, one or two 4-inch diameter holes may be drilled on each quarter section to a maximum depth of 400 feet.

Contact Person: Ted T. Fukushima

Telephone: (916)322-7813

This document is prepared pursuant to the requirements of the California Environmental Quality Act (Section 21000 et seq., Public Resources Code), the State CEQA Guidelines (Section 15000 et seq., Title 14, California Administrative Code), and the State Lands Commission regulations (Section 2901 et seq., Title 2, California Administrative Code).

Based upon the attached Initial Study, it has been found that:

the project will not have a significant effect on the environment.

mitigation measures included in the project will avoid potentially significant effects.

CALENDAR PAGE	166
MINUTE PAGE	613

Form 13.17 (3/85)

File Ref.: W 40459
W 40460
W 40461
W 40462

SCH# 85073115

**MITIGATION MEASURES
PROPOSED FOR INCORPORATION INTO THE PROJECT DESCRIPTION**

1. Prospecting excavations and related activities will be conducted in such a manner that will avoid adverse impacts to desert wildlife and vegetation.
2. Prior to augering each hole, the applicant shall inspect each drill site to determine if burrowing animals are present. If any burrows are found, the drill hole will be located where burrows and wildlife would not be adversely affected.
3. If hibernating desert tortoise are found within the excavation areas, the permittee should contact Kim Nicol (DFG Biologist) at (619) 393-3747 to determine the appropriate action to be taken to avoid loss of this state-designated protected species.

File Ref.: W 40459
W 40460
W 40461
W 40462

SCH# 85073115

COMMENTS RECEIVED ON INITIAL STUDY AND RESPONSES TO COMMENTS

1. Department of Parks and Recreation

Comments:

"We have reviewed the initial study you have provided on the four mineral prospecting permits on State Lands located in the Mesquite Mining District in Imperial County. It appears that a Negative Declaration would be the appropriate environmental document.

Response:

None required

2. Department of Transportation

Comments:

"Caltrans District 11 will evidently not have a role within the meaning of Section 21080.3. Future consultation could become necessary, however, if the initial exploration leads to a project involving work within the right-of-way State Route 78".

Response:

The mineral prospecting permit document will specifically exclude the 12.57 acres for Caltrans right-of-way State Highway 78.

3. Department of Fish and Game

Comments:

"We could concur with the proposed activities being processed as a conditioned Negative Declaration if the following conditions are included in each permit:

1. The extent of prospecting activities (size, depth, and number of sample excavations) should not exceed those identified in the Initial Study.
2. Prospecting excavations and related activities should avoid adverse impacts to desert biological resources.
3. Prior to commencement of operations, each excavation site should be inspected to determine if burrowing animals are present and would be adversely affected by drilling activities. If impacts could occur, prospecting activities shall be located where such resources would not be adversely affected.

If hibernating desert tortoise are found within the excavation areas, the permittee should contact Kim Nicol (DFG Biologist) at (619) 393-3747 to determine the appropriate action to be taken to avoid loss of this state-designated protected species.

4. New access road construction shall be prohibited in order to avoid adverse impacts to desert biological resources and to avoid creating new access for ORV users.
5. If commercial mineral deposits are discovered that could involve commercial mining operations, the applicant shall be required to prepare an EIR.
6. The applicant should be advised that diversion of the natural flow or changes in the channel, bed, or banks of any river, stream, or lake will require notification to the Department of Fish and Game as called for in the Fish and Game Code. This notification (with fee) and the subsequent agreement must be completed prior to initiating any such changes. Notification should be made after the project is approved by the lead agency."

Response:

1. The issued prospecting permit will be subject to the described exploration activities and mitigation measures in the Negative Declaration, which will be documented in Paragraph 3 and Exhibit "A" of the permit.

2. See Mitigation Measure number 1
3. See Mitigation Measures number 2 and 3
4. Access shall be limited under Exhibit "A" of the permit to existing roads and jeep trails. No new road construction will be permitted.
5. Before issuance of a lease to commercially extract valuable deposits of minerals, paragraph 15(a) of the permit states:

"(a) That permittee complies with the provisions of Public Resources Code Section 6371, governing the preparation of environmental reports."
6. The applicant will be advised of the provisions of Fish and Game Code Section 1603. In addition, any permit issued by the Commission requires any applicant to receive and comply with all other laws, regulations and permit conditions.

File Ref.: W 40459
W 40460
W 40461
W 40462

**INITIAL STUDY
INTRODUCTION**

Mr. and Mrs. Rolla Buck, Conrad Harley, Edgar L. Buck and Tom P. Stephens have separately applied to the State Lands Commission for four mineral prospecting permits on State lands located in the Mesquite Mining District, east of Glamis, in eastern Imperial County, California. The proposed project consists of augering approximately 64 holes, 2 inches in diameter and from 2 to 12 feet deep on each quarter section using a portable hand held auger. In addition one or two four inch holes may be drilled on each quarter section to a maximum depth of 400 feet. The samples will be tested and assayed to determine placer values for gold and other valuable minerals.

The permits when issued, are for a two-year period and may be extended for a maximum of one year.

This initial study consists of an environmental impact assessment checklist, information form response and maps.

STATE LANDS COMMISSION
September 1985

EXHIBIT "A"

STATE LANDS COMMISSION

W 40459, W 40460; W 40461, W40462

APPLICATIONS for FOUR PROSPECTING PERMITS

R. BUCK, C. HARLEY, E. BUCK, T. STEPHENS

IMPERIAL COUNTY

SEPTEMBER 1985

G.J.P.

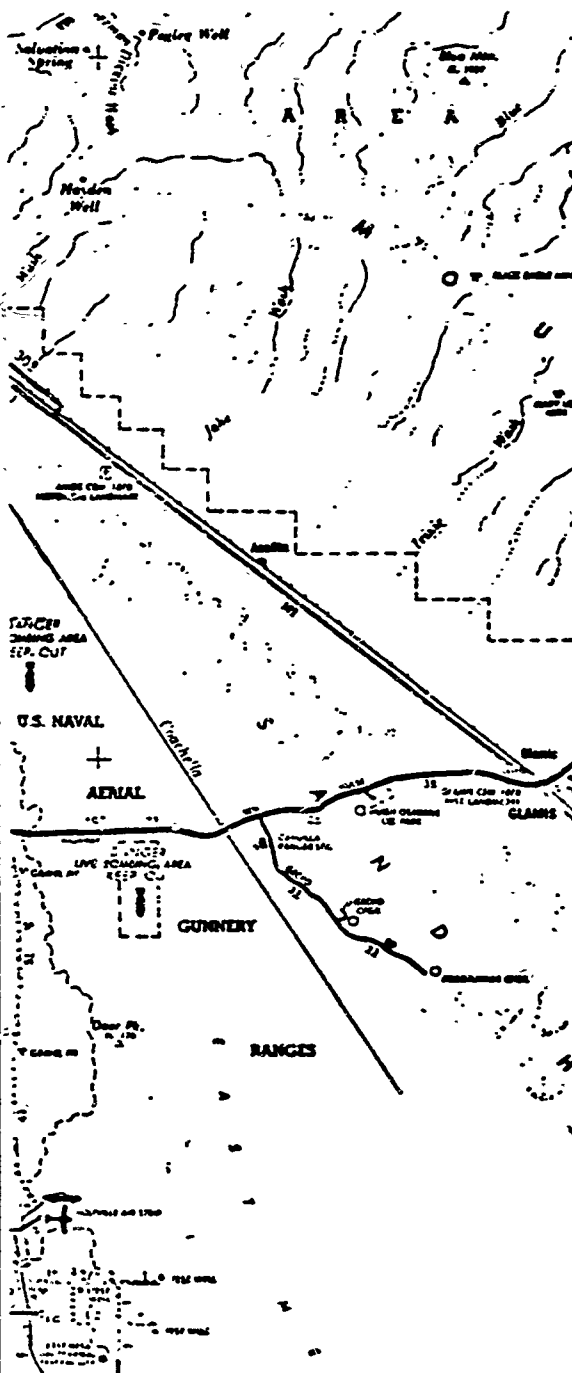
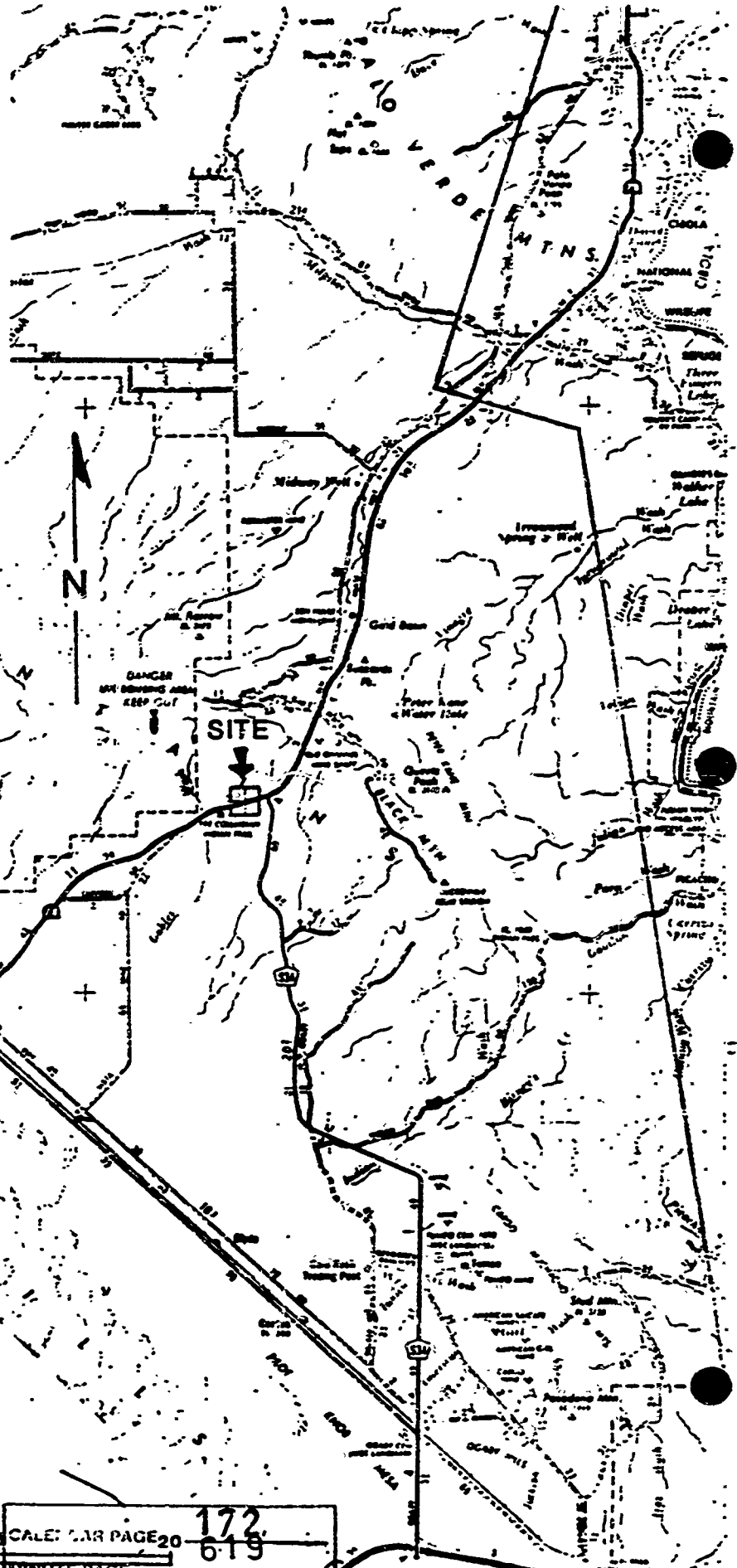

5 10

SCALE BAR PAGE 20 172 619

MINUTE PAGE

EXHIBIT "B"

● QUARTZ PEAK, CALIFORNIA

15' USGS
QUADRANGLE

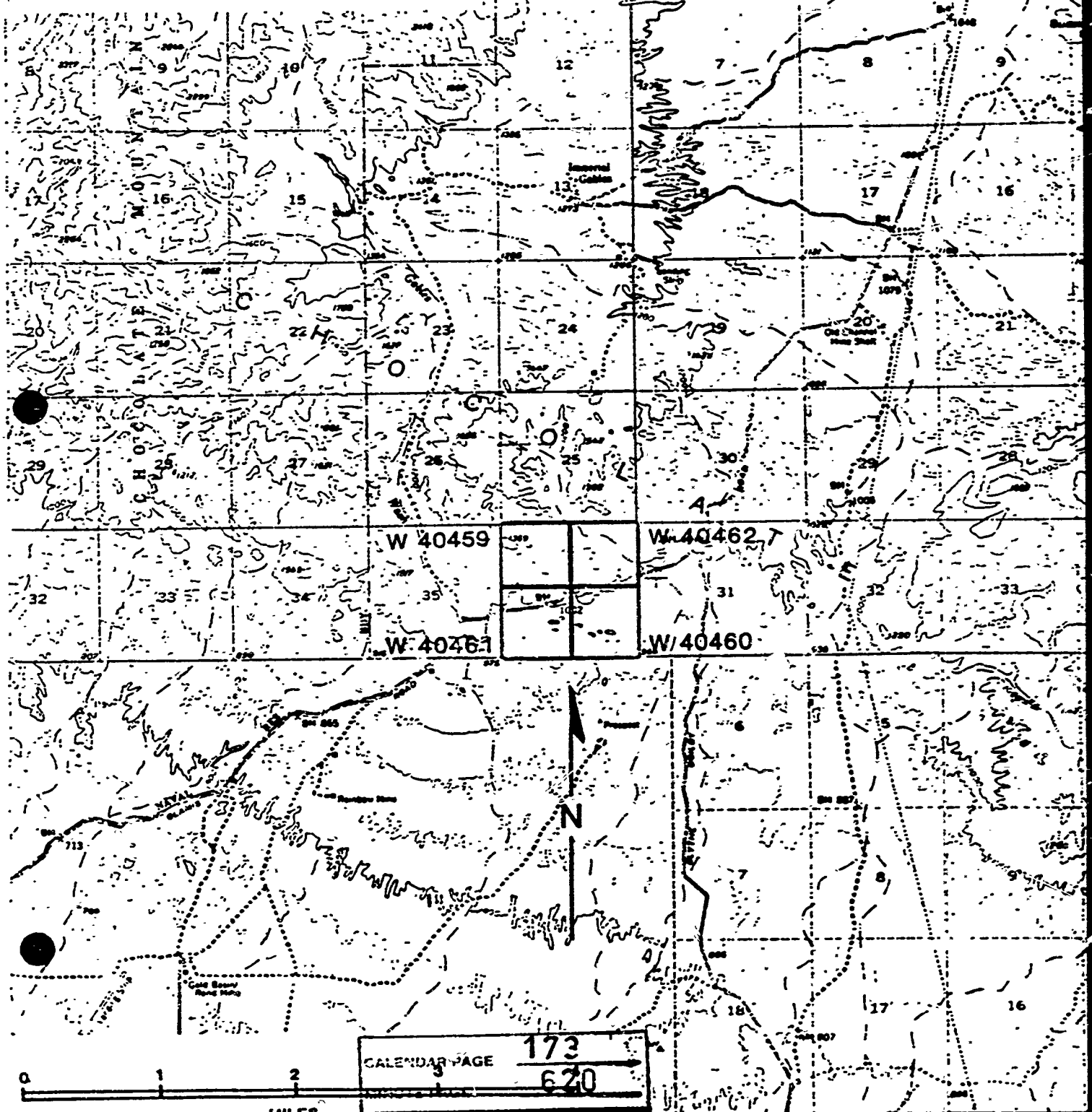

W 40459

W 40462

W 40461

W 40460

CALENDAR PAGE 173
620

B. *Air.* Will the proposal result in:

Yes Maybe No

- 1. Substantial air emissions or deterioration of ambient air quality?
- 2. The creation of objectionable odors?
- 3. Alteration of air movement, moisture or temperature, or any change in climate, either locally or regionally?

C. *Water.* Will the proposal result in:

- 1. Changes in the currents, or the course or direction of water movements, in either marine or fresh waters?
- 2. Changes in absorption rates, drainage patterns, or the rate and amount of surface water runoff?
- 3. Alterations to the course or flow of flood waters?
- 4. Change in the amount of surface water in any water body?
- 5. Discharge into surface waters, or in any alteration of surface water quality, including but not limited to temperature, dissolved oxygen or turbidity?
- 6. Alteration of the direction or rate of flow of ground waters?
- 7. Change in the quantity of ground waters, either through direct additions or withdrawals, or through interception of an aquifer by cuts or excavations?
- 8. Substantial reduction in the amount of water otherwise available for public water supplies?
- 9. Exposure of people or property to water-related hazards such as flooding or tidal waves?
- 10. Significant changes in the temperature, flow or chemical content of surface thermal springs?

D. *Plant Life.* Will the proposal result in:

- 1. Change in the diversity of species, or number of any species of plants (including trees, shrubs, grass, crops, and aquatic plants)?
- 2. Reduction of the numbers of any unique, rare or endangered species of plants?
- 3. Introduction of new species of plants into an area, or in a barrier to the normal replenishment of existing species?
- 4. Reduction in acreage of any agricultural crop?

E. *Animal Life.* Will the proposal result in:

- 1. Change in the diversity of species, or numbers of any species of animals (birds, land animals including reptiles, fish and shellfish, benthic organisms, or insects)?
- 2. Reduction of the numbers of any unique, rare or endangered species of animals?
- 3. Introduction of new species of animals into an area, or result in a barrier to the migration or movement of animals?
- 4. Deterioration to existing fish or wildlife habitat?

F. *Noise.* Will the proposal result in:

- 1. Increase in existing noise levels?
- 2. Exposure of people to severe noise levels?

G. *Light and Glare.* Will the proposal result in:

- 1. The production of new light or glare?

H. *Land Use.* Will the proposal result in:

- 1. A substantial alteration of the present or planned land use of an area?

I. *Natural Resources.* Will the proposal result in:

- 1. Increase in the rate of use of any natural resources?
- 2. Substantial depletion of any nonrenewable resources?

J. Risk of Upset. Does the proposal result in:

Yes Maybe No

- 1. A risk of an explosion or the release of hazardous substances (including, but not limited to, oil, pesticides, chemicals, or radiation) in the event of an accident or upset conditions?
- 2. Possible interference with emergency response plan or an emergency evacuation plan?

K. Population. Will the proposal result in:

- 1. The alteration, distribution, density, or growth rate of the human population of the area?

L. Housing. Will the proposal result in:

- 1. Affecting existing housing, or create a demand for additional housing?

M. Transportation/Circulation. Will the proposal result in:

- 1. Generation of substantial additional vehicular movement?
- 2. Affecting existing parking facilities, or create a demand for new parking?
- 3. Substantial impact upon existing transportation systems?
- 4. Alterations to present patterns of circulation or movement of people and/or goods?
- 5. Alterations to waterborne, rail, or air traffic?
- 6. Increase in traffic hazards to motor vehicles, bicyclists, or pedestrians?

N. Public Services. Will the proposal have an effect upon, or result in a need for new or altered governmental services in any of the following areas:

- 1. Fire protection?
- 2. Police protection?
- 3. Schools?
- 4. Parks and other recreational facilities?
- 5. Maintenance of public facilities including roads?
- 6. Other governmental services?

O. Energy. Will the proposal result in:

- 1. Use of substantial amounts of fuel or energy?
- 2. Substantial increase in demand upon existing sources of energy, or require the development of new sources?

P. Utilities. Will the proposal result in a need for new systems, or substantial alterations to the following utilities:

- 1. Power or natural gas?
- 2. Communication systems?
- 3. Water?
- 4. Sewer or septic tanks?
- 5. Storm water drainage?
- 6. Solid waste and disposal?

Q. Human Health. Will the proposal result in:

- 1. Creation of any health hazard or potential health hazard (excluding mental health)?
- 2. Exposure of people to potential health hazards?

R. Aesthetics. Will the proposal result in:

- 1. The obstruction of any scenic vista or view open to the public, or will the proposal result in the creation of an aesthetically offensive site open to public view?

S. Recreation. Will the proposal result in:

- 1. An impact upon the quality or quantity of existing recreational opportunities?

CALENDAR PAGE	176
MINUTE PAGE	623

T. Cultural Resources.

Yes Maybe No

- 1. Will the proposal result in the alteration of or the destruction of a prehistoric or historic archeological site?
- 2. Will the proposal result in adverse physical or aesthetic effects to a prehistoric or historic building, structure, or object?
- 3. Does the proposal have the potential to cause a physical change which would affect unique ethnic cultural values?
- 4. Will the proposal restrict existing religious or sacred uses within the potential impact area?

U. Mandatory Findings of Significance.

- 1. Does the project have the potential to degrade the quality of the environment, reduce the habitat of a fish or wildlife species, cause a fish or wildlife population to drop below self-sustaining levels, threaten to eliminate a plant or animal community, reduce the number or restrict the range of a rare or endangered plant or animal or eliminate important examples of the major periods of California history or prehistory?
- 2. Does the project have the potential to achieve short-term, to the disadvantage of long-term, environmental goals?
- 3. Does the project have impacts which are individually limited, but cumulatively considerable?
- 4. Does the project have environmental effects which will cause substantial adverse effects on human beings, either directly or indirectly?

III. DISCUSSION OF ENVIRONMENTAL EVALUATION (See Comments Attached)

See attached Detailed Project Description, Discussion of Environmental Evaluation, and Project Environmental Data.

IV. PRELIMINARY DETERMINATION

On the basis of this initial evaluation:

- I find the proposed project COULD NOT have a significant effect on the environment, and a NEGATIVE DECLARATION will be prepared.
- I find that although the proposed project could have a significant effect on the environment, there will not be a significant effect in this case because the mitigation measures described on an attached sheet have been added to the project. A NEGATIVE DECLARATION will be prepared.
- I find the proposed project MAY have a significant effect on the environment, and an ENVIRONMENTAL IMPACT REPORT is required.

Date: 10 18 1985

Heidi J. Pelt
 For the State Land Commission
 MINUTE PAGE 177
 MINUTE PAGE 624
 Form 1320 (1/84)

W 40459
W 40460
W 40461
W 40462

DETAILED PROJECT DESCRIPTION

Mr. and Mrs. Rolla Buck, Conrad Harley, Edgar L. Buck and Tom P. Stephens each on a separate quarter section, propose to conduct exploration in the permit areas by augering two inch holes from 2 to 18 feet deep. See Exhibits C, D, E and F, for quantity and location of the auger holes on each quarter section. Two or three portable two inch augers will be employed. The portable hand held auger equipment is manufactured by Little Beaver, Inc. of Livingston Texas, and is powered by both mechanical and hydraulic units. If geological studies and the initial surface exploration justify extended sub-surface exploration, the permittee will contract with a drill testing service company. If any drill tests are undertaken, there will not be more than one or two 4 inch holes drilled in each quarter section to a maximum depth of 400 feet. Core samples may or may not be taken depending upon the analysis of cuttings. The type of rig that may be utilized cannot be specified at this time. If the project eventually requires a mud program, the actual type of mud may depend to some degree upon the preference of the drilling contractor. It is likely that a fresh water mud may be used in the spudding stage with the possibility that colloidal additives or low density non-dispersed polymer muds could be added at increased depths. Solids disposal could be greatly simplified by the use of low density non-dispersed polymer muds which make products of the operation all biodegradable. If a mud program becomes necessary, a reserve pit 25 feet in diameter may be utilized. All resultant solids would be mixed with a weak cement type stabilizer to be returned to the earth essentially as found. When drilling is completed, the pit would be filled and the remaining solids would be used to improve the dirt road in Section 36 or trucked to disposal areas.

In terms of support vehicles, one pick-up truck will be utilized for the auger program, dry concentrator and general surface support. The drilling phase might involve a portable drill testing unit, a water truck, one drilling service truck and temporary use of one front end loader.

Drill site preparation will depend upon the final sites selected. Preliminary indications are that the sites will be on level ground and thus require little or no grading. Road grading is not necessary due to the presence of a natural pavement of schist in the area. State highway 78 running through Section 36 is not fenced for livestock, however the applicants might put up a three strand barb wire fence around drill sites to protect both bike riders and the site itself. Access by highway 78 and other dirt roads within the project area, should negate the necessity of any road building.

The applicants do not expect that drill testing activity not exceeding a depth of 400 feet would encounter water bearing stratas in the project area due to the lack of water wells in the area. However, in the event that a drill testing program is undertaken which penetrates a water bearing formation, when the drill hole is abandoned, normal industry standards would be followed to seal off the water to prevent circulation between formations. It is likely that at least 32 barrels of bentonite-cement slurry will be pumped down the hole or drill pipe and allowed to set for 18 hours. It will then be tested to determine whether the cavity is sealed. If necessary, the process will be repeated at 12 hour intervals until the cavity has been cemented off. The hole will also be plugged at the surface with concrete.

The applicants emphasize that before a drill testing program is undertaken, the applicants will obtain approval from all appropriate governmental agencies.

It is difficult to calculate maximum excavated volume and surface area disturbance since the extent of prospecting activity depends upon the success of discovery in the early stages of exploration. The applicants estimate that not more than 3000 square feet of surface area will be disturbed. Total excavated volume is not expected to exceed 273 cubic feet. The bulk of the excavated volume includes that processed through the dry concentrator which will be returned to its original source in virtually the same condition.

Sampling, testing and assaying will be performed in a variety of ways for the purpose of estimating placer values. Dry wash tests, using a portable dry washer and panning tests will be made. Due to the very low quality placer expected, the "free milling" properties of the placer material will be determined by using a portable dry concentrator.

EXHIBIT C

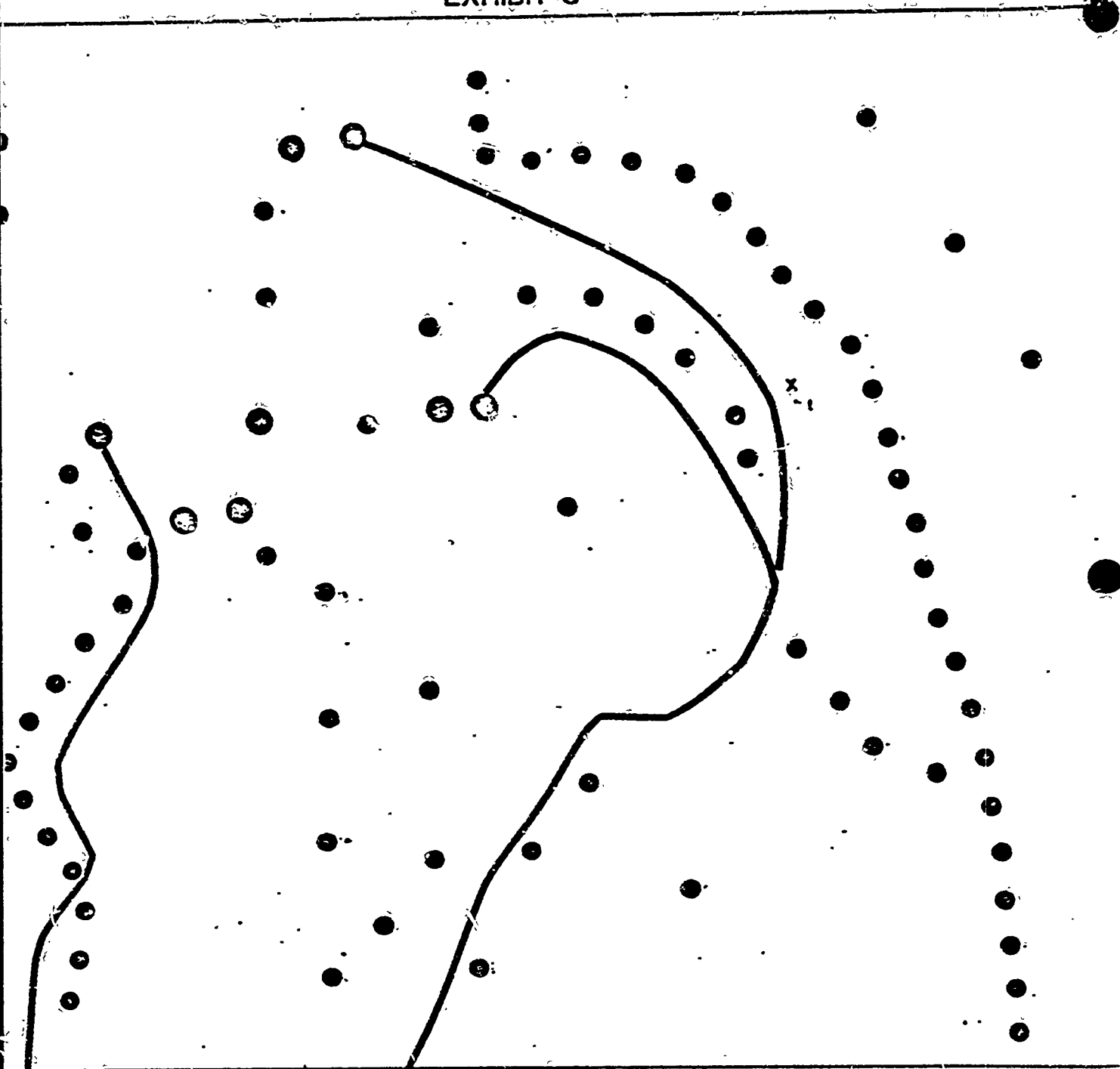

<p>232 444</p> <p>SCALE</p> <p>1 INCH = 322 FT</p>	<p>AN</p> <p>● AUGER</p> <p>X DRILL TEST</p> <p>○ OLD PIT</p>	<p>PROJECT MAP</p> <p>NW 1/4 SECTION 36, T12S R19E</p> <p>W 40459 73 AUGER HOLES</p>
--	---	--

CALENDAR PAGE	180
MINUTE PAGE	627

EXHIBIT D

STATE HIGHWAY 75

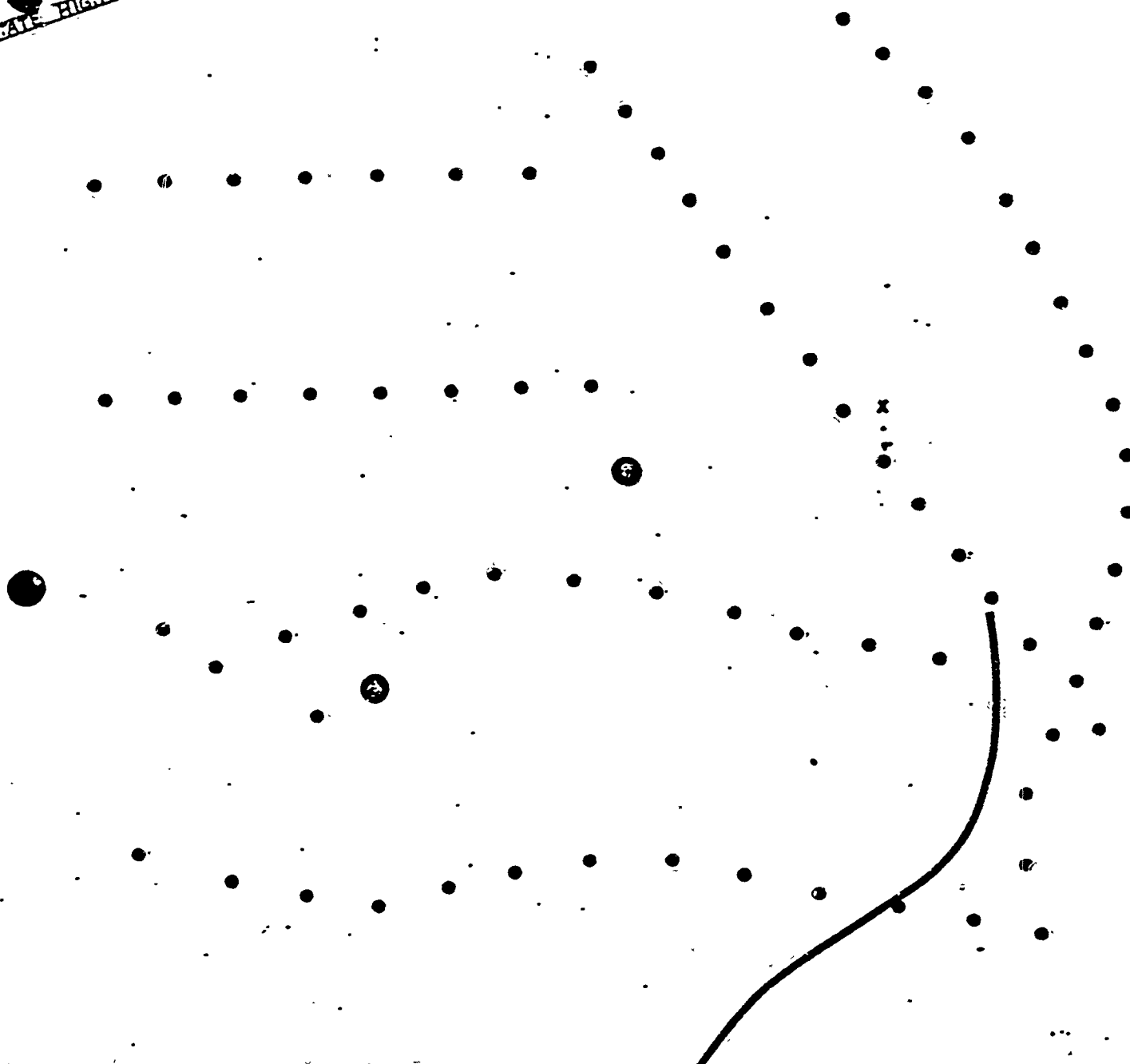

<p>SCALE ONE INCH = 220 FT.</p>	<p>N</p>	<p>● AUGER X DRILL TEST ⊙ OLD PIT</p>	<p>PROJECT MAP SE 1/4 SECTION 36 T12S R19 E W 40460-72 AUGER HOLE</p>
-------------------------------------	----------	---	---

CALENDAR PAGE	181
MINUTE PAGE	628

EXHIBIT E

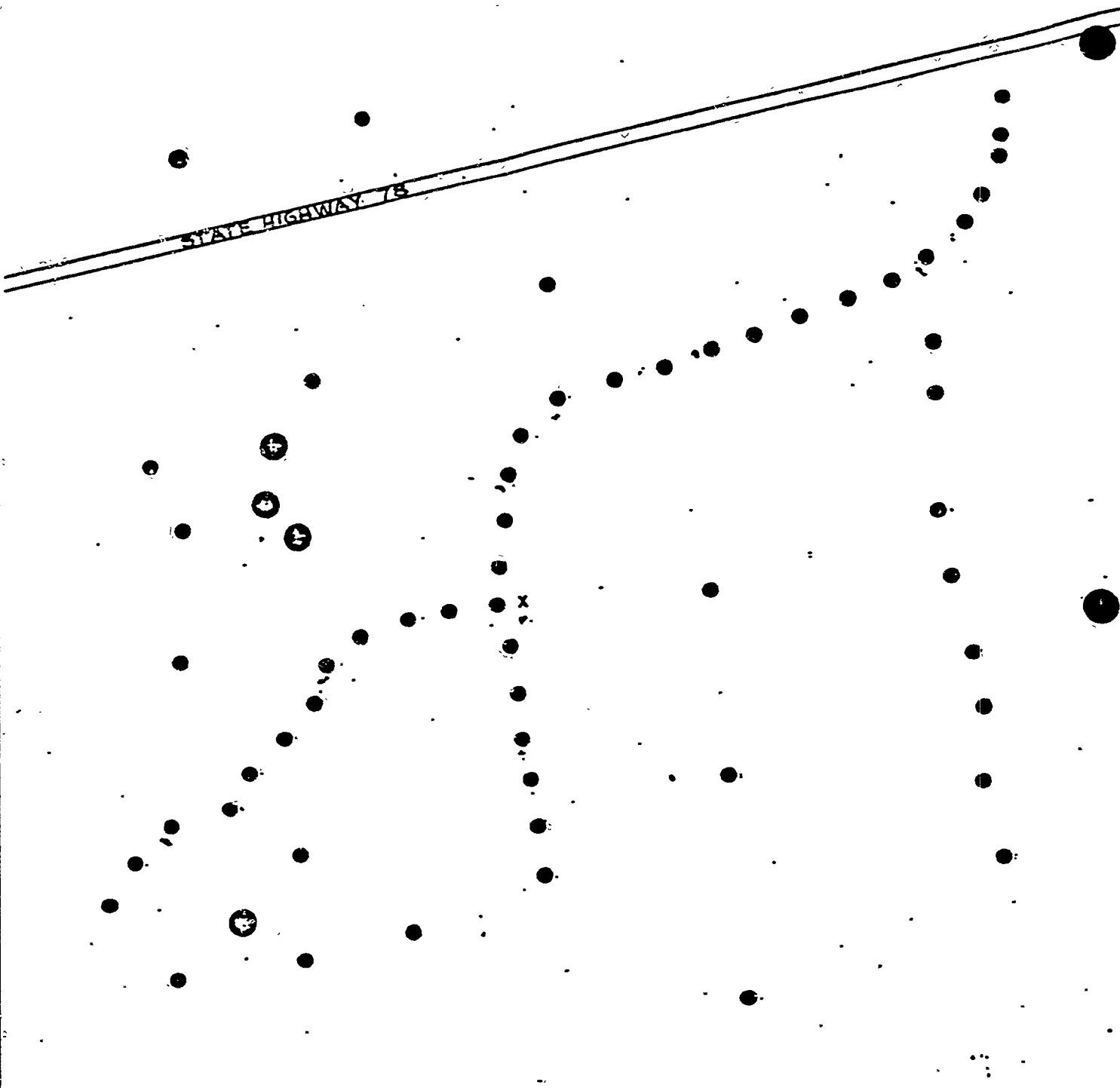

222 244
 EL: ONE INCH = 222 FT





- AUGER _____
- X DRILL TEST _____
- ⊙ OLD PIT _____

PROJECT MAP
 SW 1/4 SECTION 36 T12S R12E
 W 40461-59 AUGER HOLE

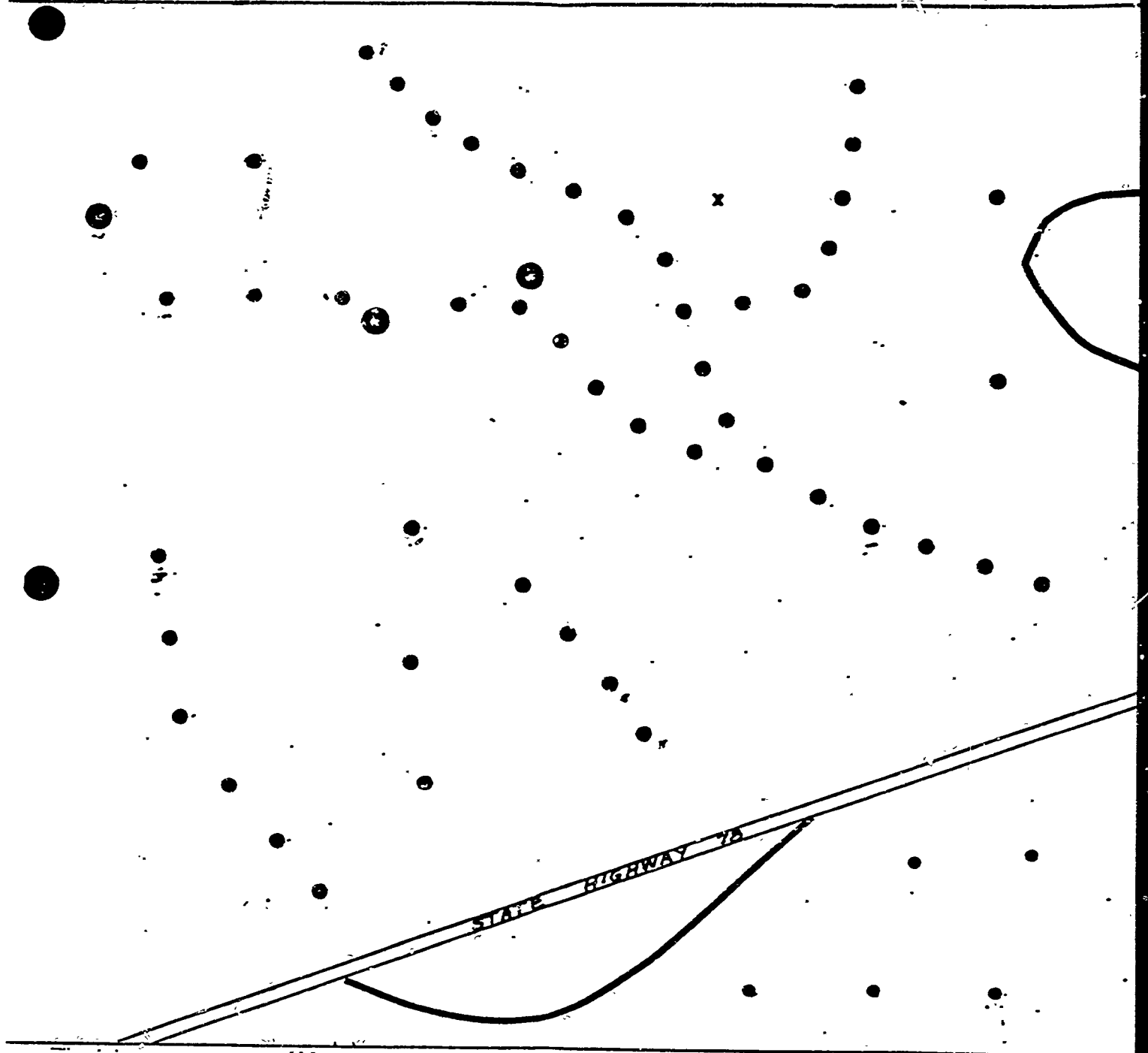
EXHIBIT F

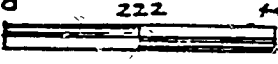

 SCALE ONE INCH = 222 FT.	 N	<ul style="list-style-type: none">● AUGERX DRILL TEST.⊙ OLD PIT	PROJECT MAP NE 1/4 SECTION 36 T12S R13E W 40462-54 AUGER HOLE
--	--	---	---

CALENDAR PAGE	183
MINUTE PAGE	630

W 40459
W 40460
W 40461
W 40462

III Discussion of Environmental Evaluation

- A 2. Disruption, displacement, compaction and overcovering of the soil will occur in the vicinity of the auger holes and possible drill sites.
- A 5. An increase in wind and water erosion of the disturbed soil may take place during wind and rain storms at the auger locations and drill sites.
- C 6. Should the drill holes penetrate water bearing rocks, upon abandonment a bentonite-cement slurry will be pumped down the hole or drill pipe and allowed to set for 18 hours. If necessary, the process will be repeated at 12 hour intervals until the cavity has been cemented off. The hole will be plugged at the surface with concrete.
- F 1. The operating auger, drill rig and accessory activities will temporarily increase the existing noise levels.

PART II

PROJECT AND ENVIRONMENTAL DATA

Form 33.45c (5/84)

SECTION A: PROJECT INFORMATION

Please answer all questions and provide the following information on separate sheet(s) of paper. Please respond in detail. The information is needed to process the application. If any question is inapplicable or otherwise inappropriate to the application, please state the reasons for so concluding.

1. *Project Location.* Submit the following maps and/or drawings: (a) a small-scale (topographic) map or drawing showing the general vicinity of the proposed project including nearby landmarks, roads and other features that would make clear its relationship to the general vicinity, and (b) a large-scale (topographic) map or drawing showing the project location in detail and such features as existing structures, fills, dredged areas and public access. On one of these maps, indicate the property(ies) that are adjacent to the State lands in question and that are owned, leased or otherwise available for use by the applicant. Include copies of all conveyances, leases, permits, easements or other documents that show the extent of the applicant's interest to use or have access to the property(ies) adjacent to the State lands in question.
2. *Existing Zoning and General Plan Designation of Project Site.* Submit all zoning information and include (to the extent available and applicable) the project's street address, city, county, Assessor's parcel number, quad sheet name, section, township, range, base and meridian designation, and/or legal description of the property.
3. *Existing Land Use of Project Site.* Describe the current land use of the area (e.g., residential, commercial, agricultural).
4. *Project Description and Proposed Use of Site.* Describe fully and in detail the proposed activity, its purpose and intended use.
5. *Other Permits Required.* Identify other public agencies having approval authority over the proposed project (e.g., Corps of Engineers, Coastal Commission, county and city agencies) and submit copies of all acquired approvals relating to this project.

SECTION B: ENVIRONMENTAL SETTING

The data and degree of specificity required in this section shall correspond with the data and degree of specificity involved in the underlying activity. Typically, larger projects require more data and a greater degree of specificity, and smaller projects require less data and a lesser degree of specificity.

1. Describe the project site as it exists before commencement of the project. Include information such as topography, soil stability, plants and animals, and any cultural, historical or scenic aspects. Describe any existing structures on the site, the use of the structures, and whether they will be retained or removed. Include photograph(s) of the site, if available.
2. Describe the surrounding properties. Include information such as topography, soil stability, plants and animals, and any cultural, historical or scenic aspects. Indicate the type of land use (e.g., residential, commercial, agricultural), intensity of land use (e.g., one-family dwellings, apartment buildings, shops, department stores) and scale of development. Include photograph(s) of the area, if available.
3. Include a statement of the proposed liquid, solid or gaseous waste disposal methods necessary for the protection and preservation of existing land and water uses.

CALIFORNIA PAGE	185
MINUTE PAGE	632

PART II. PROJECT AND ENVIRONMENTAL DATA

SECTION A: PROJECT INFORMATION

1. PROJECT LOCATION - The permit area is located in Imperial County approximately 37 miles east of Brawley and one mile east of the U.S. Navy Chocolate Mountains Aerial Gunnery Range. It lies within Section 36, Township 12 South, Range 19 East which is bisected by State Highway 78 and is part of the old Mesquite Mining district.

a) Topographic Map. The only USGS topographic map of the area known to the applicant is the Quartz Peak Quadrangle which shows the location of the permit area and its relationship to the general vicinity. A photocopy of the Quartz Peak Quadrangle topographic map which pertains to the proposed permit area is attached as Exhibit A.

b) Regional Map. A regional location map showing the location of the proposed permit area relative to State Highway 78 and S34 is also attached hereto as Exhibit B.

c) Adjacent Lands. None of the property or properties that are adjacent to the State land in question are owned, leased or otherwise available for use by the applicant. Therefore, there are no other existing documents to attach hereto showing the applicant's right to use or access properties adjacent to State lands.

2. EXISTING ZONING AND GENERAL PLAN DESIGNATION OF PROJECT SITE - The proposed permit area is within the old Mesquite Mining district and is an S-open space zone. In terms of consistency with

CALENDAR PAGE	186
MINUTE PAGE	633

the general plan of Imperial County, the proposed prospecting activity is generally consistent with the extractive lands designation in the Open Space Element of the General Plan. The Conservation Element of the General Plan identifies objectives similar to the Open Space Element. In addition, it specifically encourages development of economic mineral resources in the context of sound environmental management.

a) Actual Description of Proposed Permit Area. This application for a mineral prospecting permit relates to the Northwest quarter section (NW 1/4) of Section 36, Township 12 South, Range 19 East, Quartz Peak Quadrangle of the San Bernardino Meridian which comprises 160 acres of Imperial County, California or any portion thereof not classified by the California State Lands Commission as containing commercially valuable mineral deposits.

a) Actual Description of Proposed Permit Area. This application for a mineral prospecting permit relates to the Southeast quarter section (SE 1/4) of Section 36, Township 12 South, Range 19 East, Quartz Peak Quadrangle of the San Bernardino Meridian which comprises 160 acres of Imperial County, California or any portion thereof not classified by the California State Lands Commission as containing commercially valuable mineral deposits.

a) Actual Description of Proposed Permit Area. This application for a mineral prospecting permit relates to the Southwest quarter section (SW 1/4) of Section 36, Township 12 South, Range 19 East, Quartz Peak Quadrangle of the San Bernardino Meridian which comprises 160 acres of Imperial County, California or any portion thereof not classified by the California State Lands Commission as containing commercially valuable mineral deposits.

CALENDAR PAGE	187
MINUTE PAGE	634

a) Actual Description of Proposed Permit Area. This application for a mineral prospecting permit relates to the Northeast quarter section (NE 1/4) of Section 36, Township 12 South, Range 19 East, Quartz Peak Quadrangle of the San Bernardino Meridian which comprises 160 acres of Imperial County, California. Any portion thereof not classified by the California State Lands Commission as containing commercially valuable mineral deposits.

3. EXISTING LAND USE OF PROPOSED PERMIT AREA - The area proposed in this application for a prospecting permit is located one mile east of the U.S. Navy Chocolate Mountain Aerial Gunnery Range.

The permit area is generally an undeveloped and uninhabited part of the old Mesquite Mining District. Section 36 is bisected by a state highway easement for Highway 78; however, the highway is not fenced for livestock. The area contains no inhabitable dwellings. The nearest inhabitants are two prospectors located approximately one mile west of the permit area.

The permit area contains two uncommercial abandoned mines. The proposed activity is a continuation of past and present gold mining activities in the Mesquite area. The prospecting proposed is consistent with the existing use of the area and would not

significantly increase the scale of prospecting activity that has occurred up to this time.

To the best of the applicant's knowledge, the subject land is not serving any beneficial use at the present time.

4. PROJECT DESCRIPTION AND PROPOSED USE OF SITE - The applicant proposes to conduct a mineral exploration and prospecting program on the acreage described herein. The proposed activity is described in more detail in Part III, infra.

5. OTHER PERMITS REQUIRED - To the best of the applicant's knowledge, official approvals from other public agencies or citizens are not required for the type and extent of activity proposed in this application.

SECTION B: ENVIRONMENTAL SETTING

1. TOPOGRAPHY - The permit area, in the foothills of the Chocolate Mountains, is an arid area of sparse vegetation which contains foothills and alluvial fill which ranges in elevation from 1100 to 964 feet above sea level. For more details regarding topography, refer to the topographical map attached as Exhibit A hereto.

2. SOIL STABILITY - The soils in this area are primarily sedimentary deposits composed of decomposed crystalline rocks of igneous, metamorphic and tertiary volcanics. There are some talus

slopes in the area, but they are not a major factor relative to soil stability. It is noted that soil is not of a consistency to cause significant slumping. Only occasionally the alluvial fan is altered by desert washes and flash flooding.

3. VEGETATION AND SENSITIVE PLANT SPECIES - Creosote Bush Scrub accounts for 90% of the permit area. The washes contain plant varieties classified as Desert Microphyle Woodland with a density of more than 11.1 trees per acre. The average annual rainfall for the area is 3 inches.

Several species of cacti are found in the permit area. Only one species is relatively uncommon in California: the Mammillaria Tetrancestra. However, none of the cacti represent peculiar or exemplary stands, assemblages, or densities, and the cacti are not considered a significant botanical resource.

The Calliandra Eriophylla or Fairy Duster occurs in the subject area and it is generally considered to be rare in California but common elsewhere. It does not appear that the prospecting activity contemplated under the proposed permit will be a significant impact on the Fairy Duster population. Under any circumstance, vigorous revegetation of Calliandra has been successful in other mining operations.

Other sensitive plant species have not been noted. None of the above-mentioned plant species and the vegetation in general are expected to be substantially affected by the proposed prospecting activity.

4. WILDLIFE AND WILDLIFE HABITAT - Animals that appear in the area include the Coyote, Kit Fox and Mule Deer.

Although there appear to be no "endangered" species involved, two species which experts consider to be declining in the area are the Black-tailed Gnatcatcher and the Desert Tortoise.

Black-tailed Gnatcatcher are numerous, but losses are not expected from this project. The estimated Desert Tortoise population densities in the project area range from zero to fifty-nine (0-59) tortoises per square mile.

5. CULTURAL AND HISTORICAL ASPECTS - Mining and military activities have largely accounted for most human activity in the vicinity of the permit area.

Mining activities in the Yuma area occurred after the formation of the Republic of Mexico in 1823. The coming of the Southern Pacific Railroad in 1877 stimulated mining activity and eventually the Glamis and Mesquite railroad stations were built to serve the Mesquite Mining district.

Mining in the Mesquite district was suspended by legislation during World War II to permit General Patton to use the area as a desert training ground for his tank corps. Although re-opened in the 1950's, significant interest in the area was not rekindled until the 1970's. Military scars and debris are widely distributed throughout the district.

There are remnants of two prehistoric cultural periods in the Mesquite area: the Early Holocene San Dieguito and the Late Prehistoric Yuman. The hypothetical San Dieguito culture is

CALENDAR PAGE	191
MINUTE PAGE	638

associated with a more moist climate and a hunting and gathering group which persisted 700 years ago.

The interval between the San Dieguito and Yuman cultures is only sparsely represented in the Colorado desert.

The Yuman occupation of the region is related to the former Lake Cahuilla, a fresh water lake in the Salton Trough which has intermittently evaporated three times in the last 2000 years. Most Yuman artifaction and archeological sites are associated with the shorelines of this lake.

Isolated archeological occurrences including geoglyphs, lithic and sherd scatters have been reported on desert pavement surfaces. Impact from vehicular traffic, military movement and natural agents has already occurred.

The Chocolate Mountain Bajada is rated medium on the BLM scenic quality rating. The activity proposed by the applicant will not create a significant visual change in the permit area.

In terms of structures in the area, there are not inhabitable dwellings in the permit area or structures of any kind.

6. SURROUNDING PROPERTIES - The topography, soil stability, plants and animals, and cultural aspects of surrounding properties are similar to the proposed permit area described herein.

There are two dwellings inhabited by prospectors one and a half miles west of the permit area. Two miles west of the permit area is the site of open pit development on BLM land for the proposed Mesquite project.

7. STATEMENT OF WASTE DISPOSAL - Disposal requirements are covered in more details in Part III attached hereto.

SECTION C: ASSESSMENT OF ENVIRONMENTAL IMPACTS W 40459

All phases of a project, such as planning, acquisition, development and operation, shall be considered when evaluating its impact on the environment. Please answer the following questions by placing a check in the appropriate box. Discuss all items checked "yes" or "maybe" on additional sheet(s).

Will the project involve:

	YES	MAYBE	NO
1. A change in existing features of any bays, tidelands, beaches, lakes or hills, or substantial alteration of ground contours?	[]	[]	[X]
2. A change in scenic views from existing residential areas or public lands or roads? ...	[]	[]	[X]
3. A change in pattern, scale or character of the general area of the project?	[]	[]	[X]
4. Significant effect on plant or animal life?	[]	[]	[X]
5. Significant amounts of solid waste or litter?	[]	[]	[X]
6. A change in dust, ash, smoke, fumes or odors in the vicinity?	[]	[]	[X]
7. A change in ocean, bay, lake, stream or ground water quality or quantity, or an altering of existing drainage patterns?	[]	[]	[X]
8. A change in existing noise or vibration levels in the vicinity?	[]	[]	[X]
9. Construction on filled land or on a slope of 10 percent or more?	[]	[]	[X]
10. Use or disposal of potentially hazardous materials such as toxic or radioactive substances, flammables or explosives?	[]	[]	[X]
11. A change in demand for municipal services (e.g., police, fire, water, sewage)?	[]	[]	[X]
12. Increase in fossil fuel consumption (e.g., electricity, oil, natural gas)?	[]	[]	[X]
13. A larger project or a series of projects?	[]	[X]	[]

A larger project will not be undertaken prior to the issuance of a mineral lease from the State Lands Commission.

PART V

CERTIFICATION

I certify that all information and materials furnished in this application are true and complete to the best of my knowledge and belief. I recognize that this application and the project it addresses are subject to all laws of the State of California, and the regulations and discretionary policies of the State Lands Commission.

Applicant: ROLLA BUCK Date: January 22, 1985

Title: _____

ROLLA BUCK

Agent: BY: *E.L. Buck* Date: January 22, 1985
E.L. BUCK, Agent

Title: _____

CALENDAR PAGE
 MINUTE PAGE

193
640

SECTION C: ASSESSMENT OF ENVIRONMENTAL IMPACTS W 40460

All phases of a project, such as planning, acquisition, development and operation, shall be considered when evaluating its impact on the environment. Please answer the following questions by placing a check in the appropriate box. Discuss all items checked "yes" or "maybe" on additional sheet(s).

Will the project involve:

	YES	MAYBE	NO
1. A change in existing features of any bays, tidelands, beaches, lakes or hills, or substantial alteration of ground contours?	[]	[]	[X]
2. A change in scenic views from existing residential areas or public lands or roads? ...	[]	[]	[X]
3. A change in pattern, scale or character of the general area of the project?	[]	[]	[X]
4. Significant effect on plant or animal life?	[]	[]	[X]
5. Significant amounts of solid waste or litter?	[]	[]	[X]
6. A change in dust, ash, smoke, fumes or odors in the vicinity?	[]	[]	[X]
7. A change in ocean, bay, lake, stream or ground water quality or quantity, or an altering of existing drainage patterns?	[]	[]	[X]
8. A change in existing noise or vibration levels in the vicinity?	[]	[]	[X]
9. Construction on filled land or on a slope of 10 percent or more?	[]	[]	[X]
10. Use or disposal of potentially hazardous materials such as toxic or radioactive substances, flammables or explosives?	[]	[]	[X]
11. A change in demand for municipal services (e.g., police, fire, water, sewage)?	[]	[]	[X]
12. Increase in fossil fuel consumption (e.g., electricity, oil, natural gas)?	[]	[]	[X]
13. A larger project or a series of project?	[]	[X]	[]

A larger project will not be undertaken prior to the issuance of a mineral lease from the State Lands Commission.

PART V

CERTIFICATION

I certify that all information and materials furnished in this application are true and complete to the best of my knowledge and belief. I recognize that this application and the project it addresses are subject to all laws of the State of California, and the regulations and discretionary policies of the State Lands Commission.

Applicant: CONRAD HARLEY Date: January 22, 1985

Title: _____

Agent: By: E.L. BUCK
E.L. BUCK, Agent

Date: January 22, 1985

MINUTE PAGE

641

SECTION C: ASSESSMENT OF ENVIRONMENTAL IMPACTS W 40461

All phases of a project, such as planning, acquisition, development and operation, shall be considered when evaluating its impact on the environment. Please answer the following questions by placing a check in the appropriate box. Discuss all items checked "yes" or "maybe" on additional sheet(s).

Will the project involve:

	YES	MAYBE	NO
1. A change in existing features of any bays, tidelands, beaches, lakes or hills, or substantial alteration of ground contours?	[]	[]	[X]
2. A change in scenic views from existing residential areas or public lands or roads? ...	[]	[]	[X]
3. A change in pattern, scale or character of the general area of the project?	[]	[]	[X]
4. Significant effect on plant or animal life?	[]	[]	[X]
5. Significant amounts of solid waste or litter?	[]	[]	[X]
6. A change in dust, ash, smoke, fumes or odors in the vicinity?	[]	[]	[X]
7. A change in ocean, bay, lake, stream or ground water quality or quantity, or an altering of existing drainage patterns?	[]	[]	[X]
8. A change in existing noise or vibration levels in the vicinity?	[]	[]	[X]
9. Construction on filled land or on a slope of 10 percent or more?	[]	[]	[X]
10. Use or disposal of potentially hazardous materials such as toxic or radioactive substances, flammables or explosives?	[]	[]	[X]
11. A change in demand for municipal services (e.g., police, fire, water, sewage)?	[]	[]	[X]
12. Increase in fossil fuel consumption (e.g., electricity, oil, natural gas)?	[]	[]	[X]
13. A larger project or a series of projects?	[]	[X]	[]
A larger project will not be undertaken prior to the issuance of a mineral lease from the State Lands Commission.			

PART V

CERTIFICATION

I certify that all information and materials furnished in this application are true and complete to the best of my knowledge and belief. I recognize that this application and the project it addresses are subject to all laws of the State of California, and the regulations and discretionary policies of the State Lands Commission.

Applicant: Edgar L. BUCK Date: January 22, 1985
 EDGAR L. BUCK

Title: _____

Agent: MCS. E.L. BUCK Date: January 22, 1985

CALENDAR PAGE	195
MINUTE PAGE	642

Title: _____

SECTION C: ASSESSMENT OF ENVIRONMENTAL IMPACTS W 40462

All phases of a project, such as planning, acquisition, development and operation, shall be considered when evaluating its impact on the environment. Please answer the following questions by placing a check in the appropriate box. Discuss all items checked "yes" or "maybe" on additional sheet(s).

Will the project involve:

	YES	MAYBE	NO
1. A change in existing features of any bays, tidelands, beaches, lakes or hills, or substantial alteration of ground contours?	[]	[]	[X]
2. A change in scenic views from existing residential areas or public lands or roads? ...	[]	[]	[X]
3. A change in pattern, scale or character of the general area of the project?	[]	[]	[X]
4. Significant effect on plant or animal life?	[]	[]	[X]
5. Significant amounts of solid waste or litter?	[]	[]	[X]
6. A change in dust, ash, smoke, fumes or odors in the vicinity?	[]	[]	[X]
7. A change in ocean, bay, lake, stream or ground water quality or quantity, or an altering of existing drainage patterns?	[]	[]	[X]
8. A change in existing noise or vibration levels in the vicinity?	[]	[]	[X]
9. Construction on filled land or on a slope of 10 percent or more?	[]	[]	[X]
10. Use or disposal of potentially hazardous materials such as toxic or radioactive substances, flammables or explosives?	[]	[]	[X]
11. A change in demand for municipal services (e.g., police, fire, water, sewage)?	[]	[]	[X]
12. Increase in fossil fuel consumption (e.g., electricity, oil, natural gas)?	[]	[]	[X]
13. A larger project or a series of projects?	[]	[X]	[]

A larger project will not be undertaken prior to the issuance of a mineral lease from the State Lands Commission.

PART V

CERTIFICATION

I certify that all information and materials furnished in this application are true and complete to the best of my knowledge and belief. I recognize that this application and the project it addresses are subject to all laws of the State of California, and the regulations and discretionary policies of the State Lands Commission.

Applicant: TOM P. STEPHENS Date: January 22, 1985

Title: _____

Agent: BY: E.L. BUCK, Agent Date: January 22, 1985