

MINUTE ITEM

This Calendar Item No. 28
was approved as Minute Item
No. 28 by the State Lands
Commission by a vote of 2
to 0 at its 4/26/85
meeting.

CALENDAR ITEM

A 2, 4, 33, 29, 8, 34
S 2, 4, 16, 18

28

06/26/85
W 23541
Shimer

STATE INDEMNITY SELECTIONS

Staff has identified seven parcels of Federally-owned land and mineral interests that have potential for production of oil, gas and geothermal steam in Solano, Sonoma, Lake, Santa Barbara, and Kern Counties. The land and mineral interests on the seven parcels to be acquired are proposed to be filed in four separate selection applications with the Bureau of Land Management.

Staff proposes to use a value for value basis in assigning indemnity base for the federal property.

It is anticipated that approximately 1,400 acres of mineral base would be used in the selections. Final acreage and values to be used will be determined by appraisals to be completed in the near future.

AB 884: N/A.

OTHER PERTINENT INFORMATION:

1. Pursuant to the Commission's delegation of authority and the State CEQA Guidelines (14 Cal. Adm. Code 15061), the staff has determined that this activity is exempt from the requirements of the CEQA because the activity is not a "project" as defined by CEQA and the State CEQA Guidelines.

Authority: P.R.C. 21065 and 14 Cal. Adm. Code 15378.

EXHIBITS: A. Land Descriptions.
B. Location Map.

CALENDAR PAGE	<u>101</u>
MINUTE PAGE	<u>1920</u>

CALENDAR ITEM No. 28, (CONT'D)

IT IS RECOMMENDED THAT THE COMMISSION:

1. FIND THAT THE ACTIVITY IS EXEMPT FROM THE REQUIREMENTS OF THE CEQA PURSUANT TO 14 CAL. ADM. CODE 15061 BECAUSE THE ACTIVITY IS NOT A PROJECT AS DEFINED BY P.R.C. 21065 AND 14 CAL. ADM. CODE 15378.
2. AUTHORIZE FILING STATE INDEMNITY SELECTIONS TO ACQUIRE APPROXIMATELY 1400 ACRES OF FEDERAL LAND AND MINERAL INTERESTS WITH OIL, GAS AND GEOTHERMAL POTENTIAL USING ACRE FOR ACRE BASIS AND FOR VALUE IN ASSIGNING INDEMNITY BASE.

CALENDAR PAGE	102
MINUTE PAGE	1921

EXHIBIT "A"

LAND DESCRIPTION

W 23541

Seven parcels of land in Sonoma, Lake, Solano, Kern, and Santa Barbara Counties, California, described as follows:

PARCEL 1 (Sonoma County)

Lots 5, 12, 13 & 14, Section 2, T11N, R9W, MDM, (157.80 acres).
Lot 3, Section 11, T11N, R9W, MDM, (39.19 acres).

PARCEL 2 (Lake County)

Lots 2, 3, 4, 5, 6, S $\frac{1}{2}$ of NE $\frac{1}{4}$, SE $\frac{1}{4}$ of NW $\frac{1}{4}$, of Section 31, T12N, R8W, MDM, (232.47 acres). Lots 3 & 4, NW $\frac{1}{4}$ of Section 32, T12N, R8W, MDM, (193.67 acres). Lots 1, 2, 3, 4 of Section 6, T11N, R8W, MDM, (62.87 acres).

PARCEL 3 (Solano County)

That portion of the S $\frac{1}{2}$ of Section 3, T4N, R1E, MDM described as follows:

BEGINNING at the $\frac{1}{4}$ corner common to Sections 2 and 3, T4N, R1E, MDM; thence along the east line of said Section 3, S 0° 24' W, 1633.00 feet, said east line being the centerline of County Road No. 71; thence N 89° 34' W parallel with the East-West centerline of said Section 3, 1833.00 feet; thence N 0° 24' E parallel with the aforementioned east line of said Section 3, 1633.00 feet, more or less, to the East-West centerline of said Section 3, said centerline being the centerline of a County Road; thence S 89° 34' E along said centerline 1833.00 feet, more or less, to the point of beginning, (60.72 acres).

PARCEL 4 (Kern County)

N $\frac{1}{2}$ of NE $\frac{1}{4}$ of Section 12, T29S, R20E, MDM, (80 acres).

PARCEL 5 (Kern County)

E $\frac{1}{2}$ of Section 6, T31S, R25E, MDM, (320 acres).

PARCEL 6 (Kern County)

SE $\frac{1}{4}$ of NE $\frac{1}{4}$, E $\frac{1}{2}$ of SE $\frac{1}{4}$, of Section 32, T26S, R28E, MDM, (120 acres).
E $\frac{1}{2}$ of NE $\frac{1}{4}$ of Section 8, T27S, R28E, MDM, (80 acres).

PARCEL 7 (Santa Barbara County)

Lot 3 of Section 34, T8N, R34W, SBM, (38.51 acres).

END OF DESCRIPTION

PREPARED JUNE 6, 1985, BY BOUNDARY SERVICES UNIT, M. L. SHAFER, SUPERVISOR.

(REVISED 06/24/85)

CALENDAR PAGE	103
MINUTE PAGE	9022

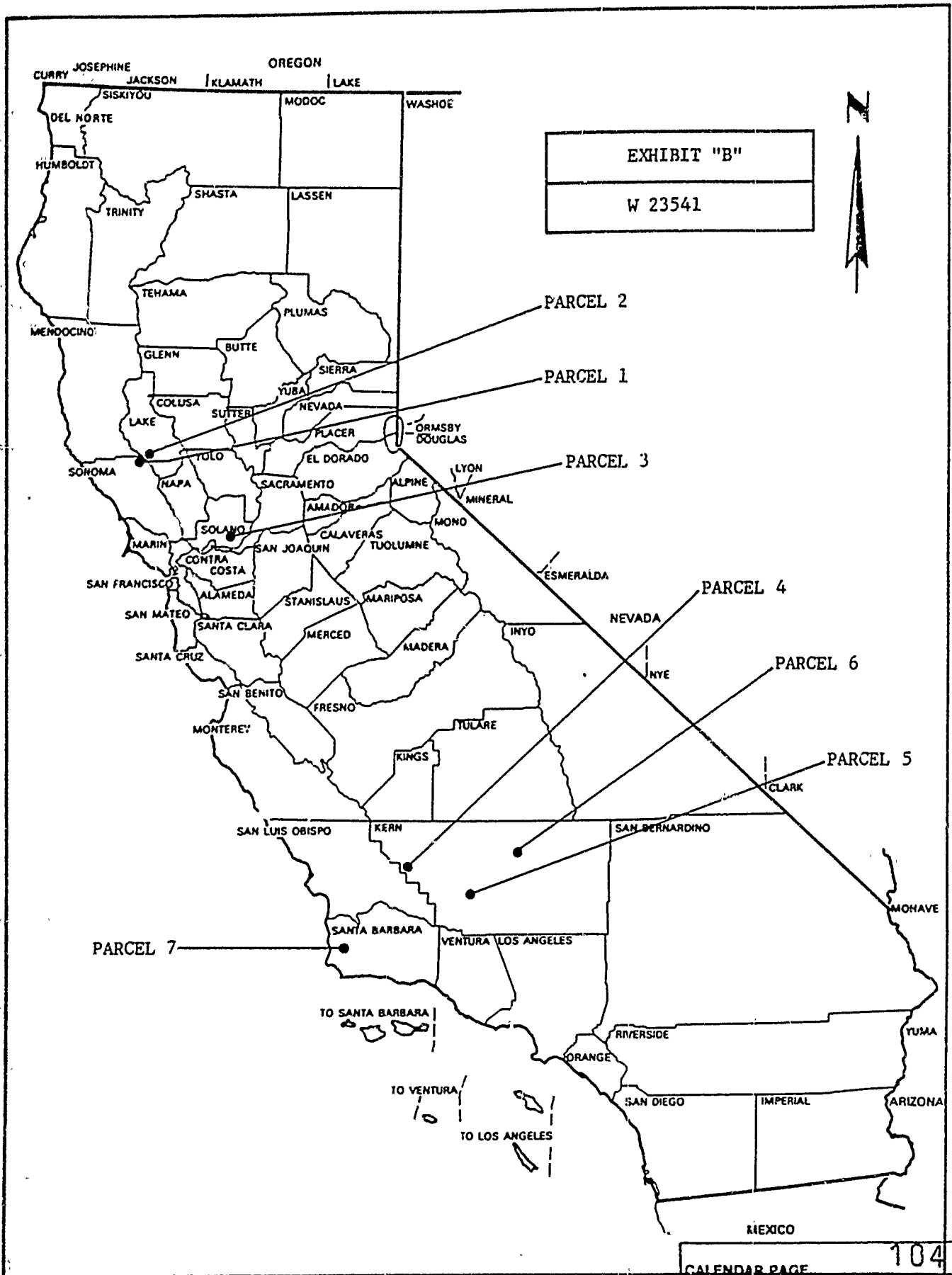

EXHIBIT "B"
W 23541

- PARCEL 1
- PARCEL 2
- PARCEL 3
- PARCEL 4
- PARCEL 5
- PARCEL 6
- PARCEL 7

CALENDAR PAGE 104
MINUTE PAGE 1923