

MINUTE ITEM

This Calendar Item No. C11
is approved as a Minute Item
by the State Lands
Commission by a vote of 2
to 0 on the 2/28/85
meeting.

CALENDAR ITEM

A 1
S 4

C 1 1

02/28/85
W 29327 PRC 6807
Miller

GENERAL LEASE - RIGHT-OF-WAY USE

APPLICANTS: Ron R. and Sharon S. Kreceman
Star Route 530,
Dunsmuir, California 96025

AREA, TYPE LAND AND LOCATION: A 0.372-acre parcel of school land, located
near LaMoine, Shasta County.

LAND USE: Water storage tank and pipeline.

TERMS OF PROPOSED LEASE: Initial period: Ten years beginning January 1,
1984.

Public liability insurance: Combined single
limit coverage of \$100,000.

CONSIDERATION: \$100 per annum; with the State reserving the
right to fix a different rental on each fifth
anniversary of the lease.

BASIS FOR CONSIDERATION: Pursuant to 2 Cal. Adm. Code 2003.

APPLICANT STATUS: Applicant is owner of adjacent land.

PREREQUISITE CONDITIONS, FEES AND EXPENSES:
Filing fee has been paid. First two years rent
have not yet been received. Rental was paid
with post-dated checks. Lease will not be
executed until checks clear.

53
692

CALENDAR ITEM NO. C 1 1 (CONT'D)

STATUTORY AND OTHER REFERENCES:

A. P.R.C.: Div. 6, Parts 1 and 2; Div. 13.

B. Cal. Adm. Code: Title 2, Div. 3; Title 14,
Div. 6.

AB 884:

03/27/85.

OTHER PERTINENT INFORMATION:

1. Applicant has applied to use school land to transport domestic water via an existing 3/4 inch pipeline from a spring to a water storage tank, and continuing on to his home. This pipeline begins on United States Forest Service property, crosses school land, and terminates on the applicant's property.

2. This activity involves lands identified as possessing significant environmental values pursuant to P.R.C. 6370, et seq. Based upon the staff's consultation with the persons nominating such lands and through the CEQA review process, it is the staff's opinion that the project, as proposed, is consistent with its use classification.

3. Pursuant to the Commission's delegation of authority and the State CEQA Guidelines (14 Cal. Adm. Code 15061), the staff has determined that this activity is exempt from the requirements of the CEQA as a categorical exempt project. The project is exempt under Class 1, Existing Facilities, 2 Cal. Adm. Code 2905(a)(2).

Authority: P.R.C. 21084, 14 Cal. Adm. Code 15300, and 2 Cal. Adm. Code 2905.

APPROVALS OBTAINED:

Department of Water Resources, United States Forest Service.

FURTHER APPROVALS REQUIRED:

N/A.

CALENDAR ITEM NO. C11 (CONT'D)

EXHIBITS: A. Land Description.
 B. Location Map.

IT IS RECOMMENDED THAT THE COMMISSION:

1. FIND THAT THE ACTIVITY IS EXEMPT FROM THE REQUIREMENTS OF THE CEQA PURSUANT TO 14 CAL. ADM. CODE 15061 AS A CATEGORICAL EXEMPT PROJECT, CLASS 1, EXISTING FACILITIES, 2 CAL. ADM. CODE 2905(a)(2).
2. FIND THAT THIS ACTIVITY WILL INVOLVE LANDS IDENTIFIED AS POSSESSING SIGNIFICANT ENVIRONMENTAL VALUES PURSUANT TO P.R.C. 6370, ET SEQ., BUT THAT SUCH ACTIVITY WILL HAVE NO DIRECT OR INDIRECT EFFECT ON SUCH LANDS.
3. AUTHORIZE ISSUANCE TO RON R. AND SHARON S. KRECEMAN OF A TEN-YEAR GENERAL LEASE - RIGHT-OF-WAY USE BEGINNING JANUARY 1, 1984; IN CONSIDERATION OF ANNUAL RENT IN THE AMOUNT OF \$100, WITH THE STATE RESERVING THE RIGHT TO FIX A DIFFERENT RENTAL ON EACH FIFTH ANNIVERSARY OF THE LEASE; PROVISION OF PUBLIC LIABILITY INSURANCE FOR COMBINED SINGLE LIMIT COVERAGE OF \$100,000; FOR A WATER PIPELINE AND TANK ON THE LAND DESCRIBED ON EXHIBIT "A" ATTACHED AND BY REFERENCE MADE A PART HEREOF.

55
694

EXHIBIT "A"

LAND DESCRIPTION

W23327

A strip of California State school land in the NW $\frac{1}{4}$ of Section 16, T36N, R5W, MDM, Shasta County, California, said strip lying immediately beneath a water pipeline and tank TOGETHER WITH a use area extending 3 feet on each side of said pipeline and tank, the centerline of said strip being described as follows:

BEGINNING at a point on the north line of said Section 16 from which the north one quarter corner thereof bears easterly 500 feet, more or less; thence southerly along a ridge 2700 feet, more or less, to a point on the south line of the NW $\frac{1}{4}$ of said Section 16 from which the south east corner of said NW $\frac{1}{4}$ bears easterly 400 feet, more or less, last said point being the end of the herein described line.

END OF DESCRIPTION

PREPARED JANUARY 11, 1985 BY BOUNDARY SERVICES UNIT, M. L. SHAFER, SUPERVISOR.

56

695

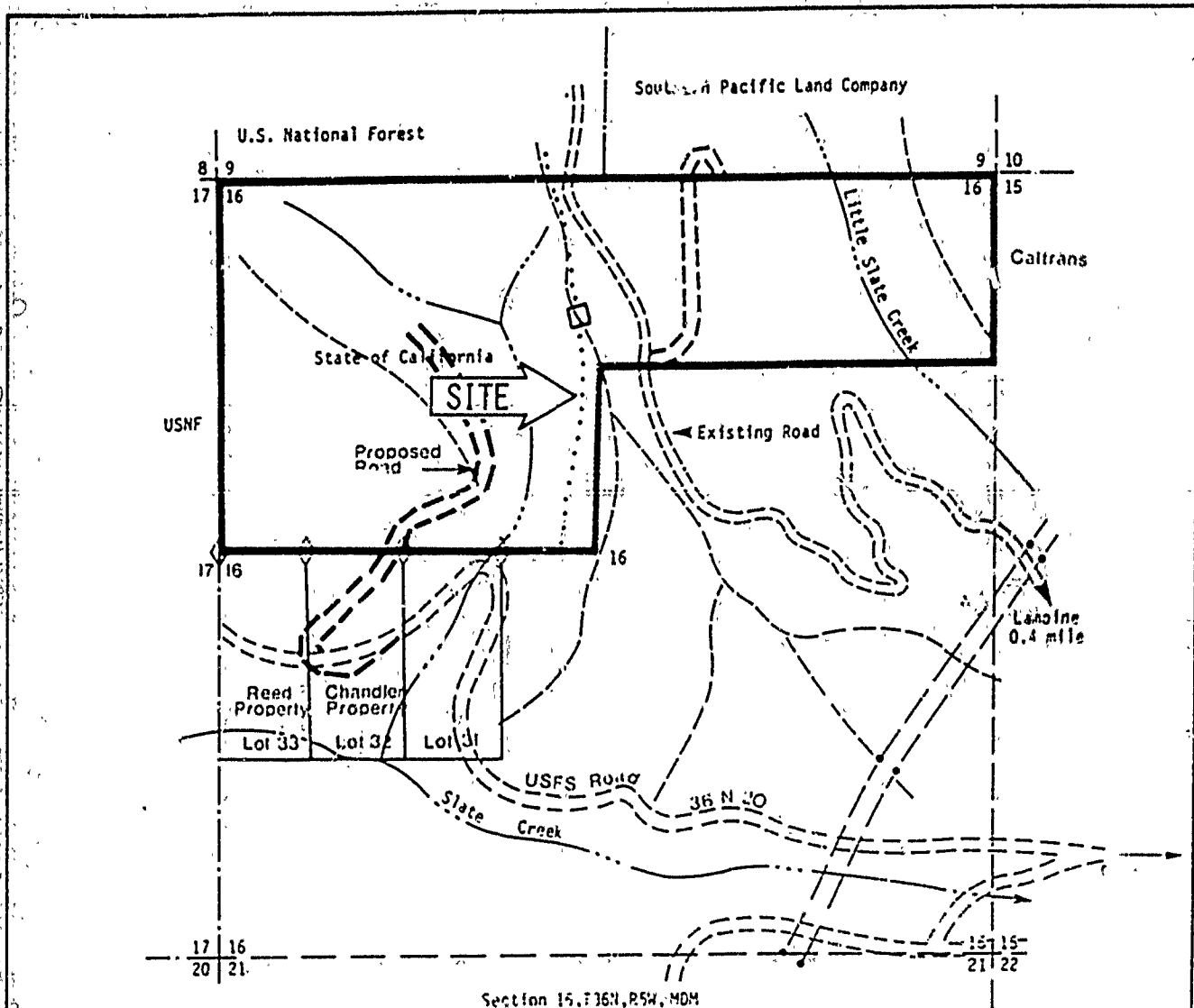

Section 16, T36N, R5W, MDM

LEGEND:

- Boundary of School Land Parcel
- · - - - - Power Line
- - - - - Ridge
- - - - - Stream
- - - - - Existing Road
- - - - - Proposed Road
- ◇ Property Corners Set by State of California
- Storage Tank
- PVC Pipe

EXHIBIT "B"

W 23327



57

MINUTE PAGE

696