

MINUTE ITEM

This Calendar Item No. 003
was approved as Minute Item
No. 3 by the State Lands
Commission by a vote of 3
to 0 at its 1/23/84
meeting.

CALENDAR ITEM

003

01/23/84
W 23291
Omand
PRC 6547

GENERAL PERMIT -
PROTECTIVE STRUCTURE

APPLICANT: William L. and Darlene Brock
3505 Garden Highway
Sacramento, California 95834

AREA, TYPE LAND AND LOCATION:
A 0.14-acre parcel of tide and submerged
land located in the Sacramento River, Sacramento
County.

LAND USE: Stabilization and bank protection.

TERMS OF PROPOSED PERMIT:
Initial period: Twenty-Five years from
January 1, 1984.

CONSIDERATION: The public use and benefit, with the State
reserving the right at any time to set
a monetary rental if the Commission finds
such action to be in the State's best interest.

BASIS FOR CONSIDERATION:
Pursuant to 2 Cal. Adm. Code 2003.

APPLICANT STATUS:
Applicant is owner of upland.

PREREQUISITE CONDITIONS FEES AND EXPENSES:
Filing fee and processing costs have been
received.

A 10

S 6

CALENDAR PAGE	<u>10</u>
MINUTE PAGE	<u>15</u>

CALENDAR ITEM NO. 03 (CONTD)

STATUTORY AND OTHER REFERENCES:

- A. P.R.C.: Div. 6, Parts 1 and 2; Div. 13.
- B. Cal. Adm. Code: Title 2, Div. 3; Title 14, Div. 6.

AB 884: 11/6/84.

OTHER PERTINENT INFORMATION:

1. The annual rental value of the site is estimated to be \$366.00.
2. This project is exempt from CEQA because it is a minor alteration to the land for a protective structure pursuant to 2 Cal. Adm. Code, Div. 3, Section 2905, Class 4(2).
3. This project is situated on lands identified as possessing significant environmental values pursuant to P.R.C. 6370.1 and is classified in a use category "B" which authorizes Limited Use. The project as proposed will not have a significant effect upon the identified environmental values.
4. Staff feels that bank protection at this point will be of mutual benefit to both the public and the applicant. The bank will have additional protection from high water erosion of material at no expense to the public. The applicant will benefit from protection of the existing homesite.

APPROVALS OBTAINED:

United States Army Corps of Engineers.

FURTHER APPROVAL REQUIRED:

State Reclamation Board: California Regional Water Quality Control Board.

CALENDAR ITEM NO. 003 (CONTD)

EXHIBITS: A. Land Description.
 B. Location Map.

IT IS RECOMMENDED THAT THE COMMISSION:

1. FIND THAT THIS ACTIVITY IS EXEMPT FROM THE REQUIREMENTS OF THE CEQA PURSUANT TO 14 CAL. ADM. CODE 15061 UNDER THE PROVISIONS OF P.R.C. 21084, AND 2 CAL. ADM. CODE 2905(d); AND FIND THAT THE PROJECT IS CONSISTENT WITH THE LAND'S USE CLASSIFICATION, PURSUANT TO PRC 6370.1.
2. AUTHORIZE ISSUANCE TO WILLIAM L. AND DARLENE BROCK OF A 25-YEAR GENERAL PERMIT - PROTECTIVE STRUCTURE, FROM JANUARY 1, 1984, THE PUBLIC USE AND BENEFIT, WITH THE STATE RESERVING THE RIGHT AT ANY TIME TO SET A MONETARY RENTAL IF THE COMMISSION FINDS SUCH ACTION TO BE IN THE STATE'S BEST INTEREST; FOR STABILIZATION AND BANK PROTECTION ON THE LAND DESCRIBED ON EXHIBIT "A" ATTACHED AND BY REFERENCE MADE A PART HEREOF.

SACRAMENTO RIVER
 FLOW

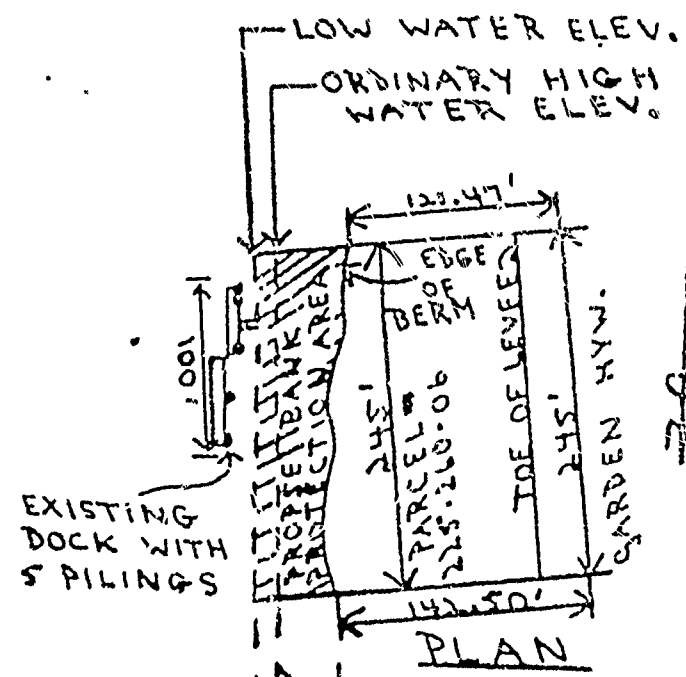

PLAN
 Scale 1" = 100'
 TOP OF BERM 27.0

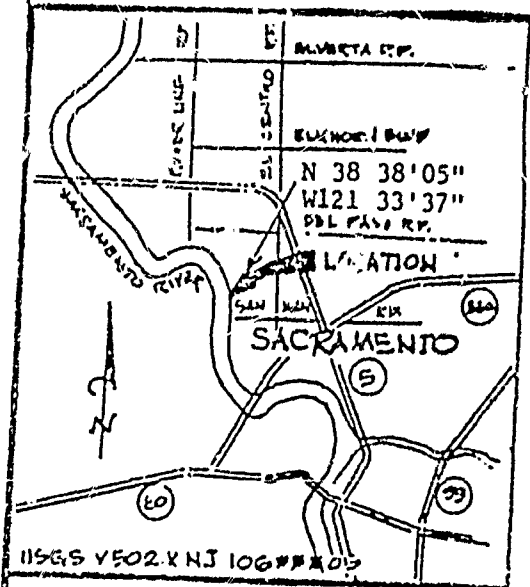

VICINITY MAP
 0 1 2 3 4 5

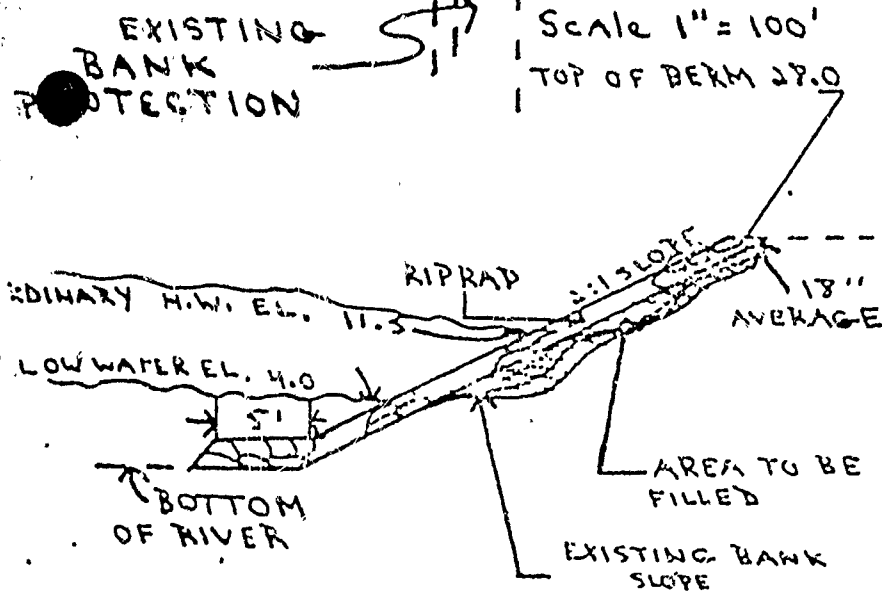

ALL ELEVATIONS
 SHOWN REFER TO U.S.G.S MSL DATUM
TYPICAL SECTION
 SCALE 1" = 10'

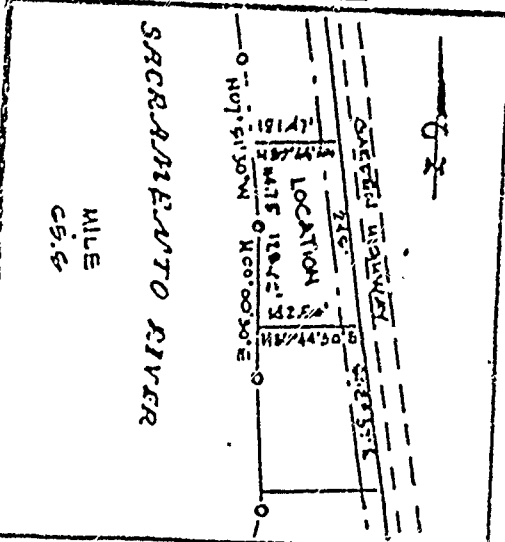

LOCATION MAP
 SCALE: 1" = 230'

PROPOSED BANK PROTECTION

LOCATION: IN THE SACRAMENTO RIVER AT ASSESSOR'S PARCEL NO. 225-260-06 SACRAMENTO COUNTY, CALIFORNIA
 APPLICATION BY:
 MR & MRS. WILLIAM BROCK
 3505 GARDEN HWY.
 SACRAMENTO, CAL. 95834

NOTE: BANK PROTECTION TO BE A 18" LAYER OF CLEAN 2'-3' DIAMETER CONCRETE BLOCKS ON EXISTING SAND FILL BLANKET + CONCRETE BLOCKS EXTENDING FROM TOP OF BERM TO 5' BEYOND TOE OF SLOPE.

EXHIBIT "A"
 LAND DESCRIPTION

CALENDAR PAGE	12.1
MINUTE PAGE	18 of 23291

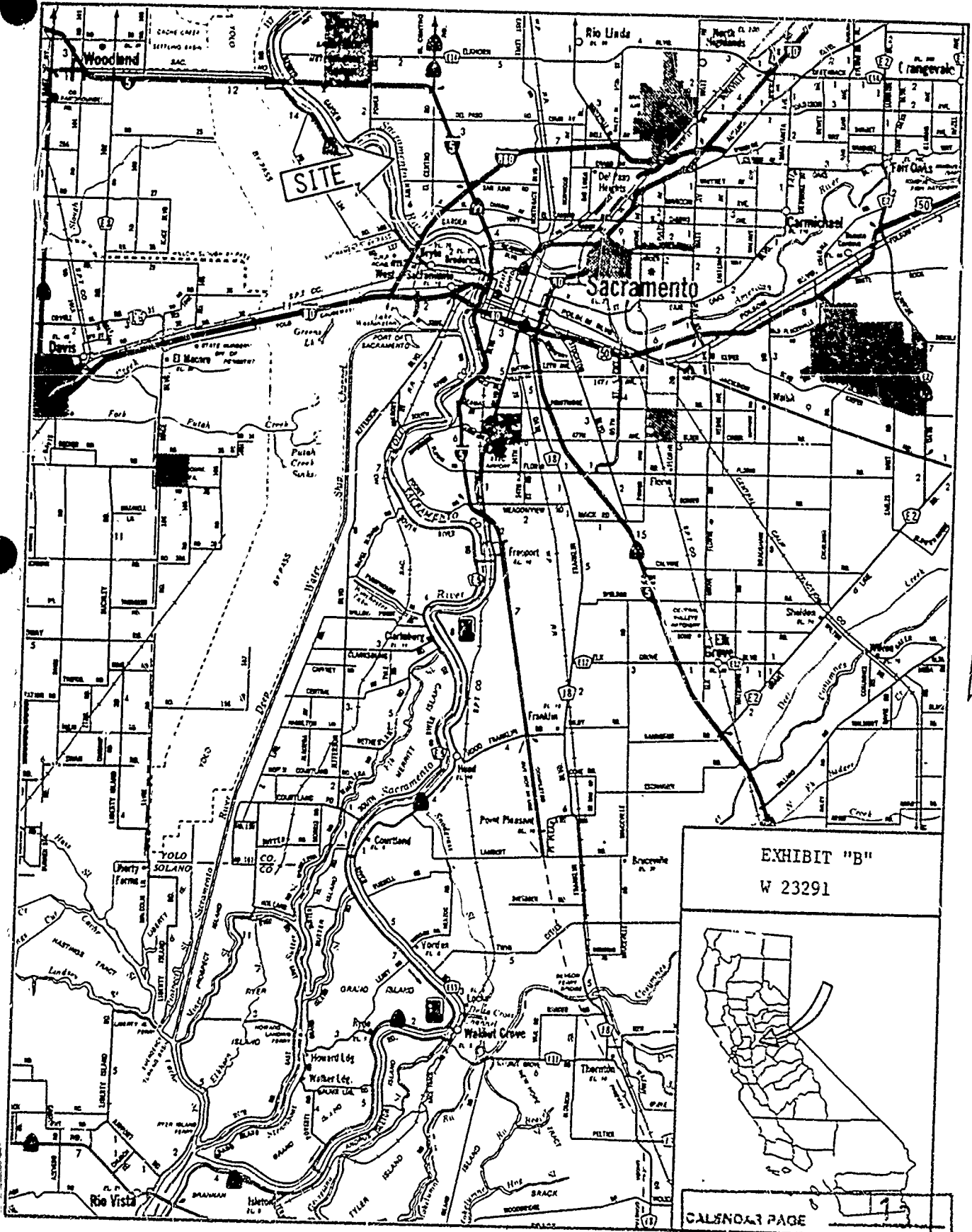

EXHIBIT "B"
W 23291



CALNDAR PAGE	15
MINUTE PAGE	19