

in 25
months

5/31/83

CALENDAR ITEM

. C 1 0

5/31/83
WP 5677 PRC 5677
Suetta

ASSIGNMENT OF PERMIT NO. PRC 5677.1
GENERAL PERMIT - RECREATIONAL USE

ASSIGNOR: Christopher Rivers, Jr.
311 California Street, Room 800
San Francisco, California 94104

ASSIGNEES: Neil J. Vannucci,
Margaret A. Vannucci, and
Nelio Vannucci
155 Highland Avenue
San Carlos, California 94070

AREA, TYPE LAND AND LOCATION:
A 0.06-acre parcel of tide and submerged
land in San Joaquin River at Webb Tract,
Contra Costa County.

LAND USE: Use and maintenance of one double, uncovered
boat berth.

TERMS OF ORIGINAL PERMIT:
Initial period: 25 years from June 1,
1982.
Surety bond: \$3,000.
Public liability insurance:
Combined single limit
coverage of \$200,000.

A 10
S 7

46
940

CALENDAR ITEM NO. C 1 0 (CONTD)

Consideration: \$140 per annum; five-year
rent review.

BASIS FOR CONSIDERATION:

Pursuant to 2 Cal. Adm. Code 2003.

PREREQUISITE TERMS, FEES AND EXPENSES:

Applicant is owner of upland.

Processing costs have been received.

STATUTORY AND OTHER REFERENCES:

A. P.R.C.: Div. 6, Parts 1 and 2; Div. 13.

B. Cal. Adm. Code: Title 2, Div. 3; Title 14,
Div. 6.

AB 884.

N/A.

OTHER PERTINENT INFORMATION:

1. On June 29, 1982, the Commission approved a General Permit - Recreational Use, for Christopher Rivers, Jr., to use and maintain one double, uncovered boat berth on the subject tide and submerged land. Mr. Rivers has since sold the upland to Neil J. Vannucci, Margaret A. Vannucci, and Nelio Vannucci.
2. This activity is exempt from CEQA because it is not a project pursuant to CEQA and the State CEQA guidelines. Authority, 14 Cal. Adm. Code 15037.
3. The activity is situated on lands identified as possessing significant environmental values pursuant to P.R.C. 6370.1 and is classified in a use category "B" which authorizes Limited Use. The project as proposed will not have a significant effect upon the identified environmental values.

APPROVALS OBTAINED:

United States Army Corps of Engineers,
State Reclamation District 2026.

FURTHER APPROVALS REQUIRED:

None.

SEARCHED	47
INDEXED	941

CALENDAR ITEM NO. C 1 0 (CONT'D)

EXHIBITS: A. Land Description.
 B. Location Map.

IT IS RECOMMENDED THAT THE COMMISSION:

1. DETERMINE THAT AN ENVIRONMENTAL DOCUMENT HAS NOT BEEN PREPARED FOR THIS ACTIVITY AS SUCH DOCUMENT IS NOT REQUIRED UNDER THE PROVISIONS OF P.R.C. 21065, 14 CAL. ADM. CODE 15037 AND 15060; AND FIND THAT THE PROJECT IS CONSISTENT WITH ITS USE CLASSIFICATION.
2. AUTHORIZE APPROVAL OF AN ASSIGNMENT OF PERMIT PRC 5677.1, GENERAL PERMIT - RECREATIONAL USE, FROM CHRISTOPHER RIVERS, JR., TO NEIL J. VANNUCCI, MARGARET A. VANNUCCI, AND NELIO VANNUCCI, EFFECTIVE JUNE 1, 1983. ALL OTHER TERMS AND CONDITIONS OF THE PERMIT SHALL REMAIN UNCHANGED.

APPROX. 4420' TO P/L
BEARING N 9° 16' W
ALONG PERIMETER OF ISLAND

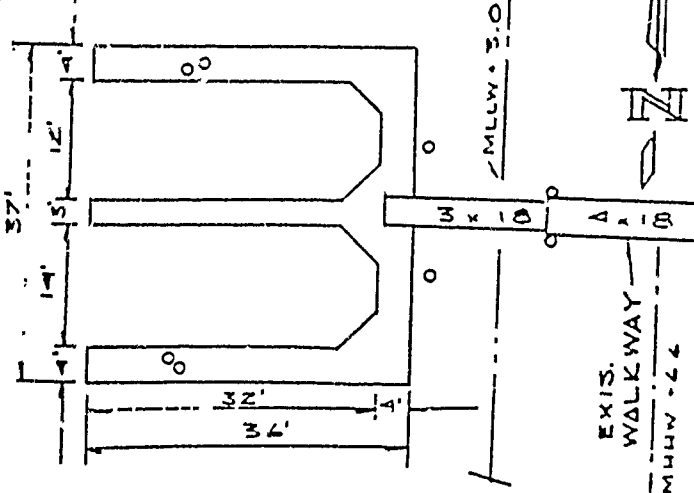

APPROX 1320' TO P/L
BEARING S 82° 35' W
ALONG LEVEE ROAD

PLAN
SCALE @ 1" = 20'

DR. PROP. OWNERS

WON. REAL TRUST CO
1057 FOST ST
VICTORIA, B.C. CANADA
PARCEL 026-070-008

D. J. PICKRELL
P.O. BOX 384
BURLINGAME CA.
94010

ALL SOUNDINGS ARE
MEASURED IN FEET
FROM MLLW + 3.0 COPE
DATUM

MATERIALS
SKI DGAED DECK
GALV. HARDWARE
STYROFOAM FLOATS
3.10 D.F. COL. ST.

SAN JOAQUIN RIVER

FLOOR
EBB

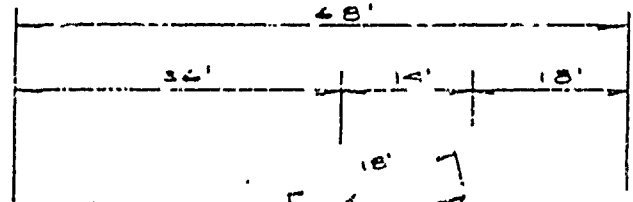

CROSS SECTION
SCALE @ 1" = 20'

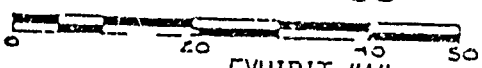
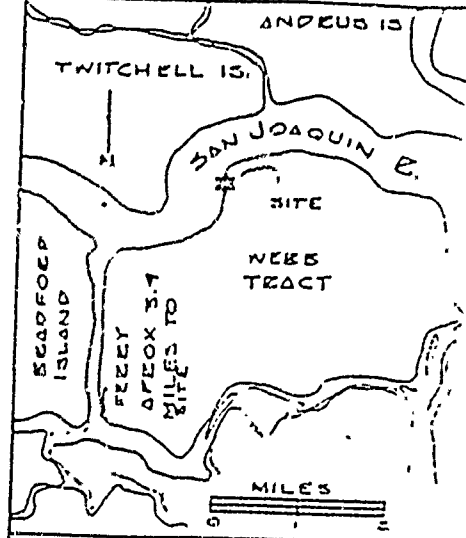
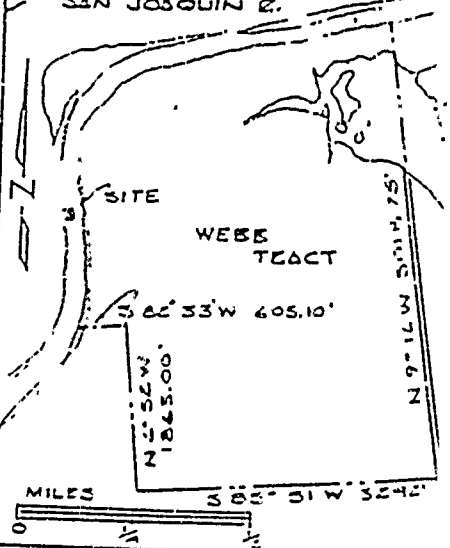

EXHIBIT "A"
IP 5677



FROM CALIF. RES. AGENCY
MAP SEP. 1974

SACTO CO. CONTRA COSTA CO.



FROM USGS 7.5' SERIES
BOULDER - JERSEY IS. CULT
1952

SITE, NORTHWEST
CORNER OF WEBB TRACT
ASSESSORS PARCEL
N° 026-070-001
CONTRA COSTA CO.

DEN. ANDERSON-WIETH
P.O. BOX 208
BETHEL ISLAND, CA.
94511
9-20-78

PLANNING NO.	49
FILE NO.	943

T.B.

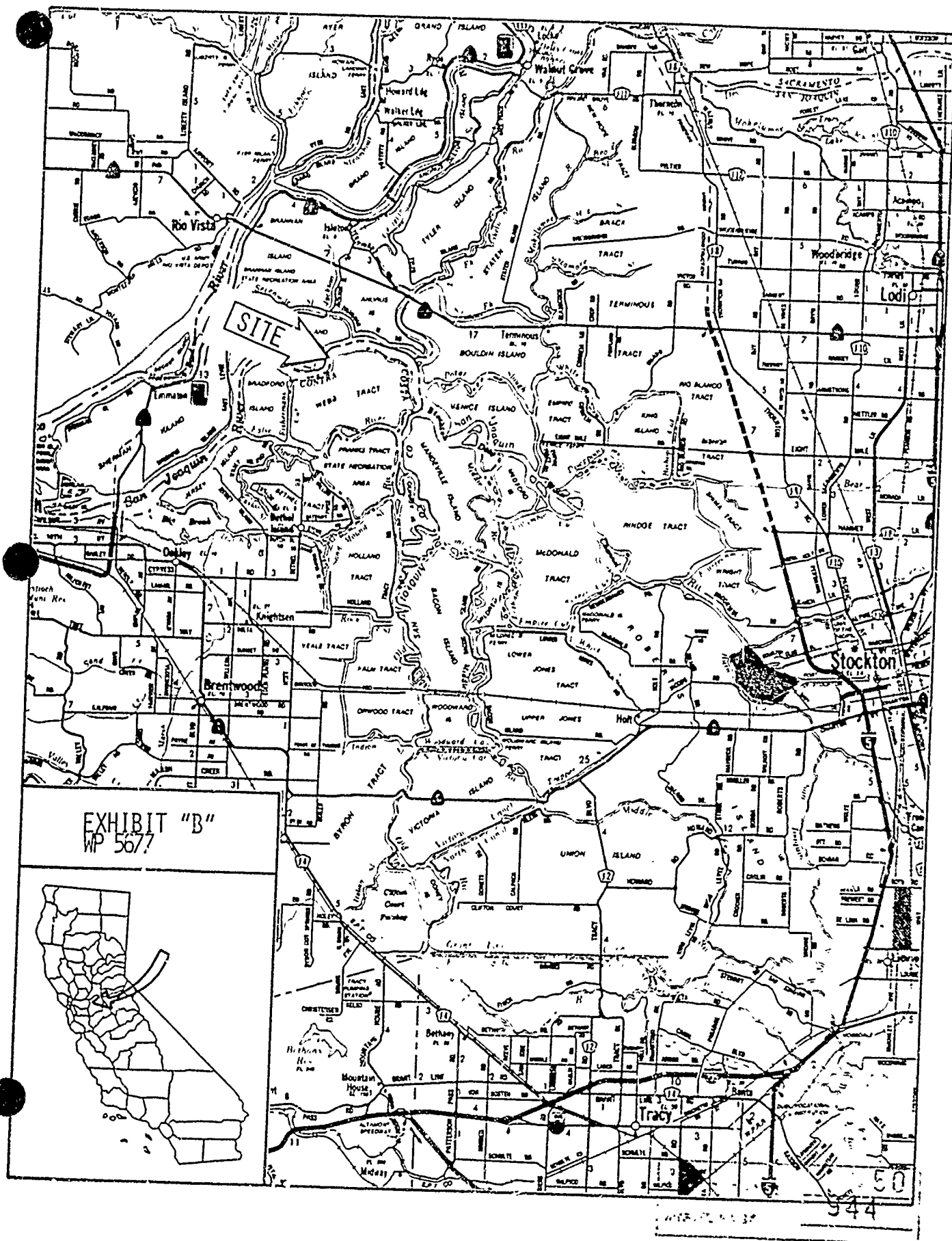

EXHIBIT "B"
WP 5677

344