

C8
to 5/31/83
meeting.

CALENDAR ITEM

C 0 8

5/31/83
W 23022
Lane
PRC 6429

APPROVAL OF A
GENERAL PERMIT - PROTECTIVE STRUCTURE USE

APPLICANT: Tree Slough Farms, Inc.
P. O. Box 114
Rheem Valley, California 94570

AREA, TYPE LAND AND LOCATION:
A 0.01-acre parcel of tide and submerged
land, located in Montezuma Slough at Grizzly
Island, Solano County.

LAND USE: Bulkhead structure for levee protection
and stabilization.

TERMS OF PROPOSED PERMIT:
Initial period: 25 years from July 1,
1982.

CONSIDERATION: The public benefit, with the State reserving
the right at any time to set a monetary
rental if the Commission finds such action
to be in the State's best interest.

BASIS FOR CONSIDERATION:
Pursuant to 2 Cal. Adm. Code 2003.

PREREQUISITE TERMS, FEES AND EXPENSES:
Applicant is owner of upland.
Filing fee has been received.

A 4

S 4

34
928

CALENDAR ITEM NO. C 0 8 (CONTD)

STATUTORY AND OTHER REFERENCES:

- A. P.R.C.: Div. 6, Parts 1 and 2; Div. 13.
- B. Cal. Adm. Code: Title 2, Div. 3; Title 14, Div. 6.

AB 884: 6/2/83.

OTHER PERTINENT INFORMATION:

1. The applicant proposes to construct a bulkhead from 14 4 x 8 redwood post pilings ringed with tires to protect the levee from boat wash and tidal action, in the Montezuma Slough. Staff believes that bank protection at this location will be of mutual benefit to both the applicant and the public. The bank will have additional protection at no cost to the public.

Staff recommends that processing expense fees be waived due to the minute size of the project and the uncertainty of the State's interest at the project site.

2. The annual rental value of the site is estimated to be \$50.
3. This project is exempt from CEQA because it is a minor alteration to land as defined within the purview of 2 Cal. Adm. Code 2905, Class 4(2).
4. The project is situated on lands identified as possessing environmental values pursuant to P.R.C. 6370.1, and is classified in a use category "B" which authorizes Limited Use. The project as proposed will not have a significant effect upon the environmental values.

APPROVALS OBTAINED:

United States Army Corps of Engineers,
and San Francisco Bay Conservation and
Development Commission.

CALENDAR	35
	929

CALENDAR ITEM NO. C 0 8 (CONTD)

FURTHER APPROVALS REQUIRED:

None.

EXHIBITS:

- A. Land Description.
- A-1. Land Description.
- B. Location Map.

IT IS RECOMMENDED THAT THE COMMISSION:

1. DETERMINE THAT AN ENVIRONMENTAL DOCUMENT HAS NOT BEEN PREPARED FOR THIS ACTIVITY AS SUCH DOCUMENT IS NOT REQUIRED UNDER THE PROVISIONS OF P.R.C. 21084, 14 CAL. ADM. CODE 15100 ET SEQ., AND 2 CAL. ADM. CODE 2905, AND FIND THAT THE PROJECT IS CONSISTENT WITH ITS USE CLASSIFICATION.
2. AUTHORIZE ISSUANCE TO TREE SLOUGH FARMS, INC. OF A 25-YEAR GENERAL PERMIT - PROTECTIVE STRUCTURE USE, FROM JULY 1, 1982; IN CONSIDERATION OF THE PUBLIC BENEFIT, WITH THE STATE RESERVING THE RIGHT AT ANY TIME TO SET A MONETARY RENTAL IF THE COMMISSION FINDS SUCH ACTION TO BE IN THE STATE'S BEST INTEREST; WAIVE PROCESSING COST FOR THE GENERAL PERMIT - PROTECTIVE STRUCTURE USE, FOR A BULKHEAD STRUCTURE FOR LEVEE PROTECTION AND STABILIZATION ON THE LAND DESCRIBED ON EXHIBIT "A" ATTACHED AND BY REFERENCE MADE A PART HEREOF.

Tree Slough Farms

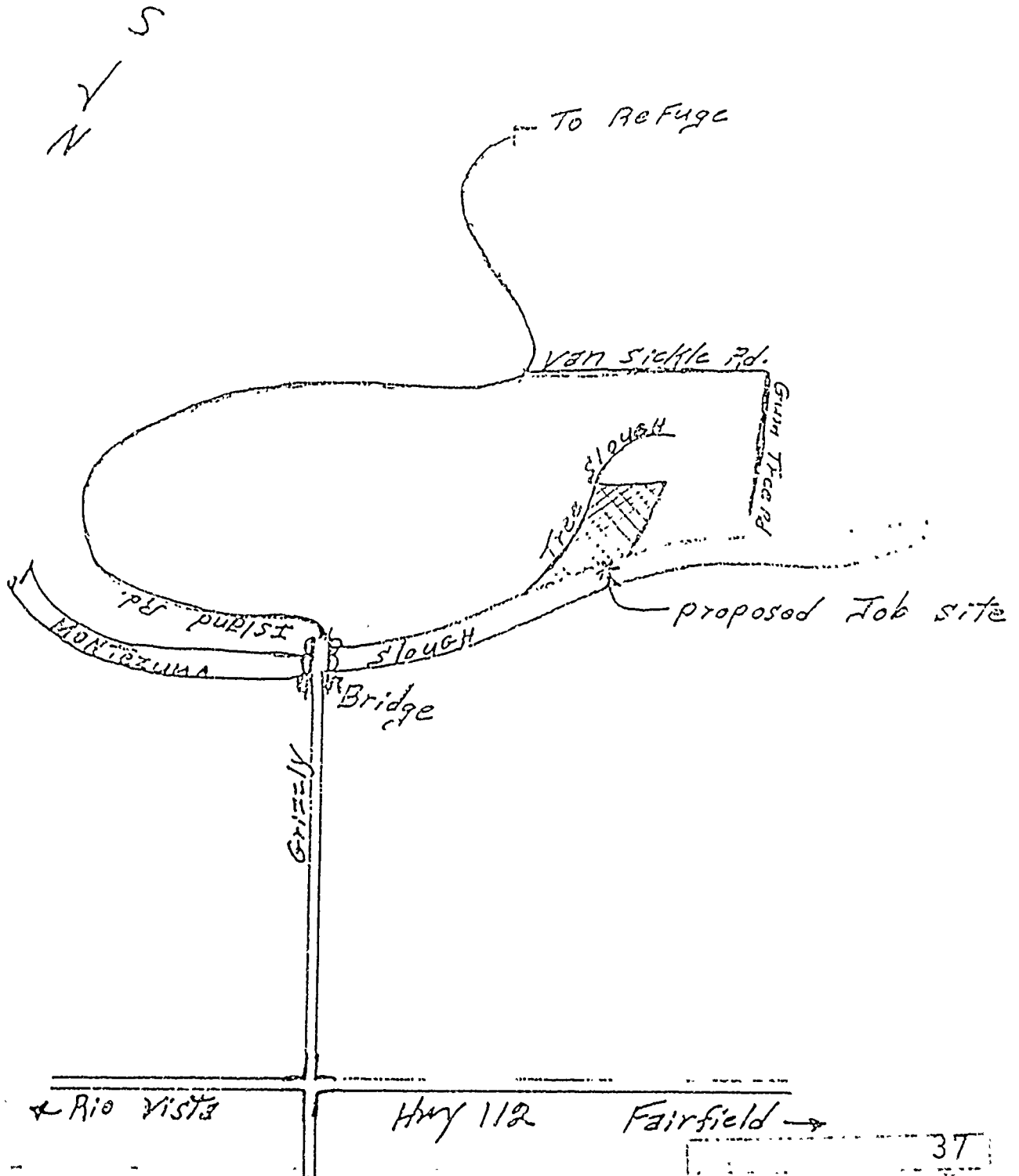

EXHIBIT "A"

LAND DESCRIPTION

37
931

W 23022

TREE Slough Farms

4-20-82

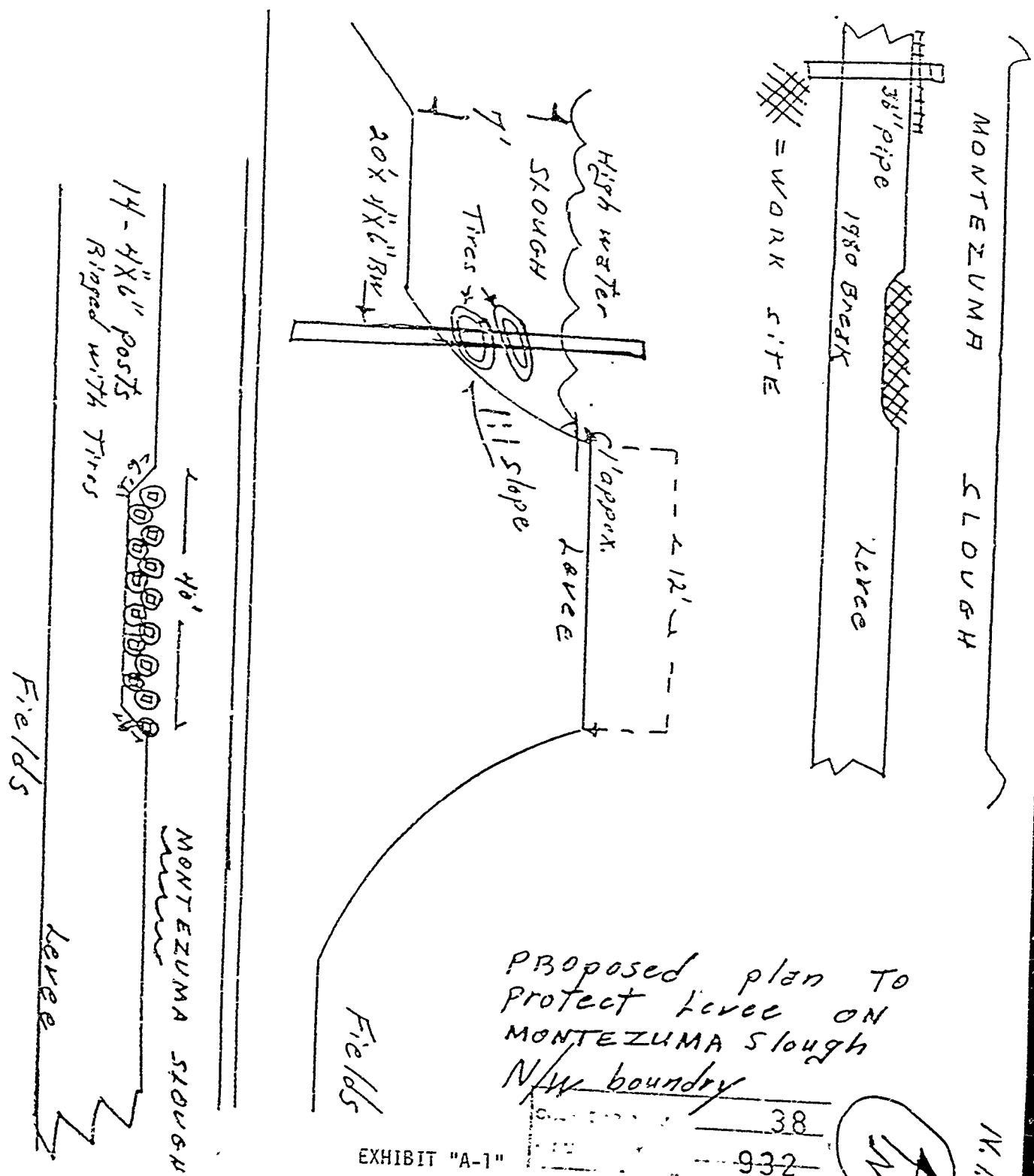

Proposed plan to protect levee on MONTEZUMA Slough N/W boundary

EXHIBIT "A-1"
JOB DESCRIPTION

38
932

W 23022



N. 1. 1. 1.

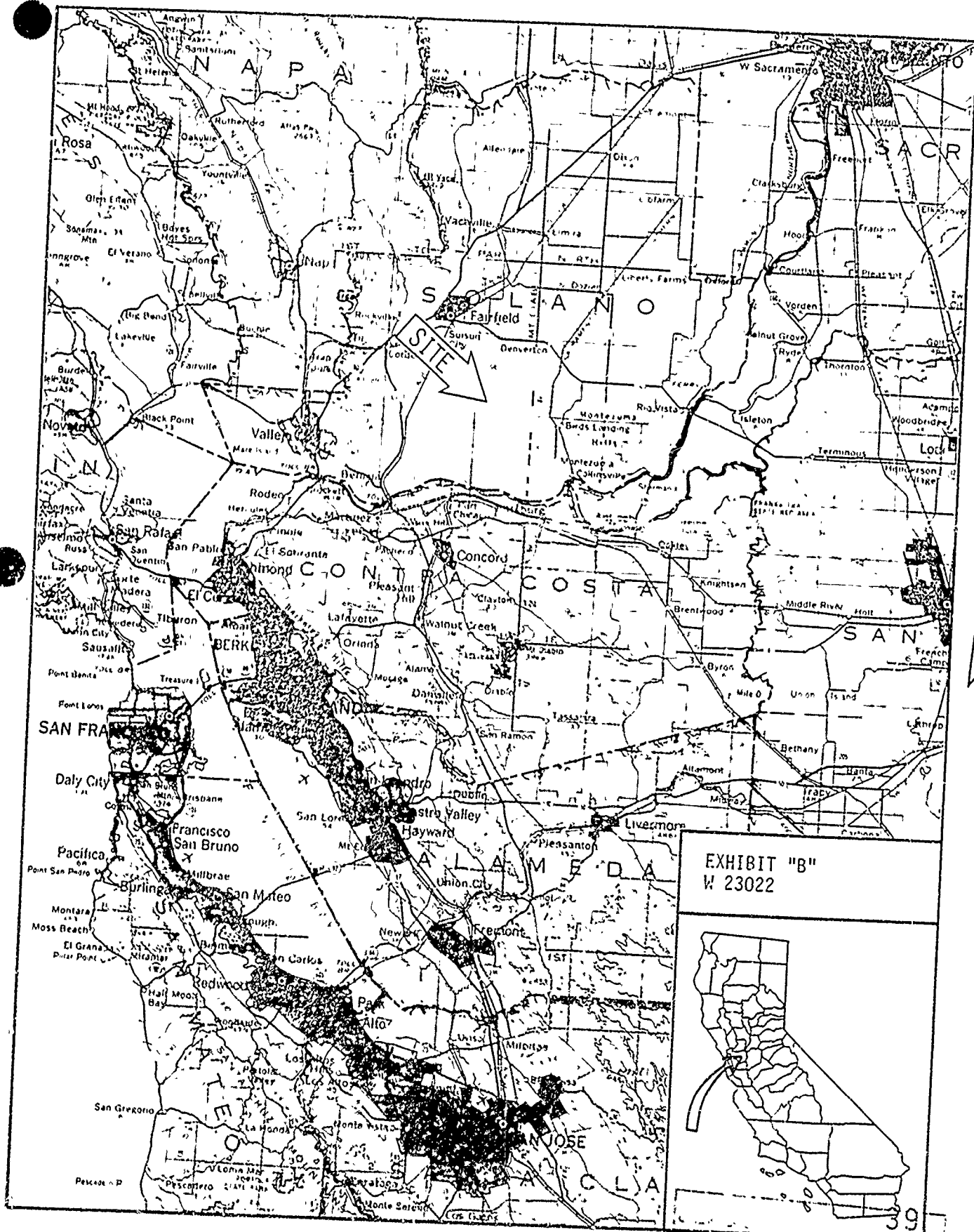

EXHIBIT "B"
W 23022

