

MINUTE ITEM

This Calendar Item No. C13
was approved as Minute Item
No. 13 by the State Lands
Commission by a vote of 3
to 0 at its 1/27/83
meeting.

CALENDAR ITEM

C 13. -4-

1/27/83
W 23113
(PRC 5865)
Omand

GENERAL PERMIT - PROTECTIVE STRUCTURE RECREATIONAL USE

APPLICANT: Richard B. and Karen M. Kelly
7257 Garden Highway
Sacramento, California 95837

AREA, TYPE LAND AND LOCATION:
A .04[±]-acre parcel of tide and submerged
land located in the Sacramento River, Sacramento
County.

LAND USE: Stabilization and bank protection, and
construction and maintenance of a private
boat dock, stairway and walkway.

TERMS OF PROPOSED PERMIT:
Initial period: Ten years from December 1,
1982.

CONSIDERATION: The public use and benefit, with the State
reserving the right at any time to set
a monetary rental if the Commission finds
such action to be in the State's best interest
for the riprap.

Other: The boat dock is rent
free pursuant to Section 6503.5
of the P.R.C.

A 5

-1-

S 3

CALENDAR PAGE	<u>62</u>
MINUTE PAGE	<u>3820</u>

CALENDAR ITEM NO. C 13 (CONT'D)

BASIS FOR CONSIDERATION:

Pursuant to 2 Cal. Adm. Code 2003.

PREREQUISITE TERMS, FEES AND EXPENSES:

Applicant is owner of upland.

Filing fee and processing costs have been received.

STATUTORY AND OTHER REFERENCES:

A. P.R.C.: Div. 6, Parts 1 and 2; Div. 13.

B. Cal. Adm. Code: Title 2, Div. 3; Title 14, Div. 6.

AB 884: 12/7/83.

OTHER PERTINENT INFORMATION

1. The annual rental value of the site is estimated to be \$1,260 per annum.
2. The bank protection and the boat dock are being combined in one permit for the purpose of record keeping and to eliminate the issuance of two separate permits for the same area.
3. Staff feels that bank protection at this point will be of mutual benefit to both the public and the applicant. The bank will have additional protection from high water erosion of material at no expense to the public. The applicant will benefit from protection of the existing homesite.
4. This project is exempt from CEQA because this is new construction of a dock occupying less than 3,000 square feet; and minor alteration to the land for a protective structure; 2 Cal. Adm. Code Section 2905, Class 3 and Class 4.
5. The project is situated on lands identified as possessing significant environmental values pursuant to P.R.C. 6370.1 and is classified in use category "B" which authorizes Limited Use. The project as proposed will not have a significant effect upon the identified environmental values.

CALENDAR ITEM NO. C 13 (CONT'D)

APPROVALS OBTAINED:

U. S. Corps of Engineers.

FURTHER APPROVALS REQUIRED:

State Reclamation Board.

EXHIBITS:

A. Land Description.

B. Location Map.

IT IS RECOMMENDED THAT THE COMMISSION:

1. DETERMINE THAT AN ENVIRONMENTAL DOCUMENT HAS NOT BEEN PREPARED FOR THIS ACTIVITY AS SUCH DOCUMENT IS NOT REQUIRED UNDER THE PROVISIONS OF P.R.C. 21084, 14 CAL. ADM. CODE 15100 ET SEQ., AND 2 CAL. ADM. CODE 2905; AND FIND THAT THE PROJECT IS CONSISTENT WITH ITS USE CLASSIFICATION.
2. AUTHORIZE ISSUANCE TO RICHARD B. AND KAREN M. KELLY OF A TEN-YEAR GENERAL PERMIT - PROTECTIVE STRUCTURE/ RECREATIONAL USE FROM DECEMBER 1, 1982; IN CONSIDERATION OF THE PUBLIC BENEFIT, WITH THE STATE RESERVING THE RIGHT AT ANY TIME TO SET A MONETARY RENTAL IF THE COMMISSION FINDS SUCH ACTION TO BE IN THE STATE'S BEST INTEREST FOR STABILIZATION AND BANK PROTECTION AND PURSUANT TO SECTION 6503.5 OF THE P & C. FOR THE CONSTRUCTION AND MAINTENANCE OF A PRIVATE BOAT DOCK, STAIRWAY AND WALKWAY ON THE LAND DESCRIBED ON EXHIBIT "A" ATTACHED AND BY REFERENCE MADE A PART HEREOF.

NO. 6802A

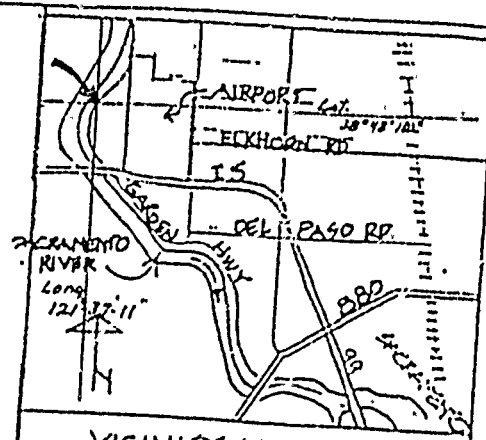
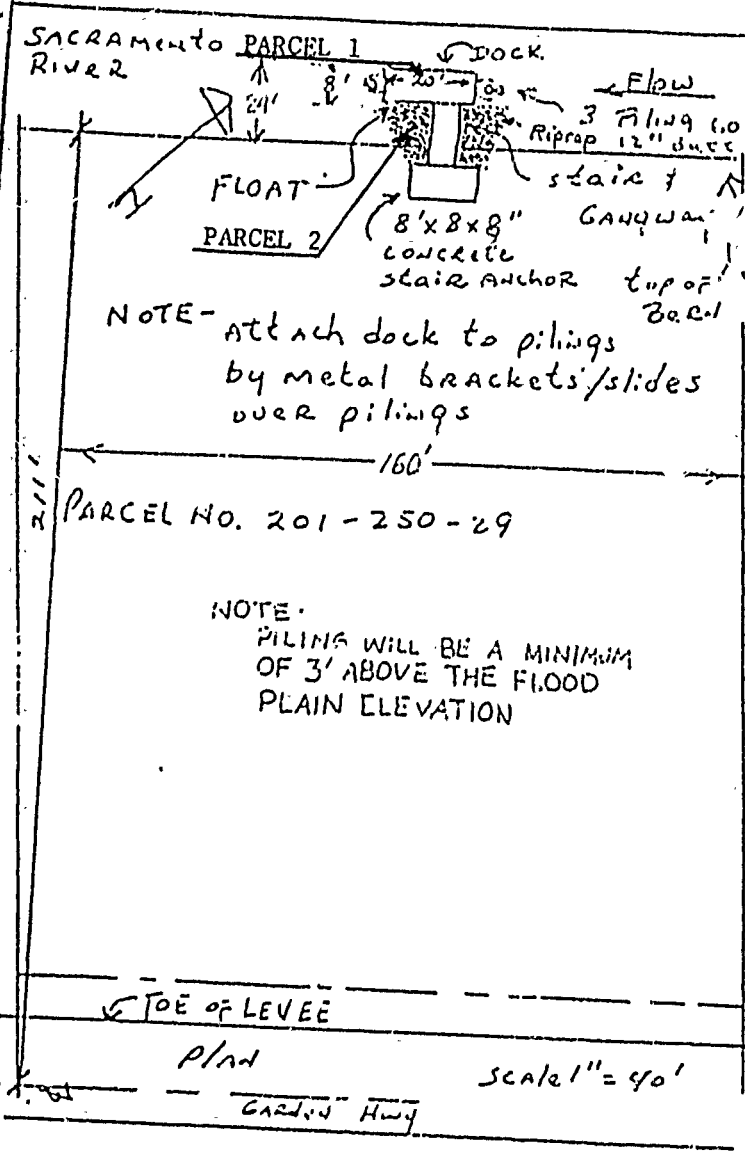

PROPOSED FLOAT

SACRAMENTO RIVER

PARCEL NO. 201-250-29

SACRAMENTO COUNTY

CALIFORNIA

MR. & MRS. Richard Kelly

7257 GARDEN HWY

SACRAMENTO, CAL 95837

SHEET 1 OF 2

11 MAY '82

PRIVATE USE

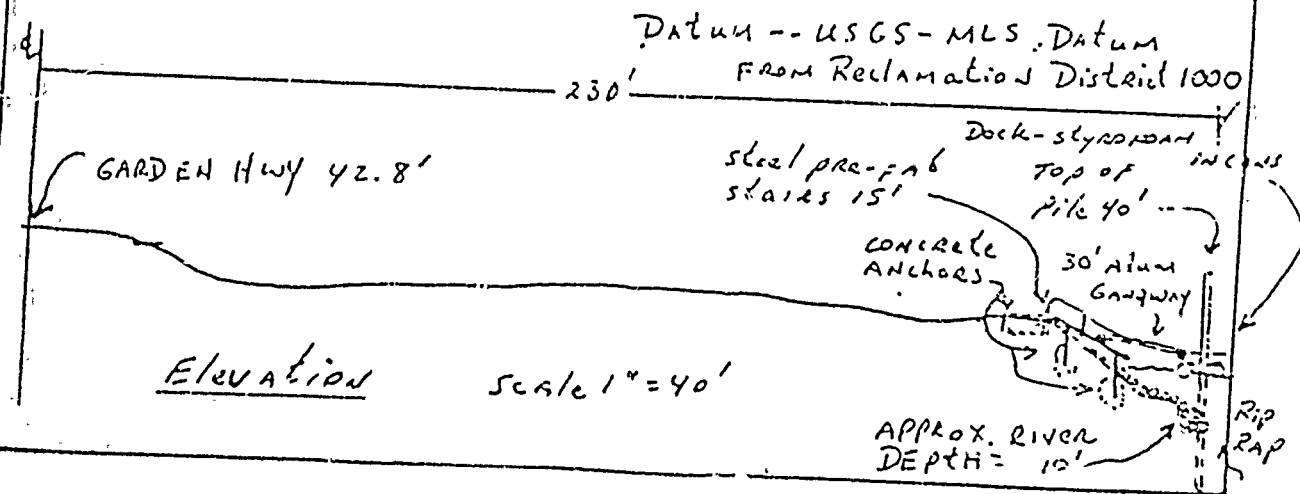

PARCELS 1&2

EXHIBIT "A" LAND DESCRIPTION

W 23113	
CALIF. DISTRICT	65
PARCEL NO.	3823

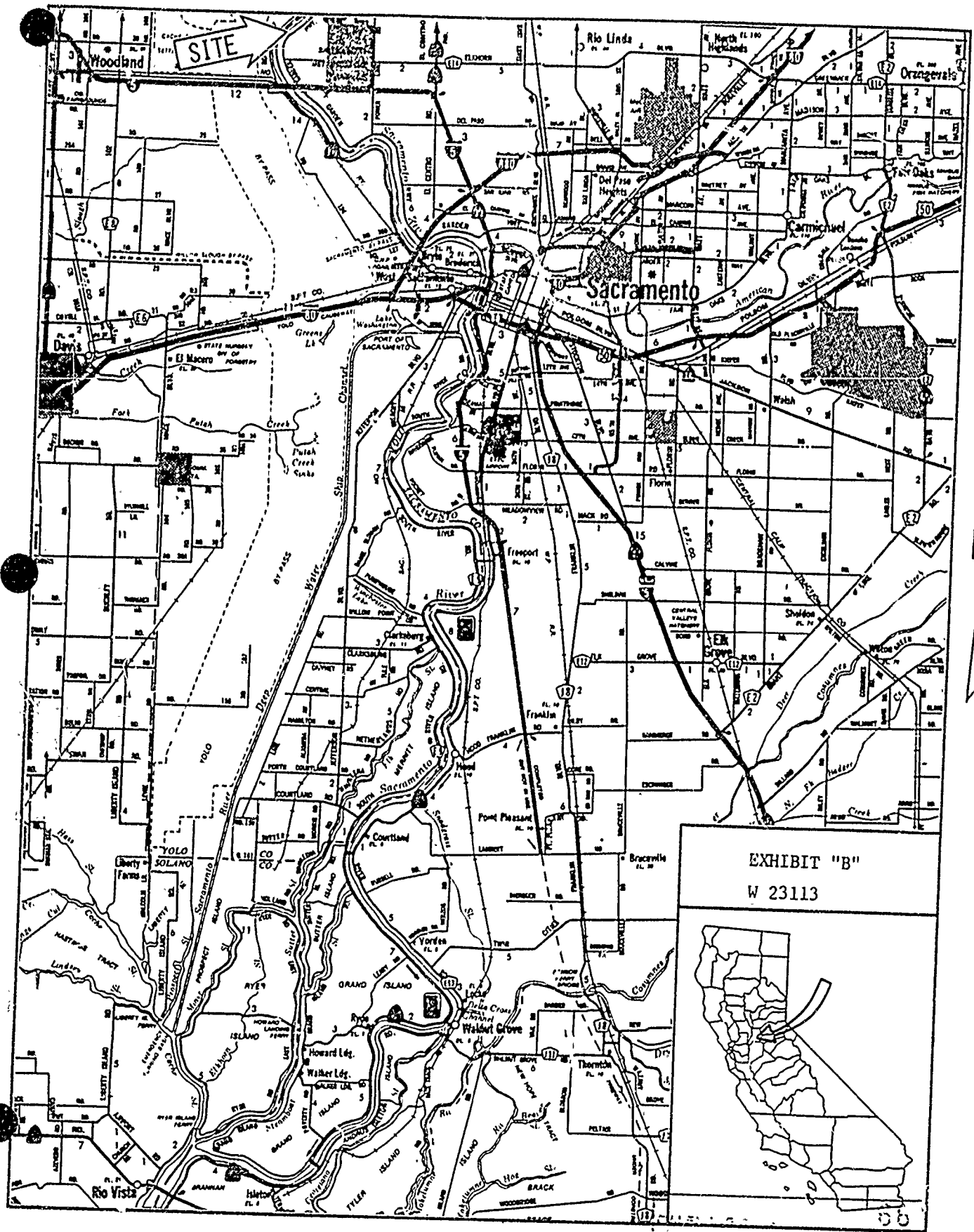

EXHIBIT "B"
W 23113



MINUTE PAGE 3924