

MINUTE ITEM

This Calendar Item No. C9  
was approved as Minute Item  
No. 7 by the State Lands  
Commission by a vote of 3  
to 0 at its 11/29/82  
meeting.

CALENDAR ITEM

C 0 9

11/29/82  
WP 4374  
Reese  
PRC 4374

TERMINATION OF PERMIT NO. 4374.9  
DATED MARCH 9, 1970  
AND APPROVAL OF A  
GENERAL PERMIT - RIGHT-OF-WAY USE

APPLICANT: General Telephone Company of California  
P. O. Box 176  
Courtland, California 95615

AREA, TYPE LAND AND LOCATION:  
A 0.106-acre parcel of tide and submerged  
land in the North Fork of the Mokelumne  
River, Sacramento and San Joaquin Counties.

LAND USE: Telephone communication facilities.

TERMS OF ORIGINAL PERMIT:  
Initial period: Continuous Use plus one  
year from November 1,  
1969.

CONSIDERATION: Exempt by law, Section 7901, Public Utilities  
Code.

TERMS OF PROPOSED PERMIT:  
Initial Period: Continuous Use plus one  
year from November 1,  
1982.

A 7  
S 13

-1-

CALENDAR PAGE	<u>44</u>
MINUTE PAGE	<u>303</u>

CONSIDERATION: Exempt by law, Section 7901, Public Utilities Code.

PREREQUISITE TERMS, FEES AND EXPENSES:  
Lessee is permittee of upland.

Filing fee and processing costs have been received.

STATUTORY AND OTHER REFERENCES:

- A. P.R.C.: Div. 6, Parts 1 and 2; Div. 13.
- B. Cal. Adm. Code: Title 2, Div. 3; Title 14, Div. 6.
- C. Section 7901, Public Utilities Code.

AB 884: 1/1/83.

OTHER PERTINENT INFORMATION:

1. Lessee's current permit covers a single submarine cable in the North Fork of the Mokelumne River. Lessee has proposed to install an additional submarine cable immediately downstream at the request of the Pacific Telephone Company which will perform as an intercompany carrier trunk cable to Thornton, California. Staff and the lessee have agreed to terminate the existing permit and issue a General Permit - Right-of-Way Use covering the proposed crossing and the existing crossing.
2. The annual rental value of the site is estimated to be \$100.
3. This project is exempt from CEQA because it entails placement of new equipment and a minor alteration.

Authority: 14 Cal. Adm. Code, Div. 6, Sections 15103 and 15104.

CALENDAR ITEM NO. 009 (CONTD)

4. The project is situated on lands identified as possessing significant environmental values pursuant to P.R.C. 6370.1 and is classified in a use category "B" which authorizes Limited Use. The project as proposed will not have a significant effect upon the identified environmental values.

APPROVALS OBTAINED:

None.

FURTHER APPROVALS REQUIRED:

The United States Army Corps of Engineers and the Reclamation Board.

EXHIBITS:

- A. Land Description.
- B. Location Map.

IT IS RECOMMENDED THAT THE COMMISSION:

1. DETERMINE THAT AN ENVIRONMENTAL DOCUMENT HAS NOT BEEN PREPARED FOR THIS ACTIVITY AS SUCH DOCUMENT IS NOT REQUIRED UNDER THE PROVISIONS OF P.R.C. 21084, 14 CAL. ADM. CODE 15100 ET SEQ., AND 2 CAL. ADM. CODE 2905; AND FIND THAT THE PROJECT IS CONSISTENT WITH ITS USE CLASSIFICATION.
2. AUTHORIZE TERMINATION OF PERMIT NO. PRC 4374.9 DATED MARCH 9, 1970, EFFECTIVE OCTOBER 31, 1982, AND ISSUANCE TO GENERAL TELEPHONE COMPANY OF CALIFORNIA OF A CONTINUOUS USE PLUS ONE-YEAR GENERAL PERMIT - RIGHT-OF-WAY USE FROM NOVEMBER 1, 1982; CONSIDERATION: EXEMPT BY LAW, SECTION 7901, PUBLIC UTILITIES CODE, FOR TELEPHONE COMMUNICATION FACILITIES ON THE LAND DESCRIBED ON EXHIBIT "A" ATTACHED AND BY REFERENCE MADE A PART HEREOF.

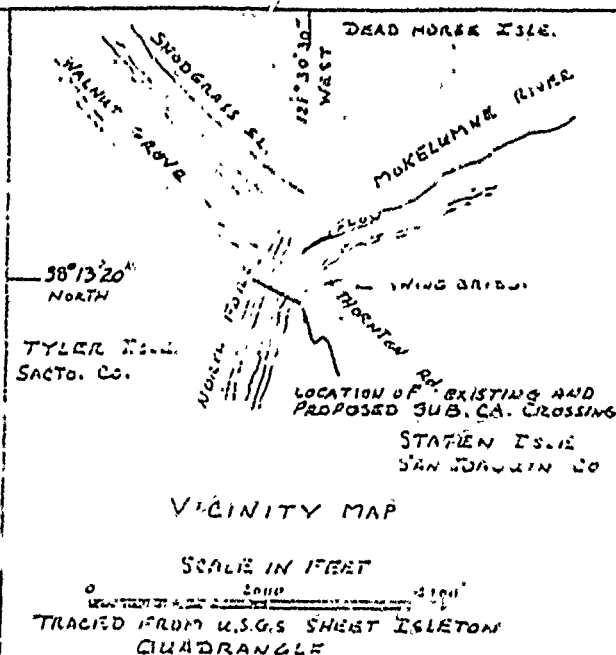
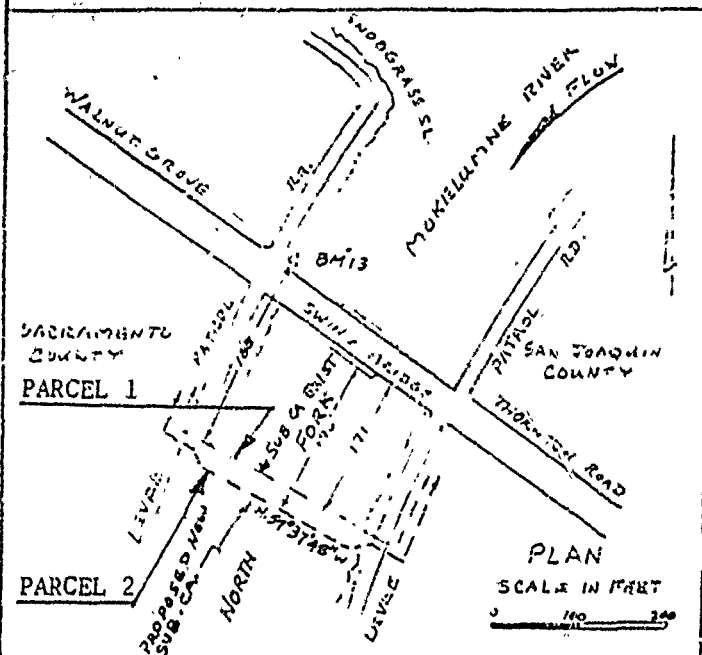

DATE OF SOUNDINGS SEPT. 16, 1981 10:10 AM PST  
DATE OF SURVEY SEPT. 14, 1981  
SURVEYOR ROY H. CARTER L.S. 3427

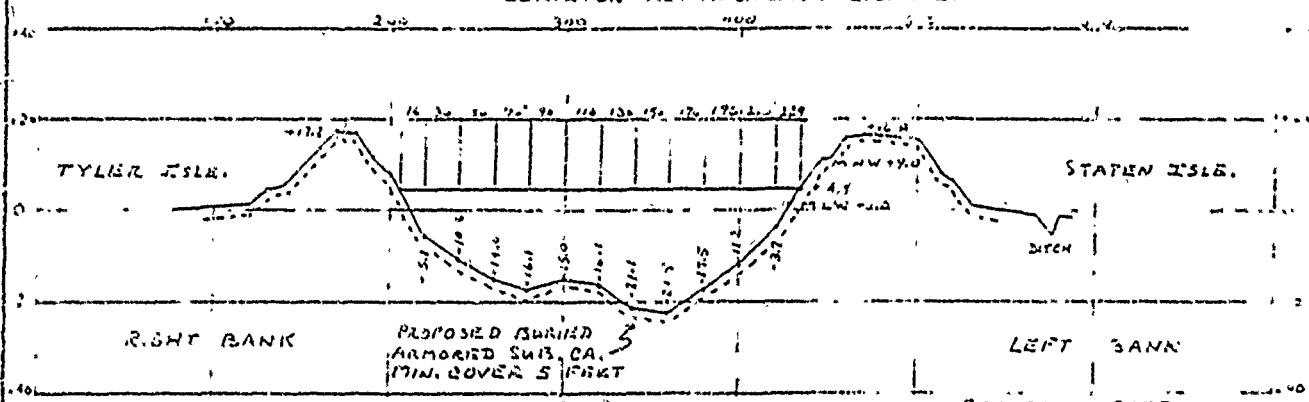

PROPOSED ARMORED SUBMARINE CABLE ACROSS THE SOUTH FORK OF THE MOKELUMNE RIVER, 146 FEET DOWNSTREAM FROM THE WALNUT GROVE-THORNTON BRIDGE IN SEC. 2, T. 4 N. R. 4 E. M. 13 S. SACTO. CO. NEW CABLE TO BE PLACED 25' DOWNSTREAM FROM AN EXIST. CABLE PLACED ON U.O.C. PERMIT #4529 DATED 10-25-81.  
SOUNDING ELEVATIONS ARE IN FEET AND REFER TO U.S. DATUM + 3.0 BELOW SEA LEVEL DATUM 1929.  
APPLICATION BY GENERAL TELEPHONE CO., P.O. BOX 176, COURTLAND, CA. 95615 DATED

WATER LEVEL DATA  
+10.0 - FLOOD PLANE  
+ 9.0 - M.H.W.  
+ 4.9 - SEPT 16, 1981  
+ 1.0 - M.L.W.

<b>GTB</b>		
<b>GENERAL TELEPHONE OF CALIFORNIA</b>		
LOCATION	N. FORK MOKELUMNE RIV. AT BRIDGE	
EXCHANGE	518	C.O. WALNUT GROVE
ISSUE DATE	APPROVALS	
4-12-82	WRP	
DWG SIZE	AREA GENERAL MANAGER	
A		
DWG NO.	RELATED DWGS.	WORK ORDER
EXHIBIT "A"	EXHIBIT "B"	575 613 292

PARCELS 1 AND 2

EXHIBIT "A"  
LAND DESCRIPTION

FORM 609540  
CALENDAR PAGE 47 WP 4374  
MINUTE PAGE 3037

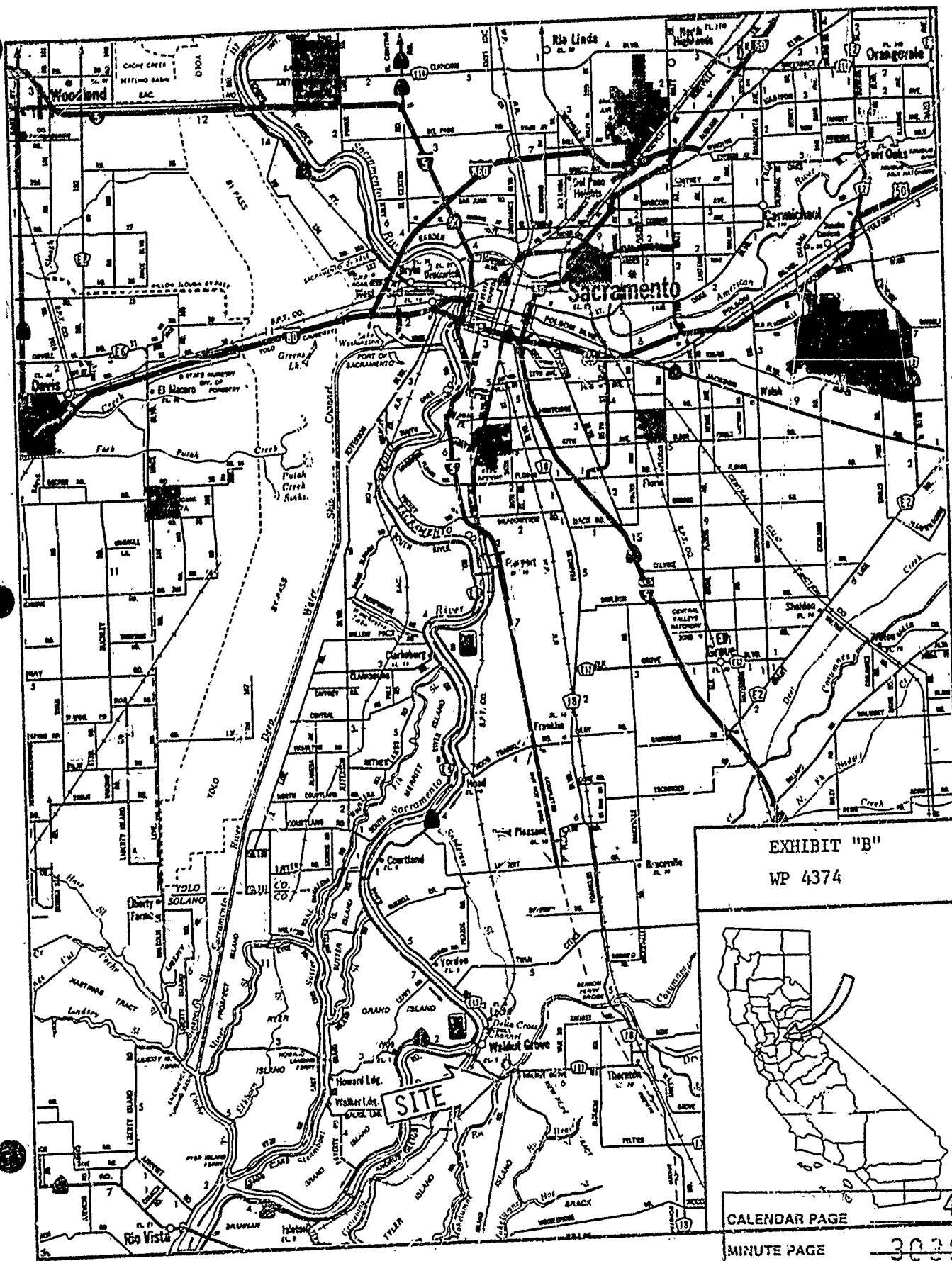

EXHIBIT "B"  
 WP 4374



CALENDAR PAGE 48  
 MINUTE PAGE 3029