

MINUTE ITEM:

This Calendar Item No. 29
was approved as Minute Item
No. 28 by the State Lands
Commission by a vote of 3
to 0 at its 10/28/82
meeting.

CALENDAR ITEM

28

10/28/82
Small
Gonzalez
W 23128

AUTHORIZATION TO INCLUDE
MINERAL ESTATE IN SALE OF PROPRIETARY LANDS

BACKGROUND:

The Department of General Services, Division of Real Estate Services, is planning on holding a competitive bid sale of the Farmers Fair of Riverside County, in the City of Hemet. Proceeds of the sale will be used to acquire new fairground facilities. The Department believes that if the mineral estate is included in the sale, the property is more likely to sell.

The Commission has jurisdiction regarding minerals reserved to the State, and under P.R.C. Section 6404 can authorize another State agency, which sells State proprietary lands, to include the mineral rights in the sale.

The Farmers Fair of Riverside County Fairgrounds is located within the city limits of Hemet, and is surrounded by residential areas. The property to be sold is composed of three parcels totaling 30 acres, more or less.

A 73

S 37

CALENDAR PAGE	146
MINUTE PAGE	26.3

Staff has reviewed the mineral potential in the area and does not believe commercially valuable deposits of minerals are likely to exist beneath the parcels to be sold.

AB 884: N/A.

EXHIBITS: A. Vicinity Map.
B. Neighborhood Map.
C. Detailed Map.

IT IS RECOMMENDED THAT THE COMMISSION:

1. AUTHORIZE THE DEPARTMENT OF GENERAL SERVICES TO INCLUDE THE MINERAL ESTATE IN THE BID OFFERING FOR THE SALE OF THE FARMERS FAIR OF RIVERSIDE COUNTY, 46TH DISTRICT AGRICULTURAL ASSOCIATION, RIVERSIDE COUNTY, CITY OF HEMET.

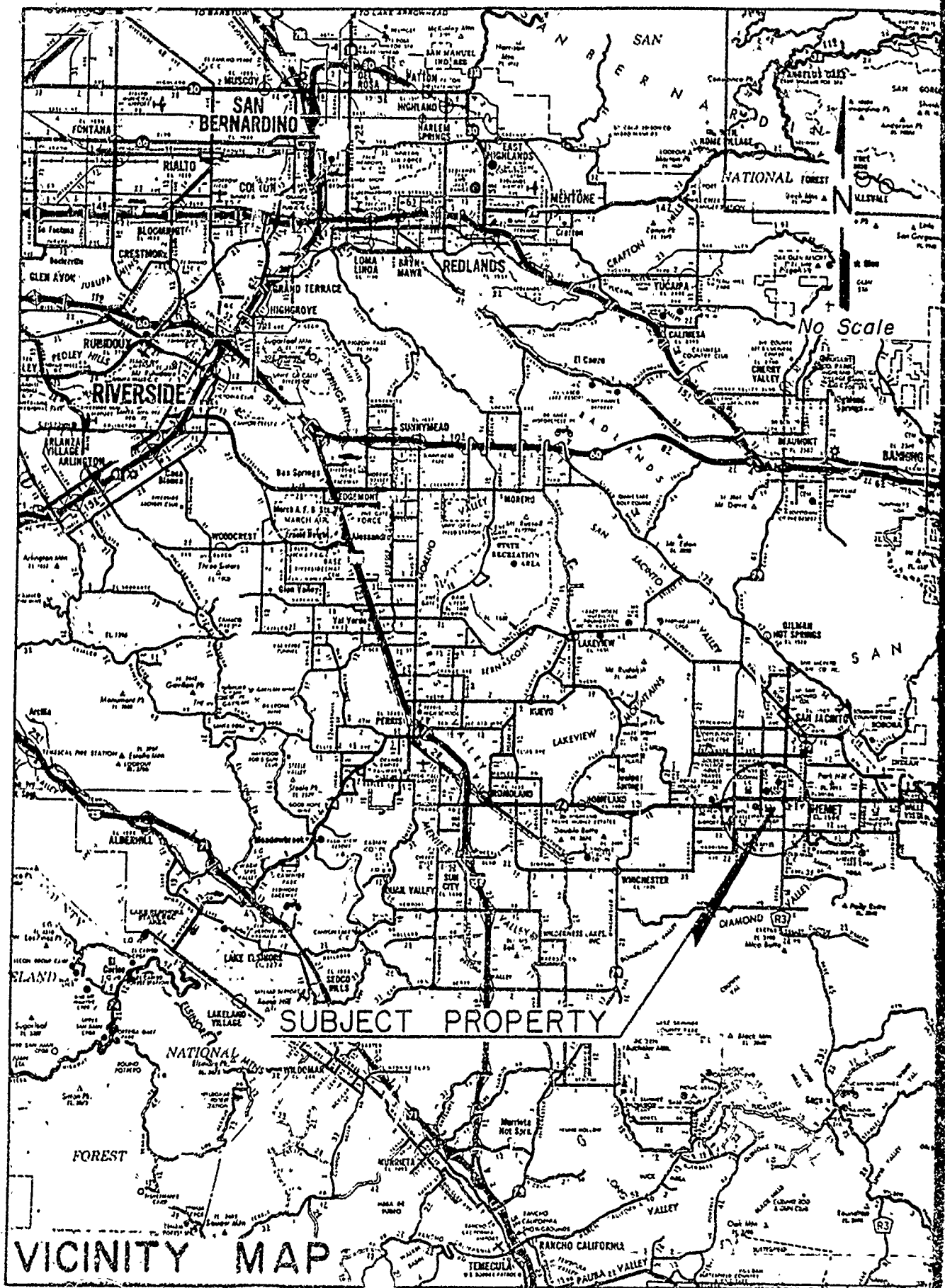

VICINITY MAP

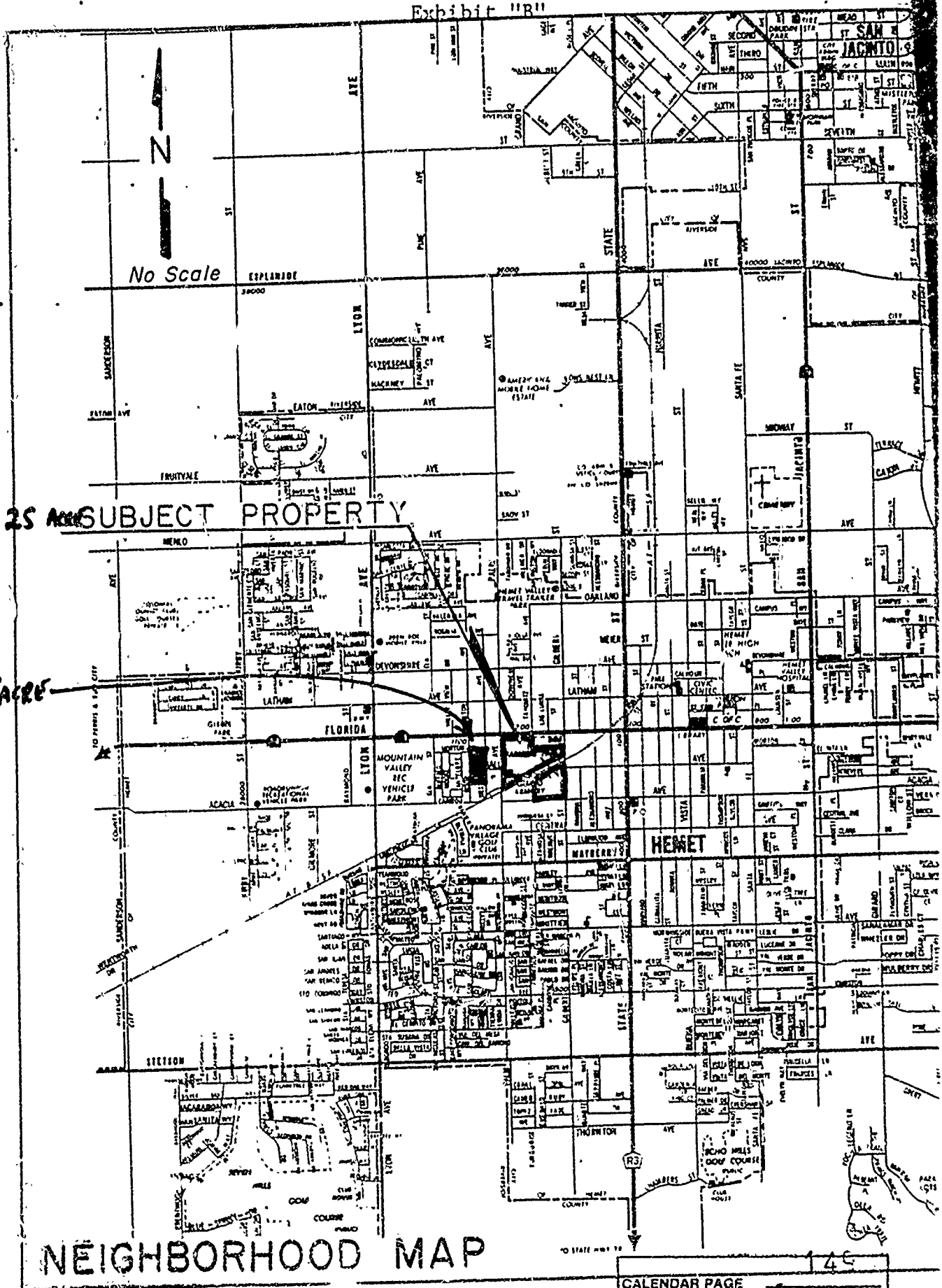

No Scale

25 AC SUBJECT PROPERTY

SACRE

NEIGHBORHOOD MAP

CALENDAR PAGE	46
MINUTE PAGE	2637

Exhibit "C"

PALM AVENUE

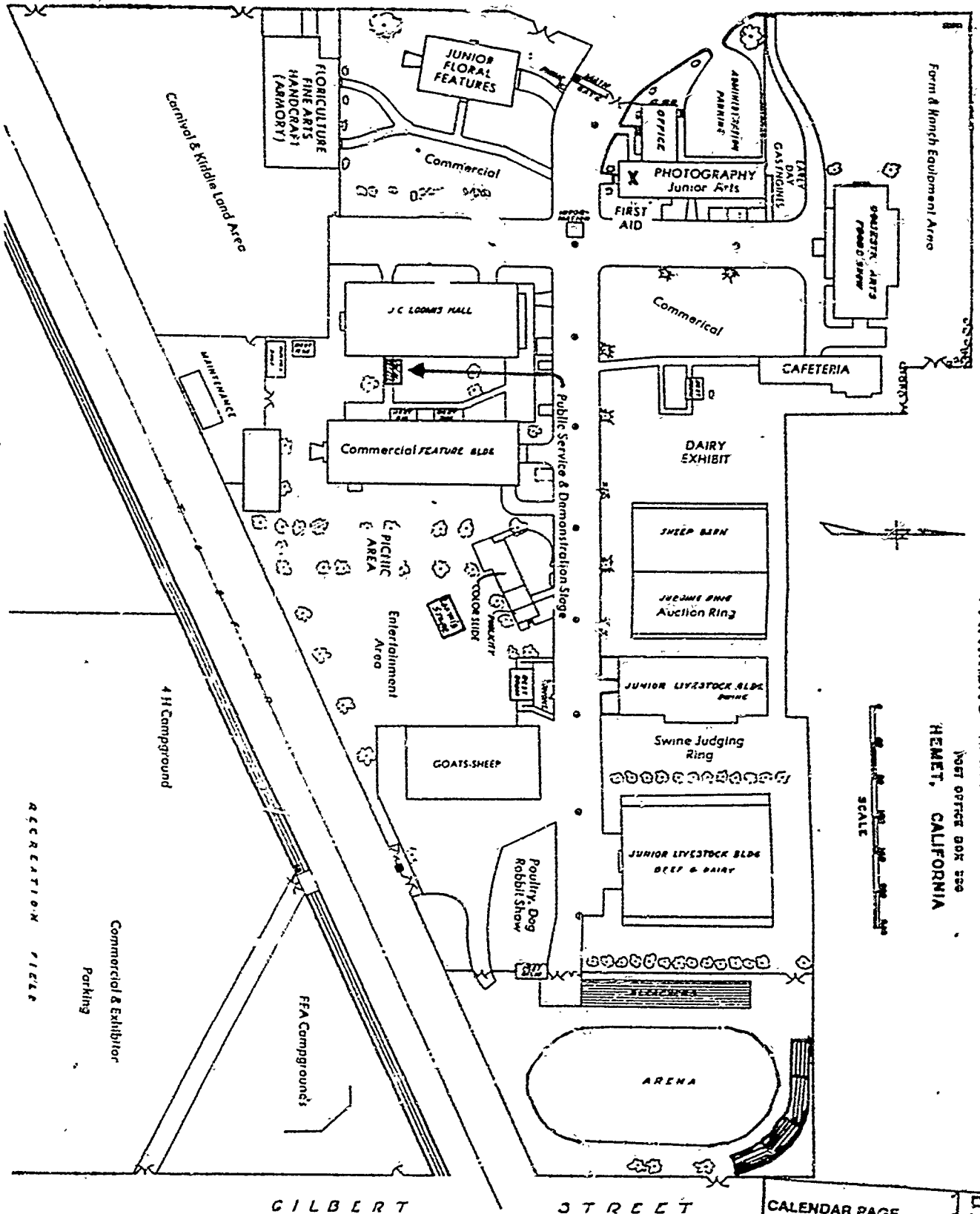

FARMERS FAIR OF RIVERSIDE COUNTY

POST OFFICE BOX 230
HEMET, CALIFORNIA



CALENDAR PAGE 150
 MINUTE PAGE 2552