

MINUTE ITEM

This Calendar Item No. C19
is approved as Minute Item
No. 19 by the State Lands
Commission by a vote of 3
to 2 at its 10/28/82
meeting.

CALENDAR ITEM

C 1 9

10/28/82
W 23052
Graber
PRC 6342

DREDGING PERMIT

APPLICANT: US Air Force Headquarters
Space Division
AD/DE, P.O. Box 92960
Worldway Postal Center
Los Angeles, California 90009

AREA, TYPE LAND AND LOCATION:
Ungranted sovereign lands at the Point
Arguello Coast Guard Station, six miles
south of Vandenberg Air Force Base, Santa
Barbara County.

LAND USE: Dredge 55,000 cubic yards of sediment at
the old boat house site for construction
of a facility to be used for landing barges
carrying space shuttle craft engines.

Spoils to be deposited at an E.P.A. authorized
disposal site located 12 miles southwest
of the construction site (34° 30' 40" N,
120° 51' 24" W) in the Pacific Ocean beyond
the three mile limit. No royalty will be
charged for spoils disposed of at sea or
placed on public property. A royalty of
\$0.25 per cubic yard of dredged material
will be charged for spoils deposited on
private property or sold.

PREREQUISITE TERMS, FEES AND EXPENSES:
Filing, extractive development and dredging
fees have been received.

A 35

S 17

CALENDAR PAGE	<u>91</u>
MINUTE PAGE	<u>2822</u>

CALENDAR ITEM NO C 19 (CONTD)

STATUTORY AND OTHER REFERENCES:

A. P.R.C.: Div. 6, Parts 1 and 2, Div. 13,
Div. 20.

B. Cal. Adm. Code: Title 2, Div. 3, Title 14.

AB 884: 8/27/83.

OTHER PERTINENT INFORMATION:

1. Determine that an Initial Study/Negative Declaration was prepared for the project by the State Lands Commission dated September 24, 1982.
2. All necessary application requirements have been fulfilled.
3. This project is situated on State lands identified as possessing significant environmental values pursuant to P.R.C. 6370.1, and is classified in use category Class B, Limited Use.
4. Royalty for material disposed of at sea will be waived in consideration of the public benefit of the US Air Force project.

EXHIBITS:

- A. Land Description Map.
- B. Site Map.
- C. Negative Declaration/Initial Study.

IT IS RECOMMENDED THAT THE COMMISSION:

1. CERTIFY THAT A NEGATIVE DECLARATION (ND 318) HAS BEEN PREPARED FOR THE PROJECT BY THE STATE LANDS COMMISSION AND THAT THE DOCUMENT WAS CIRCULATED AND REVIEWED THROUGH THE STATE CLEARINGHOUSE AND PERTINENT AGENCIES PRIOR TO THE APPROVAL OF THE PROJECT.
2. DETERMINE THAT THE PROJECT WILL NOT HAVE A SIGNIFICANT EFFECT ON THE ENVIRONMENT.
3. FIND THAT GRANTING OF THE PERMIT WILL HAVE NO SIGNIFICANT EFFECT UPON ENVIRONMENTAL CHARACTERISTICS IDENTIFIED PURSUANT TO SECTION 6370.1 OF THE P.R.C.
4. AUTHORIZE THE STAFF OF THE STATE LANDS COMMISSION TO ISSUE TO THE US AIR FORCE HEADQUARTERS, SPACE DIVISION,

CALENDAR PAGE	32
MINUTE PAGE	2623

CALENDAR ITEM No. 19 (CONT'D)

THE DREDGING PERMIT ON FILE IN THE OFFICES OF THE COMMISSION, SAID PERMIT SHALL BE ISSUED IN CONSIDERATION OF THE PUBLIC BENEFIT WITH NO ROYALTY CHARGED FOR SOILS PLACED ON AN E.P.A. AUTHORIZED DISPOSAL SITE LOCATED 12 MILES SOUTHWEST OF THE CONSTRUCTION SITE; SAID PERMIT SHALL BE FOR A PERIOD OF ONE YEAR BEGINNING NOVEMBER 1, 1982 AND SHALL ALLOW THE DREDGING OF A MAXIMUM OF 55,000 CUBIC YARDS OF MATERIALS OTHER THAN OIL, GAS AND GEOTHERMAL FROM AN AREA OF SOVEREIGN LANDS IN THE POINT ARGUELLO COAST GUARD STATION HARBOR SOUTH OF VANDENBERG AIR FORCE BASE, SANTA BARBARA COUNTY, CALIFORNIA. SAID AREA IS SHOWN IN EXHIBITS "A" AND "B" ATTACHED HERETO AND BY THIS REFERENCE EXPRESSLY MADE A PART HEREOF. THE MATERIAL DREDGED SHALL BE DEPOSITED IN A DISPOSAL SITE APPROVED BY THE E.P.A. AND ALL OTHER APPLICABLE REGULATORY AGENCIES; THE COMPLETE PERMITS ARE CONTAINED IN FILE W 23052 LOCATED IN THE COMMISSION OFFICES.

CALENDAR PAGE	93
MINUTE PAGE	2824

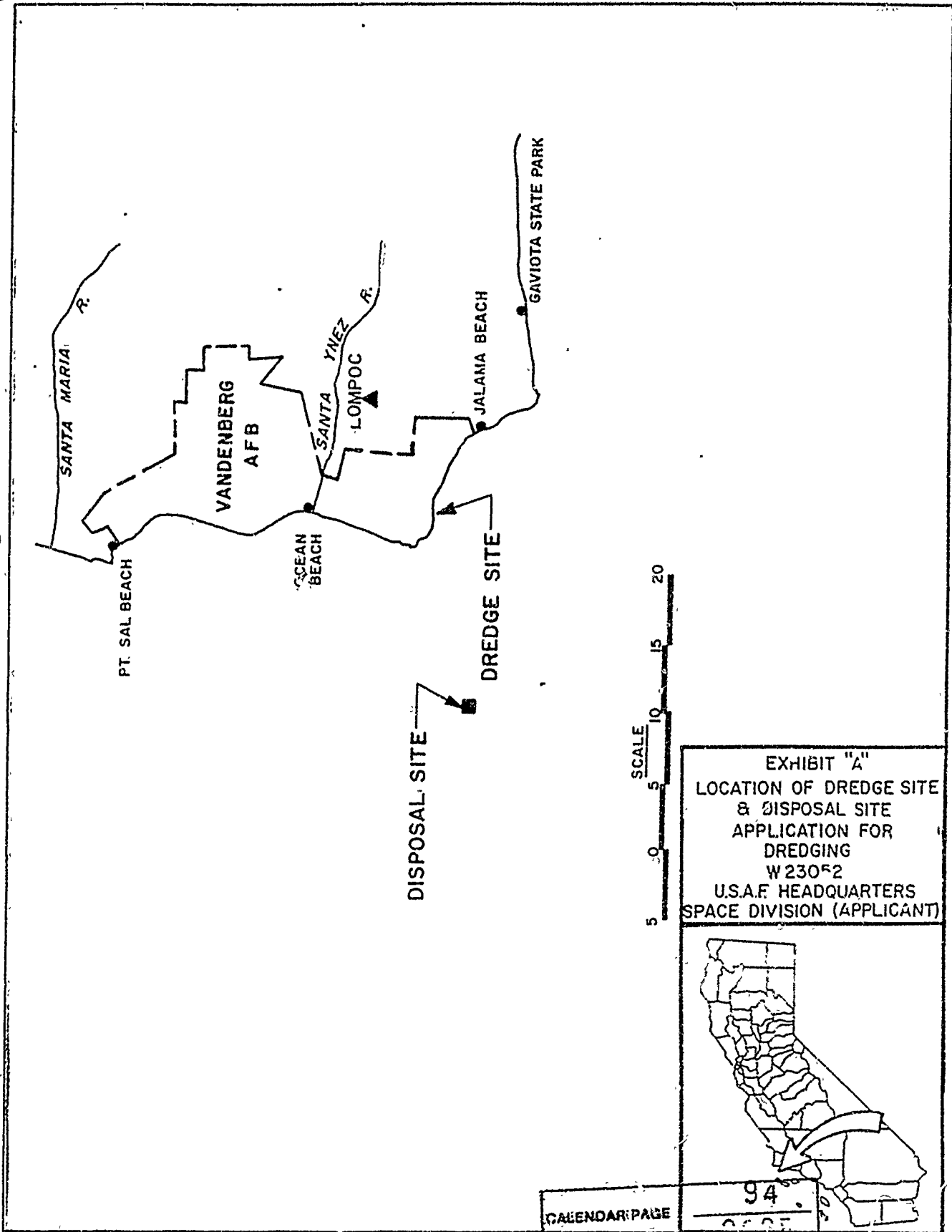

EXHIBIT "A"
LOCATION OF DREDGE SITE
& DISPOSAL SITE
APPLICATION FOR
DREDGING
W 23052
U.S.A.F. HEADQUARTERS
SPACE DIVISION (APPLICANT)

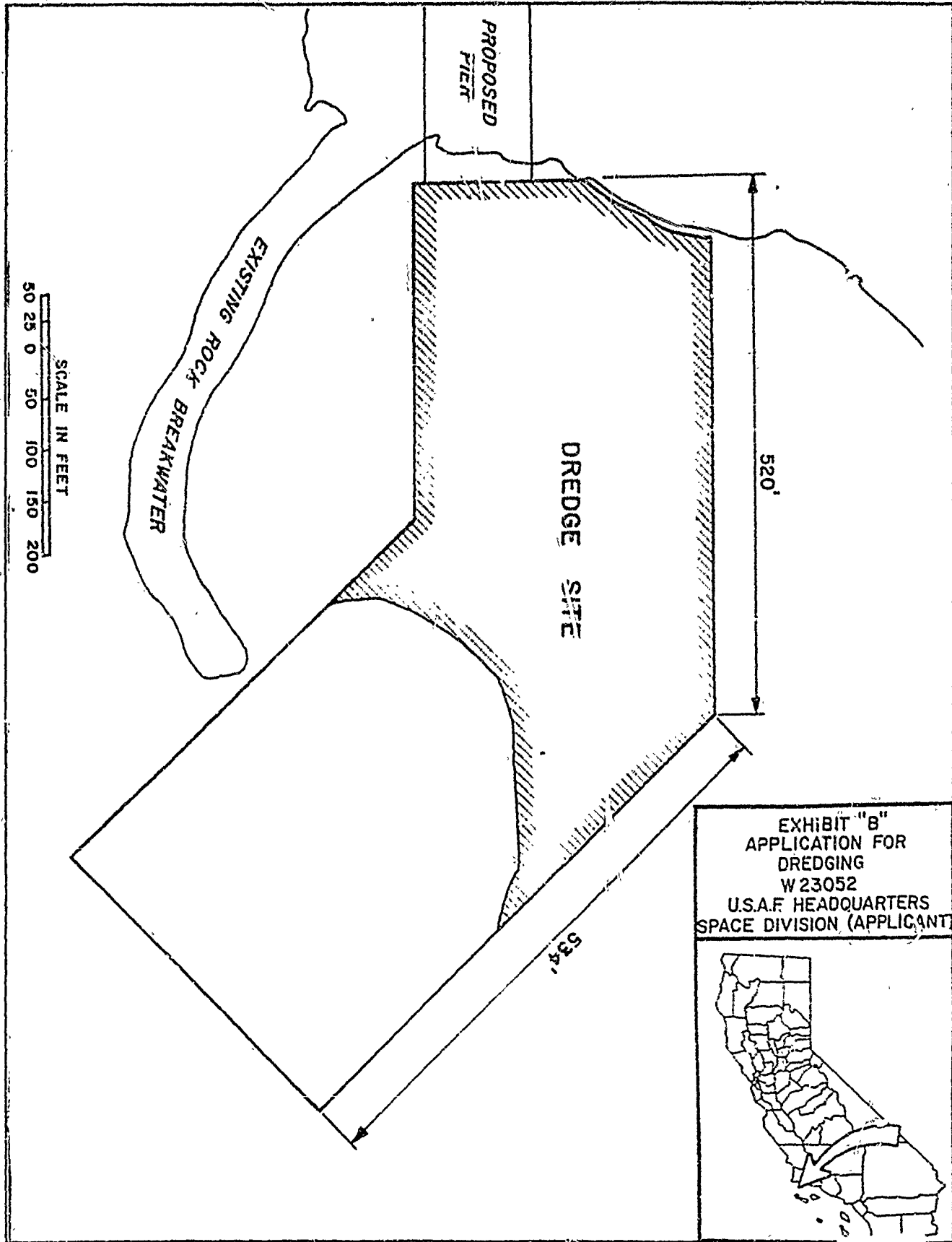

EXHIBIT "B"
 APPLICATION FOR
 DREDGING
 W23052
 U.S.A.F. HEADQUARTERS
 SPACE DIVISION (APPLICANT)



CALENDAR PAGE _____
 MINUTE PAGE 2026



STATE LANDS COMMISSION

EXECUTIVE OFFICE
1807 - 13th Street
Sacramento, California 95814PROPOSED NEGATIVE DECLARATION

EIR ND 318

File Ref.: W 23052

SCH#: 82092804

Project Title: Pier Construction-Vandenberg AFB.

Project Location: Santa Maria Basin, Pacific Ocean, at Point Arguello Coast Guard
Rescue Station, near Lompoc, Santa Barbara County.Project Description: Dredging and pier construction for landing of external tanks for
the space shuttle.

This NEGATIVE DECLARATION is prepared pursuant to the requirements of the California Environmental Quality Act (Section 1000 et seq. of the Public Resources Code), the State CEQA Guidelines (Section 15000 et seq., Title 14, of the California Administrative Code), and the State Lands Commission regulations (Section 2901 et seq., Title 2, of the California Administrative Code).

Based upon the attached Initial Study, it has been found that:

- the project will not have a significant effect on the environment.
- the attached mitigation measures will avoid potentially significant effects.

Contact Person: Ted T. Fukushima
1807-13th Street
Sacramento, CA 95814
Tel.: (916)322-7813

CALENDAR PAGE	56
MINUTE PAGE	2627

MITIGATION MEASURES

- a. Keep human interference with the natural environment to a minimum by declaring intertidal areas away from the construction sites "off-limits" to construction workers.
- b. Reseeding of abalone in the area to be affected by blasting and dredging. The California Department of Fish and Game and U.S. Fish and Wildlife Service are concerned about the diminishing population of abalone along the Pacific Coast, and the destruction of approximately 50 to 100 individuals would be regarded as an adverse impact.

Abalone reseeding is part of the abalone management plan of the California Department of Fish and Game.
- c. Avoid blasting when birds or marine mammals are within the blast area.
- d. Use slow-burning explosives for blasting. Research has indicated that the use of slow-burning explosives (such as Nitranon) results in far less damage to fish because of the slow generation of the pressure wave accompanying the explosion.
- e. Prepare to fuel spill contingency plan in case of accident.
- f. Have a biologist at the site to inspect construct activities to ensure that a minimum amount of physical impacts occur.
- g. The applicant will construct three rock structures 40' x 25' x 3' high, spaced 15 feet apart within the area between the existing breakwater and the southern edge of the dredge site. The Department of Fish and Game will approve the actual site before any material is placed. Rock for the proposed structures will be at least 2.5' in diameter.

ENVIRONMENTAL IMPACT ASSESSMENT FORM - Part I
(To be completed by applicant)
FORM 69.3 (7/82)

A. GENERAL INFORMATION

1. Name, address, and telephone number:

a. Applicant:

b. Contact person if other than applicant

U.S. Air Force/L.A. Air Force Station

P.O. Box 92960, Worldway Postal Center

Los Angeles, CA 90009

()

()

2. a. Project location: Vandenberg AFB, Santa Barbara County

b. Assessor's parcel number: N/A

3. Existing zone of project site: Military

4. Existing land use of project site: Air Force Base/Coast Guard Station

5. Proposed use of site: Pier area for landing of external tanks for space shuttle.

6. Other permits required: U.S. Army Corps of Engineers

B. PROJECT DESCRIPTION

1. Non-building construction projects: Describe fully, the proposed activity, its purpose and intended use. (Attach plans or other drawings as necessary)

2. For building construction projects, complete attachment "A".

C. ENVIRONMENTAL SETTING

1. Describe the project site as it exists before the project, including information on topography, soil stability, plants and animals, and any cultural, historical, or scenic aspects. Describe any existing structures on the site, and the use of the structures.
2. Describe the surrounding properties, including information on plants and animals and any cultural, historical, or scenic aspects. Indicate the type of land use (residential, commercial, etc.), intensity of land use (one-family, apartment houses, shops, department stores, etc.), and scale of development (height, frontage, set-back, rear yard, etc.).

D. ENVIRONMENTAL IMPACT ASSESSMENT

Answer the following questions by placing a check in the appropriate box. Discuss all items checked "yes" or "maybe". (Attach additional sheets as necessary)

Will the project involve:	Yes	Maybe	No
1. a change in existing features of any bays, tidelands, beaches, lakes or... hills, or substantial alteration of ground contours?	<input checked="" type="checkbox"/>	<input type="checkbox"/>	<input type="checkbox"/>
2. a change in scenic views or vistas from existing residential areas or... public lands or roads?	<input type="checkbox"/>	<input type="checkbox"/>	<input checked="" type="checkbox"/>
3. a change in pattern, scale, or character of the general area of project?...	<input checked="" type="checkbox"/>	<input type="checkbox"/>	<input type="checkbox"/>
4. significant effect on plant or animal life?.....	<input checked="" type="checkbox"/>	<input type="checkbox"/>	<input type="checkbox"/>
5. significant amounts of solid waste or litter?.....	<input checked="" type="checkbox"/>	<input type="checkbox"/>	<input type="checkbox"/>
6. a change in dust, ash, smoke, fumes, or odors in the vicinity?.....	<input type="checkbox"/>	<input type="checkbox"/>	<input checked="" type="checkbox"/>
7. a change in ocean, bay, lake, stream, or ground water quality or quantity, or alteration of existing drainage patterns?	<input checked="" type="checkbox"/>	<input type="checkbox"/>	<input type="checkbox"/>
8. a change in existing noise or vibration levels in the vicinity?.....	<input type="checkbox"/>	<input type="checkbox"/>	<input checked="" type="checkbox"/>
9. construction on filled land or on slope of 10 percent or more?.....	<input type="checkbox"/>	<input type="checkbox"/>	<input checked="" type="checkbox"/>
10. use or disposal of potentially hazardous materials, such as toxic or radioactive substances, flammables, or explosives?	<input type="checkbox"/>	<input type="checkbox"/>	<input checked="" type="checkbox"/>
11. a change in demand for municipal services (police, fire, water, sewage, etc)?	<input type="checkbox"/>	<input type="checkbox"/>	<input checked="" type="checkbox"/>
12. increase in fossil fuel consumption (electricity, oil, natural gas, etc.)?	<input type="checkbox"/>	<input type="checkbox"/>	<input checked="" type="checkbox"/>
13. a larger project or a series of projects?.....	<input checked="" type="checkbox"/>	<input type="checkbox"/>	<input type="checkbox"/>

E. CERTIFICATION

I hereby certify that the statements furnished above and in the attached exhibits present the data and information required for this initial evaluation to the best of my ability, and that the facts, statements, and information presented are true and correct to the best of my knowledge and belief.

Date: September 22, 1982

99
CALENDAR PAGE
MINUTE PAGE <u>2633</u>

I. BACKGROUND INFORMATION

A. Applicant: U.S. Air Force
Headquarters, Space Division
Los Angeles, CA 90009

B. Checklist Date: 9, 27, 82

C. Contact Person: Ted T. Fukushima
Telephone: 916, 322-7813

D. Purpose: To provide landing facilities for external tanks for the space shuttle.

E. Location: Adjacent to Point Arguello, near Lompoc, Santa Barbara County.

F. Description: (see attached Exhibit B)

G. Persons Contacted: This Initial Study is based upon an environmental impact statement entitled "Space Shuttle Program, USAF, 1978", prepared by the U.S. Air Force. This project was further reviewed through the U.S. Army Corps of Engineer's Public Notice (#82-100-RC, 9-8-82)

Contacts: Rolf Mall-California Department of Fish and Game
Lt. Col. Wooten-USAF

II. ENVIRONMENTAL IMPACTS. (Explain all "yes" and "maybe" answers)

A. Earth. Will the proposal result in:

- | | Yes | Maybe | No |
|--|-------------------------------------|-------------------------------------|-------------------------------------|
| 1. Unstable earth conditions or changes in geologic substructures? | <input type="checkbox"/> | <input type="checkbox"/> | <input checked="" type="checkbox"/> |
| 2. Disruptions, displacements, compaction, or overcovering of the soil? | <input checked="" type="checkbox"/> | <input type="checkbox"/> | <input type="checkbox"/> |
| 3. Change in topography or ground surface relief features? | <input checked="" type="checkbox"/> | <input type="checkbox"/> | <input type="checkbox"/> |
| 4. The destruction, covering, or modification of any unique geologic or physical features? | <input type="checkbox"/> | <input type="checkbox"/> | <input checked="" type="checkbox"/> |
| 5. Any increase in wind or water erosion of soils, either on or off the site? | <input type="checkbox"/> | <input type="checkbox"/> | <input checked="" type="checkbox"/> |
| 6. Changes in deposition or erosion of beach sands, or changes in siltation, deposition or erosion which may modify the channel of a river or stream or the bed of the ocean or any bay, inlet, or lake? | <input type="checkbox"/> | <input checked="" type="checkbox"/> | <input type="checkbox"/> |
| 7. Exposure of all people or property to geologic hazards such as earthquakes, landslides, mudslides, ground failure, or similar hazards? | <input type="checkbox"/> | <input type="checkbox"/> | <input checked="" type="checkbox"/> |

CALENDAR PAGE 100
MINUTE PAGE 2631

B. Air. Will the proposal result in:

Yes Maybe No

- 1. Substantial air emissions or deterioration of ambient air quality?
- 2. The creation of objectionable odors?
- 3. Alteration of air movement, moisture or temperature, or any change in climate, either locally or regionally?

C. Water. Will the proposal result in:

- 1. Changes in the currents, or the course or direction, of water movements, in either marine or fresh waters?
- 2. Changes in absorption rates, drainage patterns, or the rate and amount of surface water runoff?
- 3. Alterations to the course or flow of trout waters?
- 4. Change in the amount of surface water in any water body?
- 5. Discharge into surface waters, or any alteration of surface water quality, including, but not limited to temperature, dissolved oxygen or turbidity?
- 6. Alteration of the direction or rate of flow of ground waters?
- 7. Change in the quantity of ground waters either through direct additions or withdrawals or through interception of an aquifer by cuts or excavations?
- 8. Substantial reduction in the amount of water otherwise available for public water supplies?
- 9. Exposure of people or property to water-related hazards such as flooding or tidal waves?
- 10. Significant changes in the temperature, flow or chemical content of surface thermal springs?

D. Plant Life. Will the proposal result in:

- 1. Change in the diversity of species, or number of any species of plants (including trees, shrubs, grass, crops and aquatic plants)?
- 2. Reduction of the numbers of any unique rare or endangered species of plants?
- 3. Introduction of new species of plants into an area, or in a barrier to the normal replenishment of existing species?
- 4. Reduction in acreage of any agricultural crop?

E. Animal Life. Will the proposal result in:

- 1. Change in the diversity of species, or numbers of any species of animals (birds, land animals including reptiles, fish and shellfish, benthic organisms, or insects)?
- 2. Reduction of the numbers of any unique, rare or endangered species of animals?
- 3. Introduction of new species of animals into an area, or result in a barrier to the migration or movement of animals?
- 4. Deterioration to existing fish or wildlife habitat?

F. Noise. Will the proposal result in:

- 1. Increase in existing noise levels?
- 2. Exposure of people to severe noise levels?

G. Light and Glare. Will the proposal result in:

- 1. The production of new light or glare?

H. Land Use. Will the proposal result in:

- 1. A substantial alteration of the present or planned land use of an area?

I. Natural Resources. Will the proposal result in:

- 1. Increase in the rate of use of any natural resources?
- 2. Substantial depletion of any nonrenewable resources?

CALENDAR PAGE	107
MINUTE PAGE	2032

- J. *Risk of Hazard*. Does the proposal result in:
1. A risk of an explosion or the release of hazardous substances (including, but not limited to, oil, pesticides, chemicals, or radiation) in the event of an accident or upset conditions? Yes Maybe No
2. Possible interference with emergency response plan or an emergency evacuation plan? Yes Maybe No
- K. *Population*. Will the proposal result in:
1. The alteration, distribution, density, or growth rate of the human population of the area? Yes Maybe No
- L. *Housing*. Will the proposal result in:
1. Affecting existing housing, or create a demand for additional housing? Yes Maybe No
- M. *Transportation/Circulation*. Will the proposal result in:
1. Generation of substantial additional vehicular movement? Yes Maybe No
2. Affecting existing parking facilities, or create a demand for new parking? Yes Maybe No
3. Substantial impact upon existing transportation systems? Yes Maybe No
4. Alterations to present patterns of circulation or movement of people and/or goods? Yes Maybe No
5. Alterations to waterborne, rail, or air traffic? Yes Maybe No
6. Increase in traffic hazards to motor vehicles, bicyclists, or pedestrians? Yes Maybe No
- N. *Public Services*. Will the proposal have an effect upon, or result in a need for new or altered governmental services in any of the following areas:
1. Fire protection? Yes Maybe No
2. Police protection? Yes Maybe No
3. Schools? Yes Maybe No
4. Parks and other recreational facilities? Yes Maybe No
5. Maintenance of public facilities, including roads? Yes Maybe No
6. Other governmental services? Yes Maybe No
- O. *Energy*. Will the proposal result in:
1. Use of substantial amounts of fuel or energy? Yes Maybe No
2. Substantial increase in demand upon existing sources of energy, or require the development of new sources? Yes Maybe No
- P. *Utilities*. Will the proposal result in a need for new systems, or substantial alterations to the following utilities:
1. Power or natural gas? Yes Maybe No
2. Communication systems? Yes Maybe No
3. Water? Yes Maybe No
4. Sewer or septic tanks? Yes Maybe No
5. Storm water drainage? Yes Maybe No
6. Solid waste and disposal? Yes Maybe No
- Q. *Human Health*. Will the proposal result in:
1. Creation of any health hazard or potential health hazard (excluding mental health)? Yes Maybe No
2. Exposure of people to potential health hazards? Yes Maybe No
- R. *Aesthetics*. Will the proposal result in:
1. The obstruction of any scenic vista or view open to the public, or will the proposal result in the creation of an aesthetically offensive site open to public view? Yes Maybe No
- S. *Recreation*. Will the proposal result in:
1. An impact upon the quality or quantity of existing recreational opportunities? Yes Maybe No

Yes Maybe No

T. Cultural Resources.

- 1. Will the proposal result in the alteration of or the destruction of a prehistoric or historic archeological site?
- 2. Will the proposal result in adverse physical or aesthetic effects to a prehistoric or historic building, structure, or object?
- 3. Does the proposal have the potential to cause a physical change which would affect unique ethnic cultural values?
- 4. Will the proposal restrict existing religious or sacred uses within the potential impact area?

U. Mandatory Findings of Significance

- 1. Does the project have the potential to degrade the quality of the environment, reduce the habitat of a fish or wildlife species, cause a fish or wildlife population to drop below self-sustaining levels, threaten to eliminate a plant or animal community, reduce the number or restrict the range of a rare or endangered plant or animal or eliminate important examples of the major periods of California history or prehistory?
- 2. Does the project have the potential to achieve short term to the disadvantage of long-term, environmental goals?
- 3. Does the project have impacts which are individually limited but cumulatively considerable?
- 4. Does the project have environmental effects which will cause substantial adverse effects on human beings, either directly or indirectly?

III. DISCUSSION OF ENVIRONMENTAL EVALUATION (See Comments Attached)

A thorough discussion of this project, including the impacts noted in Section II above, may be found in the following documents: Final EIS, Space Shuttle Program, USAF, 1978; Draft Supplement to Final EIS, USAF, 1982; Marine Biological Study of the Point Arguello Boathouse Area. A Public Notice (#82-100-RC, 9-8-82) and subsequent response from the Resources Agency regarding this project indicates that the Department of Fish and Game has agreed with applicant on mitigation measures. Such mitigation measures has been adopted as part of this document.

IV. PRELIMINARY DETERMINATION

On the basis of this initial evaluation:

- I find the proposed project COULD NOT have a significant effect on the environment and a NEGATIVE DECLARATION will be prepared.
- I find that although the proposed project could have a significant effect on the environment, there will not be a significant effect in this case because the mitigation measures described on an attached sheet have been added to the project. A NEGATIVE DECLARATION will be prepared.
- I find the proposed project MAY have a significant effect on the environment, and an ENVIRONMENTAL IMPACT REPORT is required.

Date: 1 / 27 / 82

[Signature]
 For the State Lands Commission

CALENDAR PAGE 103
 MINUTE PAGE 283 Form 13-20 (7/82)

EXHIBIT B

PROJECT DESCRIPTION

(1) Remove existing wood pier and boathouse 350 feet by 40 feet; (2) remove existing 36 inch diameter concrete filled steel support piles (approximately 25); (3) dredge 55,000 cubic yards of rock and sand to a depth of 12.4 feet below mean sea level by clamshell dredge; (4) excavate 5,000 cubic yards of bank material; (5) transport 55,000 cubic yards of dredged material to an ocean disposal site (pending approval by the Environmental Protection Agency); (6) install six 3-pile dolphins; (7) discharge 500 cubic yards of concrete and 250 cubic yards of backfill to construct an earth and concrete solid fill pier; and (8) place 250 cubic yards of rip-rap at the base of the proposed pier.

All material that are not salvaged by the contractor in the removal of the 5,000 cubic yards of excavated bank material, pier and boathouse, will be removed to an upland disposal site. In the removal of the concrete filled steel pipe support piles, slow burning explosives may be used, if mechanical methods are unsuccessful.

It is proposed to transport the dredged material for disposal to a one time only ocean disposal site subject to approval from the Environmental Protection Agency (EPA). Two other alternatives for disposal are available: (1) approved EPA ocean disposal site IA-1, near Port Hueneme, approximately 100 miles from the project site; and (2) an upland disposal site. Both these methods would considerably raise the cost of the disposal of the dredged material. A maximum of 55,000 cubic yards of Monterey shale and sand (fractured shale will be generally one foot diameter in size) will be disposed of at this site. The shale is clean, uncontaminated bedrock, with less than 10 percent sand. The disposal site is located 12.7 miles west southwest of Point Arguello, between latitudes 34° 30' 25" and 34° 30' 55" north and longitudes 120° 51' 09" and 120° 51' 39" west, which is located in the upper reaches of submarine Arguello Canyon system, at a depth of 2,100 feet below mean sea level. Disposal is planned for the fall 1982. This site is located seaward of areas utilized for commercial fishing and is not within any current OCS lease tract or near any oil or gas-related development activities.

CALENDAR PAGE	104
MINUTE PAGE	2835