

MINUTE ITEM:

This Calendar Item No. 24
was approved as Minute Item
No. 24 by the State Lands
Commission by a vote of 3
to 2 at its 7/22/82
meeting.

CALENDAR ITEM

24

7/22/82
W 40234
Hart
PRC 6188

APPROVAL OF A PROSPECTING PERMIT FOR
MINERALS OTHER THAN OIL, GAS AND GEOTHERMAL RESOURCES,
SAN BERNARDINO COUNTY

APPLICANT: Ronald D. Spear
1334 W. Foothill Blvd., #6-c
Upland, California 91786

PROPOSED AUTHORIZATION:
Approval of a Prospecting Permit for two
years to prospect for gold and other valu-
able minerals, other than oil, gas and
geothermal resources, on approximately
320 acres of land located in San Bernardino
County.

CONSIDERATION: Filing fee of \$25, expense deposit of \$100
and an acreage deposit of \$320.

TYPE OF LAND AND LOCATION:
Approximately 320 acres of State school
land, in the east half of Section 16, T32S,
R47E, MDM, in San Bernardino County.

PROPOSED PROJECT:
The applicant will sample across the width
of ravines and dry washes, dry screen the
samples, and determine the gold content
of the sample concentrates to discover
and delineate any possible gold deposits.

TERM:
The primary term of a Prospecting Permit
is two years. The Commission may, in its
discretion, extend the term for one additional
year.

A 34
S 16

CALENDAR PAGE	139
MINUTE PAGE	1523

CALENDAR ITEM NO. 24 (CONTD)

PREREQUISITE ITEMS:

1. Required statutory filing fee, expense deposit and acreage deposit have been submitted by the applicant.
2. Subject parcel is not known to contain a commercially valuable deposit of minerals.
3. Royalty payable under any preferential lease issued shall be as follows: Not less than ten percent of the gross value of all minerals produced from the leased lands, less any charges incurred by the lessee and approved by the State, in processing and transporting said minerals.

STATUTORY REFERENCES:

- A. P.R.C.: Div. 6, Section 6891.
- B. Cal. Adm. Code: Title 2, Section 2200.

AB 884: 3/30/83.

OTHER PERTINENT INFORMATION:

1. A Negative Declaration was prepared pursuant to CEQA and the State EIR Guidelines.
2. The project is situated on lands not identified as possessing significant environmental values pursuant to P.R.C. 6370.1, and is unclassified.
3. Pursuant to P.R.C. Section 6895, the applicant would have a preferential right to a lease for a maximum of 160 acres embraced within the permit. Said right shall be subject to all necessary environmental approvals. The permit will not effect the discretion of the Commission in granting or denying such environmental approvals.

APPROVALS OBTAINED:

Pursuant to P.R.C. Section 6890, the subject permit application has been approved by the Office of the Attorney General as to compliance with applicable provisions of the law.

CALENDAR ITEM NO. 24 (CONTD)

- EXHIBITS. A. Location Map.
 B. Negative Declaration.

IT IS RECOMMENDED THAT THE COMMISSION:

1. CERTIFY THAT NEGATIVE DECLARATION NO. 311 HAS BEEN COMPLETED IN ACCORDANCE WITH CEQA, THE STATE EIR GUIDELINES AND THE COMMISSION'S ADMINISTRATIVE REGULATIONS, AND THAT THE COMMISSION HAS REVIEWED AND CONSIDERED THE INFORMATION CONTAINED THEREIN TOGETHER WITH COMMENTS RECEIVED DURING THE REVIEW PROCESS.
2. FIND THAT CHANGES OR ALTERATIONS HAVE BEEN REQUIRED IN, OR INCORPORATED INTO, THE PROPOSED PROJECT WHICH MITIGATE OR AVOID THE SIGNIFICANT ENVIRONMENTAL EFFECTS THEREOF AS IDENTIFIED IN THE COMPLETED NEGATIVE DECLARATION.
3. DETERMINE THAT THE LANDS DESCRIBED IN THE PERMIT ARE NOT KNOWN TO CONTAIN COMMERCIALY VALUABLE DEPOSITS OF MINERALS.
4. AUTHORIZE THE ISSUANCE OF THE PROSPECTING PERMIT TO RONALD D. SPEAR FOR A TERM OF TWO YEARS, FOR ALL MINERALS OTHER THAN OIL, GAS AND GEOTHERMAL RESOURCES ON THE EAST HALF OF SECTION 16, T32S, R47E, MDM, SAN BERNARDINO COUNTY, ON APPROXIMATELY 320 ACRES; IN ACCORDANCE WITH THE STANDARD FORM OF PERMIT. ROYALTY PAYABLE UNDER ANY PREFERENTIAL LEASE ISSUED UPON THE DISCOVERY OF COMMERCIALY VALUABLE DEPOSITS FOR ANY AND ALL MATERIALS EXTRACTED OR REMOVED FROM SAID PREMISES FOR SALE OR STOCKPILING SHALL NOT BE LESS THAN TEN PERCENT OF THE GROSS REVENUE, LESS SPECIFIC CHARGES, AS APPROVED BY THE COMMISSION, RELATED TO TRANSPORTING AND PROCESSING AS SET FORTH IN SAID LEASE; THE DETERMINATION OF SAID ROYALTIES SHALL BE AT THE DISCRETION OF THE COMMISSION.

EXHIBIT "A"

State Lands Commission
W-40234

Application for Prospecting Permit

Speer
San Bernardino County

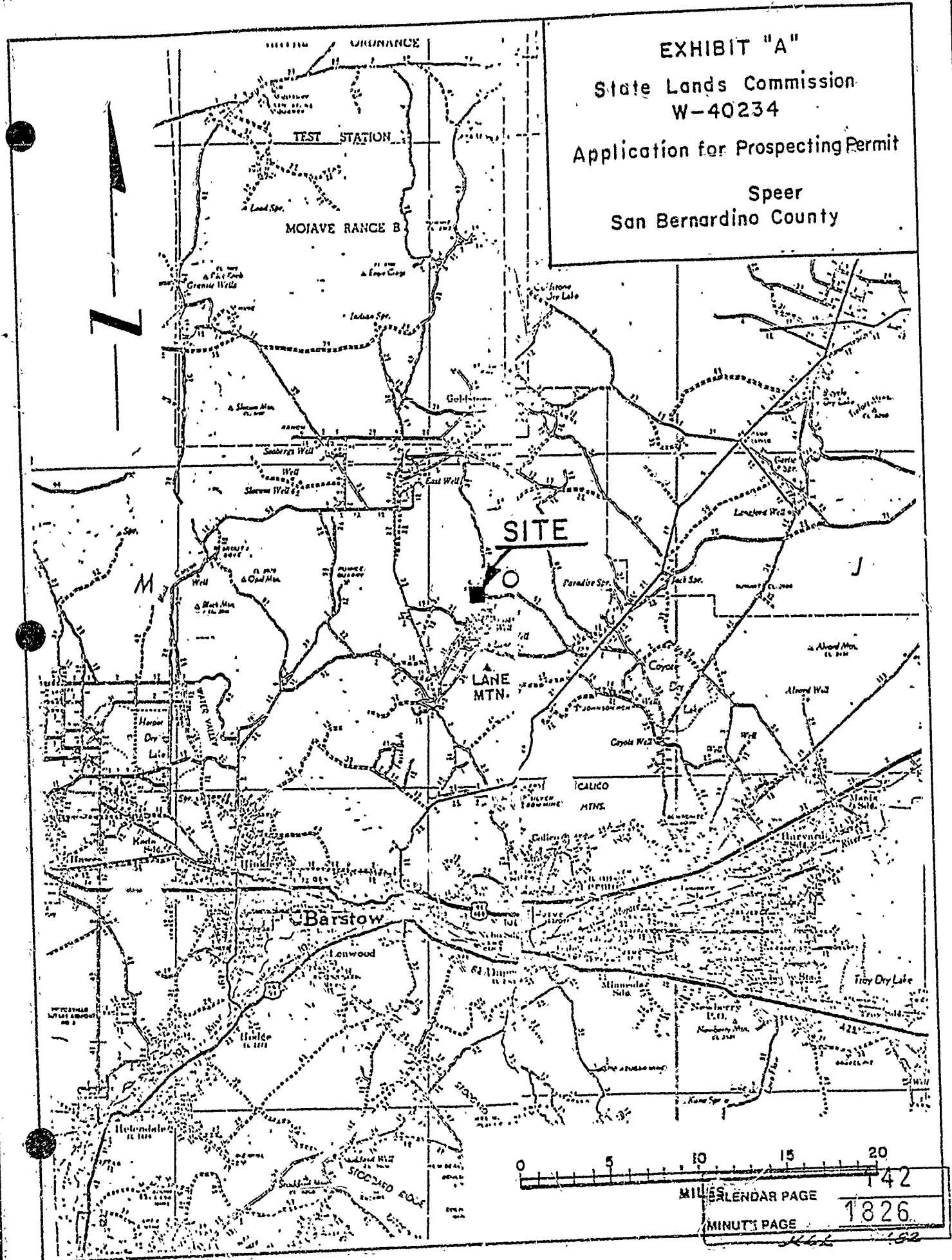

EXHIBIT "B"

PROPOSED NEGATIVE DECLARATION

EIR NO 311

File Ref.: W 40234

SCH#: 81102313

Project Title: Mineral Prospecting Permit-Ronald D. Spear

Project Location: E $\frac{1}{4}$ of Section 16, T.32 S., R.47 E., M.D.M., approximately 17 miles northerly of Barstow, San Bernardino County.

Project Description: Take samples with a rubber tired front-end loader across the width of ravines and dry washes, dry screen the samples, and determine the gold content of the sample concentrates to discover and delineate any possible gold deposits.

This NEGATIVE DECLARATION is prepared pursuant to the requirements of the California Environmental Quality Act (Section 21000 et seq. of the Public Resources Code), the State CEQA Guidelines (Section 15000 et seq., Title 14, of the California Administrative Code), and the State Lands Commission regulations (Section 2901 et seq., Title 2, of the California Administrative Code).

Based upon the attached Initial Study, it has been found that:

- the project will not have a significant effect on the environment.
- the attached mitigation measures will avoid potentially significant effects.

Contact Person: Ted T. Fukushima
1807-13th Street
Sacramento, CA 95814

(916) 322-7813

CALENDAR PAGE	<u>143</u>
MINUTE PAGE	<u>1827</u>

MITIGATION MEASURES

1. The applicant will avoid dense creosote scrub plant associations during any prospecting activity.
2. The applicant will slope the ends of trenches during prolonged sampling periods to provide an avenue of escape for any entrapped wildlife.
3. Upon completion of prospecting activities at each sampling site, the applicant will backfill any excavation and restore the prospecting site to its natural elevation as nearly as possible.

COMMENTS RECEIVED AND RESPONSES TO INITIAL STUDY

1. Department of Conservation, The Resources Agency

Comment:

"Based on the level of information included in the Initial Study, it appears a Negative Declaration is appropriate for this project; however, information should be included as to the size of the total project areas, as well as the amount of surface disturbance. This information is necessary to determine if a Reclamation Plan is required by San Bernardino County under the Surface Mining and Reclamation Act."

Response:

No adverse comments have been received from the San Bernardino County Planning Department.

A reclamation plan is not required since the applicant will excavate, at the maximum, a total of 600 cubic yards (1.875 cubic yards per acre) during the prospecting permit (exploration) phase. A logical prospecting plan entails sampling on many separate individual acres, but the total maximum excavated sampling area in the 320-acre parcel will be approximately 0.3 acres.

2. Department of Fish and Game

Comment:

"We find that a mitigated Negative Declaration would be acceptable only if the following measures are incorporated as conditions of the permit:

1. The applicant should be required to avoid dense creosote scrub plant associations during any prospecting activity.
2. During prolonged prospecting activities excavated trenches should be sloped to allow trapped animals to escape or animal-proof fences should be constructed around the trenches to prevent animal entrapment.
3. Upon completion of each sampling excavation, each trench should be filled and the site restored to its natural elevation."

Response:

See Mitigation Measures which will be conditions of any prospecting permit issued to the applicant.

File Ref.: W 40234

SCH# 81102313

December 1, 1981

INITIAL STUDY

INTRODUCTION

Ronald D. Spear has applied to the State Lands Commission for a prospecting permit on State lands located approximately three and one-half miles north of Lane Mountain in western San Bernardino County. The proposed project consists of taking exploratory samples from ravines and dry washes to discover and delineate any possible gold deposits.

The Initial Study is composed of an initial study checklist, information form responses, and maps.

STATE LANDS COMMISSION

December 1981

CALENDAR PAGE	146
MINUTE PAGE	1830

EXHIBIT "A"

State Lands Commission
W-40234
Application for Prospecting Permit

Speer
San Bernardino County

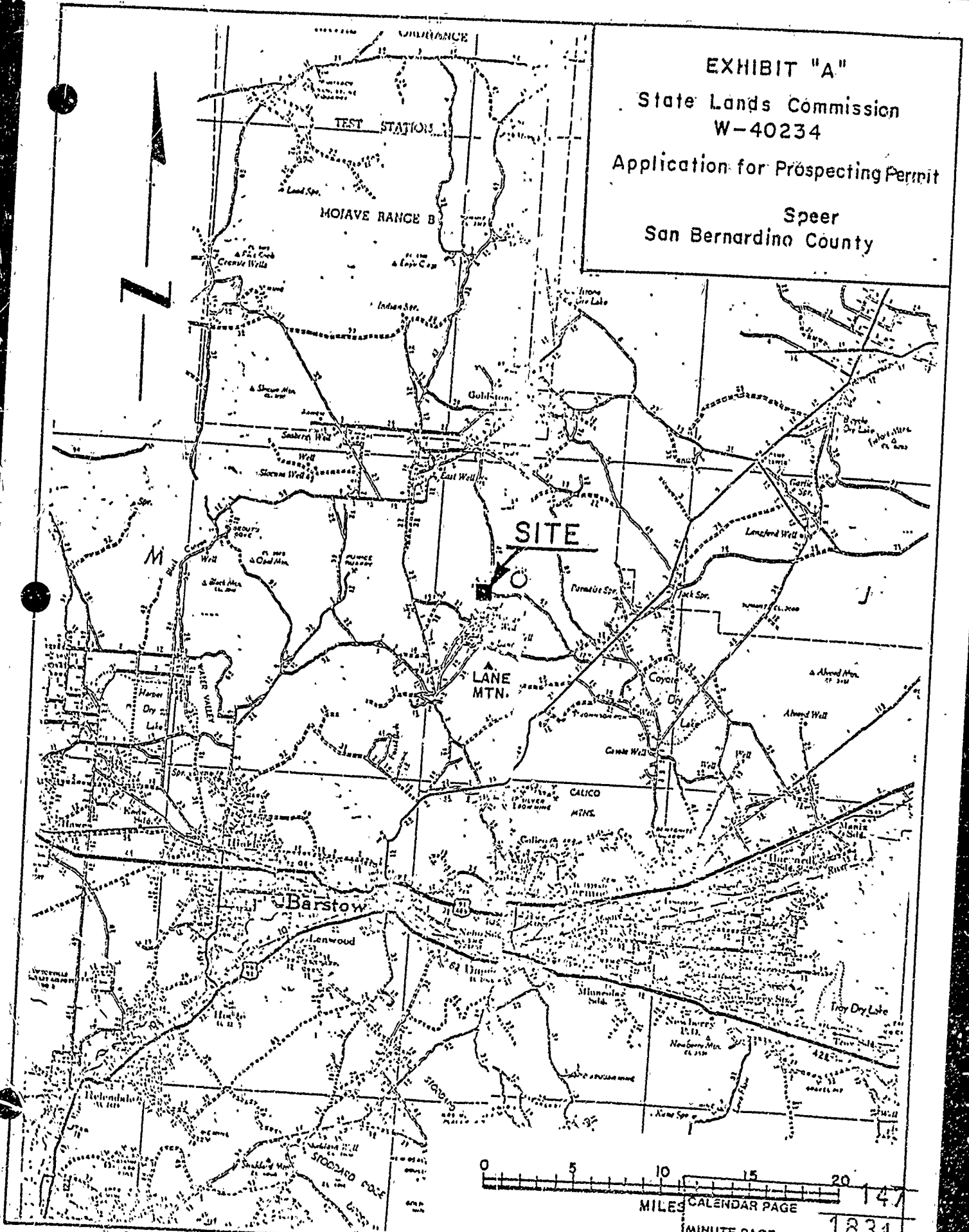

0 5 10 15 20
MILES CALENDAR PAGE 147
MINUTE PAGE 1831

K.L.L. 182

EXHIBIT "B"
Lane Mountain, Calif.
15' USGS Quadrangle

T32 S

T12 N

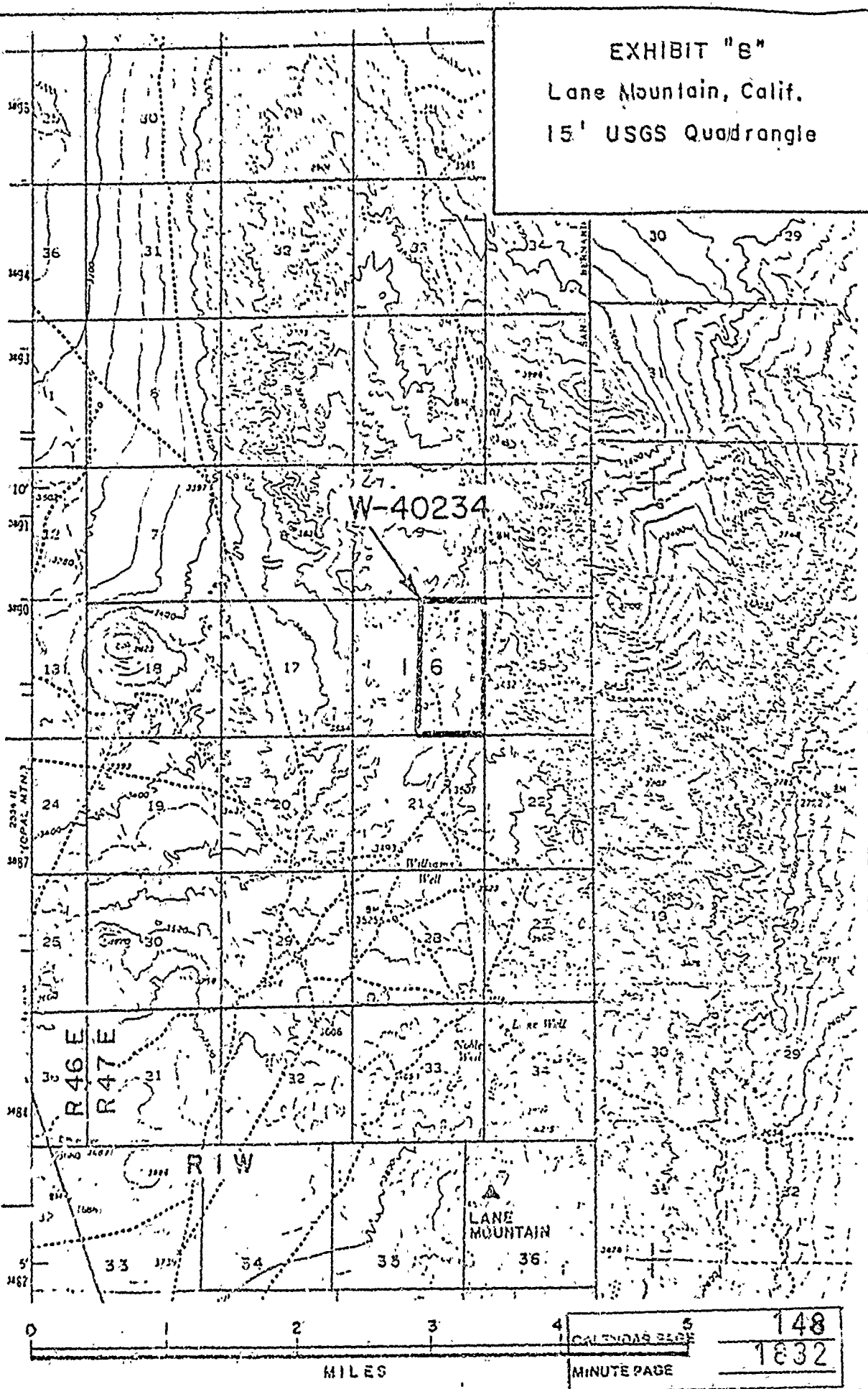

MILES

CALENDAR PAGE	148
MINUTE PAGE	1832

INITIAL STUDY CHECKLIST

Form 13.20 (7/80)

File Ref.: W 40234

I. BACKGROUND INFORMATION

A. Applicant: Ronald D. Spear
1334 W. Foothill Blvd., Apt. 6-C
Upland, CA 91786

B. Checklist Date: 11 / 30 / 81

C. Contact Person: James B. Hart, State Lands Commission
Telephone: (213 , 590-5201

D. Purpose: Prospect for valuable minerals.

E. Location: E 1/2, Section 16, T.32 S., R 47 E., M.D.B.&M., San Bernardino
County, See attached maps.

F. Description: Applicant will sample ravines and dry washes, dry screen
the samples, and determine the gold content of the sample
concentrates. See detailed project description.

G. Persons Contacted: [Blank lines for contact information]

II. ENVIRONMENTAL IMPACTS.. (Explain all "yes" and "maybe" answers)

A. Earth. Will the proposal result in:

- 1. Unstable earth conditions or changes in geologic substructures?
2. Disruptions, displacements, compaction, or overcovering of the soil?
3. Change in topography or ground surface relief features?
4. The destruction, covering, or modification of any unique geologic or physical features?
5. Any increase in wind or water erosion of soils, either on or off the site?
6. Changes in deposition or erosion of beach sands, or changes in siltation, deposition or erosion which may modify the channel of a river or stream or the bed of the ocean or any bay, inlet, or lake?
7. Exposure of all people or property to geologic hazards such as earthquakes, landslides, mudslides, ground failure, or similar hazards?

Yes Maybe No

Grid of checkboxes for Yes, Maybe, No corresponding to the list items.

CALENDAR PAGE 1833
MINUTE PAGE 1833

Yes: Maybe No

- B. *Air*. Will the proposal result in:
1. Substantial air emissions or deterioration of ambient air quality?
 2. The creation of objectionable odors?
 3. Alteration of air movement, moisture or temperature, or any change in climate, either locally or regionally?
- C. *Water*. Will the proposal result in:
1. Changes in the currents, or the course or direction of water movements, in either marine or fresh waters?
 2. Changes in absorption rates, drainage patterns, or the rate and amount of surface water runoff?
 3. Alterations to the course or flow of flood waters?
 4. Change in the amount of surface water in any water body?
 5. Discharge into surface waters, or in any alteration of surface water quality, including but not limited to temperature, dissolved oxygen or turbidity?
 6. Alteration of the direction or rate of flow of ground waters?
 7. Change in the quantity of ground waters, either through direct additions or withdrawals, or through interception of an aquifer by cuts or excavations?
 8. Substantial reduction in the amount of water otherwise available for public water supplies?
 9. Exposure of people or property to water-related hazards such as flooding or tidal waves?
 10. Significant changes in the temperature, flow or chemical content of surface thermal springs?
- D. *Plant Life*. Will the proposal result in:
1. Change in the diversity of species, or number of any species of plants (including trees, shrubs, grass, crops, and aquatic plants)?
 2. Reduction of the numbers of any unique, rare or endangered species of plants?
 3. Introduction of new species of plants into an area, or in a barrier to the normal replenishment of existing species?
 4. Reduction in acreage of any agricultural crop?
- E. *Animal Life*. Will the proposal result in:
1. Change in the diversity of species, or numbers of any species of animals (birds, land animals including reptiles, fish and shellfish, benthic organisms, or insects)?
 2. Reduction of the numbers of any unique, rare or endangered species of animals?
 3. Introduction of new species of animals into an area, or result in a barrier to the migration or movement of animals?
 4. Deterioration to existing fish or wildlife habitat?
- F. *Noise*. Will the proposal result in:
1. Increase in existing noise levels?
 2. Exposure of people to severe noise levels?
- G. *Light and Glare*. Will the proposal result in:
1. The production of new light or glare?
- H. *Land Use*. Will the proposal result in:
1. A substantial alteration of the present or planned land use of an area?
- I. *Natural Resources*. Will the proposal result in:
1. Increase in the rate of use of any natural resources?
 2. Substantial depletion of any nonrenewable resources?

CALENDAR PAGE	150
MINUTE PAGE	1334

- J. *Risk of Upset.* Does the proposal result in:
- | | Yes | Maybe | No |
|---|--------------------------|--------------------------|-------------------------------------|
| 1. A risk of an explosion or the release of hazardous substances (including, but not limited to, oil, pesticides, chemicals, or radiation) in the event of an accident or upset conditions? | <input type="checkbox"/> | <input type="checkbox"/> | <input checked="" type="checkbox"/> |
| 2. Possible interference with emergency response plan or an emergency evacuation plan? | <input type="checkbox"/> | <input type="checkbox"/> | <input checked="" type="checkbox"/> |
- K. *Population.* Will the proposal result in:
- | | | | |
|---|--------------------------|--------------------------|-------------------------------------|
| 1. The alteration, distribution, density, or growth rate of the human population of the area? | <input type="checkbox"/> | <input type="checkbox"/> | <input checked="" type="checkbox"/> |
|---|--------------------------|--------------------------|-------------------------------------|
- L. *Housing.* Will the proposal result in:
- | | | | |
|---|--------------------------|--------------------------|-------------------------------------|
| 1. Affecting existing housing, or create a demand for additional housing? | <input type="checkbox"/> | <input type="checkbox"/> | <input checked="" type="checkbox"/> |
|---|--------------------------|--------------------------|-------------------------------------|
- M. *Transportation/Circulation.* Will the proposal result in:
- | | | | |
|---|--------------------------|--------------------------|-------------------------------------|
| 1. Generation of substantial additional vehicular movement? | <input type="checkbox"/> | <input type="checkbox"/> | <input checked="" type="checkbox"/> |
| 2. Affecting existing parking facilities, or create a demand for new parking? | <input type="checkbox"/> | <input type="checkbox"/> | <input checked="" type="checkbox"/> |
| 3. Substantial impact upon existing transportation systems? | <input type="checkbox"/> | <input type="checkbox"/> | <input checked="" type="checkbox"/> |
| 4. Alterations to present patterns of circulation or movement of people and/or goods? | <input type="checkbox"/> | <input type="checkbox"/> | <input checked="" type="checkbox"/> |
| 5. Alterations to waterborne, rail, or air traffic? | <input type="checkbox"/> | <input type="checkbox"/> | <input checked="" type="checkbox"/> |
| 6. Increase in traffic hazards to motor vehicles, bicyclists, or pedestrians? | <input type="checkbox"/> | <input type="checkbox"/> | <input checked="" type="checkbox"/> |
- N. *Public Services.* Will the proposal have an effect upon, or result in a need for new or altered governmental services in any of the following areas:
- | | | | |
|---|-------------------------------------|--------------------------|-------------------------------------|
| 1. Fire protection? | <input type="checkbox"/> | <input type="checkbox"/> | <input checked="" type="checkbox"/> |
| 2. Police protection? | <input type="checkbox"/> | <input type="checkbox"/> | <input checked="" type="checkbox"/> |
| 3. Schools? | <input type="checkbox"/> | <input type="checkbox"/> | <input checked="" type="checkbox"/> |
| 4. Parks and other recreational facilities? | <input type="checkbox"/> | <input type="checkbox"/> | <input checked="" type="checkbox"/> |
| 5. Maintenance of public facilities, including roads? | <input checked="" type="checkbox"/> | <input type="checkbox"/> | <input checked="" type="checkbox"/> |
| 6. Other governmental services? | <input type="checkbox"/> | <input type="checkbox"/> | <input checked="" type="checkbox"/> |
- O. *Energy.* Will the proposal result in:
- | | | | |
|---|--------------------------|--------------------------|-------------------------------------|
| 1. Use of substantial amounts of fuel or energy? | <input type="checkbox"/> | <input type="checkbox"/> | <input checked="" type="checkbox"/> |
| 2. Substantial increase in demand upon existing sources of energy, or require the development of new sources? | <input type="checkbox"/> | <input type="checkbox"/> | <input checked="" type="checkbox"/> |
- P. *Utilities.* Will the proposal result in a need for new systems, or substantial alterations to the following utilities:
- | | | | |
|------------------------------------|--------------------------|--------------------------|-------------------------------------|
| 1. Power or natural gas? | <input type="checkbox"/> | <input type="checkbox"/> | <input checked="" type="checkbox"/> |
| 2. Communication systems? | <input type="checkbox"/> | <input type="checkbox"/> | <input checked="" type="checkbox"/> |
| 3. Water? | <input type="checkbox"/> | <input type="checkbox"/> | <input checked="" type="checkbox"/> |
| 4. Sewer or septic tanks? | <input type="checkbox"/> | <input type="checkbox"/> | <input checked="" type="checkbox"/> |
| 5. Storm water drainage? | <input type="checkbox"/> | <input type="checkbox"/> | <input checked="" type="checkbox"/> |
| 6. Solid waste and disposal? | <input type="checkbox"/> | <input type="checkbox"/> | <input checked="" type="checkbox"/> |
- Q. *Human Health.* Will the proposal result in:
- | | | | |
|--|--------------------------|--------------------------|-------------------------------------|
| 1. Creation of any health hazard or potential health hazard (excluding mental health)? | <input type="checkbox"/> | <input type="checkbox"/> | <input checked="" type="checkbox"/> |
| 2. Exposure of people to potential health hazards? | <input type="checkbox"/> | <input type="checkbox"/> | <input checked="" type="checkbox"/> |
- R. *Aesthetics.* Will the proposal result in:
- | | | | |
|--|--------------------------|--------------------------|-------------------------------------|
| 1. The obstruction of any scenic vista or view open to the public, or will the proposal result in the creation of an aesthetically offensive site open to public view? | <input type="checkbox"/> | <input type="checkbox"/> | <input checked="" type="checkbox"/> |
|--|--------------------------|--------------------------|-------------------------------------|
- S. *Recreation.* Will the proposal result in:
- | | | | |
|---|--------------------------|--------------------------|-------------------------------------|
| 1. An impact upon the quality or quantity of existing recreational opportunities? | <input type="checkbox"/> | <input type="checkbox"/> | <input checked="" type="checkbox"/> |
|---|--------------------------|--------------------------|-------------------------------------|

T. Cultural Resources.

Yes Maybe No

- 1. Will the proposal result in the alteration of or the destruction of a prehistoric or historic archeological site?
- 2. Will the proposal result in adverse physical or aesthetic effects to a prehistoric or historic building, structure, or object?
- 3. Does the proposal have the potential to cause a physical change which would affect unique ethnic cultural values?
- 4. Will the proposal restrict existing religious or sacred uses within the potential impact area?

U. Mandatory Findings of Significance.

- 1. Does the project have the potential to degrade the quality of the environment, reduce the habitat of a fish or wildlife species, cause a fish or wildlife population to drop below self-sustaining levels, threaten to eliminate a plant or animal community, reduce the number or restrict the range of rare or endangered plant or animal or eliminate important examples of the major periods of California history or prehistory?
- 2. Does the project have the potential to achieve short-term, to the disadvantage of long-term, environmental goals?
- 3. Does the project have impacts which are individually limited, but cumulatively considerable?
- 4. Does the project have environmental effects which will cause substantial adverse effects on human beings, either directly or indirectly?

III. DISCUSSION OF ENVIRONMENTAL EVALUATION (See Comments/Attached)

See attached Discussion of Environmental Evaluation, Detailed Project Description, and Form 69.3.

IV. DETERMINATION

On the basis of this initial evaluation:

- I find the proposed project COULD NOT have a significant effect on the environment, and a **NEGATIVE DECLARATION** will be prepared.
- I find that although the proposed project could have a significant effect on the environment, there will not be a significant effect in this case because the mitigation measures described on an attached sheet have been added to the project. A **NEGATIVE DECLARATION** will be prepared.
- I find the proposed project MAY have a significant effect on the environment, and an **ENVIRONMENTAL IMPACT REPORT** is required.

Date: 11/30/81

James B. Hart
 JAMES B. HART | CALENDAR PAGE | 152
 For the State Lands Commission | DATE PAGE | 1836

Detailed Project Description

The subject area has a Mesozoic basic intrusive bedrock that has been subjected to faulting. Several prominent fault traces occur at the surface in the northern half and probably extend to the south in the subsurface. Erosion processes have produced a surface of gently sloping relief with dry washes and ravines.

The applicant will take samples with a rubber tired front-end loader across the width of ravines and dry washes in a perpendicular direction to their longitudinal axes. All sampling will be done in the upper .5 to 3 feet of the surface. The sample trenches will be 3 feet wide, .5 to 3 feet deep across the width of ravines and dry washes. A dry screening process will be used to reduce the samples to concentrates. If results of the dry screening warrant further prospecting, sampling will proceed up grade from the lower end of the ravines and dry washes.

The sample concentrates will be analyzed for their gold content. If a commercially valuable deposit is discovered through prospecting efforts under authorization of a prospecting permit, a comprehensive environmental report will be required on the future impacts of mining the deposit.

III. Discussion of Environmental Evaluation

A2. Disruption, displacement, compaction, and overcovering of the sandy soil will occur in the immediate vicinity of the sampling sites. All sampling excavations will be restored to the natural ground contour if prospecting is unsuccessful.

A minimal amount of disruption and compaction of the soil will occur when the sampling equipment is moved on and off a site.

A5. An increase in wind and water erosion of the disturbed soil at the sampling sites will take place during wind and rain storms. Erosion should be minimal since the applicants will sample perpendicular to the longitudinal axes of ravines and dry washes.

B1. Temporary dust emissions will be produced during sampling and dry screening.

F1. The sampling and dry screening operations will temporarily increase the existing noise levels in the relatively quiet desert environment.

ENVIRONMENTAL INFORMATION FORM
(To be completed by applicant)

GENERAL INFORMATION

- 1. Name and address of developer or project sponsor: Ronald D. Spear
1334 W. FOOTHILL BLVD #6-C UPLAND, CAL 91786
- 2. Address of project: E $\frac{1}{2}$ Section 16, T. 32 S., R. 47 E., M.D.B.&M.,
San Bernardino County
Assessor's Block and Lot number: _____
- 3. Name, address, and telephone number of person to be contacted concerning this project: Ronald D.
Spear. SAME AS #1 714 905-5490
- 4. Indicate number of the permit application for the project to which this form pertains: W 40234
- 5. List and describe any other related permits and other public approvals required for this project, including those required by City, regional, state and federal agencies: None
- 6. Existing zoning district: _____
Present use of site: None
- 7. Proposed use of site (Project for which this form is filed): Prospect for gold under
authorization of a prospecting permit.

PROJECT DESCRIPTION:

- 8. Site size. 320 acres
- 9. Square footage. N.A.
- 10. Number of floors of construction. N.A.
- 11. Amount of off-street parking provided. N.A.
- 12. Attach plans.
- 13. Proposed scheduling. Project to commence following issue of permit.
- 14. Associated projects: None
- 15. Anticipated incremental development. Not determined at present.
- 16. If residential, include the number of units, schedule of unit sizes, range of sale prices or rents, and type of household and household size expected. N.A.
- 17. If commercial, indicate the type, whether neighborhood or city oriented, square footage of sales area, and loading facilities. N.A.
- 18. If industrial, indicate type, estimated employment per shift, and loading facilities. N.A.
- 19. If institutional, indicate the major function, estimated employment per shift, estimated occupancy, loading facilities and community benefits to be derived from the project. N.A.

RECEIVED
STATE LANDS
COMMISSION
LONG BEACH
NOV 27 1981

CALENDAR PAGE	155
MINUTE PAGE	FORM 69-1 (5/78)

20. If the project involves a variance, conditional use or rezoning application, state this and indicate clearly why the application is required. **None required.**

Are the following items applicable to the project or its effects? Discuss below all items checked yes. (attach additional sheets as necessary)

YES NO

21. Change in existing features of any bays, tidelands, beaches, lakes or hills, or substantial alteration of ground contours.
22. Change in scenic views or vistas from existing residential areas or public lands or roads.
23. Change in pattern, scale or character of general area of project.
24. Significant effect on plant or animal life.
25. Significant amounts of solid waste or litter.
26. Change in dust, ash, smoke, fumes or odors in vicinity.
27. Change in ocean, bay, lake, stream or ground water quality or quantity, or alteration of existing drainage patterns.
28. Change in existing noise or vibration levels in the vicinity.
29. Site on filled land or on slope of 10 percent or more.
30. Use of disposal of potentially hazardous materials, such as toxic substances, flammables or explosives.
31. Change in demand for municipal services (police, fire, water, sewage, etc.)
32. Increased fossil fuel consumption (electricity, oil, natural, gas, etc.)
33. Relationship to a larger project or series of projects.

ENVIRONMENTAL SETTING

34. Describe the *project site* as it exists before the project, including information on topography, soil stability, plants and animals, and any cultural, historical or scenic aspects. Describe any existing structures on the site, and the use of the structures. Attach *photographs* of the site. Snapshots or polaroid photos will be accepted.
35. Describe the *surrounding properties*, including information on plants and animals and any cultural, historical or scenic aspects. Indicate the type of land use (residential, commercial, etc.), intensity of land use (one-family, apartment houses, shops, department stores, etc.), and scale of development (height, frontage, set-back, rear yard, etc.). Attach *photographs* of the vicinity. Snapshots or polaroid photos will be accepted.

CERTIFICATION:

I hereby certify that the statements furnished above and in the attached exhibits present the data and information required for this initial evaluation to the best of my ability, and that the facts, statements, and information presented are true and correct to the best of my knowledge and belief.

Date November 27, 1981

Donald D. Jr.
For _____

CALENDAR PAGE	155A
MINUTE PAGE	1840

Environmental Information Form

Environmental Setting

34. Project site

The area is open, uninhabited desert of gently sloping relief, varying from 3440 feet to 3600 feet in elevation. Dry washes and ravines are the major topographic features occurring in the Mesozoic basic intrusive bedrock. The surface area is typical of the northern portion of the western Mojave Desert with moderate cover of perennial creosote brush and scattered annuals, depending on the rainfall for a particular year.

According to the Bureau of Land Management Environmental Assessment Worksheet (3809) for a 40-acre parcel (CA MC #80586) in adjacent Section 15, no known sensitive, rare, or endangered plants, or animals, or their habitats exist in the 40-acre parcel. No cultural resources were noted by the BLM archaeologist, and he gave a low rating on cultural resources sensitivity. No special unique landscape character values are present as noted on the BLM worksheet. It is highly probable that the BLM'S assessment of the 40-acre parcel in Section 15 is applicable to the E $\frac{1}{2}$ of adjacent Section 16 and the surrounding properties.

35. Surrounding Properties

The surrounding properties of the project site are identical to the project site described above. Much of the surrounding area is currently staked for Federal mining claims.

MAILING LIST - LETTERS
W 40234
December 1, 1981

U.S. Bureau of Land Management
Peter Ertman
1695 Spruce Street
Riverside, CA 92507

U.S. Fish and Wildlife Service
Division of Ecological Services
2400 Avila Rd.
Laguna Niguel, CA 92677

Ronald D. Spear
1334 W. Foothill, Apt. 6C
Upland, CA 91788

San Bernardino County Planning Department
Attn: Fred Hinshaw
1111 East Mill Street, Bldg. 1
San Bernardino, CA 92415

CALENDAR PAGE	157
MINUTE PAGE	1842

MAILING LIST - MEMOS
W 40234
December 1, 1981

Air Resources Board
Mike Redemer
1102 "Q" Street
Sacramento, CA 95814

Dept. of Fish & Game
Robert Tharratt
1416 Ninth Street
Sacramento, CA 95814

Dept. of Health
Harvey Collins
714 "P" Street
Sacramento, CA 95814

Dept. of Parks & Recreation
James M. Doyle
1220 "K" Street, 3rd Floor
Sacramento, CA 95814

Office of Historic Preservation
Nick del Cioppo
1220 "K" Street, 3rd Floor
Sacramento, CA 95814

State Water Resources Control Board
John Huddleson
1416 Ninth Street
Sacramento, CA 95814

Dept. of Conservation
Environmental Program Coordinator
Division of Mines and Geology
1416 Ninth Street, Room 1354
Sacramento, CA 95814

Office of Permit Assistance
Office of Planning and Research
Attn: Ron Bass
1400 Tenth Street
Sacramento, CA 95814

Dept. of Fish & Game
Fred A. Worthley, Jr.,
Regional Manager
350 Golden Shore
Long Beach, CA 90802

Regional Water Quality
Control Board
Roy C. Hampson, Executive Officer
Lahontan Region (6)
2092 Lake Tahoe Blvd.
South Lake Tahoe, CA 95702

Dept. of Transportation
District 8
Harvey Sawyer
247 West Third Street
San Bernardino, CA 92403

Native American Heritage Commission
1400 Tenth Street
Sacramento, CA 95814

CALENDAR PAGE	158
MINUTE PAGE	1643