

MINUTE ITEM

This Calendar Item No. 22  
was approved as Minute Item  
No. 22 by the State Lands  
Commission by a vote of 2  
to 0 at its 11/23/81  
meeting.

CALENDAR ITEM

22

11/23/81  
W 40228  
Craber

PUBLIC HEARING ON PROPOSED  
OIL AND GAS LEASE

APPLICANT: Jordan Oil and Gas Company  
P. O. Box 1919  
Santa Rosa, California 95402

AREA, LAND TYPE AND LOCATION:  
Approximately 186 acres of tide and submerged  
land in the bed of the Sacramento River  
one-half mile north of the Town of Princeton,  
Glenn County, California, near Packer Island  
and Packer Lake.

PERTINENT INFORMATION:

The Commission has received a request from  
Jordan Oil and Gas Company to enter into  
an Oil and Gas Lease on a portion of the  
Sacramento River near Princeton, California,  
as shown on Exhibits "A" and "B" (attached).  
Jordan Oil and Gas has leases on property  
adjacent to all riverbanks adjoining the  
State lands.

Section 6873.2 of the P.R.C. requires that  
before offering any tide and submerged  
land area or beds of navigable rivers for  
lease, the Commission shall hold a public  
hearing on the matter within a city or  
county adjacent to such area. The Commission  
shall propose at such hearing a plan for  
the control of subsidence and pollution  
which might occur as a result of the proposed  
oil and gas operation.

The staff is preparing an initial study  
for this project which will include a pollution  
and subsidence control plan. The initial  
study will then be circulated to responsible  
agencies for consultation and comment.

AB 884: N/A.

A 1

S 1

CALENDAR ITEM NO. 22 (CONTD)

EXHIBITS:           A. Location Map.  
                      B. Land Description.

IT IS RECOMMENDED THAT THE COMMISSION:

1. AUTHORIZE THE EXECUTIVE OFFICER OR HIS DESIGNEE TO CONDUCT A PUBLIC HEARING, AS REQUIRED BY SECTION 687B OF THE P.R.C. REGARDING THE COMMISSION'S INTENTION TO CONSIDER ENTERING INTO A LEASE FOR THE EXTRACTION OF OIL AND GAS FROM A PARCEL OF TIDE AND SUBMERGED LAND DESCRIBED IN EXHIBIT "B" ATTACHED HERETO AND BY THIS REFERENCE MADE A PART HEREOF.

|               |      |
|---------------|------|
| CALENDAR PAGE | 71   |
| MINUTE PAGE   | 2520 |

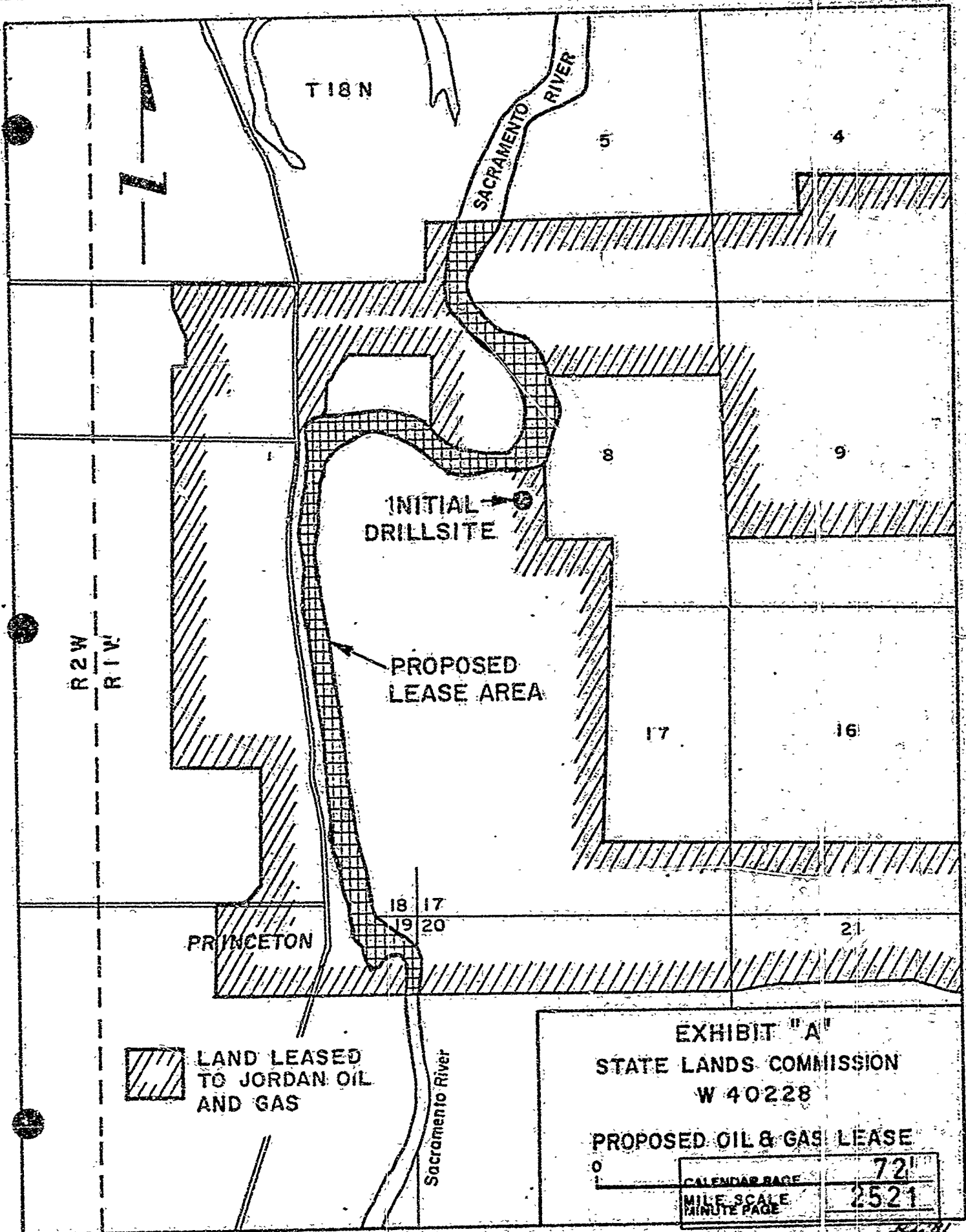

T18N

SACRAMENTO RIVER

5

4

8

9

INITIAL DRILLSITE

PROPOSED LEASE AREA

17

16

PRINCETON

18

17

19

20

21

Sacramento River

LAND LEASED TO JORDAN OIL AND GAS

EXHIBIT "A"  
STATE LANDS COMMISSION  
W 40228

PROPOSED OIL & GAS LEASE

|               |      |
|---------------|------|
| CALENDAR PAGE | 72   |
| MILE SCALE    | 2521 |
| MINUTE PAGE   |      |

3/2/81

EXHIBIT "B"

LAND DESCRIPTION

W 40228

A parcel of submerged land in the bed of the Sacramento River, in T18N, R1W, MDM, Glenn and Colusa Counties, California, described as follows:

All those lands bounded by the ordinary low water marks on the east and west banks of said Sacramento River and bounded on the north and south by California Coordinate System, Zone 2 latitudinal grid lines of the following "y" values:

North line, y = 645,950 feet  
South line, y = 642,000 feet

END OF DESCRIPTION

PREPARED OCTOBER 23, 1981 BY TECHNICAL SERVICES UNIT, ROY MINNICK, SUPERVISOR.

|               |      |
|---------------|------|
| CALENDAR PAGE | 73   |
| MINUTE PAGE   | 2522 |