

MINUTE ITEM

This Calendar Item No. C3
was approved as Minute Item
No. 3 by the State Lands
Commission by a vote of 3
to 0 at its 7/29/81
meeting.

CALENDAR ITEM

C 0-3

7/81
W 22726
Grimmett
PRC 6034

GENERAL PERMIT - PROTECTIVE STRUCTURE USE

APPLICANT: John McCormack Company
P. O. Box 527
Walnut Grove, California 95690

AREA, TYPE LAND AND LOCATION:
A 0.02-acre parcel of tide and submerged
land, located in the Sacramento River
(Mile 33.95), near Walnut Grove, Sacramento
County.

LAND USE: Bank stabilization and protection.

TERMS OF PROPOSED PERMIT:
Initial period: 25 years from May 1,
1981.

CONSIDERATION: The public benefit, with the State reserving
the right at any time to set a monetary
rental if the Commission finds such action
to be in the State's best interest.

BASIS FOR CONSIDERATION:
Pursuant to 2 Cal. Adm. Code 2005.

PREPREQUISITE TERMS, FEES AND EXPENSES:
Applicant is owner of upland.

Filing fee and processing costs have been
received.

STATUTORY AND OTHER REFERENCES:
A. P.R.C.: Div. 6, Parts 1 & 2; Div. 13.
B. Cal. Adm. Code: Title 2, Div. 3;
Title 14, Div. 6.

AB 884: 5/27/82.

OTHER PERTINENT INFORMATION:
1. The annual rental value of the site
is estimated to be \$30.

A 4

S 4

CALENDAR PAGE	14
MINUTE PAGE	1470

CALENDAR ITEM NO. C 03 (CONTD)

2. The applicant proposes to retain 15 cubic yards of riprap material placed to stabilize the levee on the bank of the Sacramento River.
3. Staff feels that bank protection at this location will be of mutual benefit to both the public and the applicant. The bank will have additional protection at no cost to the public.
4. An EIR is not required. This transaction is within the purview of 2 Cal. Adm. Code 2907, Class 1(B), which exempts an existing structure or facility that is in an acceptable state of repair, and there is no evidence of record to show injury to adjacent property, shoreline erosion, or other types of environmental degradation.
5. This project is situated on State land identified as possessing significant environmental values pursuant to P.R.C. 6370.1, and is classified in a use category, Class B, which authorizes Limited Use.

Staff review indicates that there will be no significant effect upon the identified environmental values. This is an existing facility for which no adverse comments have been received.

FURTHER APPROVALS REQUIRED:

United States Army Corps of Engineers.

EXHIBITS:

A. Land Description. B. Location Map.

IT IS RECOMMENDED THAT THE COMMISSION:

1. DETERMINE THAT AN ENVIRONMENTAL DOCUMENT HAS NOT BEEN PREPARED FOR THIS ACTIVITY AS SUCH DOCUMENT IS NOT REQUIRED UNDER THE PROVISIONS OF P.R.C. 21084, 14 CAL. ADM. CODE 15100 ET SEQ., AND 2 CAL. ADM. CODE 2907.

CALENDAR ITEM NO. C 03 (CONTD)

2. FIND THAT GRANTING OF THE PERMIT WILL HAVE NO SIGNIFICANT EFFECT UPON ENVIRONMENTAL CHARACTERISTICS IDENTIFIED PURSUANT TO SECTION 6370.1, OF THE P.R.C.
3. AUTHORIZE ISSUANCE TO JOHN MCCORMACK COMPANY OF A 25-YEAR GENERAL PERMIT - PROTECTIVE STRUCTURE USE FROM MAY 1, 1981; IN CONSIDERATION OF THE PUBLIC BENEFIT; WITH THE STATE RESERVING THE RIGHT AT ANY TIME TO SET A MONETARY RENTAL IF THE COMMISSION FINDS SUCH ACTION TO BE IN THE STATE'S BEST INTEREST; FOR BANK STABILIZATION AND PROTECTION ON THE LAND DESCRIBED ON EXHIBIT "A" ATTACHED AND BY REFERENCE MADE A PART HEREOF.

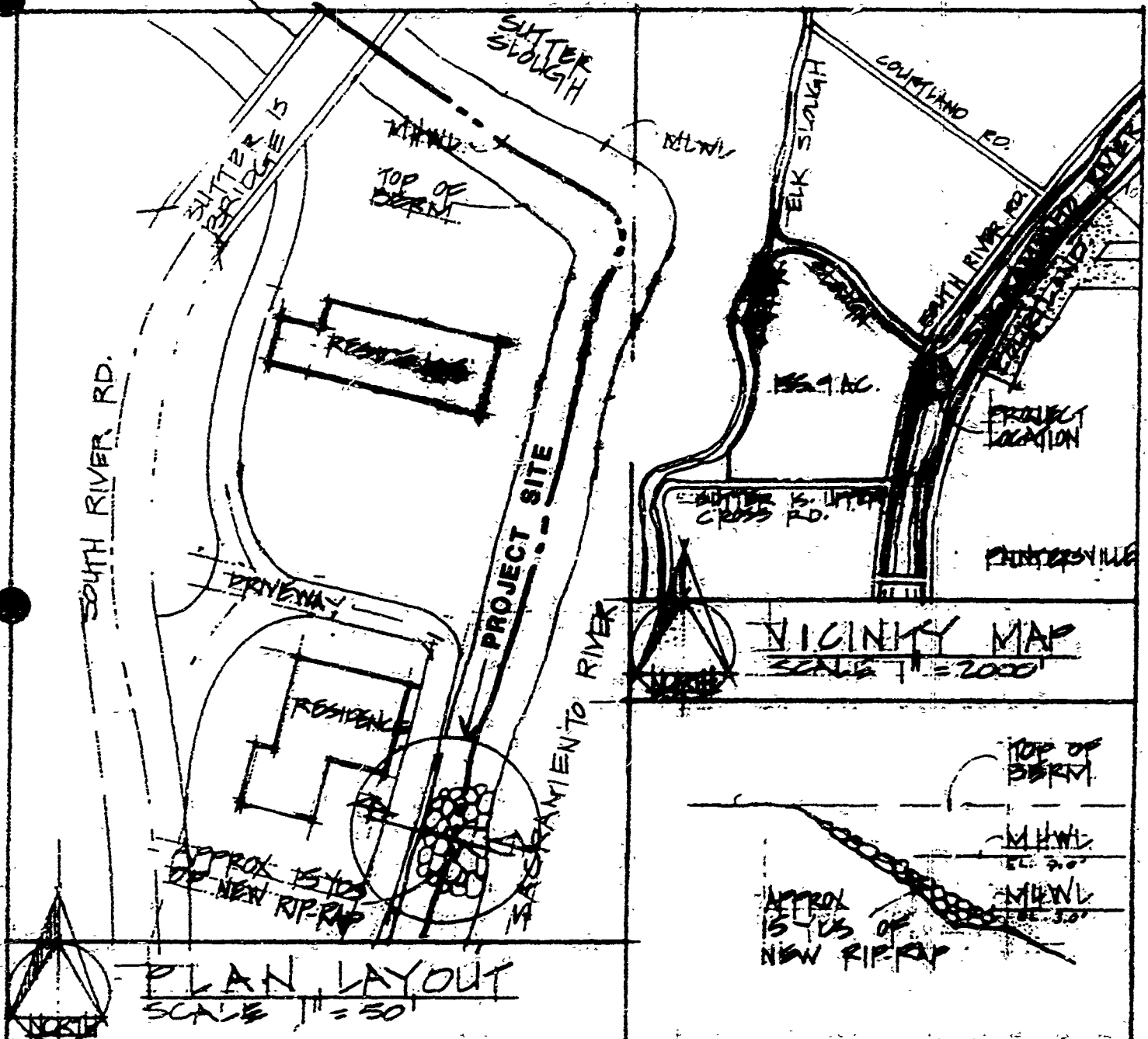

BANK PROTECTION

APPLICATION BY:
 JOHN MC CORMACK CO
 P.O. BOX 527
 WALNUT GROVE, CA 95690

LOCATION:
 SAC. COUNT. AP. # 142-01-001

SHEET NO. 1 OF 1

SECTION @ RIP-RAP

SCALE 1" = 20' 0"
 USGS DATUM

DRWN BY:

CALENDAR PAGE	17
GIL LARIE	1473
DATE PAGE	

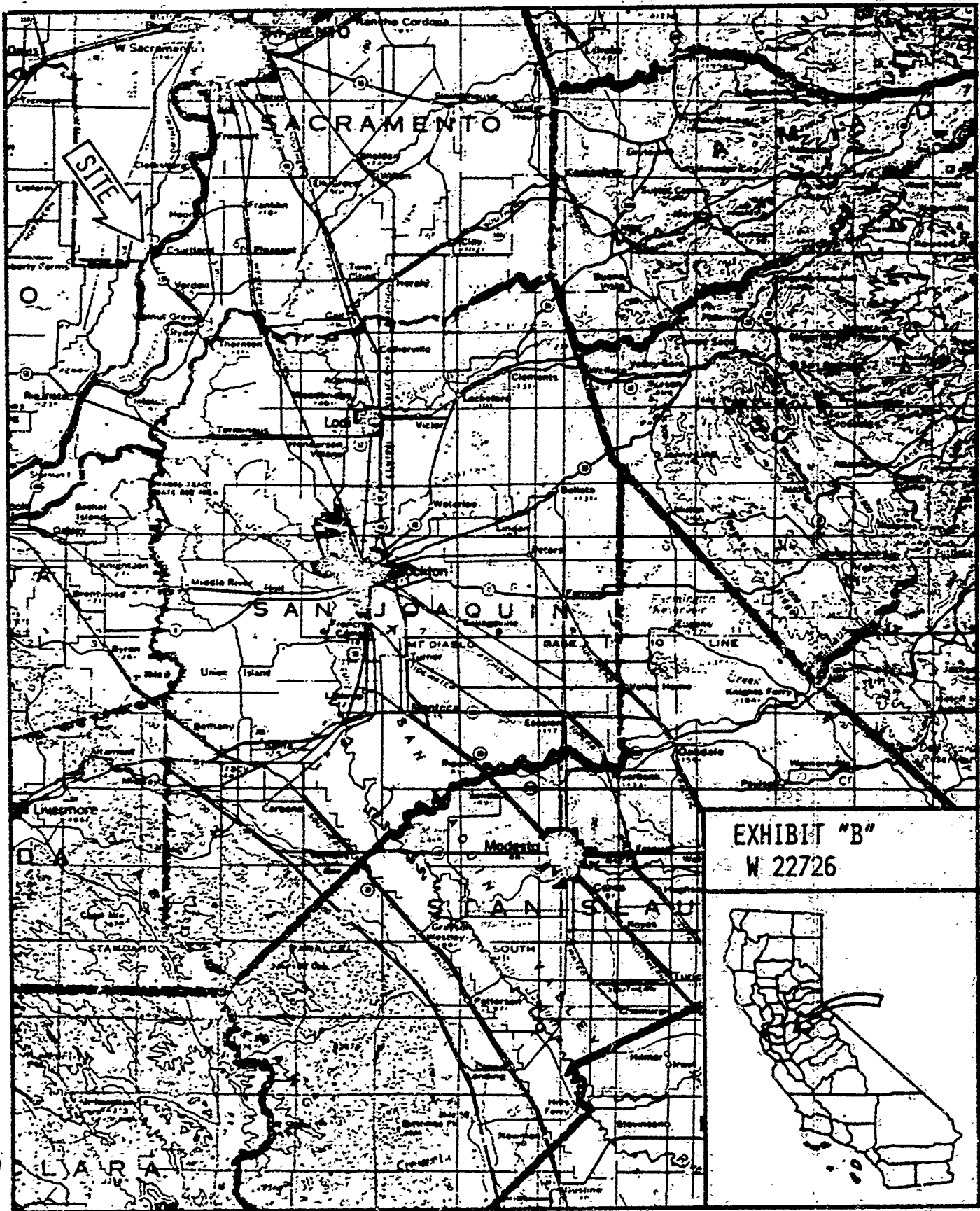

EXHIBIT "B"
W 22726

CALENDAR PAGE	18
MINUTE PAGE	1474