

MINUTE ITEM

This Calendar Item No. 23
was approved as Minute Item
No. 23 by the State Lands
Commission by a vote of 3
to 0 at its 7-7-81
meeting.

CALENDAR ITEM

23

3/81
SA 5628
Childress

SALE OF THREE PARCELS OF STATE SCHOOL LANDS FOR ROAD PURPOSES

APPLICANT: United States of America
Department of the Interior
Bureau of Land Management
P. O. Box 1090
Susanville, California 96130

AREA, TYPE LAND AND LOCATION:
27.29 acres, more or less, of State school
land in Lassen County.

LAND USE: Access route to be incorporated into BLM's
existing road system.

BACKGROUND: The land to be acquired is an existing
road with only minor realignments.

Staff review indicates that the land is
not suitable for cultivation, that the
fee acquisition will have no adverse effect
on the lands retained by the Commission
since perpetual right-of-way is reserved
to the State, and that approval of the
proposed sale is in the best interest of
the State.

STATUTORY AND OTHER REFERENCES:

A. P.R.C.: Div. 6, Div. 13.

B. Cal. Adm. Code: Title 2, Div. 3; Title 14,
Div. 6.

OTHER PERTINENT INFORMATION:

1. An EIR is not required. This transaction
is within the purview of Title 14 Cal.
Adm. Code, Section 15101, Class 1,
which exempts the operation, maintenance,
and repair of existing public or private
structures, facilities or topographical
features in an acceptable state of
repair. There is no evidence of record
to show injury to adjacent property.

A 1
S 1

CALENDAR ITEM NO. 23 (CONTD)

2. In compliance with Section 6373 of the P.R.C., a General Use Plan SCH #79022650, has been prepared and adequately circulated through the State Clearinghouse and the appropriate legislative office.
3. A portion of this project is situated on State land identified as possessing significant environmental values pursuant to P.R.C. 6370.1, and is classified in a use category, Class B, which authorizes Limited Use.

Staff has coordinated this project with those agencies and organizations which nominated the site as containing significant environmental values. They have found this project to be compatible with their nomination.

4. A portion of this project is situated on school lands not identified as possessing significant environmental values. A staff review of available environmental information indicates no reason to identify the subject school land parcel as having such values at this time.
5. USRS has conducted a fair market approval of the subject parcel. Staff has reviewed the approval and is in agreement that the price of \$1350 is equal to or greater than the fair market value of the three parcels.

EXHIBITS: A. Land Description.
 B. Location Map.
 C. General Plan.

IT IS RECOMMENDED THAT THE COMMISSION:

1. DETERMINE THAT AN ENVIRONMENTAL DOCUMENT HAS NOT BEEN PREPARED FOR THIS ACTIVITY AS SUCH DOCUMENT IS NOT REQUIRED UNDER THE PROVISIONS OF P.R.C. 21084, 14 CAL. ADM. CODE 15100 ET SEQ., 2 CAL. ADM. CODE 2907.
2. FIND THAT GRANTING OF THE PATENT WILL HAVE NO SIGNIFICANT EFFECT UPON ENVIRONMENTAL CHARACTERISTICS IDENTIFIED PURSUANT TO SECTION 6370.1, OF THE P.R.C.

CALENDAR ITEM NO. 23 (CONTD)

3. FIND THAT THE STATE SCHOOL LAND DESCRIBED IN EXHIBIT "A", ATTACHED HERETO, IS NOT SUITABLE FOR CULTIVATION WITHOUT ARTIFICIAL IRRIGATION.
4. PURSUANT TO PRC 6373, FIND THAT A GENERAL PLAN HAS BEEN PREPARED BY THE COMMISSION'S STAFF AND CIRCULATED AS REQUIRED.
5. AUTHORIZE THE SALE OF THREE PARCELS OF STATE SCHOOL LAND DESCRIBED ON EXHIBIT "A", ATTACHED AND BY REFERENCE MADE A PART HEREOF, TO THE UNITED STATES DEPARTMENT OF THE INTERIOR - BUREAU OF LAND MANAGEMENT; SUBJECT TO ALL STATUTORY AND CONSTITUTIONAL RESERVATIONS, INCLUDING RESERVATIONS OF ALL GEOTHERMAL AND MINERAL RESOURCES FOR \$1,350 CASH, WITHOUT ADVERTISING WHICH IS EQUAL TO OR GREATER THAN THE FAIR MARKET VALUE FOR THE SUBJECT PROPERTY.

PATENT CERTIFICATE NO. 20659

EXHIBIT "A"

Three parcels of land, 60 feet wide, in Lassen County, lying 30 feet on each side of the following described centerlines:

PARCEL 1

BEGINNING at a point in the centerline of Skedaddle Road which bears S 87° 11' 40" E 4,102.52 feet from the southwest corner of Section 36, T29N, R17E, MDM, thence N 34° 10' 40" E 191.07 feet to the beginning of a tangent curve to the left with a radius of 100 feet through a central angle of 46° 11' 38", an arc distance of 80.62 feet, thence N 12° 00' 58" W 1,393.32 feet to the beginning of a tangent curve to the left with a radius of 1,000 feet through a central angle of 05° 21' 11" an arc distance of 93.43 feet, thence N 17° 22' 09" W 329.89 feet to the beginning of a tangent curve to the right with a radius of 100 feet through a central angle of 31° 55' 18" an arc distance of 55.71 feet, thence N 14° 33' 09" E 163.62 feet to the beginning of a tangent curve to the right with a radius of 100 feet through a central angle of 29° 41' 12" an arc distance of 51.81 feet, thence N 44° 14' 21" E 188.02 feet to the beginning of a tangent curve to the left with a radius of 100 feet through a central angle of 21° 28' 30" an arc distance of 37.48 feet, thence N 22° 45' 51" E 239.00 feet, to the beginning of a tangent curve to the left with a radius of 100 feet through a central angle of 36° 44' 48" an arc distance of 64.14 feet, thence N 13° 58' 57" W 483.44 feet to the beginning of a tangent curve to the left with a radius of 500 feet through a central angle of 13° 30' 56" an arc distance of 117.95 feet, thence 27° 29' 53" W 118.72 feet to the beginning of a tangent curve to the right with a radius of 500 feet, through a central angle of 15° 29' 53" an arc distance of 135.25 feet, thence N 12° 00' 00" W 259.77 feet to the beginning of a tangent curve to the right with a radius of 250 feet through a central angle of 28° 08' 32" an arc distance of 122.79 feet, thence N 16° 08' 32" E 324.40 feet to the beginning of a tangent curve to the left with a radius of 1,000 feet through a central angle of 09° 31' 54" an arc distance of 166.36 feet, thence N 06° 36' 38" E 526.35 feet to the beginning of a tangent curve to the right with a radius of 100 feet through a central angle of 41° 47' 37" an arc distance of 72.94 feet, thence N 48° 24' 15" E 261.57 feet to the beginning of a tangent curve to the left with a radius of 250 feet through a central angle of 15° 36' 27" an arc distance of 68.10 feet, thence N 32° 47' 48" E 408.77 feet to a point which bears N 89° 08' 07" E 4,563.35 feet from the northwest corner of Section 36, T29N, R17E, MDM.

EXCEPTING THEREFROM any portions of the above-described parcel extending southerly of the south line and northerly of the north line of said Section 36.

PARCEL 2

BEGINNING at a point in the centerline of Skedaddle Road which bears S 88° 14' 36" W 1,254.07 feet from the south quarter corner of Section 36, T30N, R17E, MDM, thence along a tangent curve to the right with a radius of 200 feet through a central angle of 25° 31' 37" an arc distance of 89.11 feet, thence N 14° 12' 40" W 36.27 feet to the beginning of a tangent curve to the right with a radius of 200 feet through a central angle of 52° 38' 52" an arc distance of 183.78 feet, thence N 38° 26' 12" E 795.59 feet to the beginning tangent curve to the right with a radius of 300 feet through a central angle of 05° 52' 13" an arc distance of 30.74 feet, thence N 44° 18' 25" E 234.15 feet to the beginning of a tangent curve to the left with a radius of 200 feet through a central angle of 32° 47' 02" an arc distance of 114.44 feet, thence N 11° 31' 23" E 163.91 feet to the beginning of a tangent curve to the left with a radius of 200 feet through a central angle of 31° 55' 08" an arc distance of 111.42 feet, thence N 20° 23' 45" W 79.64 feet to the beginning of a tangent curve to the right with a radius of 200 feet through a central angle of 27° 25' 25" an arc distance of 95.73 feet, thence N 07° 01' 40" E 443.78 feet to the beginning of a tangent curve to the right with a radius of 400 feet through a central angle of 02° 12' 03" an arc distance of 15.36 feet, thence N 09° 13' 43" E 213.48 feet to the beginning of a tangent curve to the left with a radius of 400 feet through a central angle of 04° 02' 51" an arc distance of 28.26 feet, thence N 05° 10' 52" E 542.17 feet to the beginning of a tangent curve to the right with a radius of 400 feet through a central angle of 07° 30' 41" an arc distance of 52.44 feet, thence N 12° 41' 33" E 1,597.10 feet to the beginning of a tangent curve to the left with a radius of 400 feet through a central angle of 1° 33' 35" an arc distance of 122.59 feet, thence N 04° 52' 02" W 287.09 feet to the beginning of a tangent curve to the right with a radius of 400 feet through a central angle of 16° 43' 51" an arc distance of 116.80 feet, thence N 11° 51' 49" E 362.53 feet to a point which bears N 26° 57' 55" W 51.66 feet from the north quarter corner of Section 36, T30N, R17E, MDM.

EXCEPTING THEREFROM any portion of the above-described parcel extending southerly of the south line and northerly of the north line of said Section 36.

PARCEL 3

BEGINNING at a point in the centerline of Skedaddle Road which bears S 74° 02' 42" W 837.52 feet from the southeast

corner of Section 16, T30N, R17E, MDM, thence N 45° 11' 23" W
 622.12 feet to the beginning of a tangent curve to the left
 with a radius of 1,000 feet through a central angle of
 04° 19' 59" an arc distance of 75.63 feet, thence N 49° 31' 22"
 W 729.11 feet to the beginning of a tangent curve to the
 right with a radius of 400 feet through a central angle
 of 17° 50' 41" an arc distance 124.58 feet, thence N 31° 40' 41"
 W 44.63 feet to the beginning of a tangent curve to the
 left with a radius of 200 feet through a central angle of
 36° 09' 01" an arc distance of 126.19 feet, thence N 67° 49' 42"
 W 253.27 feet to the beginning of a tangent curve to the
 right with a radius of 250 feet through a central angle
 of 33° 35' 39" an arc distance of 146.44 feet, thence
 N 34° 16' 03" W 147.97 feet to the beginning of a tangent
 curve to the left with a radius of 200 feet through a central
 angle of 44° 38' 54" an arc distance of 155.85 feet, thence
 N 78° 54' 57" W 390.09 feet to the beginning of a tangent
 curve to the right with a radius of 400 feet through a central
 angle of 18° 39' 47" an arc distance of 130.29 feet, thence
 N 60° 15' 10" W 105.70 feet to the beginning of a tangent
 curve to the right with a radius of 50 feet through a central
 angle of 70° 07' 09" an arc distance of 61.19 feet, thence
 N 09° 51' 59" E 72.16 feet to the beginning of a tangent
 curve to the right with a radius of 200 feet through a central
 angle of 24° 02' 11" an arc distance of 83.90 feet, thence
 N 33° 54' 10" E 398.85 feet to the beginning of a tangent
 curve to the left with a radius of 150 feet through a central
 angle of 41° 20' 30" an arc distance of 108.23 feet, thence
 N 07° 26' 20" W 138.29 feet to the beginning of a tangent
 curve to the left with a radius of 50 feet through a central
 angle of 132° 21' 41" an arc distance of 115.51 feet, thence
 S 40° 11' 59" W 248.13 feet to the beginning of a tangent
 curve to the right with a radius of 200 feet through a central
 angle of 34° 19' 47" an arc distance of 119.83 feet, thence
 S 74° 31' 46" W 319.70 feet to the beginning of a tangent
 curve to the right with a radius of 400 feet through a central
 angle of 17° 54' 39" an arc distance of 125.04 feet, thence
 N 87° 33' 35" W 390.03 feet to the beginning of a tangent
 curve to the right with a radius of 400 feet through a central
 angle of 12° 32' 17" an arc distance of 87.53 feet, thence
 N 75° 01' 18" W 145.36 feet to the beginning of a tangent
 curve to the right with a radius of 400 feet through a central
 angle of 27° 05' 15" an arc distance of 189.11 feet, thence
 N 47° 56' 03" W 447.03 feet to the beginning of a tangent
 curve to the right with a radius of 100 feet through a central
 angle of 71° 18' 36" an arc distance of 124.46 feet, thence
 N 23° 22' 33" E 59.75 feet to the beginning of a tangent
 curve to the left with a radius of 250 feet through a central
 angle of 22° 13' 00" an arc distance of 96.94 feet, thence
 N 01° 09' 33" E 15.89 feet to the beginning of a tangent
 curve to the left with a radius of 250 feet through a central
 angle of 26° 11' 41" an arc distance of 114.30 feet, thence
 N 25° 02' 08" W 73.36 feet to the beginning of a tangent

curve to the left with a radius of 1,000 feet through a central angle of $03^{\circ} 07' 29''$ an arc distance of 54.54 feet, thence $N 28^{\circ} 09' 37'' W$ 502.89 feet to the beginning of a tangent curve to the right with a radius of 400 feet through a central angle of $18^{\circ} 55' 30''$ an arc distance of 132.12 feet, thence $N 09^{\circ} 14' 07'' W$ 575.60 feet to the beginning of a tangent curve to the right with a radius of 300 feet through a central angle of $29^{\circ} 55' 12''$ an arc distance of 156.66 feet, thence $N 20^{\circ} 41' 05'' E$ 719.88 feet to the beginning of a tangent curve to the left with a radius of 400 feet through a central angle of $22^{\circ} 23' 45''$ an arc distance of 156.35 feet, thence $N 01^{\circ} 42' 40'' W$ 275.45 feet to a point which bears $N 81^{\circ} 49' 36'' E$ 278.24 feet from the northwest corner of Section 16, T30N, R17E, MDM.

EXCEPTING THEREFROM any portion of the above-described parcel extending southerly of the south line or northerly of the north line or westerly of the west line of said Section 16.

END OF DESCRIPTION

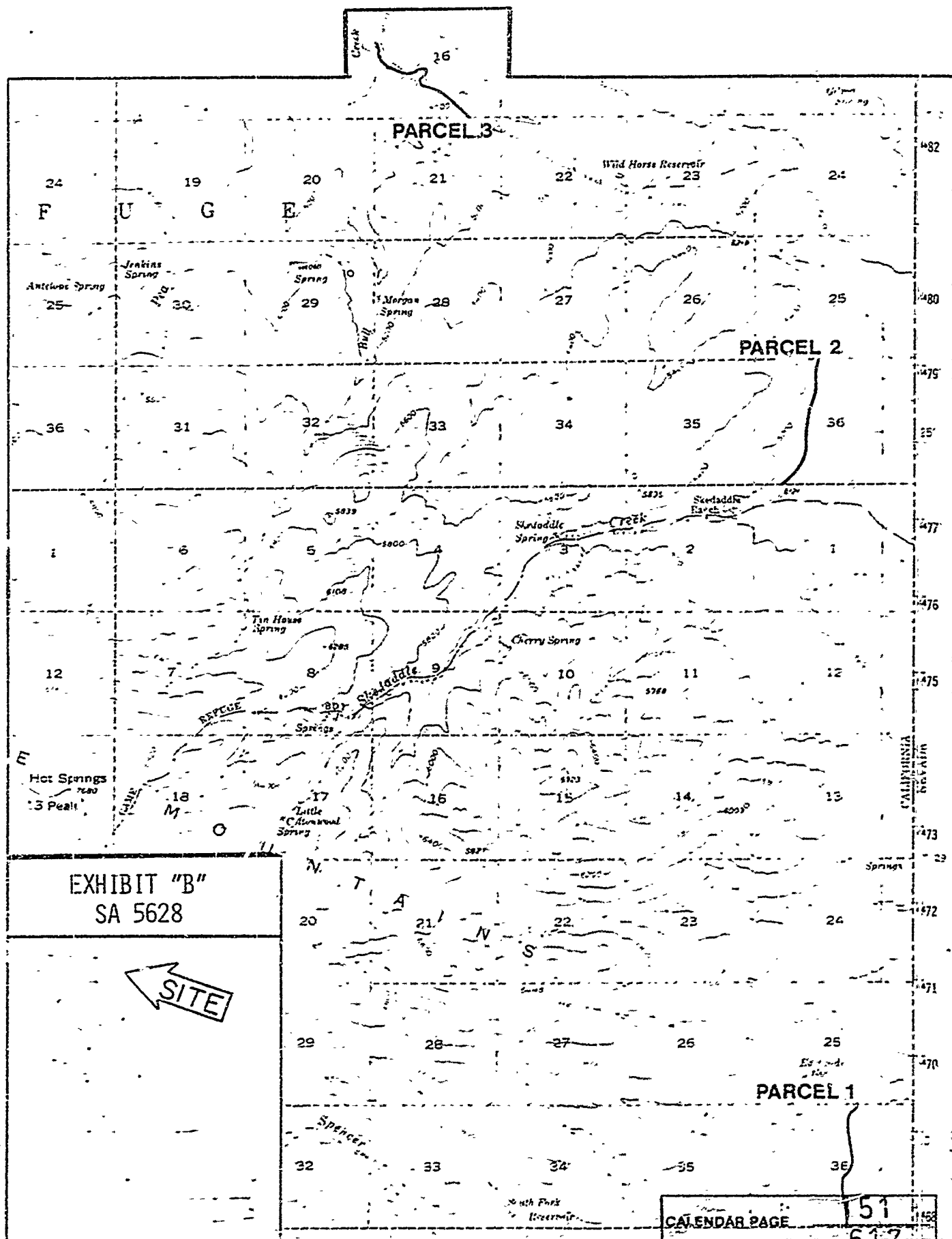

General Plan for Use of Land
Located in Lassen County

The Bureau of Land Management (BLM) has proposed the acquisition of a right-of-way covering Skeddadle Road as it crosses portions of State school land identified as Section 36, T29N, R17E, and Sections 16 and 36, T30N, R17E, MDM, containing 27.29+ acres in Lassen County.

The acquisition of the right-of-way covering Skeddadle Road will have no direct impact on the property, because it is an existing road that is open for public and BLM use. Skeddadle Road is considered a mainline road for vehicle access to a large area of public lands in the Susanville District, and BLM is attempting to insure public use of the road and to provide the proper administration and utilization of the lands under its jurisdiction.

Skeddadle Road is an existing road and is intended to remain basically unchanged. There will be minor realignments of certain curves, upgrading of the road surface, and a road maintenance program that will occur on an annual basis commencing June 1979 for the safety of the users of the roadway.

Due to the minor nature of the proposed alternatives, no permits are required by local agencies.