

MINUTE ITEM

This Calendar Item No. C17
was approved as Minute Item
No. 17 by the State Lands
Commission by a vote of 3
to 1 at its 1-26-81
meeting.

INFORMATIVE
CALENDAR ITEM

C17

1/81
W 22634
Dorsey
PRC 5942

DREDGING PERMIT

In accordance with the Commission's delegation of authority to the Executive Officer on February 24, 1977 (Minute Item No. 32), to issue Dredging Permits of 10,000 cubic yards or less, to perform maintenance dredging on State-owned lands, the following applicant has been granted such permission:

APPLICANT: Robert Bugatta Enterprises, Inc.
dba The Tides of Bodega Bay
P. O. Box 547
Bodega Bay, California 94923

The Permit provides for excavating a maximum of 6,000 cubic yards of sand, silt and gravel, excluding all other minerals including, but not limited to, oil, gas and geothermal, from granted submerged lands (minerals reserved) in Bodega Harbor, Sonoma County. Dredging is required to maintain navigable depth in and to applicant's small craft harbor. Spoils will be placed at an upland public disposal area, with a royalty of \$0.15 per cubic yard for materials so placed. The permit also provides for a royalty of \$0.25 per cubic yard in the event materials are sold or placed on private property, and is effective from December 1, 1980 through November 30, 1981.

EXHIBITS: A. Land Description. B. Location Map.

In compliance with said delegation of authority, it has been determined that the following conditions have been met:

1. The proposed project is categorically exempt from the requirements of CEQA, pursuant to the provisions of Section 15104(g) of the CEQA Guidelines as maintenance dredging with spoils disposal in an approved disposal area.

A 2

S 2

CALENDAR ITEM NO. C 17 (CONTD)

2. Issuance of the permit and the resultant project will have no significant adverse effect on the environment or the environmental characteristics identified pursuant to Section 5370.1 et seq., of the P.R.C.
3. The dredging amount will not exceed 10,000 cubic yards.
4. A charge per cubic yard will be assessed for spoil material that is deposited on private property or otherwise lost to future State benefit.
5. Approval of the project will be contingent upon approval by all pertinent State, Federal and local agencies.

CALENDAR PAGE	079
MINUTE PAGE	086

EXHIBIT "A"
W 22634

1. REMOVE APPROX 6000 CU. YDS OF SAND MATERIAL WITH SUCTION DREDGE TO ELEV. -10.0' BELOW MLLW AND DEPOSITE BY PIPE ON APPROVED "OLD QUATT AIRPORT" SITE.
2. DASH INDICATES AREA TO BE DREDGED
3. 6.9 EXISTING BOTTOM BELOW MLLW.

TIDE LANDS
COUNTY OF SONOMA

DREDGE FOR ACCESS

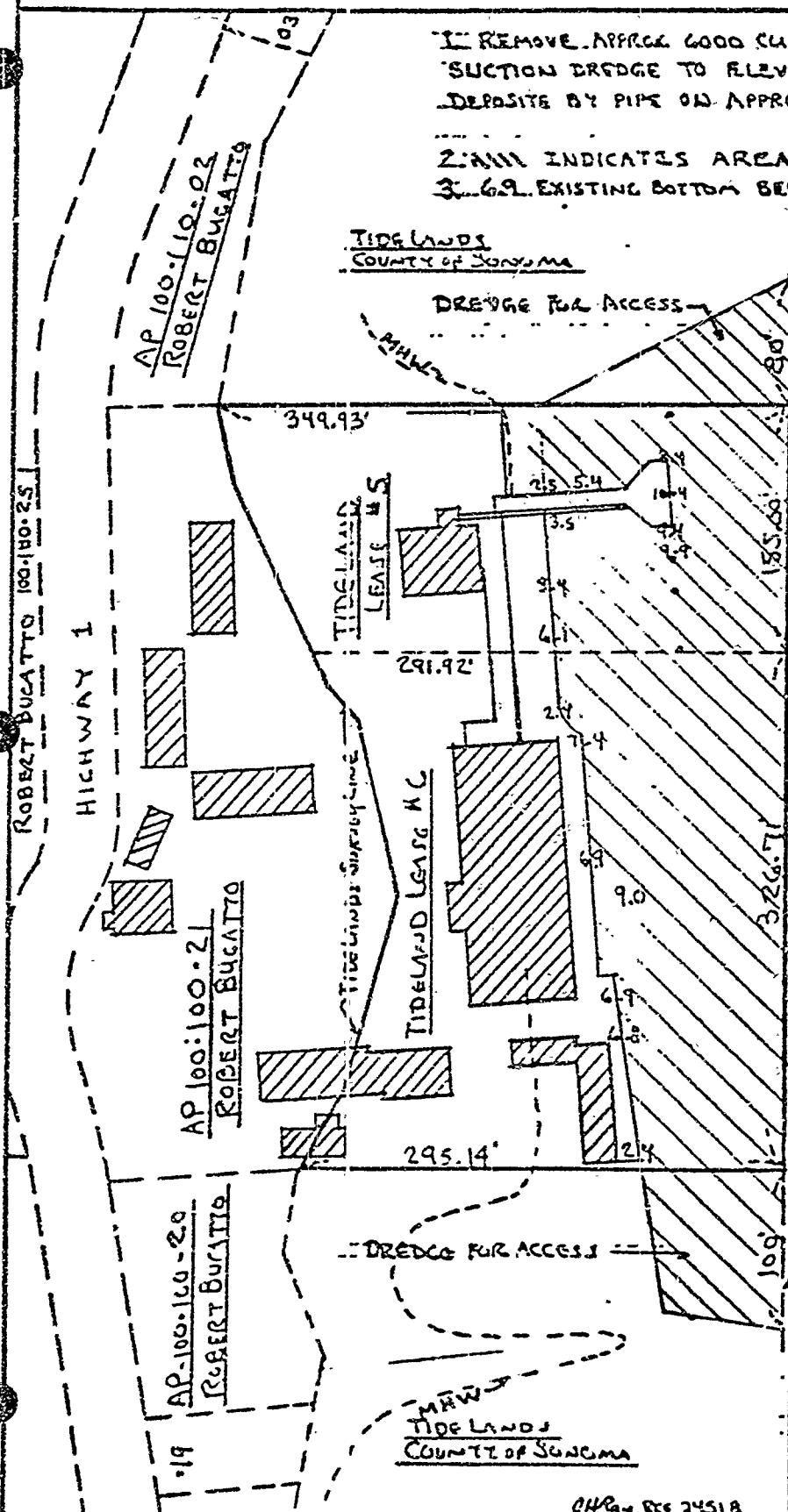
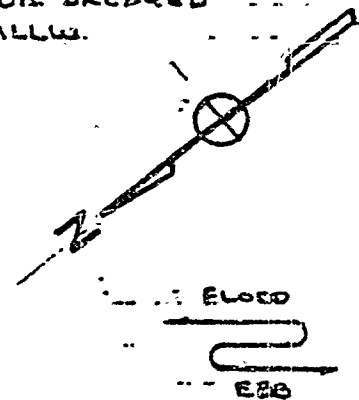

LINE OF FEDERAL CHANNEL
CURRENTLY BEING DREDGED TO 12.0' BELOW MLLW

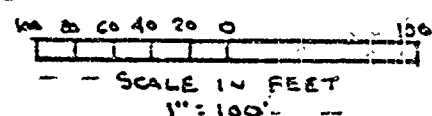

PROPOSED
MAINTENANCE DREDGING
IN BODECA HARBOR
COUNTY - SONOMA, CA.
APPL. BY ROBERT BUCATTO ENT. INC.
SHT 2 OF 3

CNR REC 24518

CALENDAR PAGE 087
MINUTE PAGE 087

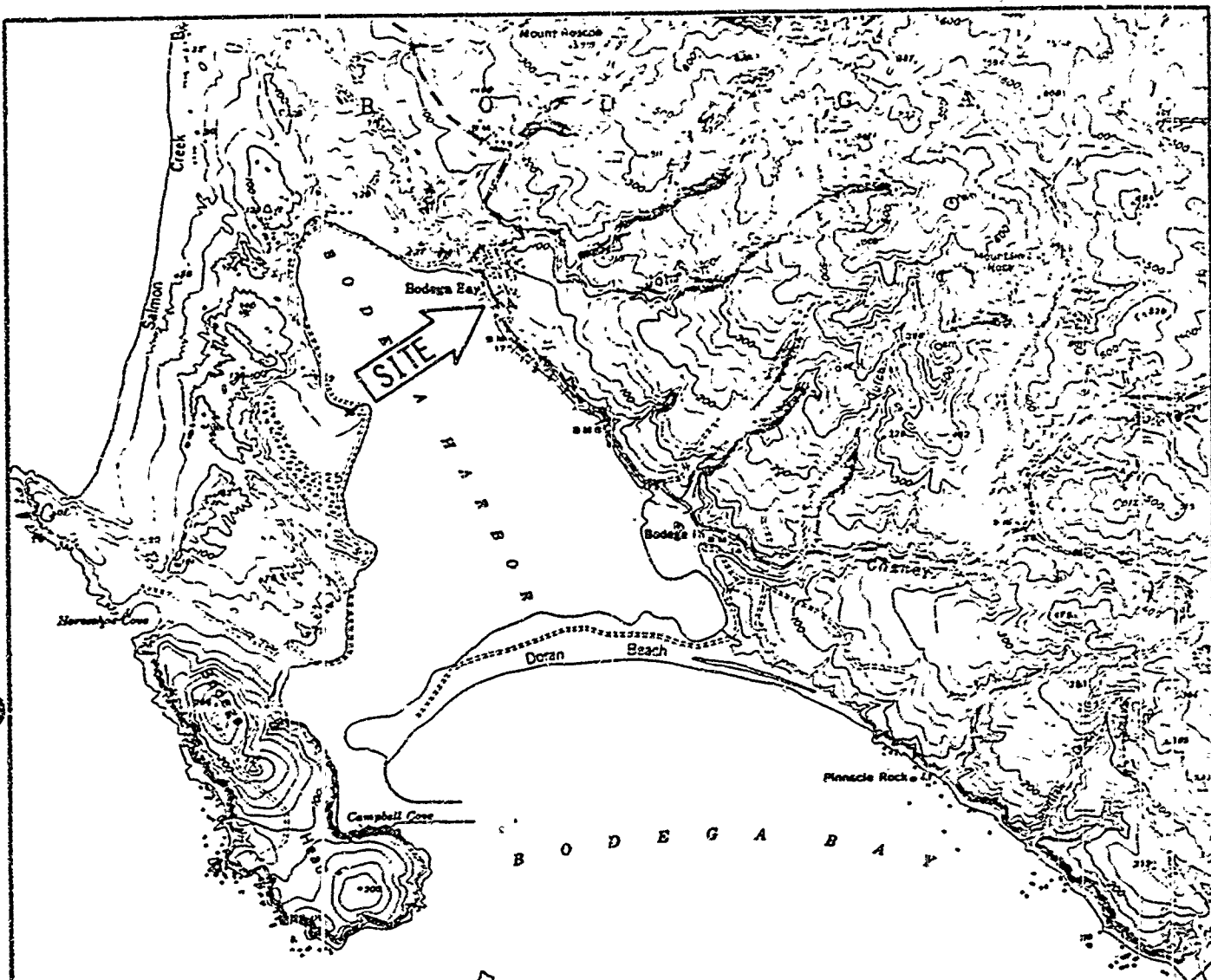

EXHIBIT "B"
W 22634

