

MINUTE ITEM

This Calendar Item No. 15.  
approved as Minute Item  
No. 15 by the State Lands  
Commission by a vote of  
to 0 at its 2-29-80  
meeting.

CALENDAR ITEM

15.

2/80  
W 22363  
Childress

PRC 5803.2

INDUSTRIAL LEASE

APPLICANT: Ball, Ball and Brosamer, Inc.  
2492 East Highway 78  
Brawley, California 92227

AREA, TYPE LAND AND LOCATION:  
A 6.10+ acre parcel of State school land,  
near the Coachella Canal, Imperial County.

LAND USE: Temporary concrete batch plant site.

TERMS OF PROPOSED LEASE:

Initial period: 1 year from March 1,  
1980.

Surety bond: \$1,000.

Public liability insurance: Combined single  
limit coverage of \$500,000.

CONSIDERATION: \$550 per annum.

BASIS FOR CONSIDERATION:

\$550 minimum rental for this type of lease.

PREREQUISITE TERMS, FEES AND EXPENSES:

Filing fee has been received.

STATUTORY AND OTHER REFERENCES:

A. P.R.C.: Div. 6, Parts 1 & 2.

B. Cal. Adm. Code: Title 2, Div. 3.

OTHER PERTINENT INFORMATION:

1. This project is exempt from CEQA because  
it is within the purview of 2 Cal.  
Adm. Code 2907, Class 4, which exempts  
minor alterations to land.

Authority: P.R.C. 21085, 14 Cal. Adm.  
Code 15100 et seq., and 2 Cal. Adm.  
Code 2907.

A 75  
S 38

CALENDAR ITEM NO. 15. (CONTD)

2. This project is situated on school lands not identified as possessing significant environmental values. A staff review of available environmental information indicates no reason to identify the subject school land parcel as having such values at this time.

EXHIBITS:      A. Site Map.    B. Location Map.

IT IS RECOMMENDED THAT THE COMMISSION:

1. DETERMINE THAT AN EIR HAS NOT BEEN PREPARED FOR THIS ACTIVITY AS SUCH REPORT IS NOT REQUIRED UNDER THE PROVISIONS OF P.R.C. 21085, 14 CAL. ADM. CODE 15100 ET SEQ., AND 2 CAL. ADM. CODE 2907.
2. AUTHORIZE ISSUANCE TO BALL, BALL AND BROSAMER, INC. OF A 1-YEAR INDUSTRIAL LEASE FROM MARCH 1, 1980; IN CONSIDERATION OF ANNUAL RENT IN THE AMOUNT OF \$550, PROVISION OF A \$1,000 SURETY BOND; PROVISION OF PUBLIC LIABILITY INSURANCE COMBINED SINGLE LIMIT COVERAGE OF \$500,000; FOR THE SET UP AND REMOVAL OF A TEMPORARY CONCRETE BATCH PLANT SITE ON THE LAND DESCRIBED ON EXHIBIT "A" ATTACHED AND BY REFERENCE MADE A PART HEREOF.

## Size Map

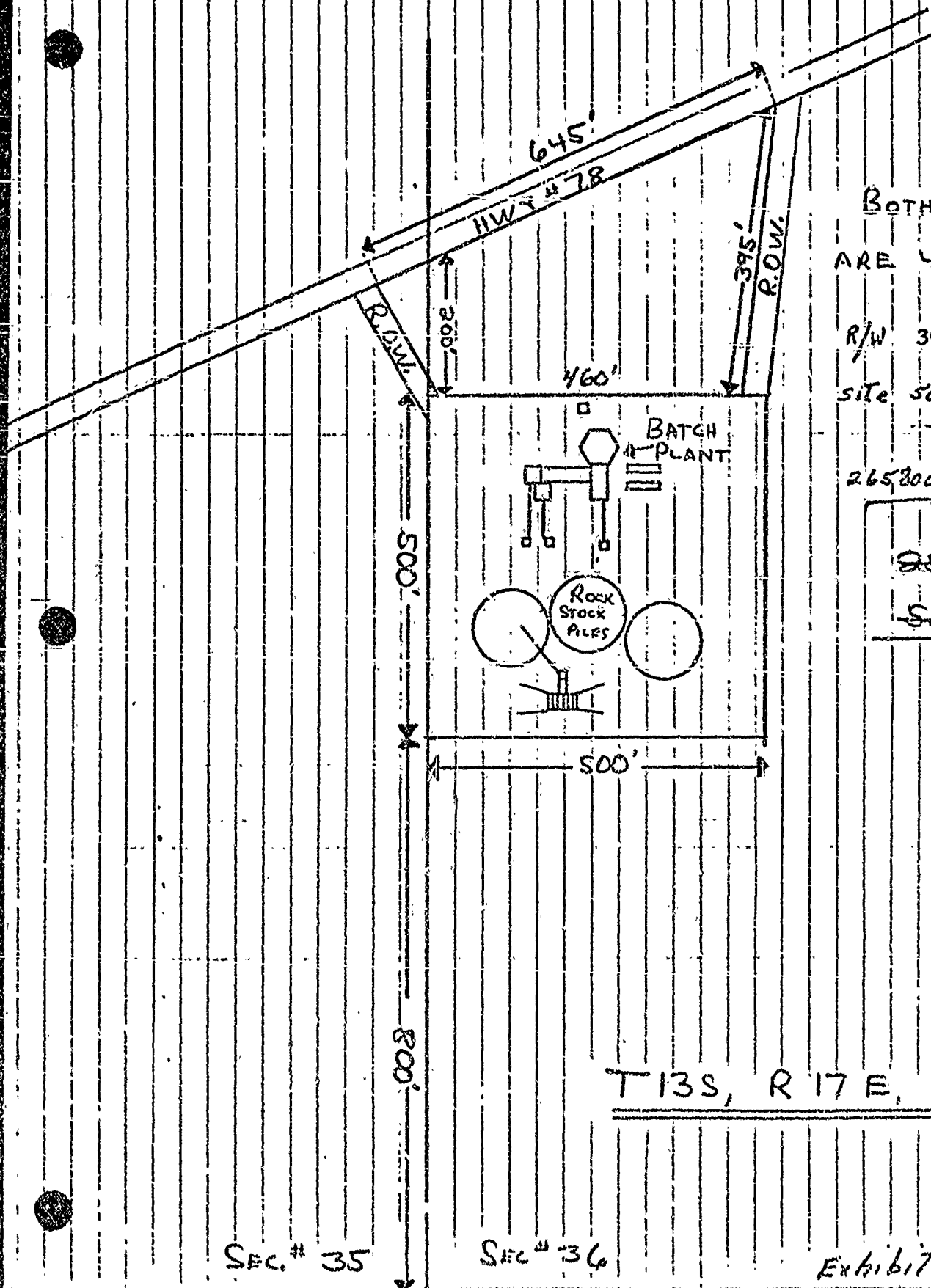

BOTH R.O.W. ROADS  
ARE 40' IN WIDTH

R/W  $395 \times 40 = 15,800 \text{ F}$

Site  $500 \times 500 = 250,000$   
 $\frac{265,830}{15,830}$

$$265800 \div 43560 = 6.104$$

~~350,000-27~~

~~S. 74 Acts~~

T13S, R17E, S36

Sec. # 35

Sec 36

Exhibit 'A'

Src #2

Sec #

CALENDAR PAGE

MINUTE PAGE

111 E

344

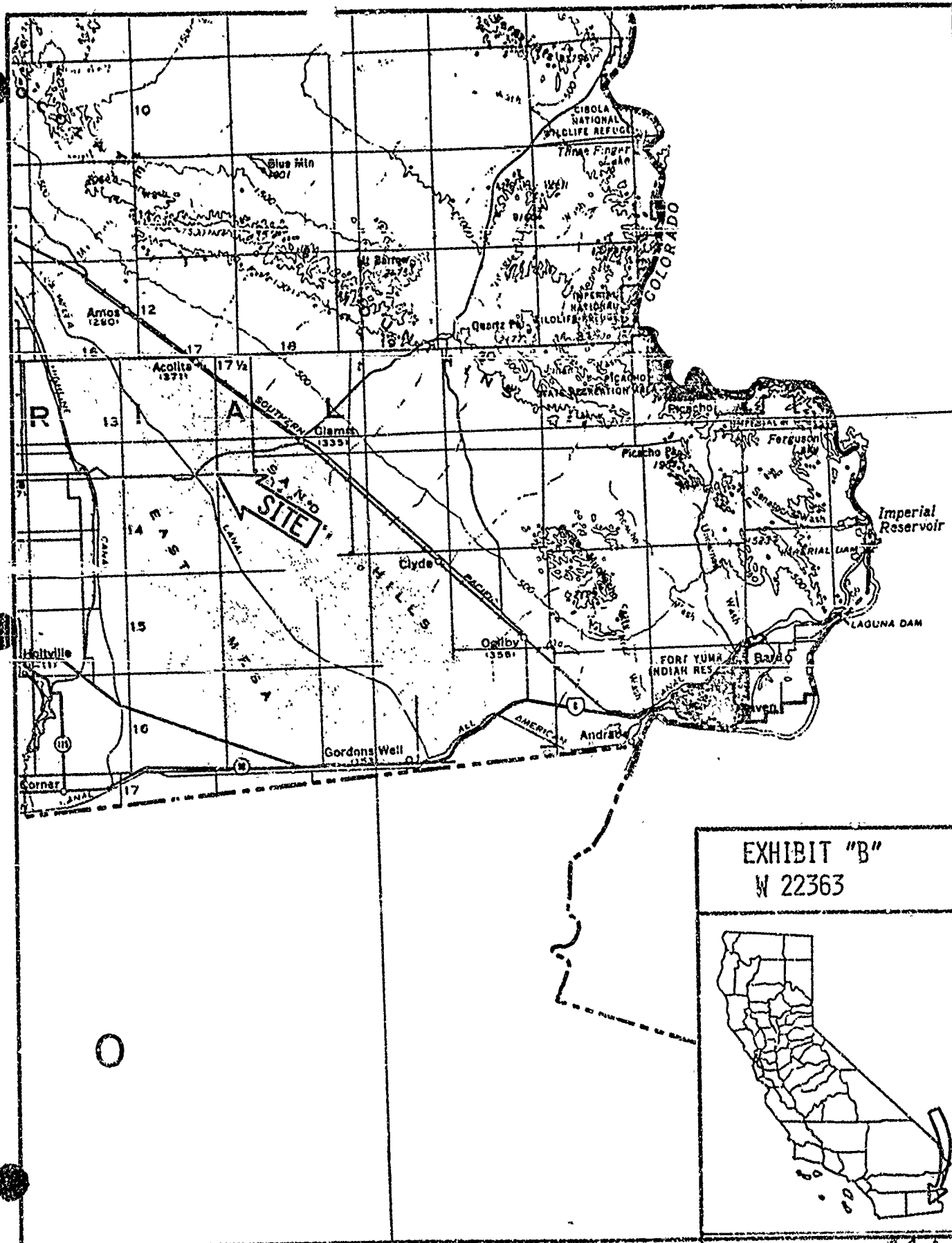

EXHIBIT "B"  
W 22363



CALENDAR PAGE  
MINUTE PAGE

114  
345