

MINUTE ITEM

This Calendar Item No. C6.
was approved as Minute Item
No. 6 by the State Lands
Commission by a vote of 2
to 0 at its 2-28-80
meeting.

CALENDAR ITEM
C6.

GENERAL PERMIT
PUBLIC AGENCY USE

2/80
W 22253
Reese
PRC 5796.9

APPLICANT: United States Department of the Interior
The Water and Power Resources Service
2800 Cottage Way
Sacramento, California 95825

AREA, TYPE LAND AND LOCATION:
0.02 acre parcel of tide and submerged
land in Cordelia Slough, 6.8 miles southwest
of Suisun City, Solano County.

LAND USE: Water Quality Monitoring Station

TERMS OF PROPOSED PERMIT:

Initial period: 10 years from January 1,
1980.

Special: Provision of a hold harmless
clause.

CONSIDERATION: The public benefit, with the State reserving
the right at any time to set a monetary
rental if the Commission finds such action
to be in the State's best interest.

PREREQUISITE TERMS:

Applicant is lessee of upland.

STATUTORY AND OTHER REFERENCES:

A. P.R.C.: Div. 6, Parts 1 & 2.

B. Cal. Adm. Code: Title 2, Div. 3.

OTHER PERTINENT INFORMATION:

1. The annual rental value of the site
is estimated to be \$100.

A 4

S 4

CALENDAR ITEM NO. 66 (CONTD)

2. This project is exempt from CEQA because it is within the purview of 14 Cal. Adm. Code 15106 (6c) (Information Collection)
3. This project is situated on land identified as possessing environmental values in that the State Lands Commission stated all waterways under the Commission's jurisdiction have environmental significance. Staff finds this project to be compatible with Commission policy.
4. The Water and Power Resources Services (formerly United States Bureau of Reclamation) is the lead agency in an intergovernmental study to determine "best environmental management alternatives" for the Suisun Marsh. Other agencies involved in the study include the United States Fish and Wildlife Service, Soil Conservation, and the California Departments of Fish and Game and Water Resources. Accordingly, staff recommends waiver of normal processing fees.

APPROVALS OBTAINED:

United States Army Corp of Engineers
State Water Resources Control Board
San Francisco Bay Conservation and Development Commission.

EXHIBITS: A. Land Description. B. Location Map.

IT IS RECOMMENDED THAT THE COMMISSION:

1. DETERMINE THAT EIR HAS NOT BEEN PREPARED FOR THIS ACTIVITY AS SUCH REPORT IS NOT REQUIRED UNDER THE PROVISIONS OF P.R.C. 21085, 14 CAL. ADM. CODE 15100 ET SEQ., AND 2 CAL. ADM. CODE 2907.
2. FIND THAT GRANTING OF THE PERMIT WILL HAVE NO SIGNIFICANT EFFECT UPON ENVIRONMENTAL CHARACTERISTICS IDENTIFIED PURSUANT TO SECTION 6370.1, OF THE P.R.C.

CALENDAR ITEM NO. 76 (CONTD)

3. AUTHORIZE ISSUANCE TO UNITED STATES DEPARTMENT OF THE INTERIOR - THE WATER AND POWER RESOURCES SERVICE OF A 10-YEAR GENERAL PERMIT - PUBLIC AGENCY USE FROM JANUARY 1, 1980; IN CONSIDERATION OF THE PUBLIC BENEFIT, WITH THE STATE RESERVING THE RIGHT AT ANY TIME TO SET A MONETARY RENTAL IF THE COMMISSION FINDS SUCH ACTION TO BE IN THE STATE'S BEST INTEREST; PROVISION OF A HOLD HARMLESS CLAUSE; FOR CONSTRUCTION AND MAINTENANCE OF TWO PILINGS, 112 SQUARE FOOT FLOAT AND WALKWAY TO PERFORM WATER QUALITY MONITORING ACTIVITIES ON THE LAND DESCRIBED ON EXHIBIT "A" ATTACHED AND BY REFERENCE MADE A PART HEREOF.
4. WAIVE PROCESSING FEES NORMALLY ASSOCIATED WITH THIS TYPE OF PROJECT.

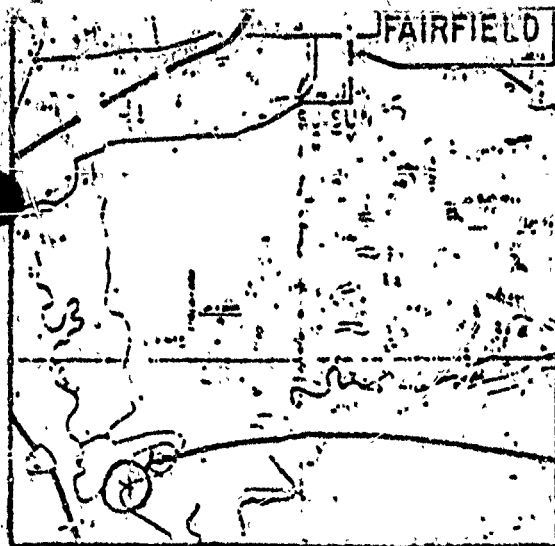

VICINITY MAP

NORTH SIDE OF
CORDERIA SLOUGH

PROJECT SITE

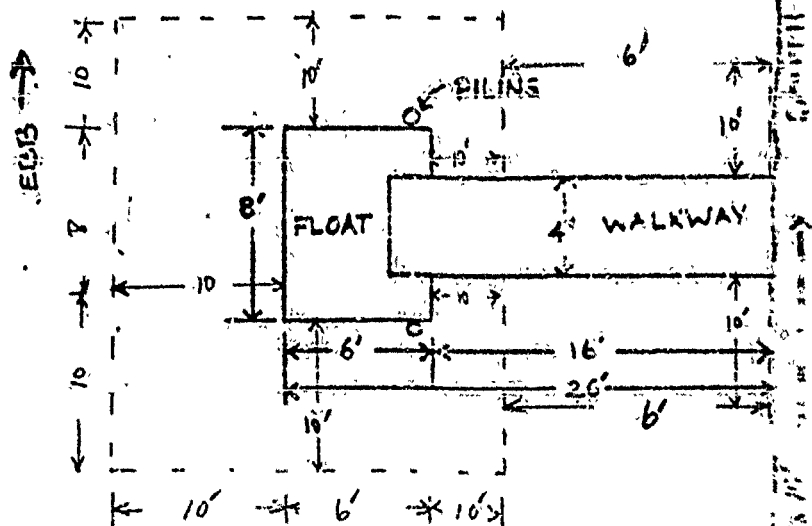

$$28' \times 26' = 728 \text{ sq ft}$$

$$\begin{array}{r} 728 \text{ sq ft} \\ + 144 \text{ sq ft} \\ \hline \text{Total Area } 872 \text{ sq ft} \end{array}$$

STAFF USE ONLY

DATUM - MLLW

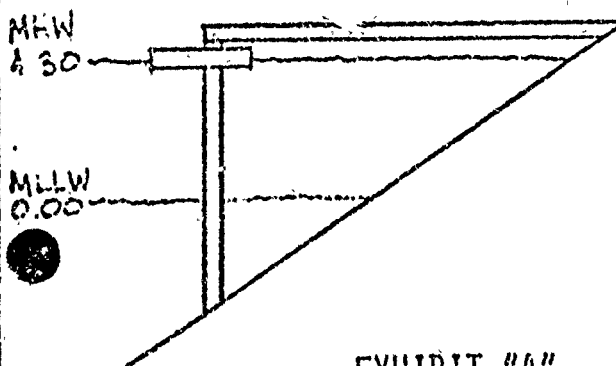

EXHIBIT "A"

W 222 3

PROPOSED MONITORING STATION
IN CORDERIA SLOUGH AT CYGNUS
6.8 MILES SOUTH-SOUTHWEST OF SUISUN CITY,
IN SOLANO COUNTY, STATE OF CALIFORNIA

APPLICATION BY: U.S. DEPARTMENT OF THE
INTERIOR, BUREAU OF RECLAMATION,
MID-PACIFIC REGION

Sheet 1 of 1

Date: 5 October 1979

CARENDAR PAGE	048
MINUTE PAGE	268

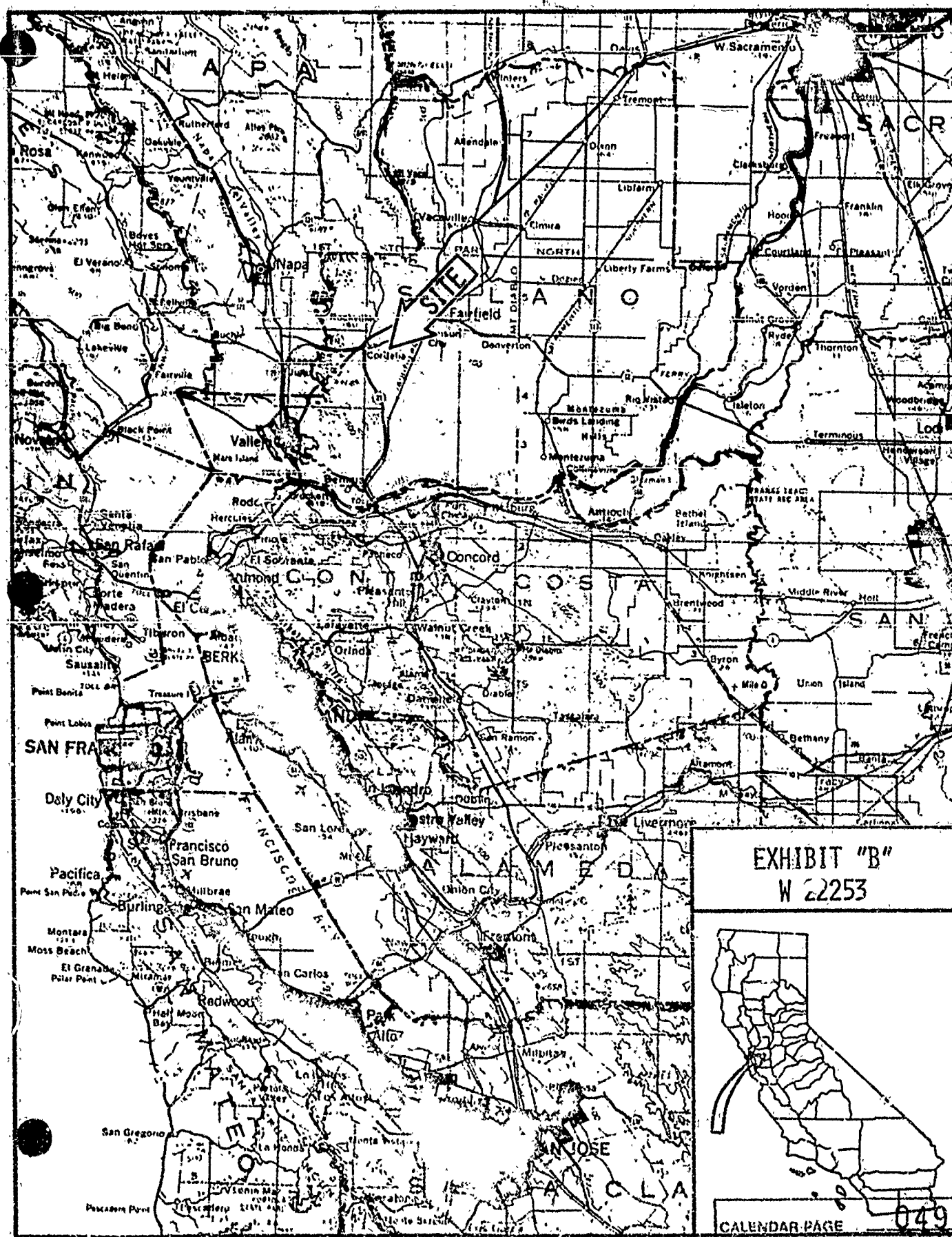

EXHIBIT "B"
W 2253



CALENDAR PAGE

049

MINUTE PAGE

269